

BEFORE THE WASHINGTON UTILITIES AND TRANSPORTATION COMMISSION

In the Matter of the Application of)
WASHINGTON NATURAL GAS COMPANY to)
Amend its Certificate of Public Con-)
venience and Necessity to Operate a)
Gas Plant for Hire in the general)
area or areas of Snohomish, King,)
Pierce, Thurston and Lewis Counties.)
.)

CAUSE NO. U-9433

ORDER GRANTING
APPLICATION

On January 22, 1963, the Washington Natural Gas Company filed an application to amend its present Certificate of Public Convenience and Necessity to Operate a Gas Plant for Hire to include additional areas in King County contiguous to its operations in that county. The additional areas sought by the company consist of an area directly east of Bothell and another area east of Kent and Auburn.

As noted above, the additional areas covered by this application are contiguous to Washington Natural Gas Company's present service area and may be readily served by extending present gas lines. The additional areas include desirable residential sites and an extensive housing project has been proposed for the area east of Kent and Auburn. Washington Natural Gas Company is fully capable of providing adequate natural gas service in the additional areas.

The Gas Certificate of Public Convenience and Necessity presently issued to Washington Natural Gas Company delineates its certificated area by attached Appendices A-1 to A-7 inclusive, consisting of maps and accompanying legal descriptions. It is the Commission's opinion Appendices 2 and 3 should be amended to include the over-all areas encompassed by the legal descriptions detailed in the Order part of this cause, which includes the additional areas requested by the company.

FINDINGS OF FACT

1. Washington Natural Gas Company operates a gas plant for hire in this state and is subject to the jurisdiction of this Commission.

2. Washington Natural Gas Company has heretofore been issued Certificate of Public Convenience and Necessity to Operate a Gas Plant for Hire No. 2, as amended August 20, 1962, in Cause No. U-9389.

3. Washington Natural Gas Company seeks to amend its present Certificate of Public Convenience and Necessity to include additional areas.

4. The additional areas requested are contiguous to the company's present service areas.

5. At present there is no gas company operating a gas plant for hire in the areas in question.

6. Washington Natural Gas Company is capable of installing plant facilities to make natural gas service available in the areas to be certificated.

7. Washington Natural Gas Company has an adequate source of natural gas.

8. The operation of a gas plant for hire by Washington Natural Gas Company in the additional areas applied for is or will be required by the public convenience and necessity.

9. The Certificate of Public Convenience and Necessity presently held by the Washington Natural Gas Company should be amended to include the additional areas requested by the company.

O R D E R

1. IT IS HEREBY ORDERED That the application of Washington Natural Gas Company to amend its Certificate of Public Convenience and Necessity to Operate a Gas Plant for Hire to encompass additional areas in King County is approved as follows:

a. All of the incorporated cities of Seattle, Edmonds, Mountlake Terrace, Beaux Arts Village, Bothell, Kirkland, Houghton, Redmond, Bellevue, Clyde Hill, Renton, Issaquah, Tukwila, the communities of Alderwood Manor, Richmond Beach, Kenmore, Woodinville, and additional portions of King County and Snohomish County adjacent thereto lying within the area described as follows:

Beginning at the northeast corner of Sec. 4 in T. 27 N, R 5 E.W.M.; thence west along the north line of Sec. 4, 5 and 6 in said Township and Range, and Secs. 1, 2, 3, 4 and 5 in T 27 N, R 4 E.W.M. to the easterly line of Puget Sound; thence southerly following the line of Puget Sound and its bays and estuaries through Tps. 27, 26, 25, 24 and 23 to the south line of Sec. 31 in T. 23 N, R 4 E.W.M.; thence east along the south line of Secs. 31, 32, 33, 34, 35 and 36 in T 23 N, R 4 E.W.M. and along the south lines of Secs. 31, 32, 33, 34, 35 and 36 in T 23 N, R 5 E.W.M., and along the south lines of Secs. 31, 32, 33, 34, 35 and 36 in T 23 N, R 6 E.W.M. to the SE corner of said Sec. 36; thence north along the east line of said Sec. 36 and Secs. 25, 24, 13, 12 and 1 in T 23 N, R 6 E.W.M., and along the east line of Secs. 36, 25, 24, 13, 12 and 1 of T 24 N, R 6 E.W.M. to the northeast corner of said Sec. 1; thence west along the north lines of said Sec. 1, and of Sec. 2 to the northwest corner of said Sec. 2; thence north along the east lines of Secs. 34, 27, 22, 15, 10 and 3 of T 25 N, R 6 E.W.M. and along the east lines of Secs. 34 and 27, 22, 15, 10 and 3 in T 26 N, R 6 E.W.M. to the northeast corner of said Sec. 3; thence west along the north line

of Secs. 3, 4, 5 and 6 of T 26 N, R 6 E.W.M. and Secs. 1, 2 and 3 in T 26 N, R 5 E.W.M. to the northwest corner of said Sec. 3 and the southeast corner of Sec. 33, T 27 N, R 5 E.W.M.; thence north along the east line of said Sec. 33 and the east lines of Secs. 28, 21, 16, 9 and 4 in T 27 N, R 5 E.W.M., to the point of beginning,

as further shown on Appendix A-2 (amended) attached hereto and by this reference made a part hereof.

b. All of the incorporated cities of Kent, Auburn, Pacific, Milton, Sumner, Puyallup, Black Diamond, the communities of Des Moines, Federal Way, and Midway, and additional portions of King and Pierce Counties adjacent thereto lying within the area described as follows:

Beginning at the northeast corner of Sec. 3, T 22 N, R 5 E.W.M.; thence west along the north lines of Secs. 3, 4, 5 and 6 in said Township and Range, and Secs. 1, 2, 3, 4, 5 and 6 in T 22 N, R 4 E.W.M. to the easterly line of Puget Sound; thence southerly along this line to its intersection with the west line of Sec. 6, T 21 N, R 4 E.W.M.; thence south along the west lines of Secs. 6, 7, 18, 19, 30 and 31 in said Township and Range, and along the west lines of Secs. 6, 7, 18, 19, 30 and 31 in T 20 N, R 4 E.W.M. and Sec. 6 in T 19 N, R 4 E.W.M. to the southwest corner of said Sec. 6; thence east along the south lines of Secs. 6, 5, 4, 3, 2 and 1 of T 19 N, R 4 E.W.M. and along the south lines of Secs. 6, 5 and 4 of T 19 N, R 5 E.W.M. to the southeast corner of Sec. 4; thence north along the east lines of said Sec. 4, and of Secs. 33, 28, 21, 16, 9 and 4 of T 20 N, R 5 E.W.M.; thence north along the east lines of Secs. 33 and 28, T 21 N, R 5 E.W.M. to the NE corner of said Sec. 28; thence east along the south line of Secs. 22, 23, and 24 of T 21 N, R 5 E.W.M. and the south line of Secs. 19, 20, 21, 22, 23 and 24 of T 21 N, R 6 E.W.M. to the southeast corner of said Sec. 24; thence north along the east line of Secs. 24, 13, 12 and 1 of T 21 N, R 6 E.W.M. and along the east line of Secs. 36, 25, 24, 13, 12 and 1 of T 22 N, R 6 E.W.M. to the northeast corner of said Sec. 1; thence west along the north line of Secs. 1, 2, 3, 4, 5 and 6 of T 22 N, R 6 E.W.M. and Secs. 1 and 2 of T 22 N, R 5 E.W.M. to the point of beginning,

as further shown on Appendix A-3 (amended) attached hereto and by this reference made a part hereof.

2. IT IS FURTHER ORDERED That the Certificate of Public Convenience and Necessity issued pursuant to Order Paragraph No. 1 above, supersedes and cancels Certificate of Public Convenience and Necessity No. 2, as amended, and issued to Washington Natural Gas Company on August 29, 1962, in Cause No. U-9389. Said Certificate of August 20, 1962, should be forthwith returned to this Commission.

U-9433

4.

3. IT IS FURTHER ORDERED That jurisdiction over this cause is retained to effectuate the provisions of this order and future consideration to determine alterations, if any, to be made to the Certificate issued pursuant to Order Paragraph No. 1 above, to conform to the requirements of public convenience and necessity as the same may then be made to appear.

DATED at Olympia, Washington, and effective this 6th day of February, 1963.

WASHINGTON UTILITIES AND TRANSPORTATION COMMISSION

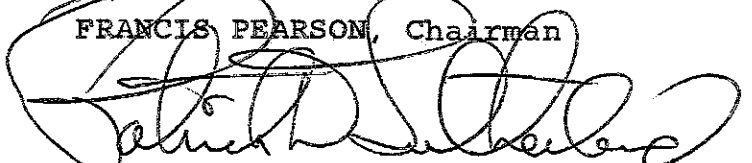
 FRANCIS PEARSON, Chairman

 PATRICK D. SUTHERLAND, Commissioner

 DAYTON A. WITTEN, Commissioner

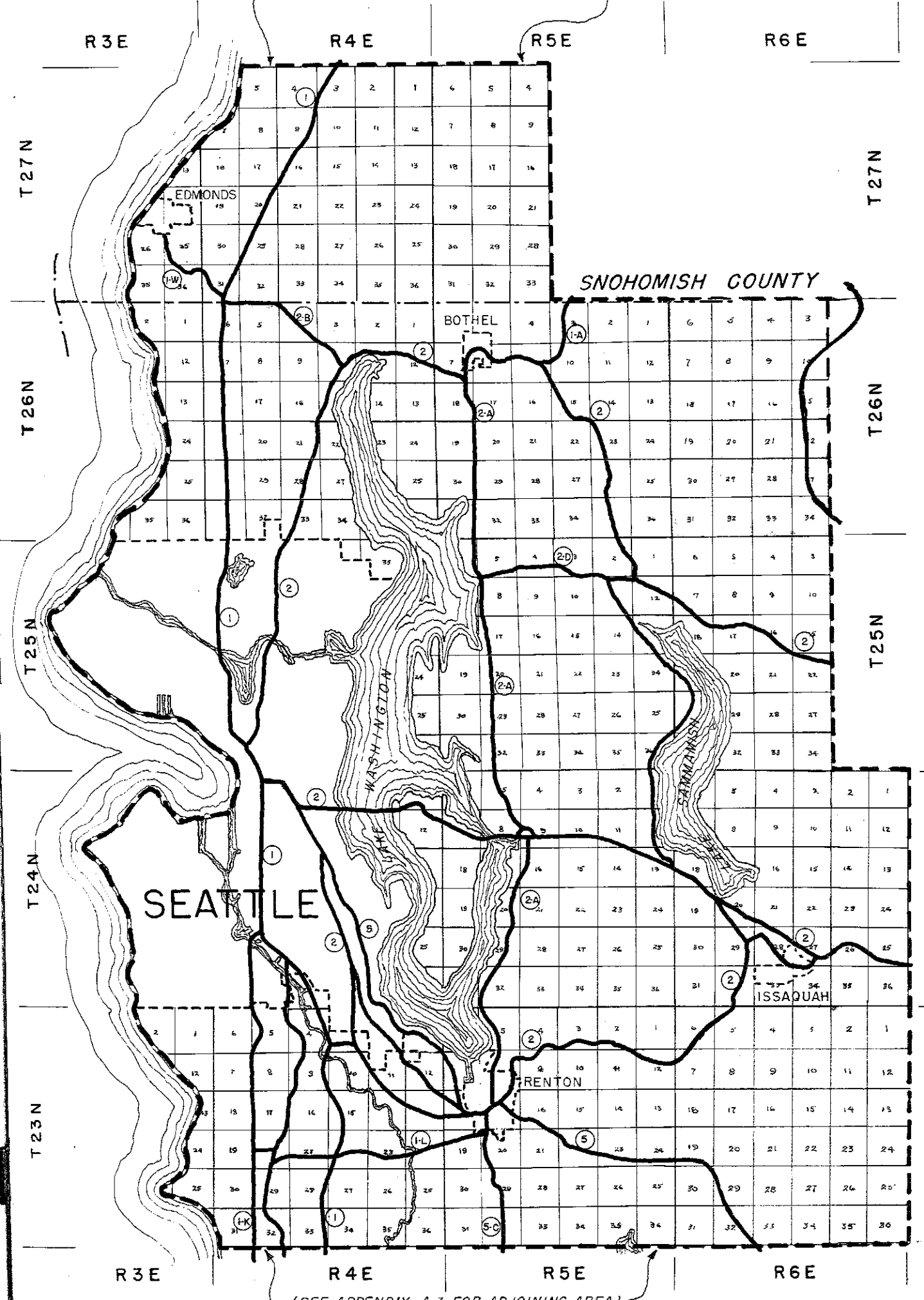
(SEE APPENDIX A-1 FOR ADJOINING AREA)



(SEE APPENDIX A-3 FOR ADJOINING AREA)

APPENDIX A-2 (AMENDED)
CAUSE NO. U-9433

WASHINGTON NATURAL GAS COMPANY
BOUNDARY OF SERVICE AREA - - - - -

WASHINGTON
UTILITIES AND TRANSPORTATION
COMMISSION

DATE: FEB. 6, 1963

BY: D.M.

1700

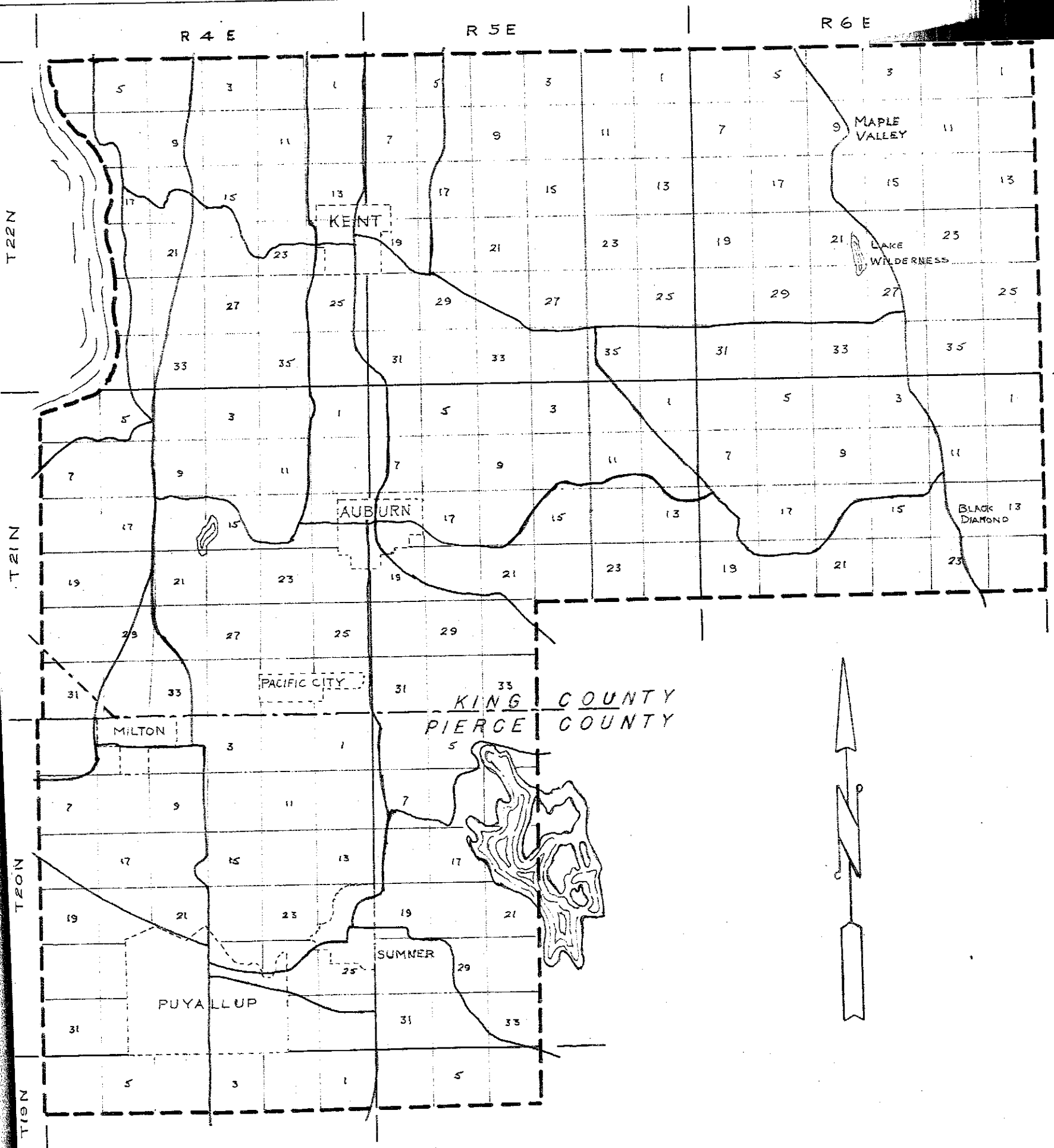

APPENDIX A-3 (AMENDED)
 CAUSE NO. U-9433
 WASHINGTON NATURAL GAS COMPANY
 BOUNDARY OF SERVICE AREA - - - - -

WASHINGTON
 UTILITIES AND TRANSPORTATION
 COMMISSION
 DATE: FEB. 6, 1963
 BY: T.W.