

BEFORE THE WASHINGTON UTILITIES AND TRANSPORTATION COMMISSION

In the Matter of the Application )  
of WASHINGTON NATURAL GAS COMPANY )  
for a Certificate of Public Con- )  
venience and Necessity to Operate )  
a Gas Plant for Hire in the )  
general area or areas of King and )  
Pierce Counties adjacent to its )  
existing certificated areas in )  
these Counties. )  
. . . . . )

CAUSE NO. U-9372

ORDER GRANTING  
APPLICATION

Washington Natural Gas Company on May 11, 1962, filed an application to amend its present Certificate of Public Convenience and Necessity to Operate a Gas Plant for Hire to include additional areas adjacent to its presently certificated areas in King and Pierce Counties.

The company presently holds Certificate of Public Convenience and Necessity No. 2, as amended January 3, 1961, in Cause No. U-9230. In general Washington's certificate encompasses an area along the shores of Puget Sound extending from North or Marysville to a line west of Olympia and an area adjacent to and including the cities of Centralia and Chehalis. The additional areas sought by the company consist of a township south of Issaquah and east of Renton and some twelve square miles of territory east of Pacific City between Auburn and Sumner. All the new area is adjacent to the company's presently certificated areas and is fully detailed in the application.

Washington's application states the area requested is contiguous to its present service area and normal growth and expansion has created a demand for gas service in the additional area. Furthermore, several of the company's proposed construction projects provide an opportunity to economically install new service facilities in the requested areas. The Commission realizes Washington Natural Gas Company is the only company capable of readily providing gas service in the requested area and will grant its application. The Commission is also aware the company has adequate financial resources to cover the cost of installing the necessary plant facilities in the new areas as well as a sufficient supply of natural gas.

The Gas Certificate of Public Convenience and Necessity presently issued to Washington Natural Gas Company delineates its certificated area by attached Appendices A-1 to A-7 inclusive, consisting of a map and legal description. It is the Commission's opinion Appendices A-2 and A-3 should be amended to include the overall areas encompassed by the legal descriptions detailed in the Order part of this cause, which includes the additional areas requested by the company.

FINDINGS OF FACT

1. Washington Natural Gas Company operates a gas plant for hire in this state and is subject to the jurisdiction of this Commission.
2. Washington Natural Gas Company has heretofore been issued Certificate of Public Convenience and Necessity to Operate a Gas Plant for Hire No. 2, as amended January 3, 1961, in Cause No. U-9230.
3. Washington Natural Gas Company seeks to amend its present Certificate of Public Convenience and Necessity to include additional areas.
4. The additional areas requested are contiguous to the company's present service areas.
5. At present there is no gas company operating a gas plant for hire in the areas in question.
6. Washington Natural Gas Company is capable of installing plant facilities to make natural gas service available in the areas to be certificated.
7. Washington Natural Gas Company has an adequate source of natural gas.
8. The operation of a gas plant for hire by Washington Natural Gas Company in the additional areas applied for is or will be required by the public convenience and necessity.
9. The Certificate of Public Convenience and Necessity presently held by the Washington Natural Gas Company should be amended to include the additional areas requested by the company.

O R D E R

1. IT IS HEREBY ORDERED That the application of Washington Natural Gas Company to amend its Certificate of Public Convenience and Necessity to Operate a Gas Plant for Hire to encompass additional areas in King and Pierce Counties is approved as follows:

a. All of the incorporated cities of Seattle, Edmonds, Mountlake Terrace, Beaux Arts Village, Bothell, Kirkland, Houghton, Redmond, Bellevue, Clyde Hill, Renton, Issaquah, Tukwila, and the communities of Alderwood Manor, Richmond Beach, Kenmore, Woodinville, and additional portions of King County and Snohomish County adjacent thereto lying within the area described as follows:

Beginning at the northeast corner of Sec. 4 in T 27 N, R 5 E.W.M.; thence west along the north line of Secs. 4, 5 and 6 in said Township and Range, and Secs. 1, 2, 3, 4 and 5 in T 27 N, R 4 E.W.M. to the easterly line of Puget Sound; thence southerly following the line of Puget Sound and its

Bays and estuaries through Townships 27, 26, 25, 24 and 23 to the south line of Sec. 31 in T 23 N, R 4 E.W.M.; thence east along the south line of Secs. 31, 32, 33, 34, 35 and 36 in T 23 N, R 4 E.W.M. and along the south lines of Secs. 31, 32, 33, 34, 35 and 36 in T 23 N, R 5 E.W.M. to the southeast corner of said Sec. 36; and along the south lines of Secs. 31, 32, 33, 34, 35 and 36 in T 23 N, R 6 E.W.M. to the SE corner of said Sec. 36; thence north along the east line of said Sec. 36 and Secs. 25, 24, 13, 12 and 1 in T 23 N, R 6 E.W.M. to the NE corner of said Sec. 1; thence north along the east line of Secs. 36, 25, 24, 13, 12 and 1 of T 24 N, R 6 E.W.M. to the northeast corner of said Sec. 1; thence west along the north lines of said Sec. 1, and of Sec. 2 to the northwest corner of said Sec. 2; thence north along the east lines of Secs. 34, 27, 22, 15, 10 and 3 of T 25 N, R 6 E.W.M., and along the east lines of Sec. 34 and 27, T 26 N, R 6 E.W.M. to the northeast corner of said Sec. 27; thence west along the north lines of said Sec. 27, and of Secs. 28, 29 and 30, to the northwest corner of Sec. 30, T 26 N, R 6 E.W.M.; thence north along the east line of Secs. 24, 13, 12 and 1 in T 26 N, R 5 E.W.M. to the northeast corner of said Sec. 1; thence west along the north line of said Sec. 1 and the north line of Secs. 2 and 3 in T 26 N, R 5 E.W.M. to the northwest corner of said Sec. 3 and the southeast corner of Sec. 33, T 27 N, R 5 E.W.M.; thence north along the east line of said Sec. 33 and the east lines of Secs. 28, 21, 16, 9 and 4 in T 27 N, R 5 E.W.M., to the point of beginning,

as further shown on Appendix A-2 (amended) attached hereto and by this reference made a part hereof.

b. All of the incorporated cities of Kent, Auburn, Pacific, Milton, Sumner, Puyallup, the communities of Des Moines, Federal Way, and Midway, and additional portions of King and Pierce Counties adjacent thereto lying within the area described as follows:

Beginning at the northeast corner of Sec. 3, T 22 N, R 5 E.W.M.; thence west along the north lines of Secs. 3, 4, 5 and 6 in said Township and Range, and Secs. 1, 2, 3, 4, 5 and 6 in T 22 N, R 4 E.W.M. to the easterly line of Puget Sound; thence southerly along this line to its intersection with the west line of Sec. 6, T 21 N, R 4 E.W.M.; thence south along the west lines of Secs. 6, 7, 18, 19, 30 and 31 in said Township and Range, and along the west lines of Secs. 6, 7, 18, 19, 30 and 31 in T 20 N, R 4 E.W.M., and Sec. 6 in T 19 N, R 4 E.W.M. to the southwest corner of said Sec. 6; thence east along the south lines of Secs. 6, 5, 4, 3, 2, and 1 of T 19 N, R 4 E.W.M. and along the south lines of Secs. 6, 5 and 4 of T 19 N, R 5 E.W.M. to the southeast corner of Sec. 4; thence north along the east lines of said Sec. 4, and of Secs. 33 and 28, T 20 N, R 5 E.W.M. to the northeast corner of said Sec. 28; thence north along the east lines of Secs. 21, 16, 9 and 4 of T 20 N, R 5 E.W.M.;

1703

thence north along the east lines of Secs. 33, and 28, T 21 N, R 5 E.W.M. to the NE corner of said Sec. 28; thence east along the south line of Sec. 22 to the southeast corner of said Sec. 22, T 21 N, R 5 E.W.M.; thence north along the east lines of said Sec. 22, and of Secs. 15, 10 and 3 in T 21 N, R 5 E.W.M. and north along the east lines of Secs. 34, 27, 22, 15, 10 and 3 in T 22 N, R 5 E.W.M. to the point of beginning,

as further shown on Appendix A-3 (amended) attached hereto and by this reference made a part hereof.

2. IT IS FURTHER ORDERED That the Certificate of Public Convenience and Necessity issued pursuant to Order Paragraph No. 1 above, supersedes and cancels Certificate of Public Convenience and Necessity No. 2, as amended, and issued to Washington Natural Gas Company on January 3, 1961, in Cause No. U-9230. Said Certificate of January 3, 1961, should be forthwith returned to this Commission.

3. IT IS FURTHER ORDERED That jurisdiction over this cause is retained to effectuate the provisions of this order and future consideration to determine alterations, if any, to be made to the Certificate issued to Order Paragraph No. 1 above, to conform to the requirements of public convenience and necessity as the same may then be made to appear.

DATED at Olympia, Washington, and effective this 28th day of May, 1962.

WASHINGTON UTILITIES AND TRANSPORTATION COMMISSION

  
FRANCIS PEARSON, Chairman

  
PATRICK D. SUTHERLAND, Commissioner

  
DAYTON A. WITTEN, Commissioner

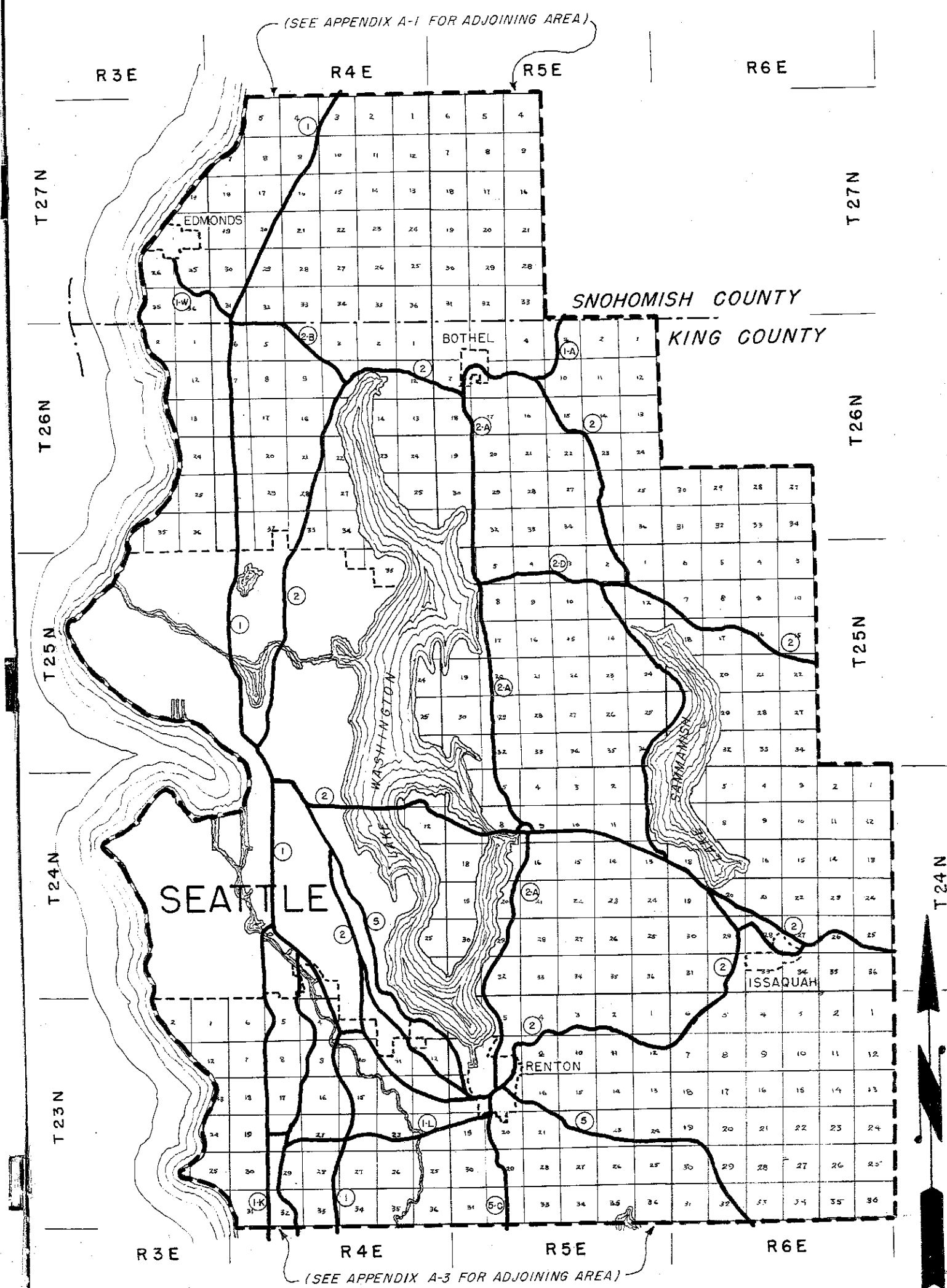

APPENDIX A-2 (AMENDED)  
 CAUSE NO. U-9372  
 WASHINGTON NATURAL GAS COMPANY  
 BOUNDARY OF SERVICE AREA - - - - -  
 (SEATTLE & VICINITY - KING & SNOHOMISH COUNTIES)

WASHINGTON PUBLIC SERVICE COMMISSION  
 FIELD ENGINEERING  
 DATE: MAY 28, 1962  
 CHECKED: T.W. BY: D.H.

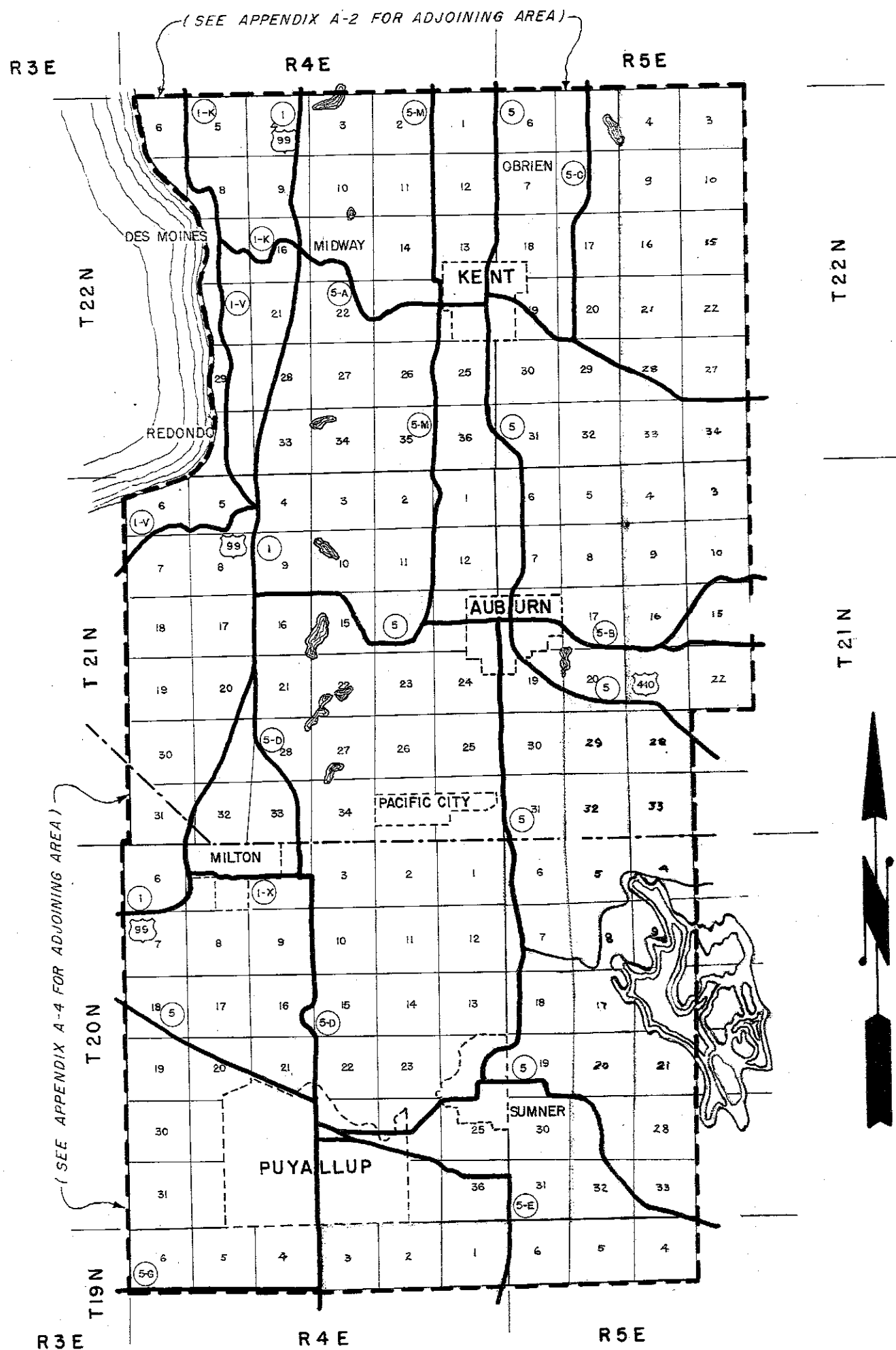

APPENDIX A-3 (AMENDED)  
 CAUSE NO. U-9372  
 WASHINGTON NATURAL GAS COMPANY  
 BOUNDARY OF SERVICE AREA - - - - -  
 (VALLEY AREA - KING & PIERCE COUNTIES)

WASHINGTON PUBLIC SERVICE COMMISSION  
 FIELD ENGINEERING  
 DATE: MAY 28, 1962  
 CHECKED: T.W. BY: D.H.