



WASHINGTON UTILITIES AND TRANSPORTATION COMMISSION

)	DOCKET NO. TR-
)	
Skagit County)	PETITION FOR INSTALLATION OF
_____)	MEDIAN BARRIERS AT A
Petitioner,)	HIGHWAY-RAIL GRADE
)	CROSSING
vs.)	
Burlington Northern Santa Fe Railway)	
_____)	
Respondent)	USDOT CROSSING NO.: 084791W
)	
.....)	

The Petitioner asks the Washington Utilities and Transportation Commission to approve installation of median barriers at a highway-rail grade crossing.

Section 1 – Petitioner’s Information

<u>Skagit County</u>
Petitioner

Signature
<u>1800 Continental Place</u>
Street Address
<u>Mount Vernon, WA 98273</u>
City, State and Zip Code
<u>Same</u>
Mailing Address, if different than the street address
<u>Forrest Jones</u>
Contact Person Name
<u>360-416-1422 forresti@co.skagit.wa.us</u>
Contact Phone Number and Email Address

Section 2 – Respondent's Information

Burlington Northern Santa Fe Railway
Respondent

2454 Occidental Avenue South, Suite 2D
Street Address

Seattle, WA 98134
City, State and Zip Code

Mailing Address, if different than the street address

Stephen Semenick, Manager of Public Projects
Contact Person Name

206-625-6152, Stephen.Semenick@BNSF.com
Contact Phone Number and Email Address

Section 3 – Crossing Location

1. Name of highway/roadway (North) Legg Road

2. Name of railroad Burlington Northern Santa Fe Railway

3. USDOT Crossing No. 084791W

4. Located in the SW 1/4 of the NW 1/4 of Sec. 22 Twp. 36 Range 3E W.M.

5. GPS location, if known Lat. 48.5960391 / Long. -122.4203009

6. Railroad mile post (nearest tenth) 81.829

7. City Burlington County Skagit

Section 4 – Current Crossing Traffic

1. Type of public road at the crossing State County City
 Port State Park Other _____
2. Average daily vehicle traffic over the tracks 154 Vehicle speed limit 25-MPH
3. Number of lanes 2
4. Trucks (commercial vehicles) are what percent of average daily traffic 4.4
5. Number of school buses over the crossing each day 2
6. Name of railroad(s) operating at crossing _____
Burlington Northern Santa Fe Railway
AmTrac
7. Type of railroad at crossing Common Carrier Logging Industrial
 Passenger Excursion
8. Type of tracks at crossing Main Line Siding or Spur
9. Number of tracks at crossing 1
10. Average daily train traffic, freight 20
Authorized freight train speed 59 Operated freight train speed 50
11. Average daily train traffic, passenger 2
Authorized passenger train speed 79 Operated passenger train speed 79

Section 5 – Justification

1. Provide the following information:

a. Describe in detail the why this crossing should have median barriers installed.

Skagit County has issued a Notice of Intent to establish a quiet zone at the (North) Legg Road grade crossing. With the lack of train horns the risk index increases substantially, in order to reduce the risk index at this crossing without train horns it is necessary to install Supplemental Safety Measures (SSM's), non-traversable median barriers. The installation of the non-traversable median barriers with delineators will reduce the risk index with horns from 11,274.93 to 3,761.32 without horns, a 67% reduction, in addition to bringing it below the National Significant Risk Index of 14,347.00. The non-traversable median barriers will provide a physical deterrent in the absence of the train horn and restrict motorist from driving around the gates. Due to the curve on the west leg of the crossing inconjunction with the median, the County will also implement truck restrictions on this crossing because of trailer tracking issues. The crossing will maintain the existing warning devices of two gates, advanced warning signs, bells and flashing lights. This crossing is part of a four crossing quiet zone in which non-traversable median barriers will be installed at three of the four crossings, reducing the overall risk index for the quiet zone from 11,497.06 with train horns to 6,077.37 without train horns.

b. Provide a description of the type of median barriers proposed.

The non-traversable median barriers will be constructed on-site using concrete. The median will be 12 inches in width and 6 inches in height. The length of the median barriers will begin at the gates and extend 100 feet in length. Reflective breakaway traffic channelization devices are 36 inches tall by 8 to 12 inches wide with 192 to 288 square inches of type III reflective sheeting. These will be installed on top of the median barriers and spaced at approximately 120 inch intervals the length of the median barriers.

c. Describe who will maintain the barriers.

The non-traversable median barriers will be maintained by Skagit County Public Works Operations Division. The barriers, channelization devices, and signing will be maintained in accordance with standard maintenance practices, repairing or replacing any compromising functionality of the barrier, channelization devices, and signing. As with all of our traffic control devices, the County performs annual inspections that included retro-reflectivity surveys and repainting of striping and curbing/medians. As this will be Skagit County's first quiet zone, we intend to monitor the site closely and address any issues, maintenance or operational that may occur.

d. Attach a proposed diagram or design of the crossing and median barriers.

See attached plan of the proposed non-traversable median barriers

Section 6 – Waiver of Hearing by Respondent

Waiver of Hearing

The undersigned represents the Respondent in the petition to install median barriers at the following crossing.

USDOT Crossing No. 084791W

We have investigated the conditions at the crossing. We are satisfied the conditions are the same as described by the Petitioner in this docket. We agree installation of median barriers should be made and consent to a decision by the commission without a hearing.

Dated at Seattle, Washington, on the 11th day of
October, 2017.

Stephen Semenick

Printed name of Respondent

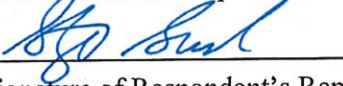

Signature of Respondent's Representative

Manager Public Projects

Title

BNSF Railway Company

Company Name

206-625-6152; Stephen.Semenick@bnsf.com

Phone number and email address

2454 Occidental Ave S, Suite 2D

Seattle, WA 98134

Mailing address

RESOLUTION NO.

RESOLUTION INITIATING COUNTY ROAD PROJECTS

BEFORE THE BOARD OF COUNTY COMMISSIONERS OF SKAGIT COUNTY, WA

In the matter of initiating County Road Projects and assigning CRP numbers.

IT IS HEREBY RESOLVED THAT the Blanchard Quiet Zone, Tye Road Culvert, and Guemes Ferry Parking Lot Improvements Projects listed below be improved as shown at or between the points indicated. These projects are hereby declared to be a public necessity and the county road engineer is hereby ordered and authorized to report and proceed thereon as by law provided. (RCW 36.75.050, 36.80.030, and 36.80.070).

IT IS FURTHER RESOLVED that if and when Washington State Department of Transportation (WSDOT) services are used during a project as mandated in RCW 47.04.060, authorization is hereby given that WSDOT will be reimbursed for services rendered.

IT IS FURTHER RESOLVED that appropriations from the officially adopted Road Fund budget and based on the County Engineer's estimates are hereby made in the amounts and for the purposes shown:

1 ROAD NAME AND/OR BRIDGE NUMBER	2 RD. LOG NO.	3 M.P. TO M.P.		4 TYPE OF WORK SEE CODES BELOW	5 CONTRACT	6 COUNTY FORCES	7 COST ESTIMATE (THOUSANDS)				8 ACP ITEM NO.	9 CRP NO.
							PE, ROW	CN	GRANT	LOCAL		
BLANCHARD QUIET ZONE (Legg Rd / Colony Rd)	20830 24000	Vary	Vary	A,F,G	X	X	18	45	0	63	21	ES20830-3 / -3A
TYEE ROAD	83000	0.50	0.80	A,H	X	X	37	214	0	251	20	ES83000-2
GUEMES FERRY PARKING LOT IMPROVEMENTS	N/A	N/A	N/A	A,J	X	X	47	203	216	34	22	FEMP-6

Appropriate

(4) Type of Work Code:

- | | |
|---------------------------------|-----------------------|
| A. Preliminary Engineering | F. Curbs & Gutters |
| B. Right-of-Way | G. Traffic Facilities |
| C. Grading, Draining, Surfacing | H. Bridges, Culverts |
| D. BST | I. Paths and Trails |
| E. AC or PCC Pavement | J. Ferry |

IT IS FURTHER RESOLVED that:

- The construction is to be accomplished by contract in accordance with RCW 36.77.020 et.seq.
- The construction is to be accomplished by county forces in accordance with RCW 36.77.065 and WAC 136-18.
- The construction is to be accomplished by contract with County Force participation.

ADOPTED this 19 day of June, 2017.

BOARD OF COUNTY COMMISSIONERS
SKAGIT COUNTY, WASHINGTON

Ron Wesen

Ron Wesen, Chair

ABSENT

Kenneth A. Dahlstedt, Commissioner

Lisa Janicki

Lisa Janicki, Commissioner



Attest:

Linda Hamme

Clerk of the Board

Approved as to Form

[Signature] 6/12/17
Skagit County Prosecuting Attorney

Approved as to content:

[Signature]
Department Head

BLANCHARD QUIET ZONE (LEGG RD & COLONY RD CROSSINGS) ES20830-3 | ES20830-3A

FEDERAL AID NO.: N/A

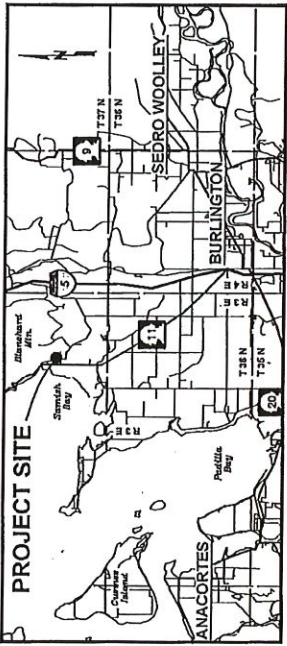

PLAN SHEET INDEX

SHEET	TITLE
1	COVER, LEGEND
2	ROAD SECTIONS
3-5	CURB & SIGNING PLANS
6	CURB DETAILS



SKAGIT COUNTY OFFICIALS
 BOARD OF COMMISSIONERS
 -KENNETH DANFORTH, COMMISSIONER
 -LISA JANICK, COMMISSIONER
 PUBLIC WORKS
 -DAN BERENTSON, DIRECTOR

PAUL A. RANDALL - GRUTTER, P.E., COUNTY ENGINEER DATE

T. 37N R. 3E W.M., SECTIONS 22 & 27.

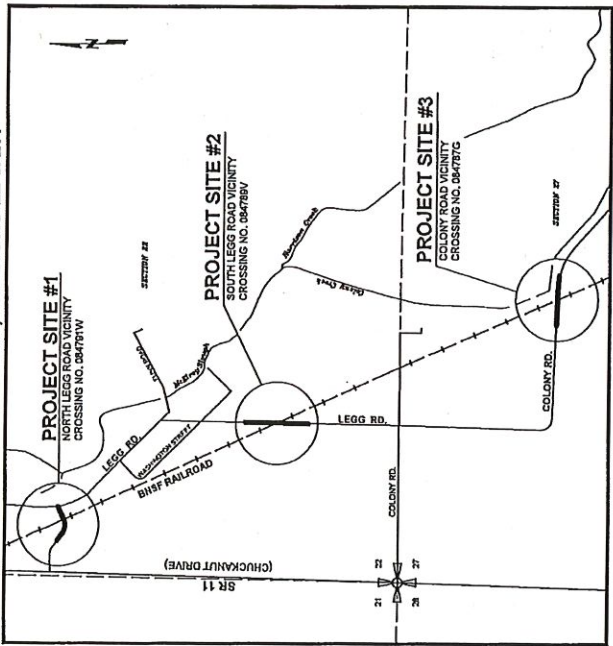

SUMMARY OF QUANTITIES

Item #	Qty.	Unit	Item Description
1	1	LS	MOBILIZATION
2	20	CY	BALLAST
3	500	LF	EXTRUDED DUAL-FACED TRAFFIC CURB
4	50	EA	VERTICAL PANEL
5	200	LF	PAINTING CURB
6	10	EA	PERMANENT SIGNING
7	1	LS	ROADSIDE CLEANUP
8	1	LS	REIMBURSEMENT FOR THIRD PARTY DAMAGE
9	2	DAY	ROADWAY FLAGGING
10	1	LS	SPACE
11	1	LS	SPACE

- LEGEND**
- EXISTING EDGE OF PAVEMENT
 - EXISTING EDGE OF SHOULDER
 - EXISTING CONCRETE PAD
 - EXISTING RAILROAD TRACKS
 - EXISTING RAILROAD GATE
 - EXISTING GUARDRAIL
 - NEW SIGN
 - PROPOSED CURB
 - GRADING / FILL LIMITS
 - EXISTING PAVEMENT MARKINGS
 - EXISTING POWER POLE

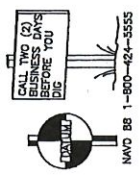

NAVJ 88 1-800-424-3555

PROJECT NO.: ES20830-3-ES20830-3A	FED. AID NO.: VA	DESIGNED BY: SA	DRAWN BY: SA	CHECKED BY: PJ	APPROVED BY:
PROJECT LOCATED HEAR: BOW, VA					
TOWNSHIP 35 RANGE 3 EAST SECTION 22 & 27					
INDEX/VICINITY / 800/LEGEND	LEGG RD & COLONY RD CROSSINGS				
1"=80' SCALE	ADJUST SCALE ACCORDINGLY				
SHEET					
1 OF 6					

BLANCHARD QUIET ZONE (LEGG RD & COLONY RD CROSSINGS) ES20830-3 | ES20830-3A

FEDERAL AID NO.: N/A

SKAGIT COUNTY
PUBLIC WORKS
1000 COMMERCIAL PLACE
MCURTHERON, WA 98273-9525
(509) 415-1100 FAX (509) 415-1408

NO	REVISIONS	DATE

DESIGNED BY: JI
DRAWN BY: SA
CHECKED BY: SA
APPROVED BY: SA

PROJECT NO.: ES20830-3 | ES20830-3A
TOWNSHIP 36 RANGE 3 EAST SECTION 22 & 27
BOM, WA

PROJECT LOCATED HEREIN:
BLANCHARD QUIET ZONE
LEGG RD & COLONY RD
ROADWAY SECTIONS

1" = 20' SCALE
ASSET SCALE ACCORDING
SHEET
2 OF 9

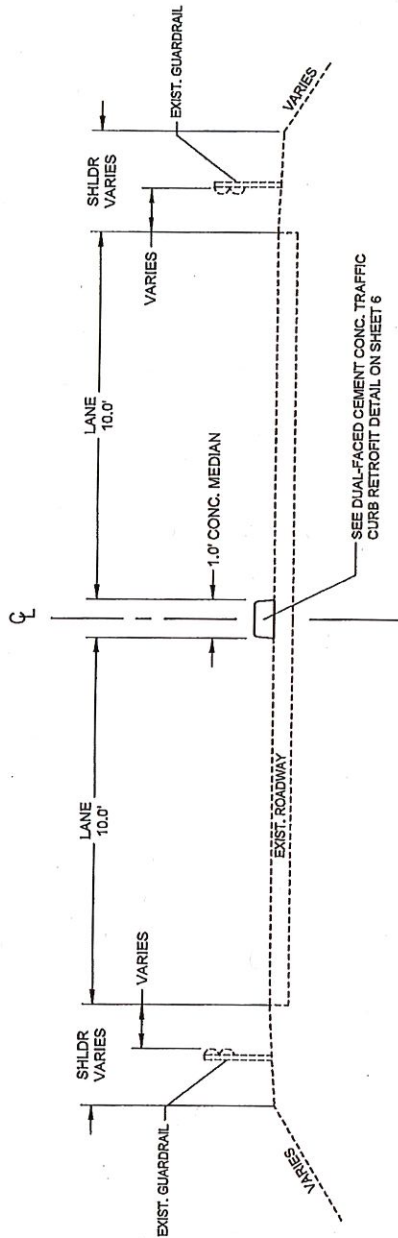

ROADWAY SECTION A

- *N. LEGG RD, MP 0.055 TO MP 0.074
- *N. LEGG RD, MP 0.080 TO MP 0.092
- *S. LEGG RD, MP 0.501 TO MP 0.520
- *S. LEGG RD, MP 0.555 TO MP 0.574
- *COLONY RD, MP 0.661 TO MP 0.684
- *COLONY RD, MP 0.686 TO MP 0.705

*SEE PLANSHEETS 3, 4 & 5 FOR ACTUAL DIMENSIONS (IN LINEAR FEET).

BLANCHARD QUIET ZONE (LEGG RD & COLONY RD CROSSINGS) ES20830-3 | ES20830-3A

GENERAL NOTES

- SEE DUAL-FACED CEMENT CONC. TRAFFIC CURB DETAIL ON SHEET 6.
- THE MEDIAN CURB OVERALL LENGTH SHALL BE DEFINED BY THE FIXED POINT AS IDENTIFIED IN THE PLANS BELOW. THIS FIXED POINT IS WHERE THE RAILROAD CROSSING ASSETS INTERSECT THE ROADWAY CENTERLINE AND IT SHALL BE ESTABLISHED IN THE FIELD BY THE PROJECT ENGINEER AT THE BEGINNING CONSTRUCTION OF THE CURB. THE OVERALL LENGTH CALLED OUT IN THE PLANS BELOW SHALL BE DEFINED FROM THIS ESTABLISHED POINT.
- VERTICAL PANEL TYPE, SHEETING & HARDWARE SHALL BE APPROVED BY THE PROJECT ENGINEER PRIOR TO USE.
- VERTICAL PANELS SHALL BE ANCHORED TO THE CURB AND PLACED EVERY 10.0' O.C.
- VERTICAL PANEL DIMENSIONS, SEE VERTICAL PANEL DETAIL ON THIS SHEET. ALTERNATE PANEL TYPES MAY BE USED TO OBTAIN PROJECT ENGINEER APPROVAL PRIOR TO INSTALLATION.
- SIGN R4-7C SHALL BE ANCHORED TO THE CURB WITH AN APPROPRIATE ANCHOR BASE TO BE APPROVED BY THE PROJECT ENGINEER PRIOR TO USE.
- FOR SIGN INSTALLATION LOCATION REQUIREMENTS SEE WSDOT STANDARD PLAN G-20.10.00.
- FOR TIMBER SIGN SUPPORT INSTALLATION, SEE WSDOT STANDARD PLAN G-22.10.01, SINGLE POST INSTALLATION.
- SIGN SHALL BE COVERED UPON COMPLETION OF INSTALLATION. SIGN SHALL BE UNCOVERED 48 HOURS AFTER THE QUIET ZONE HAS BEEN OFFICIALLY ESTABLISHED.
- FILL MATERIAL SHALL BE CRUSHED SURFACING BASE COURSE. APPROXIMATELY 10 CY SHALL BE PLACED IN THE LOCATION OUTLINED ABOVE TO EXTEND THE EXISTING SHOULDER OUT IN LINE WITH THE EXISTING LIMIT LOCATIONS. THE FILL LIMITS SHALL BE MARKED BY THE PROJECT ENGINEER PRIOR TO FILL BEING PLACED. THE FILL SHALL BE COMPACTED TO 95% COMPACTION, AS DETERMINED BY THE PROJECT ENGINEER. NO SENSITIVE AREAS SHALL BE IMPACTED.

FEDERAL AID NO.: N/A

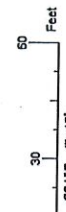
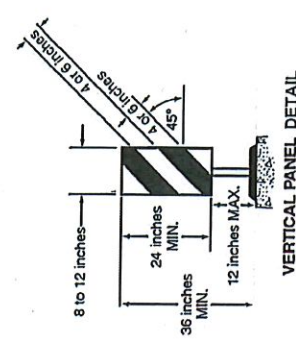
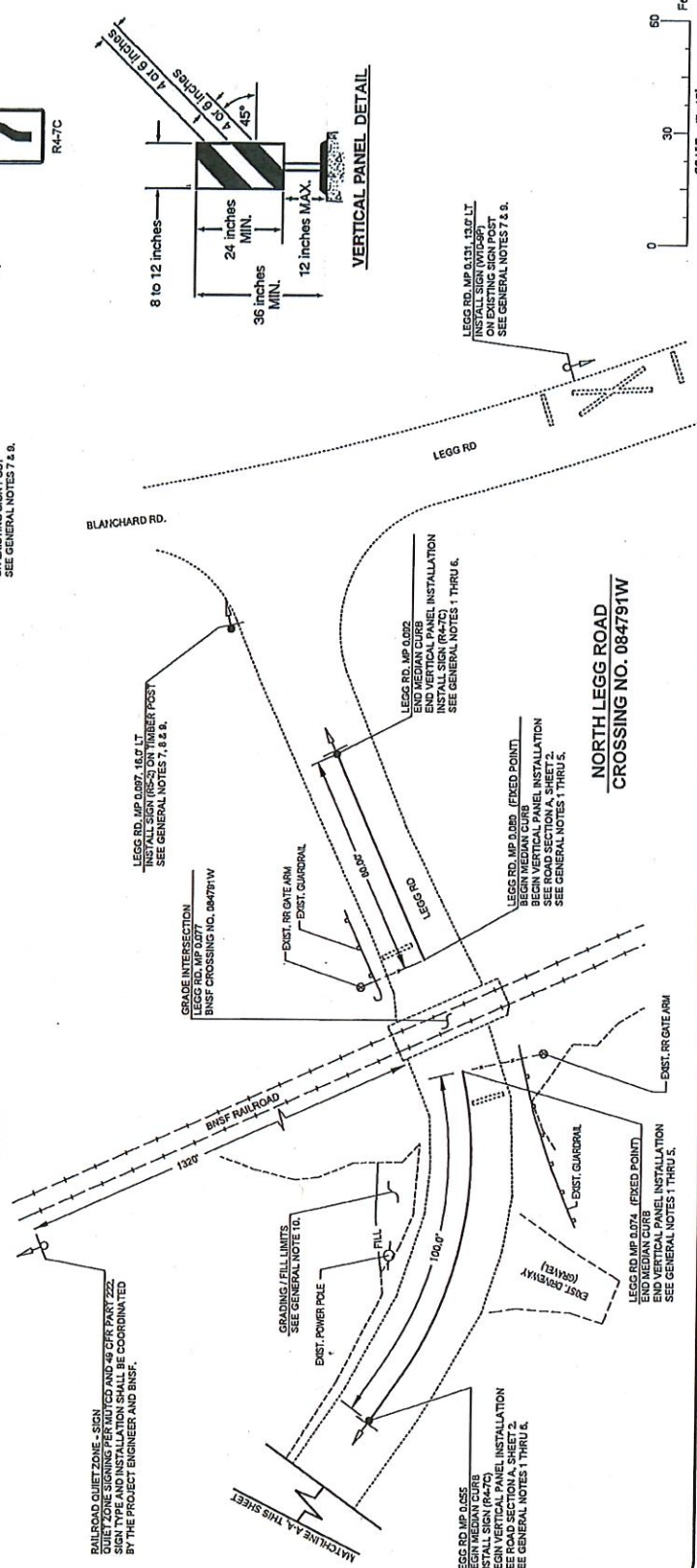
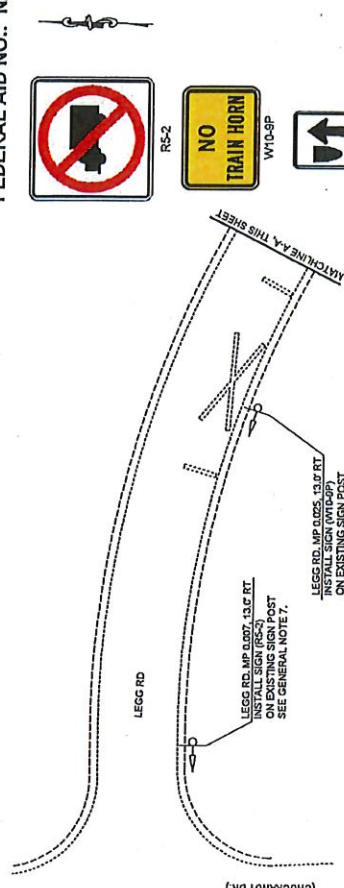

PROJECT NO.: ES20830-3 ES20830-3A		PROJECT LOCATED HEAR: BOW, WA	
DESIGNED BY: SA		CHECKED BY: PJ	
DRAWN BY: SA		APPROVED BY: SA	
LEGG RD & COLONY RD CROSSINGS		NORTH LEGG ROAD	
BNSF CROSSING NO. 084791W		PROJECT NO.: ES20830-3 ES20830-3A	

NO	REVISIONS	DATE

1000 COMMERCIAL PLACE	MOORETOWN, VA 22123-5625	(301) 416-1400 FAX (301) 416-1405
SKAGIT COUNTY PUBLIC WORKS		

BLANCHARD QUIET ZONE (LEGG RD & COLONY RD CROSSINGS) ES20830-3 | ES20830-3A

FEDERAL AID NO.: N/A

SOUTH EGG ROAD BNSF CROSSING NO. 084789V		PROJECT NO.: ES20830-3A		PROJECT LOCATION: BOW, WA	
LEGG RD & COLONY RD CROSSINGS		DESIGNED BY: SA		CHECKED BY: PJ	
BLANCHARD QUIET ZONE		DRAWN BY: SA		APPROVED BY:	
SHEET 4 OF 6		DATE		REVISIONS	
1000 CENTRAL PLACE SKAGIT COUNTY PUBLIC WORKS		DATE		REVISIONS	
(509) 418-1400 FAX (509) 418-1405		DATE		REVISIONS	

- SEE DUAL-FACED CEMENT CONC. TRAFFIC CURB DETAIL ON SHEET 6
- THE MEDIAN CURB LENGTH SHALL BE DETERMINED BY THE FIXED POINT AS IDENTIFIED IN THE PLANS BELOW. THIS FIXED POINT SHALL BE ESTABLISHED IN THE FIELD PRIOR TO BEGINNING CONSTRUCTION OF THE CURB. THE OVERALL LENGTH CALLED OUT IN THE PLANS BELOW SHALL BE DEFINED FROM THIS ESTABLISHED POINT.
- VERTICAL PANEL TYPE, SHEETING & HARDWARE SHALL BE APPROVED BY THE PROJECT ENGINEER PRIOR TO USE.
- VERTICAL PANELS SHALL BE ANCHORED TO THE CURB AND PLACED EVERY 10.0' O.C.
- FOR TYPICAL VERTICAL PANEL DIMENSIONS, SEE VERTICAL PANEL DETAIL ON THIS SHEET. ALTERNATE SIGN TYPES MAY BE USED BUT SHALL REQUIRE PROJECT ENGINEER APPROVAL PRIOR TO INSTALLATION.
- THE MEDIAN CURB SHALL BE CONSTRUCTED WITH AN APPROPRIATE ANCHOR BASE TO BE APPROVED BY THE PROJECT ENGINEER PRIOR TO INSTALLATION.
- FOR SIGN INSTALLATION LOCATION REQUIREMENTS, SEE WSDOT STANDARD PLAN G-22.10-00.
- FOR TIMBER SIGN SUPPORT INSTALLATION, SEE WSDOT STANDARD PLAN G-22.10-01, SINGLE POST INSTALLATION.
- SIGN SHALL BE COVERED UPON COMPLETION OF INSTALLATION. SIGN SHALL BE UNCOVERED 48 HOURS AFTER THE QUIET ZONE HAS BEEN OFFICIALLY ESTABLISHED.
- FILL MATERIAL SHALL BE CRUSHED SURFACING BASE COURSE, APPROXIMATELY 10 CY SHALL BE PLACED IN THE LOCATION OUTLINED ABOVE TO EXTEND THE EXISTING SHOULDER OUT IN LINE WITH THE EXISTING UTILITY POLE SHOWN IN THE PLANS. THE FILL LIMITS SHALL BE MARKED BY THE PROJECT ENGINEER PRIOR TO FILL BEING PLACED. PLACED FILL SHALL BE COMPACTED TO 95% COMPACTION, AS DETERMINED BY THE PROJECT ENGINEER. NO SENSITIVE AREAS SHALL BE IMPACTED.

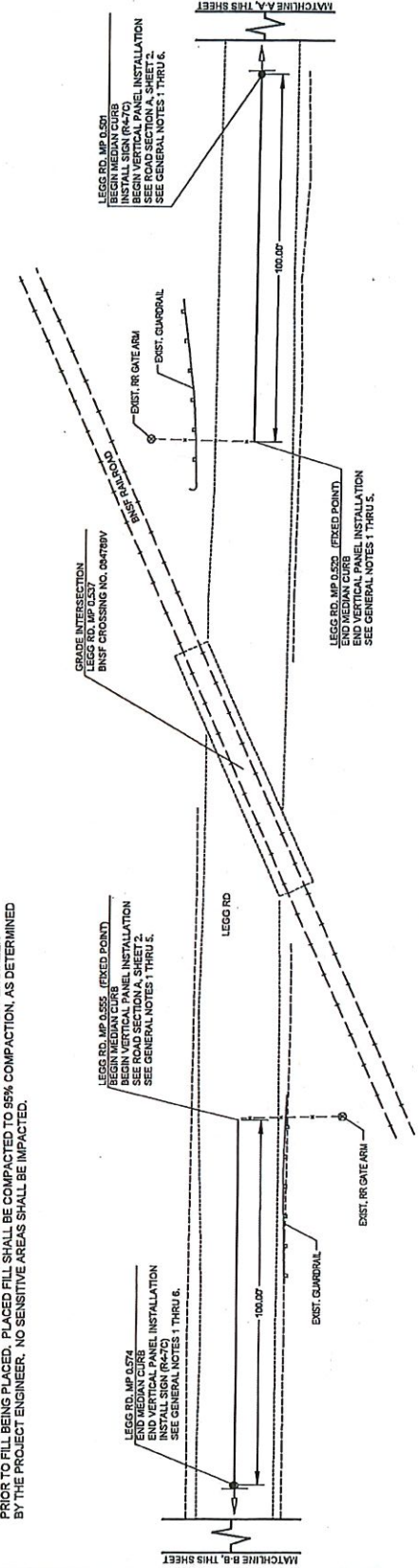

SOUTH LEGG ROAD
CROSSING NO. 084789V

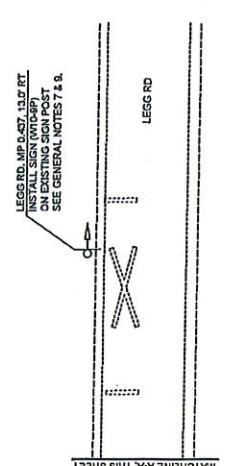

BLANCHARD QUIET ZONE (LEGG RD & COLONY RD CROSSINGS) ES20830-3 | ES20830-3A

GENERAL NOTES

- 1) SEE DUJA-FACED CEMENT CONC. TRAFFIC CURB DETAIL ON SHEET 5
- 2) THE MEDIAN CURB OVERALL LENGTH SHALL BE DETERMINED BY THE FIXED POINT AS IDENTIFIED IN THE PLANS BELOW. THIS FIXED POINT IS WHERE THE RAILROAD CROSSING GATE INTERSECTS THE ROADWAY CENTERLINE. THIS SHALL BE THE POINT WHERE THE RAILROAD CROSSING GATE INTERSECTS THE ROADWAY BEGINNING CONSTRUCTION OF THE CURB. THE OVERALL LENGTH CALLED OUT IN THE PLANS BELOW SHALL BE DEFINED FROM THIS ESTABLISHED POINT.
- 3) VERTICAL PANEL TYPE, SHEETING & HARDWARE SHALL BE APPROVED BY THE PROJECT ENGINEER PRIOR TO USE.
- 4) VERTICAL PANELS SHALL BE ANCHORED TO THE CURB AND PLACED EVERY 10.0' O.C.
- 5) FOR TYPICAL VERTICAL PANEL DIMENSIONS, SEE VERTICAL PANEL DETAIL ON THIS SHEET. ALTERNATE PANEL TYPES MAY BE USED BUT SHALL REQUIRE PROJECT ENGINEER APPROVAL PRIOR TO INSTALLATION.
- 6) SIGN RA-7C SHALL BE ANCHORED TO THE MEDIAN CURB WITH AN APPROPRIATE ANCHOR BASE TO BE APPROVED BY THE PROJECT ENGINEER PRIOR TO USE.
- 7) FOR TYPICAL LOCATION DETAILS, SEE MSDOT STANDARD PLAN G-20.10-06.
- 8) FOR TIMBER SIGN SUPPORT INSTALLATION, SEE MSDOT STANDARD PLAN G-22.10-01, SINGLE POST INSTALLATION.
- 9) SIGN SHALL BE COVERED UPON COMPLETION OF INSTALLATION. SIGN SHALL BE UNCOVERED 48 HOURS AFTER THE QUIET ZONE HAS BEEN OFFICIALLY ESTABLISHED.
- 10) FILL MATERIAL SHALL BE CRUSHED SURFACING BASE COURSE. APPROXIMATELY 10 CY SHALL BE PLACED IN THE LOCATION OUTLINED ABOVE TO EXTEND THE EXISTING SHOULDER OUT IN LINE WITH THE EXISTING UTILITY POLE SHOWN IN THE PLANS. THE FILL LIMITS SHALL BE MARKED BY THE PROJECT ENGINEER PRIOR TO FILL BEING PLACED. PLACED FILL SHALL BE COMPACTED TO 85% COMPACTION, AS DETERMINED BY THE PROJECT ENGINEER. NO SENSITIVE AREAS SHALL BE IMPACTED.

FEDERAL AID NO.: N/A

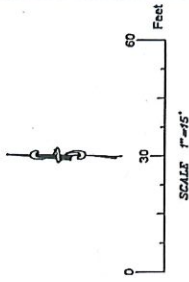

RA-7C



W10-5P

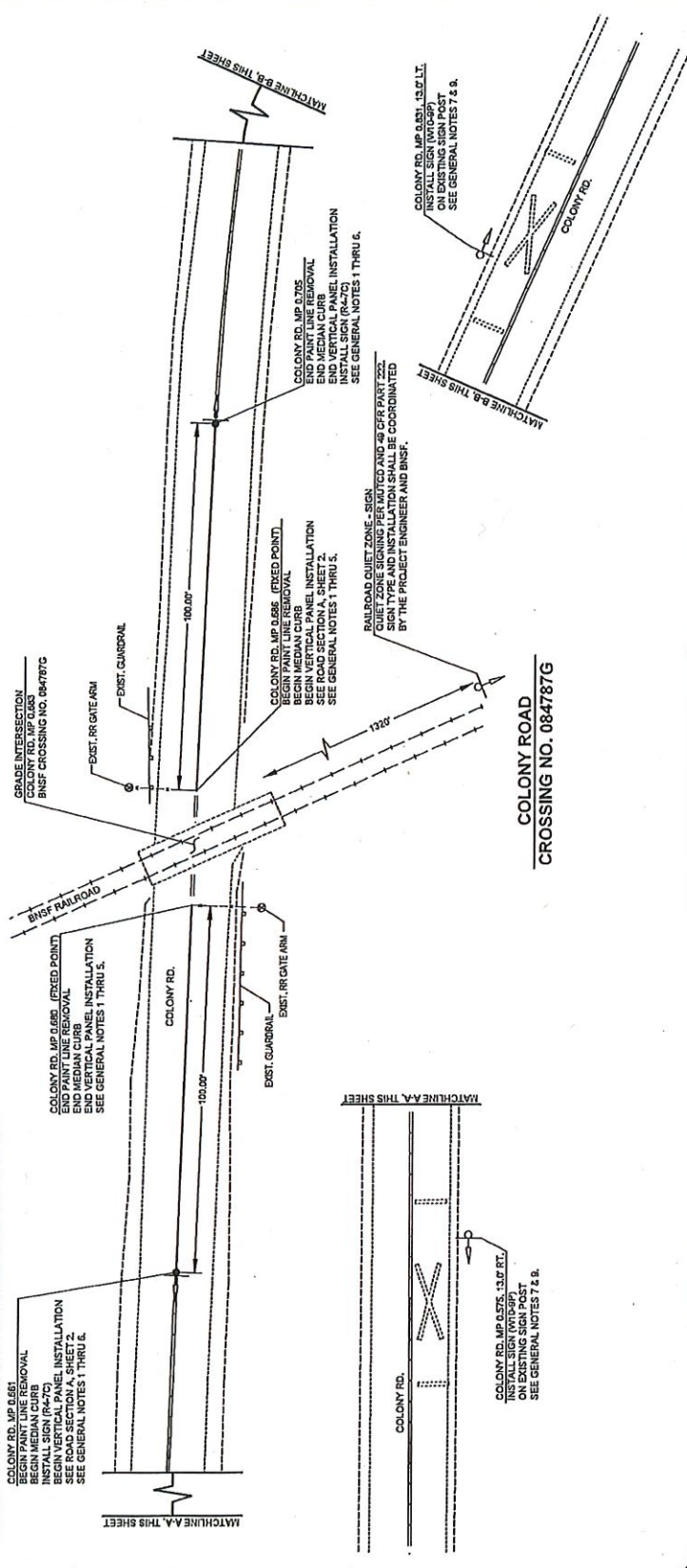

PROJECT NO.: ES20830-3 ES20830-3A		PROJECT LOCATED HERE: HON, VA	
DESIGNED BY: EA	DRAWN BY: EA	CHECKED BY: RJ	APPROVED BY:
COLONY ROAD BNSF CROSSING NO. 084787G			
LEGG RD & COLONY RD CROSSINGS			
PROJECT NO.: ES20830-3 ES20830-3A		PROJECT LOCATED HERE: HON, VA	
DESIGNED BY: EA	DRAWN BY: EA	CHECKED BY: RJ	APPROVED BY:
COLONY ROAD BNSF CROSSING NO. 084787G			
LEGG RD & COLONY RD CROSSINGS			

BLANCHARD QUIET ZONE (LEGG RD & COLONY RD CROSSINGS) ES20830-3 | ES20830-3A

FEDERAL AID NO.: N/A

PROJECT NO.: ES20830-3 ES20830-3A PROJECT LOCATED NEAR: BOW, MA TOWNSHIP 33 RANGES EAST SECTION 19 & 21		CURB DETAILS LEGG RD & COLONY RD BLANCHARD QUIET ZONE CROSSINGS	
DRAWN BY: SA CHECKED BY: RA	DATE:	REVISIONS:	NO.:
1000 CENTRAL PLACE SKAGIT COUNTY PUBLIC WORKS (202) 410-1100 FAX (202) 410-1400			

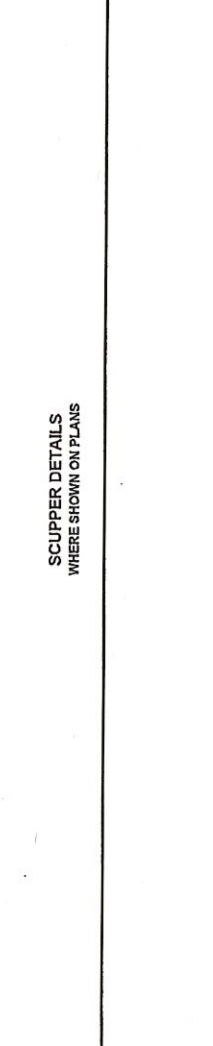
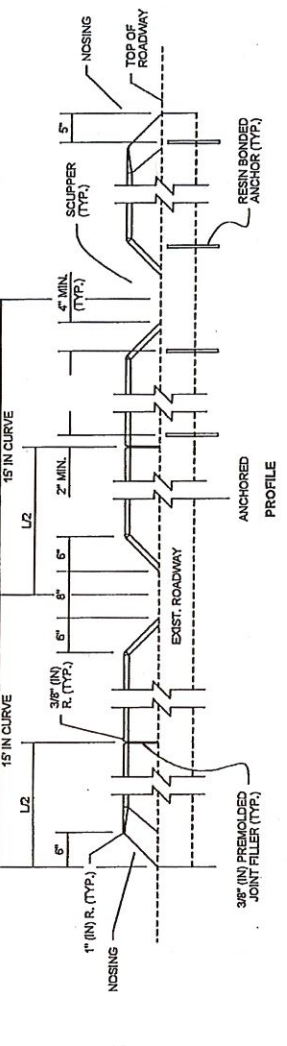
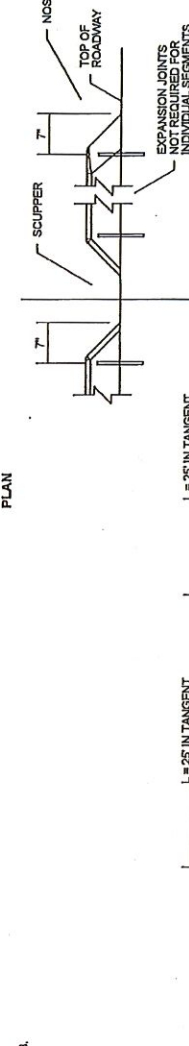
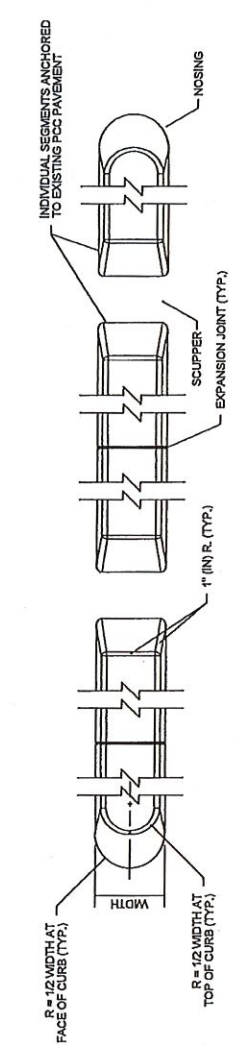

SCUPPER DETAILS WHERE SHOWN ON PLANS

- GENERAL NOTES:**
1. EXTRUDED CURB SHALL BE USED AS APPROVED BY THE PROJECT ENGINEER.
 2. CEMENT CONCRETE SHALL MEET OR EXCEED 4000 PSI COMPRESSIVE STRENGTH.
 3. FINISHED SURFACE SHALL BE FINISHED TO A FINISH FINISH AS PERMITTED BY THE CONTRACTOR AND APPROVED BY THE PROJECT ENGINEER PRIOR TO USE.
 4. FINISHED CURB SHALL BE PAINTED YELLOW AFTER A 28-DAY CURE TIME OF THE MEDIAN CURB.

- CONSTRUCTION NOTES:**
1. DRILL 3/4\"/>

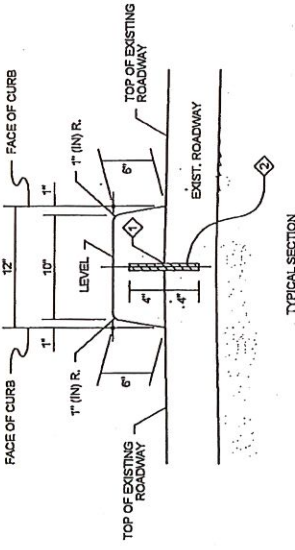

DUAL-FACED CEMENT CONC. TRAFFIC CURB RETROFIT ANCHORED TO EXISTING PAVEMENT