

RECEIVED  
RECORDS MANAGEMENT  
2015 AUG 25 AM 8:32  
STATE OF WASH.  
UTIL. AND TRANSP.  
COMMISSION

**CITY OF SEDRO-WOOLLEY  
NOTICE OF PUBLIC HEARING FOR THE NORTHERN STATE ANNEXATION**

**PROJECT DESCRIPTION:** The City of Sedro-Woolley will hold a public hearing to consider a petition to annex approximately 230 acres of property known as the Northern State Campus, including five adjacent residential parcels within the City's existing Urban Growth Area (UGA). On August 18, 2015, the City of Sedro-Woolley received a Petition for Annexation (submitted by property ownership representing at least 60% of the assessed valuation of the proposed annexation area). The annexation is necessary to enable the revitalization of the Northern State Campus property, allowing the development of such uses as: research & development, education, manufacturing, hospitality, specialized housing and supporting commercial and public uses.

**PROJECT LOCATION:** The proposed annexation area is primarily comprised of the former Northern State Hospital campus (Parcels 38607, 39356, 100646 & 100632) and generally speaking, the area is located north and east of Fruitdale Road and north of SR 20. Five adjacent parcels (Parcels 39359, 39343, 39341, 39340 & 39353) along Fruitdale Road are also included within the annexation area.

**PROJECT PROPONENT:** Washington State is the owner of the Northern State property. The State's representative is the Department of Enterprise Services.



**PUBLIC HEARING:** The public hearing will be held **September 9, 2015 at 7:00 PM** in the Sedro-Woolley Council Chambers at 326 Metcalf Street, Sedro-Woolley, WA 98284.

Interested parties can comment on the proposed annexation in writing or at the hearing. **Written comments must be received by 4:30 PM September 9, 2015** to be considered at this public hearing. Send written comments to: Sedro-Woolley Planning Department, 325 Metcalf Street, Sedro-Woolley, WA 98284. The complete project file is available for review at the Planning Department between the hours of 8:00 AM to 5:00 PM, Monday through Friday.

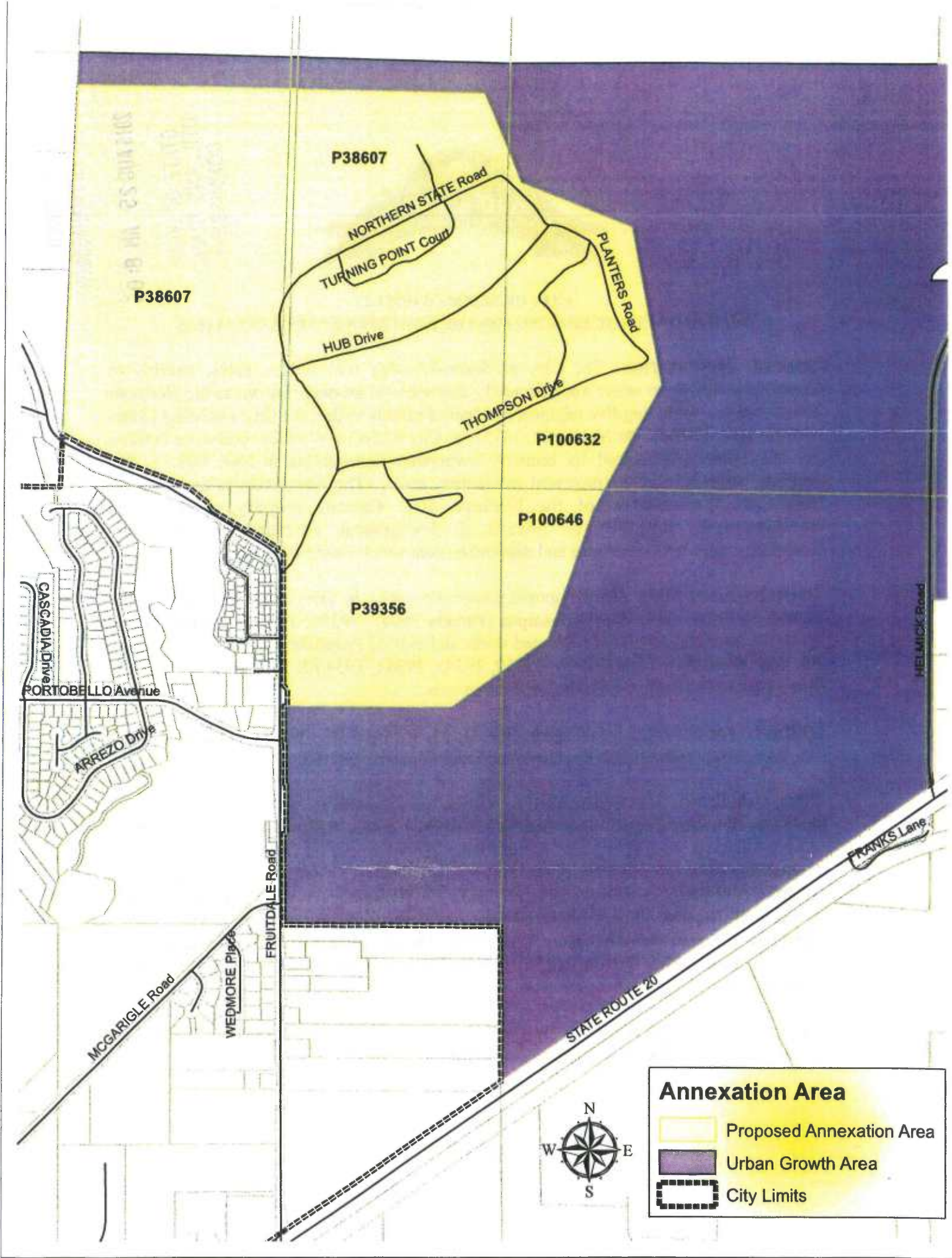
**CITY CONTACT:** Questions to City staff can be directed to John Coleman, 325 Metcalf Street, Sedro-Woolley, WA 98284 (360) 855-0771.

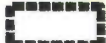

**Annexation Area**

-  Proposed Annexation Area
-  Urban Growth Area
-  City Limits