

CONTENTS

1. Application
2. Map of proposed service area . . . . . Exhibit A
3. Map of present service area . . . . . Exhibit B
4. Map showing plant to be used in proposed service area. Exhibits C-1 and C-2
5. Statement of facts in support of application . . . . . Exhibit D
6. Information with respect to stockholders. (Item 5. on application) . . . . . Exhibit E
7. Copy of Applicant's existing certificate of public convenience and necessity . . . . . Exhibit F
7. Certified copy of Franchise for the City of <sup>Bellingham</sup> ~~Bingen~~ . . . . . Exhibit G *not included*
8. Certified copy of Franchise for the City of <sup>Ridgely</sup> ~~White~~ Salmon . . . . . Exhibit H *not included*
10. Map showing both existing and proposed service areas. Exhibit I
9. 11. Proposed <sup>Second</sup> ~~First~~ Revision of Original Sheet 1 of Tariff WN U-5 . . . . . Exhibit J



6. If applicant is not a corporation list below the name and address of each person having an equity in the business.

Name

Address

(DINA)

7. Is this an application for an amendment of an existing certificate of public convenience and necessity already issued to applicant? YES  NO

8. If so, attach to this application the certificate referred to. (Marked Exhibit F)

9. If applicant is presently operating a gas plant for hire in the State of Washington, state where.

Camas, Washougal and Vancouver in Clark County, Washington and areas adjacent thereto.

10. Is applicant presently operating a gas plant for hire in the area or areas involved in this application? YES NO

Area now served

Since

Area now served

Since

11. Is any other gas company operating a gas plant for hire in any part of the area or areas for which applicant herein requests certification? YES NO  If YES, give name of other company or companies by areas.

12. Does applicant hold franchises or other governmental consents from any municipality in the area or areas involved in this application? YES  NO If YES, attach a certified copy of such franchise. If NO, state action taken or to be taken to procure such.

(Copies marked Exhibits G and H)

13. If applicant secures a certificate to serve the area or areas involved in this application, state by areas the date applicant expects to make gas service available.

In Bingen and White Salmon and areas adjacent thereto, within 60 days from the date the certificate applied for herein is secured.

14. Is applicant familiar with all the rules and regulations of the Washington Public Service Commission regarding the operation of a gas plant for hire? YES  NO

15. Is applicant submitting herewith its proposed tariff or tariffs covering the service to be offered in the area or areas involved in this application? YES NO If answer is NO, state when applicant intends to submit such. Applicant proposes to file First Revision of Original Sheet 1 to its Tariff WN U-5, which will make said Tariff applicable to the proposed service area. (See Exhibit J)

16. On separate sheets designated "Exhibit A" provide detailed maps showing for each service area the boundaries thereof proposed to be served under this application.
17. On separate sheets designated "Exhibit B" provide detailed maps showing for each service area the boundaries of the area now being served by applicant if different than shown above.
18. On a separate sheet designated "Exhibit C" state in general terms for each separate service area the plant now used or to be used in rendering such service. In lieu of such statement a map or sketch may be substituted showing such plant thereon.
19. On a separate sheet designated "Exhibit D" state fully the conditions existing which are relied upon as justification for the granting of this application, the estimated cost of new plant to be used in exercise of the certificate and the manner of financing such cost.

### FINANCIAL STATEMENT

As of July 31, 1962

ASSETS	LIABILITIES
Utility Plant (See Below) . . . . .	Common Stock . . . . .
\$ 73,576,686	\$ 14,405,300
Less Deprn. & Amort. Reserves \$ 5,237,212	Preferred Stock . . . . .
\$ 5,237,212	\$ 11,000,000
Net Utility Plant in Service. \$ 68,339,474	Premiums, Assessments on
Invest. in Assoc. Companies.. \$ - - -	Capital Stock . . . . .
\$ - - -	\$ 4,310,912
Other Invest. & Fund Accts. . . . .	Installments received on
\$ 126,452	Capital Stock . . . . .
Current & Accrued Assets:	\$ 1,989
Cash . . . . .	Capital Surplus . . . . .
\$ 1,761,734	\$ 1,215,433
Receivables (Net) . . . . .	Earned Surplus . . . . .
\$ 2,269,373	\$ 7,529,831
Materials & Supplies . . . . .	Disc. & Exp. on Cap. Stock-Dr. \$ - - -
\$ 1,459,331	Other Equity . . . . .
Other Current & Accrued	\$ - - -
Assets . . . . .	Total Equity . . . . .
\$ 2,935,034	\$ 38,463,965
Deferred Debits:	Long-Term Debt-Bonds . . . . .
Unamortized Debt Discount	\$ 29,208,500
and Expense . . . . .	-Other . . . . .
\$ 399,898	\$ 11,160,000
Preliminary Survey and	Current & Accrued Liabilities:
Investigation Charges . . . . .	Notes Payable . . . . .
\$ - - -	\$ - - -
Other Deferred Debits . . . . .	Accounts Payable . . . . .
\$ 6,734,483	\$ 1,369,688
	Other . . . . .
	\$ 3,540,386
	Deferred Credits:
	Unamortized Premium on
	Debt . . . . .
	\$ - - -
	Other . . . . .
	\$ 74,293
	Operating Reserves . . . . .
	\$ 62,129
	Contributions in Aid of
	Construction . . . . .
	\$ 146,818
	Total Liabilities and Other
	Credits . . . . .
	\$ 34,025,779
Total All Assets . . . . .	
\$ 34,025,779	

### UTILITY PLANT

Utility Plant in Service:	Utility Plt. Purchased or Sold. \$ - - -
Intangible Plant . . . . .	Utility Plt. in Process of
\$ 25,312	Reclassification . . . . .
Production Plant . . . . .	\$ - - -
\$ 12,099,154	Utility Plt. Leased to Others.. \$ - - -
Products Extraction Plant.. \$ - - -	\$ - - -
Storage Plants . . . . .	Property Held for Future Use. \$ - - -
\$ - - -	Construction (In Progress and
Transmission Plant . . . . .	Completed Not Classified).. \$ 6,590,655
\$ 996,409	Utility Plant Acquisition
Distribution Plant . . . . .	Adjustments (Net) . . . . .
\$ 49,400,480	\$ 421,246
General Plant . . . . .	Plant Adjustments & Other... \$ - - -
\$ 4,043,430	Total Utility Plant . . . . .
Total Utility Plant in Service. \$ 66,564,785	\$ 73,576,686

WHEREFORE, The undersigned applicant requests that the Washington Public Service Commission make its order granting to such applicant a Certificate of Public Convenience and Necessity as provided for in section 4, chapter 316, Laws of 1955.

Dated at Portland, Oregon, ~~Washington~~ this 29th day of October, 19 62

NORTHWEST NATURAL GAS COMPANY

By /s/ Francis F. Hill, President  
(Signature of applicant)

STATE OF ~~Washington~~ Oregon }  
County of Multnomah } ss.

Francis F. Hill, being first duly sworn, deposes and says that he is the President of applicant in the proceeding entitled above, that he has read the foregoing application and knows the contents thereof; that the same is true of his own knowledge except as to matters which are therein stated on information or belief, and as to those matters he believes it to be true.

Subscribed and sworn to before me this 29th day of October, 19 62

/s/ H.W. Pierce  
Notary Public for Oregon  
~~Notary Public in and for the State of Washington,~~  
Residing at \_\_\_\_\_  
My Commission Expires 1-25-66

NOTE: Wherever there is insufficient space provided for supplying any foregoing required information attach same on separate sheets.

Where applicant is an existing public service company and has on file with the Commission documents containing information fully responsive to any inquiry herein reference to such documents may be made.

A remittance in the sum of twenty-five dollars (\$25.00) is to be forwarded with this application. Original and two copies of this application with exhibits are to be filed.

Exhibit A

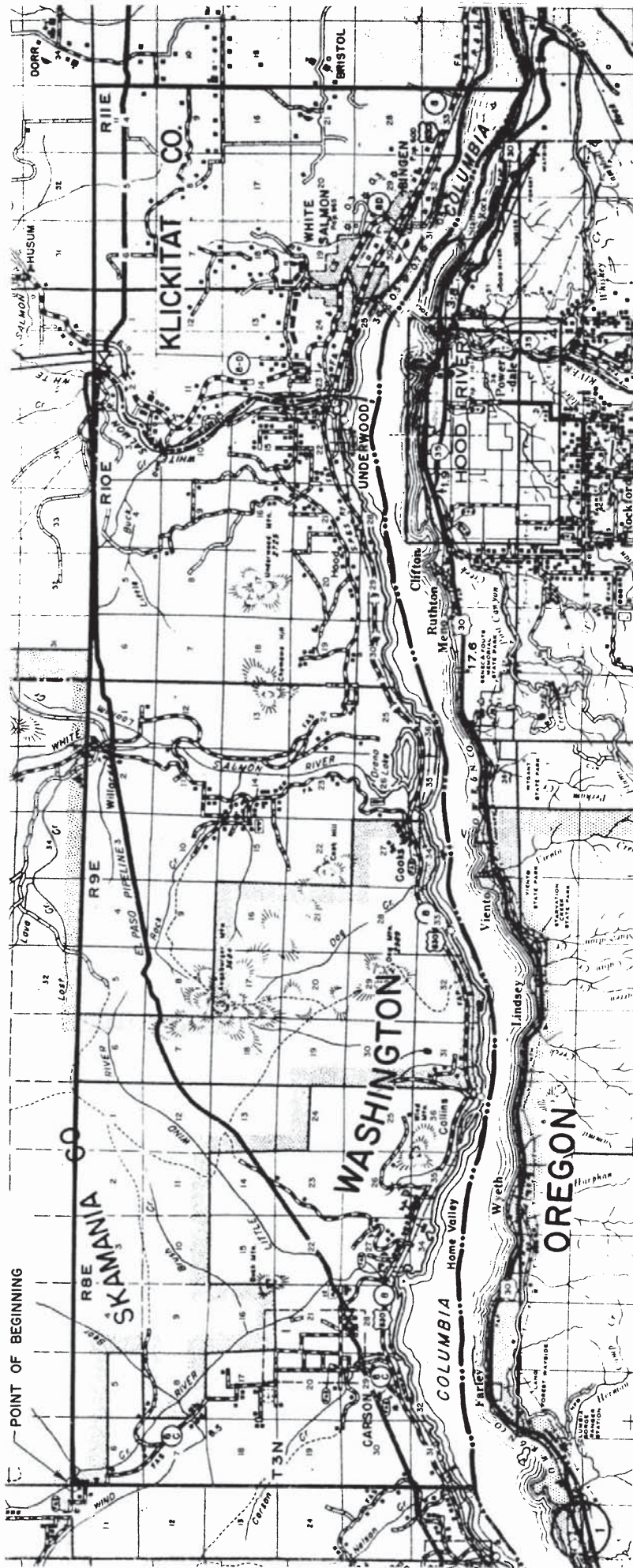

**NORTHWEST NATURAL GAS COMPANY**

**MAP OF SERVICE AREA**

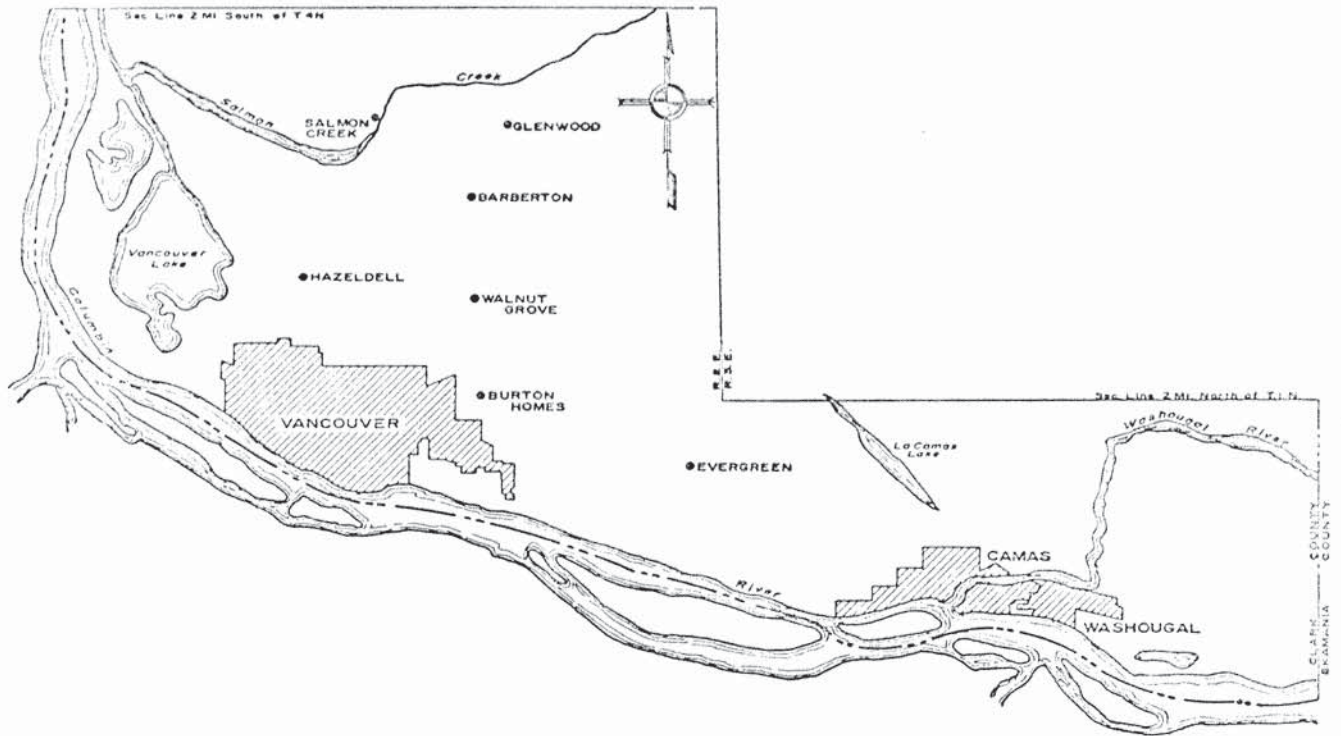

Issued March 16, 1959 Effective February 17, 1960  
By Authority of Order of the Washington Public Service Commission  
Cause No. U-9117

Northwest Natural Gas Company, hereinafter referred to as "Applicant", is a corporation duly organized, validly existing and in good standing under the laws of the State of Oregon. It has duly qualified and is authorized to transact business in the State of Washington and is in good standing as a foreign corporation under the laws of said state. Applicant's corporate name was changed from Portland Gas & Coke Company to Northwest Natural Gas Company, effective July 1, 1958.

For further information regarding Applicant, the general character of its business and the territory it serves, reference is hereby made to Applicant's Annual Reports to the Commission, filed pursuant to the Rules and Regulations of the Commission and to other documents and data pertinent to Applicant on file in the office of the Commission, including the applications filed in the causes referred to in the next succeeding paragraph.

In addition to the areas it serves in the State of Oregon, Applicant is engaged in selling and distributing natural gas to the general public in the cities of Vancouver, Camas and Washougal and areas adjacent thereto in Clark County, Washington, pursuant to Certificate of Public Convenience and Necessity No. 1, issued by the Commission December 16, 1955, in Cause No. U-3326, as amended July 17, 1956 in Cause No. U-3383 (see Exhibit B).

By its order of December 26, 1961 in Cause Nos. U-206 and U-207, the Commission approved the application of Columbia Gas Company for a Certificate of Public Convenience and Necessity to Operate a Gas Plant for Hire in Bingen and White Salmon and areas adjacent thereto. The application of Mt. Adams Gas Co. Inc., was denied in said order. The Commission was subsequently advised by letter dated March 28, 1962 that Columbia Gas Company had decided not to proceed with the construction of a distribution



system to serve the cities of Bingen and White Salmon. By its order dated April 9, 1962, the Commission amended Columbia Gas Company's Certificate of Public Convenience and Necessity No. 10, so as to exclude certification for Bingen and White Salmon and areas adjacent thereto.

Thereafter, at the request of residents of the aforesaid areas, Applicant made a study which indicated it was economically feasible to build a distribution system designed to make natural gas service available in the Bingen and White Salmon areas.

The proposed service area, as outlined on the map attached to the within application as Exhibit A, embraces an area extending approximately 18 miles west of White Salmon, one and one-half miles east of Bingen, and five miles north of the state line between Oregon and Washington. This area is largely rural but is gradually being built up by residences and small commercial operations along the state and county highways. There are a number of potential industrial development sites within the proposed area along the Columbia River. The incorporated cities of Bingen and White Salmon are located in close proximity to one another at the eastern end of the proposed service area, and have populations of approximately 630 and 1590, respectively. The unincorporated community of Carson is located in the western portion of the proposed area and Applicant has made a preliminary study indicating that it may be feasible to provide service in that community. Applicant believes that the area for which it has requested certification covers the territory in which normal growth will be experienced.

No other gas company is providing natural gas utility service for residential, commercial or industrial uses within the boundaries of the area described. To the best of Applicant's knowledge and belief, Mt. Adams

Gas Co., Inc., is no longer interested in serving the area and Applicant knows of no other Company planning or in a position to do so.

Applicant has entered into a five year contract with Bingen Veneer & Plywood Company, the major industrial enterprise in the area, for a firm supply of natural gas and estimates that during the first three years it will obtain approximately 200 residential, 23 commercial and two industrial customers. Applicant believes that the revenue to be derived from the estimated residential, commercial and industrial customers outlined above will be fully sufficient to justify the investment required to provide service as proposed herein.

Applicant proposes to make its service available in the proposed area at the same rates which are applicable in its presently certificated areas in the State of Washington and upon the granting of the certificate requested herein, Applicant will file First Revision of Original Sheet 1 to its Tariff WN U-5, (see Exhibit J).

Applicant has an agreement with El Paso Natural Gas Company, its pipeline supplier, whereby the existing contract between the parties for firm gas, effective through January 31, 1981, will be amended to include the additional volumes necessary to assure Applicant a sufficient supply of natural gas to meet the present and anticipated requirements of the proposed service area, to be delivered at a Gate Station or Gate Stations to be located in said area. As indicated in Exhibit A, El Paso Natural Gas Company's pipeline traverses the area sought to be certified.

Natural gas for the Bingen and White Salmon areas will be received by Applicant from the pipeline at a Gate Station to be located between these cities and Applicant will construct an initial distribution

system in the area, consisting of approximately nine and one-half miles of two-inch and one-inch mains, two district regulators, and the service lines and meter equipment necessary for individual users, in accordance with the provisions of the Commission's order in Cause Nos. U-8799 and U-8800 (see Exhibit C). Applicant is willing and able to expand this distribution system to serve all customers within the proposed area who desire natural gas service, in accordance with its regularly established main extension policy, as set forth in Rule 12 of its Rules and Regulations, on file with the Commission.

Applicant proposes to maintain its facilities in, along, under and upon state highways, county roads and city streets within the area described in Exhibit A, pursuant to franchises or permits granted by the appropriate state, county and municipal authorities. Applicant has heretofore obtained franchises from the two incorporated cities of Bingen and White Salmon, certified copies of which are attached to the within application as Exhibits G and H, respectively, and representatives of Klickitat and Skamania Counties have indicated a willingness to grant Applicant franchises coextensive with the certificate the Commission deems it appropriate to approve herein. Applications will be made to the Washington State Highway Commission under the provisions of Chapter 53, Laws of 1937, as amended, for such franchises as may be required for the use of state highways.

Applicant estimates that it will be required to invest approximately \$187,000 for new distribution facilities in the proposed area within the next three years, most of which will be expended in the first year for the backbone system shown in Exhibit C. This investment will be made, however, as and when facilities are required and will be financed, along with other expenditures

of the same nature to be made elsewhere in Applicant's system, in accordance with overall plans heretofore referred to and described in connection with its application filed with the Commission on May 14, 1962, in Cause No. U-9373, and reference is made thereto for further details.

Exhibit I has been attached to the within application for the purpose of affording the Commission a broader view of Applicant's existing and proposed service areas.

NORTHWEST NATURAL GAS COMPANY

Names and addresses of the 10 common or preferred stockholders (if any) owning greatest number of shares with voting rights	Number Shares Owned		Total Number of Votes
	Common	Preferred	
1. Unit & Company Trust Department U. S. National Bank Portland 4, Oregon	33,308	*	33,308
2. John S. Shute American Bank Bldg. Portland 5, Oregon	33,200	*	33,200
3. Merrill, Lynch, Pierce Fenner & Smith 70 Pine Street New York 5, New York	24,111	*	24,111
4. Dean Witter & Co. 2 Broadway New York 4, New York	18,393	*	18,393
5. C. A. Seidensticker & Co. 3 Trust Dept. Princeton Bank & Trust Co. Princeton, New Jersey	12,820	*	12,820
6. Newhard Cook & Co. 400 Olive Street St. Louis, Missouri	8,741	*	8,741
7. Lehman Bros. 1 William Street New York 4, New York	8,765	*	8,765
8. Charles McGonigle 320 S. W. Stark Street Portland 4, Oregon	6,160	*	6,160
9. Rache & Co. 36 Wall St. New York 5, New York	5,945	*	5,945
10. J. E. Hinton 6690 Michaeljohn Drive La Jolla, California	5,384	*	5,384

\*Preferred stock is non-voting except under certain conditions.

W.P.S.C.

Gas Certificate No. 1  
(As Amended July 17, 1956)

WASHINGTON PUBLIC SERVICE COMMISSION  
 CERTIFICATE OF PUBLIC CONVENIENCE AND NECESSITY  
 TO OPERATE A GAS PLANT FOR HIRE

PORTLAND GAS & COKE COMPANY

(Name)

of Portland, Oregon is hereby authorized  
 (Address)  
 to operate a gas plant for hire in the general area or areas of:

Camas, Washougal and Vancouver in Clark County and areas adjacent  
 as more particularly designated on Appendix A, attached hereto and by  
 this reference made a part hereof, such appendix consisting of a map  
 and attached legal description.

~~as more particularly designated on "Exhibit A" of certificate holder's application. as "Exhibit A" has been or may be amended.  
 - Said "Exhibit A" is on file with the Commission and is open to public inspection.~~

CONDITIONS:

1. Any gas plant operated by virtue of this certificate must be operated in accordance with the Laws of the State of Washington and the Rules and Regulations of this Commission.
2. This certificate must be kept on file at the main office of the gas company except when directed to be transmitted to the Commission, and shall be subject at all times to inspection by the authorized representatives of the Commission.
3. This certificate shall be subject to revocation and cancellation by the Commission upon a showing of procurement by false affidavit or representation.
4. This certificate is subject to the terms, conditions and provisions of the order in Cause No. U-8883, effective July 17, 1956, pursuant to which this amended certificate is issued.

*This certificate is issued upon finding by the Washington Public Service Commission that public convenience and necessity requires or will require such operation in accordance with section 4, chapter 316, Laws of 1955, and*

Order No. U-8883 Dated July 17, 1956

Dated at Olympia, Washington, July 17, 1956

WASHINGTON PUBLIC SERVICE COMMISSION

By A. E. Rotchford  
 Secretary

APPENDIX -A-Legal Description of Service Area of Portland Gas & Coke Company

Beginning at the intersection of the north line of Sec. 13, T3N, R1W, Willamette Meridian, or that line extended west, with the Oregon-Washington state boundary in the Columbia River; thence east along the north line of Sec. 13, T3N, R1W, along the north lines of Sec. 18, 17, 16, 15, 14, and 13, T3N, R1E, and along the north lines of Sec. 18, 17, 16, 15, 14, and 13, to the northeast corner of Sec. 13, T3N, R2E; thence south along the township line to the southeast corner of Sec. 24, T2N, R2E; thence east along the north lines of Sec. 30, 29, 28, 27, 26, and 25, T2N, R3E, and along the north lines of Sec. 30, 29, 28, 27, 26, and 25, to the northeast corner of Sec. 25, T2N, R4E; thence south along the township line to the Oregon-Washington state boundary in the Columbia River; thence westerly, and northerly following the Oregon-Washington state boundary to the point of beginning; all being within Clark County, Washington.

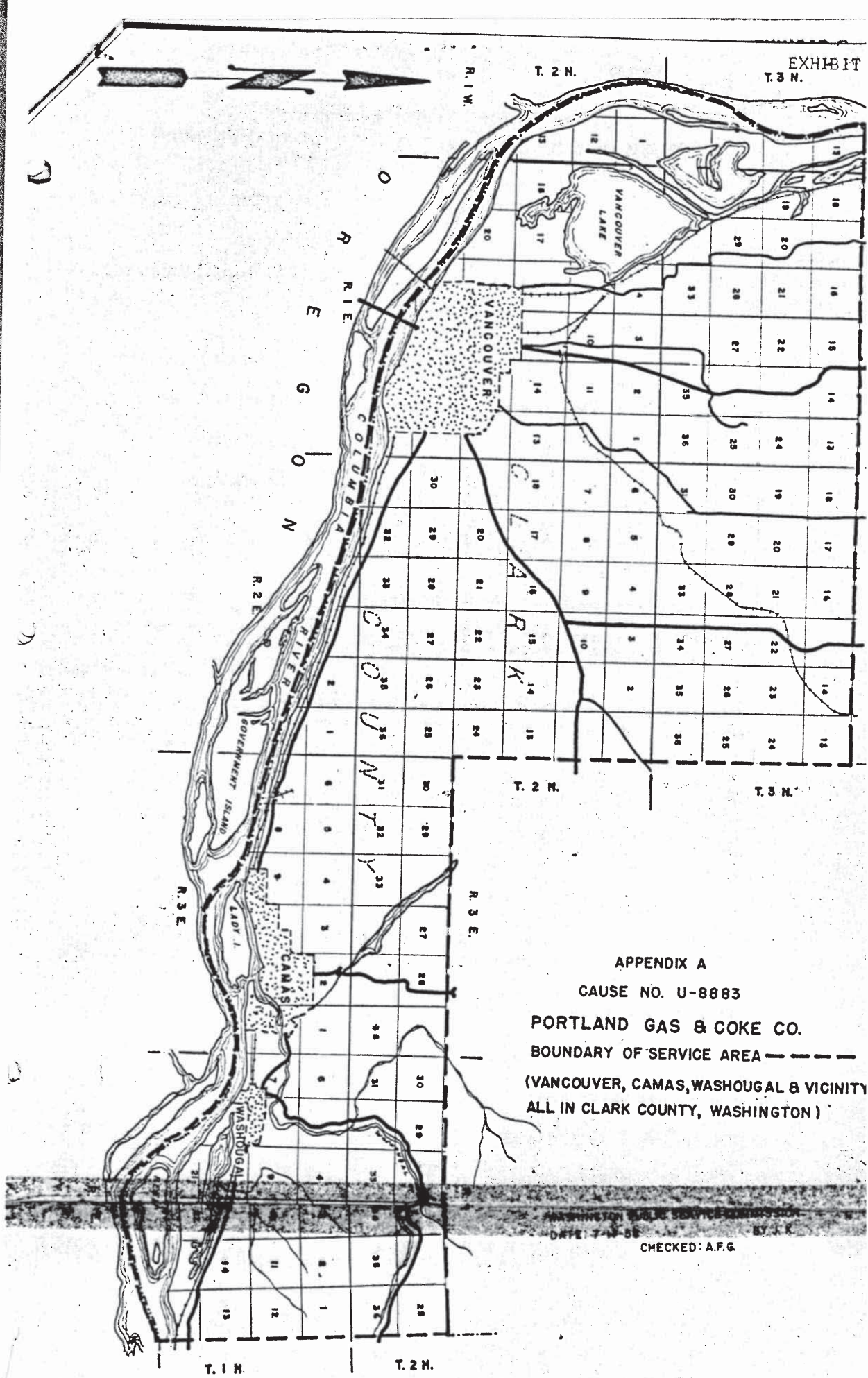

EXHIBIT  
T. 3 N.

T. 2 N.

R. 1 W.

C O L U M B I A  
R I V E R

VANCOUVER

VANCOUVER  
LAKE

C L A R K  
C O U N T Y

R. 2 E.

R. 3 E.

T. 2 N.

T. 3 N.

T. 1 N.

T. 2 N.

APPENDIX A

CAUSE NO. U-8883

PORTLAND GAS & COKE CO.

BOUNDARY OF SERVICE AREA - - - - -

(VANCOUVER, CAMAS, WASHOUGAL & VICINITY  
ALL IN CLARK COUNTY, WASHINGTON)

WASHINGTON STATE PUBLIC UTILITIES DIVISION  
DATE: 7-13-55 BY: J. K.

CHECKED: A.F.G.





This space for  
receipt stamp.

**NORTHWEST NATURAL GAS COMPANY**

**RATES, RULES AND REGULATIONS**

for

**GAS SERVICE**

at

**BINGEN, CAMAS, VANCOUVER, WASHOUGAL AND  
WHITE SALMON, WASHINGTON, AND IN ADJACENT  
TERRITORY SERVED BY THE COMPANY.**

---

Issued

Effective

**Issued by NORTHWEST NATURAL GAS COMPANY  
W. A. Cook, Senior Vice President  
735 S. W. Morrison Street, Portland, Oregon**