

WN U-5
YCOM Networks, Inc.
d/b/a FairPoint Communications

SECTION I
Second Revised Sheet No. 1
Canceling First Revised Sheet No. 1

YCOM NETWORKS, INC.
d/b/a FairPoint Communications
UBI No. 345 000 308

(T)

105 2nd Street SE
PO Box 593
Yelm, Washington 98597
360-458-2171
www.fairpoint.com

(C)

NAMING RATES FOR
TELEPHONE SERVICE

for the

(T)

Yelm Exchange

(C)

And

CONTAINING RULES AND REGULATIONS
GOVERNING SERVICE

WN U-5
 YCOM Networks, Inc.
 d/b/a FairPoint Communications

SECTION IV
 Second Revised Sheet No. 3
 Canceling First Revised Sheet No. 3

BASIC LOCAL EXCHANGE ACCESS LINE SERVICE

LOCAL EXCHANGE ACCESS LINE SERVICE (Cont'd.)

B. EXCHANGE ACCESS LINE RATES

Exchange Name: Yelm (C)

Effective June 1, 2014, the rate centers of Yelm and Rainier will be consolidated into one rate center named Yelm. (C)
 (C)

		Monthly Rates		
		<u>Basic Calling Service</u> ⁽¹⁾⁽²⁾	<u>Flat Rate Service</u> ⁽¹⁾	
<u>Residence Service:</u>				
One Party (per line)		\$7.00	\$16.00	(T)
<u>Business Service:</u>				
One-Party		NA	\$24.00	(T)
KTS/PBX Trunk		NA	\$32.00	
Centrex Additive ⁽³⁾ (per line)	2-6 Lines	NA	\$ 6.00	
	7-24 Lines	NA	\$ 5.00	
	25-49 Lines	NA	\$ 4.50	
	50-74 Lines	NA	\$ 4.00	
	75-99 Lines	NA	\$ 2.50	
	100 - 249 Lines	NA	\$ 2.25	
	250+ Lines	NA	\$ 2.00	

Volume/Term Discounts

	1 yr Term	2 yr Term	3 yr Term	5 yr Term	(N)
1-3 lines	5%	10%	15%	20%	
4-10 Lines	7%	12%	17%	22%	
11-25 Lines	9%	14%	19%	24%	
26-49 lines	11%	16%	21%	26%	
50-74 Lines	13%	18%	23%	28%	
75-99 Lines	15%	20%	25%	30%	
100-199 Lines	17%	22%	27%	32%	
200-299 Lines	19%	24%	29%	34%	(N)

(D)

WN U-5
YCOM Networks, Inc.
d/b/a FairPoint Communications

SECTION IV
First Revised Sheet No. 3A
Canceling Original Sheet No. 3A

BASIC LOCAL EXCHANGE ACCESS LINE SERVICE

LOCAL EXCHANGE ACCESS LINE SERVICE (Cont'd.)

B. EXCHANGE ACCESS LINE RATES

	<u>Basic Calling Service</u>	<u>Flat Rate Service</u>	
Usage Rate			
- for local calls <u>inside</u> Yelm exchange:			(C)
1 st Minute	.03/Min	No	
Additional minute	.02/min	Charge	
- for local calls <u>outside</u> of Yelm exchange:			(C)
1 st Minute	.15/min	No	
Additional minute	.10/min	Charge	
(1) Includes Extended Area Service to Tacoma, Roy, Graham and Olympia.			(C)
(2) Customers of Basic Calling Service receive a \$3.00 monthly allowance for outgoing local and EAS calls. Non-recurring charges to convert to Basic Calling Service will be waived the first 90 days after EAS implementation.			
(3) Centrex Additive is rate per line for Flat Rate Service and is in addition to Centrex line rate identified in Section XI.			

WN U-5
YCOM Networks, Inc.
d/b/a FairPoint Communications

SECTION X
First Revised Sheet No. 5
Canceling Original Sheet No. 5

TOLL REFERENCE LIST

<u>Locality or Exchange</u>	<u>Use Rate To</u>	<u>V</u>	<u>H</u>	
Yelm	Yelm	6486	8927	(D)
				(D)
				(D)
				(D)

WN U-5
YCOM Networks, Inc.
d/b/a FairPoint Communications

SECTION IV
First Revised Sheet No. 4
Canceling Original Sheet No. 4

Reserve for Future Use

(D)

(D)

WN U-5
YCOM Networks, Inc.
d/b/a FairPoint Communications

SECTION IV
First Revised Sheet No. 5
Canceling Original Sheet No. 5

Reserve for Future Use

(D)

(D)

WN U-5
YCOM Networks, Inc.
d/b/a FairPoint Communications

SECTION IV
First Revised Sheet No. 6
Canceling Original Sheet No. 6

LOCAL EXCHANGE SERVICES

LOCAL EXCHANGE MAP

LEGEND
EXCHANGE BOUNDARY - - - - -
COUNTY BOUNDARY - - - - -
BASE RATE AREA BOUNDARY - - - - -
CENTRAL OFFICE ⊕

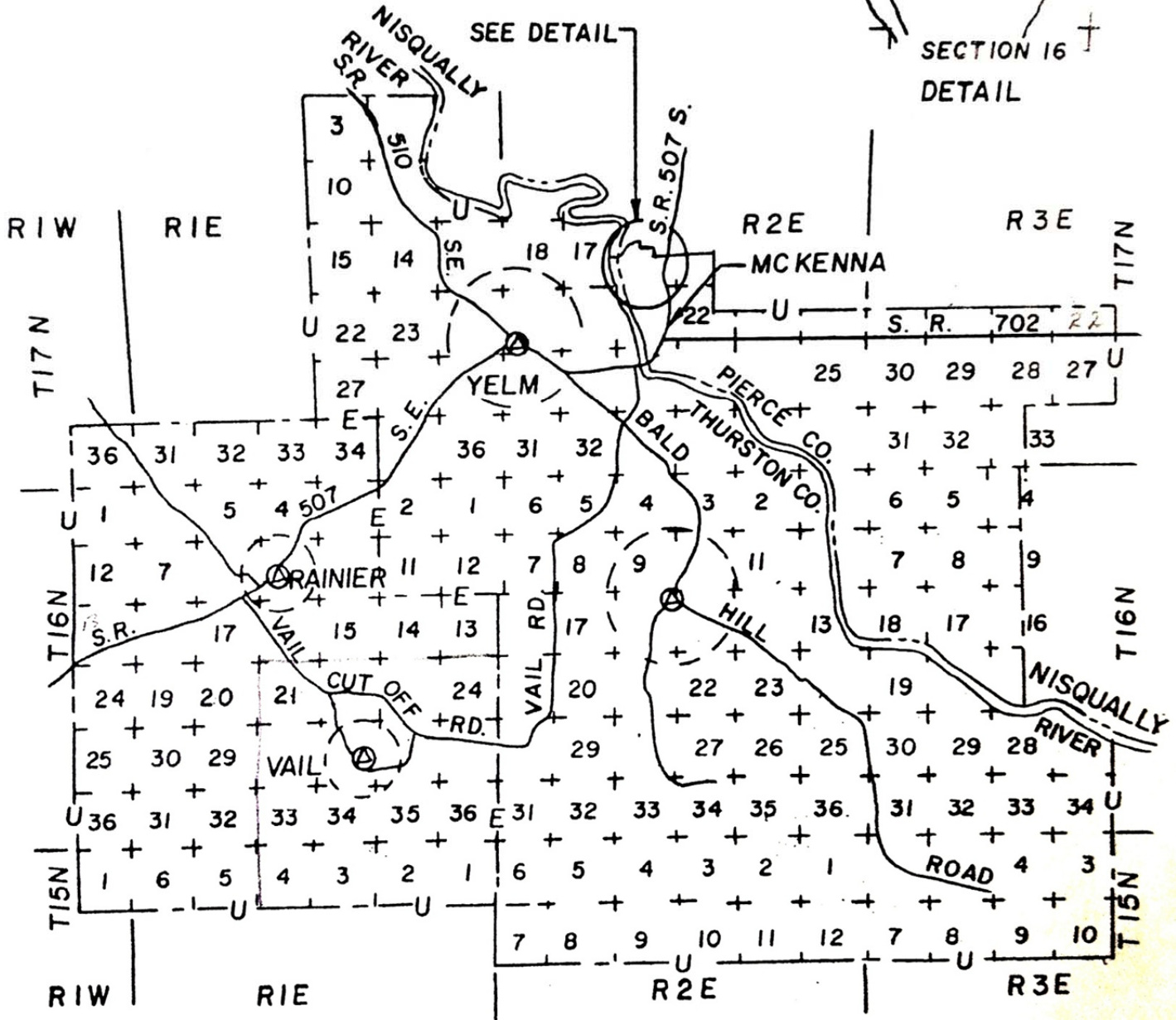
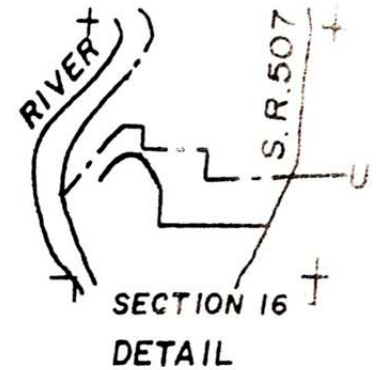

WN U-5
YCOM Networks, Inc.
d/b/a FairPoint Communications

SECTION IV
Second Revised Sheet No. 6.1
Canceling First Revised Sheet No. 6.1

Reserve for Future Use

(D)

(D)