

M:\WOODLAND\19624 Guild Road and W. Scott Ave\01 Design\PLANSET\00-Planaset-BNSF\Civil\RETAINING WALL.dwg, 2/8/2021 12:13 PM, YVONNE PAWTOWSKI

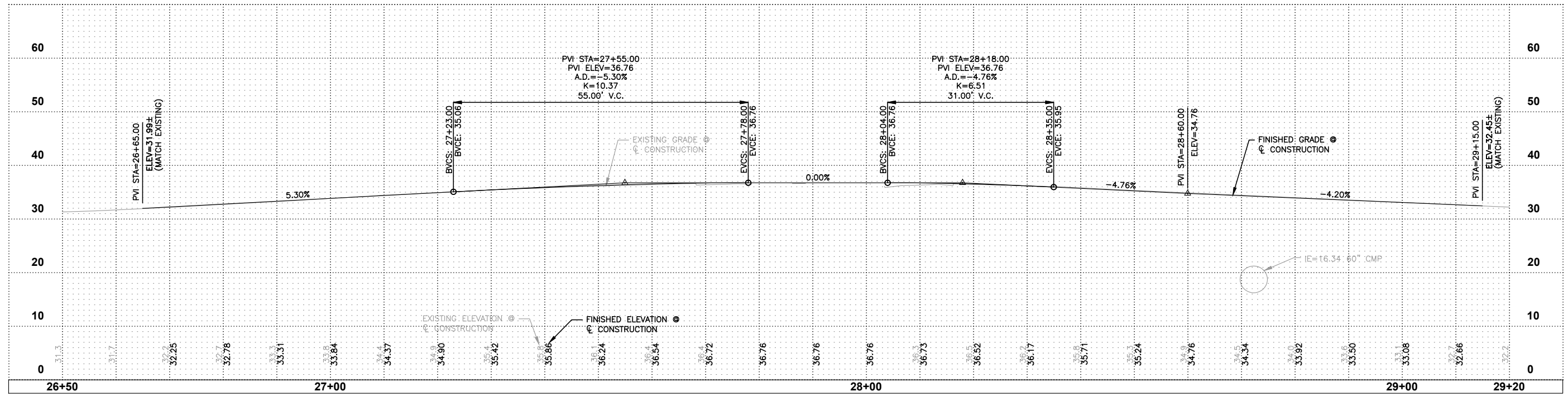
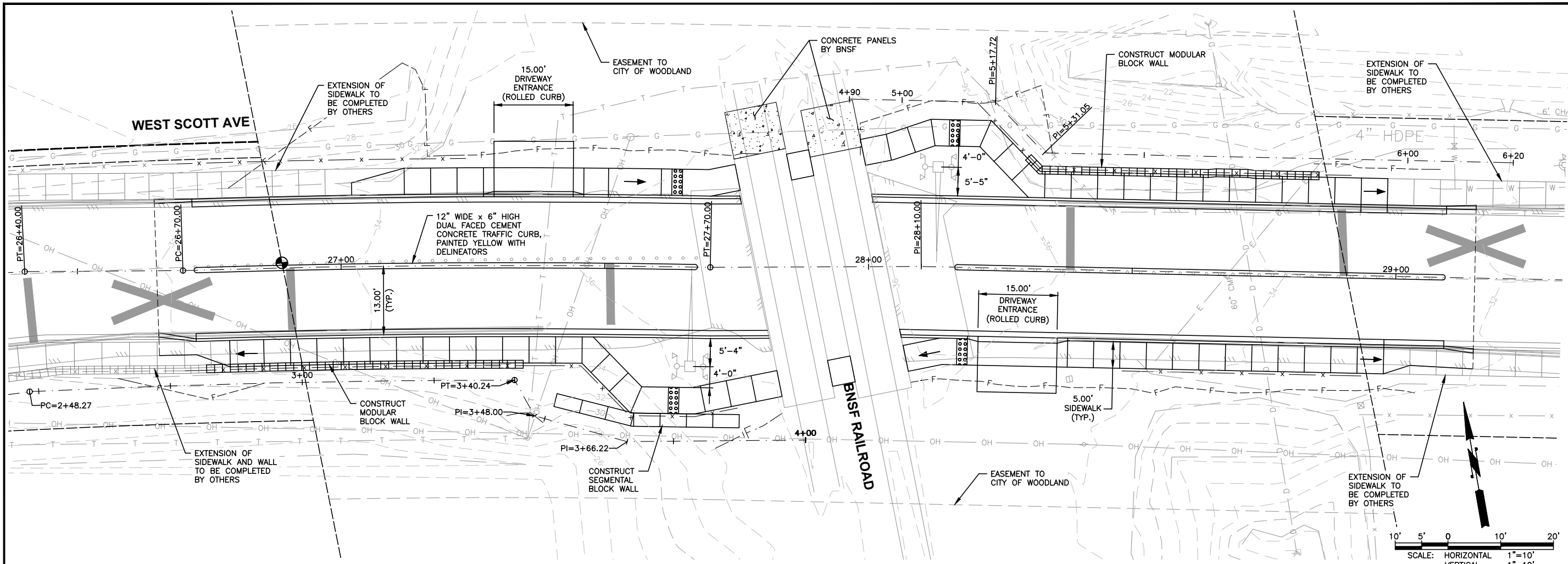

0 1" 2"
TWO INCHES AT FULL SCALE.
IF NOT, SCALE ACCORDINGLY

Gray & Osborne, Inc.
CONSULTING ENGINEERS
1130 RAINIER AVENUE SOUTH, SUITE 300
SEATTLE, WASHINGTON 98144 • (206) 284-0860

DATE: FEB 2021	DRAWN:	CHECKED:	APPROVED:
----------------	--------	----------	-----------

NO.	REVISION	DATE	APPD.
	PRELIMINARY NOT FOR CONSTRUCTION		

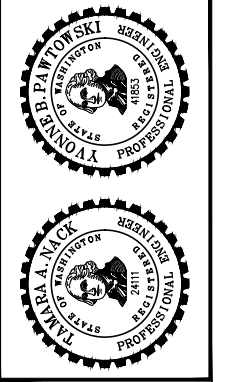

CITY OF WOODLAND
COWLITZ COUNTY WASHINGTON
BNSF / WEST SCOTT AVENUE
CROSSING 092437K IMPROVEMENTS
WEST SCOTT AVENUE PLAN & PROFILE

DRAWING: RW-1
SHEET: 1 OF: 4
JOB NO.: 19624
DWG: RETAINING WALL

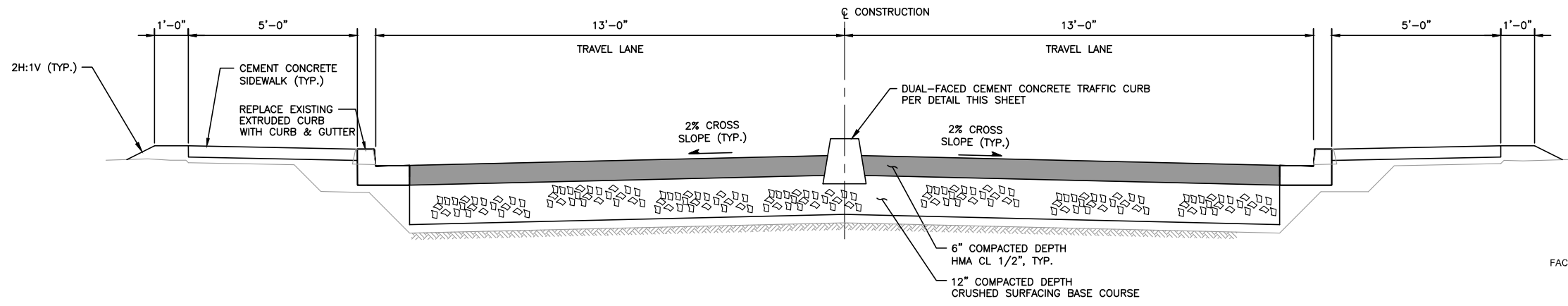

**TYPICAL ROAD CROSS-SECTION
WEST SCOTT AVENUE
(BNSF RR CROSSING - LOOKING EAST)**
NOT TO SCALE

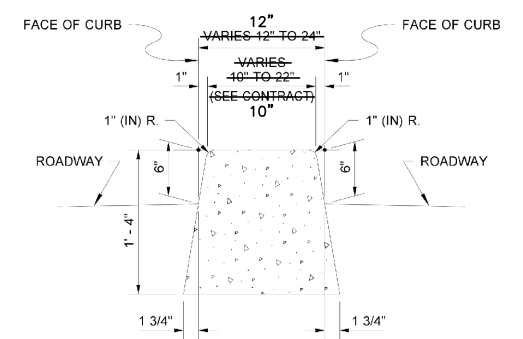

**PORTION OF MODIFIED WSDOT STANDARD PLAN F-10.12-04
CEMENT CONCRETE CURBS**
NOT TO SCALE

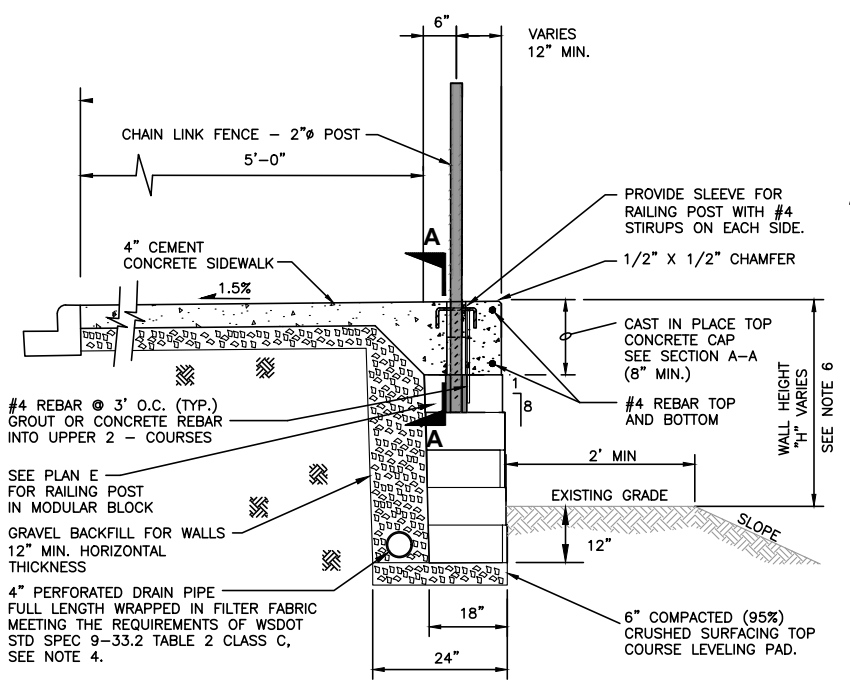

**TYPICAL FILL SECTION
MODULAR BLOCK RETAINING WALL**
NOT TO SCALE

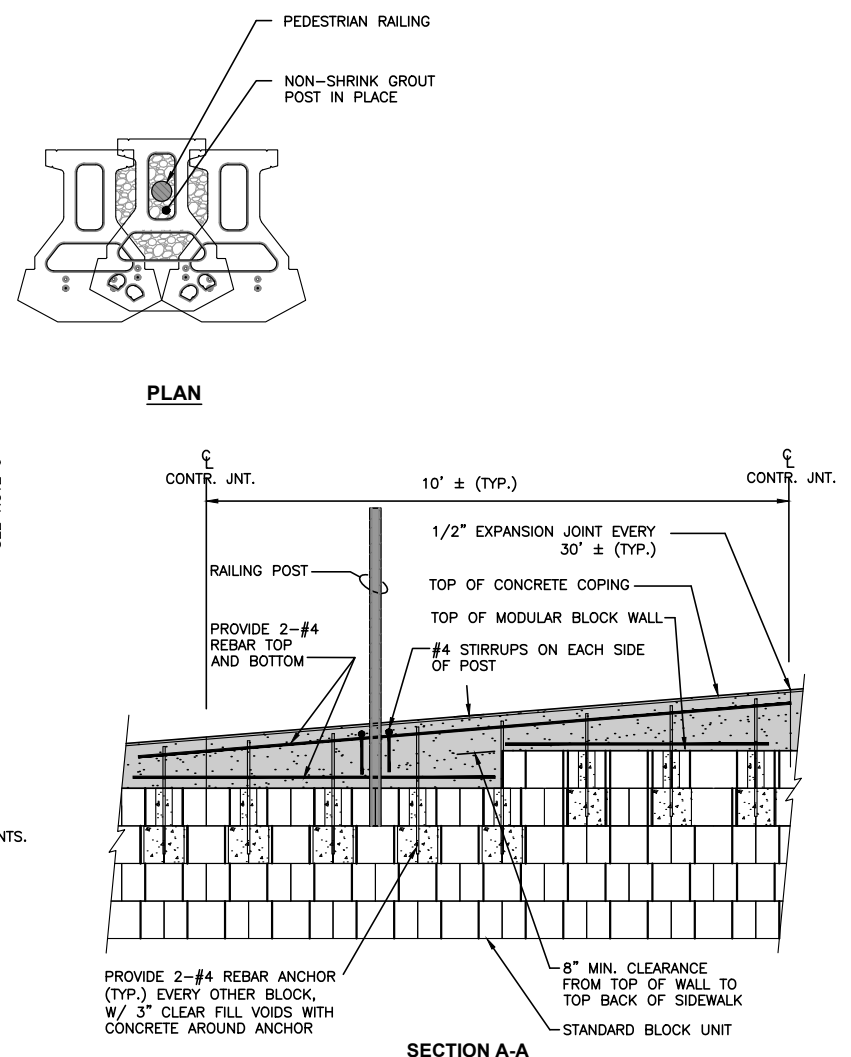

SECTION A-A

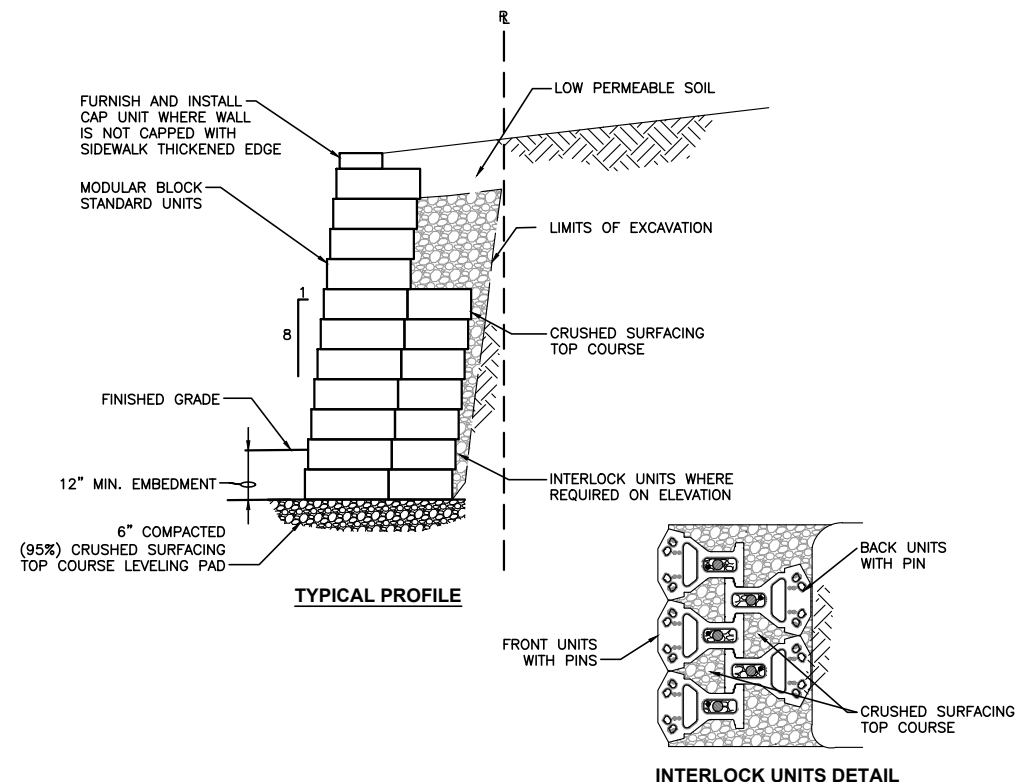

TYPICAL INTERLOCKED WALL SECTION
NOT TO SCALE

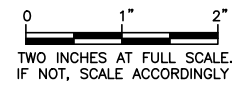

Gray & Osborne, Inc.
CONSULTING ENGINEERS
1130 RAINIER AVENUE SOUTH, SUITE 300
SEATTLE, WASHINGTON 98144 • (206) 284-0860

DATE: FEB 2021	DRAWN:	CHECKED:	APPROVED:
----------------	--------	----------	-----------

REVISION	DATE	APPD
PRELIMINARY NOT FOR CONSTRUCTION		
No.		

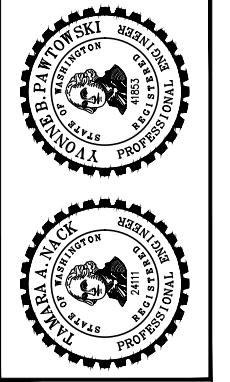

CITY OF WOODLAND
COWLITZ COUNTY WASHINGTON
**BNSF / WEST SCOTT AVENUE
CROSSING IMPROVEMENTS**
ROADWAY AND RETAINING WALL DETAILS

DRAWING: RW-2
SHEET: 2 OF: 4
JOB NO.: 19624
DWG: RETAINING WALL

M:\WOODLAND\19624 Guild Road and W. Scott Ave\01 Design\PLANSET\00-Planset-BNSF\Civil\RETAINING WALL.dwg, 2/8/2021 12:13 PM, YVONNE PAWTOWSKI

M:\WOODLAND\19624 Guild Road and W. Scott Ave\01 Design\PLANSET\00-Planaset-BNSF\Civil\RETAINING WALL.dwg, 2/8/2021 12:13 PM, YVONNE PAWTOWSKI

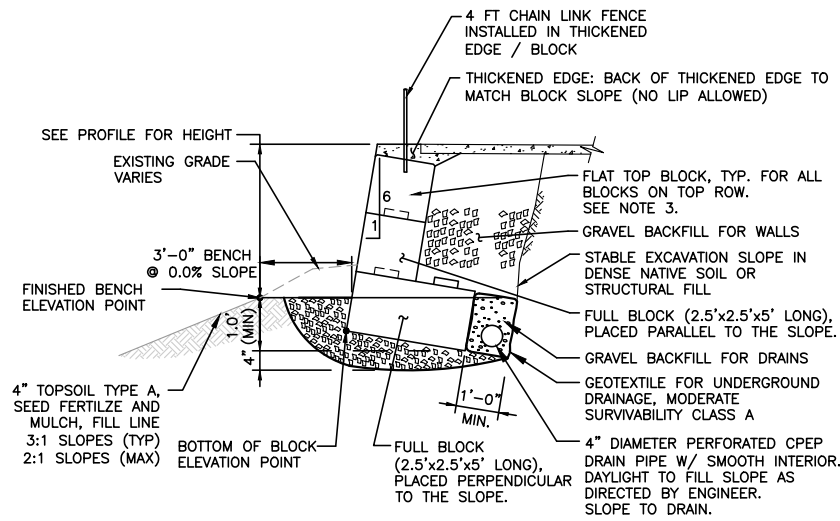

WALL UNDER SIDEWALK

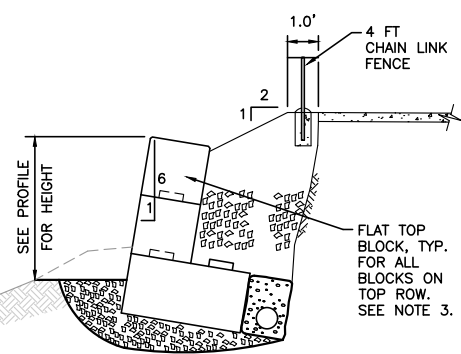

WALL BEHIND SIDEWALK

BLOCK WALL NOTES:

1. ALL LOOSE SOIL AT WALL FOUNDATION SHALL BE OVER EXCAVATED AND REPLACED WITH COMPACTED BACKFILL AS DESCRIBED ABOVE. THE EXCAVATION SHALL BE KEPT FREE OF WATER. THE PREPARED WALL FOUNDATION SHALL BE EVALUATED BY THE ENGINEER PRIOR TO PLACEMENT OF ANY BLOCKS.
2. FOR TYPICAL BLOCK CONFIGURATION SEE SEGMENTAL BLOCK RETAINING WALL TYPICAL CONFIGURATION, THIS SHEET.
3. ALL BLOCKS LOCATED ALONG THE TOP ROW SHALL BE FURNISHED WITH A FLAT TOP.
4. TYPICAL DRAIN PIPE LOCATION INDICATED. ADJUST LOCATION TO DRAIN TO DAYLIGHT.

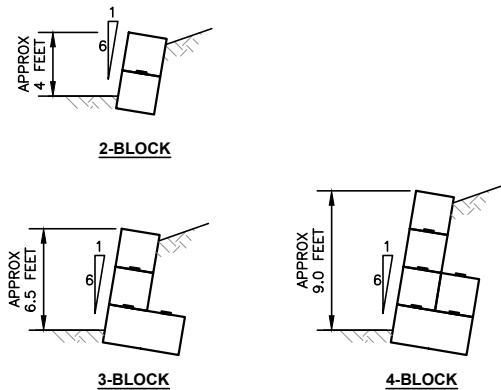

**TYPICAL CONFIGURATION
SEGMENTAL BLOCK WALL
NOT TO SCALE**

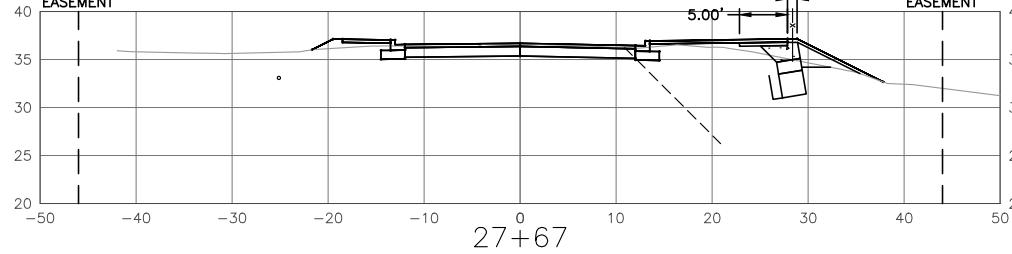
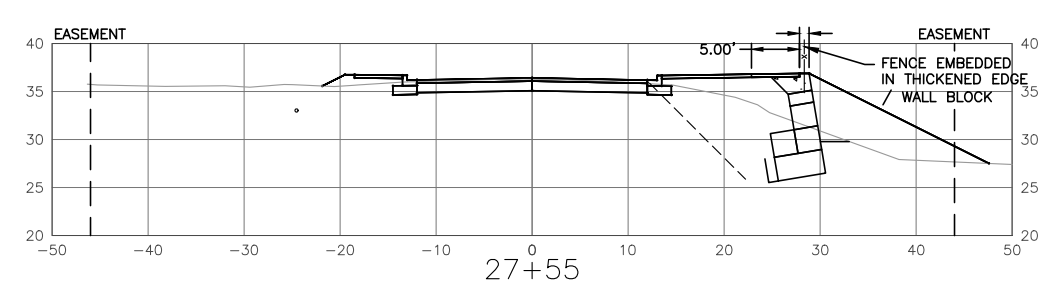
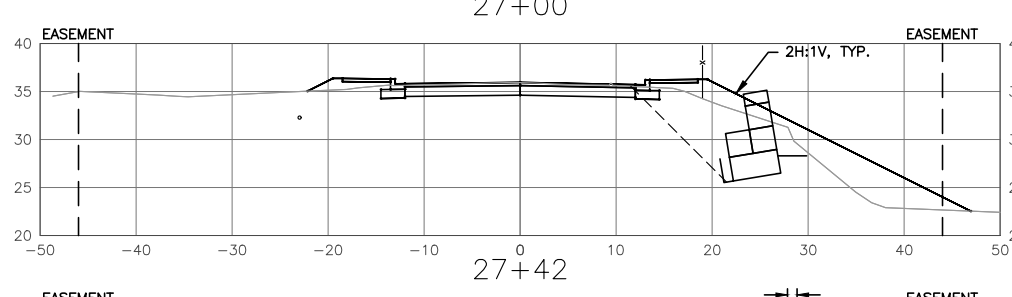
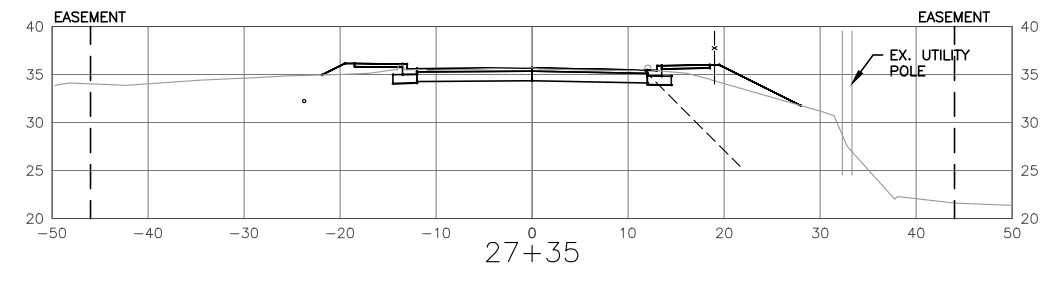
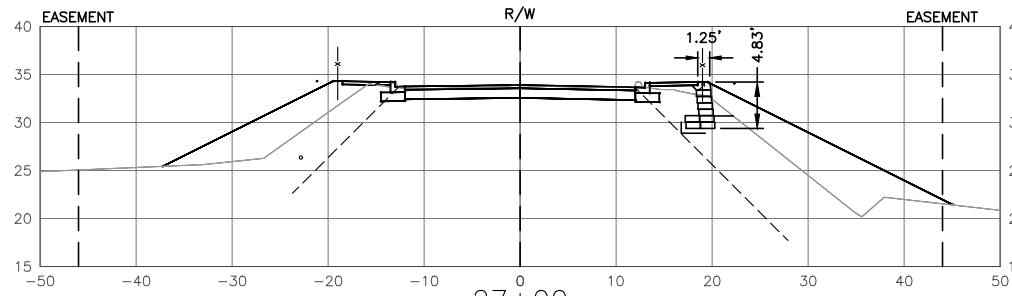
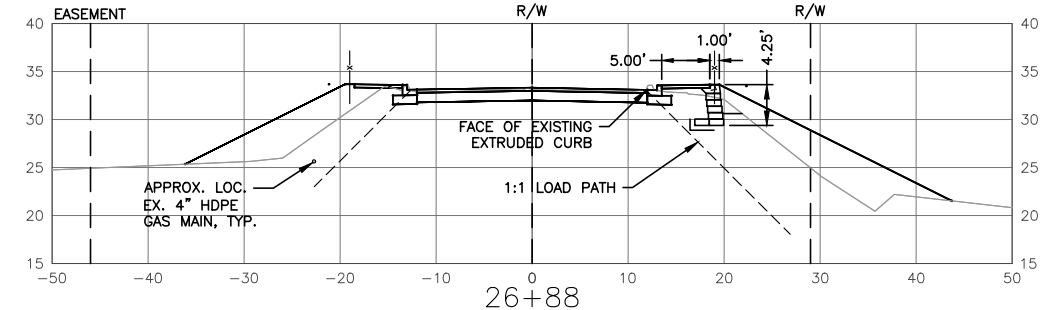
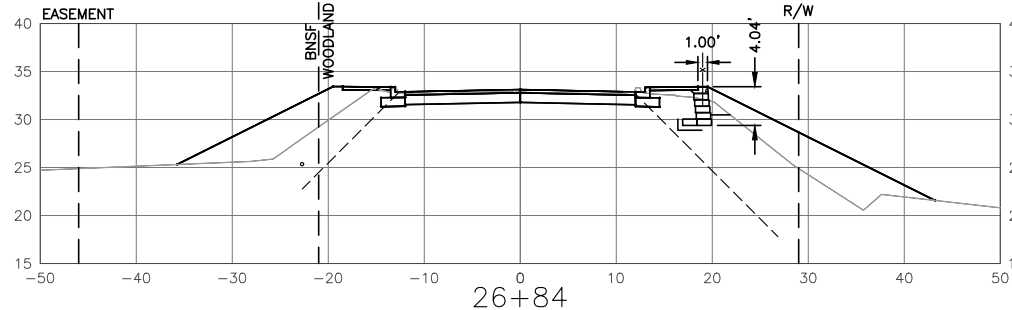
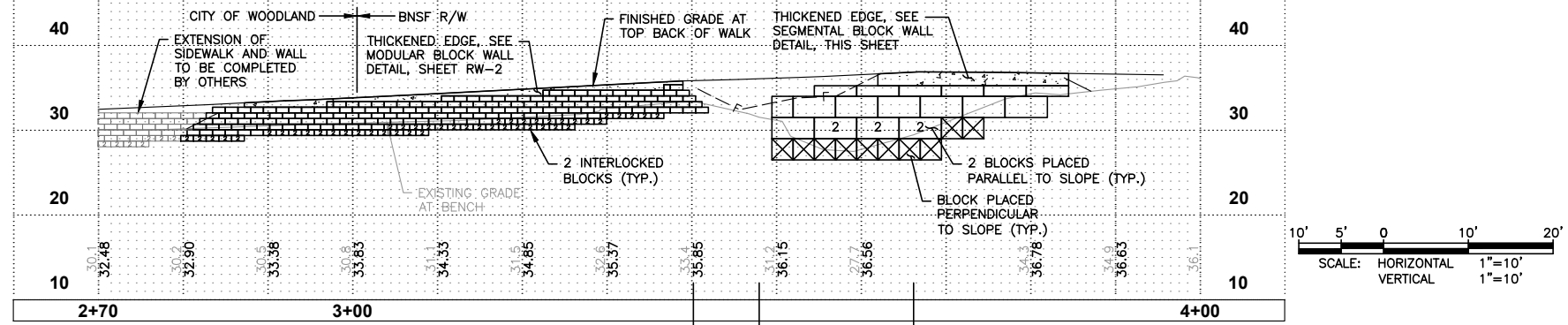

**SOUTHWEST WALL
PROFILE AND CROSS SECTIONS
SCALE: 1"=10'**

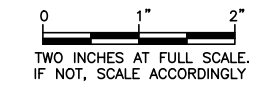

Gray & Osborne, Inc.
CONSULTING ENGINEERS
1130 RAINIER AVENUE SOUTH, SUITE 300
SEATTLE, WASHINGTON 98144 • (206) 264-0860

DATE: FEB 2021	DRAWN:	CHECKED:	APPROVED:
----------------	--------	----------	-----------

REVISION	DATE	APPD

**PRELIMINARY
NOT FOR
CONSTRUCTION**

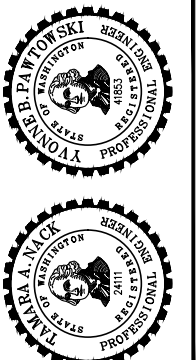

CITY OF WOODLAND
COWLITZ COUNTY WASHINGTON
BNSF / WEST SCOTT AVENUE
CROSSING 092437K IMPROVEMENTS
RETAINING WALL DETAILS

DRAWING: RW-3
SHEET: 3 OF: 4
JOB NO.: 19624
DWG: RETAINING WALL

M:\WOODLAND\19624 Guild Road and W. Scott Ave\01 Design\PLANSET\00-Planset-BNSF\Civil\RETAINING WALL.dwg, 2/8/2021 12:14 PM, YVONNE PAWTOWSKI

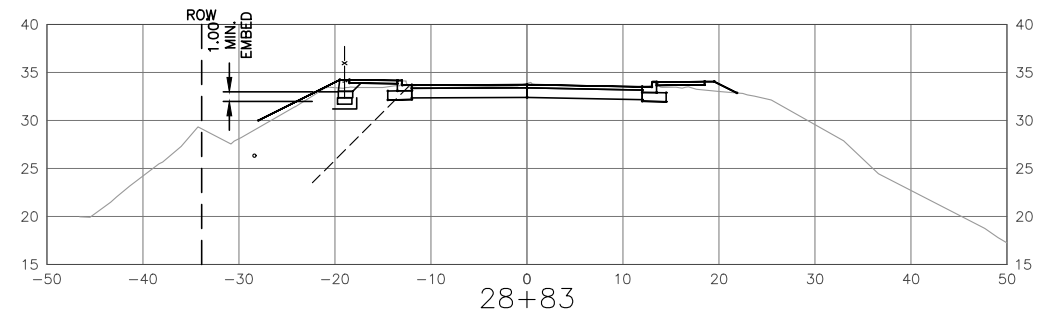
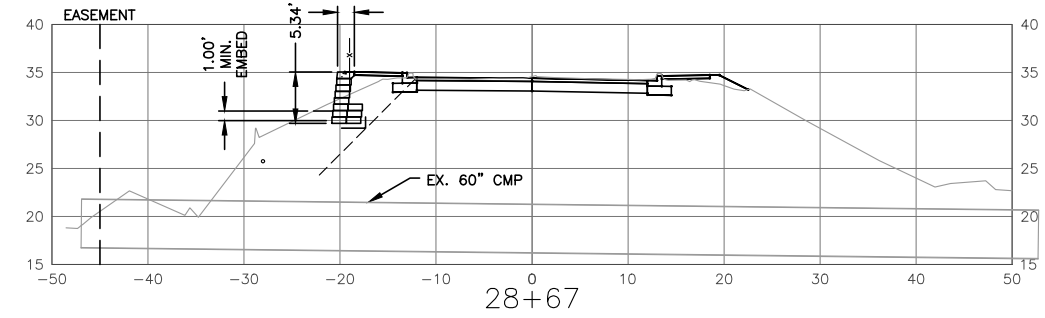
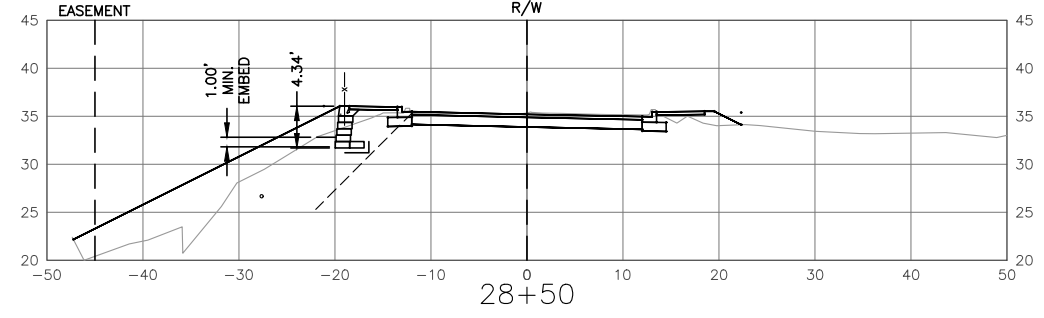
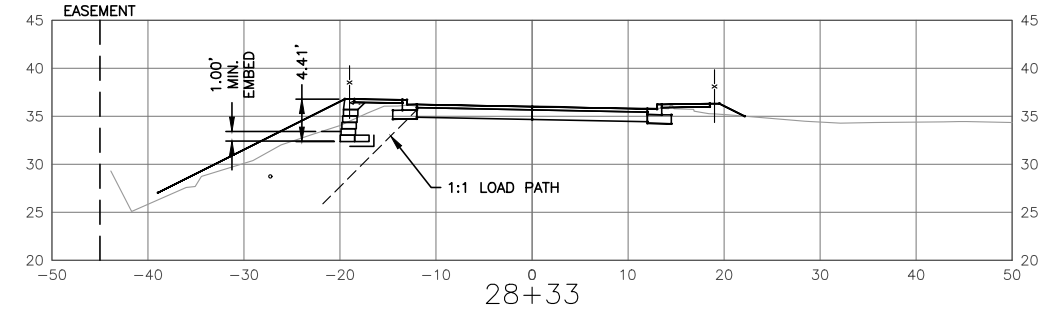
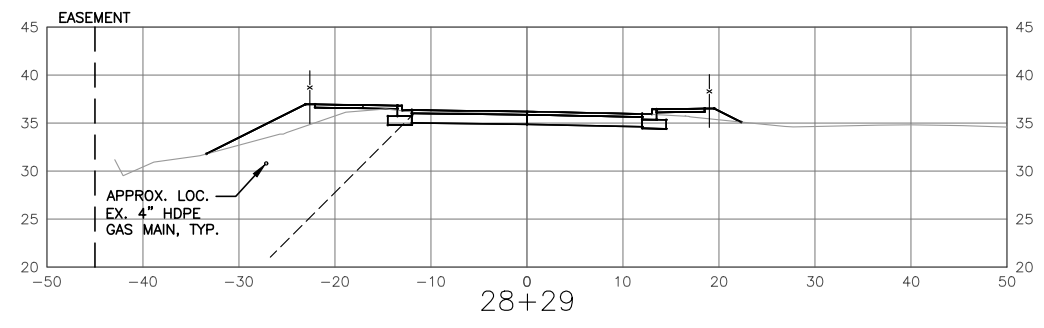
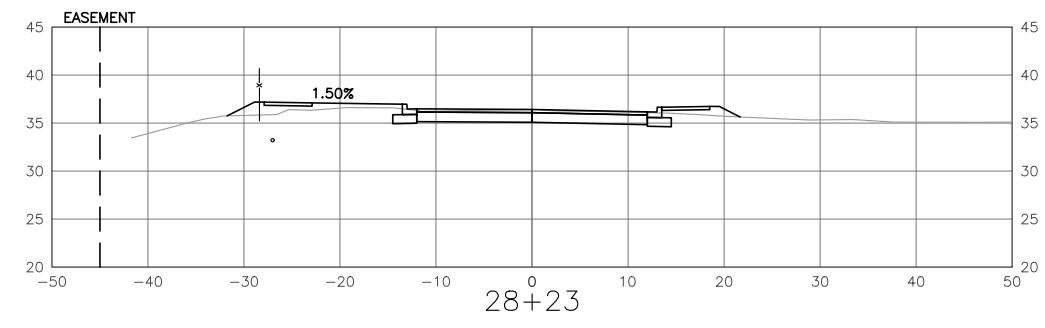
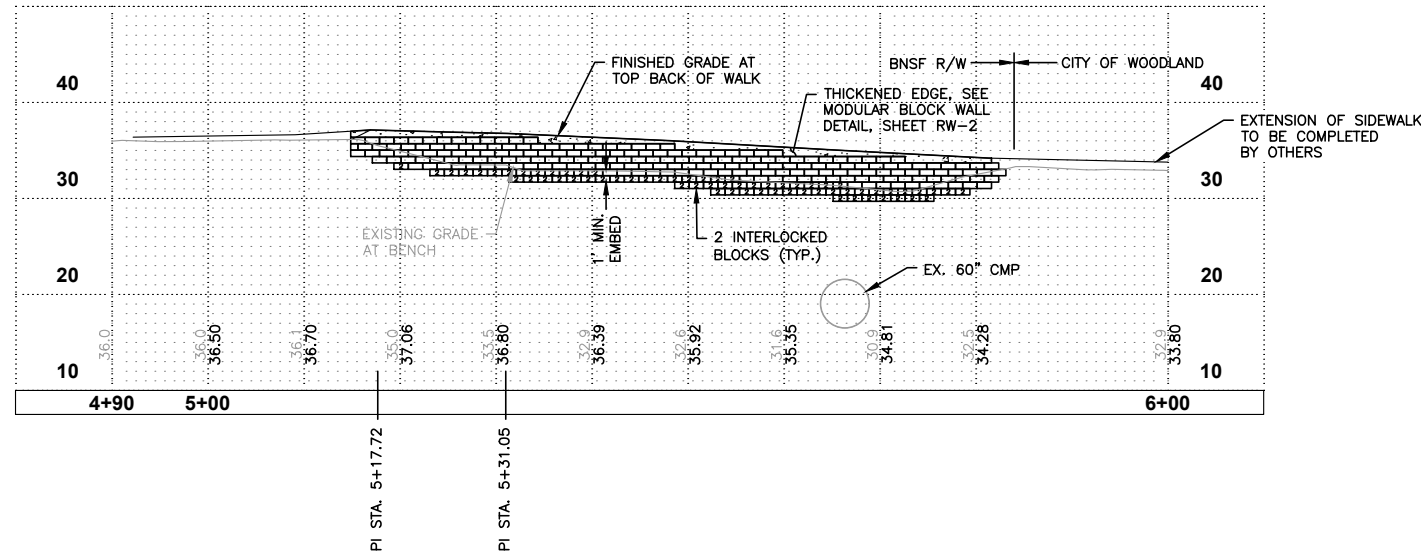

**NORTHEAST WALL
PROFILE AND CROSS SECTIONS**
SCALE: 1"=10'

Gray & Osborne, Inc.
CONSULTING ENGINEERS
1130 RAINIER AVENUE SOUTH, SUITE 300
SEATTLE, WASHINGTON 98144 • (206) 264-0860

DATE: FEB 2021	DRAWN:	CHECKED:	APPROVED:
----------------	--------	----------	-----------

PRELIMINARY NOT FOR CONSTRUCTION	REVISION	DATE	APPD
	No.		

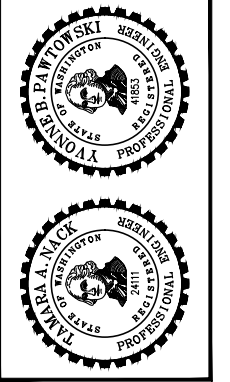

CITY OF WOODLAND
COWLITZ COUNTY WASHINGTON
**BNSF / WEST SCOTT AVENUE
CROSSING 092437K IMPROVEMENTS**
RETAINING WALL DETAILS

DRAWING: RW-4
SHEET: 4 OF: 4
JOB NO.: 19624
DWG: RETAINING WALL

