

APR 10 1985

64

BEFORE THE WASHINGTON UTILITIES AND TRANSPORTATION COMMISSION

In the Matter of the Application)
 of WASHINGTON NATURAL GAS COMPANY)
 to Amend its Certificate of Public)
 Convenience and Necessity to Oper-)
 ate a Gas Plant for Hire in the)
 General Area of Snohomish County.)
)

CAUSE NO. U-85-10

ORDER GRANTING
APPLICATION

On February 28, 1985 Washington Natural Gas Company (WNG), a Delaware corporation, filed an application to amend its present Certificate of Public Convenience and Necessity to Operate a Gas Plant for Hire, No. 2 amended, to include additional area in Snohomish County. (Appendix A-15, amended).

WNG is presently certificated for and is now providing gas service in Snohomish County. The additional area in Snohomish County requested is contiguous to the aforesaid presently certificated area in Snohomish County.

WNG has been requested by Snohomish County Economic Council if they could serve a 10,000,000 therm industrial load in the area being requested.

The total of direct and indirect construction cost is estimated to be \$819,000. The rate of return on investment is calculated to be 54.9%.

It appears that the application herein should be granted to satisfy the public convenience and necessity.

FINDINGS OF FACT

1. Washington Natural Gas Company, a Delaware corporation, operates a gas plant for hire in this state and is subject to the jurisdiction of this Commission.

2. WNG has heretofore been issued a Certificate of Public Convenience and Necessity to Operate a Gas Plant for Hire, No. 2, amended.

3. WNG has filed an application to amend its Certificate of Public Convenience and Necessity, No. 2, amended, to include an area in Snohomish County.

4. The operation of a gas plant for hire in the additional area requested is or will be required by the public convenience and necessity.

5. The Certificate of Public Convenience and Necessity to Operate a Gas Plant for Hire, No. 2, amended, presently held by WNG, should be further amended to include the additional area applied for herein.

O R D E R

1. IT IS HEREBY ORDERED That the application of Washington Natural Gas Company to amend its Certificate of Public Convenience and Necessity to Operate a Gas Plant for Hire,

No. 2, amended, to include an additional area in Snohomish County, is hereby approved and said Certificate shall be amended in accordance with attached Appendixes A-15 and A-16, amended, which, by this reference, is made a part hereof as though fully set forth herein.

2. IT IS FURTHER ORDERED That the Certificate of Public Convenience and Necessity to Operate a Gas Plant for Hire, No. 2, amended, issued pursuant to Order Paragraph No. 1, above, supersedes and cancels the Certificate of Public Convenience and Necessity to Operate a Gas Plant for Hire, No. 2, amended, and issued to Washington Natural Gas Company on September 20, 1968 in Cause No. U-9860. Said Certificate of September 20, 1968 shall be forthwith returned to this Commission.

3. IT IS FURTHER ORDERED That the Certificate issued pursuant to Order Paragraph No. 1, above, is subject to the terms, conditions and provisions of the Orders in Cause Nos. U-8839, U-8923, U-8991, U-9230, U-9372, U-9386, U-9389, U-9412, U-9433, U-9478, U-9536, U-9597, U-9598, U-9648, U-9692, U-9713, U-9820, U-9836, U-9864, U-9860, U-9872 and U-71-28.

4. IT IS FURTHER ORDERED That jurisdiction over this Cause is retained to effectuate the provisions of this order.

DATED at Olympia, Washington and effective this *10th* day of April, 1985.

WASHINGTON UTILITIES AND TRANSPORTATION COMMISSION



SHARON L. NELSON, Chairman



RICHARD D. CASAD, Commissioner

66

APPENDIX A-15 - LEGAL DESCRIPTION - GRANITE FALLS AND VICINITY -
SNOHOMISH COUNTY

All of the incorporated area of Granite Falls and other portions of Snohomish County described as follows:

Beginning at the northwest corner of Sec. 7 T. 30 N., R. 6 E.; thence east along section lines to the northeast corner of Sec. 7, T. 30 N., R. 7 E.; thence south along section lines to the southeast corner of Sec. 30, T. 30 N., R. 7 E.; thence west along section lines to the southwest corner of Sec. 25 T. 30 N., R. 6 E.; thence south along the east line of Sec. 35, T. 30 N., R. 6 E., to its southeast corner; thence west along section lines to the southwest corner of Sec. 31, T. 30 N., R. 6 E.; thence north along section lines to the point of beginning.

APPENDIX A-16 - LEGAL DESCRIPTION - SULTAN, STARTUP, GOLDBAR, AND
VICINITY

All of the area comprising the towns of Sultan, Startup, and Goldbar, and that additional portion of Snohomish County, described as follows:

Beginning at the northwest corner of Sec. 20, T. 28 N., R. 7 E.; thence east along section lines to the northeast corner of Sec. 20, T. 28 N., R. 9 E.; thence south along section lines to the southeast corner of Sec. 8, T. 27 N., R. 9 E.; thence west along section lines to the southwest corner of Sec. 8, T. 27 N., R. 7 E.; thence north along section lines to the northwest corner of sec. 20, T. 28 N., R. 7 E., the point of beginning.

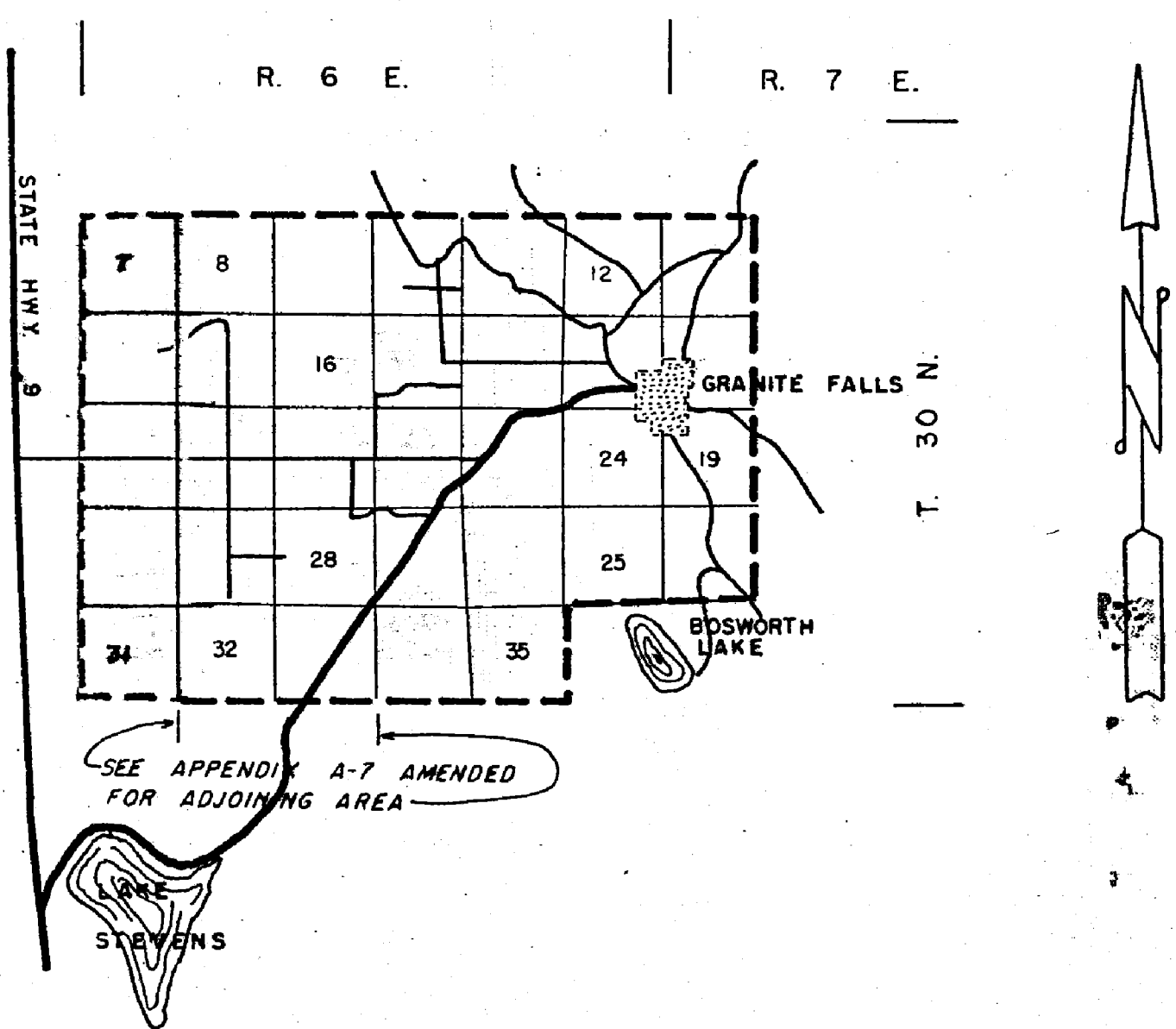

APPENDIX A-15
CAUSE NO. U-85-10

WASHINGTON NATURAL GAS COMPANY

BOUNDARY OF SERVICE AREA - - - - -

SNOHOMISH COUNTY

WASHINGTON
UTILITIES AND TRANSPORTATION
COMMISSION

DATE: APRIL 3, 1985 BY: T.W.

SEE APPENDIX A-14 FOR ADJOINING AREA

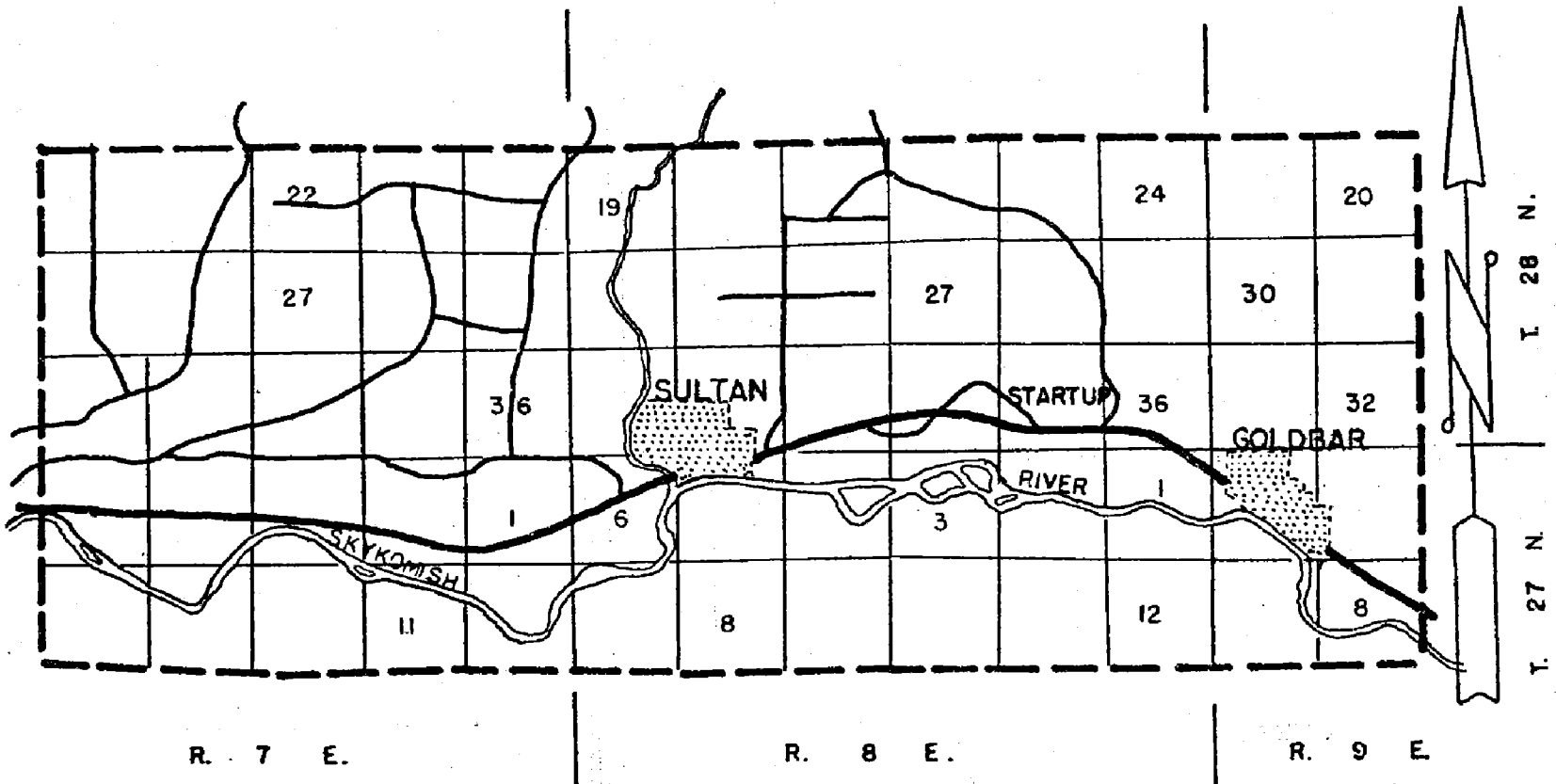

APPENDIX A-16
CAUSE NO. U-85-10

WASHINGTON NATURAL GAS COMPANY

BOUNDARY OF SERVICE AREA ———

SNOHOMISH COUNTY

WASHINGTON
UTILITIES AND TRANSPORTATION
COMMISSION

DATE: APRIL 3, 1985

BY: TW.