

MT. HULL EXCHANGE SERVICE BOUNDARIES

Rev. 10-16-00

Attachment to
Original Sheet No. 49

PAGE 1 OF 2

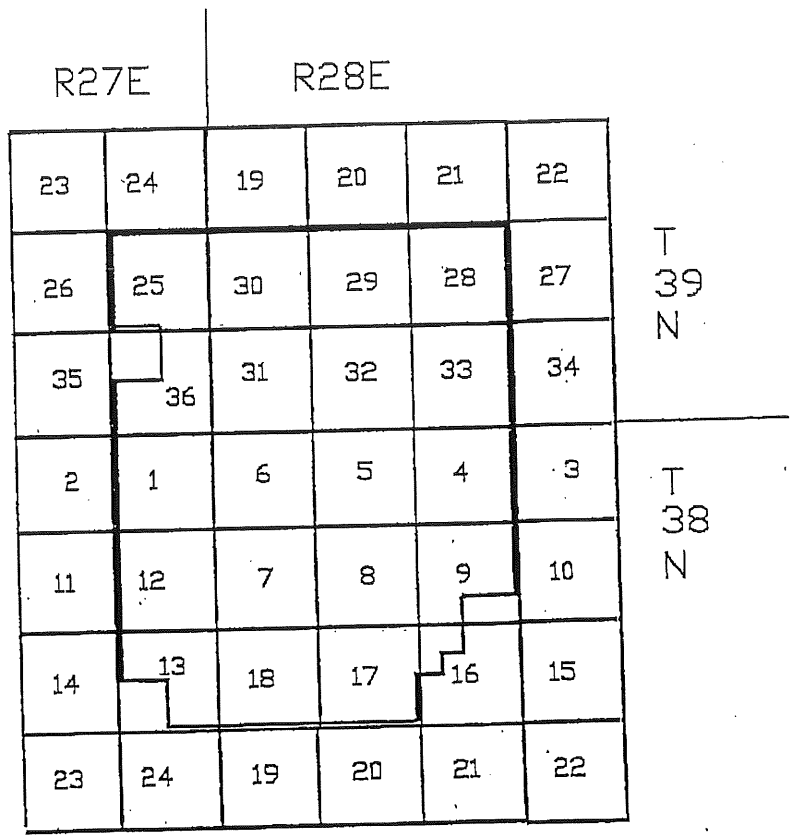

ROM(Limits, scaled to fit)
mthlbdry.dwg / 8-2-00

Attachment to
Original Sheet No. 49

Proposed Mt. Hull Exchange Service Boundaries (Swanson Mill, WA) Described as Follows:

BEGINNING at the southeast corner, Section 17, T-38-N, R-28-E, of the Willamette Base and Meridian, Okanogan County, Washington;
THENCE, West to the southwest corner, Southeast ¼ Section 13, T-38-N, R-27-E;
THENCE, North to the southwest corner, Northeast ¼ Section 13, T-38-N, R-27-E;
THENCE, West to the southwest corner, Northwest ¼ Section 13, T-38-N, R-27-E;
THENCE, North to the northwest corner, Southwest ¼ Section 36, T-39-N, R-27-E;
THENCE, East to the northwest corner, Southeast ¼ Section 36, T-39-N, R-27-E;
THENCE, North to the southwest corner, Southeast ¼ Section 25, T-39-N, R-27-E;
THENCE, West to the southwest corner, Section 25, T-39-N, R-27-E;
THENCE, North to the northwest corner, Section 25, T-39-N, R-27-E;
THENCE, East to the northeast corner, Section 28, T-39-N, R-28-E;
THENCE, South to northeast corner, Section 9, T-38-N, R-28-E;
THENCE, South 3,960', Southeast ¼ Section 9, T-38-N, R-28-E;
THENCE, West 2,640', Southwest ¼ Section 9, T-38-N, R-28-E;
THENCE, South 2,640', Northwest ¼ Section 16, T-38-N, R-28-E;
THENCE, West 1,320', Northwest ¼ Section 16, T-38-N, R-28-E;
THENCE, South 1,320', Northwest ¼ Section 16, T-38-N, R-28-E;
THENCE, West 1,320', Southeast ¼ Section 17, T-38-N, R-28-E;
THENCE, South to the point of beginning being the southeast corner, Section 17, T-38-N, R-28-E, of the Willamette Base and Meridian, Okanogan County, Washington.