

CEPS PLAN ITEM DOCUMENT

(FOR INTERNAL BNSF RAILWAY USE ONLY)

LOCATION : EAST QUINCY HOLDING	LINE SEGMENT : 37	AFE NUMBER :
PLANITEM NUMBER : 000276076	MILEPOST : 1611.71	RFA NUMBER :
PROPERTY OF : BNSF RAILWAY COMPANY	DIVISION : NW	CPAR NUMBER :
OPERATED BY : BNSF RAILWAY COMPANY	SUBDIVISION : COLUMBIA RIVER	BUDGET YEAR : 2016
JOINT FACILITY : GRANT COUNTY	ENGR. DIVISION : NORTHWEST EAST	BUDGET CLASS : 10
% BILLABLE (+/-) : 100.0	TAX STATE : WA, CO: GRANT	REPORTING OFFICE : 463
REQUESTOR ID : Q595	MATL DATE :	SPONSOR : VP ENGINEERING
PROJECT TYPE : SPP	LOCATION CODE : 511003	DEPT CODE : MOWGH
DOT NUMBER : 065792C	TRACK TYPE : 1	DERAILMENT CODE :
STIMULUS FUND TYPE : FHWA	STIMULUS STATUS : BUY AMERICAN	

PURPOSE, JUSTIFICATION AND DESCRIPTION

ADAMS RD - EPHRATA, WA; INSTALL CONSTANT WARNING / FLASHERS / GATES; NORTHWEST DIV; COLUMBIA RIVER SUBDIV; LS 37; MP 1611.71; DOT# 065792C. SEQ. #60749.

MONTHLY POWER UTILITY COST CENTER : 61504.

THE MATERIAL LIST BELOW REFLECTS TYPICAL REPRESENTATIVE PACKAGES USED FOR ESTIMATING PURPOSES ONLY.

THIS ESTIMATE IS GOOD FOR 90 DAYS. THEREAFTER THE ESTIMATE IS SUBJECT TO CHANGE IN COST FOR LABOR, MATERIAL, AND OVERHEAD.

CONTRACTS HAVE BEEN ESTABLISHED FOR PORTIONS OF SIGNAL WORK ON THE BNSF RAILROAD.

***** SIGNAL WORK ONLY *****

GRANT COUNTY IS FUNDING 100% OF THIS PROJECT.

MAINTAIN PROPRIETARY CONFIDENTIALITY.

PRIMARY FUNDING SOURCE IS FHWA

** BUY AMERICA(N) APPLIES **

	CASH CAPITAL	NONCASH CAPITAL	OPERATING EXP	REMOVAL COSTS	BILLABLE	TOTALS
LABOR COSTS	0	0	0	0	78,078	78,078
MATERIAL COSTS	0	0	0	0	107,232	107,232
OTHER COSTS	0	0	0	0	51,678	51,678
TOTALS	0	0	0	0	236,988	236,988

SYSTEM MAINTENANCE AND PLANNING

ESTIMATE REF. NUMBER : 000276076 - 1--2S

COSTING DATE : 04/13/2016

PRINTED ON : 04/27/2016

ESTIMATED BY : KANT

PRINTED BY : KANT

TOTAL MATERIAL COST		107,232	107,232

OTHER			

AC POWER SERVICE	1.0 EA N	10,000	
CONTRACT ENGINEERING	1.0 LS N	8,000	
DIRECTIONAL BORING	200.0 FT N	10,000	
TOTAL OTHER ITEMS COST		28,000	28,000
PROJECT SUBTOTAL			213,310
CONTINGENCIES			21,331
BILL PREPARATION FEE			2,347
GROSS PROJECT COST			236,988
LESS COST PAID BY BNSF			0
TOTAL BILLABLE COST			236,988

CEPS PLAN ITEM DOCUMENT

(FOR INTERNAL BNSF RAILWAY USE ONLY)

LOCATION : EAST QUINCY HOLDING	LINE SEGMENT : 37	AFE NUMBER :
PLANITEM NUMBER : 000276076	MILEPOST : 1611.71	RFA NUMBER :
PROPERTY OF : BNSF RAILWAY COMPANY	DIVISION : NW	CPAR NUMBER :
OPERATED BY : BNSF RAILWAY COMPANY	SUBDIVISION : COLUMBIA RIVER	BUDGET YEAR : 2016
JOINT FACILITY : GRANT COUNTY	ENGR. DIVISION : NORTHWEST EAST	BUDGET CLASS : 10
% BILLABLE (+/-) : 100.0	TAX STATE : WA, CO: GRANT	REPORTING OFFICE : 463
REQUESTOR ID : Q595	MATL DATE :	SPONSOR : VP ENGINEERING
PROJECT TYPE : SPP	LOCATION CODE : 511003	DEPT CODE : MOWGH
DOT NUMBER : 065792C	TRACK TYPE : 1	DERAILMENT CODE :
STIMULUS FUND TYPE : FHWA	STIMULUS STATUS : BUY AMERICAN	

PURPOSE, JUSTIFICATION AND DESCRIPTION

ADAMS RD - EPHRATA, WA; INSTALL CONSTANT WARNING / FLASHERS / GATES; NORTHWEST DIV; COLUMBIA RIVER SUBDIV; LS 37; MP 1611.71; DOT# 065792C. SEQ. #60749.

MONTHLY POWER UTILITY COST CENTER : 61504.

THE MATERIAL LIST BELOW REFLECTS TYPICAL REPRESENTATIVE PACKAGES USED FOR ESTIMATING PURPOSES ONLY.

THIS ESTIMATE IS GOOD FOR 90 DAYS. THEREAFTER THE ESTIMATE IS SUBJECT TO CHANGE IN COST FOR LABOR, MATERIAL, AND OVERHEAD.

CONTRACTS HAVE BEEN ESTABLISHED FOR PORTIONS OF SIGNAL WORK ON THE BNSF RAILROAD.

***** SIGNAL WORK ONLY *****

GRANT COUNTY IS FUNDING 100% OF THIS PROJECT.

MAINTAIN PROPRIETARY CONFIDENTIALITY.

PRIMARY FUNDING SOURCE IS FHWA

** BUY AMERICA(N) APPLIES **

	CASH CAPITAL	NONCASH CAPITAL	OPERATING EXP	REMOVAL COSTS	BILLABLE	TOTALS
LABOR COSTS	0	0	0	0	78,078	78,078
MATERIAL COSTS	0	0	0	0	107,232	107,232
OTHER COSTS	0	0	0	0	51,678	51,678
TOTALS	0	0	0	0	236,988	236,988

SYSTEM MAINTENANCE AND PLANNING

ESTIMATE REF. NUMBER : 000276076 - 1--2S

COSTING DATE : 04/13/2016

PRINTED ON : 04/27/2016

ESTIMATED BY : KANT

PRINTED BY : KANT

ACCT	CST	RSN	PPE	DESCRIPTION	QTY/ST	OT U/M	CASH	NONCASH	OPER	REMOVAL
8		400		SIGNAL SHOP LABOR - CAP	80.00	16.0 MH	3,236			
* LABOR SUBTOTAL							3,236	0	0	0
* ADDITIVES										
PAYROLL ASSOCIATED COSTS							2,125			
DA OVERHEADS							3,142			
EQUIPMENT EXPENSES							871			
INSURANCE EXPENSES							543			
* GANG SUBTOTAL							9,917	0	0	0
8		400	9911	ELECTRICAL LABOR F/SIGNAL EQUIPMENT	54.00	0.0 MH	1,520			
* LABOR SUBTOTAL							1,520	0	0	0
1120	319	400	9911	ELECTRICAL MATERIAL	1.00	EA N	1,500			
* MATERIAL SUBTOTAL							1,500	0	0	0
* ADDITIVES										
PAYROLL ASSOCIATED COSTS							998			
DA OVERHEADS							1,476			
EQUIPMENT EXPENSES							409			
INSURANCE EXPENSES							255			
USE TAX							140			
OFFLINE TRANSPORTATION							18			
* GANG SUBTOTAL							6,316	0	0	0
8		400	9911	SIGNAL FIELD LABOR - CAP	672.00	0.0 MH	20,718			
* LABOR SUBTOTAL							20,718	0	0	0
1120	313	400	9911	ARRESTOR, MDSA-2 XS	1.00	EA N	750			
1120	313	400	9911	BATTERY, 10 VGL-255, 18 VGL-350	1.00	LS N	7,954			
1120	313	400	9911	BELLS	2.00	EA N	392			
1120	313	400	9911	BUNGALOW 6X6	1.00	LS N	6,693			
1120	313	400	9911	BUNGALOW MATERIAL	1.00	LS N	7,130			
1120	313	400	9911	CABLE, 2C/6 TW	500.00	FT N	570			
1120	313	400	9911	CABLE, 3C/2	300.00	FT N	1,633			
1120	313	400	9911	CABLE, 5C/10	70.00	FT N	128			
1120	313	400	9911	CABLE, 5C/6	500.00	FT N	1,950			
1120	313	400	9911	CABLE, 7C/14	500.00	FT N	835			
1120	313	400	9911	CHARGERS, 12/20, 12/40	1.00	LS N	848			
1120	313	400	9911	CONDUIT, PVC 4", SCH 80	200.00	FT N	674			
1120	313	400	9911	CONSTANT WARNING, XP4, 2TK	1.00	EA N	29,325			
1120	313	400	9911	EVENT RECORDER	1.00	EA N	3,560			
1120	313	400	9911	FIELD MATERIAL	1.00	LS N	7,386			
1120	313	400	9911	FILL DIRT	20.00	CY N	500			
1120	313	400	9911	FOUNDATION, CONCRETE	2.00	EA N	600			
1120	313	400	9911	GATE KEEPER	2.00	EA N	3,726			
1120	313	400	9911	GATE MECHANISM, S-60	2.00	EA N	12,032			
1120	313	400	9911	LED LIGHT	8.00	EA N	1,608			
1120	313	400	9911	LED LIGHT GATE KIT	2.00	EA N	372			
1120	313	400	9911	LIGHT OUT DETECTOR	1.00	EA N	1,023			
1120	313	400	9911	SHUNT, NBS	2.00	EA N	2,232			
1120	313	400	9911	SURFACE ROCK	10.00	CY N	500			
1120	313	400	9911	TELLULAR DEVICE, RTU	1.00	EA N	3,052			
* MATERIAL SUBTOTAL							95,473	0	0	0
1120	367	400	9911	CONTRACT ENGINEERING	1.00	LS N	8,000			
1120	399	400	9911	DIRECTIONAL BORING	200.00	FT N	10,000			
* OTHER SUBTOTAL							18,000	0	0	0
* ADDITIVES										
PAYROLL ASSOCIATED COSTS							13,607			
DA OVERHEADS							20,119			
EQUIPMENT EXPENSES							5,581			
INSURANCE EXPENSES							3,478			
USE TAX							8,911			
OFFLINE TRANSPORTATION							1,190			
* GANG SUBTOTAL							187,077	0	0	0
1120	410	400	9911	AC POWER SERVICE	1.00	EA N	10,000			
* OTHER SUBTOTAL							10,000	0	0	0
* GANG SUBTOTAL							10,000	0	0	0

ACCT	CST	RSN	PPE	DESCRIPTION	QTY/ST	OT U/M	CASH	NONCASH	OPER	REMOVAL
				PROJECT SUBTOTAL			213,310	0	0	0
				CONTINGENCIES			21,331	0	0	0
				BILL PREPARATION FEE			2,347	0	0	0
				PROJECT GROSS COST			236,988	0	0	0
				LESS COST PAID BY OTHERS			236,988	0	0	0
				PROJECT NET COST			0	0	0	0

TOTAL MATERIAL COST		107,232	107,232

OTHER			

AC POWER SERVICE	1.0 EA N	10,000	
CONTRACT ENGINEERING	1.0 LS N	8,000	
DIRECTIONAL BORING	200.0 FT N	10,000	
TOTAL OTHER ITEMS COST		28,000	28,000
PROJECT SUBTOTAL			213,310
CONTINGENCIES			21,331
BILL PREPARATION FEE			2,347
GROSS PROJECT COST			236,988
LESS COST PAID BY BNSF			0
TOTAL BILLABLE COST			236,988

AUTHORITY FOR EXPENDITURE

LOCATION : EAST QUINCY HOLDING	LINE SEGMENT : 37	AFE NUMBER :
PLANITEM NUMBER : 211671000	MILEPOST : 1611.71	RFA NUMBER : 5922616
PROPERTY OF : BNSF RAILWAY COMPANY	DIVISION : NW	CPAR NUMBER : CB960016
OPERATED BY : BNSF RAILWAY COMPANY	SUBDIVISION : COLUMBIA RIVER	BUDGET YEAR : 2016
JOINT FACILITY : GRANT COUNTY	TRACK TYPE : S	BUDGET CLASS : 6
% BILLABLE (+/-) : 100.0	TAX STATE : WA	REPORTING OFFICE : 716
	SPONSOR : VP ENGINEERING	CENTER/ROLLUP : 28956

PURPOSE, JUSTIFICATION AND DESCRIPTION

PIP NWE DIV COLUMBIA RIVER SUB LS 37 MP 1611.71 DOT# 065792C - 100% BILLABLE TO GRANT COUNTY - CROSSING WIDENING FOR ROAD WIDENING PROJECT IN GRANT COUNTY
PRIMARY FUNDING SOURCE IS COUNTY FUNDS

PLAN ITEM	LINE SEG	BEG MP	END MP	TRK NBR	BEGIN STATION	END STATION	PROJECT TYPE	BUD YEAR
211671000	37	1611.71	1611.71	S	EAST QUINCY	EAST QUINCY	PUBLIC IMPROVEMENT PROJECT	2016

	CASH CAPITAL	NONCASH CAPITAL	OPERATING EXP	REMOVAL COSTS	BILLABLE	TOTALS
LABOR COSTS	0	0	0	0	18,064	18,064
MATERIAL COSTS	0	0	0	0	26,768	26,768
OTHER COSTS	0	0	0	0	4,748	4,748
TOTALS	0	0	0	0	49,580	49,580

SYSTEM MAINTENANCE AND PLANNING
ESTIMATE REF. NUMBER: 5922616
COSTING DATE: 03/21/2016

PRINTED ON: 03/21/2016
ESTIMATED BY: Elkins
PRINTED BY: Elkins

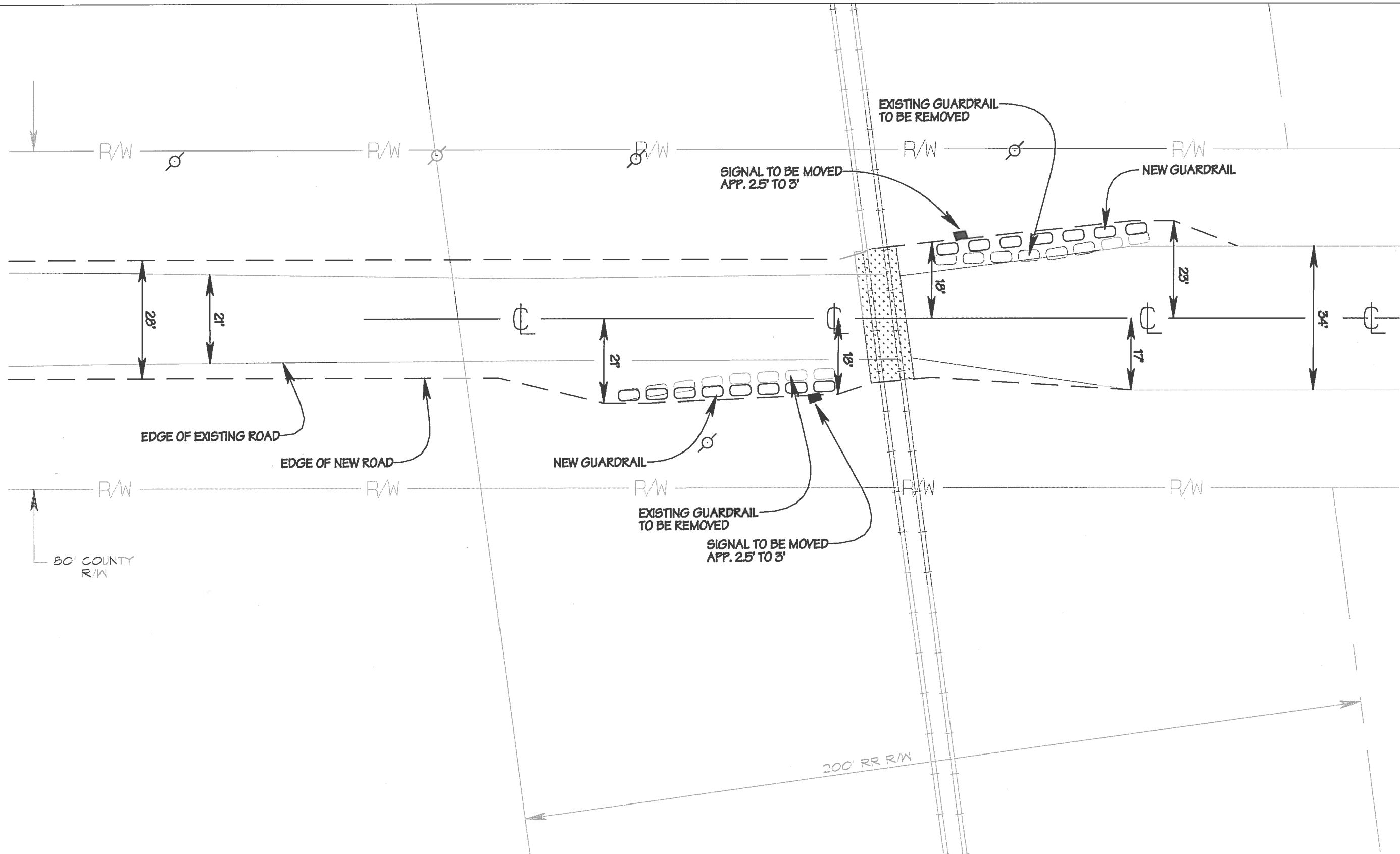

GRANT COUNTY PUBLIC WORKS DEPARTMENT

124 ENTERPRISE ST. SE
 EPHRATA, WASHINGTON 98823
 (509) 754-6082 FAX (509) 754-6087

ADAMS RD. NW

CRP 14-08

BNSF CROSSING
 DOT #065792C

DESIGNED BY:	BOB BERSANTI
CHECKED BY:	TODD MITTGE
APPROVED BY:	JEFF TINCHER
REVISIONS BY:	
DATE REVISED:	12/08/14
FEDERAL AID NO.:	

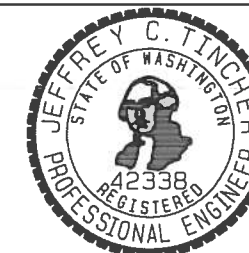

SHEET 1

OF 1