



April 22, 2015

Betty Young, Rail Safety  
WUTC  
PO Box 47250  
Olympia, WA 98504-7250

RE: Filing TR-150557–City of Moses Lake  
Station of Moses Lake–State of WA.

Dear Betty,

Please accept this letter as comment from Columbia Basin Railroad on the Application for Funding filed by City of Moses Lake (TR-150557) which was filed with a Waiver of Petition signed by Columbia Basin Railroad (CBRR) for a former application (TR-143567). CBRR had signed the "original" Petition in an effort to expedite the funding for the City of Moses Lake, but had not yet received fully engineered plans for the Grade Crossing Upgrades for Engineering Review.

A plan sheet of the crossing upgrades was received from the City of Moses Lake on 2/18/15 and sent to the CBRR Engineer for review. On 3/12/15, CBRR provided the attached Engineering Review Comments. Since that date CBRR and the City of Moses Lake have been working together to find a solution that works for both parties.

As of this date, CBRR and City of Moses Lake are still in the process of working through the approval of the Engineering Plans for the sidewalk upgrade to the Crossing and are hopeful for a compromise on the safety issues presented by CBRR.

Contact this office should you require additional clarification. Your consideration of this safety issue is appreciated.

Sincerely,

A handwritten signature in black ink that reads "Tim Kelly".

Tim Kelly, COO  
Central Washington Railroad

Cc: Kim Yeager–Iron Horse Real Estate  
**Via Email: 4-22-15**





Railroad Property Management  
111 University Parkway, Suite 200  
Yakima, WA 98901  
Bus: 509-966-5916 Fax: 509-453-9349

Date: April 22, 2015

**Paul J. Weber - Sr. Rail Project Mgr.**

**HDR ONE COMPANY | Many Solutions**  
1401 E. Trent Avenue, Suite 101 | Spokane, WA 99202

**Subject: Engineering Review at Stratford Road – Moses Lake, WA #14-3317**

Proposed Licensee: **CITY OF MOSES LAKE**

Line Segment: **0379**

Division: **Moses Lake Division**

Subdivision: **1st Subdivision**

Station: **Moses Lake**

Mile Post: **MP 14.80**

**Comments:**

This proposal is not ADA Compliant. The proper fix is to extend the crossing with ADA compliant crossing panels. Please re-submit with ADA Compliant Plans.

Plans approved as prepared       Plans need revision as requested above

Paul Weber: Per Email

Date: 3/12/15

Thank you,

Kim Yeager, Real Estate Manager  
Iron Horse Development, LLC

Attachment

GENERAL NOTES:

- (A) EXISTING SWING ARM WITH WARNING BEACONS. NO CHANGE.
- (B) EXISTING STOP BAR (PAINTED). NO CHANGE.
- (C) PROPOSED 5-FOOT-WIDE CONCRETE SIDEWALK. 4 INCH THICK.
- (D) EXISTING CONCRETE AT TRACKS WILL BE EXTENDED TO BACK OF PROPOSED SIDEWALK.
- (E) EXISTING CURB OR NO CHANGE.
- (F) UNIMPROVED GRADE ON EAST SIDE. NO CHANGE. R.O.W. IS 5.5 FEET FROM BACK OF CURB.
- (G) EMBANKMENT WILL BE INSTALLED TO REVISE EXISTING GRADE BEHIND PROPOSED SIDEWALK TO 3:1 / H:V OR LESS.
- (H) EXISTING GUARD RAIL WILL BE REMOVED.
- (I) EXISTING STRATFORD RD R.O.W. IS 0.5 FEET BEHIND PROPOSED BACK OF SIDEWALK. ACCESS REQUIRED FROM COLUMBIA BASIN RAILROAD.
- (J) INSTALL THERMOPLASTIC R/R MARKING, 50-FT FROM STOP BAR, WHITE, OR AS STAKED BY CITY.
- (K) INSTALL THERMOPLASTIC "STOP" & STOP BAR, 15- FEET FROM RAILROAD TRACK, WHITE.
- (L) INSTALL W10-1 R/R CROSSING SIGN, 2 FEET FROM BACK OF SIDEWALK, AS STAKED BY CITY.

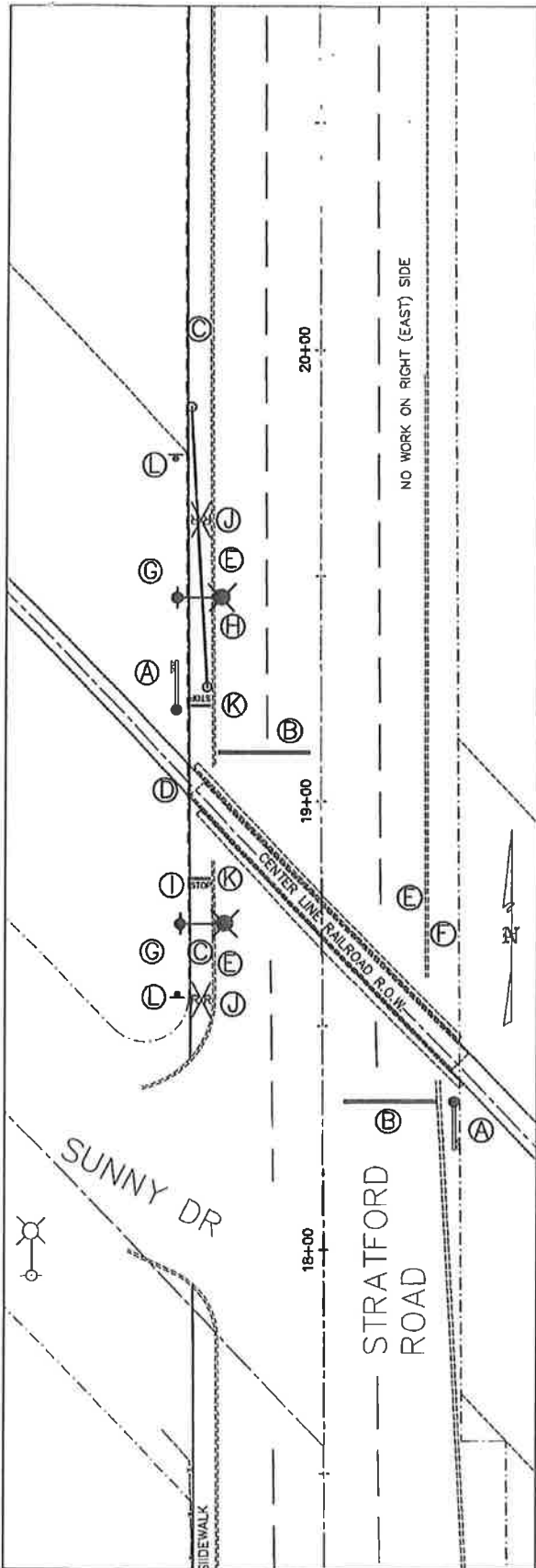

LEGEND	
PROPOSED	EXISTING
— PROPOSED LINE	--- R/W
- - - SAWCUT LINE	..... PROPERTY LINE
	..... CENTER LINE
	..... EDGE OF ASPHALT
	..... EDGE OF CONCRETE
	..... WATER LINE
	..... SEWER
	..... STORM SEWER
	..... GAS LINE
	..... FENCE
▲ SIGN	○ POWER POLE
● BOLLARD	○ POWER POLE ANCHOR
⊠ JUNCTION BOX	○ STREET LIGHT
⊞ STREET LIGHT	△ TELEPHONE PEDESTAL
	□ CATCH BASIN



STRATFORD RD CROSSWALK PROJECT - 2015  
RAILROAD DETAIL

MUNICIPAL SERVICES DEPT. - ENGINEERING DIVISION

DRAWN LG  
CHECK MORD  
SCALE 1" = 20'  
DATE 8/2014

CITY OF MOSES LAKE

GRANT COUNTY

WASHINGTON



**VICINITY MAP**  
CITY OF MOSES LAKE, WA  
N.T.S.

APPROVED  
STAGING AREA

PROJECT  
JOB SITE

SF 17

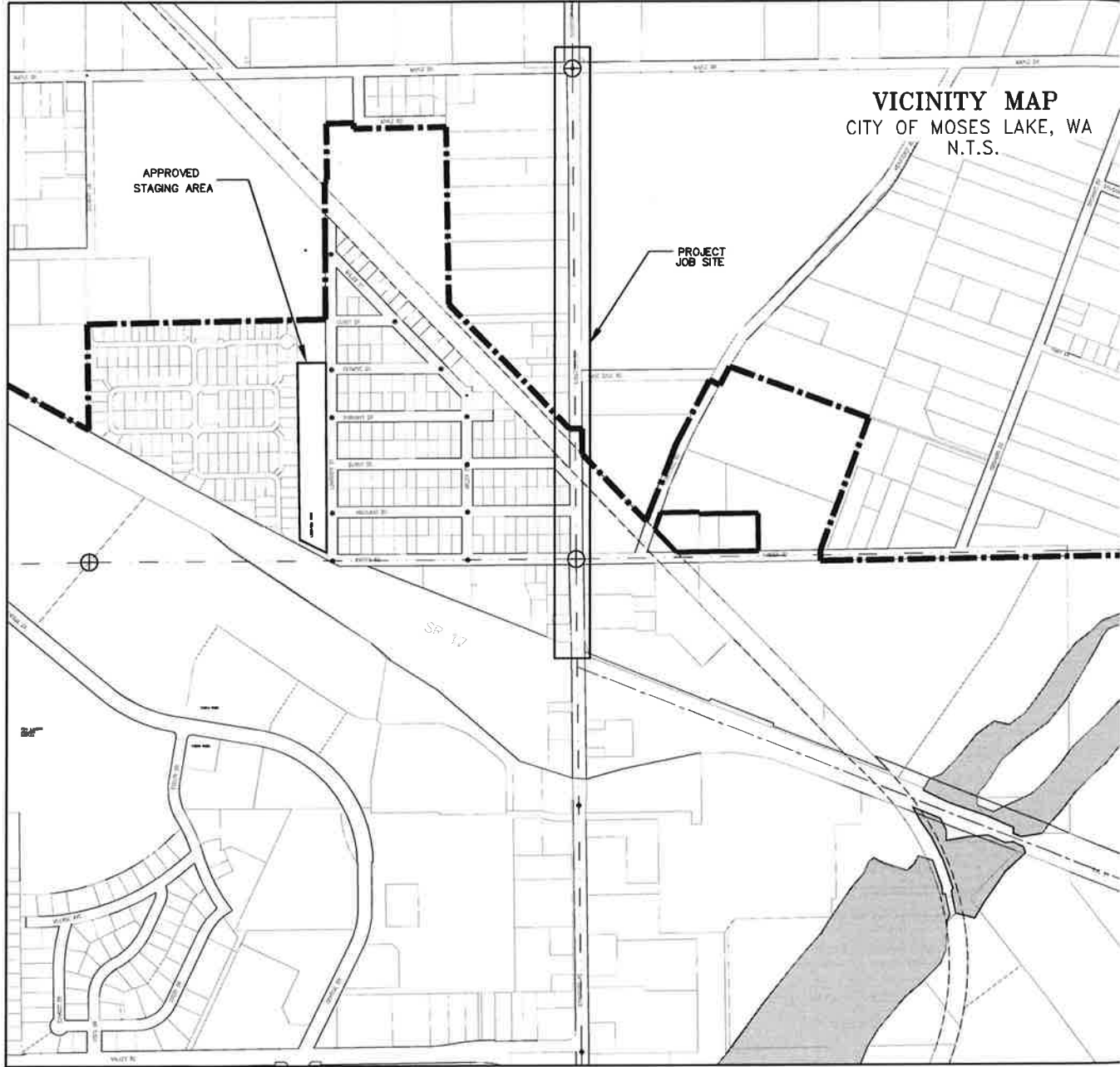

PROPOSED		EXISTING	
	PROPOSED SAWCUT LINE		CONSTRUCTION EASEMENT
	STORM SEWER		R/W
	2 INCH CONDUIT TRANSITION LINE		PROPERTY LINE
	WATER SERVICE		CENTER LINE
	MAIL BOX		EDGE OF ASPHALT
	CATCH BASIN		EDGE OF GRAVEL
	STREET LIGHT BY OTHERS		EDGE OF CONCRETE
	J-BOX		WATER LINE
	DETECTABLE WARNING SURFACE		SEWER
			STORM SEWER
			GAS LINE
			BURIED POWER
			BURIED PHONE
			BURIED CABLE
			IRRIGATION
			FENCE
			STREET MONUMENT SIGN
			FIRE HYDRANT
			WATER METER
			WATER VALVE
			MANHOLE
			CATCH BASIN
			DRYWELL
			POWER POLE
			POWER POLE ANCHOR
			STREET LIGHT
			TELEPHONE PEDESTAL
			DECIDUOUS TREE
			CONIFEROUS TREE
			MAILBOX
			PROPERTY CORNER

CALL 2 DAYS BEFORE YOU DIG  
1-800-424-5555

CONSTRUCTION NOTES:

- SAWCUT FACE OF CURB TO CREATE TAPER OF H:V=12:1 OR FLATTER.
- REMOVE EXISTING CURB & PAVEMENT AS DIRECTED BY ENGINEER. RE-GRADE, & INSTALL NEW CURB & HMA AS STAKED BY ENGINEER.
- INSTALL CEMENT CONCRETE SIDEWALK & DRIVEWAY AS STAKED BY ENGINEER.
- REMOVE PAVEMENT & INSTALL HMA PATCH AS DIRECTED BY ENGINEER TO MATCH EXISTING PAVEMENT & BACK OF SIDEWALK.
- INSTALL CURB RAMP IN ACCORDANCE WITH CURB RAMP DETAILS AND AS DIRECTED BY ENGINEER.
- INSTALL 18-INCH PEDESTRIAN CURB AS DIRECTED BY ENGINEER.
- INSTALL CATCH BASIN & STORM WATER PIPE. CONNECT TO EXISTING CATCH BASIN. ADJUST PIPE AS DIRECTED BY ENGINEER TO AVOID EXISTING UTILITIES.
- REMOVE & DISPOSE EXISTING CONCRETE SIGN BASE.
- REMOVE PARKING BLOCKS.
- MAINTAIN A 15-FOOT ENTRANCE FROM STRATFORD ROAD AT ALL TIMES. COMPLETE CONCRETE WORK THROUGH DRIVEWAY ACCESS IN TWO PHASES.
- FOR WORK IN VICINITY OF RAILROAD. SEE SHEET 4.
- REPLACE EXISTING WATER SERVICE.
- REMOVE AND REPLACE CURB AS DIRECTED BY ENGINEER.
- WIDEN CONCRETE SIDEWALK TO INCLUDE 1-FOOT AROUND 2 EXISTING WATER SERVICES. ADJUST FRAMES/COVERS TO NEW SIDEWALK GRADE.
- CONSTRUCT SUPPORT BASE FOR SIDEWALK & EMBANKMENT FOR SLOPE IN ACCORDANCE WITH DETAIL SR-1 SHEET 5. REMOVE EXISTING FENCE AND INSTALL NEW FENCE/CONNECT TO EXISTING FENCE AS DIRECTED BY ENGINEER.
- SAWCUT CURB TO EXTEND/CREATE DRIVEWAY ACCESS AS DIRECTED BY ENGINEER.
- REMOVE FIRST SIDEWALK PANEL AT POINT OF CONNECTION.
- PLACE BALLAST BEHIND NEW SIDEWALK AS DIRECTED BY ENGINEER.
- RE-GRADE & PLACE SELECT BACKFILL/CSTC TO MATCH BACK OF NEW SIDEWALK.
- CENTURY LINK WILL RELOCATE PHONE PEDESTAL DURING CONSTRUCTION. CONTACT CURT AUSTIN AT (509) 235-3375.
- WORK WITHIN SR17 ROW REQUIRES TRAFFIC CONTROL PLANS IN ACCORDANCE WITH DETAIL & AS AUTHORIZED BY WSDOT.
- MATCH EXISTING PAVEMENT OR SIDEWALK.
- INSTALL V-LOCK IN ACCORDANCE WITH SIGN DETAIL & AS DIRECTED BY ENGINEER. INSTALL SIGN IN ACCORDANCE WITH SIGN TABLE.
- CONNECT 2" ELECTRICAL CONDUIT INTO EXISTING PEDESTAL COORDINATE WITH GRANT COUNTY PUD. PUD WILL INSTALL STREET LIGHT ON EXISTING POLE.
- INSTALL ELECTRICAL CONDUIT, J-BOXES, AND HANGOR TUBES IN ACCORDANCE WITH DETAILS & AT LOCATIONS AS SHOWN ON PLANS & DIRECTED BY ENGINEER. WHERE NO CONDUIT IS SHOWN AT LOCATION OF NEW STREET LIGHT INSTALL HANGOR TUBE ONLY.

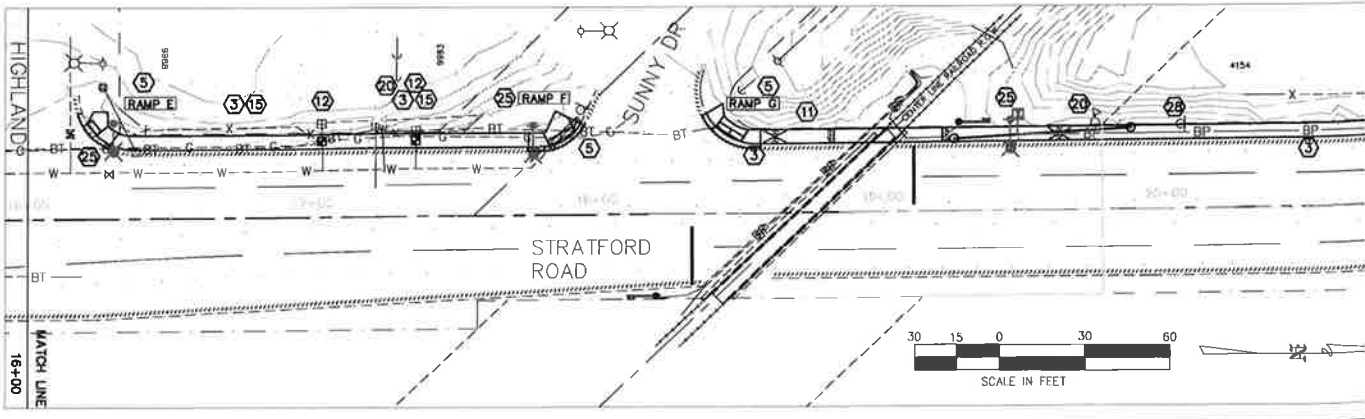
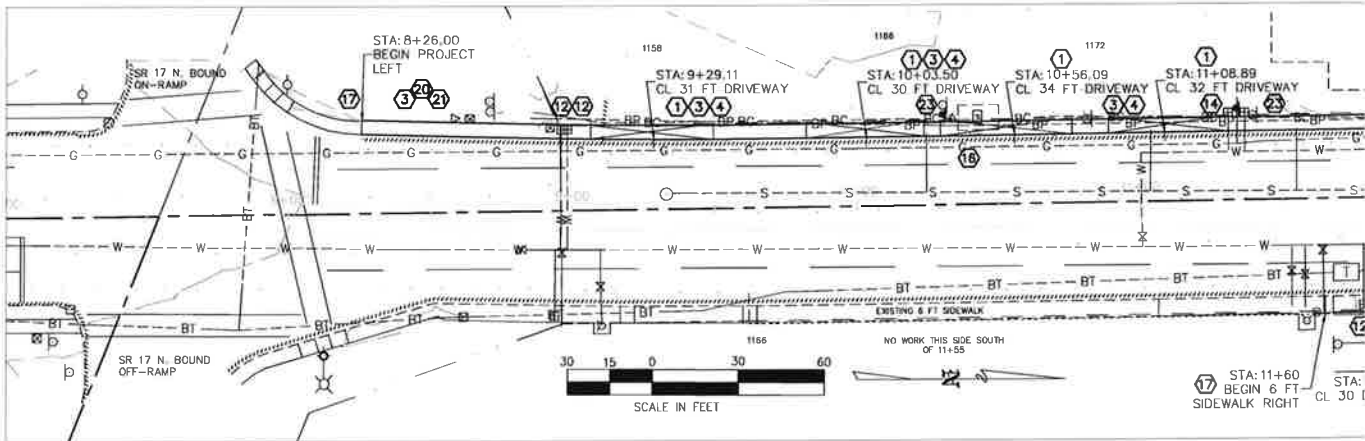

# LEGEND

PROPOSED	EXISTING
<p>  PROPOSED SAWCUT LINE   ST STORM SEWER   BP 2 INCH CONDUIT TRANSITION LINE                 </p>	<p>  CONSTRUCTION EASEMENT R/W   PROPERTY LINE   CENTER LINE   EDGE OF ASPHALT   EDGE OF GRAVEL   EDGE OF CONCRETE   W-----W-----W-----W WATER LINE   S-----S-----S-----S SEWER   ST-----ST-----ST-----ST STORM SEWER   G-----G-----G-----G GAS LINE   BP-----BP-----BP-----BP BURIED POWER   BT-----BT-----BT-----BT BURIED PHONE   BC-----BC-----BC-----BC BURIED CABLE   IR-----IR-----IR-----IR LANDSCAPING   IR-----IR-----IR-----IR IRRIGATION   X-----X-----X-----X FENCE                 </p>
<p>  WATER METER   SIGN   MAIL BOX   CATCH BASIN   STREET LIGHT BY OTHERS   J-BOX   TD DETECTABLE WARNING SURFACE                 </p>	<p>  STREET MONUMENT   SIGN   FIRE HYDRANT   WATER METER   WATER VALVE   MANHOLE   CATCH BASIN   DRYWELL   POWER POLE   POWER POLE ANCHOR   STREET LIGHT   TELEPHONE PEDESTAL   DECIDUOUS TREE   CONIFEROUS TREE   MAIL BOX   PROPERTY CORNER                 </p>

CALL 2 DAYS BEFORE YOU DIG  
1-800-424-5555

## CONSTRUCTION NOTES:

- |  |  |
|--|--|
| <ul style="list-style-type: none"> <li>① SAWCUT FACE OF CURB TO CREATE TAPER OF H:V=12:1 OR FLATTER.</li> <li>② REMOVE EXISTING CURB &amp; PAVEMENT AS DIRECTED BY ENGINEER. RE-GRADE, &amp; INSTALL NEW CURB &amp; HMA AS STAKED BY ENGINEER.</li> <li>③ INSTALL CEMENT CONCRETE SIDEWALK &amp; DRIVEWAY AS STAKED BY ENGINEER.</li> <li>④ REMOVE PAVEMENT &amp; INSTALL HMA PATCH AS DIRECTED BY ENGINEER TO MATCH EXISTING PAVEMENT &amp; BACK OF SIDEWALK.</li> <li>⑤ INSTALL CURB RAMP IN ACCORDANCE WITH CURB RAMP DETAILS AND AS DIRECTED BY ENGINEER.</li> <li>⑥ INSTALL 18-INCH PEDESTRIAN CURB AS DIRECTED BY ENGINEER..</li> <li>⑦ INSTALL CATCH BASIN &amp; STORM WATER PIPE. CONNECT TO EXISTING CATCH BASIN. ADJUST PIPE AS DIRECTED BY ENGINEER TO AVOID EXISTING UTILITIES.</li> <li>⑧ REMOVE &amp; DISPOSE EXISTING CONCRETE SIGN BASE.</li> <li>⑨ REMOVE PARKING BLOCKS.</li> <li>⑩ MAINTAIN A 15-FOOT ENTRANCE FROM STRATFORD ROAD AT ALL TIMES. COMPLETE CONCRETE WORK THROUGH DRIVEWAY ACCESS IN TWO PHASES.</li> <li>⑪ FOR WORK IN VICINITY OF RAILROAD, SEE SHEET 4.</li> <li>⑫ REPLACE EXISTING WATER SERVICE.</li> <li>⑬ REMOVE AND REPLACE CURB AS DIRECTED BY ENGINEER.</li> <li>⑭ WIDEN CONCRETE SIDEWALK TO INCLUDE 1-FOOT AROUND 2 EXISTING WATER SERVICES. ADJUST FRAMES/COVERS TO NEW SIDEWALK GRADE.</li> </ul> | <ul style="list-style-type: none"> <li>⑮ CONSTRUCT SUPPORT BASE FOR SIDEWALK &amp; EMBANKMENT FOR SLOPE IN ACCORDANCE WITH DETAIL SR-1 SHEET 5. REMOVE EXISTING FENCE AND INSTALL NEW FENCE/CONNECT TO EXISTING FENCE AS DIRECTED BY ENGINEER.</li> <li>⑯ SAWCUT CURB TO EXTEND/CREATE DRIVEWAY ACCESS AS DIRECTED BY ENGINEER.</li> <li>⑰ REMOVE FIRST SIDEWALK PANEL AT POINT OF CONNECTION.</li> <li>⑱ PLACE BALLAST BEHIND NEW SIDEWALK AS DIRECTED BY ENGINEER.</li> <li>⑲ RE-GRADE &amp; PLACE SELECT BACKFILL/CSTC TO MATCH BACK OF NEW SIDEWALK.</li> <li>⑳ CENTURY LINK WILL RELOCATE PHONE PEDESTAL DURING CONSTRUCTION. CONTACT CURT AUSTIN AT (509) 235-3375.</li> <li>㉑ WORK WITHIN SR17 ROW REQUIRES TRAFFIC CONTROL PLANS IN ACCORDANCE WITH DETAIL &amp; AS AUTHORIZED BY WSDOT.</li> <li>㉒ MATCH EXISTING PAVEMENT OR SIDEWALK.</li> <li>㉓ INSTALL V-LOCK IN ACCORDANCE WITH SIGN DETAIL &amp; AS DIRECTED BY ENGINEER INSTALL SIGN IN ACCORDANCE WITH SIGN TABLE.</li> <li>㉔ CONNECT 2" ELECTRICAL CONDUIT INTO EXISTING PEDESTAL. COORDINATE WITH GRANT COUNTY PUD. PUD WILL INSTALL STREET LIGHT ON EXISTING POLE.</li> <li>㉕ INSTALL ELECTRICAL CONDUIT, J-BOXES, AND HANCOR TUBES IN ACCORDANCE WITH DETAILS &amp; AT LOCATIONS AS SHOWN ON PLANS &amp; DIRECTED BY ENGINEER. WHERE NO CONDUIT IS SHOWN AT LOCATION OF NEW STREET LIGHT INSTALL HANCOR TUBE ONLY.</li> </ul> |
|--|--|

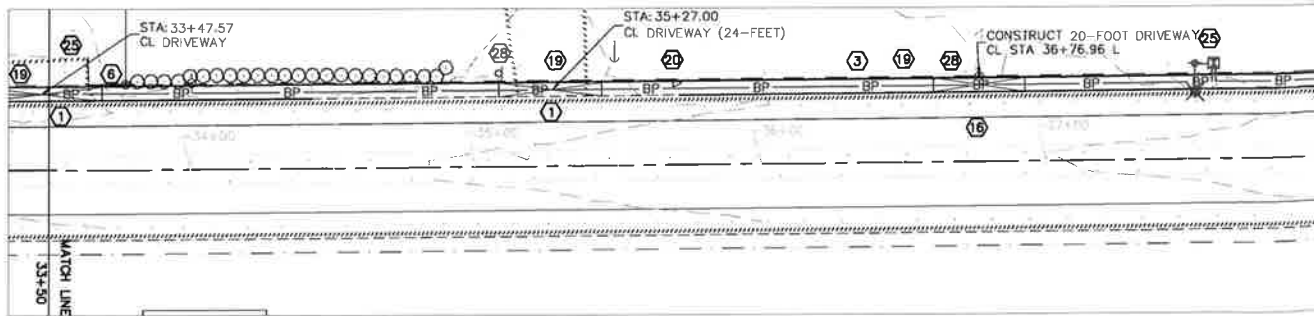
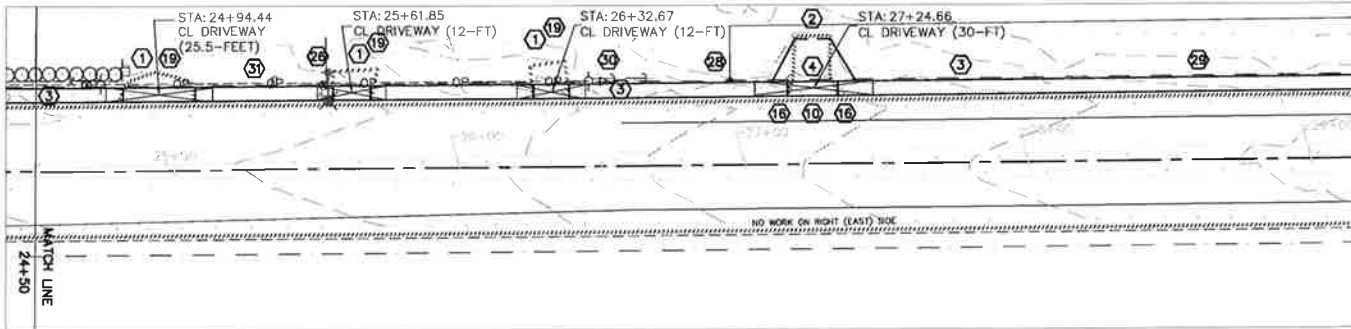

PROPOSED		EXISTING	
	PROPOSED SAWCUT LINE		R/W PROPERTY LINE
	STORM SEWER		CENTER LINE
	REMOVE AND REPLACE CONCRETE		EDGE OF ASPHALT
	DRIVEWAY		EDGE OF GRAVEL
	WATER METER		EDGE OF CONCRETE
	SIGN		WATER LINE
	CATCH BASIN		SEWER
	STREET LIGHT		STORM SEWER
			GAS LINE
			BURIED POWER
			BURIED PHONE
			BURIED CABLE
			LANDSCAPING
			IRRIGATION
			FENCE
			STREET MONUMENT
			SIGN
			FIRE HYDRANT
			WATER METER
			WATER VALVE
			MANHOLE
			CATCH BASIN
			DRYWELL
			POWER POLE
			POWER POLE ANCHOR
			STREET LIGHT
			TELEPHONE PEDESTAL
			DECIDUOUS TREE
			CONIFEROUS TREE
			MAILBOX
			PROPERTY CORNER
			SIGNAL ARM

CALL 2 DAYS  
BEFORE YOU DIG  
1-800-424-5555

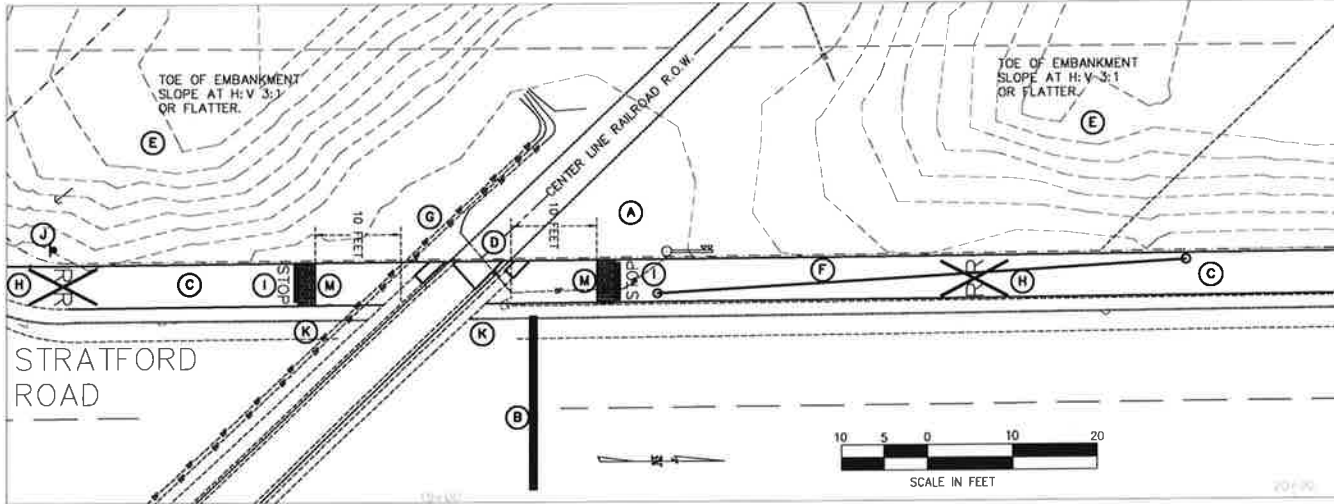

**GENERAL NOTES:**

- (A) EXISTING SWING ARM WITH WARNING BEACONS. NO CHANGE.
- (B) EXISTING STOP BAR (PAINTED). NO CHANGE.
- (C) INSTALL SIDEWALK AS DIRECTED BY ENGINEER, TYPICAL 5-FOOT-WIDE.
- (D) INSTALL CONCRETE TO EXTEND AND MATCH EXISTING CROSSING PANELS. PER SPECIFICATIONS AND AS DIRECTED BY ENGINEER.
- (E) REVISE EXISTING GRADE BEHIND PROPOSED SIDEWALK TO 3:1 / H:V OR LESS, AS DIRECTED BY ENGINEER. PLACE BALLAST IN TOP 1 FOOT OF EMBANKMENT.
- (F) REMOVE EXISTING GUARD RAIL AND POSTS.
- (G) CONTRACTOR SHALL OBTAIN "RIGHT OF ENTRY" PERMIT FROM COLUMBIA BASIN RAILROAD PRIOR TO ANY WORK NOT WITHIN STRATFORD ROAD RIGHT-OF-WAY. SEE SPECIAL PROMSION 1-04.13.
- (H) INSTALL THERMOPLASTIC R/R MARKING, 50-FT FROM STOP BAR, WHITE, OR AS STAKED BY CITY.
- (I) INSTALL THERMOPLASTIC "STOP" & STOP BAR, 15-FEET FROM RAILROAD TRACK, WHITE.
- (J) INSTALL W10-1 R/R CROSSING SIGN, 2 FEET FROM BACK OF SIDEWALK, AS STAKED BY CITY.
- (K) EXTEND CURB TO MEET CROSSING PANELS AS DIRECTED BY ENGINEER.
- (M) INSTALL CAST IRON DETECTABLE WARNING SURFACE, POWDER COATED FEDERAL YELLOW.

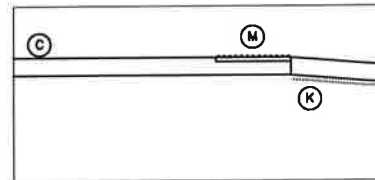

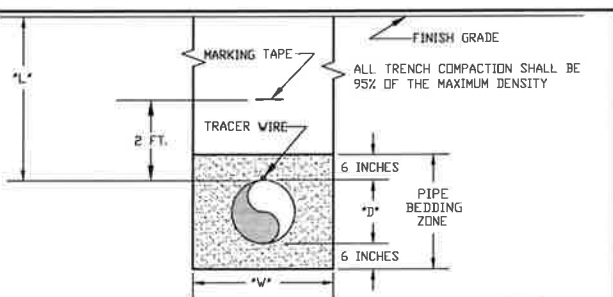

**TABLE B-3**  
WATER MAINS, SANITARY SEWER MAINS, AND STORM SEWER MAINS

TRENCH WIDTH FOR MAINS (W) SHALL BE PIPE SIZE PLUS 18 INCHES.  
ALL TRENCHES SHALL MEET WAC CHAPTER 296-155 FOR CONSTRUCTION WORK.

REQUIRED PIPE COVER "L"	REQUIRED PIPE DIAMETER "D"
42 INCHES	8 INCH
30 INCHES	1 INCH
48 INCHES	8 INCH
36 INCHES	4 INCH
72 INCHES	VARIES
36 INCHES	10 INCH
24 INCHES	10 INCH
18 INCHES	10 INCH

- NOTES:**
- TRACER WIRE SHALL BE TAPED AT 10-FOOT INTERVALS TO THE TOP OF ALL WATER AND SEWER PRESSURE MAINS, AND WATER SERVICE LINES.
  - BEDDING MATERIAL SHALL BE PLACED UNDER ALL PIPE PRIOR TO PLACING PIPE.
  - TRENCHES MAY BE BACKFILLED WITH CONTROLLED DENSITY FILL.
  - ALL UTILITIES (PHONE, GAS, CABLE TV, TELECOMMUNICATIONS, ELECTRIC, WATER, SEWER, STORM, ETC.) SHALL MEET THE REQUIREMENTS OF THIS DETAIL.
  - WHERE THE DEPTH OF COVER IS LESS THAN 30 INCHES, THE ENGINEER SHALL DETERMINE THE LOCATION OF THE MARKING TAPE.
  - PIPE COVER (L) AND PIPE DIAMETER (D) MAY BE LONGER THAN REQUIRE BY TABLE B-3.
  - BUILDING SEWERS SHOULD BE INSTALLED BELOW WATER LINES. CASING IS NOT REQUIRED ON BUILDING SEWERS.
  - ENGINEER MAY APPROVE DEVIATIONS TO BUILDING SEWER LOCATIONS WHEN EXISTING CONDITIONS PREVENT COMPLIANCE WITH THIS DETAIL.
  - ALL CONSTRUCTION AND MATERIALS SHALL MEET THE SPECIFICATIONS AND REQUIRE AUTHORIZATION BY THE CITY OF MOSES LAKE.

**TRENCHING AND BEDDING**

MUNICIPAL SERVICES DEPT. - ENGINEERING DIVISION  
CITY OF MOSES LAKE

**B-3**

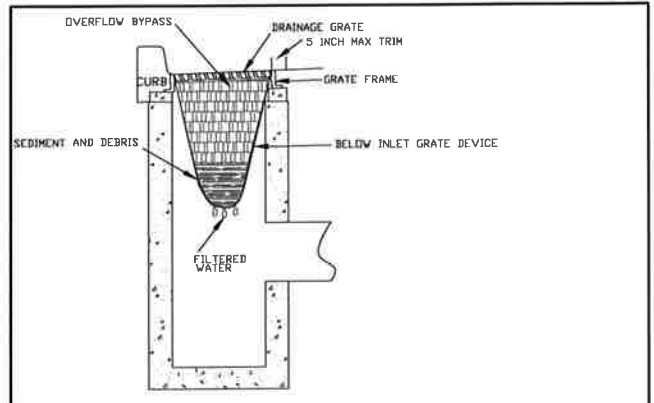

CATCH BASIN  
SECTION VIEW NOT TO SCALE

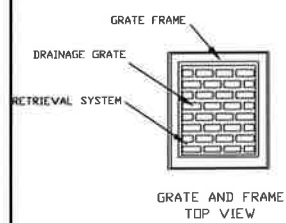

- NOTE:**
- SIZE THE BELOW INLET GRATE DEVICE (BIGD) FOR THE STORM WATER STRUCTURE IT WILL SERVICE.
  - THE BIGD SHALL HAVE A BUILT-IN HIGH-FLOW RELIEF SYSTEM (OVERFLOW BYPASS).
  - THE RETRIEVAL SYSTEM SHALL ALLOW REMOVAL OF THE BIGD WITHOUT SPILLING THE COLLECTED MATERIAL.
  - MAINTENANCE SHALL BE PERFORMED IN ACCORDANCE WITH STANDARD SPECIFICATION 8-01.9(15).
  - ALL CONSTRUCTION AND MATERIALS SHALL MEET THE SPECIFICATIONS AND REQUIRE AUTHORIZATION BY THE CITY OF MOSES LAKE.

**INLET PROTECTION BELOW INLET GRATE DEVICE**

MUNICIPAL SERVICES DEPT. - ENGINEERING DIVISION  
CITY OF MOSES LAKE

**A-14**

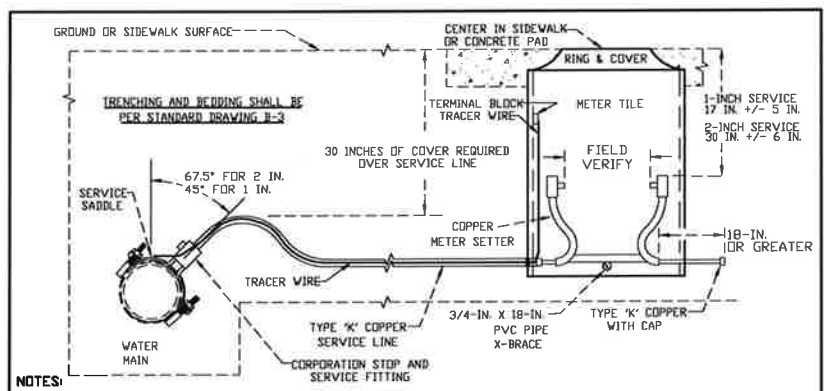

- NOTES:**
- METER TILE SHALL BE CENTERED IN A 5-FOOT BY 5-FOOT BY 6-INCH-THICK CONCRETE PAD OR SIDEWALK. WATER SERVICES BEYOND THE RIGHT-OF-WAY SHALL BE INSTALLED FROM A PRIVATE WATER MAIN.
  - CONNECT SERVICE TRACER WIRE TO WATER MAIN TRACER WIRE WITH BRASS WIRE CLAMP. BRASS WIRE CLAMP SHALL BE SPLIT-BOLT CONNECTOR OR OTHER CONNECTOR AS AUTHORIZED BY THE ENGINEER.
  - SERVICE LINE SHALL BE INSTALLED WITHOUT JOINTS.
  - SERVICE LINES ON THE SERVICE SIDE OF THE SETTER SHALL BE COPPER TYPE "K" COPPER TYPE L, PEX, PVC SCHEDULE 40 OR GREATER, PE 200 PSI OR GREATER, CPVC, OR AS AUTHORIZED BY THE BUILDING OFFICIAL.
  - ALL CONSTRUCTION AND MATERIALS SHALL MEET THE SPECIFICATIONS AND REQUIRE AUTHORIZATION BY THE CITY OF MOSES LAKE.

**1-INCH AND 2-INCH WATER SERVICE**

MUNICIPAL SERVICES DEPT. - ENGINEERING DIVISION  
CITY OF MOSES LAKE

**B-7**

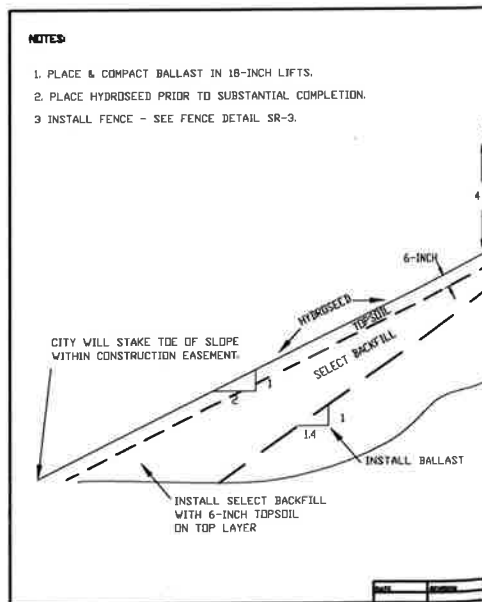

- NOTES:**
- PLACE & COMPACT BALLAST IN 18-INCH LIFTS.
  - PLACE HYDROSEED PRIOR TO SUBSTANTIAL COMPLETION.
  - INSTALL FENCE - SEE FENCE DETAIL SR-3.





## LEGEND

### PROPOSED

- |  |                             |  |              |
|--|-----------------------------|--|--------------|
|  | PROPOSED SAWCUT LINE        |  | WATER METER  |
|  | WATER                       |  | FIRE HYDRANT |
|  | SAN. SEWER                  |  | WATER VALVE  |
|  | STORM SEWER                 |  | SIGN         |
|  | REMOVE AND REPLACE CONCRETE |  | MAIL BOX     |
|  | DRIVEWAY                    |  | MANHOLE      |
|  |                             |  | CATCH BASIN  |
|  |                             |  | DRYWELL      |

**CALL 2 DAYS  
BEFORE YOU DIG  
1-800-424-5555**

### EXISTING

- |  |                   |  |                    |
|--|-------------------|--|--------------------|
|  | R/W PROPERTY LINE |  | STREET MONUMENT    |
|  | CENTER LINE       |  | SIGN               |
|  | EDGE OF ASPHALT   |  | FIRE HYDRANT       |
|  | EDGE OF GRAVEL    |  | WATER METER        |
|  | EDGE OF CONCRETE  |  | WATER VALVE        |
|  | WATER LINE        |  | MANHOLE            |
|  | SEWER             |  | CATCH BASIN        |
|  | STORM SEWER       |  | DRYWELL            |
|  | GAS LINE          |  | POWER POLE         |
|  | BURIED POWER      |  | POWER POLE ANCHOR  |
|  | BURIED PHONE      |  | STREET LIGHT       |
|  | BURIED CABLE      |  | TELEPHONE PEDESTAL |
|  | LANDSCAPING       |  | DECIDUOUS TREE     |
|  | IRRIGATION        |  | CONIFEROUS TREE    |
|  | FENCE             |  | MAILBOX            |
|  |                   |  | PROPERTY CORNER    |

