



STATE OF WASHINGTON

WASHINGTON UTILITIES AND TRANSPORTATION COMMISSION

1300 S. Evergreen Park Dr. S.W., P.O. Box 47250 • Olympia, Washington 98504-7250  
(360) 664-1160 • TTY (360) 586-8203

June 12, 2009

Rick Rouse  
Port of Chehalis  
321 Maurin Road  
Chehalis, WA 98532

Rick Burchett  
Chehalis and Centralia Railroad and Museum  
1945 South Market Blvd.  
Chehalis, WA 98532

**RE: TR-090980 Petition from the Washington State Parks and Recreation  
Commission – Willapa Hills Trail**

Dear Mr. Rouse and Mr. Burchett:

On June 5, 2009, the Washington State Parks and Recreation Commission (Parks) filed a petition with the Washington Utilities and Transportation Commission (commission) seeking approval to establish a new at-grade pedestrian-only rail grade crossing along the Willapa Hills Trail in the city of Chehalis. Horses will also have access to use the trail and thus the crossing. The commission assigned docket TR-090980 to this petition.

Commission records indicate that the Port of Chehalis owns this track and the Chehalis and Centralia Railroad and Museum operates on this track. Therefore, we are providing both of you notice of the petition filed by Parks.

Please review the attached petition and respond by July 2, 2009. Your response options include:

- Support the petition – Complete the Respondent's Waiver of Hearing form, which serves as your consent for the commission to issue an order without further notice or hearing.
- Do not support the petition – Reply with your position and include whether you believe a hearing is necessary to resolve the issues. You may also suggest other courses of action, such as further discussion prior to going to hearing.



Rick Rouse  
Rick Burchett  
June 12, 2009  
Page 2

If you do not respond within 20 days of the date of this letter, we will assume you do not support the petition and will set the matter for hearing. You will be required to attend the hearing and respond to the commission.

If you have any questions, please contact Kathy Hunter at (360) 664-1257 or at [khunter@utc.wa.gov](mailto:khunter@utc.wa.gov).

Sincerely,

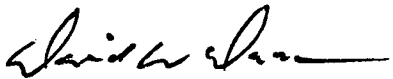

David W. Danner  
Director and Executive Secretary

Enclosure

cc: Hon Lee, Washington State Parks and Recreation Commission

WASHINGTON UTILITIES AND TRANSPORTATION COMMISSION

WA State Parks & Recreation Commission

Petitioner,

vs.

1. Port of Chehalis
2. Chehalis Centralia Railroad & Museum

Respondent

DOCKET NO. TR- 090980

PETITION TO CONSTRUCT OR  
 RECONSTRUCT A HIGHWAY-RAIL  
 GRADE CROSSING

The Petitioner asks the Washington Utilities and Transportation Commission to approve construction or reconstruction of a highway-rail grade crossing.

Construction       Reconstruction

RECEIVED  
 WASHINGTON UTILITIES AND TRANSPORTATION COMMISSION  
 2009 JUN -5 PM 2:37

*Section 1 – Petitioner’s Information*

Washington State Parks & Recreation Commission

Petitioner

11834 Tilley Road S.

Street Address

Olympia, WA 98512

City, State and Zip Code

Mailing Address, if different than the street address

Hon Lee

Contact Person Name

360-956-4826 / hon.lee@parks.wa.gov

Contact Phone Number and E-mail Address

*Section 2 – Respondent's Information*

<u>1.Port of Chehalis</u> Respondent
<u>321 Maurin Road</u> Street Address
<u>Chehalis, WA 98532</u> City, State and Zip Code
<u>Same as above</u> Mailing Address, if different than the street address
<u>Rick Rouse</u> Contact Person Name
<u>360-748-9365 /rrouse@portofchehalis.com</u> Contact Phone Number and E-mail Address

<u>2.Chehalis Centralia Railroad &amp; Museum</u> Respondent
<u>1945 S. Market Blvd.</u> Street Address
<u>Chehalis, WA 98532</u> City, State and Zip Code
<u>Same as above</u> Mailing Address, if different than the street address
<u>Rick Burchett</u> Contact Person Name
<u>360-570-9191 / a22twin@comcast.net</u> Contact Phone Number and E-mail Address

**Section 3 – Proposed Crossing Location**

1. Existing highway/roadway Willapa Hills Trail
2. Existing railroad The Port of Chehalis Curtis Line
3. Location of proposed crossing:  
Located in the \_\_\_ 1/4 of the \_\_\_ 1/4 of Sec. 1 , Twp. 13N , Range 3W W.M.
4. GPS location, if known \_\_\_\_\_
5. Railroad mile post (nearest tenth) 1.5
6. City Chehalis County Lewis

**Section 4 – Proposed Crossing Information**

1. Railroad company Chehalis Centralia Railroad & Museum

2. Type of railroad at crossing     Common Carrier     Logging     Industrial

Passenger                     Excursion

3. Type of tracks at crossing     Main Line     Siding or Spur

4. Number of tracks at crossing    1

5. Average daily train traffic, freight    N/A

          Authorized freight train speed 10 mph    Operated freight train speed N/A

6. Average daily train traffic, passenger    2

          Authorized passenger train speed 15 mph    Operated passenger train speed 15 mph

7. Will the proposed crossing eliminate the need for one or more existing crossings?

          Yes         No   X  

8. If so, state the distance and direction from the proposed crossing.

          N/A

\_\_\_\_\_

\_\_\_\_\_

\_\_\_\_\_

9. Does the petitioner propose to close any existing crossings?

          Yes         No   X

**Section 5 – Temporary Crossing**

1. Is the crossing proposed to be temporary?      Yes \_\_\_\_\_ No  X

2. If so, describe the purpose of the crossing and the estimated time it will be needed

\_\_\_\_\_

\_\_\_\_\_

\_\_\_\_\_

3. Will the petitioner remove the crossing at completion of the activity requiring the temporary crossing?      Yes \_\_\_\_\_ No  X

Approximate date of removal \_\_\_\_\_

**Section 6 – Current Highway Traffic Information**

1. Name of roadway/highway  Willapa Hills Trail

2. Roadway classification \_\_\_\_\_

3. Road authority \_\_\_\_\_

4. Average annual daily traffic (AADT)  20 bicyclist & 30 pedestrians (Summer)

5. Number of lanes  1 bicycle lane and 1 horse lane

6. Roadway speed  20 mph (bicyclist)

7. Is the crossing part of an established truck route?      Yes \_\_\_\_\_ No  X

8. If so, trucks are what percent of total daily traffic?  N/A

9. Is the crossing part of an established school bus route?      Yes \_\_\_\_\_ No  X

10. If so, how many school buses travel over the crossing each day? \_\_\_\_\_

11. Describe any changes to the information in 1 through 7, above, expected within ten years:

Parks expect about 10 percent increase use for the trail.

*Section 7 – Alternatives to the Proposal*

1. Does a safer location for a crossing exist within a reasonable distance of the proposed location?

Yes  No

2. If a safer location exists, explain why the crossing should not be located at that site.

---

---

---

3. Are there any hillsides, embankments, buildings, trees, railroad loading platforms or other barriers in the vicinity which may obstruct a motorist's view of the crossing?

Yes  No

4. If a barrier exists, describe:

- ◆ Whether petitioner can relocate the crossing to avoid the obstruction and if not, why not.
- ◆ How the barrier can be removed.
- ◆ How the petitioner or another party can mitigate the hazard caused by the barrier.

Some vegetation has grown on the east side of existing crossing. The vegetation decreases  
a bicyclist's sight distance. Parks' will maintain the clearance of vegetation within 200 feet  
of the crossing.

---

5. Is it feasible to construct an over-crossing or under-crossing at the proposed location as an alternative to an at-grade crossing?

Yes  No

6. If an over-crossing or under-crossing is not feasible, explain why.

---

---

---

---

---



7. Does the railway line, at any point in the vicinity of the proposed crossing, pass over a fill area or trestle or through a cut where it is feasible to construct an over-crossing or an under-crossing, even though it may be necessary to relocate a portion of the roadway to reach that point?

Yes  X  No      

8. If such a location exists, state:

- ◆ The distance and direction from the proposed crossing.
- ◆ The approximate cost of construction.
- ◆ Any reasons that exist to prevent locating the crossing at this site.

\_\_\_\_\_

Parks considered under-crossing option. However, Parks suspended the idea of under-crossing due to the following reasons:

- \_\_\_\_\_
- \_\_\_\_\_
1. Height clearance.
  2. The crossing is located in flood zone area and it will submerge into water during winter time.
  3. The proposed crossing is out of State Park Right of Way.
  4. The proposed crossing will have more impact on the environment.

9. Is there an existing public or private crossing in the vicinity of the proposed crossing?

Yes       No  X

10. If a crossing exists, state:

- ◆ The distance and direction from the proposed crossing.
- ◆ Whether it is feasible to divert traffic from the proposed to the existing crossing.

N/A

\_\_\_\_\_

\_\_\_\_\_

\_\_\_\_\_



3. If not, state the percentage of grade prior to the level grade and explain why the grade exceeds five percent.

---

---

---

---

***Section 9 – Illustration of Proposed Crossing Configuration***

Attach a detailed diagram, drawing, map or other illustration showing the following:

- ◆ The vicinity of the proposed crossing.
- ◆ Layout of the railway and highway 500 feet adjacent to the crossing in all directions.
- ◆ Percent of grade.
- ◆ Obstructions of view as described in Section 7 or identified in Section 8.
- ◆ Traffic control layout showing the location of the existing and proposed signage.

***Section 10 – Proposed Warning Signals or Devices***

1. Explain in detail the number and type of automatic signals or other warning devices planned at the proposed crossing, including a cost estimate for each.

---

---

(2) Crossbuck signs and (2) Advance warning signs.

(2) Stop signs and Emergency call sign and Stop bars and Flange way filler.

Striping for RR crossing

Total cost: \$6,000

---

---

---

---

2. Provide an estimate for maintaining the signals for 12 months. \_\_\_\_\_

3. Is the petitioner prepared to pay to the respondent railroad company its share of installing the warning devices as provided by law?

Yes  X  No \_\_\_\_\_

***Section 11 – Additional Information***

Provide any additional information supporting the proposal, including information such as the public benefits that would be derived from constructing a new crossing as proposed.

Parks proposed to provide a safe trail from Chehalis and Adna to the general public. The trail users can use this corridor and travel from Chehalis to Adna upon the completion of proposed railroad crossing. The trail will provide the following benefits to the public:

1. Provide accessible, widely available and low cost opportunities to meet the physical activity need of most Chehalis and Adna residences.
2. Attract tourists to the local communities
3. Provide recreational opportunities to Chehalis and Adna communities.
4. Provide quality time with family in a safe environment.
5. Provide an alternative mode of transportation

*Section 12 – Waiver of Hearing by Respondent #1*

**Port of Chehalis  
Waiver of Hearing**

The undersigned represents the Respondent in the petition to construct or reconstruct a highway-railroad grade crossing.

We have investigated the conditions at the proposed or existing crossing site. We are satisfied the conditions are the same as described by the Petitioner in this docket. We agree that a crossing be installed or reconstructed and consent to a decision by the commission without a hearing.

Dated at \_\_\_\_\_, Washington, on the \_\_\_\_\_ day of  
\_\_\_\_\_, 20 \_\_\_\_.

Port of Chehalis

Printed name of Respondent

Signature of Respondent's Representative

Title

Phone number and e-mail address

Mailing address

*Section 12 – Waiver of Hearing by Respondent #2*

**Chehalis Centralia Railroad & Museum  
Waiver of Hearing**

The undersigned represents the Respondent in the petition to construct or reconstruct a highway-railroad grade crossing.

We have investigated the conditions at the proposed or existing crossing site. We are satisfied the conditions are the same as described by the Petitioner in this docket. We agree that a crossing be installed or reconstructed and consent to a decision by the commission without a hearing.

Dated at \_\_\_\_\_, Washington, on the \_\_\_\_\_ day of  
\_\_\_\_\_, 20 \_\_\_\_.

\_\_\_\_\_  
Chehalis Centralia Railway & Museum

\_\_\_\_\_  
Printed name of Respondent

\_\_\_\_\_  
Signature of Respondent's Representative

\_\_\_\_\_  
Title

\_\_\_\_\_  
Phone number and e-mail address

\_\_\_\_\_  
Mailing address

CD: HQ:A10001-1\FIELD.DWG

NO.	DATE	BY	REVISIONS
1	01/01/01	AAA	DESIGNED
2	01/01/01	AAA	DRAWN
3	01/01/01	AAA	CHECKED (FIELD)
4	01/01/01	AAA	CHECKED (OFFICE)

NO.	DATE	BY	REVISIONS
1	01/01/01	AAA	DESIGNED
2	01/01/01	AAA	DRAWN
3	01/01/01	AAA	CHECKED (FIELD)
4	01/01/01	AAA	CHECKED (OFFICE)

PROJECT ENGINEER

**WASHINGTON STATE PARKS AND RECREATION COMMISSION**



**RAINBOW FALLS STATE PARK - WILLAPA HILLS TRAIL**

**PAVING & TRAILHEAD**

**WILLAPA HILLS TRAIL - OVERVIEW**

SCALE AS SHOWN

FILE NO.

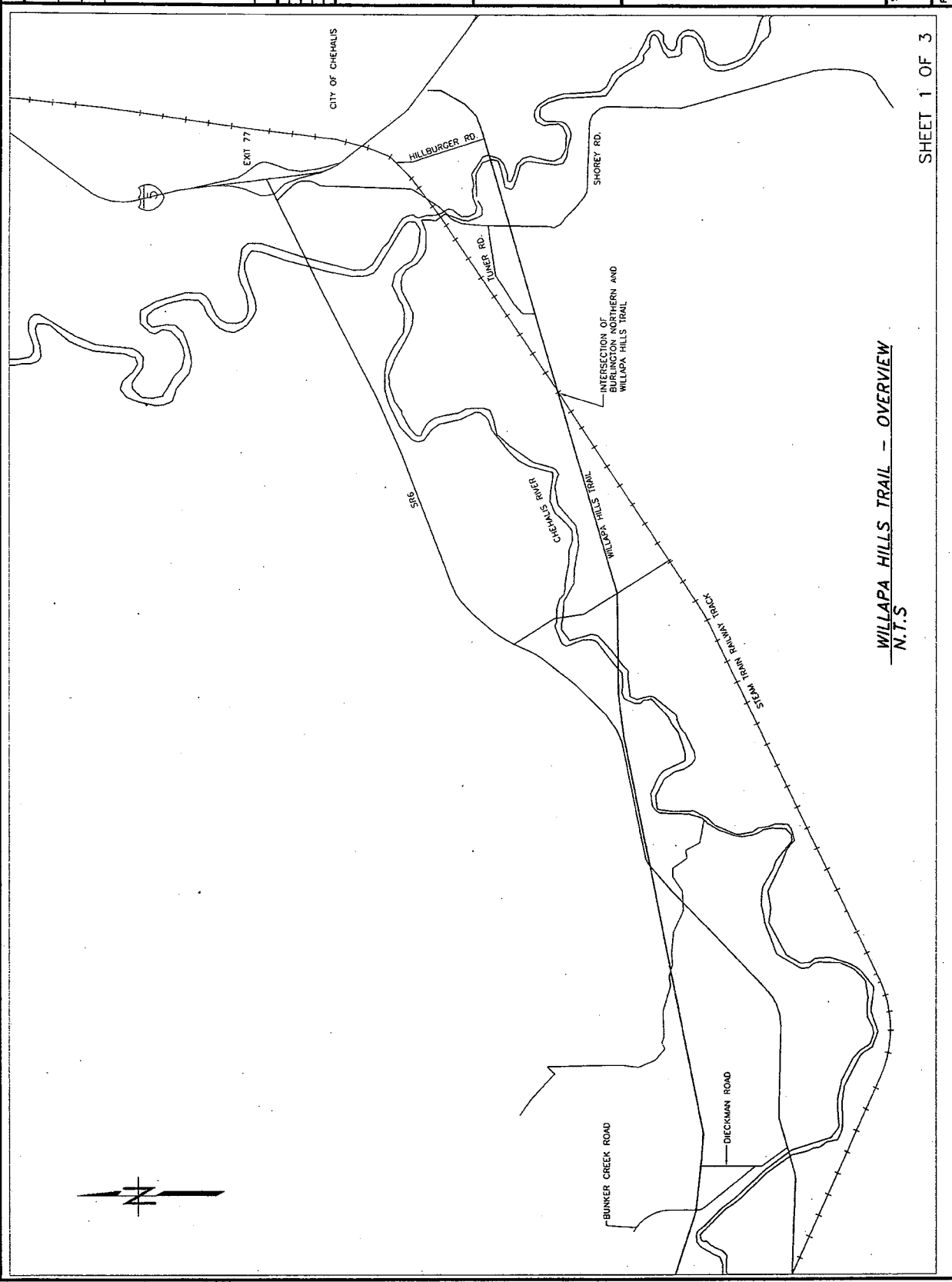

**WILLAPA HILLS TRAIL - OVERVIEW**  
N.T.S

CAD NO. A10001-1 \ FILE.DWG

DATE	
APP.	
INT.	
REVISIONS	

BY	DATE
DESIGNED	01/01/01
DRAWN	01/01/01
CHECKED (FIELD)	01/01/01
CHECKED (OFFICE)	01/01/01

PROJECT ENGINEER

**WASHINGTON STATE PARKS AND RECREATION COMMISSION**

RAINBOW FALLS STATE PARK  
WILLAPA HILLS TRAIL  
PAVING & TRAILHEAD  
EXISTING SITE PLAN - RAILROAD CROSSING

SCALE

FILE NO.

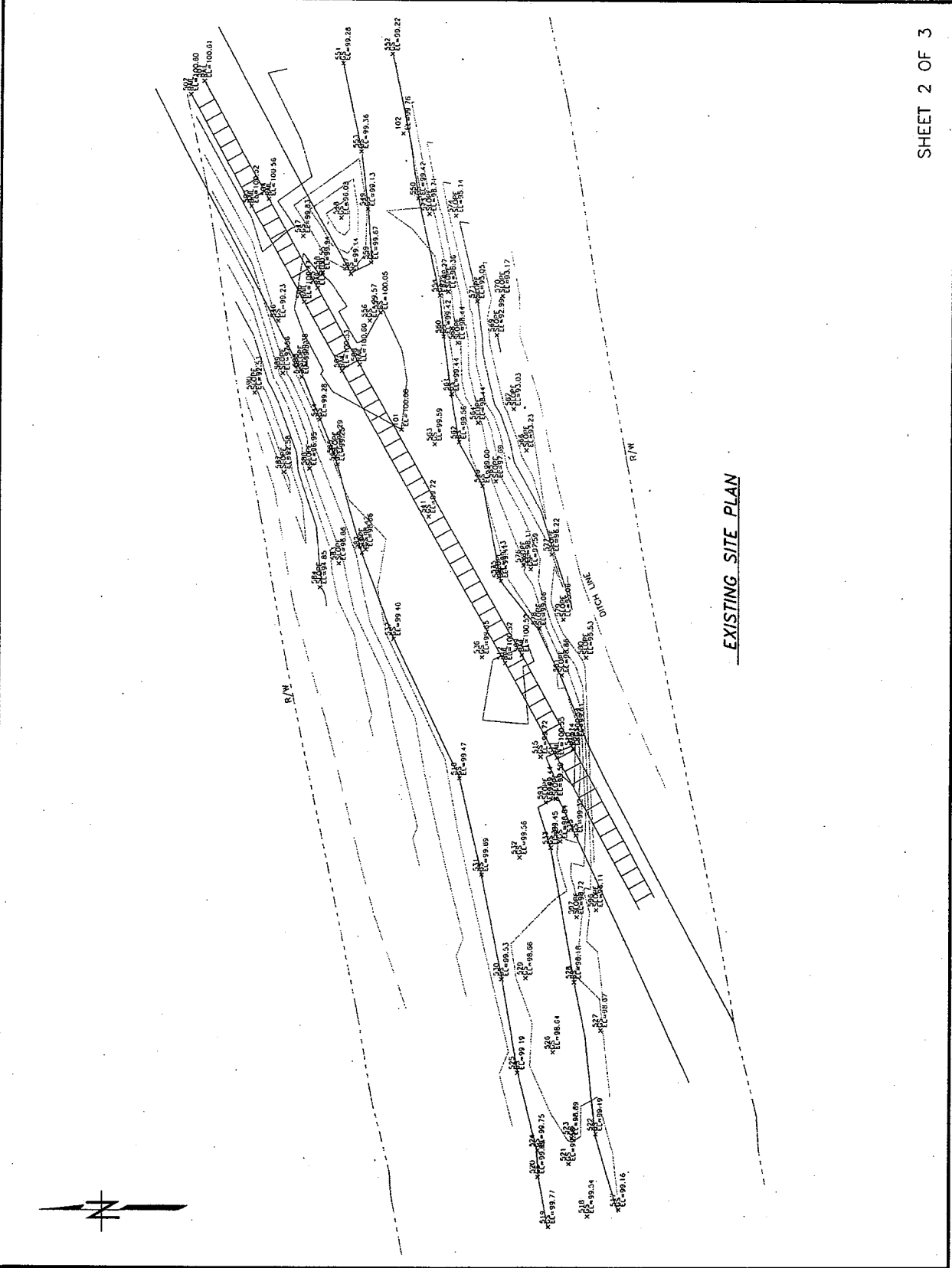



CAD NO. A-10001 - FILE.DWG

NO.	REVISIONS	BY	DATE
		AAA	10/27/01
		AAA	10/27/01
		AAA	10/27/01
		AAA	10/27/01

ACTION	BY	DATE
DESIGNED	AAA	10/27/01
DRAWN	AAA	10/27/01
CHECKED (E.L.S.)	AAA	10/27/01
CHECKED (H.D.S.)	AAA	10/27/01

PROJECT ENGINEER  
**WASHINGTON STATE PARKS AND RECREATION COMMISSION**



RAINBOW FALLS STATE PARK - WILLAPA HILLS TRAIL

PAVING & TRAILHEAD

LAYOUT PLAN - RAILROAD CROSSING

SCALE AS SHOWN

FILE NO.

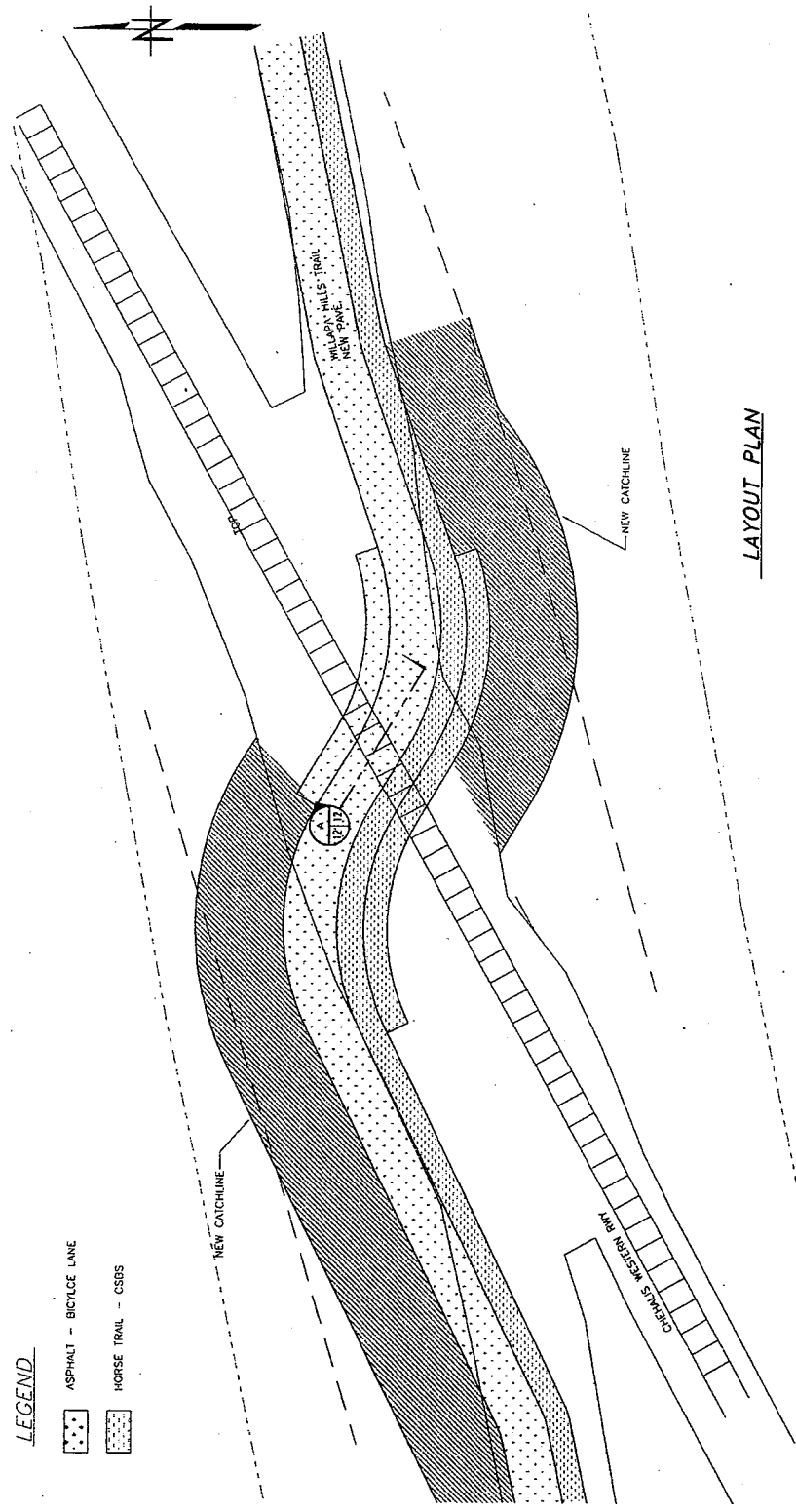

LAYOUT PLAN

LEGEND

- ASPHALT - BICYCLE LANE
- HORSE TRAIL - CSBS

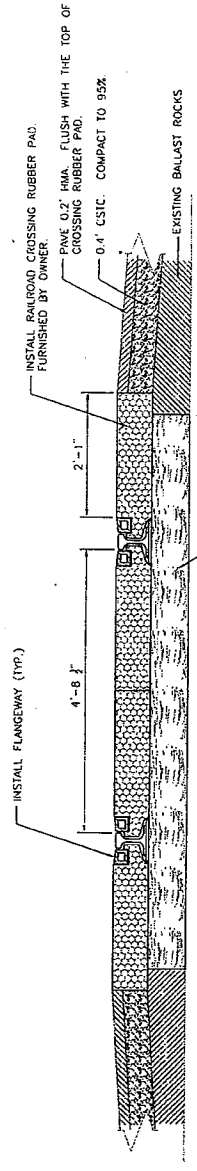

SECTION A-1 (SCALE)

