

TR-090597

WASHINGTON



UTILITIES AND TRANSPORTATION  
COMMISSION

1300 S. Evergreen Park Drive SW  
PO Box 47250  
Olympia, WA 98504-7250  
(360)664-1257 or (360)664-1100  
Fax: (360)586-1150  
Web: [www.wutc.wa.gov](http://www.wutc.wa.gov)  
E-mail: [records@utc.wa.gov](mailto:records@utc.wa.gov)

**GRADE CROSSING PROTECTIVE FUND  
APPLICATION FOR FUNDING**

The Washington Utilities and Transportation Commission (commission), through its Grade Crossing Protective Fund (GCPF), funds projects that eliminate or mitigate public safety hazards at railroad crossings and along railroad rights-of-way in Washington State. Any public, private, or non-profit entity may submit an application to the commission for GCPF monies.

**Please complete and submit the following information as part of the application process:**

**Applicant Information**

Applicant Name:	Randy Robinson	
Organization:	Seattle Parks Department	
Address:	800 Maynard Avenue South, 3 <sup>rd</sup> Floor, Seattle, WA 98134	
Phone:	(206) 684-7035	
E-mail:	randy.robinson@seattle.gov	
Fax:	(206)233-3949	

Please list all other companies, organizations or state or local agencies that may be involved in implementing this proposal and the contact name, address and phone number for each.

**Project Information**

1. *Provide a detailed summary of the hazard being addressed. Include:*  
 Project Location: Carkeek Park, north Seattle  
 Carkeek Park is a large (186 acre) passive park with environmental education center, trails, picnicking, play area, and several hundred feet of waterfront on Puget Sound. The waterfront beach is separated from the main areas of the park by the Burlington Northern Sante Fe Railway line between Seattle and Everett. The park infrastructure includes a pedestrian bridge with stairs that cross over the railway tracks to allow park users safe access from the park to the beach.

Some park users, however, choose to access the beach by walking across the tracks from a grassy area at the southern edge of the park around the end of an existing safety fence (see photo). This grassy area is used by dog owners who often bring their dogs across the tracks on their way to the beach and thereby avoiding the bridge. Additionally, there are damaged sections of the existing fence in this area in need of replacement. One damaged

RECEIVED  
 RECORDS MANAGEMENT  
 2009 AUG 10 4:11:03 PM  
 STATE OF WASHINGTON  
 UTILITIES AND TRANSPORTATION COMMISSION

**Posted**

Grade Crossing Protective Fund Application Form

section has a hole in the chain link fabric large enough for a person to crawl through. There is significant risk of trespass in this stretch of tracks in the northern beach areas of Seattle. There have been fatal accidents in this vicinity in the past few years, including one death in June, 2009.

2. *Provide a detailed description of the proposed project and explain how it will eliminate or mitigate the hazard. Include any drawings or construction plans for the proposed project.*

This project proposes to construct approximately 100 lineal feet of new 6 foot high chain link fence and replace approximately 200 lineal feet of existing fence with new 6 foot high chain link fence. This work will take place on the east side of the BNSF Railway right-of-way in the southern portion of Carkeek Park to deter trespass and encourage pedestrian use of the existing bridge (see plan). Seattle Parks Department believes this additional fence work will improve safety for the park users.

3. *Provide cost estimates.*

Costs for the project include new fencing, fence modifications, and survey.

Construction mobilization and access	\$ 2,500
100 lf new fence @ \$ 36.00 per lf	\$ 3,600
200 lf new fence @ \$ 28.50 per lf	\$ 5,700
subtotal of construction cost of the project:	\$ 11,800
Washington State Sales Tax 9.5%	\$ 1,120
Survey	\$ 1,500
Administrative	\$ 1,000
<b>TOTAL PROJECT COST</b>	<b>\$ 15,420</b>

4. *Provide the name of the party responsible for long-term maintenance.*  
Maintenance will be performed by Seattle Parks Department.

5. *Provide an estimated timeline of project, if approved.*  
This project can be completed in 2009.

6. *Provide a description of how the project's success would be measured.*  
Success will be hard to measure because currently, baseline trespass is not being monitored or measured. After completion of the project Seattle Parks maintenance staff will observe the rate of trespass at Carkeek Park and compare to past visual observations.

7. *Provide any other information the applicant believes would be useful to the commission in considering the project.*

This project has obvious need due to developed patterns of use. Please observe the photograph showing the unauthorized but clearly defined path created by railway trespass.

## Grade Crossing Protective Fund Application Form

8. *If the project involves any construction, modification or demolition on a railroad right-of-way, complete the attached Railroad Commitment form. This includes fencing, gates or other structures located near enough to the tracks to be on the railroad right-of-way, modification to a grade crossing or any other project that involves railroad property or rights-of-way.*

Access and all construction work will occur on Seattle Parks Department property in Carkeek Park adjacent to the BNSF Railway right-of-way. All work will be coordinated with BNSF staff.

### **Submitting the Application**

After completing the GCPF application, please send the original to:

Washington Utilities and Transportation Commission  
Attention: Grade Crossing Protective Fund  
1300 S. Evergreen Park Drive SW  
PO Box 47250  
Olympia, WA 98504-7250

A signed application may be filed electronically at [records@utc.wa.gov](mailto:records@utc.wa.gov). When filing electronically, please specify "Grade Crossing Protective Fund" in the subject line.

### **Assistance**

For questions or assistance, please contact:

- Kathy Hunter at (360)664-1257 or by e-mail at [khunter@utc.wa.gov](mailto:khunter@utc.wa.gov).
- David Pratt at (360)664-1100 or by e-mail at [dpratt@utc.wa.gov](mailto:dpratt@utc.wa.gov).

**Railroad Commitment**

The undersigned represents the Railroad Company in the GCPF application described as (enter a brief description):

---

---

---

We have reviewed the application and are satisfied the conditions are the same as described by the applicant in this matter. We agree to allow construction, modification or demolition on a railroad right-of-way as described in the application.

---

Printed name of Railroad Representative

---

Signature of Railroad Representative

---

Title

---

Phone

---

E-mail

Date: \_\_\_\_\_

# LEGEND

- 6 Foot Contour
- 1 Foot Contour
- Ditchline
- Water Line
- Chain Link Fence
- Property Line
- Electric Line
- Center
- Outlet
- Circle
- Circle with Center
- Circle with Cross
- Circle with Star
- Circle with Square
- Circle with Triangle
- Circle with Diamond
- Circle with Hexagon
- Circle with Octagon
- Circle with Circle
- Circle with Square
- Circle with Triangle
- Circle with Diamond
- Circle with Hexagon
- Circle with Octagon
- Circle with Circle
- Circle with Square
- Circle with Triangle
- Circle with Diamond
- Circle with Hexagon
- Circle with Octagon

PUGET SOUND

BEACH

WILSON

PEDESTRIAN OVERPASS

CARKREEK PARK

200' OF REPLACE MENT FENCE

100 LF OF 6' - NEW CHAIN LINK FENCE WITH SIGNS

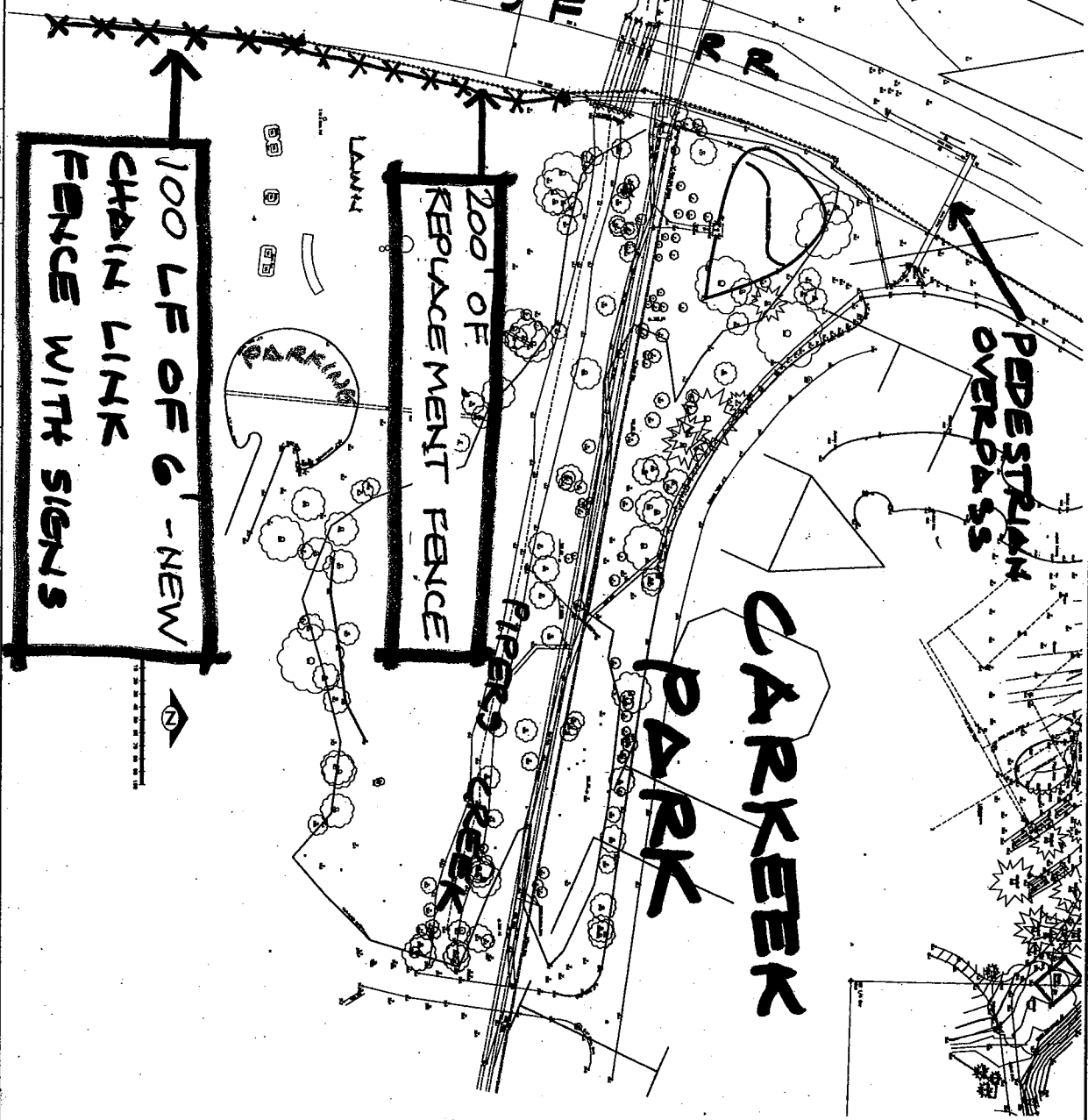

APPROVED FOR ADVERTISING  
 Director of Executive Administration  
 Kenneth J. Nakatani

DATE: \_\_\_\_\_

CITY OF SEATTLE

Carkreek Park  
 Proposed Sanitary Sewer Route  
 Topography

SCALE: 1"=50'

DATE: \_\_\_\_\_



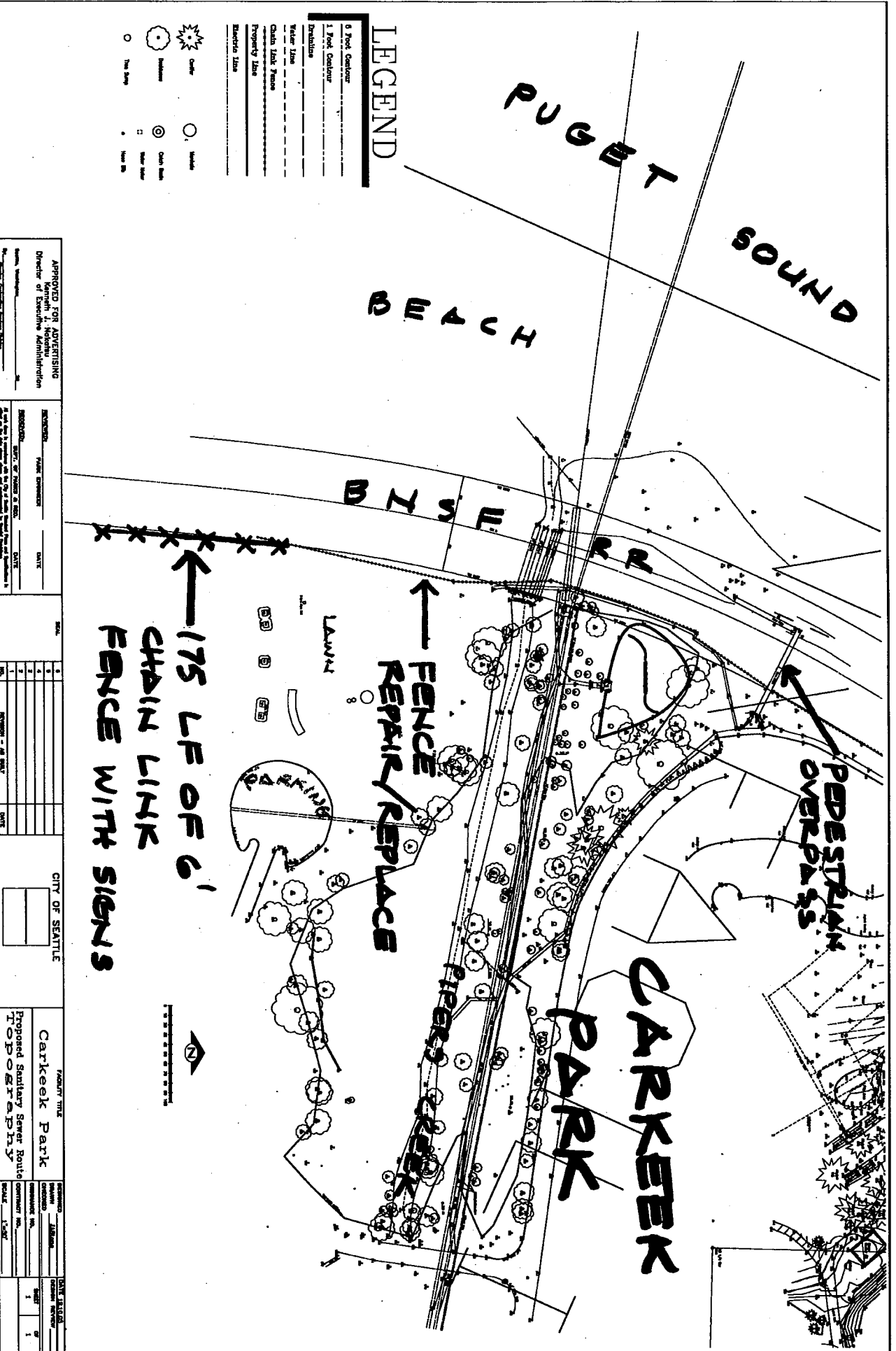

**LEGEND**

- 0 Foot Contour
- 1 Foot Contour
- Drainage
- Water Table
- Chain Link Fence
- Property Line
- Direction Sign

APPROVED FOR ADVERTISING  
 Director of Sanitary Administration  
 Name: \_\_\_\_\_ DATE: \_\_\_\_\_

NO.	DATE	REVISIONS - SEE SHEET
1		
2		
3		
4		
5		

CITY OF SEATTLE

PROJECT TITLE  
**Carkeek Park**  
 Proposed Sanitary Sewer Route  
 TOPOGRAPHY

DATE: 1-20-67

← 175 LF OF 6' CHAIN LINK FENCE WITH SIGNS

← FENCE REPAIR/REPLACE

← PEDESTRIAN OVERPASS

**CARRIEK PARK**

**DUGWAY SOUND**

**BEACH**

**BISSELL BLVD**

LAWN

PARKING

**CARRIEK PARK PARKWAY**

