

THURSTON COUNTY
WASHINGTON
 SINCE 1852

TR-041729
 COUNTY COMMISSIONERS

Cathy Wolfe
 District One

Diane Oberquell
 District Two

Robert N. Macleod
 District Three

ROADS & TRANSPORTATION SERVICES

Lester Olson
 Director

TO: Resident/Property Owner
FROM: Dave Nichols, Construction Engineering Manager
DATE: June 12, 2006
SUBJECT: Moon Rd / Gate Rd Intersection
 Vicinity Puget Sound & Pacific Railroad Crossing

RECEIVED
 JUN 14 8:02 AM '06
 STATE OF WASHINGTON
 DEPARTMENT OF TRANSPORTATION

Dear Resident/Property Owner:

As a result of several public meetings last year involving residents, representatives from Thurston County Roads & Transportation Services, Puget Sound and Pacific Railroad, and the Washington Utilities and Transportation Commission, the County has agreed to complete improvements to the intersection of Moon Road and Gate Road. The improvements consist of: reconstructing the intersection so that westbound traffic on Gate Road must stop at the intersection of Moon Road, a painted traffic island to better direct traffic around the curve, eliminating the stop sign for southbound traffic on Moon Road, widening and shifting the railroad crossing to improve alignment, and construction of a new timber railroad crossing. Attached for your information is a plan of the proposed improvements.

Construction is tentatively scheduled to begin the week of June 26, 2006. The construction will require that the section of Moon Road between Gate Road and Hunter Road be closed. There will also be times that two-way traffic is restricted to one lane in each direction.

If you have questions or concerns during construction you can contact Lucy Mills, Road Operations Supervisor at: cell 239-1322 office 709-3037.

We appreciate your patience during construction of this safety improvement project.

cc: Washington Utilities & Transportation Commission
 Puget Sound & Pacific Railroad



T.16 N. R.4 W. SEC. 25

EDGE OF PAVEMENT CURVE RETURN DATA

INTERSECTION	PC	PT	LENGTH
SOUTHWEST 40' RADIUS	121.62	121.82	121.82
SOUTHWEST 37' RADIUS	121.82	121.87	121.87
NORTHWEST 25' RADIUS	121.87	121.97	121.97
NORTHEAST 25' RADIUS	121.97	122.07	122.07

- CONSTRUCTION NOTES
- (F1) 24" PLASTIC STOP LINE
 - (F2) DOUBLE YELLOW CENTER LINE
 - (F3) EDGE LINE
 - (F4) EDGE LINE

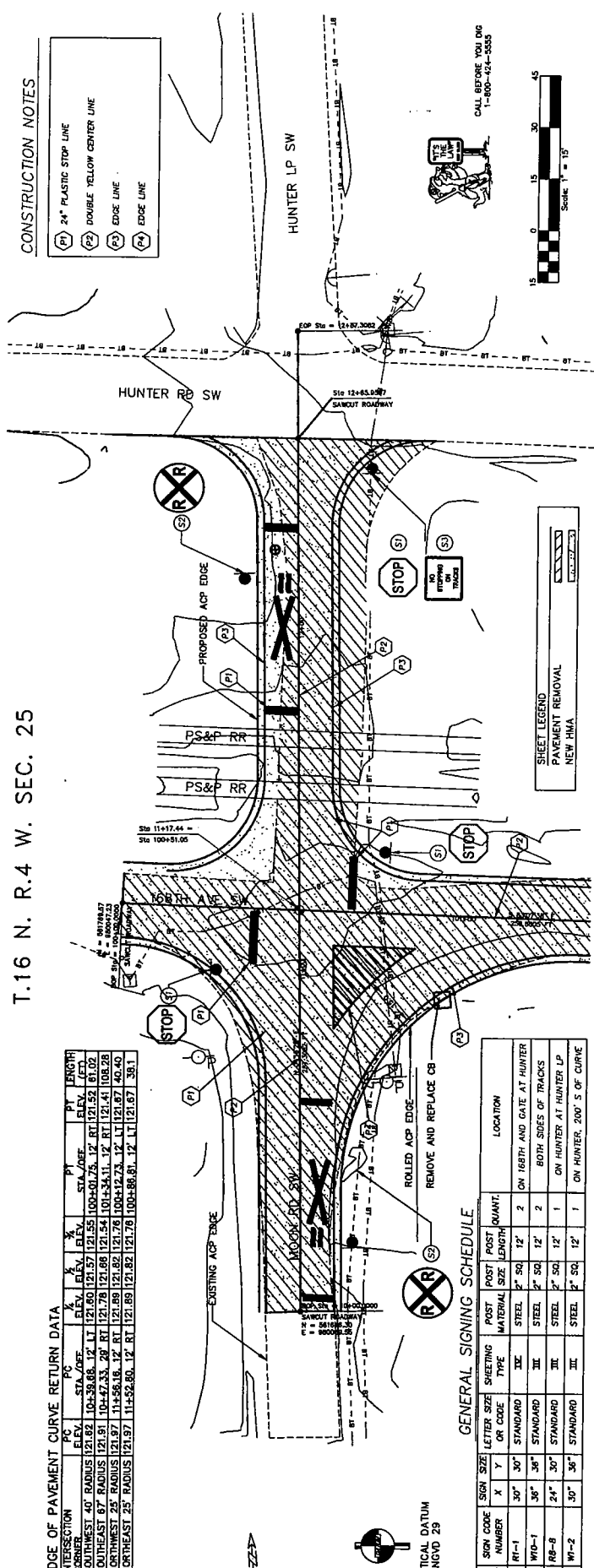

GENERAL SIGNING SCHEDULE

SYMBOL	SIGN CODE NUMBER	SIGN SIZE	LETTER SIZE	SHEETING	POST OR CODE	POST TYPE	POST SIZE	MATERIAL	POST LENGTH	QUANT.	LOCATION
(S1)	RF-1	30"	30"	STANDARD	III	STANDARD	27"	50'	12'	2	ON 168TH AND GATE AT HUNTER
(S2)	WD-1	36"	36"	STANDARD	III	STANDARD	27"	50'	12'	2	BOTH SIDES OF TRACKS
(S3)	RP-8	24"	30"	STANDARD	III	STANDARD	27"	50'	12'	1	ON HUNTER AT HUNTER LP
(S4)	WP-2	30"	36"	STANDARD	III	STANDARD	27"	50'	12'	1	ON HUNTER, 200' S OF CURVE

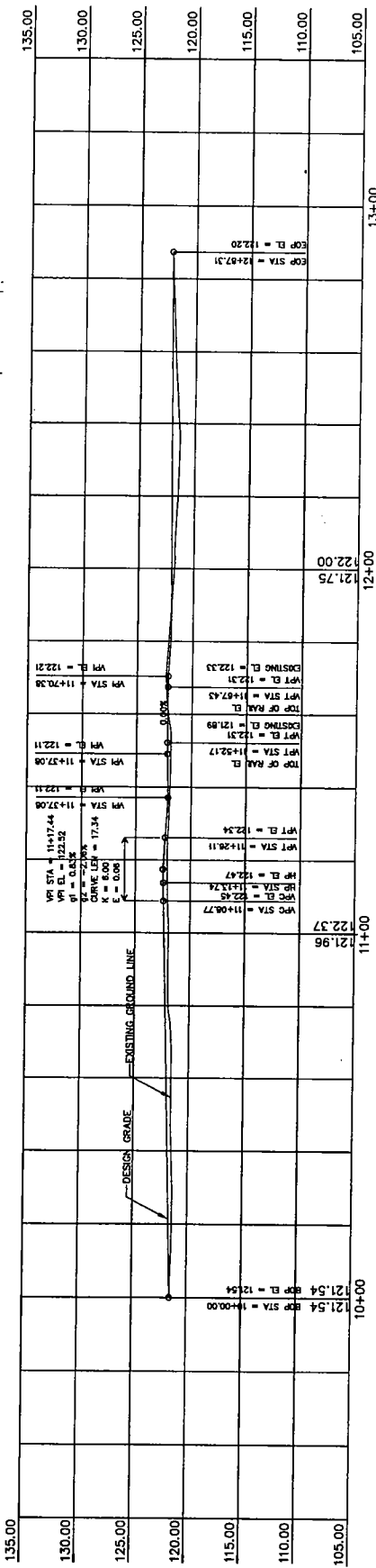

THURSTON COUNTY ROADS & TRANSP. SERVICES
 TRAFFIC DIVISION
 9605 B TILLEY RD
 OLYMPIA, WA 98502 (360) 786-6495

Designer: M. URZELMAN
 Draftsman: M. URZELMAN
 Checker: B. ADAM
 Scale: AS NOTED
 DWG FILE: AADWG

Revisions
 Date

MOON RD SW / GATE RD SW
 C.R.P. No. 060606 F.A. No. XXXXX

MOON RD PLAN & PROFILE

Sheet

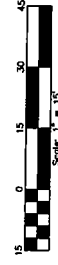

VERTICAL DATUM
 NGVD 29