

SERVICE DATE

NOV 13 1985

BEFORE THE WASHINGTON UTILITIES AND TRANSPORTATION COMMISSION

In the Matter of the Application )	
of THE WASHINGTON WATER POWER )	
COMPANY to Amend its Certificate )	CAUSE NO. U-85-67
of Public Convenience and Neces- )	
sity to Operate a Gas Plant for )	
Hire in the General Area of Adams )	ORDER GRANTING
County. )	APPLICATION
. . . . . )	

On September 23, 1985 The Washington Water Power Company (WWP), a Washington corporation, filed an application to amend its present Certificate of Public Convenience and Necessity to Operate a Gas Plant for Hire, No. 10 amended, to include additional area in Adams County. (Appendix A-24, amended).

WWP is presently certificated for and is now providing gas service in Adams County. The additional area in Adams County requested is not contiguous to the aforesaid presently certificated area in Adams County.

This order makes no determination at this time as to the reasonableness of any gas pipeline facility construction in this additionn to WWP's service area, but reserves the right of the Commission to determine such reasonable services and expenditures, together with the treatment of same, in any formal proceeding before the Commission dealing with WWP's results of operations for ratemaking purposes.

It appears that the application herein should be granted to satisfy the public convenience and necessity.

FINDINGS OF FACT

1. The Washington Water Power Company, a Washington corporation, operates a gas plant for hire in this state and is subject to the jurisdiction of this Commission.

2. WWP has heretofore been issued a Certificate of Public Convenience and Necessity to Operate a Gas Plant for Hire, No. 10, amended.

3. WWP has filed an application to amend its Certificate of Public Convenience and Necessity, No. 10, amended, to include an area in Adams County.

4. The operation of a gas plant for hire in the additional area requested is or will be required by the public convenience and necessity.

5. The Certificate of Public Convenience and Necessity to Operate a Gas Plant for Hire, No. 10, amended, presently held by WWP, should be further amended to include the additional area applied for herein.

O R D E R

1. IT IS HEREBY ORDERED That the application of The Washington Water Power Company to amend its Certificate of Public Convenience and Necessity to Operate a Gas Plant for Hire, No. 10, amended, to include an additional area in Adams County, is hereby approved and said Certificate shall be amended in accordance with attached Appendix A-24, amended, which, by this reference, is made a part hereof as though fully set forth herein.

2. IT IS FURTHER ORDERED That the Certificate of Public Convenience and Necessity to Operate a Gas Plant for Hire, above, No. 10, amended, issued pursuant to Order Paragraph No. 1, above, supersedes and cancels the Certificate of Public Convenience and Necessity to Operate a Gas Plant for Hire, No. 10, amended, and issued to The Washington Water Power Company on March 13, 1974 in Cause No. U-73-53. Said Certificate of March 13, 1974 shall be forthwith returned to this Commission.

3. IT IS FURTHER ORDERED That the Certificate issued pursuant to Order Paragraph No. 1, above, is subject to the terms, conditions and provisions of the Orders in Cause Nos. U-9021, U-9022, U-9023, U-9052, U-9115, U-9288, U-9591, U-9676, U-9764, U-9826, U-9954 and U-73-53.

4. IT IS FURTHER ORDERED That jurisdiction over this Cause is retained to effectuate the provisions of this order.

DATED at Olympia, Washington and effective this 13th day of November, 1985.

WASHINGTON UTILITIES AND TRANSPORTATION COMMISSION



SHARON L. NELSON, Chairman



ROBERT W. BRATTON, Commissioner



RICHARD D. CASAD, Commissioner

APPENDIX A-24 - LEGAL DESCRIPTION - KEYSTONE & VICINITY,  
ADAMS COUNTY

All of the area of Adams County lying within the area described as follows:

Beginning at the northeast corner of Sec. 10, T. 20 N., R. 37 E., and running southerly along the east line of Sec. 10 and 15, T. 20 N., R. 37 E. to the southeast corner of Sec. 15, T. 20 N., R. 37 E.; thence westerly along the south line of Sec. 15, 16 and 17, T. 20 N., R. 37 E. to the northeast corner of Sec. 19, T. 20 N., R. 37 E.; thence southerly along the east line of Sec. 19, T. 20 N., R. 37 E. to its southeast corner; thence westerly along the south line extended of Sec. 19, T. 20 N., R. 37 E and Sec. 24, 23 and 22, T. 20 N., R. 36 E. to the southwest corner of Sec. 22, T. 20 N., R. 36 E.; thence northerly along the west line of Sec. 22 and 15, T. 20 N., R. 36 E. to the northwest corner of Sec. 15, T. 20 N., R. 36 E.; thence easterly along the north line of Sec. 15, 14 and 13, T. 20 N., R. 36 E. to the northeast corner of Sec. 13, T. 20 N., R. 36 E; thence northerly along the west line of Sec. 7, T. 20 N., R. 37 E. to its northwest corner; thence easterly along the north line of Sec. 7, 8, 9 and 10, T 20 N., R. 37 E to the point of beginning.

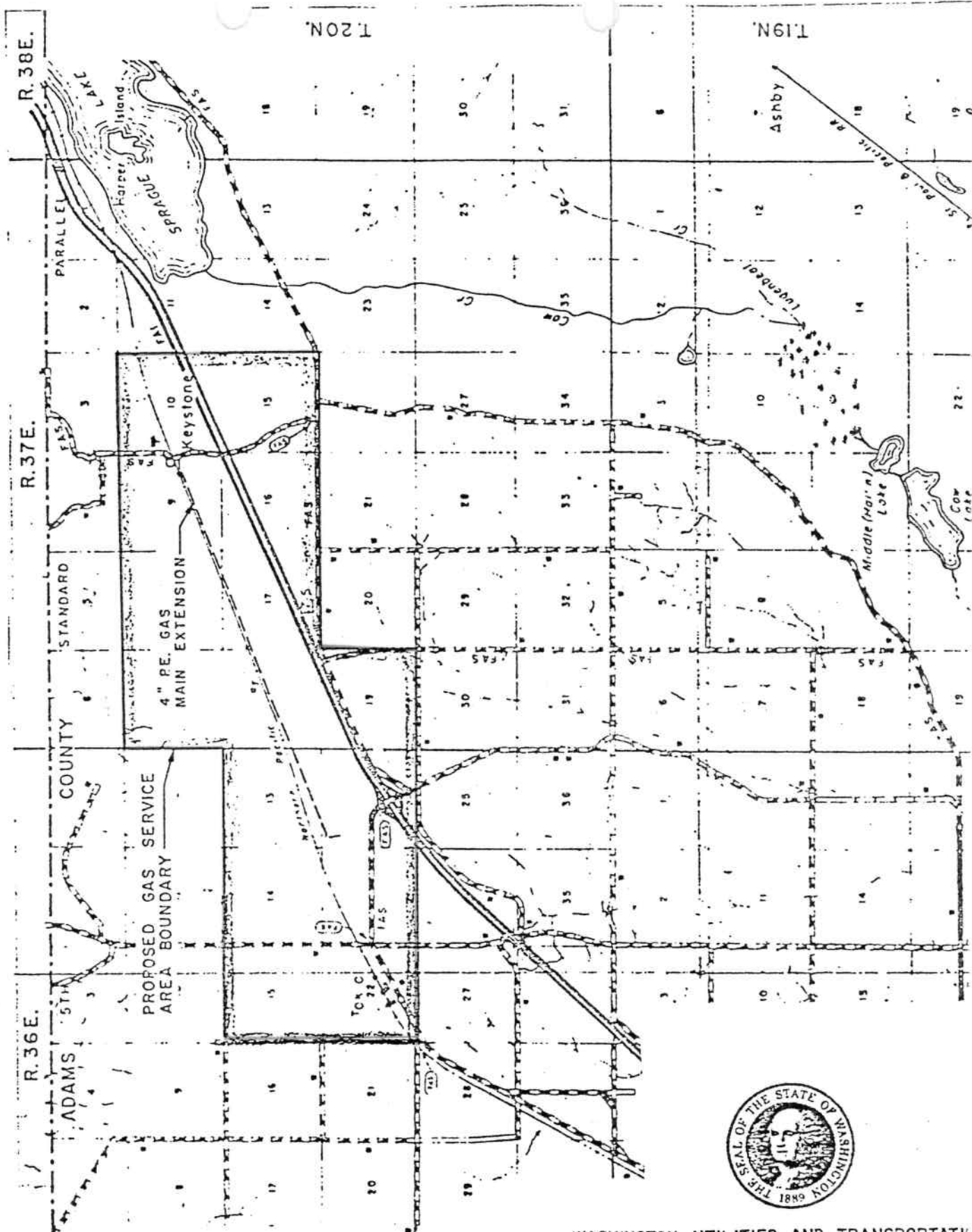

WASHINGTON UTILITIES AND TRANSPORTATION COMMISSION

Appendix A-24  
Cause U-85-67

The Washington Water Power Co.  
BOUNDARY OF SERVICE AREA