

GENERAL NOTES

- Grade crossing layout per BNSF Signal Department Standard Drawing No. DE0005.02, Figure 3.
- Proposed roadway design per JUB / Port of Pasco Reimann Industrial Center Phase 1 Road and Waterline Improvements dated August 2022. Proposed roadway is a 2-lane paved road with 12' travel lanes, 5' paved shoulder on west side of roadway, and 3' paved shoulder on east side of roadway. Lane markings include a double yellow centerline, and no fog lines.
- Roadway Design Speed = 50 MPH
- Rail Design Speed = 10 MPH
- Clear view triangle per WSDOT Design Manual Exhibit 1350-1.
- Proposed active warning will use constant warning time system.
- Crossing panels shall be common standard precast concrete panels on 10'-0" long wood ties, per BNSF standard DWG. NO. 200100. Panels shall be specially manufactured "curved concrete panels" to conform with curvature indicated. Curvature through crossing is 9°30'.
- Guardrails shall be Beam Guardrail Type 31, per WSDOT Standard Plan C-20.14-05, Case 3-31.



ISSUE	DATE	DESCRIPTION
1	XX/XX/XX	CONCEPT EXHIBIT

PROJECT MANAGER	WEBER, PAUL
RAIL LEAD	WEBER, PAUL
DRAWN BY	KELLY, SEAN
PROJECT NUMBER	10343022

**PORT OF PASCO
REIMANN INDUSTRIAL CENTER
UTC PETITION APPLICATION EXHIBIT**



FILENAME: POP RIC UTC Petition Exhibit Base.dwg
SCALE: 1" = 50'

SHEET
1 of 3

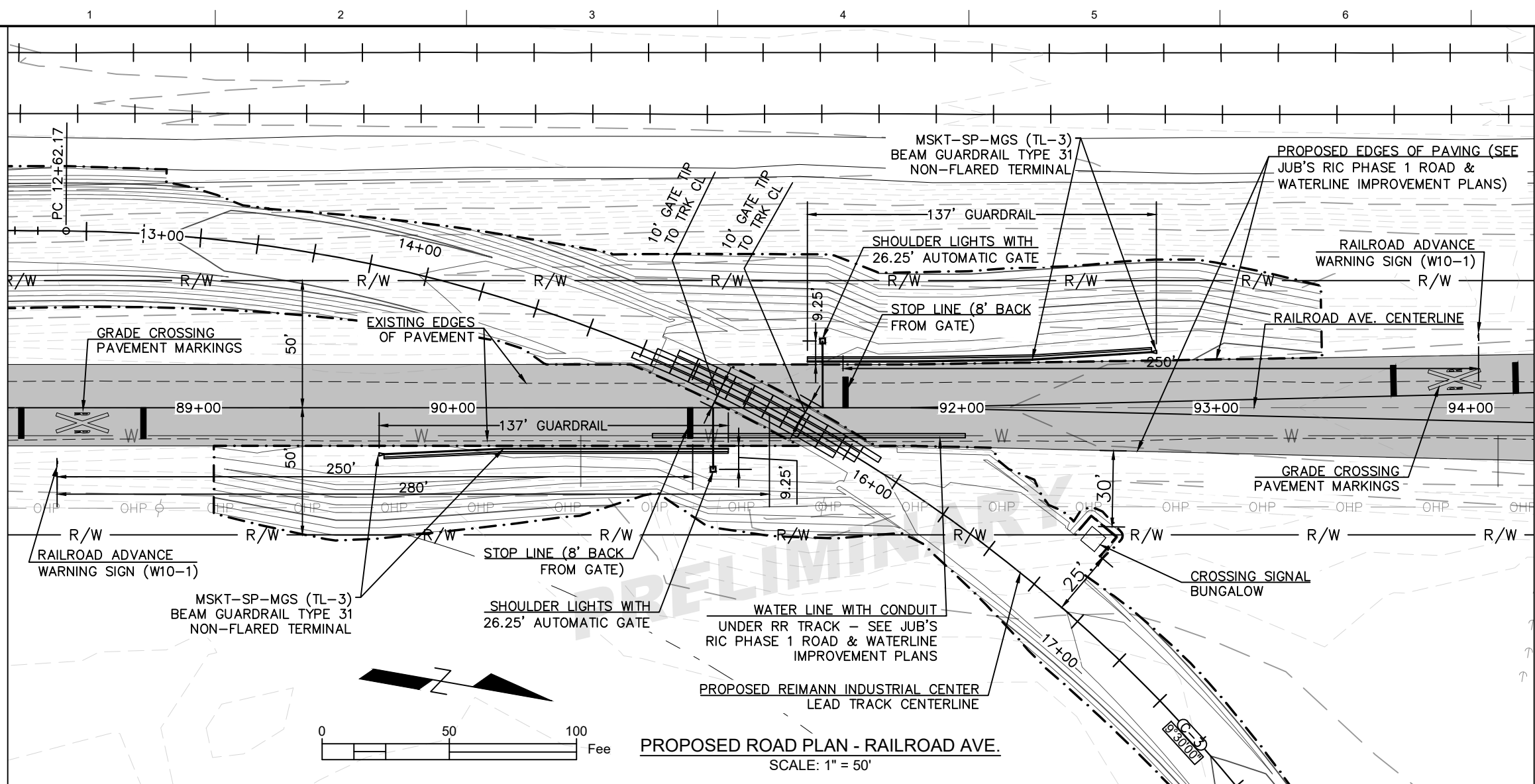

- GENERAL NOTES**
- Grade crossing layout per BNSF Signal Department Standard Drawing No. DE0005.02, Figure 3.
 - Proposed roadway design per JUB / Port of Pasco Reimann Industrial Center Phase 1 Road and Waterline Improvements dated August 2022. Proposed roadway is a 2-lane paved road with 12' travel lanes, 5' paved shoulder on west side of roadway, and 3' paved shoulder on east side of roadway. Lane markings include a double yellow centerline, and no fog lines.
 - Roadway Design Speed = 50 MPH
 - Rail Design Speed = 10 MPH
 - Clear view triangle per WSDOT Design Manual Exhibit 1350-1.
 - Proposed active warning will use constant warning time system.
 - Crossing panels shall be common standard precast concrete panels on 10'-0" long wood ties, per BNSF standard DWG. NO. 200100. Panels shall be specially manufactured "curved concrete panels" to conform with curvature indicated. Curvature through crossing is 9°30'.
 - Guardrails shall be Beam Guardrail Type 31, per WSDOT Standard Plan C-20.14-05, Case 3-31.

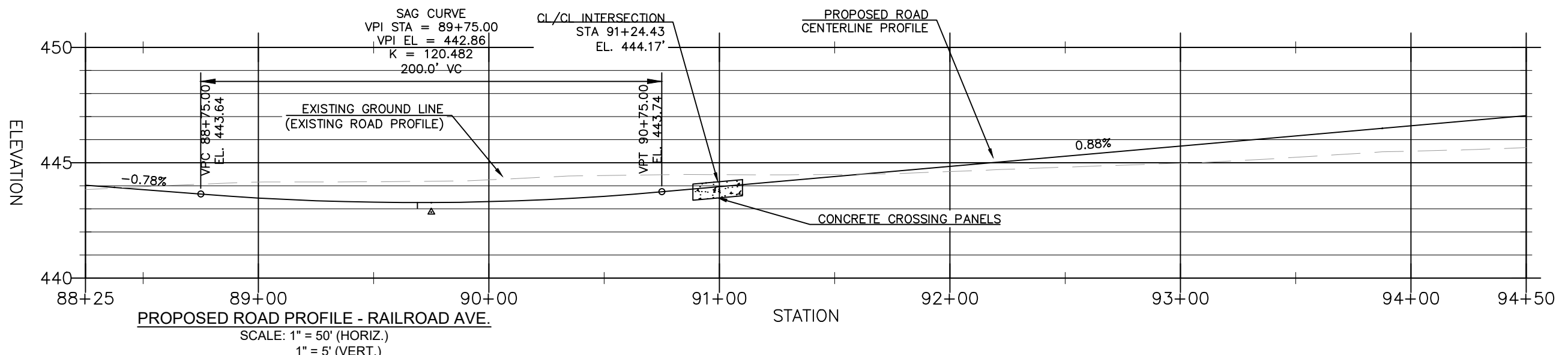

ISSUE	DATE	DESCRIPTION
1	XX/XX/XX	CONCEPT EXHIBIT

PROJECT MANAGER	WEBER, PAUL
RAIL LEAD	WEBER, PAUL
DRAWN BY	KELLY, SEAN
PROJECT NUMBER	10343022

**PORT OF PASCO
REIMANN INDUSTRIAL CENTER
UTC PETITION APPLICATION EXHIBIT**

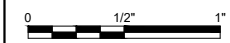

FILENAME | POP RIC UTC Petition Exhibit Base.dwg
SCALE | 1" = 50'

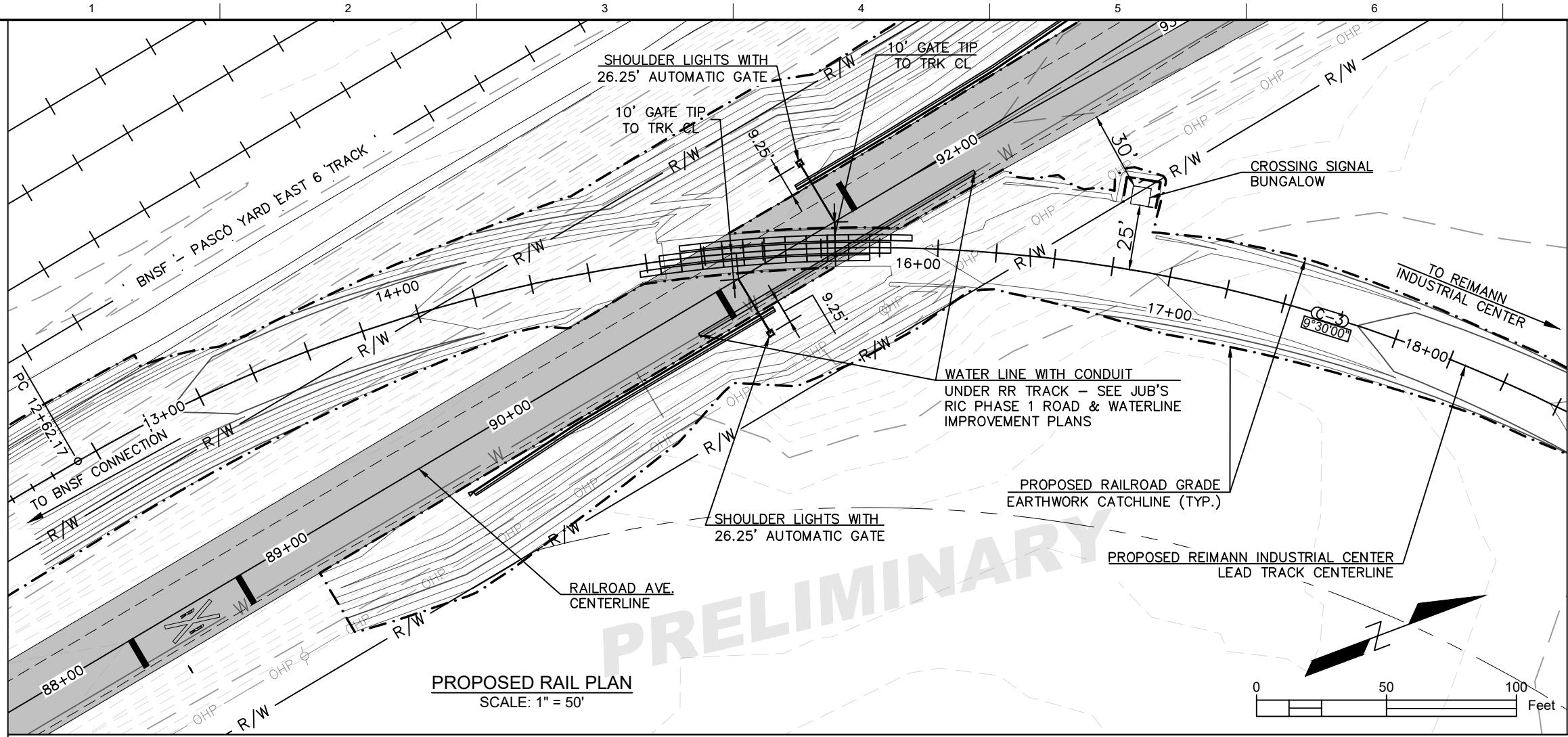

- GENERAL NOTES**
- Grade crossing layout per BNSF Signal Department Standard Drawing No. DE0005.02, Figure 3.
 - Proposed roadway design per JUB / Port of Pasco Reimann Industrial Center Phase 1 Road and Waterline Improvements dated August 2022. Proposed roadway is a 2-lane paved road with 12' travel lanes, 5' paved shoulder on west side of roadway, and 3' paved shoulder on east side of roadway. Lane markings include a double yellow centerline, and no fog lines.
 - Roadway Design Speed = 50 MPH
 - Rail Design Speed = 10 MPH
 - Clear view triangle per WSDOT Design Manual Exhibit 1350-1.
 - Proposed active warning will use constant warning time system.
 - Crossing panels shall be common standard precast concrete panels on 10'-0" long wood ties, per BNSF standard DWG. NO. 200100. Panels shall be specially manufactured "curved concrete panels" to conform with curvature indicated. Curvature through crossing is 9°30'.
 - Guardrails shall be Beam Guardrail Type 31, per WSDOT Standard Plan C-20.14-05, Case 3-31.

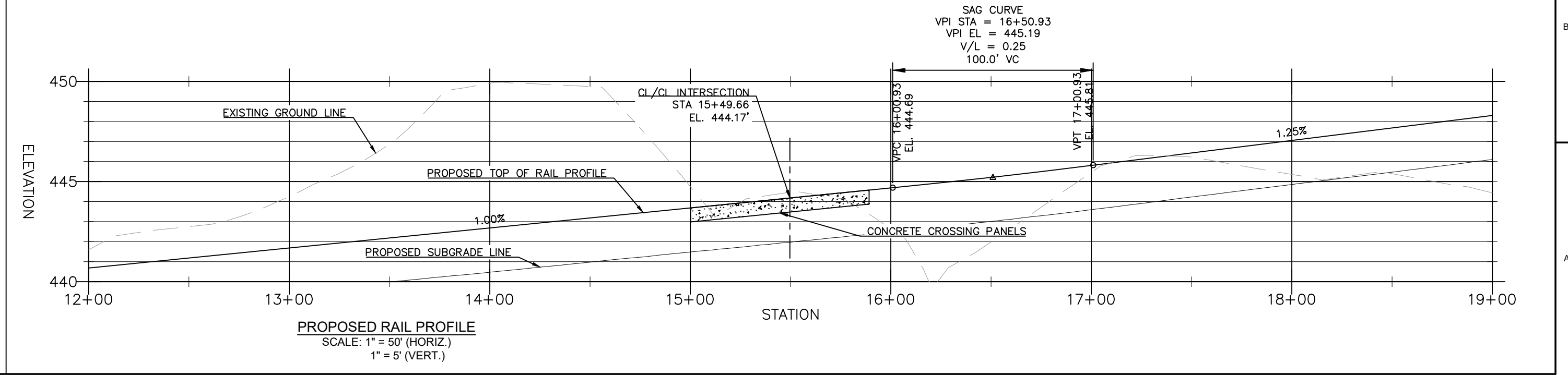

ISSUE	DATE	DESCRIPTION
1	XX/XX/XX	CONCEPT EXHIBIT

PROJECT MANAGER	WEBER, PAUL
RAIL LEAD	WEBER, PAUL
DRAWN BY	KELLY, SEAN
PROJECT NUMBER	10343022

**PORT OF PASCO
REIMANN INDUSTRIAL CENTER
UTC PETITION APPLICATION EXHIBIT**



FILENAME | POP RIC UTC Petition Exhibit Base.dwg
SCALE | 1" = 50'