

K:\PROJECTS\PACIFIC\17168-Stewart Rd\DESIGN\Drawings\Working\2020\214-UPRR FIGURE.dwg 2/2/2021 3:47 PM

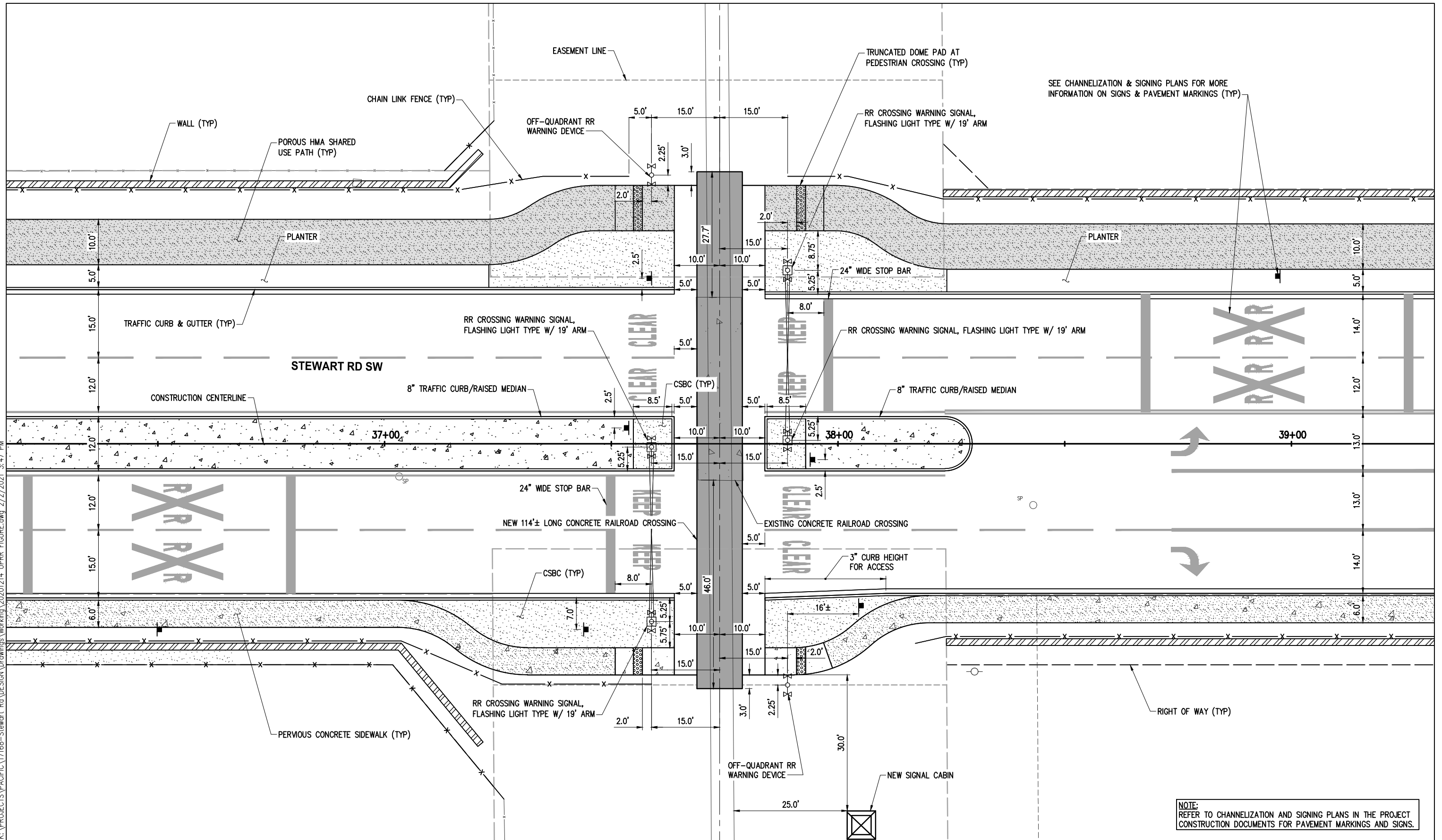

SEE CHANNELIZATION & SIGNING PLANS FOR MORE INFORMATION ON SIGNS & PAVEMENT MARKINGS (TYP)

NOTE:
REFER TO CHANNELIZATION AND SIGNING PLANS IN THE PROJECT CONSTRUCTION DOCUMENTS FOR PAVEMENT MARKINGS AND SIGNS.

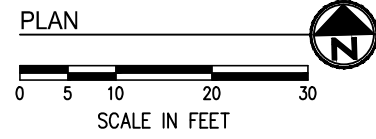

UPRR CROSSING IMPROVEMENTS FIGURE
STEWART ROAD IMPROVEMENTS

K:\PROJECTS\PACIFIC\17168-Stewart Rd\DESIGN\Drawings\Contract\17168ILL01.dwg 3/9/2021 6:54 PM

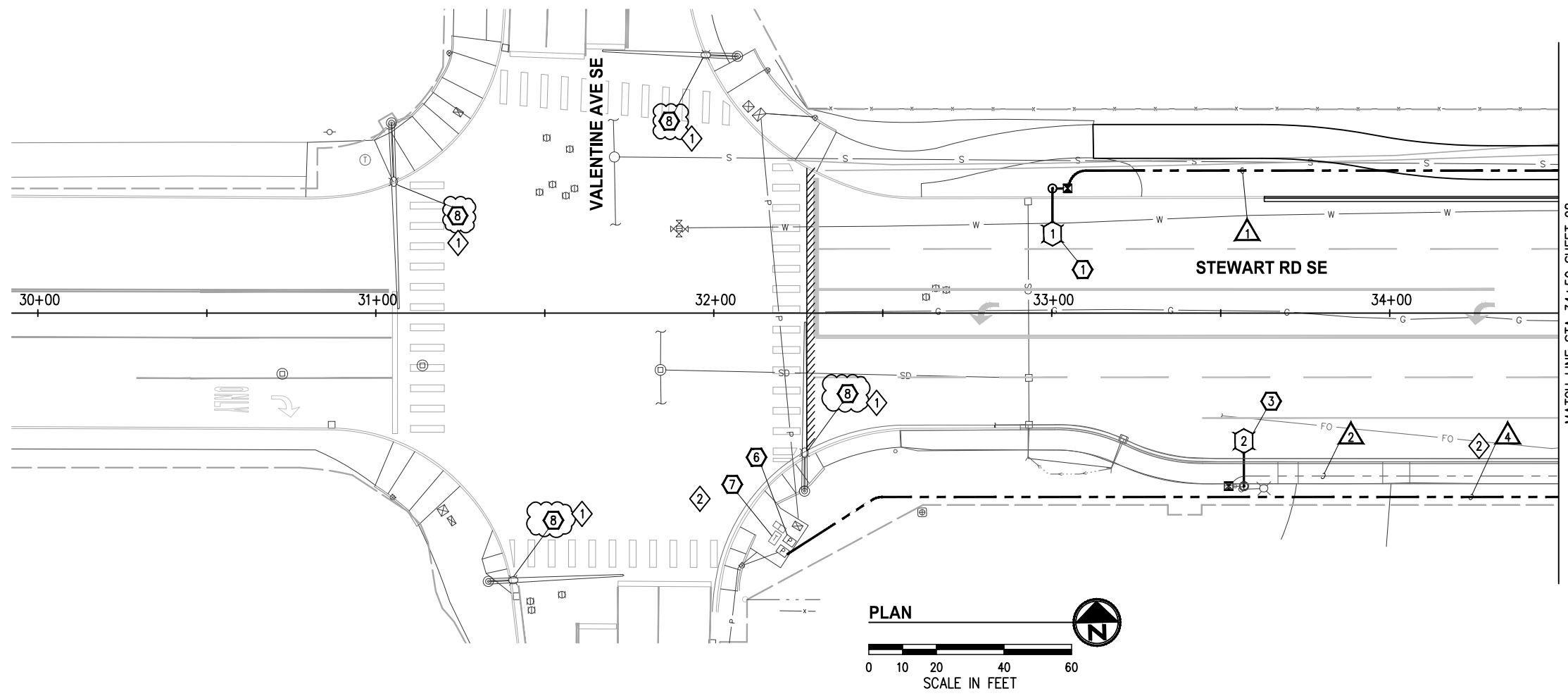

- ### CONSTRUCTION NOTES
- FURNISH AND INSTALL POLE BASE TUBE AND CONDUIT PER DETAILS, SHEET 30. TUBE BASE DEPTH SHALL BE PER DETAIL, SHEET 56. AFTER THE INSTALLATION CONTRACTOR TO COVER THE HOLE PER DETAIL, SHEET 30. POLE, LUMINAIRE, JUNCTION BOX AND WIRING TO BE FURNISHED AND INSTALLED BY PSE.
 - LOCATION OF EXISTING CONDUIT AND POLE BASE TUBE. POLE, LUMINAIRE, JUNCTION BOX AND WIRING TO BE INSTALLED BY PSE.
 - LOCATION OF EXISTING JUNCTION BOX. INSTALL CONDUIT INTO JUNCTION BOX PER WIRE NOTES, THIS SHEET.
 - LOCATION OF EXISTING TRAFFIC SIGNAL CONTROLLER CABINET. CONTRACTOR TO FURNISH AND INSTALL PRE-TERMINATED PATCH CABLE INSIDE EXISTING TRAFFIC SIGNAL CABINET FOR FIBER CONNECTION TO INTERSECTION OF BUTTE AVE AND STEWART RD SW. CONTRACTOR TO TERMINATE RAILROAD WIRING AND INSTALL EQUIPMENT FOR RAILROAD INTERCONNECT INSIDE EXISTING TRAFFIC SIGNAL CONTROLLER CABINET. COORDINATE WORK WITH KING COUNTY TRAFFIC SIGNAL TECHNICIAN. SEE SPECIAL PROVISIONS.
 - EXISTING SIGNAL POLE MOUNTED LUMINAIRE TO REMAIN. PROTECT CONDUCTORS DURING CONSTRUCTION.

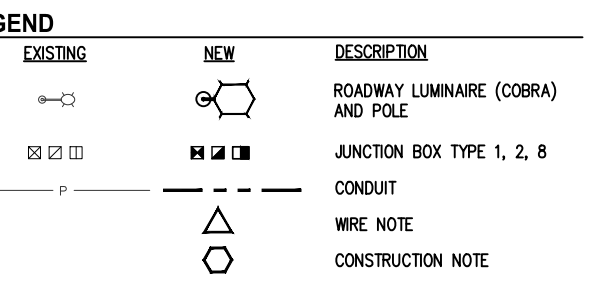

LUMINAIRE SCHEDULE (FOR PANEL SCHEDULE AND LOCATION SEE SHEET 30)

LUMINAIRE #	STATION	OFFSET	LUMINAIRE TYPE	LUMINAIRE ARM	MOUNTING HEIGHT	BASE	CIRCUIT #	COMMENTS
1	33+00.2	36.8' LT	DECORATIVE ROADWAY 103W 4K TYPE III 240V	10'	35'	FIXED	-	INSTALLED BY PSE POLE SERVICES
2	33+56.9	51.2' RT	DECORATIVE ROADWAY 103W 4K TYPE III 240V	10'	35'	FIXED	-	INSTALLED BY PSE POLE SERVICES

WIRE NOTES

RACEWAY/ CONDUIT SIZE	CONDUCTORS	COMMENTS
1 2"	BY PSE POLE SERVICES	
2 EX 2"	BY PSE POLE SERVICES	
3 2"	1-14C(#12)	RAILROAD INTERCONNECT
4 2"	1-26(#12), 1-12CT(SMFO)	RAILROAD INTERCONNECT, SIGNAL INTERCONNECT
5 HDPE 1 1/2"	1-26(#12), 1-12CT(SMFO)	RAILROAD INTERCONNECT, SIGNAL INTERCONNECT
6 HDPE 1 1/2"		SPARE

- NOTES:
- ALL PVC CONDUITS CONTAINING CONDUCTORS SHALL CONTAIN GROUND WIRE. WIRE SIZE SHALL MATCH THE LARGEST CONDUCTOR (#8 AWG MIN).
 - ALL CONDUIT SHALL BE PVC SCH 80 UNLESS OTHERWISE SPECIFIED.

NO.	DATE	BY	APPR.	REVISIONS
1	2/26	TD	JC	CHANGE ORDER 1 - REVISED INTERCONNECT AND SIGNAL WIRING
2	2/8	TD	JC	ADDENDUM 2 - REVISED INTERCONNECT AND SIGNAL WIRING

Approved By		17168ILL01.dwg
ENGINEERING MANAGER	DATE	FILENAME
PROJECT MANAGER	DATE	DESIGNED BY
PROJECT ENGINEER	DATE	TD
		DATE
		1/2021
		DATE
		1/2021
		DATE
		1/2021

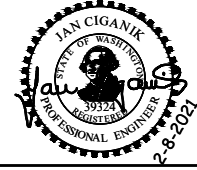

KPG
Interdisciplinary Design
TACOMA
2502 Jefferson Ave
WA 98402
(253) 627 0720

CHANGE ORDER #1

WSP
WSP USA Inc.
33301 9th Avenue South
Suite 300
Federal Way, WA 98003-2600
TEL: (206) 431-2300
FAX: (206) 431-2250



CITY OF PACIFIC
STEWART ROAD PERMITTING & DESIGN PROJECT
BETWEEN VALENTINE AVE SE & BUTTE AVE E

ILLUMINATION & INTERCONNECT PLAN
STEWART RD SE
STA 30+00 TO STA 34+50
KPG PROJECT No. 17168 | SHT 27 OF 56

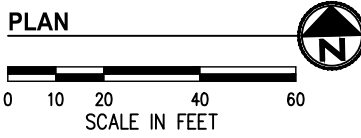
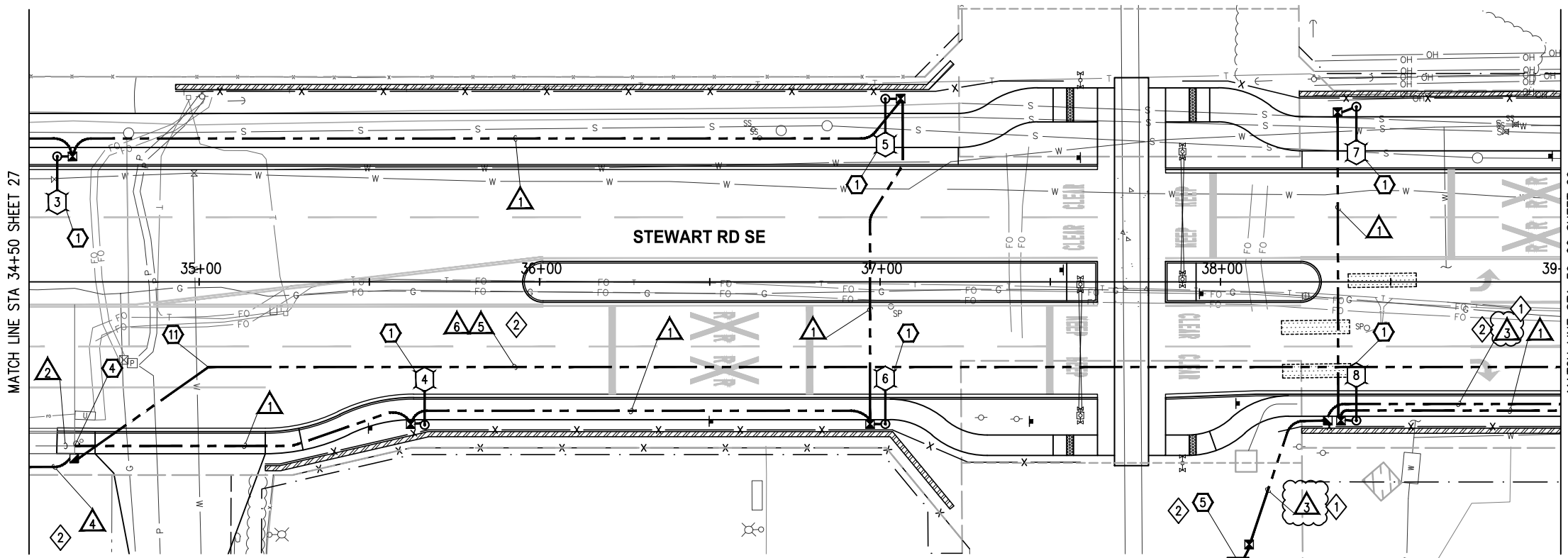

GENERAL NOTES

1. ALL WORK SHALL BE COMPLETED IN ACCORDANCE WITH WSDOT/APWA STANDARD PLANS, STANDARD SPECIFICATIONS, CITY OF PACIFIC STANDARDS, SPECIAL PROVISIONS AND THESE PLANS.
2. UTILITY LOCATION (DIAL-A-DIG) PRIOR TO CONSTRUCTION SHALL BE THE RESPONSIBILITY OF THE CONTRACTOR. CONFLICTS SHALL BE BROUGHT TO THE ATTENTION OF THE ENGINEER FOR RESOLUTION.
3. THE LOCATION OF ALL CONDUIT, JUNCTION BOXES, AND LUMINAIRES SHOWN ON THIS PLAN ARE FOR GRAPHIC PRESENTATION ONLY. FINAL LOCATIONS SHALL BE DETERMINED BY THE CONTRACTOR AND APPROVED BY THE ENGINEER IN THE FIELD.
4. THE NUMBER OF CONDUIT BENDS BETWEEN PULL POINTS SHALL NOT BE MORE THAN THE EQUIVALENT OF FOUR QUARTER BENDS (360 DEGREES TOTAL). IF THE NUMBER OF BENDS EXCEEDS 360 DEGREES, THE CONTRACTOR SHALL INSTALL ADDITIONAL JUNCTION BOXES.
5. CONTRACTOR SHALL COORDINATE WITH PSE POLE SERVICES REPRESENTATIVE, LARS LARSON AT 425-456-2496.
6. CONTRACTOR SHALL COORDINATE RAILROAD AND TRAFFIC SIGNAL INTERCONNECT INSTALLATION IN SIGNAL CABINETS WITH KING COUNTY TRAFFIC SIGNAL MAINTENANCE REPRESENTATIVE, RICK THIBODEAU AT 206-205-5587.
7. ALL NEW JUNCTION BOXES INSTALLED IN SIDEWALKS SHALL HAVE LOCKING AND SLIP RESISTANT LIDS. JUNCTION BOXES SHALL NOT BE PLACED IN ADA CURB RAMPS OR LANDING.
8. CONTRACTOR IS RESPONSIBLE FOR MAINTAINING A CLEARANCE ZONE OF 10' AROUND EXISTING AERIAL POWER LINES DURING CONSTRUCTION. COORDINATE WORK WITH THE POWER COMPANY REPRESENTATIVE.

CONSTRUCTION NOTES

- ① FURNISH AND INSTALL POLE BASE TUBE AND CONDUIT PER DETAILS, SHEET 30. TUBE BASE DEPTH SHALL BE PER DETAIL, SHEET 56. AFTER THE INSTALLATION CONTRACTOR TO COVER THE HOLE PER DETAIL, SHEET 30. POLE, LUMINAIRE, JUNCTION BOX AND WIRING TO BE FURNISHED AND INSTALLED BY PSE.
- ④ LOCATE EXISTING EMPTY CONDUIT AND COUPLE TO NEW CONDUIT TO FORM CONTINUOUS RACEWAY PER WIRE NOTES, THIS SHEET.
- ⑤ LOCATION OF UNION PACIFIC RAILROAD (UPRR) SIGNAL HOUSE. CONDUIT AND WIRING FOR RAILROAD PREEMPTION SHALL BE INSTALLED BY CONTRACTOR UP TO JUNCTION BOX LOCATED NEXT TO UPRR SIGNAL HOUSE AS SHOWN ON PLANS AND PER WIRE NOTES, THIS SHEET. FINAL CONDUIT AND WIRING CONNECTION TO UPRR SIGNAL HOUSE SHALL BE PERFORMED BY UPRR. CONTRACTOR SHALL COORDINATE WORK WITH THE RAILROAD REPRESENTATIVE. SEE SPECIAL PROVISIONS.
- ⑩ LOCATION OF EXISTING CONDUIT CASING. CONTRACTOR SHALL EXCAVATE TO EXPOSE EXISTING CASING AND FURNISH AND INSTALL HDPE CONDUIT THROUGH CASING TOWARD INTERSECTION OF BUTTE AND STEWART RD. HDPE CONDUIT SIZE PER WIRE NOTES, THIS SHEET. HDPE CONDUIT SHALL TERMINATE AT JUNCTION BOX AS CALLED OUT ON THIS SHEET. FOR OTHER TERMINATION POINT OF HDPE CONDUIT, SEE SIGNAL SHEETS. COMPLETE WIRING PER WIRE NOTES, THIS SHEET. SEE SPECIAL PROVISIONS.

LUMINAIRE SCHEDULE (FOR PANEL SCHEDULE AND LOCATION SEE SHEET 30)

LUMINAIRE #	STATION	OFFSET	LUMINAIRE TYPE	LUMINAIRE ARM	MOUNTING HEIGHT	BASE	CIRCUIT #	COMMENTS
3	34+58.3	36.8' LT	DECORATIVE ROADWAY 103W 4K TYPE III 240V	10'	35'	FIXED	-	INSTALLED BY PSE POLE SERVICES
4	35+66.2	42.0' RT	DECORATIVE ROADWAY 103W 4K TYPE III 240V	10'	35'	FIXED	-	INSTALLED BY PSE POLE SERVICES
5	37+01.6	53.8' LT	DECORATIVE ROADWAY 103W 4K TYPE III 240V	10'	35'	FIXED	-	INSTALLED BY PSE POLE SERVICES
6	37+01.6	41.7' RT	DECORATIVE ROADWAY 103W 4K TYPE III 240V	10'	35'	FIXED	-	INSTALLED BY PSE POLE SERVICES
7	38+39.9	51.4' LT	DECORATIVE ROADWAY 103W 4K TYPE III 240V	10'	35'	FIXED	-	INSTALLED BY PSE POLE SERVICES
8	38+39.9	40.8' RT	DECORATIVE ROADWAY 103W 4K TYPE III 240V	10'	35'	FIXED	-	INSTALLED BY PSE POLE SERVICES

WIRE NOTES

RACEWAY/CONDUIT SIZE	CONDUCTORS	COMMENTS
1 2"	BY PSE POLE SERVICES	
2 EX 2"	BY PSE POLE SERVICES	
3 2"	1-14C(#12)	RAILROAD INTERCONNECT
4 2"	1-26(#12), 1-12CT(SMFO)	RAILROAD INTERCONNECT, SIGNAL INTERCONNECT
5 HDPE 1 1/2"	1-26(#12), 1-12CT(SMFO)	RAILROAD INTERCONNECT, SIGNAL INTERCONNECT
6 HDPE 1 1/2"		SPARE

- NOTES:**
1. ALL PVC CONDUITS CONTAINING CONDUCTORS SHALL CONTAIN GROUND WIRE. WIRE SIZE SHALL MATCH THE LARGEST CONDUCTOR (#8 AWG MIN).
 2. ALL CONDUIT SHALL BE PVC SCH 80 UNLESS OTHERWISE SPECIFIED.

LEGEND

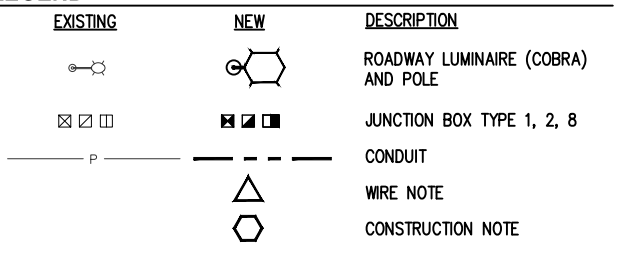

K:\PROJECTS\PACIFIC-Stewart Rd\DESIGN\Drawings\Contract\17168\1101.dwg 3/9/2021 6:54 PM

NO.	DATE	BY	APPR.	REVISIONS
①	2/26	TD	JC	CHANGE ORDER 1 - REVISED INTERCONNECT AND SIGNAL WIRING
②	2/8	TD	JC	ADDENDUM 2 - REVISED INTERCONNECT AND SIGNAL WIRING

Approved By

ENGINEERING MANAGER	DATE	17168\1101.dwg	FILENAME
PROJECT MANAGER	DATE	TD	DESIGNED BY
PROJECT ENGINEER	DATE	TD	DRAWN BY
	DATE	JC	CHECKED BY
	DATE		



KPG
Interdisciplinary Design
TACOMA
2502 Jefferson Ave
WA 98402
(253) 627 0720

Seattle
Wenatchee
Bellevue
www.kpg.com

CHANGE ORDER #1

WSP
WSP USA Inc.
33301 9th Avenue South
Suite 300
Federal Way, WA 98003-2600
TEL: (206) 431-2300
FAX: (206) 431-2250



CITY OF PACIFIC
STEWART ROAD PERMITTING & DESIGN PROJECT
BETWEEN VALENTINE AVE SE & BUTTE AVE E

ILLUMINATION & INTERCONNECT PLAN	
STEWART RD SE	
STA 34+50 TO STA 39+00	
KPG PROJECT No. 17168	SHT 28 OF 56

GENERAL NOTES

- ALL WORK SHALL BE COMPLETED IN ACCORDANCE WITH WSDOT/APWA STANDARD PLANS, STANDARD SPECIFICATIONS, CITY OF PACIFIC STANDARDS, SPECIAL PROVISIONS AND THESE PLANS.
- UTILITY LOCATION (DIAL-A-DIG) PRIOR TO CONSTRUCTION SHALL BE THE RESPONSIBILITY OF THE CONTRACTOR. CONFLICTS SHALL BE BROUGHT TO THE ATTENTION OF THE ENGINEER FOR RESOLUTION.
- THE LOCATION OF ALL CONDUIT, JUNCTION BOXES, AND LUMINAIRES SHOWN ON THIS PLAN ARE FOR GRAPHIC PRESENTATION ONLY. FINAL LOCATIONS SHALL BE DETERMINED BY THE CONTRACTOR AND APPROVED BY THE ENGINEER IN THE FIELD.
- THE NUMBER OF CONDUIT BENDS BETWEEN PULL POINTS SHALL NOT BE MORE THAN THE EQUIVALENT OF FOUR QUARTER BENDS (360 DEGREES TOTAL). IF THE NUMBER OF BENDS EXCEEDS 360 DEGREES, THE CONTRACTOR SHALL INSTALL ADDITIONAL JUNCTION BOXES.
- CONTRACTOR SHALL COORDINATE WITH PSE POLE SERVICES REPRESENTATIVE, LARS LARSON AT 425-456-2496.
- CONTRACTOR SHALL COORDINATE RAILROAD AND TRAFFIC SIGNAL INTERCONNECT INSTALLATION IN SIGNAL CABINETS WITH KING COUNTY TRAFFIC SIGNAL MAINTENANCE REPRESENTATIVE, RICK THIBODEAU AT 206-205-5587.
- ALL NEW JUNCTION BOXES INSTALLED IN SIDEWALKS SHALL HAVE LOCKING AND SLIP RESISTANT LIDS. JUNCTION BOXES SHALL NOT BE PLACED IN ADA CURB RAMPS OR LANDING.
- CONTRACTOR IS RESPONSIBLE FOR MAINTAINING A CLEARANCE ZONE OF 10' AROUND EXISTING AERIAL POWER LINES DURING CONSTRUCTION. COORDINATE WORK WITH THE POWER COMPANY REPRESENTATIVE.

CONSTRUCTION NOTES

- ① FURNISH AND INSTALL POLE BASE TUBE AND CONDUIT PER DETAILS, SHEET 30. TUBE BASE DEPTH SHALL BE PER DETAIL, SHEET 56. AFTER THE INSTALLATION CONTRACTOR TO COVER THE HOLE PER DETAIL, SHEET 30. POLE, LUMINAIRE, JUNCTION BOX AND WIRING TO BE FURNISHED AND INSTALLED BY PSE.
- ② SIGNAL POLE MOUNTED LUMINAIRE. SEE LUMINAIRE SCHEDULE, THIS SHEET AND SIGNAL PLANS.
- ⑨ LOCATION OF ELECTRICAL SERVICE CABINET FOR TRAFFIC SIGNAL AND INTERSECTION LIGHTING. FOR ADDITIONAL INFORMATION, SEE SIGNAL PLANS.
- ⑩ FOR CONDUIT/WIRING CONTINUATION, SEE SIGNAL SHEETS.

LEGEND

EXISTING	NEW	DESCRIPTION
		ROADWAY LUMINAIRE (COBRA) AND POLE
		JUNCTION BOX TYPE 1, 2, 8
		CONDUIT
		WIRE NOTE
		CONSTRUCTION NOTE

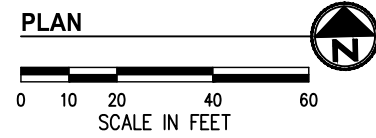
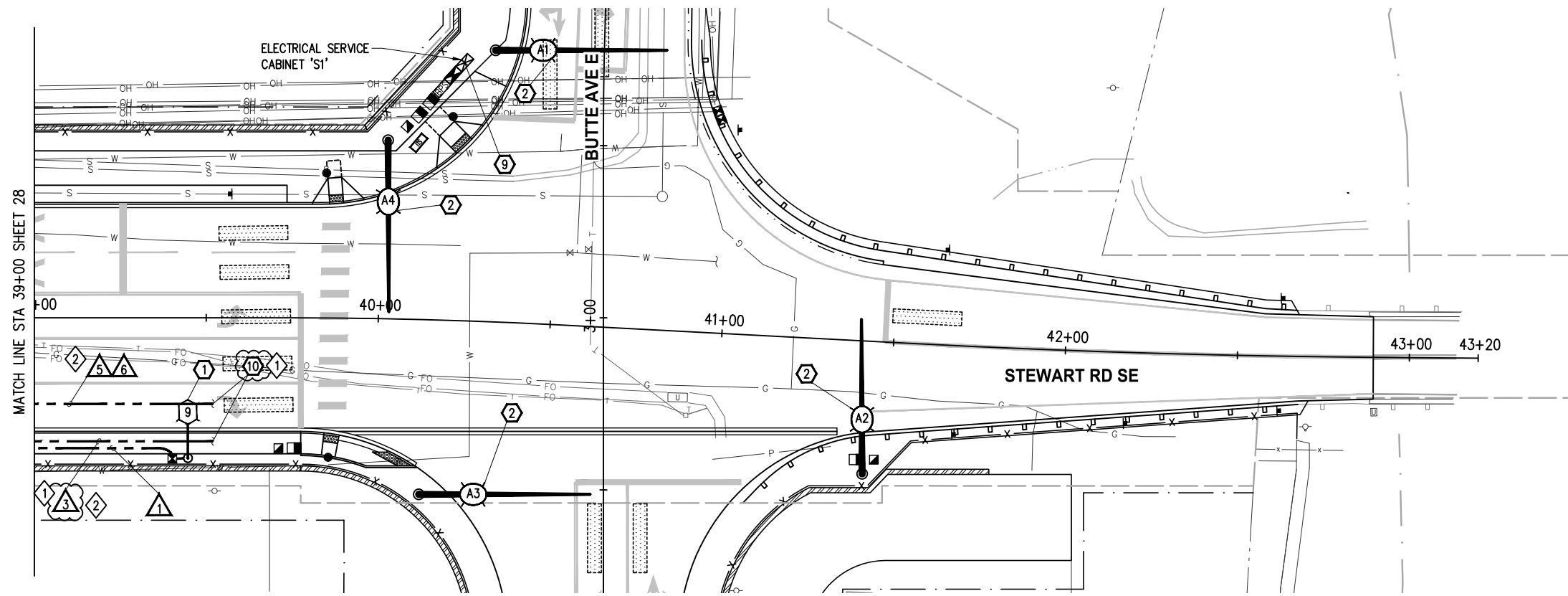

LUMINAIRE SCHEDULE (FOR PANEL SCHEDULE AND LOCATION SEE SHEET 30)

LUMINAIRE #	STATION	OFFSET	LUMINAIRE TYPE	LUMINAIRE ARM	MOUNTING HEIGHT	BASE	CIRCUIT #	COMMENTS
9	39+44.6	40.8' RT	DECORATIVE ROADWAY 103W 4K TYPE III 240V	10'	35'	FIXED	-	INSTALLED BY PSE POLE SERVICES
A1	*	*	COBRA ROADWAY 80LED 134W 4K TYPE III 240V	*	*	*	5	* MOUNTED ON SIGNAL POLE
A2	*	*	COBRA ROADWAY 80LED 134W 4K TYPE III 240V	*	*	*	5	* MOUNTED ON SIGNAL POLE
A3	*	*	COBRA ROADWAY 80LED 134W 4K TYPE III 240V	*	*	*	5	* MOUNTED ON SIGNAL POLE
A4	*	*	COBRA ROADWAY 80LED 134W 4K TYPE III 240V	*	*	*	5	* MOUNTED ON SIGNAL POLE

WIRE NOTES

NO.	RACEWAY/CONDUIT SIZE	CONDUCTORS	COMMENTS
1	2"	BY PSE POLE SERVICES	
2	EX 2"	BY PSE POLE SERVICES	
3	2"	1-14C(#12)	RAILROAD INTERCONNECT
4	2"	1-26(#12), 1-12CT(SMFO)	RAILROAD INTERCONNECT, SIGNAL INTERCONNECT
5	HDPE 1 1/2"	1-26(#12), 1-12CT(SMFO)	RAILROAD INTERCONNECT, SIGNAL INTERCONNECT
6	HDPE 1 1/2"		SPARE

- NOTES:**
- ALL PVC CONDUITS CONTAINING CONDUCTORS SHALL CONTAIN GROUND WIRE. WIRE SIZE SHALL MATCH THE LARGEST CONDUCTOR (#8 AWG MIN).
 - ALL CONDUIT SHALL BE PVC SCH 80 UNLESS OTHERWISE SPECIFIED.

K:\PROJECTS\PACIFIC\17168-Stewart Rd\DESIGN\Drawings\Contract\17168ILL01.dwg 3/9/2021 6:54 PM

NO.	DATE	BY	APPR.	REVISIONS
①	2/26	TD	JC	CHANGE ORDER 1 - REVISED INTERCONNECT AND SIGNAL WIRING
②	2/8	TD	JC	ADDENDUM 2 - REVISED INTERCONNECT AND SIGNAL WIRING

Approved By

ENGINEERING MANAGER	DATE	17168ILL01.dwg	FILENAME
PROJECT MANAGER	DATE	TD	DESIGNED BY
PROJECT ENGINEER	DATE	TD	DATE
	DATE	JC	DRAWN BY
	DATE	JC	DATE
	DATE	JC	CHECKED BY
	DATE	JC	DATE



KPG
Interdisciplinary Design
TACOMA
2502 Jefferson Ave
WA 98402
(253) 627 0720

Seattle
Wenatchee
Bellevue
www.kpg.com

CHANGE ORDER #1

WSP
WSP USA Inc.
33301 9th Avenue South
Suite 300
Federal Way, WA 98003-2600
TEL: (206) 431-2300
FAX: (206) 431-2250



CITY OF PACIFIC
STEWART ROAD PERMITTING & DESIGN PROJECT
BETWEEN VALENTINE AVE SE & BUTTE AVE E

ILLUMINATION & INTERCONNECT PLAN
STEWART RD SE
STA 39+00 TO STA 43+20

KPG PROJECT No. 17168 | SHT 29 OF 56

K:\PROJECTS\PACIFIC\17168-Stewart Rd\DESIGN\Drawings\Contract\17168SIG01.dwg 3/9/2021 6:55 PM

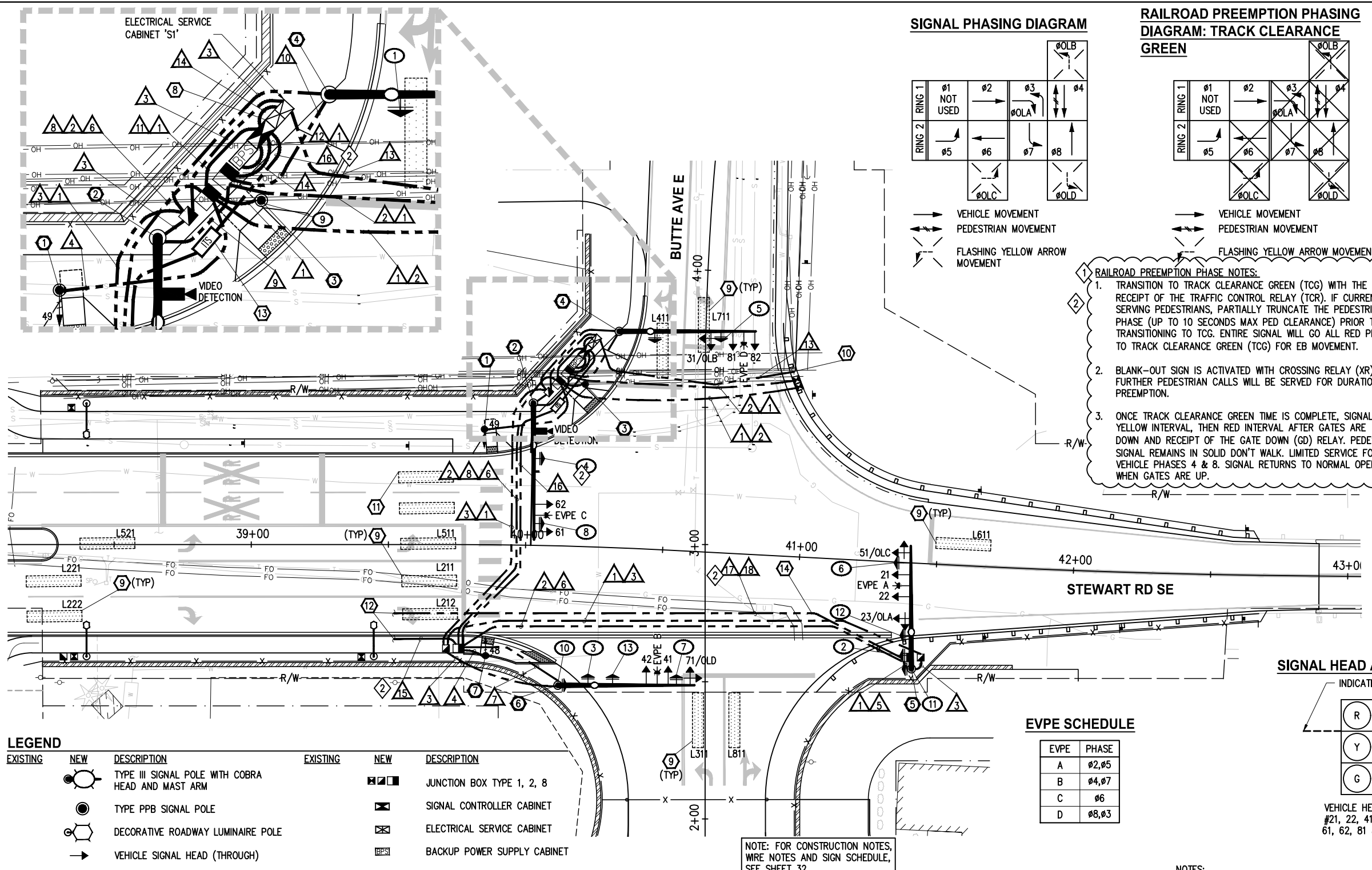

SIGNAL PHASING DIAGRAM

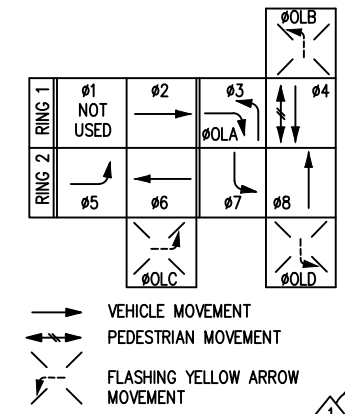

RAILROAD PREEMPTION PHASING DIAGRAM: TRACK CLEARANCE GREEN

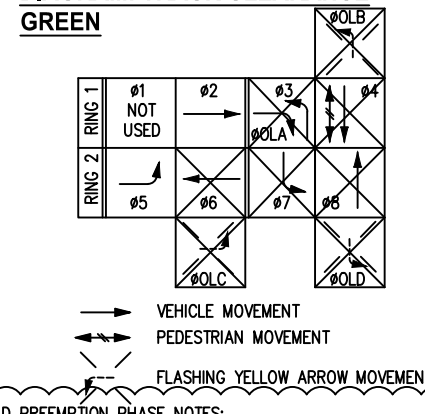

GENERAL NOTES

- ALL WORK SHALL BE DONE IN ACCORDANCE WITH THE CITY STANDARDS, KING COUNTY TRAFFIC REQUIREMENTS, WSDOT/APWA STANDARD PLANS, STANDARD SPECIFICATIONS, THE SPECIAL PROVISIONS, AND THESE PLANS.
- FOR COORDINATION WITH KING COUNTY TRAFFIC MAINTENANCE, CONTRACTOR SHALL CONTACT RICK THIBODEAU AT (206) 205-5587.
- ALL PEDESTRIAN PUSH BUTTONS SHALL BE ACCESSIBLE PEDESTRIAN SIGNALS (APS) AND SHALL BE INSTALLED PER MUTCD STANDARDS. ALL CURB RAMPS SHALL MEET PROWAG STANDARDS.
- THE LOCATION OF ALL CONDUIT, JUNCTION BOXES, AND LUMINAIRES SHOWN ON THIS PLAN ARE FOR GRAPHIC PRESENTATION ONLY. FINAL LOCATIONS SHALL BE DETERMINED BY THE CONTRACTOR AND APPROVED BY THE ENGINEER IN THE FIELD. ALL NEW FOUNDATION LOCATIONS SHALL BE APPROVED BY THE CITY ENGINEER OR THE ASSIGNED CITY INSPECTOR PRIOR TO EXCAVATION. CONTRACTOR SHALL CONFIRM FOR MINIMUM OVERHEAD CLEARANCE OF 16.5 FEET FOR ALL SIGNAL HEADS ABOVE THE STREET PRIOR TO POURING FOUNDATION.
- ALL WORK SHALL BE CONSISTENT WITH UTILITY AGENCY REQUIREMENTS. THE CONTRACTOR SHALL CONTACT ALL PERTINENT UTILITY AGENCIES 48 HOURS BEFORE COMMENCING WORK, AND SHALL COORDINATE WITH AFFECTED UTILITY AGENCIES THROUGHOUT THE PROJECT.
- ALL CONDUCTORS FOR SIGNAL HEADS, CAMERAS, PEDESTRIAN HEADS, PUSH BUTTONS, EVPE EQUIPMENT AND STREETLIGHTS SHALL BE LABELED IN EACH JUNCTION BOX.
- ALL NEW JUNCTION BOXES PLACED IN THE SIDEWALK SHALL HAVE LOCKABLE AND SKID-RESISTANT LIDS. AFTER INSTALLATION AND FINAL INSPECTION, JUNCTION BOXES SHALL BE SPOT WELDED.
- ALL VEHICLE AND PEDESTRIAN SIGNAL HEADS AND PUSH BUTTONS SHALL BE SECURELY AND COMPLETELY COVERED UNTIL PUT INTO OPERATION. SIGNAL HEADS WILL BE BAGGED WITH A SMALL HOLE IN LINE WITH EACH SIGNAL LENS.
- ONLY JOURNEY LEVEL WORK SHALL BE ALLOWED IN THE SIGNAL CONTROLLER CABINET.
- ON THE DAY OF ACTIVATION, INSTALL "NEW SIGNAL AHEAD" SIGNS AT ALL LEGS OF THE INTERSECTION PER SECTION 8-20.3(11) OF THE SPECIAL PROVISIONS.
- CONTRACTOR TO CONTACT UNION PACIFIC RAILROAD (UPRR) MANAGER OF PUBLIC PROJECTS PRIOR TO ANY WORK WITHIN THE UPRR RIGHT-OF-WAY OR ANY WORK AFFECTING GRADE CROSSING OPERATIONS.

- RAILROAD PREEMPTION PHASE NOTES:**
- TRANSITION TO TRACK CLEARANCE GREEN (TCG) WITH THE RECEIPT OF THE TRAFFIC CONTROL RELAY (TCR). IF CURRENTLY SERVING PEDESTRIANS, PARTIALLY TRUNCATE THE PEDESTRIAN PHASE (UP TO 10 SECONDS MAX PED CLEARANCE) PRIOR TO TRANSITIONING TO TCG. ENTIRE SIGNAL WILL GO ALL RED PRIOR TO TRACK CLEARANCE GREEN (TCG) FOR EB MOVEMENT.
 - BLANK-OUT SIGN IS ACTIVATED WITH CROSSING RELAY (XR). NO FURTHER PEDESTRIAN CALLS WILL BE SERVED FOR DURATION OF PREEMPTION.
 - ONCE TRACK CLEARANCE GREEN TIME IS COMPLETE, SIGNAL GOES YELLOW INTERVAL, THEN RED INTERVAL AFTER GATES ARE DOWN AND RECEIPT OF THE GATE DOWN (GD) RELAY. PEDESTRIAN SIGNAL REMAINS IN SOLID DON'T WALK. LIMITED SERVICE FOR VEHICLE PHASES 4 & 8. SIGNAL RETURNS TO NORMAL OPERATION WHEN GATES ARE UP.

LEGEND

EXISTING	NEW	DESCRIPTION	EXISTING	NEW	DESCRIPTION
		TYPE III SIGNAL POLE WITH COBRA HEAD AND MAST ARM			JUNCTION BOX TYPE 1, 2, 8
		TYPE PPB SIGNAL POLE			SIGNAL CONTROLLER CABINET
		DECORATIVE ROADWAY LUMINAIRE POLE			ELECTRICAL SERVICE CABINET
		VEHICLE SIGNAL HEAD (THROUGH)			BACKUP POWER SUPPLY CABINET
		VIDEO DETECTION CAMERA			CONDUIT
		VEHICLE SIGNAL HEAD (TURN)			POLE CONSTRUCTION NOTE
		PEDESTRIAN SIGNAL HEAD			CONSTRUCTION NOTE
		EMERGENCY VEHICLE PRE-EMPTION DETECTOR (EVPE)			WIRE NOTE
		MAST ARM SIGN			SIGN NOTE
		SPARE TENON			
		VIDEO VEHICLE DETECTION ZONE			

EVPE SCHEDULE

EVPE	PHASE
A	Ø2, Ø5
B	Ø4, Ø7
C	Ø6
D	Ø8, Ø3

SIGNAL HEAD ASSIGNMENTS

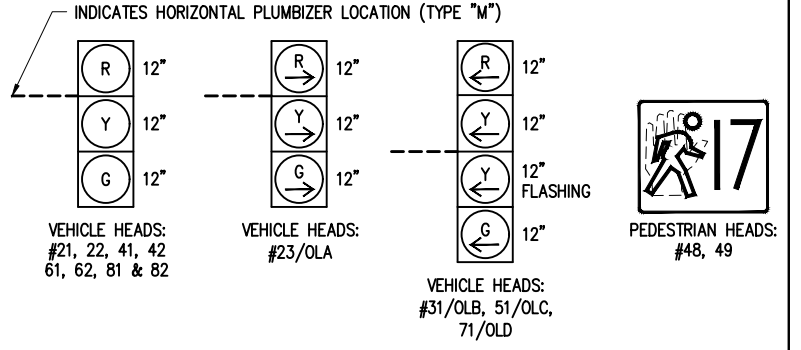

NOTES:

- ALL VEHICLE SIGNAL HEADS SHALL BE LED TYPE AND SHALL USE TUNNEL VISORS, SQUARE DOORS, 5" BACKPLATES WITH 2" RETROREFLECTIVE BORDERS USING TYPE IX SIGN SHEETING. VEHICLE HEADS SHALL BE COATED FEDERAL YELLOW, SEE SPECIAL PROVISIONS.
- MAST ARM MOUNTED VEHICLE SIGNAL HEADS SHALL USE MOUNTING TYPE "M". TOP OF POLE MOUNTED VEHICLE SIGNAL HEADS SHALL USE MOUNTING TYPE "D" OR "F". SIDE OF POLE MOUNTED VEHICLE SIGNAL HEADS SHALL USE MOUNTING TYPE "K" OR "H".
- ALL PEDESTRIAN SIGNAL HEADS SHALL BE LED TYPE WITH SOLID SYMBOLS. ALL PEDESTRIAN SIGNAL HEADS SHALL USE MOUNTING TYPE "E" OR "D". PEDESTRIAN SIGNAL HEADS SHALL BE COATED FEDERAL YELLOW, SEE SPECIAL PROVISIONS.
- ALL PEDESTRIAN SIGNAL HEADS SHALL BE COUNTDOWN TYPE AND SHALL CONFORM TO THE LATEST MUTCD REQUIREMENTS. APS PUSH BUTTON CONTROL UNIT SHALL BE INSTALLED IN THE PEDESTRIAN SIGNAL HEAD HOUSING.

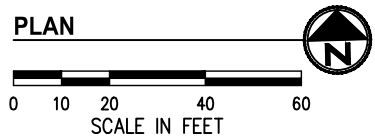

NO.	DATE	BY	APPR.	REVISIONS
1	2/26	TD	JC	CHANGE ORDER 1 - REVISED INTERCONNECT AND SIGNAL WIRING
2	2/8	TD	JC	ADDENDUM 2 - REVISED INTERCONNECT AND SIGNAL WIRING

Approved By

ENGINEERING MANAGER	DATE
PROJECT MANAGER	DATE
PROJECT ENGINEER	DATE

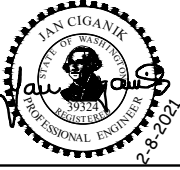

KPG
Interdisciplinary Design
TACOMA
2502 Jefferson Ave
WA 98402
(253) 627 0720

CHANGE ORDER #1

WSP
WSP USA Inc.
33301 9th Avenue South
Suite 300
Federal Way, WA 98003-2600
TEL: (206) 431-2300
FAX: (206) 431-2250



CITY OF PACIFIC
STEWART ROAD PERMITTING & DESIGN PROJECT
BETWEEN VALENTINE AVE SE & BUTTE AVE E

SIGNALIZATION PLAN
STEWART RD SE & BUTTE AVE E
KPG PROJECT No. 17168 | SHT 31 OF 56

SIGN SCHEDULE

Stewart Rd SE

D3-301
(18" x 102")

1 3

Butte Ave E

D3-302
(18" x 92")

2

Butte Ave E

D3-302
(18" x 92")

4

NOTES

1. ALL SIGNAGE SHALL COMPLY WITH MUTCD 2009 STANDARDS.
2. ALL SIGN DIMENSIONS SHALL BE VERIFIED WITH THE ENGINEER AND MANUFACTURER PRIOR TO FABRICATION.
3. MAST ARM MOUNTED SIGNS SHALL HAVE TYPE IX SHEETING AND SHALL BE BRACED AND INSTALLED PER WSDOT STD PLAN G-30.10.
4. STREET NAME SIGNS SHALL BE BLUE BACKGROUND WITH WHITE LETTERING.

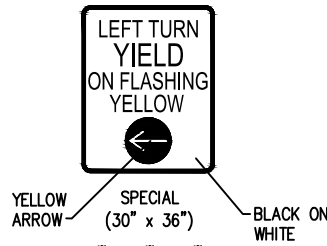

5 6 7

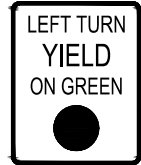

R10-12
(30" x 36")

8



R9-3
(18" x 18")

9 10



R9-3
(30" x 36")

11



R3-1
(36" x 36")

BLANK-OUT SIGN

WIRE NOTES

NO.	RACEWAY / CONDUIT SIZE	CONDUIT HEAD										COMMENTS			
		5C (VEHICLE HEAD)	5C (PEDESTRIAN HEAD)	5C (BLANK OUT SIGN)	2CS (PPB)	3CS (E/PE INDICATOR)	CAT6 (VIDEO DETECTOR)	#6 (ILLUMINATION)	#6 (CONTROLLER POWER)	#3/0 (SERVICE)	1-14C (RAIL ROAD PE)		1-12C (SMFD)		
1	2"														SPARE
2	3"														SPARE
3	2"														
4	2"														
5	3"	4	1			1	1								
6	3"	4	1			1	1								
7	3"	3	1	1		1	1								
8	3"	3	2	1	1	1	1								
9	3"	1	1			1	1	1							
10	3"	3				1	1								
11	4"	7	4	1	2	2	2								
12	3"	4	2		1	2	2	1							
13	3"														
14	2"														
15	2"														
16	2"														
17	HDPE 1 1/2"														
18	HDPE 1 1/2"														SPARE

NOTES:

1. ALL NEW PVC CONDUITS CONTAINING CONDUCTORS SHALL CONTAIN GROUND WIRE (NOT SHOWN IN THE TABLE ABOVE). GROUND WIRE SIZE SHALL MATCH THE LARGEST CONDUCTOR (MIN #8 AWG). SPARE/EMPTY CONDUITS SHALL CONTAIN DETECTABLE PULL TAPE AND SHALL BE MARKED AS "CITY OF PACIFIC" CONDUIT.
2. ALL CONDUIT SHALL BE RIGID PVC SCH 80 UNLESS NOTED OTHERWISE ON THE PLANS.

CONSTRUCTION NOTES

1. CONSTRUCT FOUNDATION AND INSTALL TYPE PS POLE PER WSDOT STD PLANS J-21.10, J-20.16, J-20.20. INSTALL ONE PEDESTRIAN SIGNAL HEAD AND ONE APS STYLE PUSH BUTTON ASSEMBLY ON THE POLE. FOR ADDITIONAL DETAILS AND LOCATION, SEE SIGNAL POLE SPECIFICATIONS, SHEET 34.
2. CONSTRUCT FOUNDATION PER WSDOT STD PLAN J-26.10 AND INSTALL ONE TYPE III SIGNAL POLE. INSTALL TWO VEHICLE SIGNAL HEADS, ONE EMERGENCY VEHICLE PRE-EMPTION DETECTOR AND INDICATOR, ONE STREET NAME SIGN, AND ONE REGULATORY SIGN ON THE MAST ARM. INSTALL ONE LED LUMINAIRE AND ONE VIDEO DETECTION CAMERA ON THE LUMINAIRE ARM. INSTALL ONE TERMINAL CABINET ON THE POLE. FOR POLE LOCATION AND DETAILS SEE SIGNAL POLE SPECIFICATION, SHEET 34. FOR LUMINAIRE DETAILS, SEE ILLUMINATION PLAN, SHEET 29. SEE SPECIAL PROVISIONS.
3. CONSTRUCT FOUNDATION AND INSTALL TYPE PS POLE PER WSDOT STD PLANS J-21.10 AND J-20.16. INSTALL ONE REGULATORY SIGN ON THE POLE. FOR ADDITIONAL DETAILS AND LOCATION, SEE SIGNAL POLE SPECIFICATIONS, SHEET 34.
4. CONSTRUCT FOUNDATION PER WSDOT STD PLAN J-26.10 AND INSTALL ONE TYPE III SIGNAL POLE. INSTALL THREE VEHICLE SIGNAL HEADS, ONE EMERGENCY VEHICLE PRE-EMPTION DETECTOR AND INDICATOR, ONE STREET NAME SIGN, AND ONE REGULATORY SIGN ON THE MAST ARM. INSTALL ONE LED LUMINAIRE ON THE LUMINAIRE ARM. INSTALL ONE TERMINAL CABINET ON THE POLE. FOR POLE LOCATION AND DETAILS SEE SIGNAL POLE SPECIFICATION, SHEET 34. FOR LUMINAIRE DETAILS, SEE ILLUMINATION PLAN, SHEET 29. SEE SPECIAL PROVISIONS.
5. CONSTRUCT FOUNDATION PER WSDOT STD PLAN J-26.10 AND INSTALL ONE TYPE III SIGNAL POLE. INSTALL FOUR VEHICLE SIGNAL HEADS, ONE EMERGENCY VEHICLE PRE-EMPTION DETECTOR AND INDICATOR, ONE STREET NAME SIGN, AND ONE REGULATORY SIGN ON THE MAST ARM. INSTALL ONE LED LUMINAIRE ON THE LUMINAIRE ARM. INSTALL ONE TERMINAL CABINET AND ONE REGULATORY SIGN ON THE POLE. FOR POLE LOCATION AND DETAILS SEE SIGNAL POLE SPECIFICATION, SHEET 34. FOR LUMINAIRE DETAILS, SEE ILLUMINATION PLAN, SHEET 29. SEE SPECIAL PROVISIONS.
6. CONSTRUCT FOUNDATION PER WSDOT STD PLAN J-26.10 AND INSTALL ONE TYPE III SIGNAL POLE. INSTALL THREE VEHICLE SIGNAL HEADS, ONE EMERGENCY VEHICLE PRE-EMPTION DETECTOR AND INDICATOR, ONE STREET NAME SIGN, AND ONE REGULATORY SIGN ON THE MAST ARM. INSTALL ONE LED LUMINAIRE ON THE LUMINAIRE ARM. INSTALL ONE TERMINAL CABINET AND ONE REGULATORY SIGN ON THE POLE. FOR POLE LOCATION AND DETAILS SEE SIGNAL POLE SPECIFICATION, SHEET 34. FOR LUMINAIRE DETAILS, SEE ILLUMINATION PLAN, SHEET 29. SEE SPECIAL PROVISIONS.
7. CONSTRUCT CURB BASE FOUNDATION AND INSTALL TYPE PS POLE PER WSDOT STD PLANS J-20.11, J-20.16, J-20.20. INSTALL ONE PEDESTRIAN SIGNAL HEAD AND ONE APS STYLE PUSH BUTTON ASSEMBLY ON THE POLE. FOR ADDITIONAL DETAILS AND LOCATION, SEE SIGNAL POLE SPECIFICATIONS, SHEET 34.
8. CONSTRUCT THREE-CABINET FOUNDATION PER WSDOT STD PLAN J-10.10 AND INSTALL ONE FULLY FUNCTIONAL TYPE 'P' TRAFFIC CONTROLLER CABINET (WITH LATEST ECONOLITE CONTROLLER AND SOFTWARE, AND RAILROAD INTERFACE PANEL), ONE EUSERC 308 COMPLIANT 120/240V ES-2EU ELECTRICAL SERVICE CABINET, AND ONE BPS (BACKUP POWER SUPPLY) CABINET. CONTRACTOR TO VERIFY BOLT PATTERN OF CABINETS BEFORE CONSTRUCTION OF FOUNDATION. CABINET DOORS SHALL BE ORIENTED TOWARD THE INTERSECTION. CENTER OF FOUNDATION SHALL BE LOCATED AT APPROXIMATE STEWART ROAD SE STATION 40+21.7, 73.6' LT (VERIFY FINAL LOCATION WITH THE ENGINEER IN THE FIELD). FOR PANEL SCHEDULE, SEE ILLUMINATION SHEET 30. SEE SPECIAL PROVISIONS.
9. VEHICLE VIDEO DETECTION ZONE SHOWN FOR REFERENCE ONLY. COORDINATE EXACT ZONE WITH THE ENGINEER IN THE FIELD.
10. FURNISH AND INSTALL CONDUIT RISER ON POLE PER DETAIL, THIS SHEET. INSTALL WIRING TO TOP OF RISER AND COIL 30'. PROVIDE 20' OF SPARE CONDUIT NEAR POLE FOR POWER COMPANY USE. COORDINATE FEEDER WIRING TERMINATION WITH THE POWER COMPANY REPRESENTATIVE. SEE SPECIAL PROVISIONS.
11. SYSTEM VIDEO DETECTION ZONE SHOWN FOR REFERENCE ONLY. COORDINATE EXACT ZONE WITH KING COUNTY TRAFFIC MAINTENANCE REPRESENTATIVE.
12. FOR CONDUIT/WIRING CONTINUATION. SEE ILLUMINATION SHEET 29.
13. FURNISH AND INSTALL SMALL CABLE VAULT PER WSDOT STD PLAN J-90.21 AND SPLICE FIBER OPTIC PATCH CABLE FROM INTERSECTION OF VALENTINE AVE SE AND STEWART RD SE INSIDE SMALL CABLE VAULT. COMPLETE WIRING TO NEW TRAFFIC SIGNAL CONTROLLER CABINET PER WIRE NOTES, THIS SHEET.
14. LOCATION OF EXISTING CONDUIT CASING. CONTRACTOR SHALL EXCAVATE TO EXPOSE END OF EXISTING CASING AND FURNISH AND INSTALL HDPE CONDUIT THROUGH CASING AND INTO JUNCTION BOX AS SHOWN ON THE PLANS. ONCE HDPE CONDUIT IS INSTALLED CONTRACTOR TO SEAL END OF CASING. HDPE CONDUIT SIZE AND WIRE INSTALLATION SHALL BE PER WIRE NOTES, THIS SHEET. SEE SPECIAL PROVISIONS.

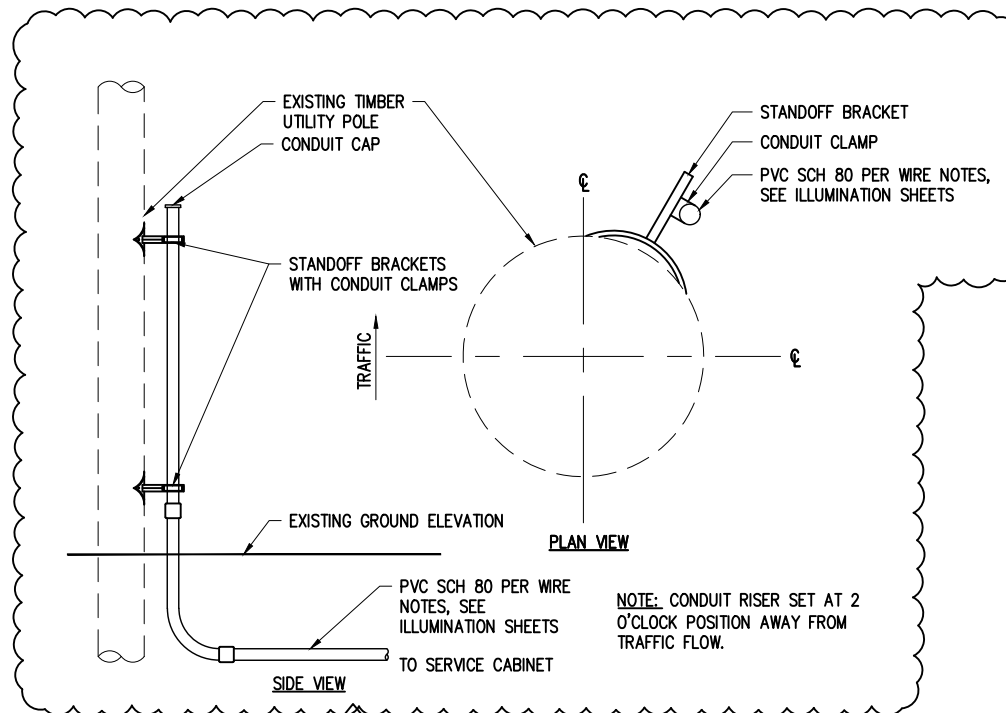

CONDUIT RISER DETAIL
NTS

K:\PROJECTS\PACIFIC\17168-Stewart Rd\DESIGN\Drawings\Contract\17168SIG01.dwg 3/9/2021 6:55 PM

NO.	DATE	BY	APPR.	REVISIONS
1	2/26	TD	JC	CHANGE ORDER 1 - REVISED INTERCONNECT AND SIGNAL WIRING
2	2/8	TD	JC	ADDENDUM 2 - REVISED INTERCONNECT AND SIGNAL WIRING

Approved By

ENGINEERING MANAGER	DATE	17168SIG01.dwg	FILENAME
PROJECT MANAGER	DATE	1/2021	DESIGNED BY
PROJECT ENGINEER	DATE	1/2021	DRAWN BY
	DATE	1/2021	CHECKED BY



KPG
Interdisciplinary Design
TACOMA
2502 Jefferson Ave
WA 98402
(253) 627 0720

Seattle
Wenatchee
Bellevue
www.kpg.com

CHANGE ORDER #1

WSP
WSP USA Inc.
33301 9th Avenue South
Suite 300
Federal Way, WA 98003-2600
TEL: (206) 431-2300
FAX: (206) 431-2250



CITY OF PACIFIC
STEWART ROAD PERMITTING & DESIGN PROJECT
BETWEEN VALENTINE AVE SE & BUTTE AVE E

SIGNAL NOTES

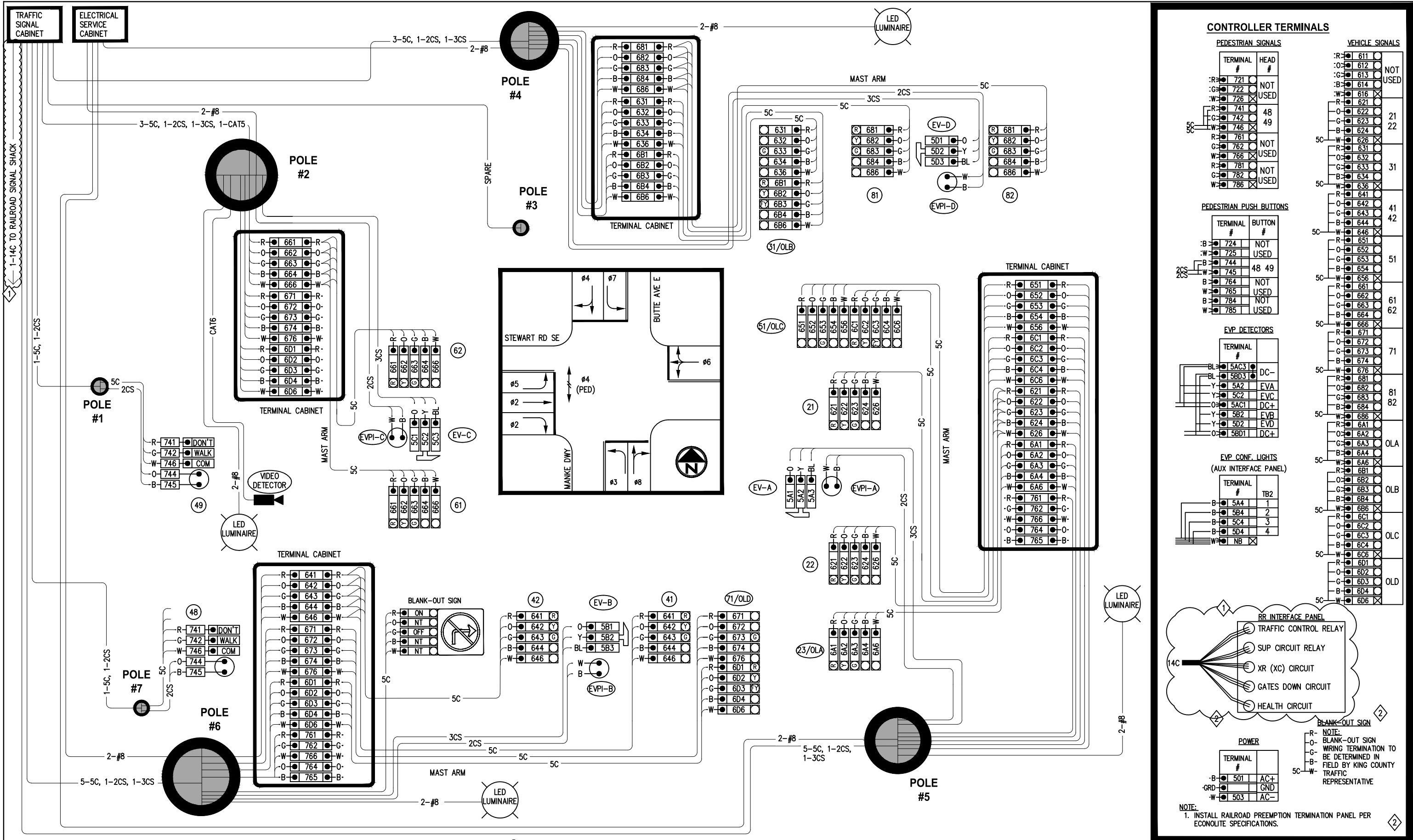

CONTROLLER TERMINALS

PEDESTRIAN SIGNALS		VEHICLE SIGNALS	
TERMINAL #	HEAD #	TERMINAL #	HEAD #
R-721	NOT USED	R-611	NOT USED
G-722	NOT USED	O-612	NOT USED
W-726	USED	G-613	NOT USED
R-741	48	B-614	NOT USED
G-742	49	W-616	NOT USED
W-746	USED	R-621	21
		O-622	22
		G-623	
		B-624	
		W-626	
		R-631	31
		O-632	
		G-633	
		B-634	
		W-636	
		R-641	41
		O-642	42
		G-643	
		B-644	
		W-646	
		R-651	51
		O-652	
		G-653	
		B-654	
		W-656	
		R-661	61
		O-662	62
		G-663	
		B-664	
		W-666	
		R-671	71
		O-672	
		G-673	
		B-674	
		W-676	
		R-681	81
		O-682	82
		G-683	
		B-684	
		W-686	
		R-6A1	OLA
		O-6A2	
		G-6A3	
		B-6A4	
		W-6A6	
		R-6B1	OLB
		O-6B2	
		G-6B3	
		B-6B4	
		W-6B6	
		R-6C1	OLC
		O-6C2	
		G-6C3	
		B-6C4	
		W-6C6	
		R-6D1	OLD
		O-6D2	
		G-6D3	
		B-6D4	
		W-6D6	

PEDESTRIAN PUSH BUTTONS	
TERMINAL #	BUTTON #
B-724	NOT USED
W-725	USED
B-744	48
W-745	49
B-764	NOT USED
W-765	USED
B-784	NOT USED
W-785	USED

EVP DETECTORS	
TERMINAL #	
BL-5AC3	DC-
BL-5BD3	DC-
Y-5A2	EVA
Y-5C2	EVC
Y-5AC1	DC+
Y-5B2	EVB
Y-5D2	EVD
O-5BD1	DC+

EVP CONF. LIGHTS (AUX INTERFACE PANEL)	
TERMINAL #	TB2
B-5A4	1
B-5B4	2
B-5C4	3
B-5D4	4
W-NB	

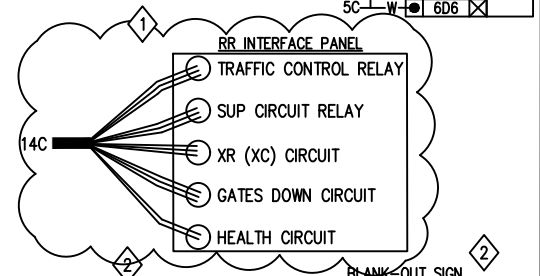

POWER	
TERMINAL #	
B-501	AC+
-GRD	GND
W-503	AC-

NOTE:
1. INSTALL RAILROAD PREEMPTION TERMINATION PANEL PER ECONOLITE SPECIFICATIONS.

K:\PROJECTS\PACIFIC\17168-Stewart Rd\DESIGN\Drawings\Contract\17168SIG01.dwg 3/9/2021 6:55 PM

NO.	DATE	BY	APPR.	REVISIONS
1	2/26	TD	JC	CHANGE ORDER 1 - REVISED INTERCONNECT AND SIGNAL WIRING
2	2/8	TD	JC	ADDENDUM 2 - REVISED INTERCONNECT AND SIGNAL WIRING

Approved By		17168SIG01.dwg
ENGINEERING MANAGER	DATE	FILENAME
PROJECT MANAGER	DATE	TD
PROJECT ENGINEER	DATE	DESIGNED BY
		TD
		DRAWN BY
		JC
		CHECKED BY
		DATE
		1/2021
		1/2021
		1/2021

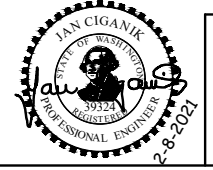

KPG
Interdisciplinary Design
TACOMA
2502 Jefferson Ave
WA 98402
(253) 627 0720

CHANGE ORDER #1

WSP
WSP USA Inc.
33301 9th Avenue South
Suite 300
Federal Way, WA 98003-2600
TEL: (206) 431-2300
FAX: (206) 431-2250



CITY OF PACIFIC
STEWART ROAD PERMITTING & DESIGN PROJECT
BETWEEN VALENTINE AVE SE & BUTTE AVE E

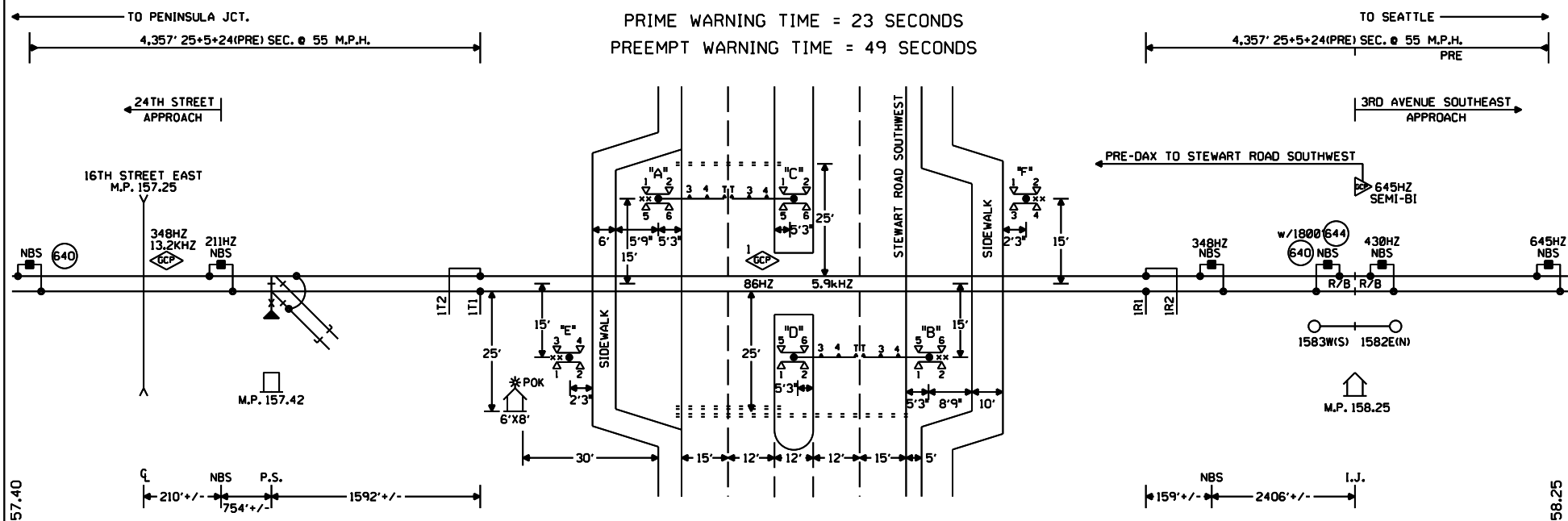

NOTES:

- ⊗ = TWISTED WIRES INSULATED 1 TWIST PER FT. ALL TRACK WIRES 2C.*6
- TRANSMITTER AND RECEIVER LEADS TO BE SEPARATED BY AT LEAST 12" IN TRENCH. LENGTHS SHOULD NOT EXCEED MANUFACTURER'S RECOMMENDATION.
- TOP OF FOUNDATION TO BE AT SAME ELEVATION AS THE SURFACE OF THE TRAVELED WAY & NO MORE THAN 4" ABOVE THE SURFACE OF THE GROUND.
- ALL BUNGALOW WIRING TO BE #16 AWG FLEX UNLESS OTHERWISE SPECIFIED EXCEPT ALL GROUND WIRE TO BE #6 AWG FLEX OR LARGER.
- ALL WIRING IN GATE MECHANISM TO BE #10 AWG FLEX. REFER TO UP STANDARD DWG FOR BUNGALOW GROUNDING.
- PORTABLE GENERATOR EXTENSION CORD FOR 240V TO 240V IS PROVIDED AS WELL AS A 120V TO 240V ADAPTER.
- ALL LIGHTS TO BE 12" ROUNDELS.
- ===== 4" X 160' CONDUIT
- LIGHTS: LED LIGHTS
- xx = BELL

TRK 1 ISLAND DISTANCE 166' MINIMUM 120' REQUIRED

OFFSET AND ISLAND DISTANCES TO BE VERIFIED BY FIELD

PREFERRED ISLAND WIRE CONNECTIONS ARE A MINIMUM 50' FROM EDGE OF ROADWAY

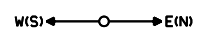

CONSTRUCTION NOTES:

- 1.) THE NEW INTERMEDIATE/REMOTE CABIN AT M.P. 158.25 WILL BE INSTALLED AS A PART OF THIS PROJECT.
- 2.) INSTALL A TRACK FILTER (TAB 729) TO THE WAYSIDE UNIT @ THE FOLLOWING LOCATION:
(1) 86 HZ - M.P. 156.75

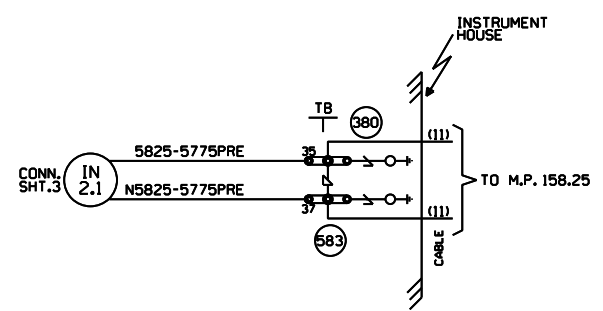

CABLE TABULATION
CABLE NO. 11 7C*14 U.G.B.T. HOUSE TO M.P. 158.25

NEW SHEET

Design: 08/17/21 INSTALL GATES, PEDESTRIAN FLASHERS AND CMT IN A NEW CABIN @ STEWART ROAD SW, MP 157.75 Rev: 1/18 M.P. 157.75 S/WP /MIT/RPH	MODIFICATION LEVEL		CIRCUIT MODIFICATIONS ARE NOT TO BE MADE WITHOUT AUTHORITY FROM THE OFFICE OF SIGNAL DESIGN	Date: 08/17/21	UNION PACIFIC RAILROAD SUMNER, WASHINGTON STEWART ROAD SOUTHWEST SEATTLE SUBDIVISION Office of Sr. AWP Engineering - Signal/TCO Omaha, Nebraska	Sh: 1
	O.A. LAST LEVEL CHECKED LAST LEVEL MOD THIS TYPICAL LAST LEVEL BY DESIGNER CHANGED FROM TYPICAL? BY: 05.23.16 4K 4617P.1	DV DV DV Y		Des: WIT Chk: S/WP AFE: 61877		DDT 396597R MP: 157.75 ID: 086015775.1X

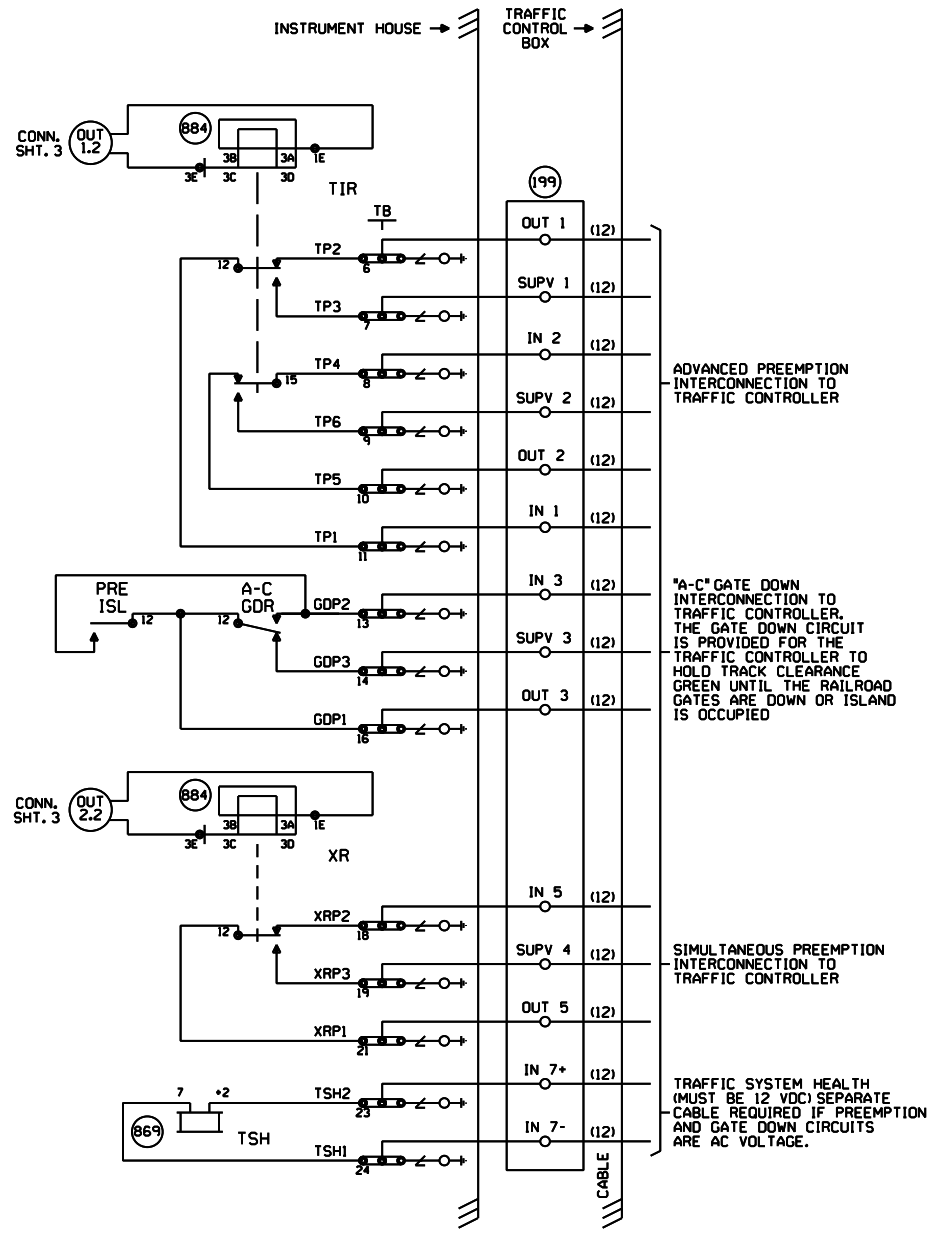

CABLE NO. 12 U.G.B.T. HOUSE TO TRAFFIC CONTROLLER

NEW SHEET

Design: 08/17/21 INSTALL GATES, PEDESTRIAN FLASHERS AND CMT IN A NEW CABIN @ STEWART ROAD SW, MP 157.75 Rev: 15 / SW, MP 157.75 15 / MIT/RPH	MODIFICATION LEVEL		CIRCUIT MODIFICATIONS ARE NOT TO BE MADE WITHOUT AUTHORITY FROM THE OFFICE OF SIGNAL DESIGN Date: 08/17/21 Des: WIT Chk: SWP AFE: 61877	UNION PACIFIC RAILROAD SUMNER, WASHINGTON STEWART ROAD SOUTHWEST SEATTLE SUBDIVISION <small>Office of Sr. AWP Engineering - Signal/TCO Omaha, Nebraska</small>		Sh: 1A
	O. A. LAST LEVEL CHECKED	DV		DOT 396597R		
	LAST LEVEL MOD THIS TYPICAL	DV		MP: 157.75		
	LAST LEVEL BY DESIGNER	DV		ID: 086015775.1AX		
CHANGED FROM TYPICAL?	Y					

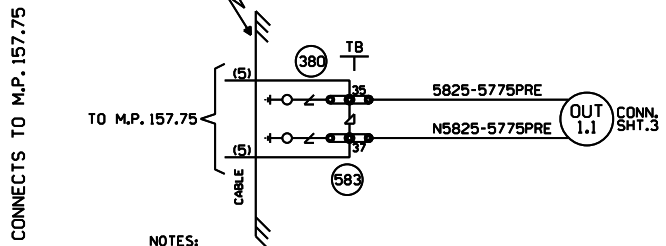
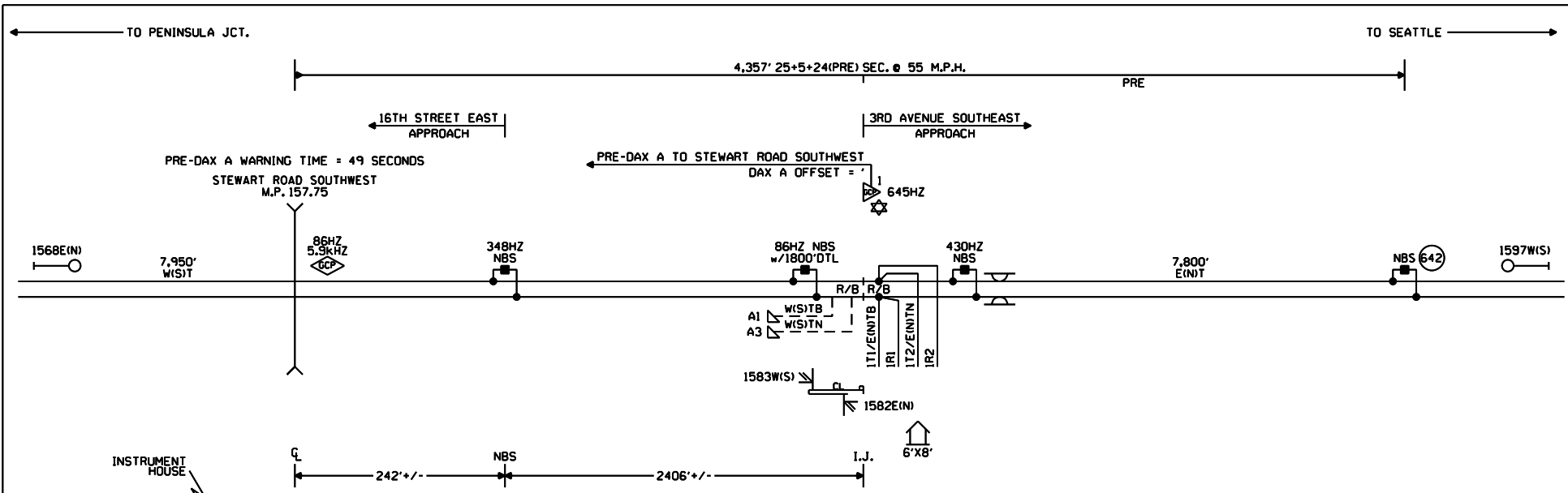

- NOTES:**
- ⊙ = OBSERVE CORRECT POLARITY EQUIPMENT WILL BE DAMAGED IF CONNECTIONS ARE REVERSED.
 - ⊗ = TWISTED WIRES. ALL WIRING TO TRACK 2C.NO.6 U.G.B.T. CABLE ALL HOUSE WIRING TO BE NO.16 UNLESS OTHERWISE SPECIFIED
 - REFER TO STANDARDS DRAWING FOR HOUSE GROUNDING SCHEME.
 - ALL GROUND CONNECTIONS TO BE #6 OR LARGER. SIGNAL WIRING SHOP TO RUN ALL GROUND CONNECTIONS.
 - ENSURE TRACK POLARITY IS TRANSPOSED ACROSS ALL INSULATED JOINTS.
 - ⊗ = TEST TERMINALS MUST BE INSTALLED ON ALL WIRING CONNECTED TO EXTERNAL CABLES (EXCEPT TRACK AND A.C. POWER WIRES). SHOW ACTUAL DED INSTALLED LOCATION ON DRAWING.
 - PORTABLE GENERATOR EXTENSION CORD FOR 240V TO 240V IS PROVIDED AS WELL AS A 120V TO 240V ADAPTER.
 - ☆ = GCP TO OPERATE IN SEMI-BIDIRECTIONAL MODE. USE TAB 627 COUPLER.

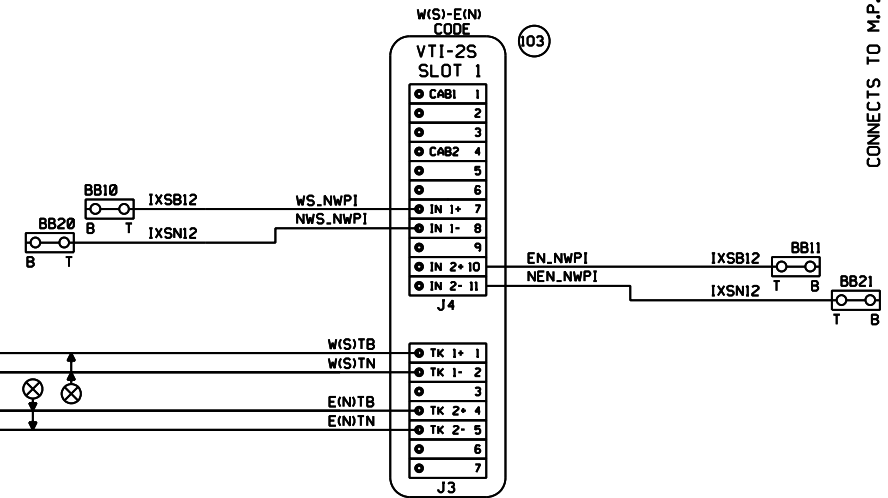
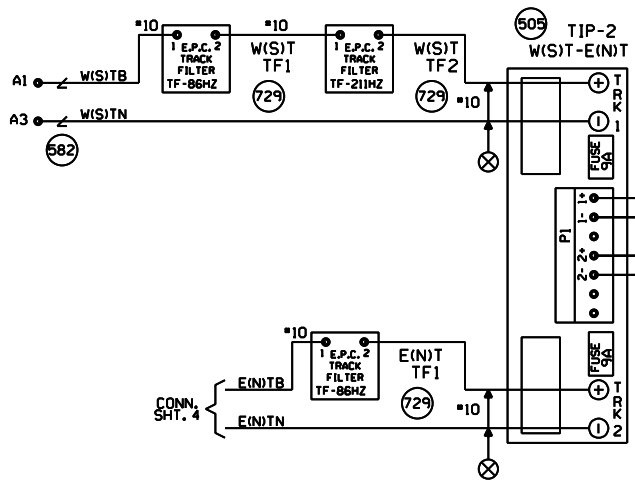

CABLE TABULATION
CABLE NO. 5 7C*14 U.G.B.T. HOUSE TO M.P. 157.75

- MATERIAL NOTES: DELETE UPON "AC"**
- 6X8 ALUMINUM CABIN U.P. PART #520-0185
 - SIG. DEPT. LOCK 170-6140 QTY: 7
 - BOOTLEG KIT P00-1731 QTY: 2
 - CONSUMABLE KIT WAYSIDE 6X8 520-1016 QTY: 1
 - NUMBER PLATE BRACKET 393-6798 QTY: 2
 - NUMBER PLATE 393-4020 QTY: 2
 - SIG FOUNDATION 520-1984 QTY: 1
 - CABLE - SIGNAL MAST P00-4365
 - CABLE - SWITCH P00-4366
 - BI RELAY KIT QTY: 4 521-0700

NEW SHEET

Design: 08/17/21 INSTALL GATES, PEDESTRIAN FLASHERS AND CMT IN A NEW CABIN @ STEWART ROAD SW, MP 157.75 Rev: 1 MOP: 61877 S/WP WIT/SPH	MODIFICATION LEVEL		CIRCUIT MODIFICATIONS ARE NOT TO BE MADE WITHOUT AUTHORITY FROM THE OFFICE OF SIGNAL DESIGN	Date: 08/17/21 Des: WIT Chk: SWP AFE: 61877	UNION PACIFIC RAILROAD ONE TRACK INTERMEDIATE SEATTLE SUBDIVISION Office of Sr. AWP Engineering - Signal/TCO Omaha, Nebraska	Sh: 1 MP: 158.25 ID: 086015825.1S
	O.A. LAST LEVEL CHECKED DW	LAST LEVEL MOD THIS TYPICAL DW				