

- ① MICROPHONE ENCLOSURE SUPPORT STANCHION – TYPICAL EIGHT PLACES  
SEE DETAIL "A" ON SHEET 3
- ② 3-INCH GALVANIZED RIGID CONDUIT (GRC) PROTRUDE 6" ABOVE BUNGALOW FLOOR – TYPICAL TWO PLACES
- ③ EQUIPMENT RACK DOORS HINGED TO OPEN FROM CENTER – TYPICAL 4 PLACES
- ④ RACK VERTICAL HEIGHT IS 40-INCHES
- ⑤ RACK VERTICAL HEIGHT IS 70-INCHES
- ⑥ AWG 2 GROUND WIRE CONNECTED TO BUNGALOW GROUND HALO
- ⑦ WORK SPACE REQUIRED FOR INSTALLATION AND MAINTENANCE – TYPICAL 2 PLACES
- ⑧ 27-INCH ACCESS DOOR TYPICAL TWO PLACES
- ⑨ 3-INCH GRC IN LINE JUNCTION BOX (TYPE C CONDUIT BODY) – TYPICAL 2 PLACES
- ⑩ VERTICAL STEEL SECTION USED TO PROTECT TADS ENCLOSURES – TYPICAL 4 PLACES  
SEE DETAIL "B" FOR EXAMPLE

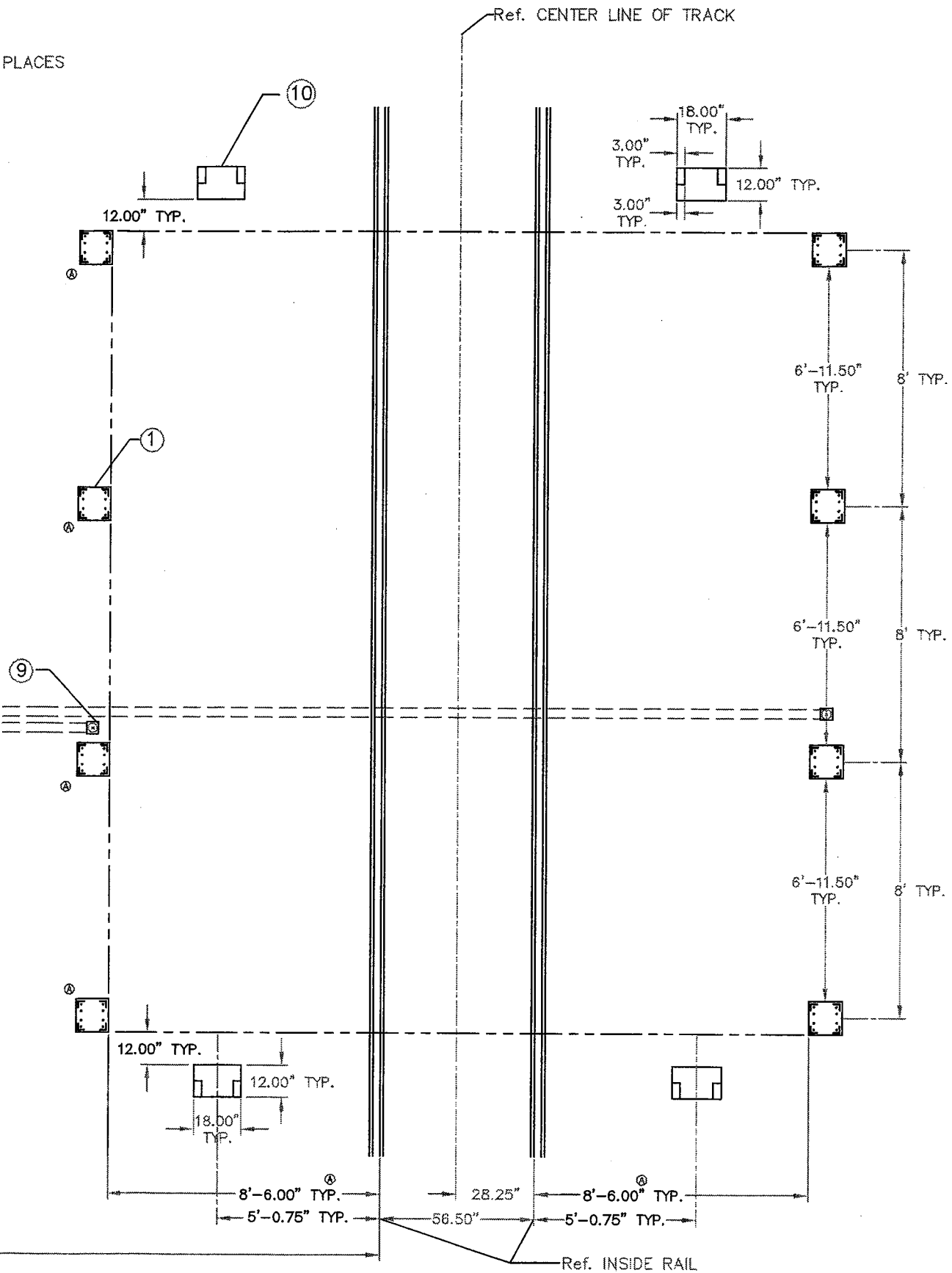

REV.	DESCRIPTION	BY	DATE
②	CHANGE DIM'S AND TAD SUPPORT STAND LOC'S.	WGL	9/30/02

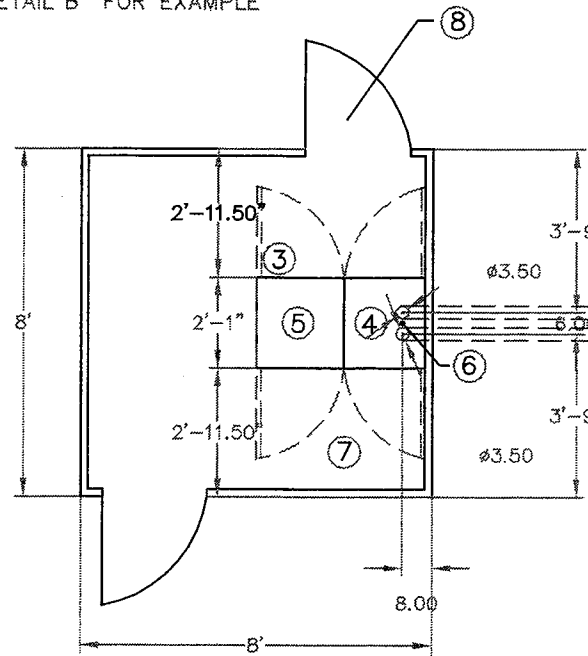

TRANSPORTATION TECHNOLOGY CENTER  
P.O. BOX 11150, PUEBLO CO. 81001

TRACKSIDE ACOUSTIC DETECTION SYSTEM (TADS)

BNSF SITE LAYOUT  
TOP VIEW – PRELIMINARY

25-TCI-001SEG02-01.00

DESIGNED: SEG  
DRAWN: LIM  
CHECKED: RLM  
APPROVED: GBA

DATE: 07/19/02  
SCALE: NTS  
TIC PROJ # C1J5  
ADD FILE #

SHEET 1 OF 3