

**WASHINGTON UTILITIES AND TRANSPORTATION COMMISSION
 CERTIFICATE OF PUBLIC CONVENIENCE AND NECESSITY
 TO OPERATE A GAS PLANT FOR HIRE**

The Washington Water Power Company of 1411 East Mission Avenue, is hereby authorized to operate a gas plant for hire in the general area or areas of:

Appendix A-1	U-9676	Amended	April 15, 1966
Appendix A-2	U-86-84	Amended	May 11, 1986
Appendix A-3	U-9976		April 15, 1966
Appendix A-4	U-9023		September 8, 1958
Appendix A-5	U-86-84	Amended	May 11, 1986
Appendix A-6	U-9115		April 2, 1959
Appendix A-7	U-9288		October 4, 1961
Appendix A-8	U-9288		October 4, 1961
Appendix A-9	U-9288		October 4, 1961
Appendix A-10	U-86-84	Amended	May 11, 1986
Appendix A-11	U-9676		April 15, 1966
Appendix A-12	U-9676		April 15, 1966
Appendix A-13	U-9764		April 7, 1967
Appendix A-14	U-9764		April 7, 1967
Appendix A-15	U-9826		April 24, 1968
Appendix A-16	U-9826		April 24, 1968
Appendix A-17	U-9954		March 24, 1970
Appendix A-18	U-73-53		March 13, 1974
Appendix A-19	U-73-53		March 13, 1974
Appendix A-20	U-73-53		March 13, 1974
Appendix A-21	U-900873	Amended	January 2, 1991
Appendix A-22	U-73-53		March 13, 1974
Appendix A-23	U-73-53		March 13, 1974
Appendix A-24	U-85-67		November 13, 1985

CONDITIONS:

1. Any gas plant operated by virtue of this certificate must be operated in accordance with the Laws of the State of Washington and the Rules and Regulations of this Commission.
2. This certificate must be kept on file at the main office of the gas company except when directed to be transmitted to the Commission, and shall be subject at all times to inspection by the authorized representatives of the Commission.
3. This certificate shall be subject to revocation and cancellation by the Commission upon a showing of procurement by false affidavit or representation.
4. This certificate is subject to the terms, conditions and provisions of the Orders in Cause Nos. U-8889, U-9021, U-9022, U-9052, U-9115, U-9288, U-9591, U-9676, U-9764, U-9826, U-9954, U-73-53, U-85-67, U-86-84, U-88-1884 and U-900873.

This certificate is issued upon finding by the Washington Utilities and Transportation Commission that public convenience and necessity requires or will require such operation in accordance with RCW 80.28.190.

Order No. UG-900873 - Dated January 2, 1991

Dated at Olympia, Washington January 22, 1991

WASHINGTON UTILITIES AND TRANSPORTATION COMMISSION

By Paul Curl
Paul Curl, Secretary

SERVICE DATE

JAN 17 1991

BEFORE THE WASHINGTON UTILITIES AND TRANSPORTATION COMMISSION

In the Matter of the Application)
of The WASHINGTON WATER POWER)
COMPANY to Amend its Certificate)
of Public Convenience and Necessity)
to Operate a Gas Plant for Hire in)
the General Area of Whitman County.)
.)

DOCKET NO. UG-900873

ORDER GRANTING
APPLICATION

On August 10, 1990 The Washington Water Power Company (WWP), a Washington corporation, filed an application to amend its present Certificate of Public Convenience and Necessity to Operate a Gas Plant for Hire, No. 6, amended to include an additional area in Whitman County. (Appendix A-6)

WWP is presently certificated for and is now providing gas service in Whitman County. The additional area in Whitman County requested is contiguous to the company's present area in Whitman County.

WWP is serving a number of commercial customers with a main extension. There is the potential of additional growth of commercial customers in the area.

This order makes no determination at this time as to the reasonableness of any gas pipeline facility construction to serve this addition to WWP's service area, but reserves the right of the Commission to determine such reasonable services and expenditures, together with the treatment of same, in any formal proceeding before the Commission dealing with WWP's results of operation for ratemaking purposes.

It appears that the application herein should be granted to satisfy the public convenience and necessity.

FINDINGS OF FACT

1. The Washington Water Power Company, a Washington corporation, operates a gas plant for hire in this state and is subject to the jurisdiction of this Commission.
2. The Washington Water Power Company has heretofore been issued a Certificate of Public Convenience and Necessity to Operate a Gas Plant for Hire No. 6, amended.

3. The Washington Water Power Company has filed an application to further amend its Certificate of Public Convenience and Necessity to Operate a Gas Plant for Hire, No. 6 amended, to include an additional area in Whitman County.

4. The operation of a gas plant for hire in the additional area requested is, or will be, required by the public convenience and necessity.

5. The Certificate of Public Convenience and Necessity to Operate a Gas Plant for Hire, No. 6, amended, presently held by The Washington Water Power Company, should be further amended to include the additional area applied for herein.

O R D E R

1. WHEREFORE, IT IS HEREBY ORDERED That the application of The Washington Water Power Company to amend its Certificate of Public Convenience and Necessity to Operate a Gas Plant for Hire, No. 6, amended, to include an additional area in Whitman County shall be and the same is hereby approved; and said Certificate shall be amended in accordance with Appendix A-6, drawing and legal description, which is attached hereto and by this reference made a part hereof as though fully set forth herein.

2. IT IS FURTHER ORDERED That the Certificate of Public Convenience and Necessity to Operate a Gas Plant for Hire, No. 6, amended, issued pursuant to Ordering Paragraph No. 1 of this order supersedes and cancels the Certificate of Public Convenience and Necessity to Operate a Gas Plant for Hire, No. 6, amended, and issued to The Washington Water Power Company on June 24, 1988 in Order No. U-88-1884.

3. IT IS FURTHER ORDERED That the Certificate issued pursuant to Ordering Paragraph No. 1 of this order is subject to the terms, conditions and provisions of the Orders in Causes numbered U-8889, U-9021, U-9022, U-9052, U-9115, U-9288, U-9591, U-9676, U-9764, U-9826, U-9954, U-73-53, U-85-67, U-86-84 and U-88-1884.

4. IT IS FURTHER ORDERED That jurisdiction over this Docket is retained to effectuate the provisions of this order.

DATED at Olympia, Washington, and effective this 16th
day of January, 1991.

WASHINGTON UTILITIES AND TRANSPORTATION COMMISSION



SHARON L. NELSON, Chairman



RICHARD D. CASAD, Commissioner



A. J. PARDINI, Commissioner

The Washington Water Power Company

Appendix A - 6 (Amended) January 2, 1991

LEGAL DESCRIPTION

Portions of Whitman County described as follows:

Beginning at the northwest corner of Section 3, Town ship 16 North, Range 43 East W.M.; thence east along the north line of Secs. 3, 2 and 1 of T. 16 N., R. 43 E. to the east corner of said Sec. 1.; thence along the east line of Secs. 1, 12, 13 and 24 of T. 16 N., R. 43 E., to the south east corner of said Sec. 24.; thence west along the south line of Secs. 24, 23, 22, 21, 20 and 19 to the center line of Sec. 19 of T. 16 N., R. 43 E.; thence north along the west centerline of Secs. 19 and 18 of T. 16 N., R. 43 E., to the center of the above center of Sec. 18; thence east along the centerline of Secs. 18 and 17, T. 16 N., R. 43 E. to the center of said Sec. 17; thence south along the centerline of Secs. 17 and 20, T. 16 N., R. 42 E. to the center of said Sec. 20; ;thence east along the centerline of Secs. 20 and 21, T. 16 N., R. 43 E. to the west line of Sec. 22 T. 16 N., R. 43 E.; ;thence north along the west line of Secs. 22, 15, 10 and 3 T. 16 N., R. 43 E. to the northwest corner of said Sec. 3 the point of beginning.

S 1/4 corner?

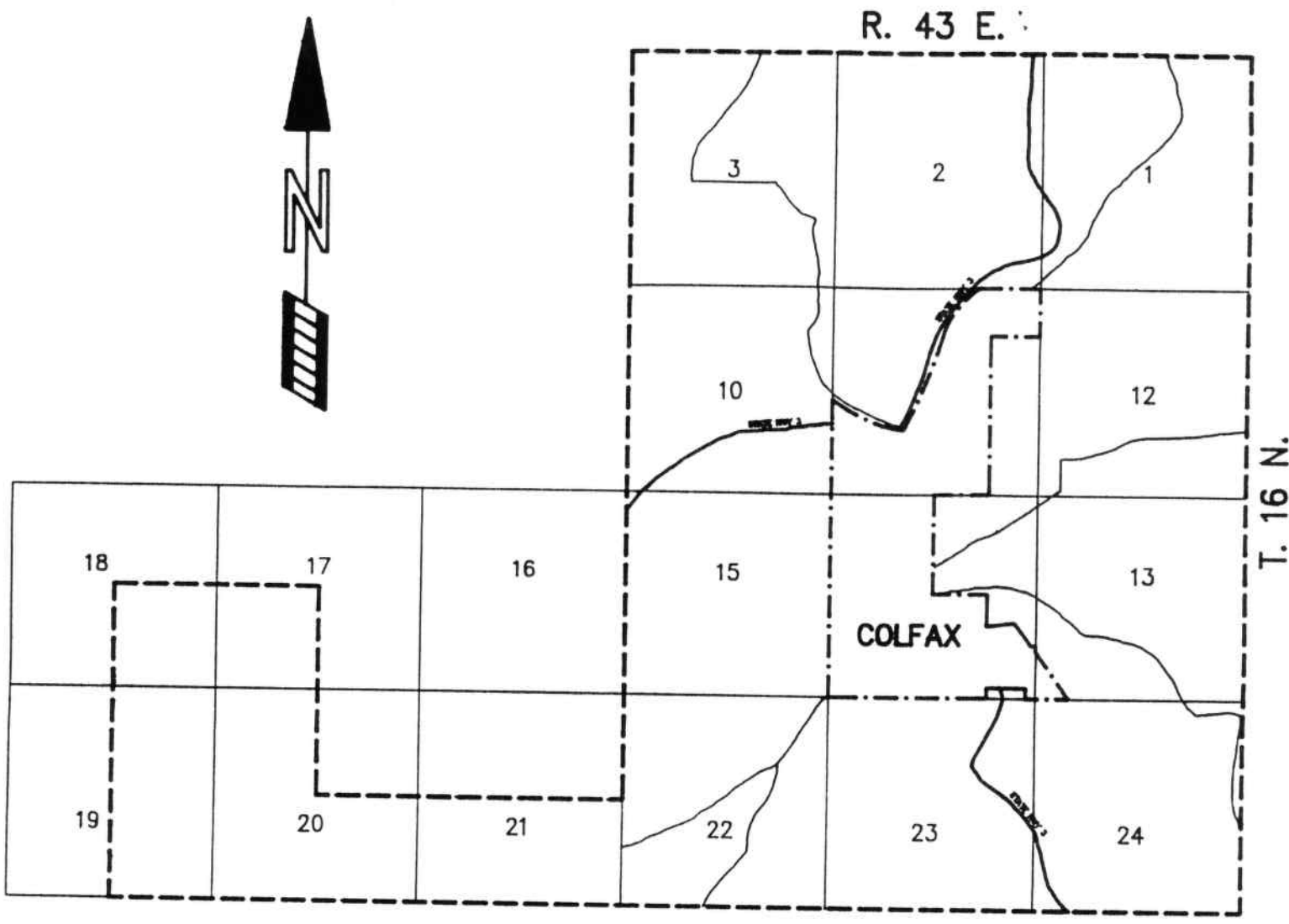

COLFAX AND VICINITY
WHITMAN COUNTY

BOUNDARY OF SERVICE AREA -----

APPENDIX A-6 (AMMENDED)
DOCKET NO. UG-900873

THE WASHINGTON
WATER POWER COMPANY



WASHINGTON
UTILITIES AND TRANSPORTATION
COMMISSION

DATE: JANUARY 16 1991 BY: R.C.C