



WASHINGTON UTILITIES AND TRANSPORTATION COMMISSION

Petitioner,

vs.

Respondent

DOCKET NO. TR-

PETITION TO CONSTRUCT A
RAILROAD-HIGHWAY GRADE
SEPARATION (OVERCROSSING
OR UNDERCROSSING)

USDOT CROSSING NO.:

By filing this petition with the Washington Utilities and Transportation Commission (UTC), the Petitioner alleges that public safety requires the construction of a highway-rail grade separated crossing (overcrossing or undercrossing) under [RCW 81.53.060](#).

Section 1 – Petitioner’s Information

Petitioner

Signature

Street Address

City, State and Zip Code

Mailing Address, if different than the street address

Contact Person Name

Contact Phone Number and Email

¹ An overcrossing means any point or place where a highway crosses a railroad by passing above the same, or any point or place where one railroad crosses another railroad not at grade. An undercrossing means any point or place where a highway crosses a railroad by passing under the same, or any point or place where one railroad crosses another not at grade. [RCW 81.53.010](#)

Section 2 – Respondent’s Information

Respondent

Street Address

City, State and Zip Code

Mailing Address, if different than the street address

Contact Person Name

Contact Phone Number and Email

Section 3 – Proposed Crossing Location

1. Name of highway/roadway:

2. USDOT number:

3. GPS location:

4. Railroad mile post (nearest tenth):

5. City:

County:

Section 4 – Current Highway Traffic Information

1. Name of highway:
2. Road authority:
3. Average annual daily traffic (AADT):
4. Number of lanes:
5. Roadway speed:
6. Is the crossing part of an established truck route? Yes No
7. If so, trucks are what percent of total daily traffic?
8. Is the crossing part of an established school bus route? Yes No
9. If so, how many school buses travel over the crossing each day?

Section 5 – Railroad Information

1. Name of railroad(s) operating at crossing:
2. Type of railroad at crossing: Common Carrier Logging Industrial
 Passenger Excursion
5. Type of tracks at crossing: Main Line Siding or Spur
6. Number of tracks at crossing:
7. Average daily train traffic, freight:
 Authorized freight train speed: Operated freight train speed:
8. Average daily train traffic, passenger:
 Authorized passenger train speed: Operated passenger train speed:

Section 6 – Description of Crossing Construction/Reconstruction

1. Describe in detail the public safety need and reasons for constructing a grade separation at this location (attach additional information sheets to petition as needed):

2. How far is the nearest alternate access across the tracks from the crossing?

3. Describe the alternate access route, including distance and driving time:

4. Will the proposed crossing eliminate the need for one or more existing crossings?

Yes

No

N/A

5. If so, identify the crossing(s) by USDOT number and state the distance and direction from the proposed crossing.

6. If the grade separation is replacing an existing at-grade crossing, describe what will happen with the existing crossing during construction of the grade separation, as well as what will happen with the crossing surface, signage, and signal equipment once the grade separation is complete.

7. Who is responsible for long-term maintenance of the grade separation?

Section 7 – Illustration of Grade Separated Crossing

Attach a diagram, design drawing, map, or other illustration showing the location of the railroad and the proposed/existing location of the crossing. Include the parcels of private property located on both sides of the proposed crossing for a distance of 500' from the crossing and the name and mailing address of each property owner.

Section 8 – Cost Apportionment

If the commission approves the construction of the grade separated crossing requested in this petition, it will apportion costs in accordance with the applicable statutes. ([RCW 81.53.130](#)).

In the alternative, if the parties to this petition have reached an agreement related to apportionment of costs, please sign here to confirm:

Petitioner Signature:

Respondent Signature:

Section 9 – Respondent's Review

The undersigned represents the Respondent in this petition to construct a highway-rail grade separation.

USDOT Crossing No.:

We have investigated the conditions at the proposed crossing site. We are satisfied the conditions are the same as described by the Petitioner. We consent to a decision by the commission based on a review of the documents filed in this docket.

Dated at _____, Washington, on the _____ day of _____

Printed name of Respondent

Signature of Respondent's Representative

Title

Phone Number

Email

Mailing Address

Checklist prior to submitting petition:

- ✓ Ensure all petition fields are completed.
- ✓ Ensure parties sign Section 8 regarding any Cost Apportionment agreement, if applicable.
- ✓ Obtain signature on Respondent's Review (Section 9). *If the respondent fails to sign this section, advise UTC staff upon submission.*
- ✓ Attach copies of:
 - Illustration of crossing (described in Section 7).
 - Any other relevant documents to support the petition, including but not limited to support of public need, project information, etc.

Submitting the petition: To officially file the petition, send the petition form and supporting documents via [EFiling](#).

Questions: For questions, please contact:

Mike Turcott Transportation Planning Specialist mike.turcott@utc.wa.gov (360) 764-0572	Tyler Whitcomb Transportation Planning Specialist tyler.whitcomb@utc.wa.gov (564) 669-0943
---	---

Xrefs:
X-CPKWY-EXRW
X-CPKWY-SRVY
KPG Survey
KPFF Survey - CP
X-CPKWY-S-PAVE
X-CPKWY-S-ROW
X-CPKWY-S-KEYP
X-CPKWY-2234xtb
X-CPKWY-S-RAIL

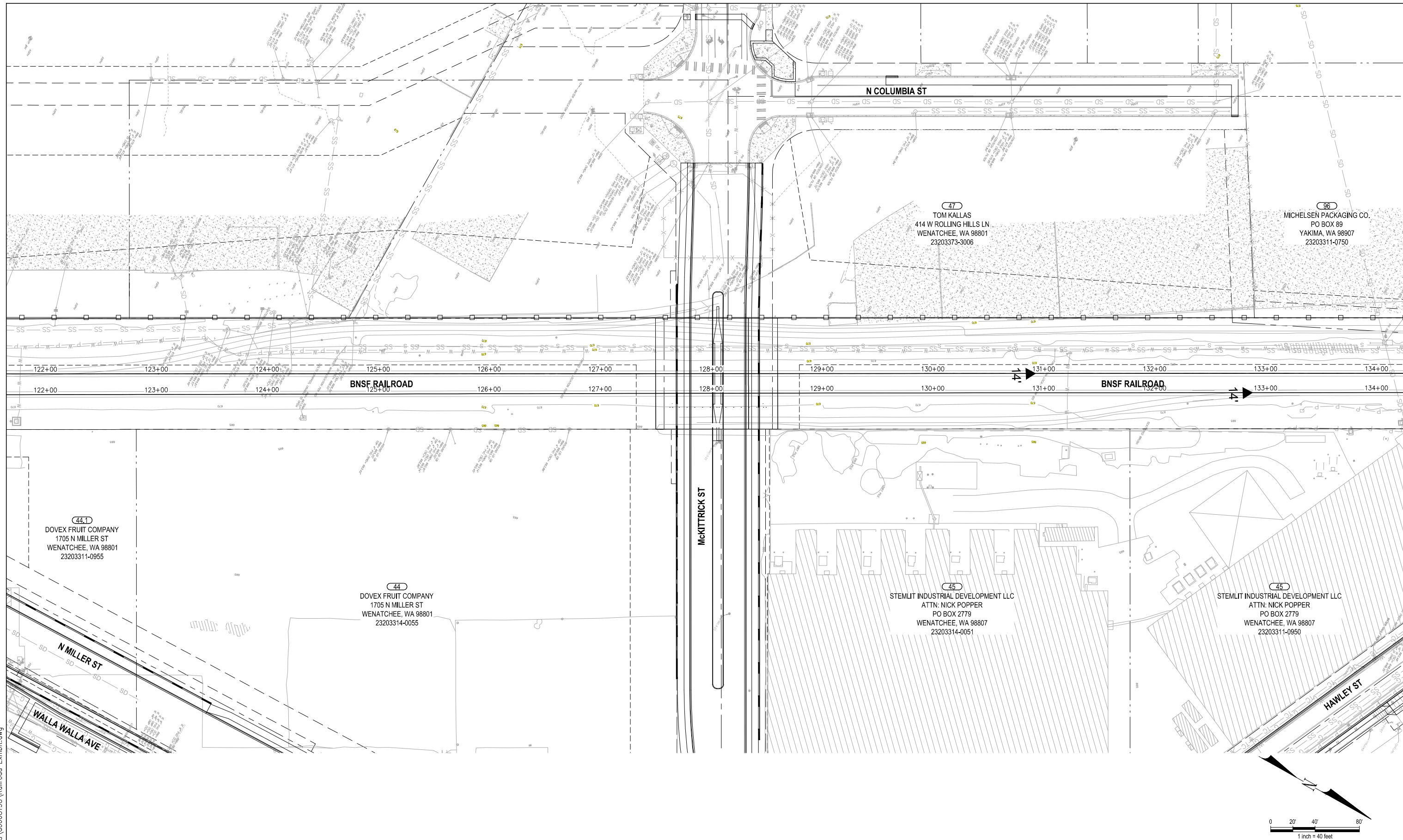

CAD USER: tomc PLOT DATE: Oct 31, 2024-01:32pm
PATH: C:\pw_work\horrocks\d0668198\Railroad Exhibit

PATH: C:\pw_work\horrocks\d0668198\Railroad Exhibit.dwg



1601 5th Avenue, Suite 1600
Seattle, WA 98101
206.622.5822
www.kpff.com



**KRAEMER
SCARSELLA
JOINT VENTURE**

NOT FOR CONSTRUCTION

[illegible]

CONFLUENCE PARKWAY PHASE 1
WENATCHEE, WA

BNSF RAILROAD EXHIBIT

DRAWN: TLC	PROJECT NO.: 2300356
DESIGN: KAI	SCALE: 1"=40'
CHECKED: KAI	DATE: 8-23-2024
DRAWING NO.	
EXHIBIT-2	
SHEET NO. 2 OF 3	

PRE-FINAL SUBMITTAL