



WASHINGTON UTILITIES AND TRANSPORTATION COMMISSION

City of Kent

Petitioner,

vs.

BNSF Railway

Respondent

DOCKET NO. TR-

PETITION TO MODIFY WARNING DEVICES AT A HIGHWAY-RAILROAD GRADE CROSSING

USDOT: 085636V

The Petitioner asks the Washington Utilities and Transportation Commission to approve modifications to warning devices at a highway-rail grade crossing.

Section 1 – Petitioner’s Information

City of Kent  
Petitioner

*Rob Brown*     *Mar 24, 2023*  
Signature

400 W. Gowe St  
Street Address

Kent, WA 98032  
City, State and Zip Code

Same as above  
Mailing Address, if different than the street address

Rob Brown  
Contact Person Name & Signature

253-856-5571 RBrown@KentWA.gov  
Contact Phone Number and Email

*Section 2 – Respondent’s Information*

BNSF Railway
Respondent
605 Puyallup Ave
Street Address
Tacoma, WA 98421
City, State and Zip Code
Same as above
Mailing Address, if different than the street address
Alex Funderburg, Jr
Contact Person Name
206-625-6152 alex.funderburgjr@bnsf.com
Contact Phone Number and Email

*Section 3 – Crossing Location*

1. Existing highway/roadway:	Meeker St		
2. Existing railroad:	BNSF Railway		
3. USDOT Crossing No.:	085636V		
4. GPS location:	47.3816072, -122.233071		
5. Railroad mile post (nearest tenth):	16.3		
6. City:	Kent	County:	King

*Section 4 – Highway Information*

1. Name of highway:	Meeker St
2. Road authority:	City of Kent
3. Average annual daily traffic (AADT):	4,139
4. Number of lanes:	2
5. Roadway speed:	25 mph
6. Is the crossing part of an established truck route?	<input type="checkbox"/> Yes <input checked="" type="checkbox"/> No
7. If so, trucks are what percent of total daily traffic?	
8. Is the crossing part of an established school bus route?	<input type="checkbox"/> Yes <input checked="" type="checkbox"/> No
9. If so, how many school buses travel over the crossing each day?	
10. Describe any changes to the information in 1 through 7, above, expected within ten years:	No changes beyond background growth are expected within the next 10 years
11. What is the available sight distance from the stop bar (or 25 feet from the tracks if no stop bar) on both approaches to the crossing?	Eastbound, to right: 60' Eastbound, to left: 80' Westbound, to right: 70' Westbound, to left: 100'
12. If the sight distance is less than 400 feet, describe the structures, roadway or track curvature, visual obstacles or other characteristics that limit sight distance:	Eastbound, to right: Future trespass fence Eastbound, to left: Future trespass fence Westbound, to right: Existing property fence Westbound, to left: Future trespass fence

*Section 5 – Railroad Information*

1. Railroad company:

2. Type of railroad at crossing:  Common Carrier  Logging  Industrial  
 Passenger  Excursion

3. Type of tracks at crossing:  Main Line  Siding or Spur

4. Number of tracks at crossing:

5. Average daily train traffic, freight:

Authorized freight train speed:  Operated freight train speed:

6. Average daily train traffic, passenger:

Authorized passenger train speed:  Operated passenger train speed:

7. Describe any changes to the information in 1 through 4, above, expected within ten years:

### ***Section 6 – Current Warning Devices***

Provide a complete description of the warning devices currently located at the crossing (vehicle and pedestrian), including signs, gates, lights, train detection circuitry, and any other warning devices.

Current warning devices consist of:

- \* R15-1 Crossbuck and R15-2P Number of Tracks signs
- \* W10-1 Grade Crossing Advanced Warning signs on Meeker St
- \* W10-2 Grade Crossing and Intersection Advanced Warning signs on 1st Ave S and Railroad Ave N
- \* Primary and supplemental I-13 Emergency Notifications Signs
- \* Grade Crossing Pavement Markings on Meeker St
- \* Stop Lines for crossing
- \* Two-quadrant automatic gates for Meeker St
- \* Automatic mast and overhead flashing LED lights for Meeker St
- \* Pedestrian bells
- \* Constant warning time detection
- \* Mountable median curb with pylons on both sides of crossing

### ***Section 7 – Description of Proposed Changes***

Describe in detail the number and type of proposed automatic signals (vehicle and pedestrian), gates, other warning devices, and/or changes to train detection circuitry. ([RCW 81.53.271](#)) Please describe any other proposed changes at the crossing, including changes to the crossing surface, signage, pavement markings, etc. If sidewalks are being installed, please provide information on who will maintain them. Attach additional information sheets, if needed.

Proposed crossing modifications include:

- \* Relocate the crossing Stop Lines per the MUTCD
- \* Relocate Grade Crossing Pavement Markings east of the crossing.
- \* Install LED edge flashing R8-8 No Not Stop On Tracks and R3-4 No U-Turn signs for eastbound and westbound Meeker St in the northeast and southwest quadrants
- \* Install double-sided R15-8 Look signs in all four quadrants
- \* Remove existing mountable curb with pylons and install a two-foot wide, seven-inch tall non-traversable on both sides of the crossing
- \* Install roadway channelization to narrow lanes to 12' with shoulders.
- \* Extend sidewalks and install ADA-compliant detectable warning surfaces in the northeast, northwest and southwest quadrants
- \* Construct new sidewalks with ADA-compliant detectable warning surfaces in the southeast quadrants

***Section 8 – Illustration of Crossing***

Attach a detailed diagram, design drawing, map, or other illustration showing the current and proposed layout of the road, crossing surface, and railway in the vicinity of the crossing, including shoulders, sidewalks, lanes of travel, bike lanes, warning devices, pavement markings and any other applicable crossing conditions.

***Section 9 – Description of Public Safety Need***

Describe and support the public safety need for the proposed changes. ([RCW 81.53.261](#))

Public safety at this crossing will be improved by the installation of improved existing warning signs, installing additional warning signs, relocating pavement markings, making pedestrian improvements at the crossing, and installing non-traversable medians between directions of vehicle traffic on the both sides of the crossing.

***Section 10 – Approximate Cost of Installation and Related Work***

Provide the approximate cost of installation and related work for the proposed changes to signals and/or warning devices. ([RCW 81.53.271](#))

The approximate cost of the proposed changes to the warning devices is \$283,000

***Section 11 – Approximate Cost of Annual Maintenance***

Provide the approximate cost of annual maintenance for the signals and/or warning devices. ([RCW 81.53.271](#))

The approximate average annual cost of maintenance for the signs and pavement markings at this crossing is \$4,200. The City of Kent will be responsible for the costs of maintaining the signs and pavement markings at this crossing with the exception of the Crossbuck (R15-1), number of tracks (R15-2P), and the Emergency Notification Signs (I-13) installed by BNSF.

*Section 12 – Cost Apportionment*

If the commission directs the installation of or changes to the warning devices requested in this petition, it will apportion installation and maintenance costs in accordance with the applicable statutes. (RCW 81.53.261-295)

Interested parties may instead enter into an agreement providing for the installation of signals or other warning devices or for the apportionment of the cost of installation and maintenance. (RCW 81.53.261) **If the parties to this petition have reached an agreement related to apportionment of costs, please sign here to confirm:**

Petitioner Signature:  Respondent Signature: 

*Section 13 – Waiver of Hearing by Respondent*

**Waiver of Hearing**

The undersigned represents the Respondent in the petition to modify highway-rail grade crossing warning devices at the following crossing.

USDOT Crossing No.

We have investigated the conditions at the crossing. We are satisfied the conditions are the same as described by the Petitioner in this docket. We agree the warning devices should be modified and consent to a decision by the commission without a hearing.

Dated at  , Washington, on the 6 day of

Printed name of Respondent



Signature of Respondent's Representative

Title

Phone Number

Email Address

Mailing address



**Checklist prior to submitting petition:**

- ✓ Ensure all petition fields are completed.
- ✓ Ensure parties sign Section 12 regarding any Cost Apportionment agreement, if applicable.
- ✓ Obtain signature on Waiver of Hearing (Section 13). *If respondent fails to sign Waiver, advise UTC staff upon submission.*
- ✓ Attach copies of:
  - Illustration of crossing (described in Section 8).
  - Any other relevant documents to support the petition, including but not limited to support of public need, project information, etc.

**Submitting the petition:** To officially file the petition, send the petition form and supporting documents to [records@utc.wa.gov](mailto:records@utc.wa.gov).

---

**Questions:** For questions, please contact:

<p><b>Mike Turcott</b> Transportation Planning Specialist <a href="mailto:mike.turcott@utc.wa.gov">mike.turcott@utc.wa.gov</a> (360) 764-0572</p>	<p><b>Betty Young</b> Rail Safety Program Advisor <a href="mailto:betty.young@utc.wa.gov">betty.young@utc.wa.gov</a> (360) 292-5470</p>
---	---

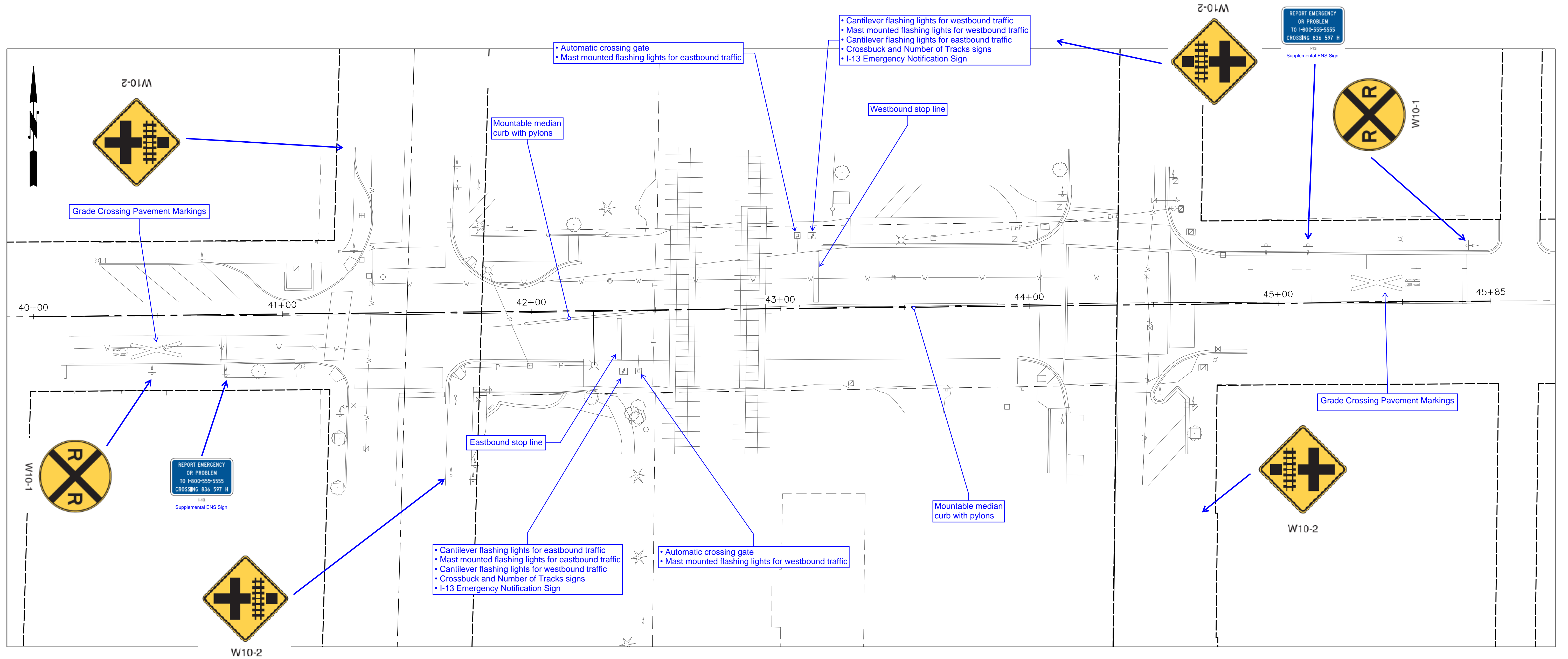

Existing Conditions

DESIGNED: BRAA	CHECKED: DNH	KENT PROJECT NO. 23-3028	SCALE: 1"=20'
DRAWN: BRAA	PROJECT ENGR: TJH	CONST. MGMT. REVIEW	HORIZ: -
APPROVED: _____	CITY ENGINEER	DATE	VERT: -

BAR IS ONE INCH ON ORIGINAL DRAWING ADJUST SCALES ACCORDINGLY

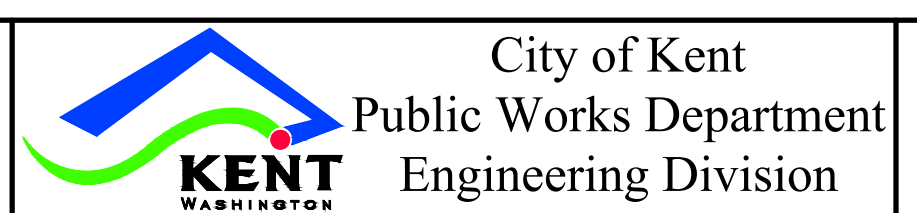

**MEEKER ST EXISTING CONDITIONS**

**BNSF RAILROAD QUIET ZONE**

085636V Meeker St  
Proposed Crossing Modifications

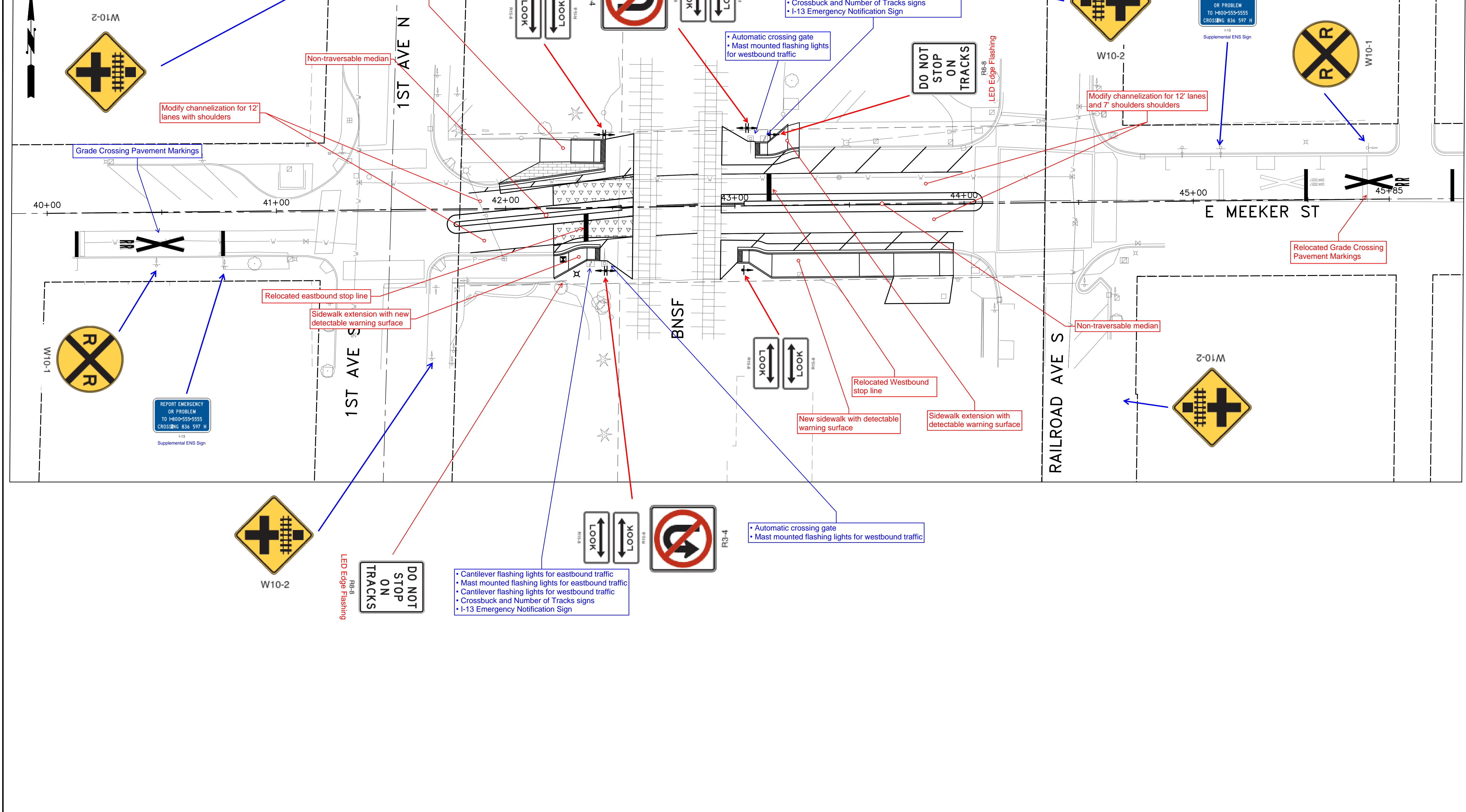

— Existing Conditions  
— Proposed Modifications

DESIGNED: BRAA		CHECKED: DNH		KENT PROJECT NO. 23-3028		SCALE: HORIZ: 1"=20'		BAR IS ONE INCH ON ORIGINAL DRAWING ADJUST SCALES ACCORDINGLY 0" 1"		<b>MEEKER ST CONSTRUCTION PLAN</b>	<b>BNSF RAILROAD QUIET ZONE</b>	SHEET 8 OF 14 FILE NO. BNSF_Meeker_Intersection Plan
DRAWN: BRAA		PROJECT ENGR: TJH		CONST. MGMT. REVIEW		VERT: -						
NO.	REVISION	BY	DATE	APPROVED: _____ CITY ENGINEER		DATE						