



WASHINGTON UTILITIES AND TRANSPORTATION COMMISSION

Franklin County, Washington

Petitioner,

vs.

Burlington Northern Santa Fe Railroad Company

Respondent.

DOCKET NO. TR-

PETITION TO MODIFY HIGHWAY-  
RAIL GRADE CROSSING PASSIVE  
WARNING DEVICES

USDOT # 089696T

The Petitioner asks the Washington Utilities and Transportation Commission to approve modification of highway-rail grade crossing passive warning devices.

*Section 1 – Petitioner’s Information*

<u>Franklin County, Washington</u>
Petitioner
<u>Craig Erdman</u>
Signature
<u>3416 Stearman Avenue</u>
Street Address
<u>Pasco, WA 99301</u>
City, State and Zip Code
<u>Mailing Address, if different than the street address</u>
<u>Craig Erdman, County Engineer</u>
Contact Person Name
<u>509-545-3514 / cerdman@co.franklin.wa.us</u>
Contact Phone Number and Email Address

*Section 2 – Respondent's Information*

<b>Burlington Northern Santa Fe Railroad Company</b>
Respondent
<b>2454 Occidental Avenue South Ste 2D</b>
Street Address
<b>Seattle, Washington 98134</b>
City, State and Zip Code
Mailing Address, if different than the street address
<b>Stephen Semenick</b>
Contact Person Name
<b>(206)625-6152, Stephen.Semenick@BNSF.com</b>
Contact Phone Number and Email Address

*Section 3 – Crossing Location*

1. Name of highway/roadway:	<b>Hailey Road</b>		
2. Name of railroad:	<b>Burlington Northern Santa Fe Railroad Company</b>		
3. USDOT Crossing No.:	<b>089696T</b>		
4. GPS location:	<b>46.55700, -119.00066</b>		
5. Railroad mile post (nearest tenth):	<b>121.4</b>		
6. City:	<b>Mesa</b>	County:	<b>Franklin County</b>

*Section 4 – Current Highway Traffic Information*

1. Name of highway Hailey Road

2. Road authority Franklin County - Public Works Department

3. Average annual daily traffic (AADT) 12

4. Number of lanes 2

5. Roadway speed 50

6. Is the crossing part of an established truck route? Yes  No

7. If so, trucks are what percent of total daily traffic? n/a

8. Is the crossing part of an established school bus route? Yes  No

9. If so, how many school buses travel over the crossing each day? n/a

*Section 5 – Current Crossing Information*

1. Railroad company Burlington Northern Santa Fe - BNSF

2. Type of railroad at crossing  Common Carrier  Logging  Industrial  
 Passenger  Excursion

3. Type of tracks at crossing  Main Line  Siding or Spur

4. Number of tracks at crossing 1

5. Average daily train traffic, freight 40  
Authorized freight train speed 60 mph Operated freight train speed \_\_\_\_\_

6. Average daily train traffic, passenger 2  
Authorized passenger train speed 75 mph Operated passenger train speed \_\_\_\_\_

7. Describe any changes to the information in 1 through 4, above, expected within ten years:

None known

8. What is the available sight distance from the stop bar (or 25 feet from the tracks if no stop bar) on both approaches to the crossing?

Looking north from the east side of the crossing ~ 1500 ft (NE)

Looking south from the east side of the crossing ~ 1500 ft (SE)

Looking north from the west side of the crossing ~ 1500 ft (NW)

Looking south from the west side of the crossing ~ 1500 ft (SW)

9. If the sight distance is less than 400 feet, describe the structures, roadway or track curvature, visual obstacles or other characteristics that limit sight distance.

n/a

***Section 6 – Current Warning Devices***

Provide a complete description of the warning devices currently located at the crossing, including signs and any other warning devices (e.g., crossbucks, yield signs, advance warning signs, etc.).

Heading east on Hailey from Old SR- 17 to RR crossing

- Railroad Advance sign located 300 ft from crossing
- Crossbucks and Yield sign located 15 ft from crossing on same post

Head west on Hailey from Russell Road to RR crossing

- Crossbucks and Yield sign located 15 ft from crossing on same post

***Section 7 – Description of Proposed Changes***

Describe in detail the proposed changes to the passive warning devices at the crossing. Include the funding source for the proposed installation, if applicable.

Heading east on Hailey from Old SR-17 to RR crossing

- Flashing solar powered stop ahead sign with motion detection located 500 ft from crossing
- Railroad advance sign located from 250 ft from crossing
- Flashing solar powered stop sign with motion detection located 17 ft from crossing
- Crossbucks located 17 ft from crossing

Heading west on Hailey from Russell Rd to RR crossing

- Flashing solar powered stop ahead sign with motion detection located 500 ft from crossing
- Railroad advance sign located from 250 ft from crossing
- Flashing solar powered stop sign with motion detection located 17 ft from crossing
- Crossbucks located 17 ft from crossing

***Section 8 – Illustration of Proposed Warning Devices***

Attach a detailed design diagram, drawing, map or other illustration showing the proposed warning devices.

*Section 9 – Waiver of Hearing by Respondent*

**Waiver of Hearing**

The undersigned represents the Respondent in this petition to change the passive warning devices at this crossing.

We have investigated the conditions at the crossing. We are satisfied the conditions are the same as described by the Petitioner in this docket. We do not oppose the proposed passive warning device changes at this crossing and consent to a decision by the commission without a hearing.

Dated at Seattle, Washington, on the 27 day of  
March, 2019.

**Stephen Semenick**

Printed name of Respondent

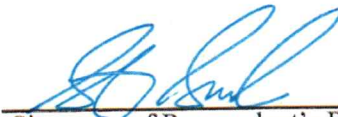

Signature of Respondent's Representative

**Manager Public Projects**

Title

206-625-6152; stephen.semenick@bnsf.com

Phone number and email address

**2454 Occidental Ave S, Ste 2D**

**Seattle, WA 98134**

Mailing address

# CRP 620 HAILEY RAILROAD/HIGHWAY CROSSING

FEDERAL AID NO. RAIL-2011(051)  
CONTRACT NO. CRP 620

VICINTY MAP

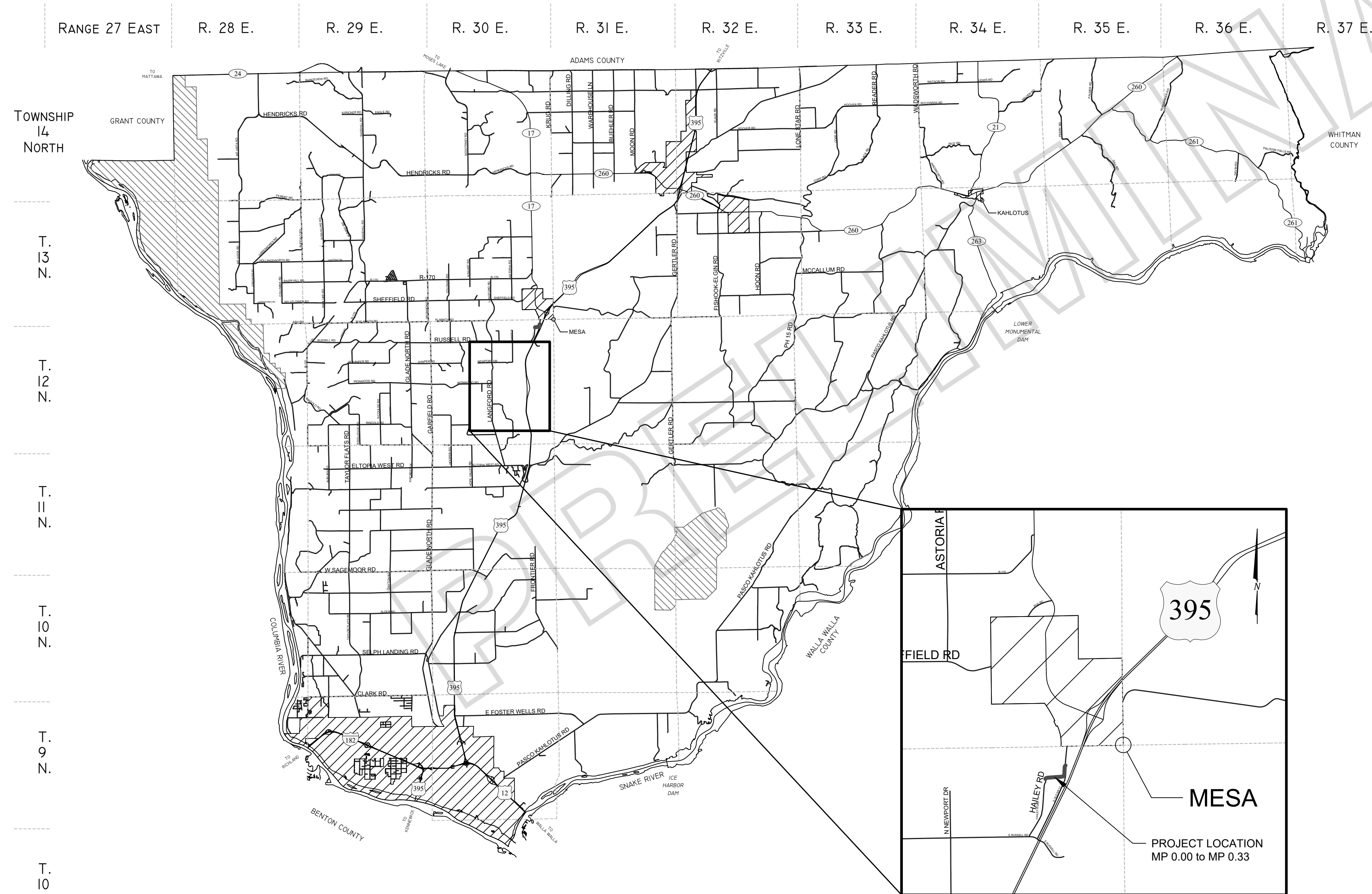

GENERAL	
G001	GENERAL NOTES, INDEX, SUMMARY OF QUANTITIES, VICINITY MAP
CIVIL	
C101	CRP 620 PLAN SHEET
C102	DETAILS

**GENERAL NOTES:**

1. ALL WORK AND MATERIALS SHALL BE COMPLETED IN ACCORDANCE WITH THE LATEST REVISION OF THE WSDOT STANDARD SPECIFICATIONS FOR ROAD, BRIDGE, AND MUNICIPAL CONSTRUCTION 2018 AND FRANKLIN COUNTY STANDARDS AND SPECIFICATIONS AND ALL OTHER GOVERNING AGENCY'S STANDARDS.
2. THE CONTRACTOR SHALL OBTAIN AND MAKE AVAILABLE COPIES OF APPLICABLE GOVERNING AGENCY STANDARDS AT THE JOB SITE DURING THE RELATED CONSTRUCTION OPERATIONS.
3. THE CONTRACTOR SHALL BE RESPONSIBLE FOR VERIFYING THE LOCATIONS, DIMENSIONS, AND DEPTHS OF ALL UTILITIES PRIOR TO CONSTRUCTION. ALL UTILITY LOCATIONS SHOWN ON THE PLANS ARE APPROXIMATE.
4. THE CONTRACTOR SHALL BE RESPONSIBLE TO COORDINATE WITH AND CONTACT ALL INVOLVED UTILITIES PRIOR TO CONSTRUCTION.
5. THROUGH TRAFFIC WILL BE MAINTAINED THROUGHOUT CONSTRUCTION. CONTRACTOR SHALL SUBMIT, FOR APPROVAL BY THE ENGINEER, A TRAFFIC CONTROL PLAN. ALL TRAFFIC CONTROL DEVICES SHALL CONFORM TO THE CURRENT EDITION OF THE MANUAL OF UNIFORM TRAFFIC CONTROL DEVICES (MUTCD).
6. THE CONTRACTOR SHALL BE RESPONSIBLE FOR THE PROTECTION OF ALL ADJACENT PROPERTY DURING CONSTRUCTION.
7. FIELD VERIFY ALL DIMENSIONS AND EXISTING CONDITIONS. ANY DISCREPANCY MUST IMMEDIATELY BE BROUGHT TO THE ATTENTION OF THE ENGINEER FOR RESOLUTION BEFORE PROCEEDING WITH CONSTRUCTION.

**SUMMARY OF QUANTITIES**

ITEM NO.	STD. NO.	TOTAL QTY.	UNIT	DESCRIPTION
<b>PREPARATION</b>				
1	0001	L.S.	L.S.	MOBILIZATION
2	0050	L.S.	L.S.	REMOVAL OF STRUCTURE AND OBSTRUCTION
<b>EROSION CONTROL AND ROADSIDE PLANTING</b>				
3	6403	2	DAYS	ESC LEAD
<b>TRAFFIC</b>				
4		2	EACH	FLASHING SOLAR POWERED STOP AHEAD WITH MOTION DETECTION
5		2	EACH	FLASHING SOLAR POWERED STOP WITH MOTION DETECTION
6		2	EACH	GRADE CROSSING
7		2	EACH	GRADE CROSSING ADVANCE WARNING
8	6971	L.S.	L.S.	PROJECT TEMPORARY TRAFFIC CONTROL
<b>OTHER ITEMS</b>				
9	7736	1	L.S.	SPCC PLAN
10		1	L.S.	FLAGGER (RAILROAD)

**MILEAGE CHART**

PASCO TO PROJECT LOCATION	27 MI.
CONNELL TO PROJECT LOCATION	13 MI.
BASIN CITY TO PROJECT LOCATION	12 MI.
KAHLOTUS TO PROJECT LOCATION	31 MI.
ELTOPIA TO PROJECT LOCATION	12 MI.

INDEX

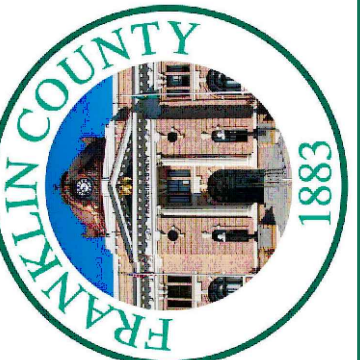

FRANKLIN COUNTY  
PUBLIC WORKS DEPARTMENT  
3416 STEARMAN AVE.  
PASCO, WA 99301  
(509)545-3514  
WEB: WWW.CO.FRANKLIN.WA.US

REVISION	NO.	DESCRIPTION	BY	DATE

CRP 620  
HAILEY RAILROAD/HIGHWAY  
CROSSING  
GENERAL



FEDERAL AID NUMBER  
RAIL-2011(051)  
CONTRACT NUMBER  
CRP 620  
STATE WA REGION SC  
PLAN CHECK  
DRAWN BY: HMB  
DESIGNED BY: HMB  
CHECKED BY: CBE  
DATE: 2019-02-13 12:05:46  
CADD DWG  
620BASE

REF. NO. SHEET  
G001 1 OF 3



TOWNSHIP 12 NORTH, RANGE 30 EAST, W.M.

NW ¼ SEC. 1

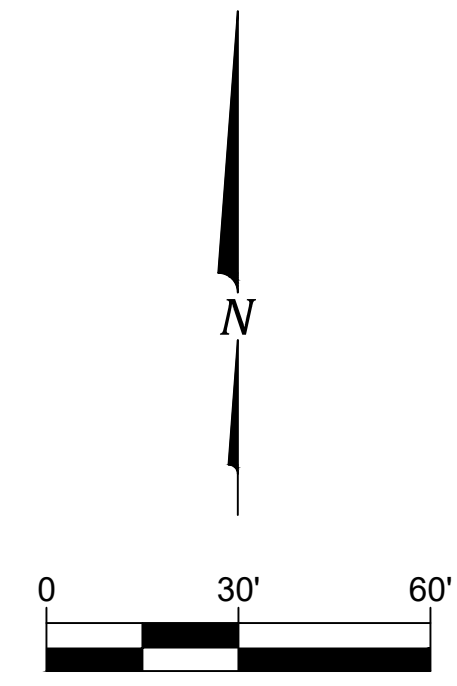

SIGN NO.	SIGN CODE (DESCRIPTION)	LOCATION		SIGN SIZE		POST	REMARKS
		STATION	OFFSET	X	Y		
1	W3-1 STOP AHEAD	12+53.48	16.00' LEFT	30"	30"	FC-G24.40-06	FLASHING SOLAR POWERED SIGN WITH MOTION DETECTION
2	W10-1 RAILROAD CROSSING ADVANCE	10+03.48	16.00' LEFT	36"	36"	FC-G24.40-06	
3	R1-1 STOP	7+70.48	16.00' LEFT	30"	30"	FC-G24.40-06	FLASHING SOLAR POWERED SIGN WITH MOTION DETECTION
4	R15-1 GRADE CROSSING	7+70.48	16.00' LEFT	36"	36"	FC-G24.40-06	
5	R15-1 GRADE CROSSING	7+36.48	16'.00' RIGHT	36"	36"	FC-G24.40-06	
6	R1-1 STOP	7+36.48	16'.00' RIGHT	30"	30"	FC-G24.40-06	FLASHING SOLAR POWERED SIGN WITH MOTION DETECTION
7	W10-1 RAILROAD CROSSING ADVANCE	5+03.48	16'.00' RIGHT	36"	36"	FC-G24.40-06	
8	W3-1 STOP AHEAD	2+53.48	16'.00' RIGHT	30"	30"	FC-G24.40-06	FLASHING SOLAR POWERED SIGN WITH MOTION DETECTION



**FRANKLIN COUNTY**  
**PUBLIC WORKS DEPARTMENT**  
 3416 STEARMAN AVE.  
 PASCO, WA 99301  
 (509)545-3514  
 WEB: WWW.CO.FRANKLIN.WA.US

REVISION	NO.	DESCRIPTION	BY	DATE

**CRP 620**  
**HAILEY RAILROAD/HIGHWAY**  
**CROSSING**  
 PLAN

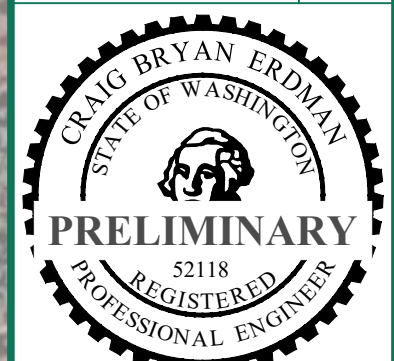

**PRELIMINARY**  
 REGISTERED PROFESSIONAL ENGINEER

FEDERAL AID NUMBER  
 RAIL-2011(051)  
 CONTRACT NUMBER  
 CRP 620

STATE	REGION
WA	SC

PLAN CHECK  
 DRAWN BY: HMB  
 DESIGNED BY: HMB  
 CHECKED BY: CBE  
 DATE: 2019-02-13 12:05:47  
 CADD DWG  
 620BASE

REF. NO.	SHEET
C101	2 OF 3



**Figure 8B-3. Crossbuck Assembly with a YIELD or STOP Sign on a Separate Sign Support (Sheet 2 of 2)**

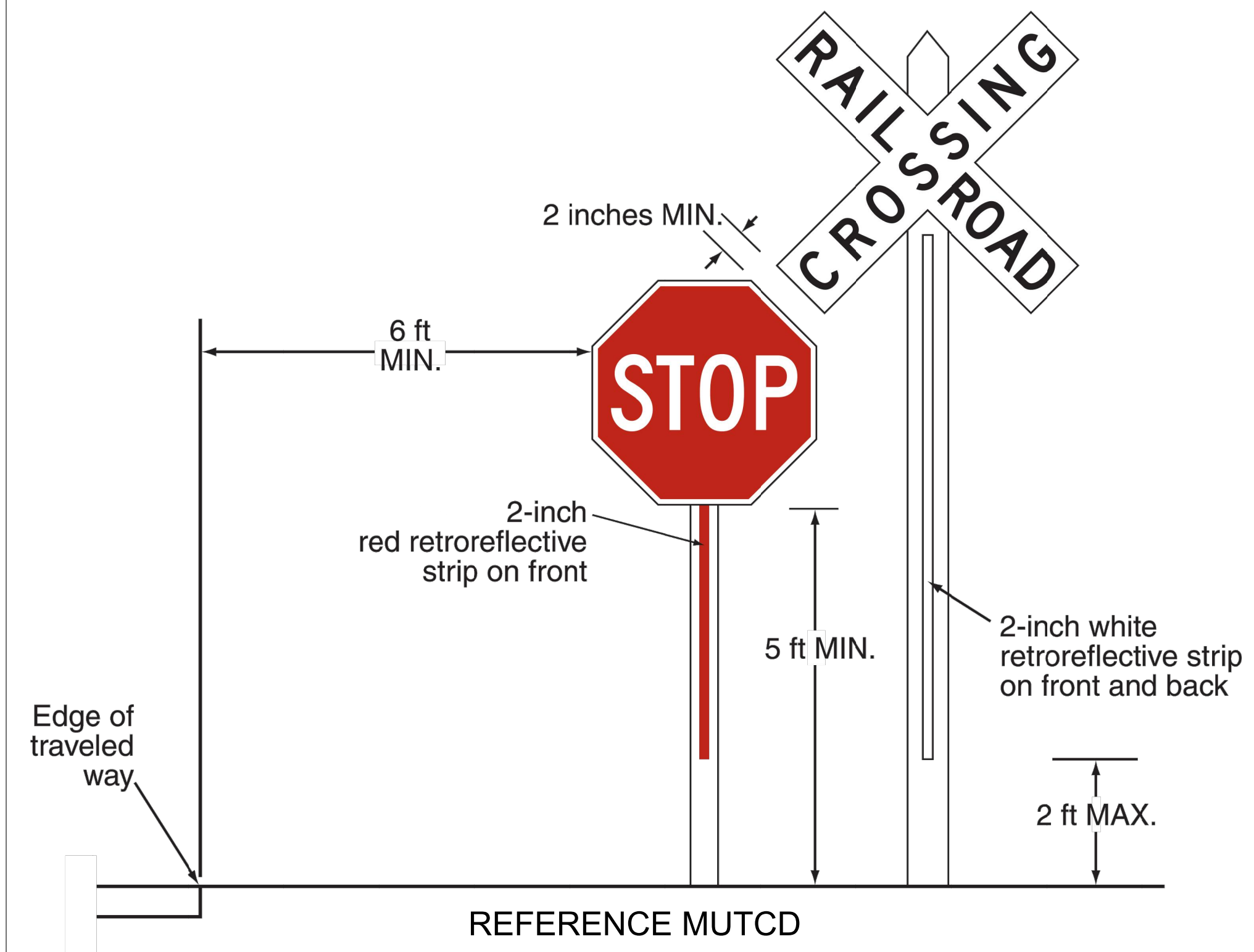

R1-1  
30"x30"



W3-1  
30"x30"



R15-1  
36"x36"



W10-1  
36"x36"

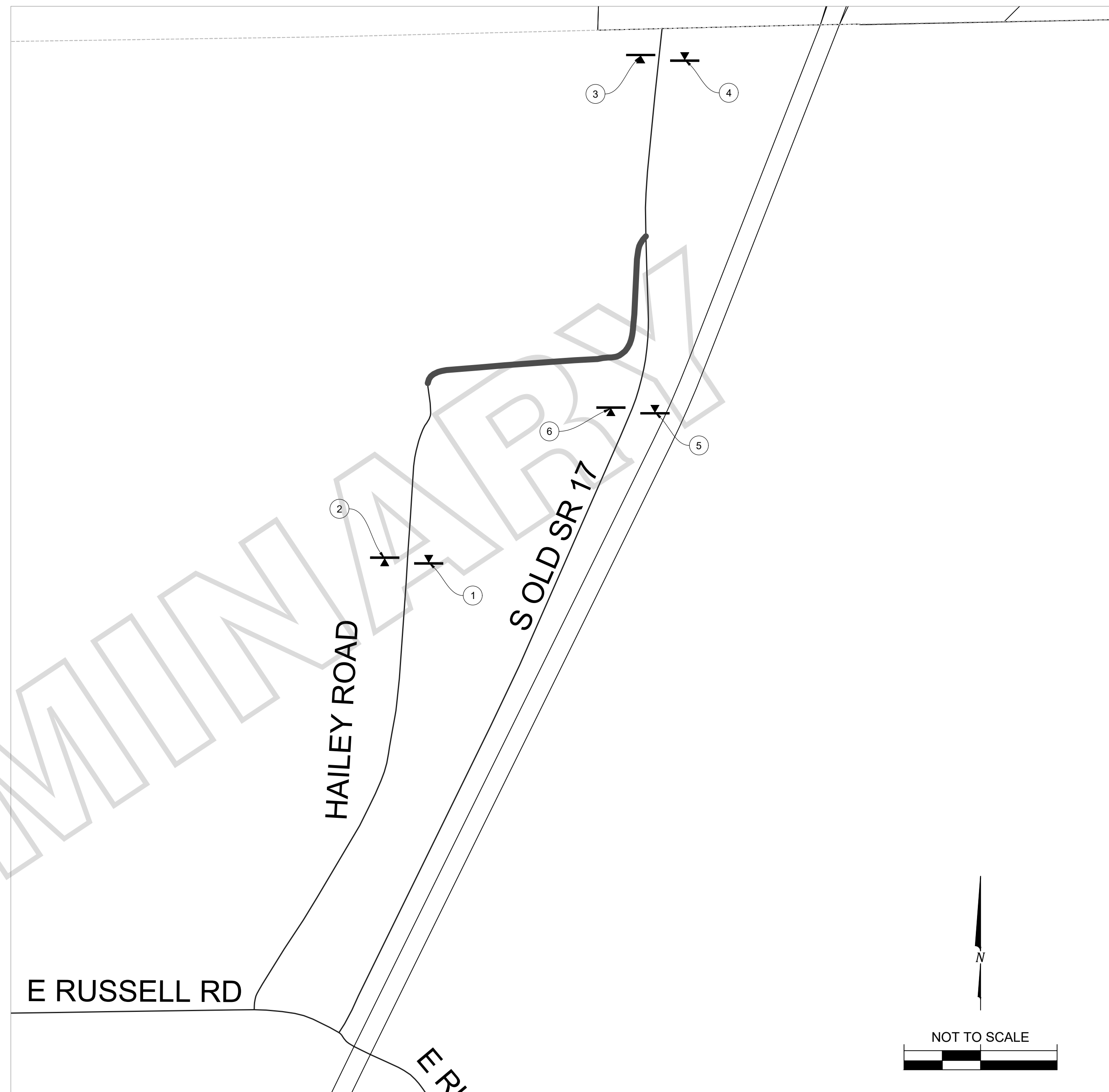

SIGN LEGEND			
NO.	TYPE	SIZE	LOCATION AND MOUNTING
1	W20-1 (ROAD WORK AHEAD)	36" X 36"	HAILEY ROAD 1000' FROM END OF PROJECT (AS STAKED IN FIELD BY ENGINEER) ON APPROVED POST
2	G20-2 (END ROAD WORK)	36" X 18"	HAILEY ROAD 1000' FROM END OF PROJECT (AS STAKED IN FIELD BY ENGINEER) ON APPROVED POST
3	W20-1 (ROAD WORK AHEAD)	36" X 36"	S OLD SR 17 1000' NORTH OF INTERSECTION WITH HAILEY ROAD (AS STAKED IN FIELD BY ENGINEER) ON APPROVED POST
4	G20-2 (END ROAD WORK)	36" X 18"	S OLD SR 17 1000' NORTH OF INTERSECTION WITH HAILEY ROAD (AS STAKED IN FIELD BY ENGINEER) ON APPROVED POST
5	W20-1 (ROAD WORK AHEAD)	36" X 36"	S OLD SR 17 1000' SOUTH OF INTERSECTION WITH HAILEY ROAD (AS STAKED IN FIELD BY ENGINEER) ON APPROVED POST
6	G20-2 (END ROAD WORK)	36" X 18"	S OLD SR 17 1000' SOUTH OF INTERSECTION WITH HAILEY ROAD (AS STAKED IN FIELD BY ENGINEER) ON APPROVED POST



**FRANKLIN COUNTY**  
PUBLIC WORKS DEPARTMENT  
3416 STEARMAN AVE.  
PASCO, WA 99301  
(509)545-3514  
WEB: WWW.CO.FRANKLIN.WA.US

REVISION	NO.	DESCRIPTION	BY	DATE

**CRP 620**  
**HAILEY RAILROAD/HIGHWAY**  
**CROSSING**  
**DETAILS**

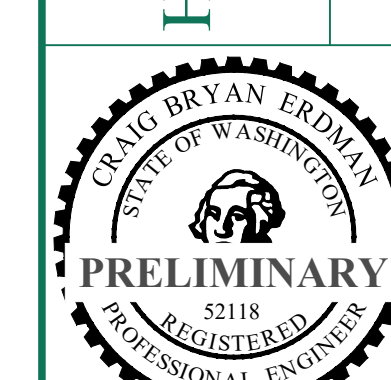

FEDERAL AID NUMBER  
RAIL-2011(051)  
CONTRACT NUMBER  
CRP 620  
STATE WA REGION SC  
PLAN CHECK  
DRAWN BY: HMB  
DESIGNED BY: HMB  
CHECKED BY: CBE  
DATE: 2019-02-13 12:05:48  
CADD DWG  
620BASE

REF. NO. SHEET  
**C102** **3** OF **3**