



WASHINGTON UTILITIES AND TRANSPORTATION COMMISSION

)	DOCKET NO. TR-
)	
Skagit County)	PETITION FOR INSTALLATION OF
_____)	MEDIAN BARRIERS AT A
Petitioner,)	HIGHWAY-RAIL GRADE
)	CROSSING
vs.)	
Burlington Northern Santa Fe Railway)	
_____)	
Respondent)	USDOT CROSSING NO.: 084789V
)	
.....)	

The Petitioner asks the Washington Utilities and Transportation Commission to approve installation of median barriers at a highway-rail grade crossing.

Section 1 – Petitioner’s Information

Skagit County _____ Petitioner
_____ Signature
1800 Continental Place _____ Street Address
Mount Vernon, WA 98273 _____ City, State and Zip Code
Same _____ Mailing Address, if different than the street address
Forrest Jones _____ Contact Person Name
360-416-1422 forresti@co.skagit.wa.us _____ Contact Phone Number and Email Address

Section 2 – Respondent's Information

Burlington Northern Santa Fe Railway

Respondent

2454 Occidental Avenue South, Suite 2D

Street Address

Seattle, WA 98134

City, State and Zip Code

Mailing Address, if different than the street address

Stephen Semenick, Manager of Public Projects

Contact Person Name

206-625-6152, Stephen.Semenick@BNSF.com

Contact Phone Number and Email Address

Section 3 – Crossing Location

1. Name of highway/roadway (South) Legg Road

2. Name of railroad Burlington Northern Santa Fe Railway

3. USDOT Crossing No. 084789V

4. Located in the SW 1/4 of the SW 1/4 of Sec. 27 Twp. 36 Range 3E W.M.

5. GPS location, if known Lat. 48.5906606 / Long. -122.4164870

6. Railroad mile post (nearest tenth) 81.41

7. City Burlington County Skagit

Section 4 – Current Crossing Traffic

1. Type of public road at the crossing State County City
 Port State Park Other _____
2. Average daily vehicle traffic over the tracks 190 Vehicle speed limit 25-MPH
3. Number of lanes 2
4. Trucks (commercial vehicles) are what percent of average daily traffic 0.4
5. Number of school buses over the crossing each day 2
6. Name of railroad(s) operating at crossing _____
Burlington Northern Santa Fe Railway

AmTrac

7. Type of railroad at crossing Common Carrier Logging Industrial
 Passenger Excursion
8. Type of tracks at crossing Main Line Siding or Spur
9. Number of tracks at crossing 1
10. Average daily train traffic, freight 20
Authorized freight train speed 59 Operated freight train speed 50
11. Average daily train traffic, passenger 2
Authorized passenger train speed 79 Operated passenger train speed 79

Section 5 – Justification

1. Provide the following information:

a. Describe in detail the why this crossing should have median barriers installed.

Skagit County has issued a Notice of Intent to establish a quiet zone at the (South) Legg Road grade crossing. With the lack of train horns the risk index increases substantially, in order to reduce the risk index at this crossing without train horns it is necessary to install Supplemental Safety Measures (SSM's), non-traversable median barriers. The installation of the non-traversable median barriers with delineators will reduce the risk index with horns from 11,920.94 to 3,976.83 without horns, a 67% reduction, in addition to bringing it below the National Significant Risk Index of 14,347.00. The non-traversable median barriers will provide a physical deterrent in the absence of the train horn and restrict motorist from driving around the gates. The crossing will maintain the existing warning devices of two gates, advanced warning signs, bells and flashing lights. This crossing is part of a four crossing quiet zone in which non-traversable median barriers will be installed at three of the four crossings, reducing the overall risk index for the quiet zone from 11,497.06 with train horns to 6,077.37 without train horns.

b. Provide a description of the type of median barriers proposed.

The non-traversable median barriers will be constructed on-site using concrete. The median will be 12 inches in width and 6 inches in height. The length of the median barriers will begin at the gates and extend 100 feet in length. Reflective breakaway traffic channelization devices are 36 inches tall by 8 to 12 inches wide with 192 to 288 square inches of type III reflective sheeting. These will be installed on top of the median barriers and spaced at approximately 120 inch intervals the length of the median barriers.

c. Describe who will maintain the barriers.

The non-traversable median barriers will be maintained by Skagit County Public Works Operations Division. The barriers, channelization devices, and signing will be maintained in accordance with standard maintenance practices, repairing or replacing any compromising functionality of the barrier, channelization devices, and signing. As with all of our traffic control devices, the County performs annual inspections that included retro-reflectivity surveys and repainting of striping and curbing/medians. As this will be Skagit County's first quiet zone, we intend to monitor the site closely and address any issues, maintenance or operational that may occur.

d. Attach a proposed diagram or design of the crossing and median barriers.

See see attached plan of the proposed non-traversable median barriers

Section 6 – Waiver of Hearing by Respondent

Waiver of Hearing

The undersigned represents the Respondent in the petition to install median barriers at the following crossing.

USDOT Crossing No. 084789V

We have investigated the conditions at the crossing. We are satisfied the conditions are the same as described by the Petitioner in this docket. We agree installation of median barriers should be made and consent to a decision by the commission without a hearing.

Dated at Seattle, Washington, on the 11th day of
October, 20 17.

Stephen Semenick

Printed name of Respondent

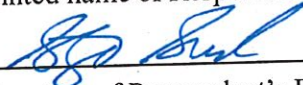

Signature of Respondent's Representative

Manager Public Projects

Title

BNSF Railway Company

Company Name

206-625-6152; Stephen.Semenick@bnsf.com

Phone number and email address

2454 Occidental Ave S, Suite 2D

Seattle, WA 98134

Mailing address

RESOLUTION NO.

RESOLUTION INITIATING COUNTY ROAD PROJECTS

BEFORE THE BOARD OF COUNTY COMMISSIONERS OF SKAGIT COUNTY, WA

In the matter of initiating County Road Projects and assigning CRP numbers.

IT IS HEREBY RESOLVED THAT the Blanchard Quiet Zone, Tye Road Culvert, and Guemes Ferry Parking Lot Improvements Projects listed below be improved as shown at or between the points indicated. These projects are hereby declared to be a public necessity and the county road engineer is hereby ordered and authorized to report and proceed thereon as by law provided. (RCW 36.75.050, 36.80.030, and 36.80.070).

IT IS FURTHER RESOLVED that if and when Washington State Department of Transportation (WSDOT) services are used during a project as mandated in RCW 47.04.060, authorization is hereby given that WSDOT will be reimbursed for services rendered.

IT IS FURTHER RESOLVED that appropriations from the officially adopted Road Fund budget and based on the County Engineer's estimates are hereby made in the amounts and for the purposes shown:

1	2	3		4	5	6	7				8	9
							ROAD NAME AND/OR BRIDGE NUMBER	RD. LOG NO.	M.P. TO M.P.	TYPE OF WORK SEE CODES BELOW		
							PE, ROW	CN	GRANT	LOCAL		
BLANCHARD QUIET ZONE (Legg Rd / Colony Rd)	20830 24000	Vary	Vary	A,F,G	X	X	18	45	0	63	21	ES20830-3 / -3A
TYEE ROAD	83000	0.50	0.60	A,H	X	X	37	214	0	251	20	ES83000-2
GUEMES FERRY PARKING LOT IMPROVEMENTS	N/A	N/A	N/A	A,J	X	X	47	203	216	34	22	FEMP-6

Appropriate

(4) Type of Work Code:

- | | |
|---------------------------------|-----------------------|
| A. Preliminary Engineering | F. Curbs & Gutters |
| B. Right-of-Way | G. Traffic Facilities |
| C. Grading, Draining, Surfacing | H. Bridges, Culverts |
| D. BST | I. Paths and Trails |
| E. AC or PCC Pavement | J. Ferry |

IT IS FURTHER RESOLVED that:

- The construction is to be accomplished by contract in accordance with RCW 36.77.020 et.seq.
- The construction is to be accomplished by county forces in accordance with RCW 36.77.065 and WAC 136-18.
- The construction is to be accomplished by contract with County Force participation.

ADOPTED this 19 day of June, 2017.

BOARD OF COUNTY COMMISSIONERS
SKAGIT COUNTY, WASHINGTON

Ron Wesen

Ron Wesen, Chair

ABSENT

Kenneth A. Dahlstedt, Commissioner

Lisa Janicki
Lisa Janicki, Commissioner



Attest:

Linda Hamme
Clerk of the Board

Approved as to Form:

[Signature]
Skagit County Prosecuting Attorney

Hand 6/12/17

Approved as to content:

[Signature]
Department Head

[Signature]

BLANCHARD QUIET ZONE (LEGG RD & COLONY RD CROSSINGS) ES20830-3 \ ES20830-3A

FEDERAL AID NO.: N/A

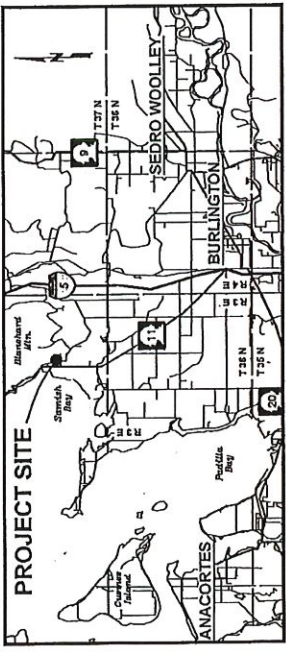

T. 37N R. 3E W.M., SECTIONS 22 & 27.

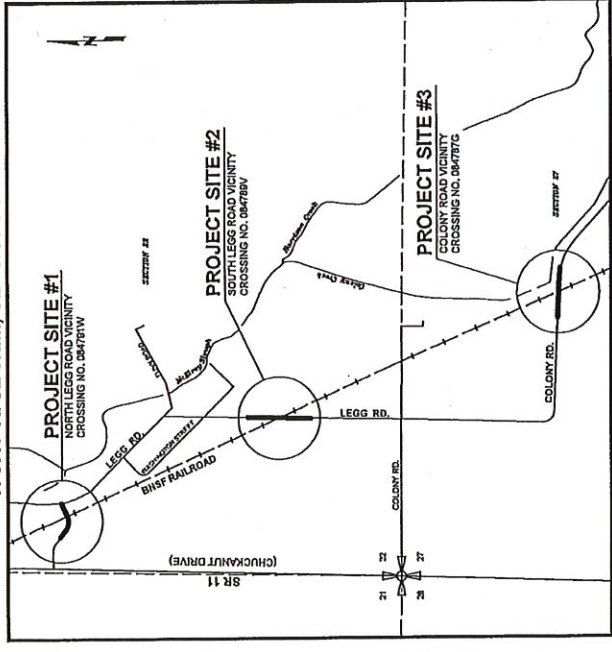

SKAGIT COUNTY OFFICIALS
 BOARD OF COMMISSIONERS
 •RON WESSEN, CHAIR
 •KENNETH A. DAHLSTEDT, COMMISSIONER
 •JAN WICKEL, COMMISSIONER
 •DAN BREIDTSON, DIRECTOR

PAUL A. RANDALL-GRUTTER, P.E., COUNTY ENGINEER DATE _____

PLAN SHEET INDEX

- 1 COVER, LEGEND
- 2 ROAD SECTIONS
- 3 GRADING PLANS
- 4 CURB DETAILS

LEGEND

- EXISTING EDGE OF PAVEMENT
- EXISTING EDGE OF SHOULDER
- EXISTING CONCRETE PAD
- EXISTING RAILROAD TRACKS
- EXISTING RAILROAD GATE
- EXISTING GUARDRAIL
- EXISTING SIGN
- NEW SIGN
- PROPOSED CURB
- GRADING / FILL LIMITS
- EXISTING PAVEMENT MARKINGS
- EXISTING POWER POLE

Item #	Qty.	Unit	Item Description
1	1	LS	MOBILIZATION
2	30	CY	BALLAST
3	500	LF	EXTRUDED DUAL-PASED TRAFFIC CURB
4	30	EA	VERTICAL PANEL
5	500	LF	PAINTING CURB
6	200	LF	PAINT REMOVAL
7	10	EA	POSTHOLE ZAPERS
8	1	LS	REMOVE CURB FOR THIRD PARTY DAMAGE
9	1	DAY	RAILROAD SIGN
10	1	LS	SPACE
11	1	LS	SPACE

<p>SKAGIT COUNTY PUBLIC WORKS 100 CENTRAL PLACE MOUNTAIN VIEW, WA 98272-5025 (509) 418-1400 FAX (509) 418-1405</p>	<p>BLANCHARD QUIET ZONE LEGG RD & COLONY RD CROSSINGS</p> <p>INDEX/VICINITY / 800/LEGEND</p>
<p>NO. _____</p> <p>REVISIONS _____</p> <p>DATE _____</p>	<p>PROJECT NO.: ES20830-3 \ ES20830-3A</p> <p>SECTION: 22 & 27</p> <p>PROJECT LOCATED NEAR: BOW, WA</p> <p>DESIGNED BY: EA CHECKED BY: PJ APPROVED BY: _____</p>
<p>1 of 6 SHEET</p>	

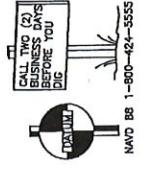

BLANCHARD QUIET ZONE (LEGG RD & COLONY RD CROSSINGS) ES20830-3 | ES20830-3A

FEDERAL AID NO.: N/A

SKAGIT COUNTY
PUBLIC WORKS
1600 COMMERCIAL PL. #2
MOUNT VERNON, WA 98273-9925
(360) 416-1400 FAX (360) 416-1403

NO	REVISIONS	DATE

PROJECT NO.: ES20830-3 | ES20830-3A
 PROJECT LOCATED NEAR:
 BOM, WA
 CHECKED BY: PJ
 APPROVED BY: SA
 DESIGNED BY: SA
 FIELD NO.: 1A
 DRAWN BY: SA

PROJECT NO.: ES20830-3 | ES20830-3A
 PROJECT LOCATED NEAR:
 BOM, WA
 CHECKED BY: PJ
 APPROVED BY: SA
 DESIGNED BY: SA
 FIELD NO.: 1A
 DRAWN BY: SA

BLANCHARD QUIET ZONE
 LEGG RD & COLONY RD
 CROSSINGS
 ROADWAY SECTIONS

2 OF 6
 SHEET

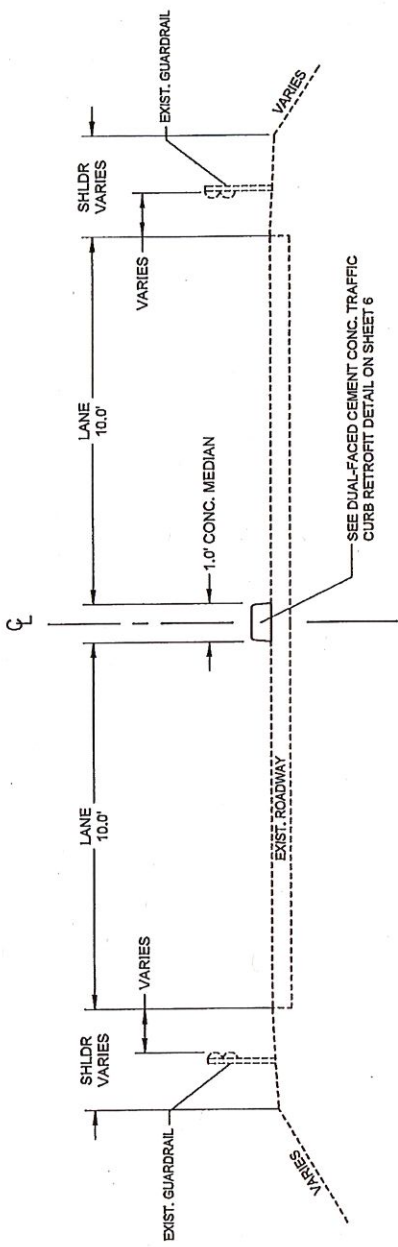

ROADWAY SECTION A

- *N. LEGG RD. MP 0.085 TO MP 0.074
- *N. LEGG RD. MP 0.080 TO MP 0.092
- *S. LEGG RD. MP 0.501 TO MP 0.520
- *S. LEGG RD. MP 0.585 TO MP 0.574
- *COLONY RD. MP 0.681 TO MP 0.680
- *COLONY RD. MP 0.686 TO MP 0.705

*SEE PLANSHEETS 3, 4 & 5 FOR ACTUAL DIMENSIONS (IN LINEAR FEET).

BLANCHARD QUIET ZONE LEGG RD & COLONY RD CROSSINGS		NORTHLEGG ROAD BHSF CROSSING NO. 084791W	
PROJECT NO.: ES20830-3 ES20830-3A	FED AID NO.: N/A	DESIGNED BY: SA	CHECKED BY: PJ
DRAWN BY: EA	APPROVED BY:	PROJECT LOCATED NEAR: BOW, VA	
DATE:	NO:	TOWN OF BOW 19 RAVINE EAST REVISION 22.27	
REVISIONS:	DATE:	SHEET 3 OF 6	
NO.:	DATE:	BLANCHARD QUIET ZONE LEGG RD & COLONY RD CROSSINGS	
NO.:	DATE:	BLANCHARD QUIET ZONE LEGG RD & COLONY RD CROSSINGS	
NO.:	DATE:	BLANCHARD QUIET ZONE LEGG RD & COLONY RD CROSSINGS	
NO.:	DATE:	BLANCHARD QUIET ZONE LEGG RD & COLONY RD CROSSINGS	

BLANCHARD QUIET ZONE (LEGG RD & COLONY RD CROSSINGS) ES20830-3 | ES20830-3A

FEDERAL AID NO.: N/A

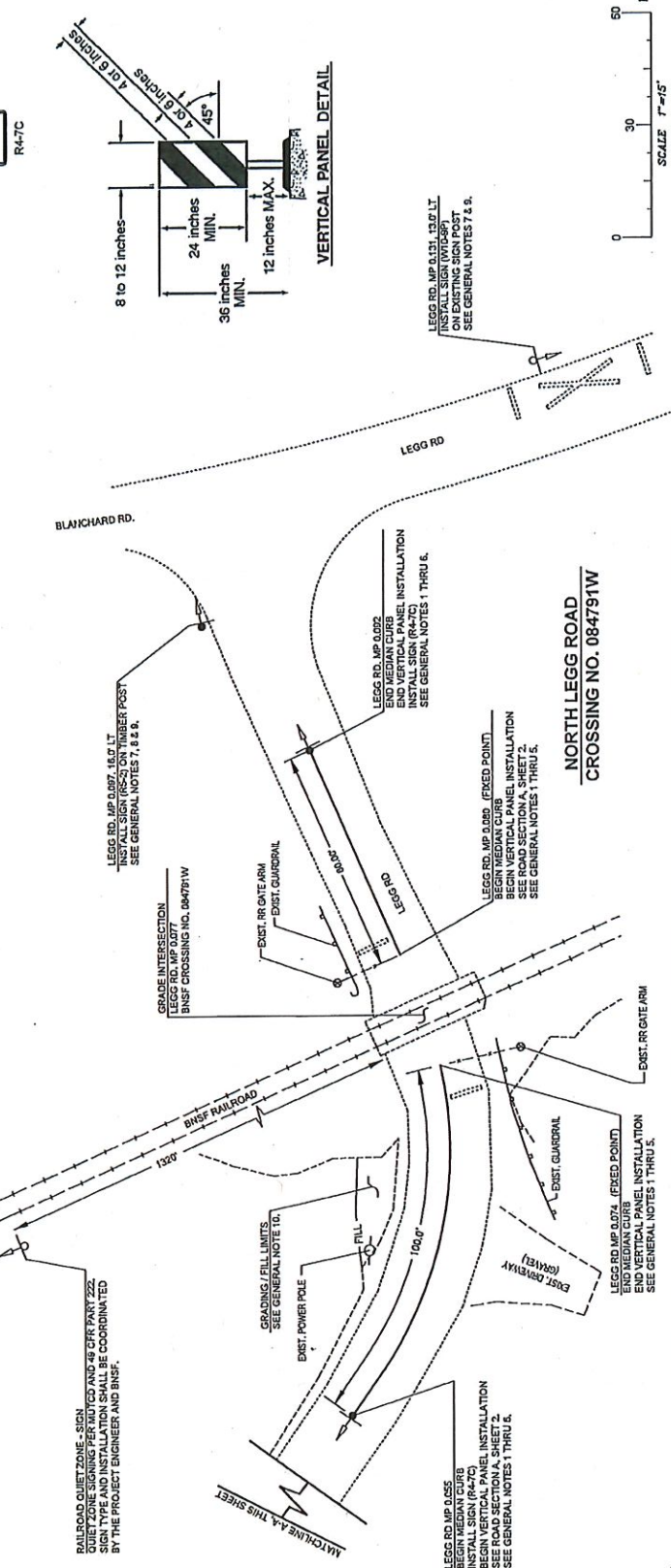
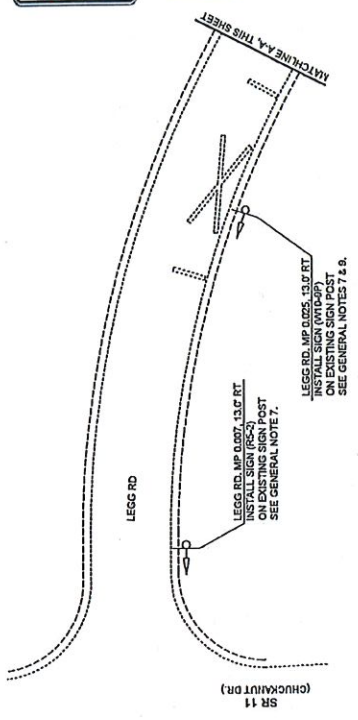
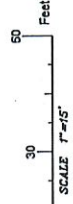

- GENERAL NOTES**
- 1) SEE DUAL-FACED CEMENT CONC. TRAFFIC CURB DETAIL ON SHEET 6
 - 2) THE MEDIUM CURB OVERALL LENGTH SHALL BE DETERMINED BY THE FIXED POINT AS IDENTIFIED IN THE PLANS BELOW. THIS FIXED POINT IS WHERE THE RAILROAD CROSSING GATE INTERSECTS THE ROADWAY CENTERLINE AND IT SHALL BE ESTABLISHED IN THE FIELD BY THE PROJECT ENGINEER. THE PLANS DO NOT SHOW THE CURB BEING PLACED UNTIL THE MEDIUM CURB IS INSTALLED.
 - 3) THE MEDIUM CURB SHALL BE PLACED IN THE LOCATION OUTLINED ABOVE TO EXTEND THE EXISTING SHOULDER OUT IN LINE WITH THE EXISTING UTILITY POLE SHOWN IN THE PLANS. THE FILL LIMITS SHALL BE MARKED BY THE PROJECT ENGINEER PRIOR TO FILL BEING PLACED. PLACED FILL SHALL BE COMPACTED TO 95% COMPACTION, AS DETERMINED BY THE PROJECT ENGINEER. NO SENSITIVE AREAS SHALL BE IMPACTED.
 - 4) FOR SIGN INSTALLATION LOCATION REQUIREMENTS SEE WSDOT STANDARD PLAN G-201.10-001
 - 5) FOR SIGN INSTALLATION LOCATION REQUIREMENTS SEE WSDOT STANDARD PLAN G-22.10-01, SINGLE POST TO USE.
 - 6) FOR SIGN INSTALLATION LOCATION REQUIREMENTS SEE WSDOT STANDARD PLAN G-22.10-01, SINGLE POST TO USE.
 - 7) FOR SIGN INSTALLATION LOCATION REQUIREMENTS SEE WSDOT STANDARD PLAN G-22.10-01, SINGLE POST TO USE.
 - 8) INSTALLATION SHALL BE COVERED UPON COMPLETION OF INSTALLATION. SIGN SHALL BE UNCOVERED 48 HOURS AFTER THE QUIET ZONE HAS BEEN OFFICIALLY ESTABLISHED.
 - 9) FILL MATERIAL SHALL BE CRUSHED SURFACING BASE COURSE. APPROXIMATELY 10 CY SHALL BE PLACED IN THE LOCATION OUTLINED ABOVE TO EXTEND THE EXISTING SHOULDER OUT IN LINE WITH THE EXISTING UTILITY POLE SHOWN IN THE PLANS. THE FILL LIMITS SHALL BE MARKED BY THE PROJECT ENGINEER PRIOR TO FILL BEING PLACED. PLACED FILL SHALL BE COMPACTED TO 95% COMPACTION, AS DETERMINED BY THE PROJECT ENGINEER. NO SENSITIVE AREAS SHALL BE IMPACTED.
 - 10) FILL MATERIAL SHALL BE CRUSHED SURFACING BASE COURSE. APPROXIMATELY 10 CY SHALL BE PLACED IN THE LOCATION OUTLINED ABOVE TO EXTEND THE EXISTING SHOULDER OUT IN LINE WITH THE EXISTING UTILITY POLE SHOWN IN THE PLANS. THE FILL LIMITS SHALL BE MARKED BY THE PROJECT ENGINEER PRIOR TO FILL BEING PLACED. PLACED FILL SHALL BE COMPACTED TO 95% COMPACTION, AS DETERMINED BY THE PROJECT ENGINEER. NO SENSITIVE AREAS SHALL BE IMPACTED.

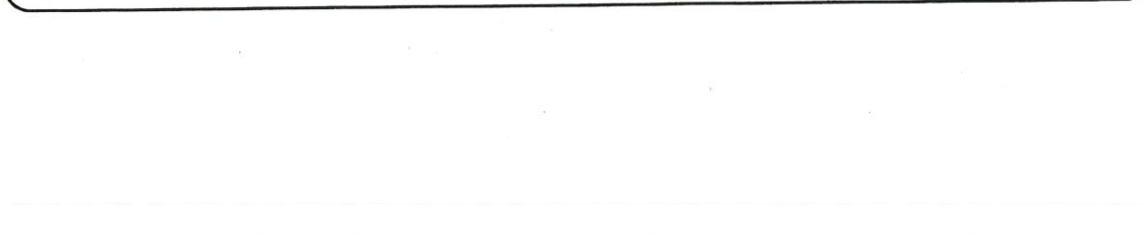

BLANCHARD QUIET ZONE (LEGG RD & COLONY RD CROSSINGS) ES20830-3 | ES20830-3A

FEDERAL AID NO.: N/A

BLANCHARD QUIET ZONE (LEGG RD & COLONY RD CROSSINGS) ES20830-3 | ES20830-3A

FEDERAL AID NO.: N/A

SKAGIT COUNTY
Public Works
1600 CENTRAL PLACE
MOUNTAIN VIEW, WA 98273-5025
(509) 416-1000 FAX (509) 416-1005

NO	REVISIONS	DATE

- GENERAL NOTES**
- SEE DUAL-FACED CEMENT CONC. TRAFFIC CURB DETAIL ON SHEET 6
 - THE MEDIAN CURB OVERALL LENGTH SHALL BE DETERMINED BY THE FIXED POINT AS IDENTIFIED IN THE PLANS BELOW. THIS FIXED POINT IS WHERE THE RAILROAD CROSSING GATE INTERSECTS THE ROADWAY CENTERLINE. THE MEDIAN CURB SHALL BE INSTALLED PRIOR TO THE GATE INTERSECTION. THE ROADWAY CENTERLINE SHALL BE IDENTIFIED BY THE CURB. THE OVERALL LENGTH CALLED OUT IN THE PLANS BELOW SHALL BE DEFINED FROM THIS ESTABLISHED POINT.
 - VERTICAL PANEL TYPE, SHEETING & HARDWARE SHALL BE APPROVED BY THE PROJECT ENGINEER PRIOR TO USE.
 - VERTICAL PANELS SHALL BE ANCHORED TO THE CURB AND PLACED EVERY 10.0' O.C.
 - FOR TYPICAL VERTICAL PANEL DIMENSIONS, SEE VERTICAL PANEL DETAIL ON THIS SHEET. ALTERNATE PANEL TYPES MAY BE USED BUT SHALL REQUIRE PROJECT ENGINEER APPROVAL PRIOR TO INSTALLATION.
 - SIGN R4-7C SHALL BE ANCHORED TO THE MEDIAN CURB WITH AN APPROPRIATE ANCHOR BASE TO BE APPROVED BY THE PROJECT ENGINEER PRIOR TO USE.
 - FOR SIGN INSTALLATION LOCATION REQUIREMENTS SEE USDOT STANDARD PLAN G-20, 10-06.
 - FOR TUMBER SIGN SUPPORT INSTALLATION, SEE WS DOT STANDARD PLAN G-22, 10-01, SINGLE POST TO USE.
 - SIGN SHALL BE COVERED UPON COMPLETION OF INSTALLATION. SIGN SHALL BE UNCOVERED 48 HOURS AFTER THE QUIET ZONE HAS BEEN OFFICIALLY ESTABLISHED.
 - FILL MATERIAL SHALL BE CRUSHED SURFACING BASE COURSE. APPROXIMATELY 10 CY SHALL BE PLACED IN THE LOCATION OUTLINED ABOVE TO EXTEND THE EXISTING SHOULDER OUT IN LINE WITH THE EXISTING UTILITY POLE SHOWN IN THE PLANS. THE FILL LIMITS SHALL BE MARKED BY THE PROJECT ENGINEER PRIOR TO FILL BEING PLACED. PLACED FILL SHALL BE COMPACTED TO 95% COMPACTION, AS DETERMINED BY THE PROJECT ENGINEER. NO SENSITIVE AREAS SHALL BE IMPACTED.

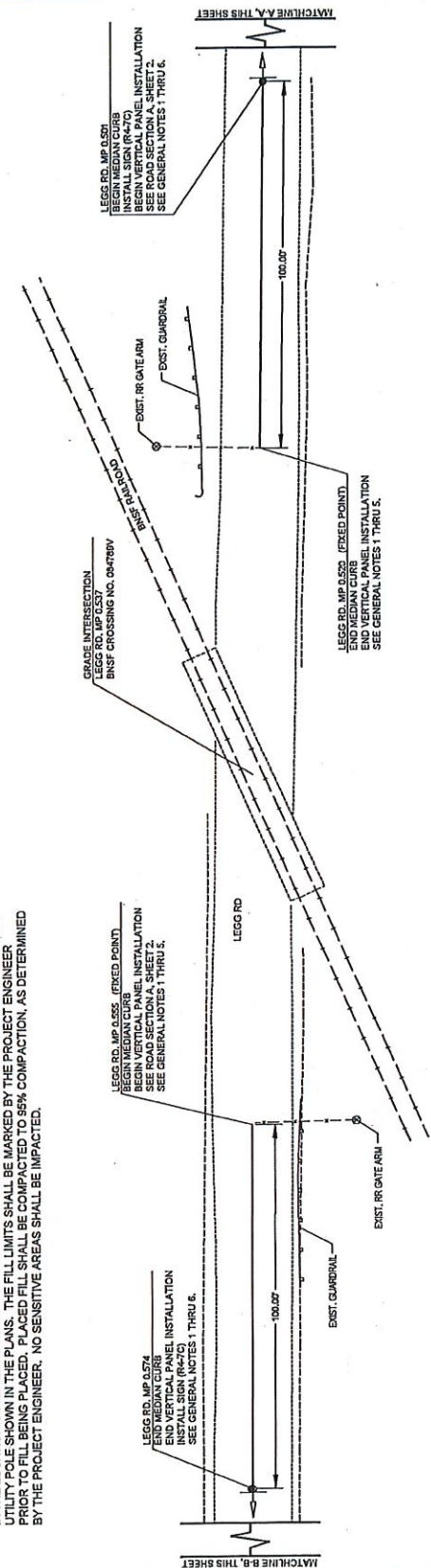
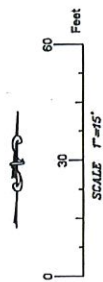

SOUTH LEGG ROAD
CROSSING NO. 084789V

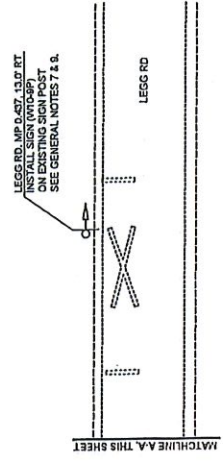

BLANCHARD QUIET ZONE
LEGG RD & COLONY RD
CROSSINGS
SOUTH LEGG ROAD
BNSF CROSSING NO. 084789V
PROJECT NO.: ES20830-3 | ES20830-3A
PROJECT LOCATION HEAT: BOM, WA
TOWNSHIP 36 N, RANGE 3 EAST, SECTION 22 & 27

DATE: _____
NO: _____
REVISIONS: _____
DATE: _____

BLANCHARD QUIET ZONE (LEGG RD & COLONY RD CROSSINGS) ES20830-3 | ES20830-3A

GENERAL NOTES

- 1) SEE DUAL-FACED CEMENT CONIC TRAFFIC CURBS DETAIL ON SHEET 5
- 2) THE MEDIAN CURB OVERALL LENGTH SHALL BE DETERMINED BY THE FIXED POINT AS IDENTIFIED IN THE PLANS BELOW. THIS FIXED POINT IS WHERE THE RAILROAD CROSSING INTERSECTS THE ROADWAY CENTERLINE AND IT SHALL BE ESTABLISHED IN THE FIELD BY THE PROJECT ENGINEER PRIOR TO BEGINNING CONSTRUCTION OF THE CURB. THE OVERALL LENGTH CALLED OUT IN THE PLANS BELOW SHALL BE DEFINED FROM THIS ESTABLISHED POINT.
- 3) VERTICAL PANEL TYPE, SHEETING & HARDWARE SHALL BE APPROVED BY THE PROJECT ENGINEER PRIOR TO USE.
- 4) VERTICAL PANELS SHALL BE ANCHORED TO THE CURB AND PLACED EVERY 10.0' O.C.
- 5) FOR TYPICAL VERTICAL PANEL DIMENSIONS, SEE VERTICAL PANEL DETAIL ON THIS SHEET. ALTERNATE PANEL TYPES MAY BE USED BUT SHALL REQUIRE PROJECT ENGINEER APPROVAL PRIOR TO INSTALLATION.
- 6) SIGN R4-7C SHALL BE USED TO IDENTIFY THE LOCATION OF THE QUIET ZONE SIGN INSTALLATION.
- 7) FOR SIGN INSTALLATION LOCATION REQUIREMENTS SEE WSDOT STANDARD PLAN G-20.10-00.
- 8) FOR TIMBER SIGN SUPPORT INSTALLATION, SEE WSDOT STANDARD PLAN G-22.10-01, SINGLE POST INSTALLATION.
- 9) SIGN SHALL BE COVERED UPON COMPLETION OF INSTALLATION. SIGN SHALL BE UNCOVERED 48 HOURS AFTER THE QUIET ZONE HAS BEEN OFFICIALLY ESTABLISHED.
- 10) FILL MATERIAL SHALL BE CRUSHED SURFACING BASE COURSE. APPROXIMATELY 10 CY SHALL BE PLACED IN THE LOCATION OUTLINED ABOVE TO EXTEND THE EXISTING SHOULDER OUT IN LINE WITH THE EXISTING UTILITY POLE SHOWN IN THE PLANS. THE FILL LIMITS SHALL BE MARKED BY THE PROJECT ENGINEER PRIOR TO FILL BEING PLACED. PLACED FILL SHALL BE COMPACTED TO 95% COMPACTION, AS DETERMINED BY THE PROJECT ENGINEER. NO SENSITIVE AREAS SHALL BE IMPACTED.

FEDERAL AID NO.: N/A

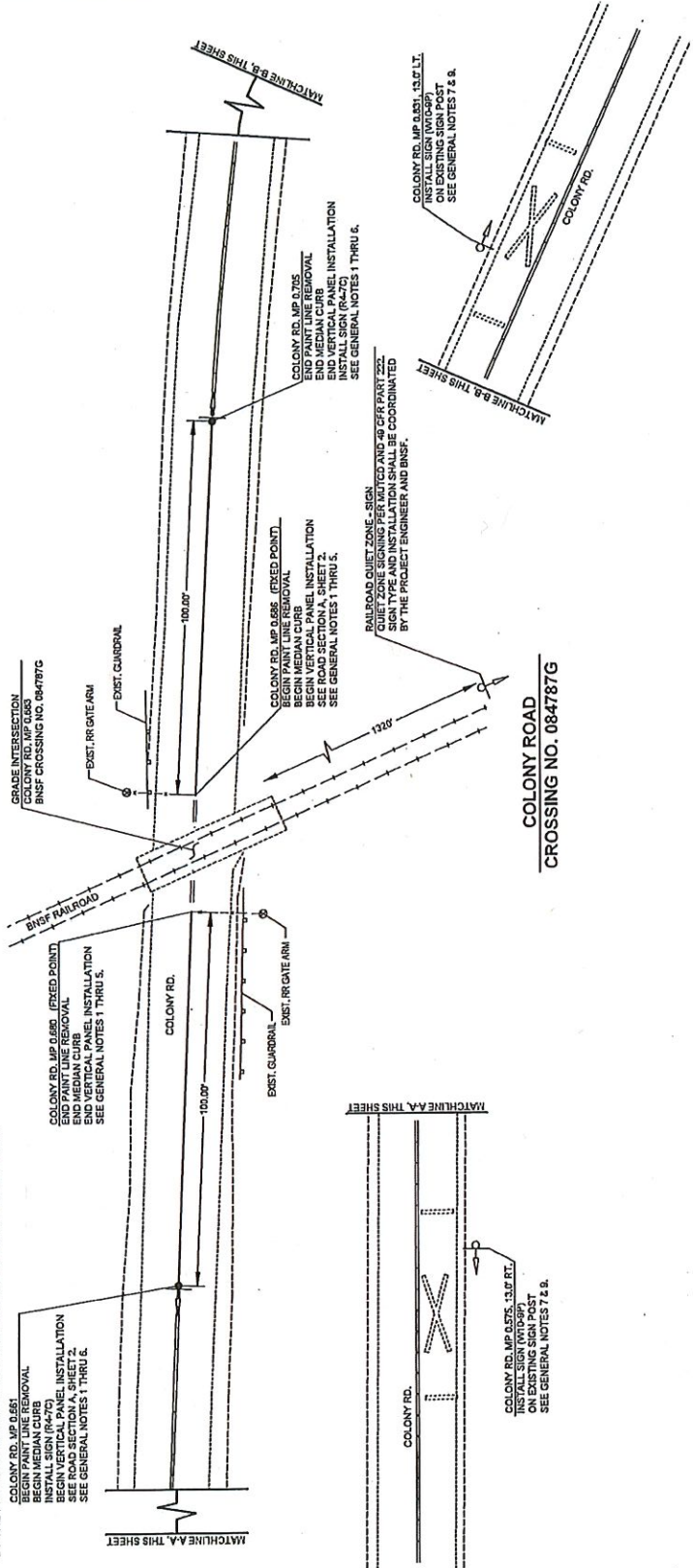
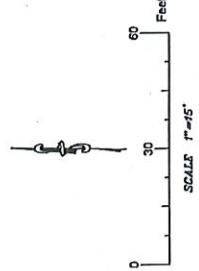

NO	REVISIONS	DATE

Skagit County Public Works
1800 COMMERCIAL PLACE
SEASIDE, WA 98272-5028
(509) 416-1400 FAX (509) 416-1405

PROJECT NO.: ES20830-3 | ES20830-3A
RD A/D: N/A
DESIGNED BY: EA
CHECKED BY: RJ
APPROVED BY: [Signature]
PROJECT LOCATED HEAR: BOW, WA
TOWNSHIP 14 RANGE 3 EAST SECTION 22 & 27

BLANCHARD QUIET ZONE
LEGG RD & COLONY RD
CROSSINGS
COLONY ROAD
BNSF CROSSING NO. 084787G

DATE: [Blank]
DRAWN BY: [Blank]
CHECKED BY: [Blank]
APPROVED BY: [Blank]

PROJECT NO.: ES20830-3 | ES20830-3A
RD A/D: N/A
DESIGNED BY: EA
CHECKED BY: RJ
APPROVED BY: [Signature]
PROJECT LOCATED HEAR: BOW, WA
TOWNSHIP 14 RANGE 3 EAST SECTION 22 & 27

BLANCHARD QUIET ZONE
LEGG RD & COLONY RD
CROSSINGS
COLONY ROAD
BNSF CROSSING NO. 084787G

DATE: [Blank]
DRAWN BY: [Blank]
CHECKED BY: [Blank]
APPROVED BY: [Blank]

PROJECT NO.: ES20830-3 | ES20830-3A
RD A/D: N/A
DESIGNED BY: EA
CHECKED BY: RJ
APPROVED BY: [Signature]
PROJECT LOCATED HEAR: BOW, WA
TOWNSHIP 14 RANGE 3 EAST SECTION 22 & 27

BLANCHARD QUIET ZONE
LEGG RD & COLONY RD
CROSSINGS
COLONY ROAD
BNSF CROSSING NO. 084787G

DATE: [Blank]
DRAWN BY: [Blank]
CHECKED BY: [Blank]
APPROVED BY: [Blank]

PROJECT NO.: ES20830-3 | ES20830-3A
RD A/D: N/A
DESIGNED BY: EA
CHECKED BY: RJ
APPROVED BY: [Signature]
PROJECT LOCATED HEAR: BOW, WA
TOWNSHIP 14 RANGE 3 EAST SECTION 22 & 27

BLANCHARD QUIET ZONE
LEGG RD & COLONY RD
CROSSINGS
COLONY ROAD
BNSF CROSSING NO. 084787G

DATE: [Blank]
DRAWN BY: [Blank]
CHECKED BY: [Blank]
APPROVED BY: [Blank]

PROJECT NO.: ES20830-3 | ES20830-3A
RD A/D: N/A
DESIGNED BY: EA
CHECKED BY: RJ
APPROVED BY: [Signature]
PROJECT LOCATED HEAR: BOW, WA
TOWNSHIP 14 RANGE 3 EAST SECTION 22 & 27

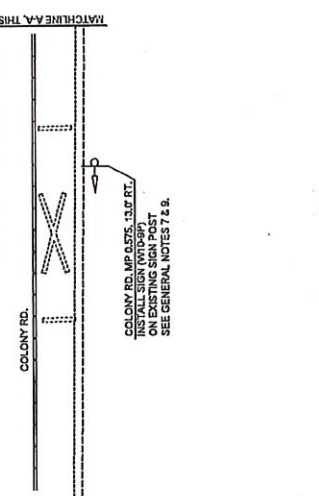

COLONY RD, MP 0.575, 13.0' FT. INSTALL SIGN (W10-3P) SEE GENERAL NOTES 7 & 8.

DATE: [Blank]
DRAWN BY: [Blank]
CHECKED BY: [Blank]
APPROVED BY: [Blank]

PROJECT NO.: ES20830-3 | ES20830-3A
RD A/D: N/A
DESIGNED BY: EA
CHECKED BY: RJ
APPROVED BY: [Signature]
PROJECT LOCATED HEAR: BOW, WA
TOWNSHIP 14 RANGE 3 EAST SECTION 22 & 27

BLANCHARD QUIET ZONE
LEGG RD & COLONY RD
CROSSINGS
COLONY ROAD
BNSF CROSSING NO. 084787G

DATE: [Blank]
DRAWN BY: [Blank]
CHECKED BY: [Blank]
APPROVED BY: [Blank]

BLANCHARD QUIET ZONE (LEGG RD & COLONY RD CROSSINGS) ES20830-3 \ ES20830-3A

FEDERAL AID NO.: N/A

SKAGIT COUNTY
PUBLIC WORKS
1800 COMMERCIAL PLACE
MOUNTAIN VIEW, WA 98273-5025
(360) 418-1100 FAX (360) 418-1405

NO.	REVISIONS	DATE

PROJECT NO.: ES20830-3 \ ES20830-3A
 PROJECT LOCATED NEAR:
 BOW, WA
 TOWNSHIP 34 RANGE 3 EAST SECTION 23 & 27
 DESIGNED BY: SA
 CHECKED BY: PJ
 APPROVED BY:

BLANCHARD QUIET ZONE
LEGG RD & COLONY RD
CURB DETAILS

DATE: 11/15/2017
 DRAWN BY: SA
 CHECKED BY: PJ
 APPROVED BY:
 PROJECT NO.: ES20830-3 \ ES20830-3A
 PROJECT LOCATED NEAR:
 BOW, WA
 TOWNSHIP 34 RANGE 3 EAST SECTION 23 & 27
 DESIGNED BY: SA
 CHECKED BY: PJ
 APPROVED BY:

BLANCHARD QUIET ZONE
LEGG RD & COLONY RD
CURB DETAILS
 SHEET
 6 OF 6

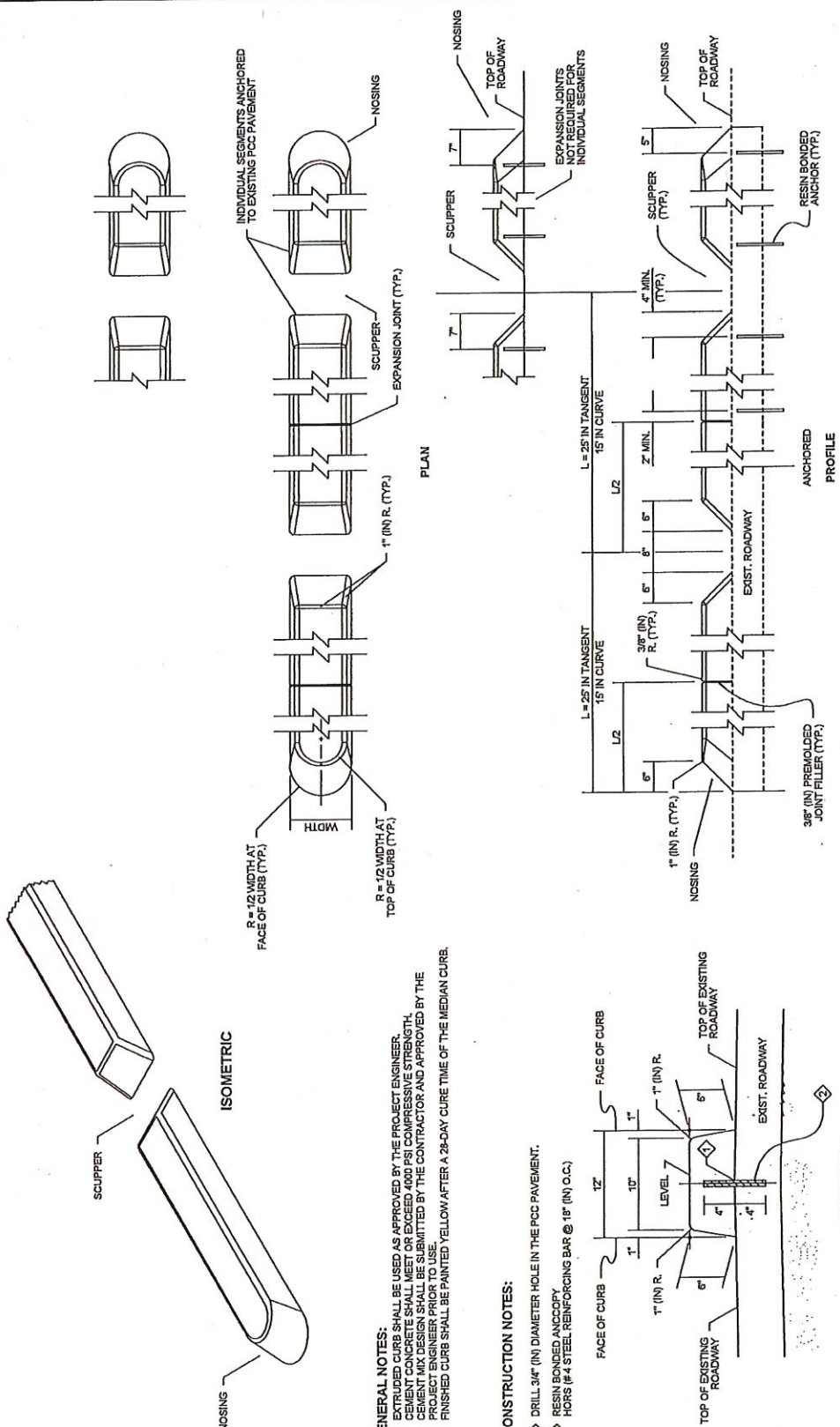

- GENERAL NOTES:**
1. EXTRUDED CURB SHALL BE USED AS APPROVED BY THE PROJECT ENGINEER.
 2. CEMENT CONCRETE SHALL MEET OR EXCEED 4000 PSI COMPRESSIVE STRENGTH.
 3. CURB SHALL BE FINISHED BY THE CONTRACTOR AND APPROVED BY THE PROJECT ENGINEER PRIOR TO USE.
 4. FINISHED CURB SHALL BE PAINTED YELLOW AFTER A 28-DAY CURE TIME OF THE MEDIAN CURB.

- CONSTRUCTION NOTES:**
- ① DRILL 3/4" (IN) DIAMETER HOLE IN THE PCC PAVEMENT.
 - ② RESIN BONDED ANCHOR HORS (#4 STEEL REINFORCING BAR @ 18" (IN) O.C.)

DUAL-FACED CEMENT CONC. TRAFFIC CURB
RETROFIT
ANCHORED TO EXISTING PAVEMENT

SCUPPER DETAILS
WHERE SHOWN ON PLANS

DATE: 11/15/2017 11:28:17 AM FILE: P:\CONTRACTS\2017\20170820\BLANCHARD QUIET_ZONE\CURB_DETAILS\20170820_3A_CURB_DETAILS.dwg