

United States of America, as administered by
the US Fish & Wildlife Service

Petitioner,

vs.

BNSF RAILWAY COMPANY, a Delaware
corporation ("BNSF")

Respondent

DOCKET NO. TR-

PETITION TO REPLACE AN
EXISTING HIGHWAY-RAIL GRADE
CROSSING WITH A HIGHWAY-
RAIL GRADE SEPARATION
(OVERCROSSING)

USDOT #092425R

The Petitioner asks the Washington Utilities and Transportation Commission approve construction of a railroad-highway grade separation (overcrossing or undercrossing) as described in this petition. An overcrossing means any point or place where a highway crosses a railroad by passing above the same, or any point or place where one railroad crosses another railroad not at grade. An undercrossing means any point or place where a highway crosses a railroad by passing under the same, or any point or place where one railroad crosses another not at grade. RCW 81.53.010

Section 1 – Petitioner’s Information

United States of America, Ridgefield NWR Complex

Petitioner



Signature

PO BOX 457 (28908 NW Main Avenue)

Street Address

Ridgefield, WA, 98642

City, State and Zip Code

Mailing Address, if different than the street address

Eric Anderson

Contact Person Name

360-887-4106, eric_anderson@fws.gov

Contact Phone Number and Email Address

Section 2 – Respondent’s Information

BNSF RAILWAY COMPANY, a Delaware corporation ("BNSF") Respondent
2454 Occidental Ave So Ste 2D Street Address
Seattle WA 98134 City, State and Zip Code
Mailing Address, if different than the street address
Rick Wagner, BNSF Mgr Public Projects Contact Person Name
O – 206.625.6152, F – 206.625.6356, Richard.Wagner@BNSF.com Contact Phone Number and Email Address

Section 3 – Crossing Location

1. Existing railroad	<u>BNSF</u>		
2. USDOT Crossing Number:	<u>092425R</u>		
3. GPS location	<u>Latitude 45.8 Longitude -122.74</u>		
4. Railroad mile post (nearest tenth)	<u>123.32</u>		
5. City	<u>Ridgefield</u>	County	<u>Clark</u>

Section 4 – Current Highway Traffic Information

1. Name of highway Wildlife Refuge Road

2. Road authority US Fish & Wildlife Service, Ridgefield NWR Complex

3. Average annual daily traffic (AADT) 100

4. Number of lanes 2

5. Roadway speed 10

6. Is the crossing part of an established truck route? Yes No X

7. If so, trucks are what percent of total daily traffic?

8. Is the crossing part of an established school bus route? Yes No X

9. If so, how many school buses travel over the crossing each day?

Section 5 – Crossing Traffic

1. Name of railroad(s) operating at proposed crossing:
BNSF

2. Type of railroad at crossing Common Carrier Logging Industrial
 Passenger Excursion

5. Type of tracks at proposed crossing Main Line Siding or Spur

6. Number of tracks at proposed crossing 2

7. Average daily train traffic, freight 59
Authorized freight train speed 79 Operated freight train speed 79

8. Average daily train traffic, passenger 6
Authorized passenger train speed 79 Operated passenger train speed 79

Section 6 – Description of Proposed Crossing

1. Describe in detail the reasons for constructing a grade separation at this location. Indicate whether the crossing will be an overcrossing or undercrossing:

The River S Bridge is proposed to be a grade separated. All foundations for the new bridge will be outside the ROW of the BNSF, meet BNSF required vertical clearances, and within existing easements of FWS. Additionally all bridge foundations are far enough away from operating tracks that no crash or deflection walls are required.

2. How far is the nearest alternate access across the tracks from the proposed crossing?

N/A

3. Describe the alternate access route, including distance and driving time:

N/A

4. Will the proposed crossing eliminate the need for one or more existing crossings?

Yes No

5. If so, identify the crossing(s) by USDOT number and state the distance and direction from the proposed crossing.

USDOT 092425R – the existing at-grade crossing will be replaced by the grade separation, which will have a new USDOT number (to be assigned)

6. Describe what will happen with the existing crossing(s) during construction of the grade separation, as well as what will happen with the crossing surface, signage and signal equipment once the grade separation is complete.

Existing crossing will remain in place and in use until construction of the grade separation is complete. Upon completion of the grade separation construction, the existing at-grade crossing will be completely removed, including the crossing surface, signals and bungalow.

6. Who is responsible for long-term maintenance of the grade separation?

Federal Government

Section 7 – Illustration of Crossing

Attach a diagram, drawing, map or other illustration showing the location of the railroad and the proposed location of the crossing. Include the parcels of private property located on both sides of the proposed crossing for a distance of 500' from the crossing and the name and mailing address of each property owner.

Property to the East of BNSF:
 City of Ridgefield
 Bryan Kast
 Public Works Director | Public Works
 (360) 857-5023
www.ci.ridgefield.wa.us
 301 N 3rd Avenue | PO BOX 608 | Ridgefield, WA 98642

Property to West of BNSF
 WGS LLC, a Washington limited liability company
 Tax Lot ID 220010-000; Vacant Land, Ridgefield, WA 98642
 Owner(s): WGS LLC, 6275 Coyote Point Ct,
 Reno Nevada 98511
 Mason D. Swigert, 360-887-3560, cmgincmail@comcast.net

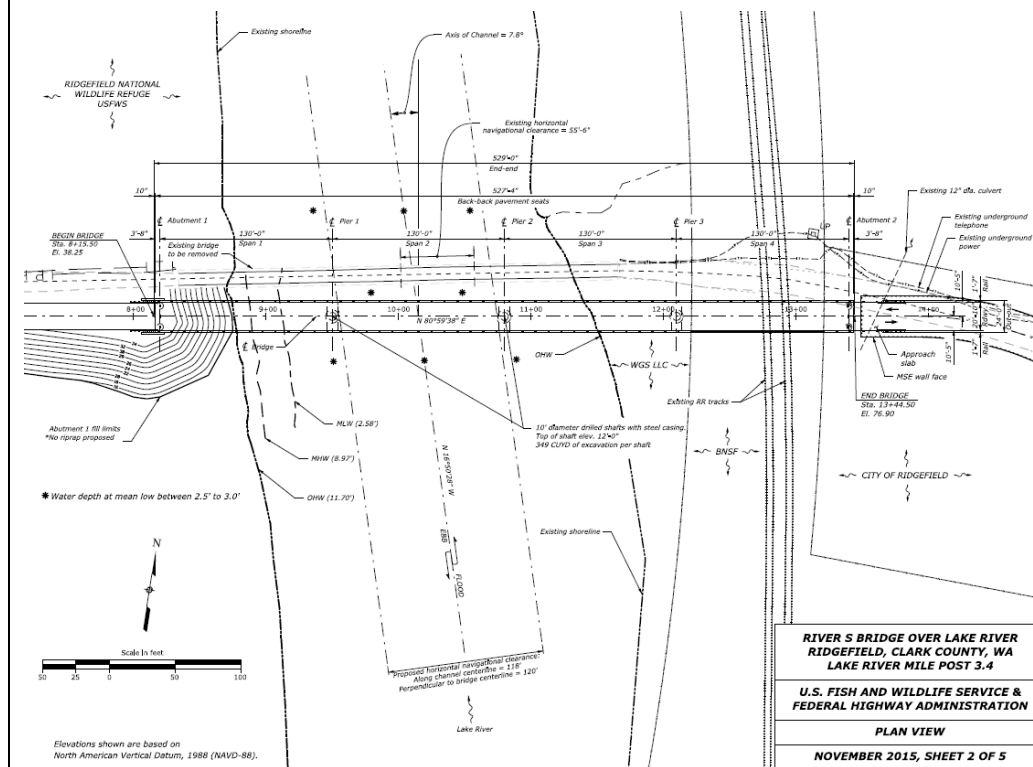

Section 8 – Waiver of Hearing by Respondent

Waiver of Hearing

The undersigned represents the Respondent in this petition to construct a highway-rail grade separation.

We have investigated the conditions at the crossing. We are satisfied the conditions are the same as described by the Petitioner in this docket. We do not oppose the proposed grade-separated crossing and consent to a decision by the commission without a hearing.

Dated at BINGHAM, Washington, on the 18th day of May, 20 17.

BNSF Railway
Printed name of Respondent

Signature of Respondent's Representative

Major Public Projects NW Division
Title

360 206.625.6152 Richard.Wagner@BNSF.com
Phone number and email address

2454 OCCIDENTAL AVENUE SOUTH STE 2D

SEATTLE, WA 98134
Mailing address