



Community Development Department  
Planning Division  
1350 McKittrick Street, PO Box 519  
Wenatchee, WA 98807

March 29, 2017

To whom it may concern:

The Wenatchee City Council recently approved an annexation for municipal purposes that brought City-owned property located in unincorporated Chelan County into the City of Wenatchee. The annexation was completed by Ordinance Number 2017-05 which utilized RCW35A.14.300. The parcel number of the land included in the annexation is 222016430050 and the address is 1201 Circle Street, Wenatchee, WA 98801. On the opposite side of this letter, you will find a map of the annexation area. A copy of the Ordinance, including the legal description, can be provided upon request.

The effective date was March 28, 2017. It is my understanding that there are currently no utility services at this site. The site is parkland and therefore there is no housing or population. In accordance with RCW35A.14.801, you have 60 days from receipt of this notice to make any necessary changes as it pertains to the remittance of utility taxes to the City of Wenatchee. If your utility has a city tax imposed upon users that differs from the rate imposed on Chelan County residents, please take this opportunity to make the necessary changes.

In an effort to ensure your records reflect the most up to date city boundary, the Washington State Office of Financial Management (OFM) has established an online annexation tracking system. This tracking system can be accessed at <http://www.ofm.wa.gov/pop/annex/cats/default.asp> and contains maps and legal descriptions for annexations of all jurisdictions within Washington State occurring since 2009.

Please contact me directly at (509) 888-3253 or by email at [mparsons@wenatcheewa.gov](mailto:mparsons@wenatcheewa.gov) if you have questions.

Thank you for your assistance in this matter.

Sincerely,  
Matt Parsons, AICP  
Associate Planner  
Community Development Department  
City of Wenatchee  
(509) 888-3253  
[mparsons@wenatcheewa.gov](mailto:mparsons@wenatcheewa.gov)

RECEIVED  
RECORDS MANAGEMENT  
2017 APR -3 AM 9:15  
STATE OF WASH.  
UTIL. AND TRANSP.  
COMMISSION

TG-170232

# Saddle Rock Municipal Annexation

Ordinance 2017-05

Effective Date: March 28, 2017

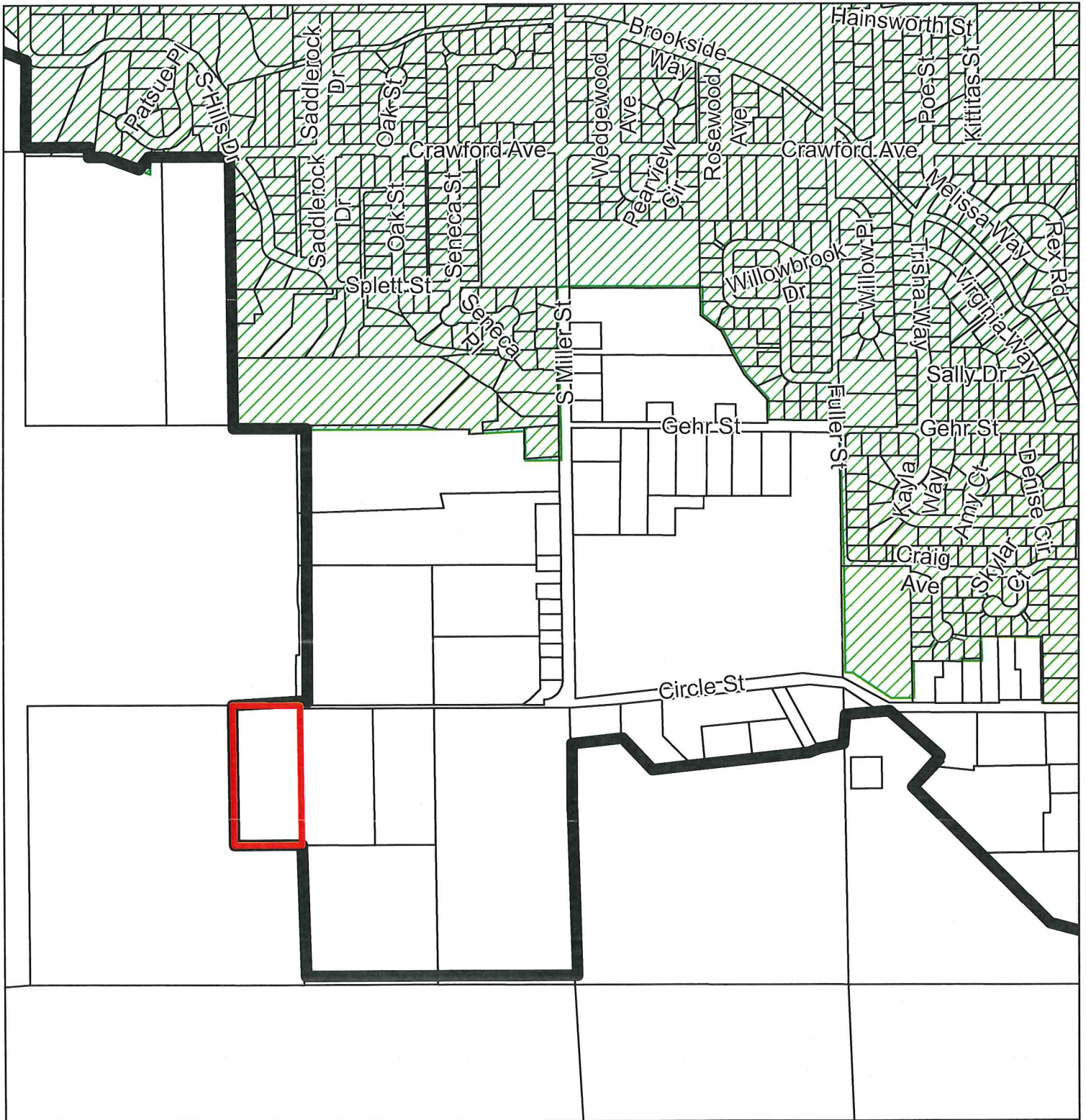

## Legend



Saddle Rock Municipal Annexation



Urban Growth Area



City Limits Effective December 12, 2017 through March 27, 2017



Parcels



0 500 1,000 Feet



**ORDINANCE NO. 2017-05**

**AN ORDINANCE,** providing for the annexation for municipal purposes of certain property to the City of Wenatchee and classifying and zoning said property, subject to the provisions of Title 10 Zoning of the Wenatchee City Code.

**WHEREAS,** a proposal to annex for municipal purposes pursuant to RCW 35A.14.300 the real property hereinafter described was initiated by staff of the City of Wenatchee, and

**WHEREAS,** the applicable zoning for the annexed property will be Residential Single-Family (RS) as designated on the pre-annexation zoning map, and

**WHEREAS,** City Council of the City of Wenatchee considered all factors relative to the proposed annexation for municipal purposes, and

**WHEREAS,** the real property proposed to be annexed is owned in its entirety by the City of Wenatchee, and

**WHEREAS,** a review proceeding for said annexation for municipal purposes is not required pursuant to RCW 35A.14.220.

**NOW, THEREFORE, THE CITY COUNCIL OF THE CITY OF WENATCHEE DO ORDAIN** as follows:

**SECTION I**

That the following described real property located in Chelan County, Washington, owned by the City of Wenatchee, to-wit:

See Exhibit "A" attached hereto and incorporated herein by reference as if fully set forth;

and each and every part thereof be and the same is hereby annexed to the City of Wenatchee, State of Washington; and that the corporate limits of the City of Wenatchee be and they are hereby extended so as to include the property and territory hereinbefore fully described.

## SECTION II

That the property described in Section I hereof be and the same is hereby classified and zoned as Residential Single-Family (RS). All such zoning and classification being subject to the provisions of Title 10 Zoning of the Wenatchee City Code.

## SECTION III

The Comprehensive Plan shall be and hereby is amended to incorporate the provisions of this Ordinance.

## SECTION IV

This Ordinance shall take effect immediately after passage and publication of such Ordinance once in *The Wenatchee World*, the same being the official newspaper of the City of Wenatchee, and the Clerk is hereby directed to cause the same to be so publicized. The Clerk is further directed to provide notice of the annexation to the county treasurer and assessor, and light, power and gas distribution businesses.

**PASSED BY THE CITY COUNCIL OF THE CITY OF WENATCHEE**, at a regular meeting thereof, this 23rd day of March 2017.

CITY OF WENATCHEE, a Municipal  
Corporation

By: \_\_\_\_\_

  
FRANK KUNTZ, Mayor

ATTEST:

By:   
TAMMY STANGER, City Clerk

APPROVED:

By:   
STEVE D. SMITH, City Attorney

# EXHIBIT A

City of Wenatchee, Washington

## SADDLEROCK MUNICIPAL ANNEXATION BOUNDARY DESCRIPTION

March 3, 2017

A Parcel of land for annexation to the City of Wenatchee described as follows;





The East half of the Northeast quarter of the Southwest quarter of the Southeast quarter of Section 16, Township 22 North, Range 20, E. W.M., Chelan County, Washington.

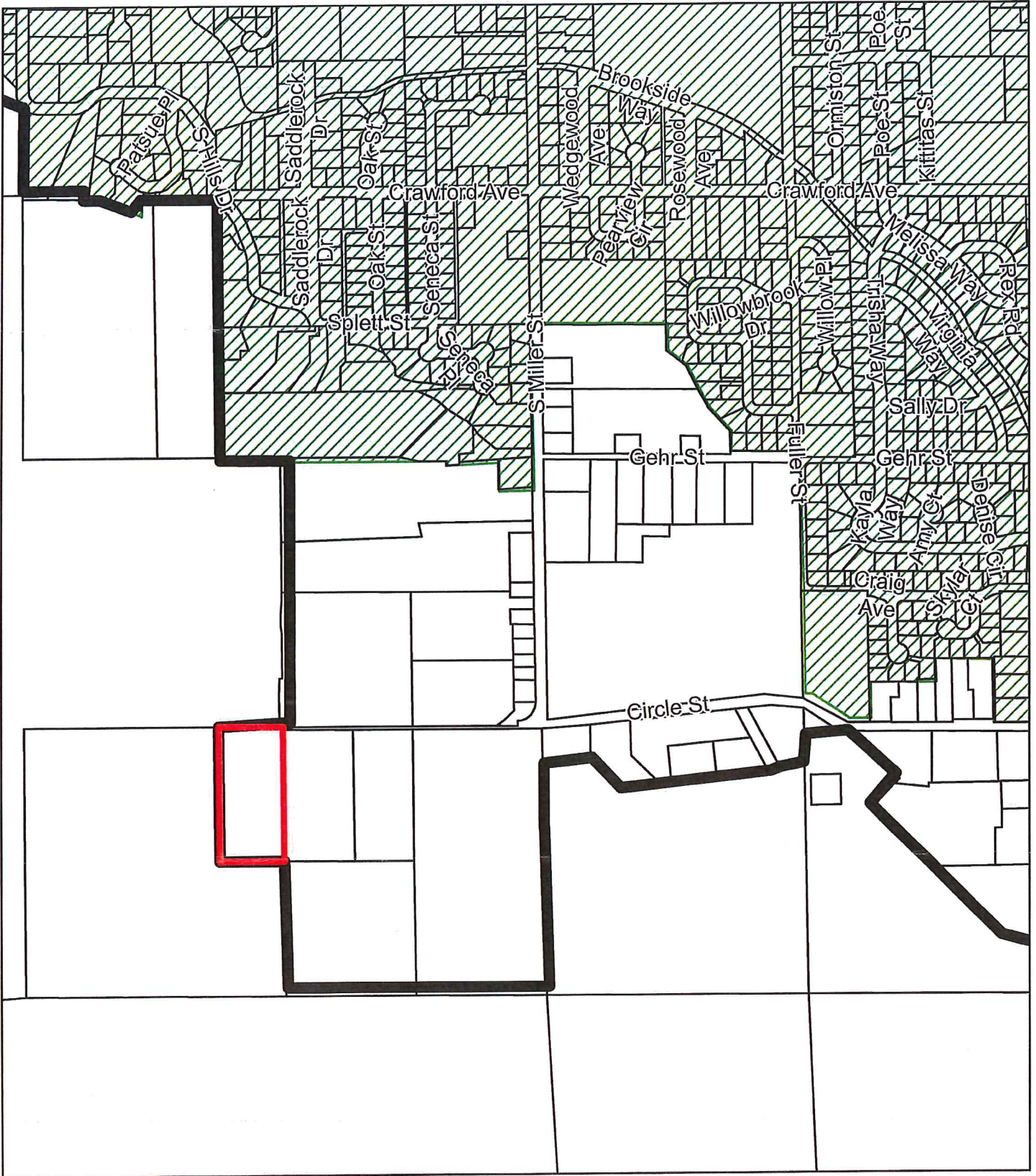

# Saddlerock Municipal Annexation



## Legend

-  Saddlerock Municipal Annexation
-  UGA
-  Parcels
-  City Limits

0 500 1,000 Feet



