

# Rail Accident Inspection Form

Docket No: TR-170186

Current Date: 10-11-2017

Railroad Owning Track: BNSF

Railroad Operating on Track: Amtrak

FRA Investigation: Yes  No

Inspector: Russ Pitner

## I. Type of Accident

Public Crossing  Private Crossing  Trestle  Pedestrian at Crossing   
 Pedestrian Not at Crossing  Other (explain)

## II. Time and Location of Accident

Date 03/19/2017 Time 1905  
 USDOT Crossing No. - WUTC Crossing No. \_\_\_\_\_  
 Railroad Milepost 21.4 GPS Identifier: Lat: 47.5109.49 Long: 122.2007.82  
 Number of Tracks: 2 City: Edmonds  
 Road name, yard name, bridge identifier: \_\_\_\_\_ County: Snohomish  
 Company responsible for track maintenance: BNSF  
 Other railroad involved in train accident/incident: Amtrak

*OK to close support staff recommendation issue assignment K. Hunk 10-12-17*

*contact owner of fence & request repair*

## III. Conditions Surrounding the Accident

Weather: Clear to cloudy  Fog  Rain  Snow   
 Road Condition: Dry  Wet  Snow  Ice   
 Visibility Due to Weather: Daylight  Darkness  Unknown   
 Adequate Sight Distance: Yes  No  N/A  Train Speed: 50  
 Describe: \_\_\_\_\_  
 Train Type: Freight  Passenger  Locomotive only  Cars only  Tilt train   
 Remote Control: Yes  No  N/A  Haz-Mat on Train: Yes  No  N/A   
 Type of Haz-Mat: \_\_\_\_\_

## IV. Pedestrian, Driver, or Passenger Fatalities Does this section apply? Yes No

Number of people killed 1 If a vehicle accident, number of passengers NA  
 Name: Jade Karen Reed  
 Driver:  Passenger  Pedestrian  Age 41 Gender: Male  Female   
 Pedestrian trying to get on/off train? Yes  No  Suicide: Yes  No  Undetermined   
 Alcohol: Yes  No  Undetermined  Information supplied by: \_\_\_\_\_  
 Drugs: Yes  No  Undetermined  Information supplied by: \_\_\_\_\_  
 Names of additional fatalities: \_\_\_\_\_

Docket No: TR-170186

**V. Pedestrian, Driver, or Passenger Injuries**

Does this section apply? Yes  No

Number of people injured \_\_\_\_\_

If a vehicle accident, number of passengers \_\_\_\_\_

Name: \_\_\_\_\_

Driver:  Passenger  Pedestrian

Age \_\_\_\_\_ Gender: Male  Female

Pedestrian trying to get on/off train? Yes  No

Drugs: Yes  No  Undetermined

Alcohol: Yes  No  Undetermined

Names of additional injured persons:  
\_\_\_\_\_

**VI. Pedestrian Access**

Does this section apply? Yes  No

Obvious signs of consistent pedestrian trespass? Yes  No

If yes, describe: \_\_\_\_\_

Pedestrian (not at a crossing) information: Accessing public area? Yes  No

If yes, describe: \_\_\_\_\_

Deterrents at site, e.g. fence, signs, etc? Yes  No

If yes, describe: "No Trespassing" signs posted and fencing

Previous collisions at or near site? Yes  No

If yes, describe: November 7, 2011, a 21 year female was struck and fatally injured 1/10<sup>th</sup> of a mile north.

**VII. Crossing History**

Does this section apply? Yes  No

Prior accidents at this crossing? Yes  No

How many?

Dates of prior accidents: \_\_\_\_\_

Description of prior accidents (e.g., fatalities, injuries, property damage) \_\_\_\_\_

Last inspection date? \_\_\_\_\_

Defects? Yes  No

If yes, describe: \_\_\_\_\_

Required to attach most current inventory? Yes  No

**VIII. Attachments**

Railroad incident report? Yes  No

Local law enforcement report? Yes  No

Coroner/medical examiner report? Yes  No

Pictures? Yes  No

Other (describe):  
\_\_\_\_\_

**IX. Comments**

On March 19, 2017, Jade Karen Reed was struck and fatally injured by a northbound Amtrak passenger train at milepost 21.4, on the Scenic Subdivision, on main track one.

Edmonds Police Department investigated at the scene. When they arrived, they found the train stopped on main track one. The tail end of the train was approximately 275 feet north of the point of impact.

The locomotive engineer stated he was traveling northbound when he observed a female start to run across the tracks heading east to west, approximately 50 feet in front of the train. The engineer stated that the train was traveling at approximately 50 miles per hour and he immediately went into emergency braking when he observed the pedestrian attempting to cross the tracks.

This incident occurred at an area that is not fenced off but is marked with numerous "No Trespassing" signs. The nearby fencing had a had been damaged/cut.

There are no reports to indicate that drugs or alcohol were a factor in this incident.

BNSF RAILWAY

**DANGER**

**TRAINS APPROACH  
AT HIGH SPEED  
WITHOUT WARNING**

**NO TRESPASSING**  
VIOLATORS WILL BE PROSECUTED

BNSF POLICE PH 1-800-832-5452

BNSF RAILWAY

**DANGER**

**TRAINS APPROACH  
AT HIGH SPEED  
WITHOUT WARNING**

**NO TRESPASSING**  
VIOLATORS WILL BE PROSECUTED

BNSF POLICE PH 1-800-832-5452

LOCK PADLOCKS TOGETHER



BNSF RAILWAY

**DANGER**

**TRAINS APPROACH  
AT HIGH SPEED  
WITHOUT WARNING**

**NO TRESPASSING**

VIOLATORS WILL BE PROSECUTED

BNSF POLICE PH 1-800-832-5452

BNSF RAILWAY

**DANGER**

TRAINS APPROACH  
AT HIGH SPEED  
WITHOUT WARNING

**NO TRESPASSING**  
VIOLATORS WILL BE PROSECUTED

BNSF POLICE PH 1-800-832-5452





# **NO TRESPASSING**

**BNSF RAILWAY CO.**

**1-800-832-5452**

**PER-RCW9A.52.080**













BNSF Fort Worth - Network Operations Center - **INCIDENT REPORT**

<b>Date:</b> 03/19/17			<b>Time:</b> 2112		<b>MP:</b> 21.4		<b>D-Code:</b> 173194	
<b>Time &amp; Date Last Revised:</b>			<b>Divn:</b> Northwest					
<b>Subdivision:</b> Scenic		<b>State:</b> WA		<b>County:</b> Snohomish				
<b>Line Segment:</b>		50						
<b>Nearest Station:</b>		Mukilteo WA						
<b>Nearest Major Terminal (distance/direction):</b>		Seattle WA South 21 Miles						
<b>Weather Conditions (Temp, wind, precipitation):</b>		Clear 45* Winds NW 9 Mph						

<b>Injuries or Fatalities?</b>	1 Trespasser Fatality	<b>Employee?</b>	
<b>Name:</b>		<b>Craft:</b>	

<b>Symbol:</b>	A8-119A	<b>If Yard Job, is it Remote Control Operation (RCO)?</b>	
<b>Lead Locos:</b>	AMTK 167 AMTK 166	<b>L-E-T-F:</b>	10-0-719-1061
<b>DP Locos:</b>		<b>Direction:</b>	East bound
<b>Did Lead locomotive have Ditch Lites?</b>		<b>Were Ditch Lite's operating?</b>	
<b>Speed:</b>		<b>Maximum Authorized Speed:</b>	60 MPH
<b>Train Crew's Origin / Destination:</b>			
<b>Conductor:</b>	LE Drawdy	<b>Engineer:</b>	M Dressor
<b>Prior Rest</b>		<b>Prior Rest</b>	
<b>On Duty Time/Date:</b>		<b>On Duty Location:</b>	
<b>Crew Interviewed by:</b>	By Amtrack Supervisors		
<b>Event Recorder/Camera:</b>			

Locomotives video equipped?											
Lead Locom	Y/N		Y/N		Y/N		Y/N		Y/N		Y/N
AMTK 167	Y	AMTK 166	Y								

<b>Crossing Name:</b>	Not at a Crossing	<b>DOT Number:</b>	
<b>Equipped with:</b>		<b>Functioning?</b>	
<b>Vehicle Direction:</b>		<b>Vehicle Description:</b>	
<b>Law Enforcement Agency:</b>	Edmonds PD	<b>Citations ?</b>	

<b>Haz Material ?</b>		<b>Release (Y/N):</b>		<b># Cars, Amount:</b>	
<b>Commodity:</b>					

<b>Derailed Locomotives / Cars:</b>					
<b>Init. Number:</b>	<b>Line:</b>	<b>Position (upright?):</b>	<b>Contents:</b>	<b>Disposition:</b>	
<b>Heavy equipment ordered:</b>					
<b>Equip. ETA:</b>		<b>Equipment Arrived:</b>		<b>Equipment Released:</b>	
<b>Main Blocked?</b>	Yes	<b>Estimated Reopen:</b>		<b>Actual Reopen:</b>	0038-CT/20

Estimated Damages and Costs:			
\$	0	<b>Track</b>	Track, Track Structures, and Roadbed Damages.
\$	0	<b>Signal</b>	
\$	0	<b>"Other"</b>	Adjacent buildings, other private property, etc.
\$	0	<b>Car Damages</b>	Car damage, incl. flat cars but excluding their trailers/containers and contents.
\$	0	<b>Locomotive Damages</b>	
\$	0	<b>FRA Reportable Subtotal</b>	2017 FRA Reportable \$10,700

\$		<b>Contractor Expense</b>	Rerailing & clearing expenses only. Do not include environmental cleanup, air monitoring, etc.
\$		<b>Estimated Lading Recovery Costs</b>	Source is usually Damage Prevention/LARS. This figure includes trucking charges and site remediation charges.



\$		<b>Prelim. Lading Loss Estimates</b>	Railcar/Trailer/Container <b>Contents ONLY</b>
		<b>Trailer/Container Damages</b>	Excludes contents. (Mktg-Equip Mtce Team – Evita Murdock)
\$	0	<b>Not FRA Reportable Subtotal</b>	
\$	0	<b>Estimated Grand Total</b>	(FRA Reportable Subtotal + Not FRA Reportable Subtotal)

<b>Cause Code:</b>	<b>Description:</b>
<b>Cause: Which Car / Locomotive, etc.?</b>	

**Brief Narrative of Incident:**  
 2112 CT SID was notified by DS 81 A8-19 struck a trespasser not at a crossing  
 =====  
 2135 CT Update confirmed fatallity by ROCC  
 =====  
 2213-CT Update 2115CT Northwest Division Scenic Subdivision: AMTRAK #8 operating on Main Track 1 with camera equipped lead locomotive AMTK 167 stuck and fatally injured trespasser at MP 21.4, not at road grade crossing between Edmonds and Mukilteo 21.4 miles east of Seattle. BNSF and local law officers responded. Will update when train is released. 9 trains delayed, expect 2 DOLs resulting.

<b>Post Accident Testing (FRA):</b>			
<b>Did this incident meet FRA Post Accident Testing criteria?</b>			
<b>If the incident analysis indicates the need for FRA Testing, Contact MEH Dept</b> so they can work with the field officer in charge of the testing to insure proper process is followed. (817) 352-1648 during normal business hours. (817) 352-1613 After hours, weekends and holidays. If no answer, then page Dustin Foster or Chris Kowalkowski via Blackberry.			
<b>Did the AGST agree with the above analysis?</b>			
<b>Was the Mgr. Dispatching Practices and Rules notified?</b>			
<b>Was the Shipping Box checked prior to use/shipment?</b>			
<b>Were the vials checked to insure they have not expired?</b>			
<b>Was the train crew tested?</b>		<b>Which BNSF Mgr took crew for test?</b>	
<b>Was the Dispatcher tested?</b>		<b>Which BNSF Mgr took Dispr for test?</b>	

**Notifications:**

Time:	Entity:	Person Notified:	Reminders:																						
2112-CT	<b>Service Interruption:</b>	BHC by DS81	<b>Include who notified SID.</b>																						
2116-CT	<b>Resource Operations:</b>	Tina																							
	<b>Cust. Solutions: 593-4670</b> Outlook Mail: Desk, CNS Cust. Support: 234-1135 Outlook Mail: CSESDesk		<b>Notify them of all derailments, collisions, or shipment damages.</b>  <b>Cust Support works 5pm-5am on weekdays and all shifts weekends.</b>																						
2118-CT	<b>Trainmaster:</b>	Steve Grachan	<b>Get ETA, check Cell number.</b>																						
	<b>Road Foreman Engines:</b>	Notified by others																							
	<b>Signal Desk: 593 - 5998</b>	Notified by others	<b>Signal Logs, TWD Logs.</b>																						
	<b>M/W Desk: 593-6823/1</b>	Notified by others	<b>Last track inspn, last B-9 inspn.</b>																						
	<b>Mechanical Desk:</b>	Notified by others	<b>Emergency car desk 593-9128</b>																						
	<b>Corridor Supt:</b>																								
2120-CT	<b>GST/AGST:</b>	David																							
	<b>Divn Supt Operations:</b>																								
This Rpt	<b>Divn General Manager:</b>	Jared Wooton																							
This Rpt	<b>Divn GDT:</b>	Jason Moyer																							
2200-CT	<b>Manager Dispatching Practices &amp; Rules: 352-1312</b>	Mike	<b>Tape recordings, including SID and ROC, when appropriate.</b>																						
This Rpt	<b>Superintendent Operating Practices</b> (All have Blackberry)	Michael Lund	<table border="0"> <tr> <td>California, L.A.</td> <td>Coleman, Herbert T</td> </tr> <tr> <td>Chicago</td> <td>Wazny, William A</td> </tr> <tr> <td>Red River</td> <td>Cleveland, Scott M</td> </tr> <tr> <td>Kansas</td> <td>Valencia, Randy J</td> </tr> <tr> <td>Montana</td> <td>Mizelle, Nicholas O</td> </tr> <tr> <td>Heartland</td> <td>Musgrove, Chris E</td> </tr> <tr> <td>Northwest</td> <td>Surina, Mike I</td> </tr> <tr> <td>Powder River North</td> <td>Erickson, Tony A</td> </tr> <tr> <td>Powder River South</td> <td>Percival, Everett E</td> </tr> <tr> <td>Southwest</td> <td>Remington, John R.</td> </tr> <tr> <td>Twin Cities</td> <td>Lund, Michael E</td> </tr> </table>	California, L.A.	Coleman, Herbert T	Chicago	Wazny, William A	Red River	Cleveland, Scott M	Kansas	Valencia, Randy J	Montana	Mizelle, Nicholas O	Heartland	Musgrove, Chris E	Northwest	Surina, Mike I	Powder River North	Erickson, Tony A	Powder River South	Percival, Everett E	Southwest	Remington, John R.	Twin Cities	Lund, Michael E
California, L.A.	Coleman, Herbert T																								
Chicago	Wazny, William A																								
Red River	Cleveland, Scott M																								
Kansas	Valencia, Randy J																								
Montana	Mizelle, Nicholas O																								
Heartland	Musgrove, Chris E																								
Northwest	Surina, Mike I																								
Powder River North	Erickson, Tony A																								
Powder River South	Percival, Everett E																								
Southwest	Remington, John R.																								
Twin Cities	Lund, Michael E																								

This Rpt	<p>The following group list is for the following departments:</p> <p>Safety, Law, Rules, Transportation Support, Rules and field Support, Corporate Relations, Government Affairs, and Evidence Preservation</p> <p>Major event group page list (Not MIP) Also page Region VP.</p> <p>(It is located with the SID Locomotive group lists)</p>	This Group	<p>Page for the following events:</p> <ol style="list-style-type: none"> <li>Major derailments or train collisions which are expected to exceed 16 hours or \$1,000,000 in damages.</li> <li>Derailments or collisions with evacuations, explosions, or involving crude oil trains.</li> <li>Major Hazardous Incidents</li> <li>Employee Fatalities, life threatening injuries, or amputations.</li> </ol>
	Conference Calls:		<p>If Conf Call is being established:</p> <p>(1) Notify: NOC Mechanical Desk (2) Notify: NOC M/W Desk (3) Notify: ROC</p>
	Hazardous Incidents: Contact East/West On-call mgrs. <i>If California, notify CUPA.</i>		<p>Page for all Hazardous Incidents: Pat Brady, Piper, Justin, Reid, Clay D, Howard Horn, David C Clark, John D. Lovenburg, Allen Stegman, Laura Fiffick</p>
	ChemTrec (USA) 800-424-9300		<p>Call whenever Haz Matl car involved in derailment or damaged; whether leaking or not.</p> <p>Run TSS: WBCOPY &amp; HAZ &amp; EXCR</p>
	CanuTec (Canada) 1-888-226-8832 or 613-996-6666		
2208-CT	<p>NRC: (#1) 800 - 424 - 8802 <i>(Initial SID Analysis)</i> Reasons for notifying them now include for <i>significant</i> violence or threats of violence against people or property (02-07-01).</p>	Brent Rpt #117-3596	<p>Obtain their Report Number and name of person who took the report.</p> <p><i>This block is for the Initial SID analysis. If initially "not reportable" and later becomes "reportable," use next block.</i></p>
	<p>NRC: (#2) 800 - 424 - 8802</p>		
2204-CT	<p>State: California - CUPA Foreign Railroad:</p>	Dan Fox Rpt # 17-0947	
	<p>"Go Team" 1. Alpha Page Mark Schulze. 2. Alpha Page team on duty.</p>		<p>Contact the "Team" that's on duty. If approp., also notify Mark Schulze. (To see Team on duty, go to n/SID/SIDBOTH/GOTEAM).</p>
2125-CT	Passenger Svcs: 352-2606	Clair	<p>If incident involves passenger train route, email copy of report to Rich Wessler, Tamora Noel.</p>
This Rpt	State Corporate Relations:	Gus Melonas COURTNEY WALLACE	<p>Notify of all significant Incidents:</p> <p><b>Gus Melonas and Courtney Wallace:</b> BC, ID, OR, WA <b>Ross Richard Lane:</b> MT, WY <b>Matt Jones:</b> MT, ID <b>Joe Faust:</b> AL, AR, LA, MS, TN, TX <b>Lena Kent:</b> AZ, CA <b>Amy McBeth:</b> MB, MN, ND, SD, WI <b>Andy Williams:</b> KS, MO, NE, IL, KY, IA <b>Joe Sloan:</b> CO, OK, NM, UT, NV</p>
	Energy Desk:		<p>Notify Energy desk of any crude oil train derailments: <b>OPR DL Energy Desk managers or call 817-8670021</b></p>
2130-CT	Director Transportation Support - Sean Hill	Paged	<p>Page for all main track derailments, crossing and trespasser accidents, and anything else affecting main track velocity.</p>

## Halstead, Lori (UTC)

---

**From:** State Emergency Operations Officer (MIL)  
**Sent:** Sunday, March 19, 2017 8:26 PM  
**To:** Banks, Daniel C (MIL); Elizabeth Klute; Kenneth W. Holgard; Mark Daniels (FRA); Stacey Thompson (Fed Railroad Association Reg 8); Steven Travers; UTC DL WUTC Rail Reporting  
**Cc:** Utzinger, Chris (MIL); Clark, Anthony B (MIL); Kaplan, Alysha (MIL)  
**Subject:** Train vs pedestrian Fatality - Mukilteo - NRC#1173596

Reporting Party Name & Position: Brock Clifton, RR Operations, 817-352-2832 Name of Railroad(s) involved: BNSF  
Date/Time of Event: 03/19/17 19:12 Time Reported to State EOC: 03/19/17 20:00 Milepost and/or Address of Event: MP 21.4, close to Mukilteo Type of Rail Car Involved: Locomotive Number of Injuries/Fatalities: 1 Type and Amount Of HAZMAT Spilled: 0 Circumstances of the Incident: A passenger train struck a trespasser resulting in a fatality.  
Name and Phone of Local Contact: Alonzo Bacon, 206-498-2603 Railroad Incident Number:  
State EOC Incident Number: 17-0947

\*\*\*Also attached is the report from the National Response Center\*\*\*

Scott Caldwell, MSEM  
State Emergency Operations Officer  
Washington State Emergency Management Division Building 20, MS: TA-20 Camp Murray, WA 98430-5122  
1-800-258-5990  
dutyofficer@mil.wa.gov

-----Original Message-----

From: HQS-PF-flidr-NRC@uscg.mil [mailto:HQS-PF-flidr-NRC@uscg.mil]  
Sent: Sunday, March 19, 2017 8:11 PM  
To: State Emergency Operations Officer (MIL); State Emergency Operations Officer (MIL); State Emergency Operations Officer (MIL)  
Subject: NRC#1173596

NATIONAL RESPONSE CENTER 1-800-424-8802

\*\*\*GOVERNMENT USE ONLY\*\*\*GOVERNMENT USE ONLY\*\*\*

Information released to a third party shall comply with any applicable federal and/or state Freedom of Information and Privacy Laws

Incident Report # 1173596

### INCIDENT DESCRIPTION

\*Report taken by: CIV BRENT TALIAFERRO at 23:05 on 19-MAR-17  
Incident Type: RAILROAD NON-RELEASE  
Incident Cause: TRESPASSER  
Affected Area:  
Incident occurred on 19-MAR-17 at 21:12 local incident time.  
Affected Medium: NON-RELEASE (N/A)

---

REPORTING PARTY

Name: ROBERT LARSON  
Organization: BNSF  
Address: 2600 LOU MENK DR.  
FORT WORTH, TX

PRIMARY Phone: (817)3522832  
Type of Organization: PRIVATE ENTERPRISE

---

SUSPECTED RESPONSIBLE PARTY

Name: UNKNOWN

Type of Organization: UNKNOWN

---

INCIDENT LOCATION

MP 21.4 County: SNOHOMISH  
City: MUKILTEO State: WA

---

RELEASED MATERIAL(S)

---

DESCRIPTION OF INCIDENT

CALLER REPORTED A PASSENGER TRAIN STRUCK A TRESPASSER RESULTING IN A FATALITY.

---

SENSITIVE INFORMATION

---

INCIDENT DETAILS

Grade Crossing: NO  
Location Subdivision: SCENIC  
Railroad Milepost: 21.4  
Type of Vehicle Involved:  
Crossing Device Type:  
Device Operational: YES  
DOT Crossing Number:  
Date and Time Service was/will be Restored:  
Brake Failure: UNKNOWN  
Federal Post-Accident 219.201 Sub Part C Testing Required: NO  
Passenger Train Route: YES  
Passenger Train Delay Expected: YES  
Passenger Train Delay Handling: PASSENGERS WILL STAY ON THE TRAIN.

---RAILROAD INFORMATION---

Railroad Involved: BNSF  
Train Number: AMTK167  
Train Type: PASSENGER Train Direction: E  
Train Speed: Track Speed:  
Locomotives: 2 Cars: 10 Derailed:  
Suspected DOT Regulation Non Compliance: UNKNOWN

DERAILED CARS:

Pos. Carnumber Type Cargo

IMPACT

Fire Involved: NO Fire Extinguished: UNKNOWN

INJURIES: NO Hospitalized: Empl/Crew: Passenger:  
FATALITIES: YES 1 Empl/Crew: Passenger: Occupant:  
EVACUATIONS:NO Who Evacuated: Radius/Area:

Damages: NO

Closure Type	Description of Closure	Hours	Direction of Closure
N			
Air:			
Road:		Major	Artery:N
Waterway:			
Track:	Y DOUBLE MAIN		E/W

Environmental Impact: UNKNOWN  
Media Interest: UNKNOWN Community Impact due to Material:

REMEDIAL ACTIONS

INVESTIGATION UNDERWAY  
Release Secured: UNKNOWN  
Release Rate:  
Estimated Release Duration:

WEATHER

Weather: PARTLY CLOUDY, 9F

ADDITIONAL AGENCIES NOTIFIED

Federal:  
State/Local: ECOLOGY DEPT  
State/Local On Scene:  
State Agency Number: 17-0947

NOTIFICATIONS BY NRC

CENTERS FOR DISEASE CONTROL (GRASP)  
19-MAR-17 23:10 (770)4887100  
CGIS D13 FIELD OFFICE (CGIS D13 COMMAND CENTER)  
19-MAR-17 23:10 (206)2207141  
CUSTOMS AND BORDER PROTECTION (INTEL BRANCH/BLAINE SECTOR)  
19-MAR-17 23:10 (360)4107222  
DHS DEFENSE THREAT REDUCTION AGENCY (CHEMICAL AND BIOLOGICAL TECHNOLOGI  
19-MAR-17 23:10 (703)7673477  
NATIONAL COORDINATING CTR FOR COMMS (NCC COMM-ISAC)

19-MAR-17 23:10 (703)2355626  
DOT CRISIS MANAGEMENT CENTER (MAIN OFFICE)  
19-MAR-17 23:10 (202)3661863  
FEDERAL RAILROAD ADMIN. (MAIN OFFICE)  
19-MAR-17 23:10 (202)4936242  
FEMA REGION 10 (MAIN OFFICE)  
19-MAR-17 23:10 (425)4874704  
NATIONAL INFRASTRUCTURE COORD CTR (MAIN OFFICE)  
19-MAR-17 23:10 (202)2829201  
NOAA RPTS FOR WA (MAIN OFFICE)  
19-MAR-17 23:10 (206)5264911  
NATIONAL RESPONSE CENTER HQ (AUTOMATIC REPORTS)  
19-MAR-17 23:10 (202)2671136  
NTSB RAIL (MAIN OFFICE)  
19-MAR-17 23:10 (202)3146293  
HOMELAND SEC COORDINATION CENTER (MAIN OFFICE)  
19-MAR-17 23:10 (202)2828300  
OREGON TITAN FUSION CENTER (FUSION COMMAND CENTER)  
19-MAR-17 23:10 (877)6204702  
WA STATE EMERGENCY MANAGEMENT (MAIN OFFICE)  
19-MAR-17 23:10 (800)2585990  
WASHINGTON STATE FUSION CENTER (FUSION COMMAND CENTER)  
19-MAR-17 23:10 (877)8439522  
WASHINGTON STATE NATIONAL GUARD (COMMAND CENTER)  
19-MAR-17 23:10 (253)5128159

---

ADDITIONAL INFORMATION

---

\*\*\* END INCIDENT REPORT #1173596 \*\*\*

Report any problems by calling 1-800-424-8802  
PLEASE VISIT OUR WEB SITE AT <http://www.nrc.uscg.mil>



# Edmonds Police Department Detail



Print Date/Time: 03/28/2017 08:34  
 Login ID: ep0864  
 Case Number: 2017-00006212

Edmonds Police Department  
 WA0310200

ORI Number:

**Case Details:**

Case Number: 2017-00006212	Incident Type: Death Investigation	
Location: 16121 75TH PL W EDMONDS, WA 98026	Occured From: 03/19/2017 19:00	
	Occured Thru: 03/19/2017 19:10	
	Reported Date: 03/19/2017 19:09 Sunday	
Reporting Officer ID: EP2952-Hwang	Status: Open	Status Date: 03/19/2017
Disposition: Follow-Up	Disposition Date: 03/22/2017	

**Case Assignments:**

Assigned Officer	Assignment Date/Time	Assignment Type	Assigned By Officer	Due Date/Time
EP2601-Mehl	03/22/2017 00:00	Lead Investigator	EP1104-Richardson	04/22/2017 00:00

Associated Cases	Status	Assisting ORIs	Role
Modus Operandi		Solvability Factors	Weight

**Offenses**

No.	Group/ORI	Crime Code	Statute	Description	Counts
-----	-----------	------------	---------	-------------	--------

**Subjects**

Type	No.	Name	Address	Phone	Race	Sex	DOB/Age
Deceased	1	REED, JADE KAREN	18132 59TH PL W LYNNWOOD, WA 98037		White	Female	06/13/1975 41
Other Involved	2	COLLINS, JOHN RICHARD	187 S HOLGATE ST SEATTLE, WA 98134	(206) 819-8446	White	Male	10/11/1961 55
Other Involved	3	AMTRAK	187 S HOLGATE ST SEATTLE, WA 98134	(206) 819-8446			
Other Involved	5	TRAVERS, STEVE M	187 S HOLGATE ST SEATTLE, WA 98134	(206) 819-8446	White	Male	
Other Involved	6	BACON, ALONZO	2454 OCCIDENTAL AVE S 1a seattle, WA 98134	(206) 625-6160	White	Male	
Other Involved	4	BNSF RAILWAY	2900 BOND ST EVERETT, WA 98201	(425) 303-3404			
Other Involved	1	DRAWDY, LARRY EARL	187 S HOLGATE ST SEATTLE, WA 98134	(206) 819-8446	White	Male	04/05/1954 62
Witness	2	DRESSOR, MARK DANIEL	187 S HOLGATE ST SEATTLE, WA 98134	(206) 819-8446	White	Male	06/06/1960 56
Witness	1	REED, RYAN BARTLETT	18132 59TH PL W LYNNWOOD, WA 98037	(425) 273-1895	White	Male	08/19/1979 37
Witness	3	CONAHAN, SCOTT ANTHONY	15927 75TH PL W EDMONDS, WA 98026	(425) 356-7822	White	Male	05/06/1965 51
Witness	4	CONAHAN, HEIDI H	15927 75TH PL W EDMONDS, WA 98026	(206) 940-2029	White	Female	03/08/1964 53







# Edmonds Police Department Detail



Print Date/Time: 03/28/2017 08:34  
 Login ID: ep0864  
 Case Number: 2017-00006212

ORI Number: Edmonds Police Department  
 WA0310200

**Subject #** 1-Other Involved

Primary: No  
 Name: DRAWDY, LARRY EARL  
 Address: 187 S HOLGATE ST  
 SEATTLE WA 98134  
 Primary Phone: (206) 819-8446  
 Resident Status: Non-Resident

Race: White  
 Height: 6ft 2 in  
 Eyes: HAZ  
 State:

Sex: Male  
 Weight: 239.0 lbs.  
 Hair: GRY

DOB: 04/05/1954  
 Age: 62

**Subject #** 2-Witness

Primary: No  
 Name: DRESSOR, MARK DANIEL  
 Address: 187 S HOLGATE ST  
 SEATTLE WA 98134  
 Primary Phone: (206) 819-8446  
 Resident Status: Non-Resident

Race: White  
 Height: 6ft 0 in  
 Eyes: BRO  
 State:

Sex: Male  
 Weight: 240.0 lbs.  
 Hair: GRY

DOB: 06/06/1960  
 Age: 56

**Subject #** 1-Witness

Primary: No  
 Name: REED, RYAN BARTLETT  
 Address: 18132 59TH PL W  
 LYNNWOOD WA 98037  
 Primary Phone: (425) 273-1895  
 Resident Status: Non-Resident

Race: White  
 Height: 5ft 9 in  
 Eyes: BLU  
 State:

Sex: Male  
 Weight: 179.0 lbs.  
 Hair: BLN

DOB: 08/19/1979  
 Age: 37

**Subject #** 3-Witness

Primary: No  
 Name: CONAHAN, SCOTT ANTHONY  
 Address: 15927 75TH PL W  
 EDMONDS WA 98026  
 Primary Phone: (425) 356-7822  
 Resident Status: Full-Time Resident

Race: White  
 Height: 5ft 7 in  
 Eyes: BLU  
 State:

Sex: Male  
 Weight: 180.0 lbs.  
 Hair: BRO

DOB: 05/06/1965  
 Age: 51

**Subject #** 4-Witness

Primary: No  
 Name: CONAHAN, HEIDI H  
 Address: 15927 75TH PL W  
 EDMONDS WA 98026  
 Primary Phone: (206) 940-2029  
 Resident Status: Full-Time Resident

Race: White  
 Height: 5ft 4 in  
 Eyes: HAZ  
 State:

Sex: Female  
 Weight: 122.0 lbs.  
 Hair: BLN

DOB: 03/08/1964  
 Age: 53

**Arrests**

Arrest No.	Name	Address	Date/Time	Type	Age
------------	------	---------	-----------	------	-----

**Property**



# Edmonds Police Department Detail



Print Date/Time: 03/28/2017 08:34  
 Login ID: ep0864  
 Case Number: 2017-00006212

Edmonds Police Department  
 ORI Number: WA0310200

Date	Code	Type	Make	Model	Description	Tag No.	Item No.
03/21/2017	Evidence	Digital Media			Disc containing video of video from Amtrak train	2017-00006212	8
03/19/2017	Evidence	Cell Phone	Unknown or Unlisted		CELL PHONE WITH PINK CASE	2017-00006212	7
03/19/2017	Evidence	Consumable Goods			CIGARETTE PACK WITH POSS BLOOD MATTER	2017-00006212	6
03/19/2017	Evidence	Clothes Fur			WATCH BAND	2017-00006212	5
03/19/2017	Evidence	Clothes Fur			FRAME, GOLD AVATOR STYLE	2017-00006212	4
03/19/2017	Evidence	Clothes Fur			RIGHT GRAY BOOT	2017-00006212	3
03/19/2017	Evidence	Clothes Fur			WHITE PING GOLF HAT	2017-00006212	2
03/19/2017	Evidence	Clothes Fur			Left grey boot	2017-00006212	1

**Seq #8**

Tag Number: 2017-00006212      Item Number: 8  
 Property Codes:      Property Type: Digital Media  
 Evidence  
 Quantity: 1.000      Unit of Measure: Each  
 Description: Disc containing video of video from Amtrak train

Date Received: 03/21/2017

**Chain of Custody**

Date	Transaction	From	From Role	To	To Role
03/21/2017 17:22	Type: Intake	EP2601-Andrew Mehl		EP2066-Lynn Mandeville	
	Code: Initial				
	Remarks:				

**Seq #7**

Tag Number: 2017-00006212      Item Number: 7  
 Property Codes:      Property Type: Cell Phone  
 Evidence  
 Quantity: 1.000      Unit of Measure: Each  
 Description: CELL PHONE WITH PINK CASE  
 Make: Unknown or Unlisted  
 Color: Pink

Date Received: 03/19/2017

Officer Remarks: OWNER: REED, JADE (DECEASED)

**Chain of Custody**

Date	Transaction	From	From Role	To	To Role
03/19/2017 23:21	Type: Intake	EP2952-Joshua Hwang		EP2066-Lynn Mandeville	
	Code: Initial				
	Remarks:				



# Edmonds Police Department Detail



Print Date/Time: 03/28/2017 08:34  
 Login ID: ep0864  
 Case Number: 2017-00006212

ORI Number: Edmonds Police Department  
 WA0310200

**Seq #6**

Tag Number: 2017-00006212      Item Number: 6  
 Property Codes:      Property Type: Consumable Goods  
 Evidence  
 Quantity: 1.000      Unit of Measure: Each  
 Description: CIGARETTE PACK WITH POSS BLOOD MATTER

Date Received: 03/19/2017

Officer Remarks: FOUND WEST SIDE TRACK BY WATCH BAND #8

Chain of Custody

Date	Transaction	From	From Role	To	To Role
03/19/2017 22:59	Type: Intake	EP1104-Michael Richardson		EP2066-Lynn Mandeville	
	Code: Initial				
	Remarks:				

**Seq #5**

Tag Number: 2017-00006212      Item Number: 5  
 Property Codes:      Property Type: Clothes Fur  
 Evidence  
 Quantity: 1.000      Unit of Measure: Each  
 Description: WATCH BAND  
 Color: Black

Date Received: 03/19/2017

Officer Remarks: WEST SIDE TRACK, #7 , COLLECTED MEHL

Chain of Custody

Date	Transaction	From	From Role	To	To Role
03/19/2017 22:59	Type: Intake	EP1104-Michael Richardson		EP2066-Lynn Mandeville	
	Code: Initial				
	Remarks:				

**Seq #4**

Tag Number: 2017-00006212      Item Number: 4  
 Property Codes:      Property Type: Clothes Fur  
 Evidence  
 Quantity: 1.000      Unit of Measure: Each  
 Description: FRAME, GOLD AVATOR STYLE  
 Color: Gold

Date Received: 03/19/2017

Officer Remarks: FOUND WEST SIDE TRACK #2, MEHL

Chain of Custody

Date	Transaction	From	From Role	To	To Role
03/19/2017 22:59	Type: Intake	EP1104-Michael Richardson		EP2066-Lynn Mandeville	
	Code: Initial				
	Remarks:				



# Edmonds Police Department Detail



Print Date/Time: 03/28/2017 08:34  
 Login ID: ep0864  
 Case Number: 2017-00006212

ORI Number: Edmonds Police Department  
 WA0310200

**Seq #3**

Tag Number: 2017-00006212      Item Number: 3  
 Property Codes:      Property Type: Clothes Fur  
 Evidence  
 Quantity: 1.000      Unit of Measure: Each  
 Description: RIGHT GRAY BOOT  
  
 Color: Gray

Date Received: 03/19/2017

Officer Remarks: FOUND ON WEST SIDE OF TRACK,  
 MEHL #1

Chain of Custody

Date	Transaction	From	From Role	To	To Role
03/19/2017 22:59	Type: Intake	EP1104-Michael Richardson		EP2066-Lynn Mandeville	
	Code: Initial				
	Remarks:				

**Seq #2**

Tag Number: 2017-00006212      Item Number: 2  
 Property Codes:      Property Type: Clothes Fur  
 Evidence  
 Quantity: 1.000      Unit of Measure: Each  
 Description: WHITE PING GOLF HAT  
 Color: White

Date Received: 03/19/2017

Officer Remarks: found by Swartz on beach

Chain of Custody

Date	Transaction	From	From Role	To	To Role
03/19/2017 22:59	Type: Intake	EP1104-Michael Richardson		EP2066-Lynn Mandeville	
	Code: Initial				
	Remarks:				

**Seq #1**

Tag Number: 2017-00006212      Item Number: 1  
 Property Codes:      Property Type: Clothes Fur  
 Evidence  
 Quantity: 1.000      Unit of Measure: Each  
 Description: Left grey boot

Date Received: 03/19/2017

Officer Remarks: Found by Swartz on beach

Chain of Custody

Date	Transaction	From	From Role	To	To Role
03/19/2017 22:59	Type: Intake	EP1104-Michael Richardson		EP2066-Lynn Mandeville	
	Code: Initial				
	Remarks:				

**Vehicles**

No.	Role	Vehicle Type	Year	Make	Model	Color	License Plate	State
1	Other Vehicle	Passenger Car	2005	Chevrolet	Equinox	Blue	BCB5166	WA



# Edmonds Police Department Detail



Print Date/Time: 03/28/2017 08:34  
 Login ID: ep0864  
 Case Number: 2017-00006212

ORI Number: Edmonds Police Department  
 WA0310200

**Vehicle # 1**

Type:	Passenger Car	Year:	2005	Make:	Chevrolet	Model:	Equinox	
Color:	Blue	License Plate:	BCB5166	State:	WA			
Date/Time:	03/19/2017 19:10	Location:	16121 75TH PL W EDMONDS, WA 98026					

- Liquor Board
- Dawson Place
- Juvenile Court
- Juvenile Prosecutor
- Mental Health
- APS
- District Court
- Municipal Court
- DOL
- CPS
- Other \_\_\_\_\_
- City Attorney
- County Prosecutor
- Federal Prosecutor
- Domestic Violence Unit
- City Prosecutor
- Detectives

2017-6212 Field Sketch

17-6212

Field sketch

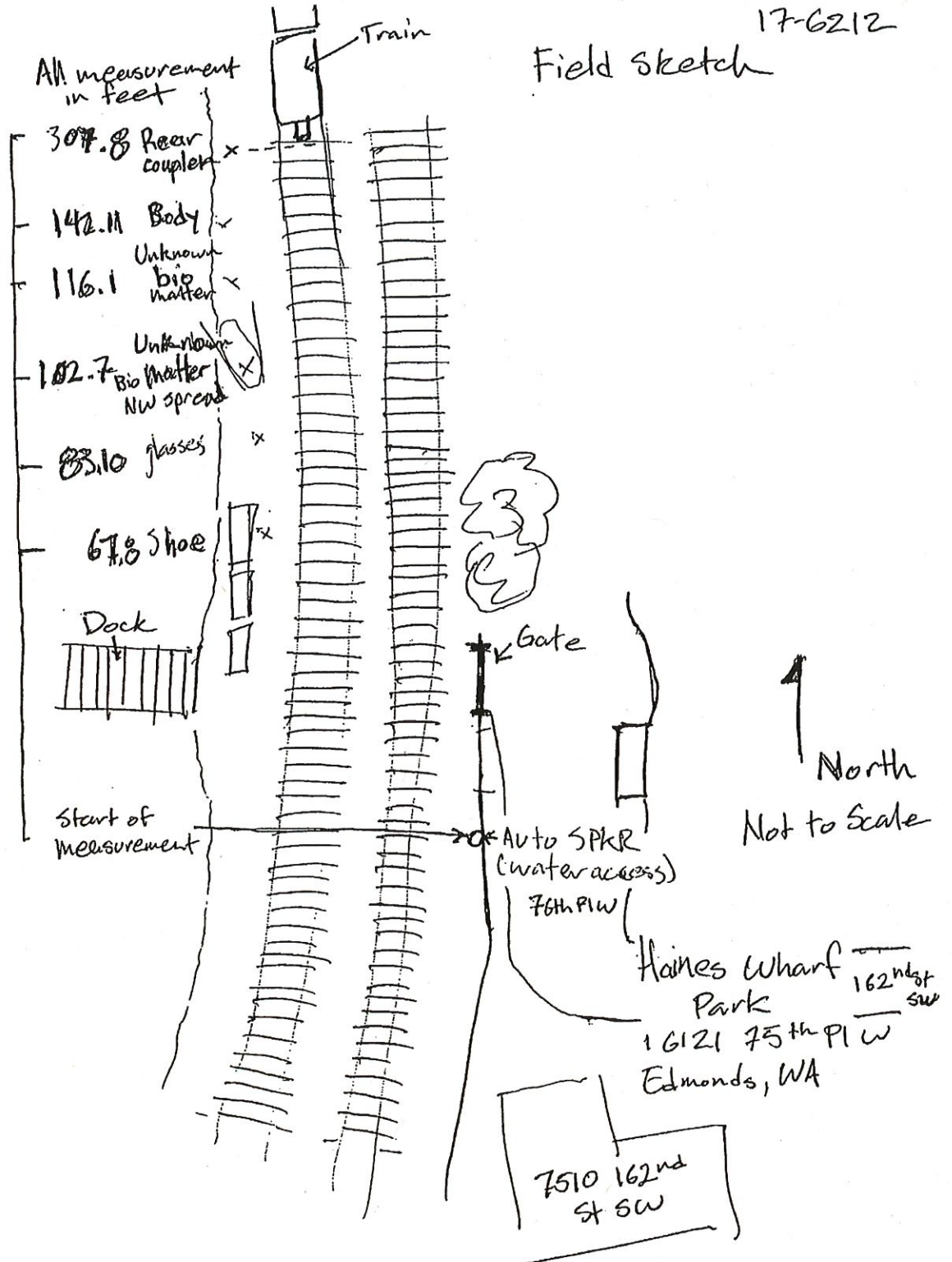

EP Case Supplement, Officer: ep1104, Supervisor: ep0358, Merged

 <b>EDMONDS POLICE DEPARTMENT</b> 250 5th Ave N Edmonds, WA 98020 (425) 771-0200	<b>Case Supplement Report</b>
	Case Report # <b>2017-00006212</b>

DATE/TIME REPORTED	03/19/2017 19:40
--------------------	------------------

OFFENSES	STATUTE / DESCRIPTION	Counts	Attempt/Commit

SUBJECT	<input type="checkbox"/> NON-DISCLOSURE						
	SUBJECT TYPE		NAME			DOB / AGE RANGE	
	ADDRESS					PRIMARY PHONE	
						SECONDARY PHONE	
	RACE		SEX	HEIGHT	WEIGHT	HAIR	EYE
	DL NUMBER		DL STATE		EMPLOYER		

SUBJECT	<input type="checkbox"/> NON-DISCLOSURE						
	SUBJECT TYPE		NAME			DOB / AGE RANGE	
	ADDRESS					PRIMARY PHONE	
						SECONDARY PHONE	
	RACE		SEX	HEIGHT	WEIGHT	HAIR	EYE
	DL NUMBER		DL STATE		EMPLOYER		

VEHICLE	PROPERTY CODE			YEAR	COLOR
	TYPE / MAKE / MODEL /				
	PLATE	STATE	VIN	VALUE	
	DESCRIPTION				

PROPERTY	PROPERTY CODE			
	SERIAL NUMBER	QTY/UNIT OF MEASURE	VALUE	COLOR
	TYPE / MAKE / MODEL /			
	DESCRIPTION			

REPORTING OFFICER / ID #	APPROVING SUPERVISOR
Richardson, Michael B 1104	Jones, Jeff J



**EDMONDS POLICE DEPARTMENT**  
250 6th Ave N  
Edmonds, WA 98020  
(425) 771-0200

### Case Supplement Report

Case Report # 2017-00006212

### NARRATIVE

On 03/19/17 at approximately 1940hrs I received a call from Corporal D. Smith of the Edmonds Police Department. In informed me that there had been a train vs pedestrian collision at Meadowdale Marina or Haines Warf Park. That area is located in the City of Edmonds. I agreed to call out Detectives to document the scene and interview witnesses.

I called Det Mehl who agreed to respond. I attempted to call other detectives, but they were not available. I responded to the police department. I was contacted by Detective Mehl who was at the scene. He advised the death appeared to be an accident. He stated there were witnessed to the incident. He was going to document the incident with photographs and take measurements. I asked him if he had all the equipment he needed. He stated he needed evidence placards.

I arrived at Edmonds PD and responded to the scene in the crime scene van.

Upon arrival I was briefed by Det Mehl, Cpl Smith and Officer J. Hwang. They said the female was married to the male in the Fire Department Aid Car. The male's name was Reed, Ryan B dob 8/19/79. The female was id'd as Reed, Jade K dob 6/13/75. I was advised they were coming down to the beach to see the sunset. Ryan Reed went off the trail to use the bathroom before going onto the railroad tracks. Jade Reed continued onto the tracks and was hit by a train traveling at a high rate of speed.

I walked down to where the body was wedged between the rocks on the rock wall. I assisted marking evidence as Detective Mehl took photographs of the incident. The following items were marked with a placard:

1. Left gray boot
2. Gold framed eye glasses
3. Brain matter
4. Brain matter
5. Blood
6. Blood spatter closed to body
7. Watch band broken
8. Cigarette pack with blood spatter
9. Tissue between rocks

Detective Mehl and I collected the evidence. There were six pieces of evidence collected, items 1, 2, 7, 8 and two items found on the beach and rocks. They were the right gray boot and a white baseball hat. Each item was placed into bags and marked. I locked the items in the crime scene van.

The Medical Examiner Investigators were on scene. They were preparing to remove the body. I assisted lifting the body after it was placed on the stretcher. The body was carried to the Medical Examiner's truck where they

This report was submitted from an electronic device owned, issued, or maintained by a law enforcement agency using my user ID and password. I certify or declare under penalty of perjury under the laws of the State of Washington that the foregoing is true and correct.

REPORTING OFFICER / ID # Richardson, Michael B 1104	APPROVING SUPERVISOR Jones, Jeff J
LOCATION SIGNED Snohomish County, WA	DATE SIGNED 03/20/2017

This officer's narrative is complete when an approving supervisor's name is attached. Complete report details do not print in this format.  
EP Case Supplement 2017-00006212 Page 2 OF 3





# 2017-6212 Property receipt, photo logs

17-6212

## Quick Property Receipt



Edmonds Police Department  
ORI Number: WA0310200



Print Date/Time: 03/19/2017 23:24  
Login ID: ep2952

Entry Date/Time: 03/19/2017 23:21  
Officer: EP2952 - Hwang  
Case Number: 2017-00006212  
Property Code(s): Evidence

Location/Other: TEMP Storage  
Facility: Edmonds Property Room  
Tag/Item Number: 2017-000062127

Description: CELL PHONE WITH PINK CASE

*ep2952*  
Submitted By

*3/19/17*  
Date

\_\_\_\_\_  
Property Officer

\_\_\_\_\_  
Date



City of Edmonds  
250 5th Ave N  
Edmonds, WA 98020  
(425) 771-0200

17-6212

Upload ID: 2E7330DABFC0\_1-1  
Tag Log

Case Information

Case Number: 17-6212  
Case Name: 2017  
Case Year: BNRR tracks in 16100 block  
Case Address: Other  
Case Status:

Download Information

Evidence Location: BNRR tracks in 16100 block  
Collected By: 2952, Joshua Hwang  
Collected Date/Time: 03/20/2017  
Uploaded By: 2952, Joshua Hwang  
Uploaded Date/Time: 03/20/2017 0010

No.	File Name	Bytes	Captured	Description
1	IMG_0001.JPG	4011623	3/19/2017 7:49:42 PM	SCENE OVERALL MD5: 84DCP3AA2A49B7E7F0E05088EC5127B
2	IMG_0002.JPG	6456089	3/19/2017 7:49:52 PM	SCENE OVERALL MD5: 5F7147052DF5318DFC7A7877C4B3748
3	IMG_0003.JPG	4247495	3/19/2017 7:52:22 PM	FRONT OF TRAIN MD5: 95F06A93F4403FFFC000FAD8FE023C0F
4	IMG_0004.JPG	4594615	3/19/2017 7:52:36 PM	FRONT OF TRAIN MD5: F24970AA447F9C1EA471C31E93F167B
5	IMG_0005.JPG	6144315	3/19/2017 7:53:16 PM	FRONT OF TRAIN GUARD MD5: A2D70F65E28345500921667AD1008000
6	IMG_0006.JPG	6444670	3/19/2017 7:54:00 PM	FRONT OF TRAIN GUARD MD5: 400A5F0EE577125C40ECAA3CF9273D
7	IMG_0007.JPG	5421610	3/19/2017 7:54:24 PM	IMPACT POINT FRONT OF TRAIN ABOVE GUARD MD5: 051E31710C03E3FEDE03F105060361
8	IMG_0008.JPG	5582268	3/19/2017 7:54:28 PM	FRONT OF TRAIN GUARD WEST SIDE MD5: 85782B078770F6C038A2861195311E
9	IMG_0009.JPG	6099173	3/19/2017 7:54:40 PM	FRONT OF TRAIN LOWER WEST SIDE MD5: 92D1D06431956204015AEE454FE822FB
10	IMG_0010.JPG	6374878	3/19/2017 7:54:48 PM	FRONT OF TRAIN ABOVE GUARD MD5: 300E4661B9953C32C4D1EE224F08F
11	IMG_0011.JPG	6255036	3/19/2017 7:54:58 PM	FRONT OF TRAIN GUARD UPPER WEST SIDE MD5: 0909C4D18A90EAA3457770AEE46605
12	IMG_0012.JPG	6040388	3/19/2017 7:55:00 PM	FRONT OF TRAIN GUARD UPPER WEST SIDE MD5: 008B7230ACAA9CEDAE1E36F720A4D
13	IMG_0013.JPG	6207581	3/19/2017 7:55:04 PM	FRONT OF TRAIN GUARD WEST SIDE MD5: 8F5CD65EB1009B7C50477E6A40275E4
14	IMG_0014.JPG	6426010	3/19/2017 7:55:08 PM	FRONT OF TRAIN GUARD WEST SIDE MD5: BA4DC0F732566E250400C0C77C737
15	IMG_0015.JPG	6038941	3/19/2017 7:55:14 PM	FRONT OF TRAIN GUARD LOWER WEST SIDE MD5: 601E38A7386E1E30D002318AA32E374
16	IMG_0016.JPG	6627767	3/19/2017 7:55:16 PM	FRONT OF TRAIN GUARD LOWER WEST SIDE MD5: 10247323020FF4C548379D04AE10A3F
17	IMG_0017.JPG	7101844	3/19/2017 7:55:28 PM	FRONT OF TRAIN COUPLING DEVICE MD5: 84F2F0116408D681300A179E3041FA3
18	IMG_0018.JPG	6499800	3/19/2017 7:55:32 PM	FRONT OF TRAIN WEST SIDE GUARD WITH PHONE BEHIND TUBING MD5: 30185AC0C725081FFB1E051331958423
19	IMG_0019.JPG	6232522	3/19/2017 7:55:36 PM	FRONT OF TRAIN WEST SIDE GUARD MD5: 30AD115E66204D1783E0FCACFAE8EF30
20	IMG_0020.JPG	5693968	3/19/2017 7:56:22 PM	FRONT OF TRAIN GUARD MD5: 080C22F05348701EAAD4F8768376800
21	IMG_0021.JPG	4371808	3/19/2017 7:56:52 PM	TRAIN WITH HEADLIGHTS ON MD5: 2E71801400C81C0FEE00C377002039

*JH #2952*

*3/20/17*

17-6212

Upload ID: 2E7330DABFC0\_1-1  
Tag Log



City of Edmonds  
250 5th Ave N  
Edmonds, WA 98020  
(425) 771-0200

No.	File Name	Bytes	Captured	Description
22	IMG_0022.JPG	6850146	3/19/2017 7:57:28 PM	FRONT OF TRAIN COUPLING DEVICE MDS: 50BF C70E1EA377C1AD3299905334EE
23	IMG_0023.JPG	6448527	3/19/2017 7:57:58 PM	FRONT OF TRAIN COUPLING DEVICE MDS: 71FDD0074132A372D1944840E1E501
24	IMG_0024.JPG	6136125	3/19/2017 7:58:06 PM	FRONT OF TRAIN ABOVE GUARD MDS: 1A87165AC26339902C50952E4C78C58
26	IMG_0025.JPG	5261637	3/19/2017 7:58:16 PM	FRONT OF TRAIN WEST SIDE GUARD MDS: C81E02A5145FFA659D4C3778122172
26	IMG_0026.JPG	6393694	3/19/2017 7:58:24 PM	FRONT OF TRAIN BEHIND GUARD MDS: 96F87B8F50ACB78ADCF6F10300E7002
27	IMG_0027.JPG	5677658	3/19/2017 7:59:02 PM	FRONT OF TRAIN WEST SIDE GUARD MDS: AD9F483336822341008168A1C1C653
28	IMG_0028.JPG	5480316	3/19/2017 7:59:10 PM	FRONT OF TRAIN WEST SIDE GUARD MDS: 3F6B3308D511790C7D5F85086947411
29	IMG_0029.JPG	4091038	3/19/2017 7:59:40 PM	FRONT OF TRAIN WEST SIDE GUARD MDS: 1901EC81D897DA27400FA0027713
30	IMG_0030.JPG	5910743	3/19/2017 7:59:58 PM	FRONT OF TRAIN ABOVE GUARD MDS: 8FD026FA93470A9020100C50300413
31	IMG_0031.JPG	5835116	3/19/2017 8:00:02 PM	FRONT OF TRAIN ABOVE GUARD MDS: F18EAD3F372F EDAT00ANF6291E58015
32	IMG_0032.JPG	6046156	3/19/2017 8:00:18 PM	FRONT OF TRAIN ABOVE GUARD MDS: 568318FAC665911F6889D0C939C655
33	IMG_0033.JPG	5847304	3/19/2017 8:30:05 PM	FRONT OF TRAIN BEHIND FRONT TUBING MDS: 8F7C20E1ECCF186D08EAECC62806
34	IMG_0034.JPG	5930621	3/19/2017 8:30:18 PM	FRONT OF TRAIN BEHIND TUBING, LOCATION OF CELL PHONE MDS: A1E218A603E50CF438CE0F1C6D066C
35	IMG_0035.JPG	6279437	3/19/2017 8:30:28 PM	FRONT OF TRAIN BEHIND TUBING, LOCATION OF CELL PHONE MDS: 50714A507941243373070B32DC184C2
36	IMG_0036.JPG	7121642	3/19/2017 8:30:34 PM	FRONT OF TRAIN COUPLING DEVICE MDS: 2076AC06D17761EFA34E71E82903066
37	IMG_0037.JPG	6149808	3/19/2017 8:32:36 PM	WEST SIDE OF TRAIN ENGINE MDS: 92AF08DA404DE75935915807F237
38	IMG_0038.JPG	5360391	3/19/2017 8:32:54 PM	WEST SIDE OF TRAIN ENGINE MDS: ASCA132D8E9C0C184879D81D646E790
39	IMG_0039.JPG	5826453	3/19/2017 8:33:04 PM	WEST SIDE OF TRAIN ENGINE, ENGINEER LADDER MDS: 2112595EFD88E1A198C814054854C
40	IMG_0040.JPG	5285351	3/19/2017 8:33:14 PM	WEST SIDE OF TRAIN ENGINE, ENGINEER LADDER MDS: C618D122591ED9DCC69F4ADF973AF
41	IMG_0041.JPG	4759769	3/19/2017 8:33:22 PM	WEST SIDE OF TRAIN ENGINE, ENGINEER LADDER MDS: 5F23F E0065E7FA8B7C3F112724BE000
42	IMG_0042.JPG	4405367	3/19/2017 8:33:38 PM	WEST SIDE OF TRAIN ENGINE, ENGINEER LADDER MDS: E66E4RAF657084ED8725AD412948154
43	IMG_0043.JPG	4687546	3/19/2017 8:34:16 PM	WEST SIDE OF TRAIN ENGINE, GUARD SKIRT MDS: 44DE59144544975070861E1A7DE05E37
44	IMG_0044.JPG	5259564	3/19/2017 8:34:28 PM	WEST SIDE OF TRAIN ENGINE, GUARD SKIRT MDS: EDC4TRC5E4C7434C078AD1D83492D
45	IMG_0045.JPG	5679468	3/19/2017 8:34:50 PM	WEST SIDE OF TRAIN ENGINE, GUARD SKIRT MDS: D123C4E01CA86803F7006A071CA967
46	IMG_0046.JPG	5610397	3/19/2017 8:35:00 PM	WEST SIDE OF TRAIN ENGINE, UNDER CARRIAGE MDS: C871A6207C5A03E212041B3025E85A
47	M0100.CTG	436	3/19/2017 8:35:00 PM	UNK MDS: D14726A82FEC186C73A70A51A8770A3

*[Handwritten Signature]* #2952

3/20/17



City of Edmonds  
250 5th Ave N  
Edmonds, WA 98020  
(425) 771-0200

**17-6212**  
7748D06E5y\_1-1  
Tag Log

**Case Information**

Case Number: **17-6212**  
Alias Number:  
Case Year: **2017**  
Case Address: **BNRR tracks in 16100 block**  
Type of Case: **Other**

**Download Information**

Evidence Location: **BNRR tracks in 16100 block**  
Collected By: **2985, Sierra Swartz**  
Collected Date/Time: **3/19/2017**  
Uploaded By: **2985, Sierra Swartz**  
Uploaded Date/Time: **03/20/2017 00:47**

No	File MD5 Hash	Size (bytes)	Date	Description
1	DSCN0042.JPG 2080FC441E52C712F4B041DD3FAE	4878198	3/19/2017 8:27:20 PM	Where body was located
2	DSCN0043.JPG 91F7E759148E2D4140A4A0CA5404549	4825559	3/19/2017 8:27:30 PM	Where body was located
3	DSCN0044.JPG 9E8BA14B817008A826641B887811A8A	4823771	3/19/2017 8:27:38 PM	Where body was located
4	DSCN0045.JPG 209454865C001D60F3048E0E185917	4558705	3/19/2017 8:27:48 PM	Where body was located
5	DSCN0046.JPG A862002A5E5940611F3AC8E0441FD8	4712825	3/19/2017 8:27:58 PM	Where body was located
6	DSCN0047.JPG 096931MA32F5450310AE029F40F8A	4767442	3/19/2017 8:28:08 PM	train that struck victim
7	DSCN0048.JPG 05F60CE37A12E5E5E9E270F05548ADF7	4294470	3/19/2017 8:28:36 PM	Where body was located
8	DSCN0049.JPG 70C87818785847E6E3A5411709F8E	4627370	3/19/2017 8:28:40 PM	Area victim was located
9	DSCN0050.JPG C49030597C6D118E1DDCA76A7608E5	4641129	3/19/2017 8:28:44 PM	train that struck victim
10	DSCN0051.JPG 3DE2206E4E82A7F8A6E27A181781004	4593794	3/19/2017 8:28:48 PM	train that struck victim
11	DSCN0052.JPG 39C493E7AE890C2F1D248CC47095EA	4571232	3/19/2017 8:29:52 PM	glasses found on the ground
12	DSCN0053.JPG 00F7B5B452CC2177B50F814E9A331118	4622485	3/19/2017 8:29:58 PM	glasses found on the ground
13	DSCN0054.JPG 66B950CDE083457367A828923253747B	4618703	3/19/2017 8:30:04 PM	glasses found on the ground
14	DSCN0055.JPG AACT4892054810C48180CC09E2A15C2	4488032	3/19/2017 8:30:12 PM	glasses found on the ground
15	DSCN0056.JPG 8021681FF7CC82C62E18EFA3AFCFED4	4739848	3/19/2017 8:30:16 PM	right boot
16	DSCN0057.JPG 38B463312AC0A4A0917BC77ED74A87C	4597993	3/19/2017 8:30:24 PM	right boot
17	DSCN0058.JPG 54F205453FA8E7F581BCA83FDC2923	4593417	3/19/2017 8:30:28 PM	right boot
18	DSCN0059.JPG 4E24436E77E1E9F0007CA1E250F9A9E	4608910	3/19/2017 8:30:34 PM	right boot
19	DSCN0060.JPG FE03730878110FA40D04C681E18292D	4571932	3/19/2017 8:31:04 PM	Where body was located
20	DSCN0061.JPG A95DEE2C85E40C209F5DAF692000C264	4584888	3/19/2017 8:31:54 PM	body fluids on rocks
21	DSCN0062.JPG C8456564D8450E0CFE4C0A2F0C31774	4096666	3/19/2017 8:32:04 PM	fresh broken bottle
22	DSCN0063.JPG 393FD8A6C04F507459E10C627845EFCB	4588863	3/19/2017 8:33:12 PM	fresh broken bottle
23	DSCN0064.JPG 817815811D4092820A0483C39200E15A	4688848	3/19/2017 8:34:10 PM	Where body was located
24	DSCN0065.JPG 7F984E5F87FE70CA31C08772D1C144F	4651257	3/19/2017 8:34:24 PM	Where body was located
25	DSCN0066.JPG 7A327913004605192741D1C1C0CA48CA	4762480	3/19/2017 8:34:32 PM	body fluids on rocks
26	DSCN0067.JPG 64005E1878287E91800A20C30CE7745	4661168	3/19/2017 8:34:42 PM	body parts on rocks
27	DSCN0068.JPG 45F084410A02C97DA1D0125091574	4688243	3/19/2017 8:34:52 PM	body part found in rocks
28	DSCN0069.JPG 091B18A9380768A858172294AC7A3F34	4825019	3/19/2017 8:35:12 PM	body fluids on rocks
29	DSCN0070.JPG 643945300181529E200545E571D06162	4718802	3/19/2017 8:38:00 PM	Watch band
30	DSCN0071.JPG C1E1054431180F208CA4E8B90021641B	4601548	3/19/2017 8:37:06 PM	new cigarettes
31	DSCN0072.JPG 800037820A48167A30000003C8F108F	4542638	3/19/2017 8:37:12 PM	new cigarettes
32	DSCN0073.JPG E5304A3F08B2F7F0304AE8E81DAD015A	4539715	3/19/2017 8:38:02 PM	body fluids on rocks
33	DSCN0074.JPG 0EFA0E8600C3A3C0FFFE1E35A7842	4550971	3/19/2017 8:38:10 PM	body fluids on rocks
34	DSCN0075.JPG 1F987202502026242CF8CE8C0DDF002	4807323	3/19/2017 8:40:50 PM	body fluids on rocks

*Sierra Swartz* 2985

3-20-17

Case # 17-6212

**EDMONDS POLICE DEPARTMENT**  
250 5<sup>TH</sup> AVENUE NORTH  
EDMONDS, WA 98020

**INCIDENT STATEMENT FORM**

Name Collins John P Date of Birth 10/11/61  
Last First Middle Initial mm dd yyyy

Address 10807 SEA View Dr Anderson Is WA 98303  
Number Street City St Zip

Res. Phone (206) 390 4702 Work Phone ( ) Other ( )

Email Address Collinsj@Antak.com

*The following is my voluntary statement regarding this police report:*

I had the Air Bo Saw Folks Running  
Back I walked Back and Found The Balbe

**For Burglaries, Thefts and Vehicle Theft reports:**

I did not give anyone permission to enter my premises and/or take/remove my property/vehicle.

**Making false reports to public officers:**

A person commits the crime of making a false report if he/she willfully makes any untrue, misleading or exaggerated statement in any report to a Police or Fire Department. Making a false report is a misdemeanor.

I certify (or declare) under penalty of perjury, under the laws of the State of Washington, the above statement is true and correct.

SIGNATURE [Signature] Date 3/20/17 Location Edmonds, WA

Signature Witness [Signature] #2952 Date 3/20/17

Case # 17-6212

**EDMONDS POLICE DEPARTMENT**  
250 5<sup>TH</sup> AVENUE NORTH  
EDMONDS, WA 98020

**INCIDENT STATEMENT FORM**

Name DRAWDY LARRY E Date of Birth 4, 5, 54  
Last First Middle Initial mm dd yyyy

Address 30310 24<sup>TH</sup> AVE S. Roy WA 98080  
Number Street City St Zip

Res. Phone (206) 941-8651 Work Phone (206) 382-4134 Other ( )

Email Address LEDRAWDY@AOL.COM

The following is my voluntary statement regarding this police report:

ON MARCH 19<sup>TH</sup> WHILE WORKING AM TRAK TRAIN #8 AS THE TRAIN CONDUCTOR THE FOLLOWING INCIDENT HAPPENED. I WAS RIDING/SITTING IN THE DORM CAR, WHEN I HEARD THE BRAKES GO INTO EMERGENCY AND FELT THE TRAIN START TO COME TO A STOP. I ASKED THE LOCOMOTIVE ENGINEER IF HE GOT SOMEONE AND HE SAID YES. WHEN THE TRAIN STOPPED I GOT OFF RAMP TO THE RENE AND THEN SOME J.C. COLLINS THE ON BOARD SUPERVISOR WAS ALREADY THERE. THERE WAS A LADY LYING IN THE ROCKS DECEASED AND HER BOYFRIEND SITTING BY IN SHOCK AND TEARS. WE CALLED 911, TRAIN DISPATCHER AND TRAINS IN THE AREA. THIS HAPPEN ABOUT 705 PM. POLICE ARRIVED ABOUT 715 PM. OUR EMPLOYEES PLACED BLANKETS ON THE LADY BEFORE POLICE ARRIVED.

*Larry Drawdy*

**For Burglaries, Thefts and Vehicle Theft reports:**

I did not give anyone permission to enter my premises and/or take/remove my property/vehicle.

**Making false reports to public officers:**

A person commits the crime of making a false report if he/she willfully makes any untrue, misleading or exaggerated statement in any report to a Police or Fire Department. Making a false report is a misdemeanor.

I certify (or declare) under penalty of perjury, under the laws of the State of Washington, the above statement is true and correct.

SIGNATURE Larry Drawdy Date 3/19/17 Location Edmonds, WA

Signature Witness [Signature] # 2952 Date 3/19/17

Case # 17-6212

**EDMONDS POLICE DEPARTMENT**  
250 5<sup>TH</sup> AVENUE NORTH  
EDMONDS, WA 98020

**INCIDENT STATEMENT FORM**

Name LONAHAN, SCOTT A Date of Birth 05/06/1965  
Last First Middle Initial mm dd yyyy  
Address 15927-75<sup>th</sup> PL West EDMONDS WA 98026  
Number Street City St Zip  
Res. Phone (425) 7452499 Work Phone (360) 659-2983 Cell (425) 356-7022 Other  
Email Address SCOTT@NATIONALMARINEEXHAUST.COM

The following is my voluntary statement regarding this police report:

I WAS WALKING ALONG THE BEACH HEADED SOUTH TOWARDS HAINES  
WARF. I HEARD & SAW AN AMTRAC TRAIN COMING NORTH TOWARDS  
OUR DIRECTION. I LOOKED DOWN AT THE SAND AS TO NOT  
TRIP ON ROCKS ETC. I HEARD THE TRAIN HORN SOUND  
LONG. I LOOKED UP & HEARD A LOUD THUD & SAW A PERSON  
CARTWHEEL IN THE AIR. APPEARED TO BE WEARING WHITE JEANS  
& ORANGE OR RED TOP. WE WERE APPROX 100 YDS NORTH  
OF THE IMPACT & RAN TOWARDS HER TO SEE IF THEY/SHE  
WAS OK. WHEN I APPROACHED AT THE BOTTOM OF THE  
ROCKS THERE WAS A MAN LAYING / BREATHED NEXT TO HER  
ON THE ROCKS WEEPING / VERY DISTRAIT. I NOTICE SHE HAD  
NO SHOE ON THE FOOT I COULD SEE & POSSIBLY A HIP BONE  
POKING OUT. THE TRAIN EMPLOYEES (APPROX 4-5) CAME OUT  
OF THE TRAIN WITH PLANKS TO ASSIST & COVER THE  
BODY. I DETERMINED AT THAT POINT THERE WAS NOTHING I  
COULD DO TO HELP. I WALKED BACK TOWARDS MY WIFE &  
TOLD HER NOT TO GO LOOK. WE WALKED BACK TO THE  
BEACH PARK & RANGERS HOUSE & WALKED DOWN 76<sup>M</sup> BACK TO THE  
SCENE.

For Burglaries, Thefts and Vehicle Theft reports:

I did not give anyone permission to enter my premises and/or take/remove my property/vehicle.

Making false reports to public officers:

A person commits the crime of making a false report if he/she willfully makes any untrue, misleading or exaggerated statement in any report to a Police or Fire Department. Making a false report is a misdemeanor.

I certify (or declare) under penalty of perjury, under the laws of the State of Washington, the above statement is true and correct.

SIGNATURE [Signature] Date 3/19/17 Location HAINES WARE PARK  
Signature Witness [Signature] # 2952 Date 3/19/17



Case # 17-6212

**EDMONDS POLICE DEPARTMENT**  
250 5<sup>TH</sup> AVENUE NORTH  
EDMONDS, WA 98020

**INCIDENT STATEMENT FORM**

Name JONATHAN HEIDI H Date of Birth 03/08/1964  
Last First Middle Initial mm dd yyyy

Address 15927 75<sup>TH</sup> PL W EDMONDS WA 98026  
Number Street City St Zip

Res. Phone 425 7452499 Work Phone ( ) NA Other 206 9402029

Email Address heidiiishome@msn.com

The following is my voluntary statement regarding this police report:

My husband Scott Conahan and I were walking south on Meadowdale Beach from the park to Haines Wharf Dock in the early evening just before sunset. I heard the train honking which is not unusual for this area. I was looking toward the dock when I heard a loud THUD and saw what looked like a white and pink (or red/wax) bundle like a rag doll cartwheel from the front of the train over and over and land on the rocks. It did not register at first what I saw. I looked at the other people on the beach to see if they were reacting. The train was stopping and I started to run to the "person" on the rocks, because it registered that the rag doll I saw was a real person. My husband was running to the person too, and ran past me because I stopped to help a woman give directions and info to the 911 operator. The train by now was fully stopped and a train employee opened the back door and asked me if the train hit anyone. I yelled "yes!" He (the →

For Burglaries, Thefts and Vehicle Theft reports:  
 I did not give anyone permission to enter my premises and/or take/remove my property/vehicle.

**Making false reports to public officers:**  
 A person commits the crime of making a false report if he/she willfully makes any untrue, misleading or exaggerated statement in any report to a Police or Fire Department. Making a false report is a misdemeanor.

I certify (or declare) under penalty of perjury, under the laws of the State of Washington, the above statement is true and correct.

SIGNATURE [Signature] Date 3/19/17 Location EDMONDS

Signature Witness [Signature] #2952 Date 3/17/17

train employee got out and started walking back to the body. Meanwhile, the girl's boyfriend had climbed over the rocks to his girlfriend and was kneeling next to her. The train employees put a blanket over her. My husband who ~~was~~ had gone ahead came back to me ~~and was going back to the~~ and said we should go. We turned back.

Roy (Cah)

EP Case Supplement, Officer: ep2985, Supervisor: ep2230, Merged

 <p><b>EDMONDS POLICE DEPARTMENT</b> 250 5th Ave N Edmonds, WA 98020 (425) 771-0200</p>	<p><b>Case Supplement Report</b></p> <p>Case Report # <b>2017-00006212</b></p>
--	--

DATE/TIME REPORTED	3/19/2017 19:10
--------------------	-----------------

	STATUTE / DESCRIPTION	Counts	Attempt/Commit
OFFENSES			

SUBJECT	<input type="checkbox"/> NON-DISCLOSURE						
	SUBJECT TYPE	NAME			DOB / AGE RANGE		
	ADDRESS				PRIMARY PHONE		
					SECONDARY PHONE		
	RACE	SEX	HEIGHT	WEIGHT	HAIR	EYE	
	DL NUMBER	DL STATE	EMPLOYER				

SUBJECT	<input type="checkbox"/> NON-DISCLOSURE						
	SUBJECT TYPE	NAME			DOB / AGE RANGE		
	ADDRESS				PRIMARY PHONE		
					SECONDARY PHONE		
	RACE	SEX	HEIGHT	WEIGHT	HAIR	EYE	
	DL NUMBER	DL STATE	EMPLOYER				

VEHICLE	PROPERTY CODE			YEAR	COLOR
	TYPE / MAKE /		MODEL /		
	PLATE	STATE	VIN	VALUE	
	DESCRIPTION				

PROPERTY	PROPERTY CODE			
	SERIAL NUMBER	QTY/UNIT OF MEASURE	VALUE	COLOR
	TYPE / MAKE /		MODEL /	
	DESCRIPTION			

REPORTING OFFICER / ID # Swartz, Sierra Jensen 2985	APPROVING SUPERVISOR Smith, Damian J
--	---

Complete report details do not print in this format.



EDMONDS POLICE DEPARTMENT  
250 5th Ave N  
Edmonds, WA 98020  
(425) 771-0200

## Case Supplement Report

Case Report # 2017-00006212

## NARRATIVE

On March 19th, 2017 at approximately 1910 hours dispatch advised of a pedestrian vs train collision located at Hanes Warf Park 16121 75th PI W, Edmonds, Snohomish County, Washington. I arrived on scene and observed a body that had been covered with a blanket. There was a male subject that was crying and speaking with Officers. The male was later identified as Ryan Reed and was the victim's husband.

Due to the extensive injuries on the victim, Jade Reed, she was pronounced dead on scene and covered with a blanket for privacy. I began taking photos of the scene. I observed a gray right side boot located several feet south of the body. On the beach directly west of the right boot was the left side boot. Just north of the boot was a pair of broken glasses. West of the glasses in the rocks was a white hat. Close to other property located was what appeared to be a newer pack of cigarettes and fresh broken bottles of beer unknown if related.

All along the west side of the tracks in the rocks was body fluids that had been splattered across the rocks. South of the body was an unknown body part in between rocks. I took photos of all this evidence. Officer Bickar arrived on scene with two tents that I assisted with putting up for more privacy. Detectives, chaplains, and medical examiners were called to the scene. I stood by with the body on scene to make sure it was not disturbed. Detectives arrived on scene and began taking photos of evidence.

Detective Andy Mehl requested that I collect the left boot and hat that were in the rocks. I collected the items and placed them next to the other boot on scene. All evidence items were then collected and bagged by detectives. Medical examiners arrived on scene and uncovered the body to take photos. I assisted with keeping the privacy of the victim by holding a blanket blocking the view. As medical examiners examined the body I observed the victim was a blonde Caucasian female wearing a white sweater and pink Nike leggings. The victim was face down in the rocks. The victim had no shoes on. There was a large laceration along the left side of her body along her left hip that went from her stomach to the middle of her lower back. The laceration had a large opening and there were several organs spilling out of her side. Both of her hands appeared severally cut and broken. Her left leg appeared to have several fractures throughout the whole leg.

The victim's face had a large laceration down the center of her forehead down to her nose. There was a large approximately 3 inch opening exposing the inside of her head. As medical examiners and Officers moved the body I held a blanket for privacy. I then assisted with moving the body onto the gurney. I took photos of all evidence I observed at the scene and have submitted them into evidence at the Edmonds Police Department. Please refer to Officer Hwang's primary report for further information. This ends my involvement with this case. END

Officer Sierra J. Swartz EP#2985

This report was submitted from an electronic device owned, issued, or maintained by a law enforcement agency using my user ID and password. I certify or declare under penalty of perjury under the laws of the State of Washington that the foregoing is true and correct.

REPORTING OFFICER / ID # Swartz, Sierra Jensen 2985	APPROVING SUPERVISOR Smith, Damian J
LOCATION SIGNED Snohomish County, WA	DATE SIGNED 03/20/2017

This officer's narrative is complete when an approving supervisor's name is attached. Complete report details do not print in this format.  
EP Case Supplement 2017-00006212 Page 2 OF 2

EP Case, Officer: ep2952, Supervisor: ep0358, Merged By: ep2483

 <b>EDMONDS POLICE DEPARTMENT</b> 250 5th Ave N Edmonds, WA 98020 (425) 771-0200	<b>Initial Case Report</b>
	Case Report # <b>2017-00006212</b>

<b>EVENT</b>	OCCURRED INCIDENT TYPE <b>Death Investigation</b>	DATE/TIME REPORTED <b>3/19/2017 19:10</b>	ASSOCIATED CASES			
	LOCATION OF OCCURRENCE <b>16121 75TH PL W EDMONDS, WA 98026</b>	OCCURRED DATE/TIME <b>03/19/2017 19:00</b>				
		OCCURRED THROUGH <b>03/19/2017 19:10</b>				
<b>OFFENSES</b>	STATUTE / DESCRIPTION		Counts	Attempt/Commit		
<b>SUBJECT</b>	<input type="checkbox"/> NON-DISCLOSURE					
	SUBJECT TYPE <b>Deceased</b>	NAME <b>Adult / REED, JADE KAREN</b>	DOB / AGE RANGE <b>06/13/1975</b>			
	ADDRESS <b>18132 59TH PL W LYNNWOOD, WA 98037</b>		PRIMARY PHONE			
			SECONDARY PHONE			
	RACE <b>White</b>	SEX <b>Female</b>	HEIGHT <b>5' 7</b>	WEIGHT <b>140</b>	HAIR <b>BLN</b>	EYE <b>GRN</b>
	DL NUMBER <b>4b</b>	DL STATE <b>WA</b>	EMPLOYER			
	<input type="checkbox"/> NON-DISCLOSURE					
<b>SUBJECT</b>	SUBJECT TYPE <b>Witness</b>	NAME <b>Adult / REED, RYAN BARTLETT</b>	DOB / AGE RANGE <b>08/19/1979</b>			
	ADDRESS <b>18132 59TH PL W LYNNWOOD, WA 98037</b>		PRIMARY PHONE <b>(425)273-1895</b>			
			SECONDARY PHONE			
	RACE <b>White</b>	SEX <b>Male</b>	HEIGHT <b>5' 9</b>	WEIGHT <b>179</b>	HAIR <b>BLN</b>	EYE <b>BLU</b>
	DL NUMBER <b>4b</b>	DL STATE <b>WA</b>	EMPLOYER			
	<input type="checkbox"/> NON-DISCLOSURE					
	<b>VEHICLE</b>	PROPERTY CODE		YEAR	COLOR	
TYPE / MAKE / MODEL /						
PLATE		STATE	VIN	VALUE		
DESCRIPTION						
PROPERTY CODE						
<b>PROPERTY</b>	SERIAL NUMBER	QTY/UNIT OF MEASURE	VALUE	COLOR		
	TYPE / MAKE / MODEL /					
	DESCRIPTION					
	PROPERTY CODE					

REPORTING OFFICER / ID # <b>Hwang, Joshua 2952</b>	APPROVING SUPERVISOR <b>Jones, Jeff J</b>
---	--

Complete report details do not print in this format.

 <b>EDMONDS POLICE DEPARTMENT</b> 250 5th Ave N Edmonds, WA 98020 (425) 771-0200	<b>Initial Case Report</b>
	Case Report # <b>2017-00006212</b>

ADDITIONAL SUBJECTS							
SUBJECT	<input type="checkbox"/> NON-DISCLOSURE						
	SUBJECT TYPE	NAME			DOB / AGE RANGE		
	Witness	Adult / DRESSOR, MARK DANIEL			06/06/1960		
	ADDRESS				PRIMARY PHONE		
	187 S HOLGATE ST SEATTLE, WA 98134				(206)819-8446		
				SECONDARY PHONE			
RACE	SEX	HEIGHT	WEIGHT	HAIR	EYE		
White	Male	6' 0	240	GRY	BRO		
DL NUMBER	DL STATE		EMPLOYER				
4b	WA		AMTRAK				
SUBJECT	<input type="checkbox"/> NON-DISCLOSURE						
	SUBJECT TYPE	NAME			DOB / AGE RANGE		
	Witness	Adult / CONAHAN, SCOTT ANTHONY			05/06/1965		
	ADDRESS				PRIMARY PHONE		
	15927 75TH PL W EDMONDS, WA 98026				(425)356-7822		
				SECONDARY PHONE			
RACE	SEX	HEIGHT	WEIGHT	HAIR	EYE		
White	Male	5' 7	180		BLU		
DL NUMBER	DL STATE		EMPLOYER				
4b	WA						
SUBJECT	<input type="checkbox"/> NON-DISCLOSURE						
	SUBJECT TYPE	NAME			DOB / AGE RANGE		
	Witness	Adult / CONAHAN, HEIDI H			03/08/1964		
	ADDRESS				PRIMARY PHONE		
	15927 75TH PL W EDMONDS, WA 98026				(206)940-2029		
				SECONDARY PHONE			
RACE	SEX	HEIGHT	WEIGHT	HAIR	EYE		
White	Female	5' 4	122	BLN	HAZ		
DL NUMBER	DL STATE		EMPLOYER				
4b	WA						
SUBJECT	<input type="checkbox"/> NON-DISCLOSURE						
	SUBJECT TYPE	NAME			DOB / AGE RANGE		
	Other Involved	Adult / DRAWDY, LARRY EARL			04/05/1954		
	ADDRESS				PRIMARY PHONE		
	187 S HOLGATE ST SEATTLE, WA 98134				(206)819-8446		
				SECONDARY PHONE			
RACE	SEX	HEIGHT	WEIGHT	HAIR	EYE		
White	Male	6' 2	239	GRY	HAZ		
DL NUMBER	DL STATE		EMPLOYER				
4b	WA		AMTRAK				
SUBJECT	<input type="checkbox"/> NON-DISCLOSURE						
	SUBJECT TYPE	NAME			DOB / AGE RANGE		
	Other Involved	Adult / COLLINS, JOHN RICHARD			10/11/1961		
	ADDRESS				PRIMARY PHONE		
	187 S HOLGATE ST SEATTLE, WA 98134				(206)819-8446		
				SECONDARY PHONE			
RACE	SEX	HEIGHT	WEIGHT	HAIR	EYE		
White	Male	6' 0	220	GRY	BRO		
DL NUMBER	DL STATE		EMPLOYER				
4b	WA		AMTRAK				
REPORTING OFFICER / ID #			APPROVING SUPERVISOR				
Hwang, Joshua 2952			Jones, Jeff J				

Complete report details do not print in this format.

 <b>EDMONDS POLICE DEPARTMENT</b> 260 5th Ave N Edmonds, WA 98020 (425) 771-0200	<b>Initial Case Report</b>	
	Case Report # <b>2017-00006212</b>	

CASE VEHICLES				
<b>VEHICLES</b>	VEHICLE ROLE <b>Other Vehicle</b>	PLATE / STATE <b>BCB5166 / WA</b>	REG YEAR <b>2017</b>	VIN <b>2CNDL73F556007845</b>
	YEAR <b>2005</b>	TYPE / Automobile MAKE / Chevrolet MODEL / Equinox		
	STYLE <b>SUV (Sport Util Rugged Veh)</b>	TOP COLOR <b>Blue</b>	BOTTOM COLOR <b>Blue</b>	
	ADDITIONAL DESCRIPTION			
<b>VEHICLES</b>	VEHICLE ROLE	PLATE / STATE	REG YEAR	VIN
	YEAR	TYPE / MAKE / MODEL /		
	STYLE	TOP COLOR	BOTTOM COLOR	
	ADDITIONAL DESCRIPTION			

ADDITIONAL VEHICLES as PROPERTY				
<b>VEHICLE</b>	PROPERTY CODE	YEAR	COLOR	
	TYPE / MAKE /	MODEL /		
	PLATE	STATE	VIN	VALUE
	DESCRIPTION			
<b>VEHICLE</b>	PROPERTY CODE	YEAR	COLOR	
	TYPE / MAKE /	MODEL /		
	PLATE	STATE	VIN	VALUE
	DESCRIPTION			
<b>VEHICLE</b>	PROPERTY CODE	YEAR	COLOR	
	TYPE / MAKE /	MODEL /		
	PLATE	STATE	VIN	VALUE
	DESCRIPTION			
<b>VEHICLE</b>	PROPERTY CODE	YEAR	COLOR	
	TYPE / MAKE /	MODEL /		
	PLATE	STATE	VIN	VALUE
	DESCRIPTION			

REPORTING OFFICER / ID # <b>Hwang, Joshua</b> <b>2952</b>	APPROVING SUPERVISOR <b>Jones, Jeff J</b>
--	--

Complete report details do not print in this format.



**EDMONDS POLICE DEPARTMENT**  
250 5th Ave N  
Edmonds, WA 98020  
(425) 771-0200

## Initial Case Report

Case Report # 2017-00006212

## NARRATIVE

Snohomish County Medical Examiner's Office case #175N0469

Photographs, evidence

This incident occurred in the City of Edmonds, Snohomish County. At the time of this incident, the ambient lighting was daylight, nearing dusk.

On 03/19/2017, at approximately 1910 hours, I was dispatched to a report of a person who was hit by a train near Haines Wharf Park, located at 16121 75th Pl W, in the City of Edmonds, Snohomish County. The reporting party advised dispatch a female was hit by a train. Dispatch advised BNSF dispatch had all train travel on the train tracks halted.

I arrived on scene and contacted several people who pointed to the train tracks. I observed a gate in a fence separating the park with the train tracks. The gate was open approximately three to four feet. Based on my prior experience, I knew this gate typically had a lock locking the gate, accessible only by railway employees, fire crews, city crew, or police officers. There were several clearly visible signs that stated the property west of the gate was property of BNSF Railway and subjects found on the train tracks would be trespassing on BNSF Railway property. This included a sign on a free standing post that was approximately two to three feet directly west of the gate.

I was met at the gate by a male who I later verbally identified as Larry Drawdy. I later confirmed Drawdy's identity using DOL photograph records. Drawdy told me he was an employee of Amtrak National Railway Company and was working as the conductor onboard the Amtrak train involved in the incident. He stated he did not observe the collision but felt the train apply its emergency brakes suddenly. Drawdy stated once the train was stopped, he exited the train and found a female lying on the rock seawall to the west of the west train track, south of the stopped train. In this location, the train tracks consisted of two parallel running train tracks that ran north and southbound. Drawdy stated he contacted a male who he identified as the female's husband. I later identified this male verbally as Ryan Reed. I later confirmed Reed's identity using DOL photograph records.

I observed a female lodged between several large rocks on the rock seawall. I later identified the female as Jade Reed. From this point forward, Ryan and Jade Reed will be referred to by their first names because they share a common family name. Jade was face down between two rocks and appeared to have suffered multiple blunt force trauma injuries. I observed a large laceration on Jade's stomach and her internal organs were protruding out of the laceration and were exposed. I attempted to locate a pulse on Jade's neck and did not locate one. I attempted to locate a pulse on Jade's left wrist and did not locate one. I observed a bone protruding from a puncture wound on Jade's left wrist. Ryan was extremely distraught and threw himself on to Jade as he loudly cried out.

Cpl. Smith, the Edmonds PD night shift supervisor, and multiple other officers from Edmonds PD arrived on scene to assist.

This report was submitted from an electronic device owned, issued, or maintained by a law enforcement agency using my user ID and password. I certify or declare under penalty of perjury under the laws of the State of Washington that the foregoing is true and correct.

REPORTING OFFICER / ID # Hwang, Joshua 2952	APPROVING SUPERVISOR Jones, Jeff J
LOCATION SIGNED Snohomish County, WA	DATE SIGNED 03/19/2017

This officer's narrative is complete when an approving supervisor's name is attached. Complete report details do not print in this format.



 <b>EDMONDS POLICE DEPARTMENT</b> 250 5th Ave N Edmonds, WA 98020 (425) 771-0200	<b>Initial Case Report</b>
	Case Report # <b>2017-00006212</b>

**NARRATIVE (continuation)**

Ofc. Bickar (Edmonds PD) responded to the scene with several canopy barriers which were erected to shield the incident scene from onlookers, who were gathered on the street nearby. Ofc. Swartz (Edmonds PD) photographed the collision scene and Jade's body. Cpl. Smith contacted several witnesses who were nearby at the time of the incident. Cpl. Smith requested a chaplain be dispatched to the scene to assist. Chaplain Weslander was dispatched to assist. I requested the Snohomish County Medical Examiner's office be paged.

I contacted another male who I verbally identified as John Collins. I later confirmed Collins identity using DOL photograph records. Collins told me he was an employee of Amtrak and was working as the operational supervisor at the time of this incident. Collins told me he was onboard the train as it was traveling northbound heading to the City of Everett. He stated the train was mostly empty and had only crew members on board at the time of the incident. Collins told me the train was traveling to Everett to assist with passengers stranded by a mudslide and was enroute to pick up passengers in Everett. He stated he did not observe the collision.

Collins guided me to the train's engine to contact the engineer of the train. I entered the crew cabin of the train engine and contacted a male who I identified as Mark Dressor by his train operator license. Dressor stated he was the engineer of the train. Dressor stated he was the sole occupant of the crew cabin of the train's engine. He told me the train was traveling northbound on the west train track of two train tracks running parallel to each other and had just rounded a blind curve approximately one mile south of the incident location. Dressor told me the train was traveling at speeds typical for this portion of the train tracks. He stated he believed the train was travelling approximately 50 miles per hour as it rounded the curve. Dressor told me he observed a female on the east side of the train tracks running quickly from east to west across the tracks ahead of the train.

Dressor stated he believed the female was approximately fifty feet away from the front of the train as she attempted to cross the tracks. He stated he immediately activated the emergency brakes on the train. Dressor told me he could not say for certain where the female attempted to cross the train tracks. He stated the female appeared to be attempting to cross to the other side of the train tracks. Dressor told me the train eventually came to a stop once the emergency brakes were activated. He advised me the train had video recording that would be made available to me. Dressor told me that the train's headlights were activated as the train was traveling. Dressor told me, per his company's recommendation, he would not complete a written statement. Dressor provided me with Amtrak Railway Police Detective Steve Travers' phone number (206-819-8446) for contact.

I photographed the front of the train and the portions of the front train guard and fiberglass body that appeared to have struck Jade. I later submitted my photographs to evidence. The front west portion of the train as it was oriented northbound had residual unknown body and blood matter splattered on portions of the front coupling device, the front guard, and the fiberglass body directly above the guard. I observed additional blood and unknown body matter on the engineer's ladder located on west portion

This report was submitted from an electronic device owned, issued, or maintained by a law enforcement agency using my user ID and password. I certify or declare under penalty of perjury under the laws of the State of Washington that the foregoing is true and correct.

REPORTING OFFICER / ID # Hwang, Joshua 2952	APPROVING SUPERVISOR Jones, Jeff J
LOCATION SIGNED Snohomish County, WA	DATE SIGNED 03/19/2017

This officer's narrative is complete when an approving supervisor's name is attached. Complete report details do not print in this format.



**EDMONDS POLICE DEPARTMENT**  
250 5th Ave N  
Edmonds, WA 98020  
(425) 771-0200

**Initial Case Report**

Case Report # **2017-00006212**

**NARRATIVE (continuation)**

of the front of the engine.

Collins advised me he contacted Det. Travers by phone and I spoke with him on Collins' cell phone. Det. Travers advised me he was not in the area to respond to the scene and a BNSF Police officer would be dispatched to assist in the investigation. Det. Travers did not have an Amtrak Police case number available at the time of the call. Det. Travers advised me the video from the train would be made available tomorrow; however, Amtrak was unable to provide a copy of the video on a digital media disk or thumbdrive and the viewing officer would have to document the video using the department issued camera.

Collins advised me he discovered a cell phone in a pink case lodged behind some tubing at the front of the train engine. I photographed the cell phone and collected it. Collins told me he believed the cell phone belonged to Jade and it was common for personal belongings from persons hit by trains to end up lodged in the front of the train. I later submitted the cell phone into evidence.

Collins told me the train was comprised of the train engine and five attached train cars. He stated the train was occupied by the train engineer, Dressor, the train conductor, Drawdy, himself, and six other Amtrak employees. Collins told me the six other Amtrak employees did not witness the collision. Collins and Drawdy agreed to write written statements, which I later collected and attached to this report.

I contacted BNSF Police Ofc. Alonzo Bacon who arrived on scene to assist in the investigation. Ofc. Bacon advised he would be the point of contact for BNSF and for Amtrak for the remainder of the incident and Det. Travers would be the point of contact for follow up investigation with Amtrak Police.

I contacted Ryan, who at the time was still extremely distraught. I detected the strong odor of intoxicants coming from Ryan. While on the train tracks, I observed a freshly broken glass bottle of beer near the collision location. Ryan stated he and Jade were a married couple. He told me he and Jade recently had engagement photographs taken; however, the photographs were accidentally deleted. Ryan stated he and Jade decided to go to Haines Wharf Park at sunset to attempt to recreate the engagement photographs. He told me he and Jade went past the fenced and signed area on the east side of the train tracks where he stopped to "take a piss." Ryan stated he turned his back to Jade and turned back as the train was approaching and could not see his wife. He told me he located Jade on the west side of the train tracks and "tried to put her together, but I knew that wouldn't help. She was gone."

Ryan's vehicle, a blue Chevrolet Equinox SUV with license WA/BCB5166 was parked in the street parking area of Haines Wharf Park.

Det. Sgt. Richardson (Edmonds PD) and Det. Mehl (Edmonds PD) arrived on scene to investigate.

This report was submitted from an electronic device owned, issued, or maintained by a law enforcement agency using my user ID and password. I certify or declare under penalty of perjury under the laws of the State of Washington that the foregoing is true and correct.

REPORTING OFFICER / ID # Hwang, Joshua 2952	APPROVING SUPERVISOR Jones, Jeff J
LOCATION SIGNED Snohomish County, WA	DATE SIGNED 03/19/2017

This officer's narrative is complete when an approving supervisor's name is attached. Complete report details do not print in this format.

 <b>EDMONDS POLICE DEPARTMENT</b> 250 5th Ave N Edmonds, WA 98020 (425) 771-0200	<b>Initial Case Report</b>
	Case Report # <b>2017-00006212</b>

**NARRATIVE (continuation)**

Cpl. Smith advised me he contacted two subjects who were in the area at the time of the incident. He told me the subjects, who he identified as Scott Conahan and Heidi Conahan, were a married couple. From this point forward, Scott and Heidi Conahan will be referred to by their first names because they share a common family name.

Cpl. Smith told me Scott told him he saw the train approaching and heard the train air horn activate for a long period. Cpl. Smith told me Scott told him he thought that was unusual because there was no road intersection in that area of the train tracks and it was uncommon for trains to activate their horn as they passed through. Cpl. Smith told me Scott told him he heard a thud and observed a bright, multicolored object cartwheeling through the air. Cpl. Smith told me Heidi told him she heard the train brakes activating and heard a loud thud shortly after. Scott and Heidi agreed to provide written statements, which I later collected and attached to this report.

Cpl. Smith and I took approximate measurements at the scene. Since we did not have an exact location of impact, we used a water access pipe labeled "Auto SPKR" located just south of the gate as our starting location. All distances measured were an approximation due to the uneven surface of the railroad tracks that made measuring exact distances difficult. I completed a field sketch that was not drawn to scale with the measurements included. I later attached the field sketch to this report.

From the water access pipe and measuring north, I measured approximately 67.8 feet to the location of a woman's shoe discovered west of the railroad tracks, next to a concrete retaining block. From the water access pipe, I measured approximately 83.10 feet to a pair of destroyed gold or silver framed glasses, possibly sunglasses, on the west side of the tracks. From the water access pipe, I measured approximately 102.7 feet to a splatter of unknown biological matter that was spread in a northwestern direction on the west side of the tracks. From the water access pipe, I measured approximately 116.1 feet to additional splattering of unknown biological matter on the west side of the tracks. From the water access pipe, I measured approximately 142.11 feet to the location of Jade's body located on the rock seawall west of the train tracks. From the water access pipe, I measured 307.8 feet to the rear train coupling device. Due to the uneven terrain north of the train tracks, I was unable to measure the distance to the front of the train.

Jaclyn Meserole and Lauren Alvarez of the Snohomish Medical Examiner's Office arrived on scene and conducted an investigation. Meserole advised me she would take custody of Jade's body and provided me with a case number for the medical examiner's office.

Once all investigations were completed, the Amtrak train left the scene. I, along with several other officers, assisted Meserole in moving Jade's body off the rock seawall to the medical examiner's vehicle.

Chaplain Weslander assisted in transporting Ryan back to Jade's mother's house in the City of Lynnwood, where Ryan lived with Jade in order to notify Jade's mother of Jade's death. Ofc. Bacon

This report was submitted from an electronic device owned, issued, or maintained by a law enforcement agency using my user ID and password. I certify or declare under penalty of perjury under the laws of the State of Washington that the foregoing is true and correct.

REPORTING OFFICER / ID # <b>Hwang, Joshua</b> 2952	APPROVING SUPERVISOR <b>Jones, Jeff J</b>
LOCATION SIGNED <b>Snohomish County, WA</b>	DATE SIGNED <b>03/19/2017</b>

This officer's narrative is complete when an approving supervisor's name is attached. Complete report details do not print in this format.

 <b>EDMONDS POLICE DEPARTMENT</b> 250 5th Ave N Edmonds, WA 98020 (425) 771-0200	<b>Initial Case Report</b>
	Case Report # <b>2017-00006212</b>

**NARRATIVE (continuation)**

then advised BNSF dispatch center that the train tracks were clear.

Through my investigation, based on witness statements and the evidence present at the scene, I determined the incident was likely an accidental collision between Jade and the Amtrak train and was not the result of a suicide or intentional criminal activity. I will follow up with further investigation by contacting Amtrak to review the train's video footage. Based on conjecture, I believed alcohol may have been a factor in the collision.

No further information.

END

Officer Josh Y. Hwang #2952

This report was submitted from an electronic device owned, issued, or maintained by a law enforcement agency using my user ID and password. I certify or declare under penalty of perjury under the laws of the State of Washington that the foregoing is true and correct.

<b>REPORTING OFFICER / ID #</b> Hwang, Joshua 2952	<b>APPROVING SUPERVISOR</b> Jones, Jeff J
<b>LOCATION SIGNED</b> Snohomish County, WA	<b>DATE SIGNED</b> 03/19/2017

This officer's narrative is complete when an approving supervisor's name is attached. Complete report details do not print in this format.

 <p><b>EDMONDS POLICE DEPARTMENT</b> 250 5th Ave N Edmonds, WA 98020 (425) 771-0200</p>	<p><b>Case Supplement Report</b></p> <p>Case Report # <b>2017-00006212</b></p>
--	--

DATE/TIME REPORTED	3/19/2017	19:09
--------------------	-----------	-------

	STATUTE / DESCRIPTION	Counts	Attempt/Commit
OFFENSES			

	<input type="checkbox"/> NON-DISCLOSURE					
SUBJECT	SUBJECT TYPE	NAME	DOB / AGE RANGE			
	ADDRESS				PRIMARY PHONE	
					SECONDARY PHONE	
	RACE	SEX	HEIGHT	WEIGHT	HAIR	EYE
	DL NUMBER	DL STATE	EMPLOYER			

	<input type="checkbox"/> NON-DISCLOSURE					
SUBJECT	SUBJECT TYPE	NAME	DOB / AGE RANGE			
	ADDRESS				PRIMARY PHONE	
					SECONDARY PHONE	
	RACE	SEX	HEIGHT	WEIGHT	HAIR	EYE
	DL NUMBER	DL STATE	EMPLOYER			

	PROPERTY CODE	YEAR	COLOR
VEHICLE	TYPE / MAKE / MODEL /		
	PLATE	STATE	VALUE
	VIN		
	DESCRIPTION		

	PROPERTY CODE		
PROPERTY	SERIAL NUMBER	QTY/UNIT OF MEASURE	VALUE
	COLOR		
	TYPE / MAKE / MODEL /		
	DESCRIPTION		

REPORTING OFFICER / ID # <b>Smith, Damian J</b> <b>2230</b>	APPROVING SUPERVISOR <b>Smith, Damian J</b>
--	--

Complete report details do not print in this format.



**EDMONDS POLICE DEPARTMENT**  
250 5th Ave N  
Edmonds, WA 98020  
(425) 771-0200

**Case Supplement Report**

Case Report # **2017-00006212**

**NARRATIVE**

On 03/19/17 at about 1911 hrs, I responded to assist Ofc Hwang with a request to assist the fire department at Haines Wharf (aka Meadowdale Marina) located in the 16100 blk of 76th Pl W, City of Edmonds, County of Snohomish. While enroute to the location, dispatch advised that there had been more than 1 caller from the area indicating a person had possibly been struck by a train which was now stopped. Additional callers indicated the subject was possibly a female and that her boyfriend was with her. The female that was struck was stuck in some rocks and did not appear to be breathing.

At the time of this incident, the weather was dry and partly cloudy. It was still daylight outside and the weather was approximately 45-50 degrees.

Meadowdale Marina is a dilapidated and unused dock (with structure) along the City of Edmonds Puget sound coast. A dual set of north/south railroad tracks run parallel to the shoreline and separate the dock and an old access road off of 76th Pl W. The access road is further blocked with an approximately 8' chain link fence and vehicle gate normally blocking pedestrian and vehicle access. The gate is marked with at least 3 no-trespassing signs for the railroad tracks. The railroad tracks are raised above the coastline via large jagged boulders which the water reaches depending on the tide level. At the time of this incident, the tide was noticeably out and exposing 20 or more feet in areas allowing persons to walk along the exposed beach.

Ofc Hwang was first to arrive and advised that the subject in question appeared to already be deceased.

Based upon the dispatched information, I requested a chaplain be paged and asked Ofc Bickar to respond with appropriate canopies and shielding from the police station to aid in a possible open air scene. Dispatch pre-emptively notified Edmonds PIO, Sgt Hawley.

I arrived on scene at about 1916 hrs and could see several pedestrians standing along the Haines Wharf park overlook on 75th Pl W. I parked my patrol vehicle down near Meadowdale Marina and accessed the railroad tracks via the open and unsecured vehicle gate. Upon entering the railroad tracks area, I noted two stopped trains on the tracks. The first was a northbound Amtrak train no more than 5-6 cars in length that was stopped approximately 150-200 yards north of Meadowdale Marina along the west tracks. The second train was an unknown length northbound train that was stopped approximately 400 yards south of Meadowdale Marina along the east tracks. I later learned that the second train was a BNSF train and was not involved in this incident; it had stopped short of the incident due personnel being on the tracks.

I noted several persons to include Ofc Hwang just north of the marina by about 50 yards. Upon approach, I observed what appeared to be a female with gray or blond hair lying contorted face down among the large boulders. A large melon shaped mass of what looked like intestines were visible from the subject's side. There was no movement and Ofc Hwang indicated that he checked for a pulse and found none. The female was mostly covered with white and blue blankets that were reportedly put in place by Amtrak employees.

A white male subject was near the female and identified himself verbally as Ryan, the woman's husband. Ryan's identity was later confirmed to be Ryan Reed by his Washington State issued ID card (1922 hrs). Ryan stated that the female lying in the rocks was his wife Jade. Jade was later determined to be D1/Jade Reed by Ofc Hwang. Both will be referred to by their first names from this point forward due to the shared last name.

This report was submitted from an electronic device owned, issued, or maintained by a law enforcement agency using my user ID and password. I certify or declare under penalty of perjury under the laws of the State of Washington that the foregoing is true and correct.

<b>REPORTING OFFICER / ID #</b> Smith, Damian J    2230	<b>APPROVING SUPERVISOR</b> Smith, Damian J
<b>LOCATION SIGNED</b> Snohomish County, WA	<b>DATE SIGNED</b> 03/21/2017



**EDMONDS POLICE DEPARTMENT**  
250 5th Ave N  
Edmonds, WA 98020  
(425) 771-0200

## Case Supplement Report

Case Report # 2017-00006212

### NARRATIVE (continuation)

Ryan was consistently crying and was visibly shaking. He smelled of alcohol as I briefly spoke to him but I did not question him about the incident at the time as I focused on his welfare. Ryan abruptly approached his wife and I did not stop him. I aided in consoling him as he placed his hand on her back, rubbed gently and cried. I did not prevent Ryan from his grieving and remained with him while also ensuring he did not disturb his wife's position or the immediate scene.

Ryan denied being injured and initially refused to be seen by the aid crew that had arrived on scene. I spoke to him about the investigative process that would take place and encouraged him to walk to the aid crew's vehicle to be evaluated. In trade, I advised him that I would not make him leave the area and would do my best to allow him to say final goodbyes upon the medical examiner's conclusion. Ryan agreed and the aid crew escorted him to their vehicle for evaluation. The chaplain arrived shortly afterwards and assisted with caring for Ryan.

Ofc Swartz arrived on scene and was directed to take initial scene photos while lighting still existed. After taking photographs, Ofc Swartz remained at Jade's location to maintain control over her body pending the medical examiner's arrival.

I followed up with PIO Sgt Hawley via telephone and made command notifications to ACOP Lawless and Det Sgt Richardson who advised that members from the detective division would be responding.

Amtrak employee Larry Drawdy was standing on the railroad tracks near Jade's position so I briefly spoke with him. Drawdy stated he served as the passenger conductor and was sitting in one of the cars when the incident took place. He stated he did not see anything and only heard/felt the brakes. I learned from Drawdy and another employee (John Collins - Operations Supervisor) that the train did not contain any passengers due to a mud slide that had occurred south of Edmonds. The train had been en-route to Everett to pick up passengers when the incident occurred. Drawdy and Collins only identified themselves and the Engineer who was operating the train (still on board) as the persons present at the time. Collins stated that he also did not witness the incident as he had been in the dining car at the time. Drawdy and Collins agreed to provide written statements and were provided statement forms.

Officers Bickar and Haughian arrived and assisted with setting up canopies to help shield the scene from public view.

Several onlookers were standing in front of 16106 76th Pl W which was just above the scene. I made contact with the group and learned that two of them had witnessed the incident. W/Scott Canahan and his wife W/Heidi Conahan stated they had been just north of the incident location walking southbound along the exposed beach below the raised railroad tracks. Neither observed the train actually strike Jade however Scott stated he saw the northbound train and heard the horn. He then observed a multicolored object that he believed to be a person launched through the air. Heidi only heard a "thud". After the train stopped, Scott ran to Jade's location where a male (Ryan) had already arrived and was sitting and crying next to her. Amtrak employees approached and began placing blankets over Jade's body. Scott then returned to his wife's location and discouraged her from approaching. While speaking with Scott, he mentioned that the lock securing Meadowdale Marina vehicle gate had been missing for some time and the gate had been open. I provided Scott and Heidi statement forms which they completed and were collected by other assisting officers.

This report was submitted from an electronic device owned, issued, or maintained by a law enforcement agency using my user ID and password. I certify or declare under penalty of perjury under the laws of the State of Washington that the foregoing is true and correct.

REPORTING OFFICER / ID # <b>Smith, Damian J</b> 2230	APPROVING SUPERVISOR <b>Smith, Damian J</b>
LOCATION SIGNED <b>Snohomish County, WA</b>	DATE SIGNED <b>03/21/2017</b>

This officer's narrative is complete when an approving supervisor's name is attached. Complete report details do not print in this format.



**EDMONDS POLICE DEPARTMENT**  
250 5th Ave N  
Edmonds, WA 98020  
(425) 771-0200

### Case Supplement Report

Case Report # 2017-00006212

#### NARRATIVE (continuation)

I received a request to telephone Amtrak Det Travers (206-819-8446) and briefly spoke to him. Det Travers advised he was out of state on business and that BNSF representatives would be assisting on his behalf. BNSF Greg Beam (claims representative) arrived and introduced himself to me. He advised he would be taking photographs and measurements at the scene. I did not escort him at the scene but did not see him or any other railroad representatives approach or disturb Jade's position.

Officers Haughian and Bickar conducted a brief area search for related material and/or debris along the tracks and beach before leaving the scene. Several items to include shoes, glasses and apparent body fluids and material were noted and flagged with paper for photographing and measuring.

I briefly inquired with Ryan as to whether or not Jade had been wearing glasses. He seemed unsure but believed she had been wearing her contacts. He stated she did have some gold framed aviator style sunglasses which matched the frame color of the glasses frame noted along the tracks (they were missing the lenses) but he did not know if she was actively wearing them at the time. While speaking with Ryan, I asked how he and Jade accessed the railroad tracks area and he stated the vehicle gate had been unlocked and open.

I assisted Ofc Hwang with conducting rough measurements along the track of the approximate location of items noted. The baseline was established from an apparent water main access pipe just south of the marina. All measurements were approximate due to difficulties obtaining accurate measurements along the rough tracks with a small wheeled tape roller. See Ofc Hwang's statement and field sketch for details.

2032 hrs. Representatives from the Snohomish County Medical Examiner's office arrived, were briefed and initiated their investigation.

2035 hrs. Edmonds Det Mehl arrived on scene and was briefed. Det Sgt Richardson arrived shortly afterwards.

I remained on scene in an assistance role while the medical examiner and EPD detectives conducted their investigations. I assisted with shielding the scene while the ME and officers collected Jade and prepared her for transport. Just prior to placing her in the ME's vehicle, Ryan was allowed to approach and say final goodbyes.

Ryan advised that he and Jade were currently living with Jade's adoptive mother in Lynnwood. He requested the chaplain's presence for returning home and making notification to her. I offered an Edmonds officer to also respond but he declined and thanked me for all that we had done. The chaplain drove Ryan from the scene and an assistant accompanying the chaplain drove Ryan's vehicle back to his residence with his permission.

I assisted with final scene cleanup and then cleared. No further information at this time. END

Cpl Damian Smith / #2230

This report was submitted from an electronic device owned, issued, or maintained by a law enforcement agency using my user ID and password. I certify or declare under penalty of perjury under the laws of the State of Washington that the foregoing is true and correct.

REPORTING OFFICER / ID # Smith, Damian J 2230	APPROVING SUPERVISOR Smith, Damian J
LOCATION SIGNED Snohomish County, WA	DATE SIGNED 03/21/2017

This officer's narrative is complete when an approving supervisor's name is attached. Complete report details do not print in this format



 <p><b>EDMONDS POLICE DEPARTMENT</b> 250 5th Ave N Edmonds, WA 98020 (425) 771-0200</p>	<b>Case Supplement Report</b>
	Case Report # <b>2017-00006212</b>

DATE/TIME REPORTED	03/19/2017 19:10
--------------------	------------------

OFFENSES	STATUTE / DESCRIPTION	Counts	Attempt/Commit																				
SUBJECT	<input type="checkbox"/> NON-DISCLOSURE <table border="1" style="width:100%; border-collapse: collapse;"> <tr> <td style="width:20%;">SUBJECT TYPE</td> <td style="width:40%;">NAME</td> <td colspan="2">DOB / AGE RANGE</td> </tr> <tr> <td colspan="2">ADDRESS</td> <td colspan="2">PRIMARY PHONE</td> </tr> <tr> <td colspan="2"></td> <td colspan="2">SECONDARY PHONE</td> </tr> <tr> <td>RACE</td> <td>SEX</td> <td>HEIGHT</td> <td>WEIGHT HAIR EYE</td> </tr> <tr> <td>DL NUMBER</td> <td>DL STATE</td> <td colspan="2">EMPLOYER</td> </tr> </table>			SUBJECT TYPE	NAME	DOB / AGE RANGE		ADDRESS		PRIMARY PHONE				SECONDARY PHONE		RACE	SEX	HEIGHT	WEIGHT HAIR EYE	DL NUMBER	DL STATE	EMPLOYER	
SUBJECT TYPE	NAME	DOB / AGE RANGE																					
ADDRESS		PRIMARY PHONE																					
		SECONDARY PHONE																					
RACE	SEX	HEIGHT	WEIGHT HAIR EYE																				
DL NUMBER	DL STATE	EMPLOYER																					
SUBJECT	<input type="checkbox"/> NON-DISCLOSURE <table border="1" style="width:100%; border-collapse: collapse;"> <tr> <td style="width:20%;">SUBJECT TYPE</td> <td style="width:40%;">NAME</td> <td colspan="2">DOB / AGE RANGE</td> </tr> <tr> <td colspan="2">ADDRESS</td> <td colspan="2">PRIMARY PHONE</td> </tr> <tr> <td colspan="2"></td> <td colspan="2">SECONDARY PHONE</td> </tr> <tr> <td>RACE</td> <td>SEX</td> <td>HEIGHT</td> <td>WEIGHT HAIR EYE</td> </tr> <tr> <td>DL NUMBER</td> <td>DL STATE</td> <td colspan="2">EMPLOYER</td> </tr> </table>			SUBJECT TYPE	NAME	DOB / AGE RANGE		ADDRESS		PRIMARY PHONE				SECONDARY PHONE		RACE	SEX	HEIGHT	WEIGHT HAIR EYE	DL NUMBER	DL STATE	EMPLOYER	
SUBJECT TYPE	NAME	DOB / AGE RANGE																					
ADDRESS		PRIMARY PHONE																					
		SECONDARY PHONE																					
RACE	SEX	HEIGHT	WEIGHT HAIR EYE																				
DL NUMBER	DL STATE	EMPLOYER																					
VEHICLE	<table border="1" style="width:100%; border-collapse: collapse;"> <tr> <td style="width:50%;">PROPERTY CODE</td> <td style="width:20%;">YEAR</td> <td style="width:30%;">COLOR</td> </tr> <tr> <td colspan="3">TYPE / MAKE / MODEL /</td> </tr> <tr> <td>PLATE</td> <td>STATE</td> <td>VIN</td> </tr> <tr> <td colspan="2"></td> <td>VALUE</td> </tr> <tr> <td colspan="3">DESCRIPTION</td> </tr> </table>			PROPERTY CODE	YEAR	COLOR	TYPE / MAKE / MODEL /			PLATE	STATE	VIN			VALUE	DESCRIPTION							
PROPERTY CODE	YEAR	COLOR																					
TYPE / MAKE / MODEL /																							
PLATE	STATE	VIN																					
		VALUE																					
DESCRIPTION																							
PROPERTY	<table border="1" style="width:100%; border-collapse: collapse;"> <tr> <td colspan="4">PROPERTY CODE</td> </tr> <tr> <td style="width:25%;">SERIAL NUMBER</td> <td style="width:25%;">QTY/UNIT OF MEASURE</td> <td style="width:25%;">VALUE</td> <td style="width:25%;">COLOR</td> </tr> <tr> <td colspan="4">TYPE / MAKE / MODEL /</td> </tr> <tr> <td colspan="4">DESCRIPTION</td> </tr> </table>			PROPERTY CODE				SERIAL NUMBER	QTY/UNIT OF MEASURE	VALUE	COLOR	TYPE / MAKE / MODEL /				DESCRIPTION							
PROPERTY CODE																							
SERIAL NUMBER	QTY/UNIT OF MEASURE	VALUE	COLOR																				
TYPE / MAKE / MODEL /																							
DESCRIPTION																							

REPORTING OFFICER / ID #	APPROVING SUPERVISOR
Bickar, Nicholas L 2832	Jones, Jeff J

Complete report details do not print in this format.



**EDMONDS POLICE DEPARTMENT**  
 250 5th Ave N  
 Edmonds, WA 98020  
 (425) 771-0200

**Case Supplement Report**

Case Report # **2017-00006212**

**NARRATIVE**

I responded to this call as an assisting officer. I transported portable tents/shelter to the scene to preserve the scene. After setting up the shelters I walked the beach and rocks to the west of the deceased to search for items that may have been hers. I located a boot that matched another boot found near her and a white hat (unknown if hers). I pointed both items out to Officer Swartz who photographed the items. I had no further involvement in the case.

End.

Officer Nicholas Bickar #2832

This report was submitted from an electronic device owned, issued, or maintained by a law enforcement agency using my user ID and password. I certify or declare under penalty of perjury under the laws of the State of Washington that the foregoing is true and correct.

REPORTING OFFICER / ID # <b>Bickar, Nicholas L</b>	<b>2832</b>	APPROVING SUPERVISOR <b>Jones, Jeff J</b>	
LOCATION SIGNED <b>Snohomish County, WA</b>		DATE SIGNED <b>03/20/2017</b>	

This officer's narrative is complete when an approving supervisor's name is attached. Complete report details do not print in this format.

STATE OF WASHINGTON  
DEPARTMENT OF HEALTH



CERTIFICATE OF DEATH



CERTIFICATE NUMBER: 2017-013499

LOCAL FILE NUMBER: 1297

DATE ISSUED: 06/15/2017

FEE NUMBER: 66487090

FIRST AND MIDDLE NAME(S): JADE KAREN  
LAST NAME(S): REED

COUNTY OF DEATH: SNOHOMISH  
DATE OF DEATH: MARCH 19, 2017  
HOUR OF DEATH: 07:10 PM  
SEX: FEMALE AGE: 41 YEARS  
SOCIAL SECURITY NUMBER: 4b

HISPANIC ORIGIN: NO, NOT SPANISH/HISPANIC/LATINO  
RACE: WHITE

BIRTH DATE: JUNE 13, 1975  
BIRTHPLACE: SEATTLE, WASHINGTON

MARITAL STATUS: MARRIED  
SPOUSE: RYAN BARTLETT REED

OCCUPATION: SERVICE INDUSTRY  
INDUSTRY: COUNTRY CLUB  
EDUCATION: SOME COLLEGE CREDIT, BUT NO DEGREE  
US ARMED FORCES: NO

INFORMANT: RYAN B REED  
RELATIONSHIP: HUSBAND  
ADDRESS: 18132 59TH PLACE W LYNNWOOD, WA 98037

CAUSE OF DEATH:

A: MULTIPLE BLUNT FORCE TRAUMA TO THE HEAD, TRUNK, AND EXTREMITIES

INTERVAL: IMMEDIATE

B:

INTERVAL:

C:

INTERVAL:

D:

INTERVAL:

OTHER CONDITIONS CONTRIBUTING TO DEATH:

DATE OF INJURY: MARCH 19, 2017  
HOUR OF INJURY: 07:10 PM  
INJURY AT WORK: NO  
PLACE OF INJURY: RAILROAD

LOCATION OF INJURY: 16121 75TH PL W

CITY, STATE, ZIP: EDMONDS, WASHINGTON 98026  
COUNTY: SNOHOMISH  
DESCRIBE HOW INJURY OCCURRED:  
PEDESTRIAN STRUCK BY TRAIN.

IF TRANSPORTATION INJURY, SPECIFY: NOT APPLICABLE

PLACE OF DEATH: OTHER PLACE  
FACILITY OR ADDRESS: 16121 75TH PL W  
CITY, STATE, ZIP: EDMONDS, WASHINGTON 98026

RESIDENCE STREET: 18132 59TH PL W  
CITY, STATE, ZIP: LYNNWOOD, WASHINGTON 98037  
INSIDE CITY LIMITS: YES COUNTY: SNOHOMISH  
TRIBAL RESERVATION: NOT APPLICABLE  
LENGTH OF TIME AT RESIDENCE: 40 YEARS

FATHER/PARENT: WILLIAM GRIFFITHS  
MOTHER/PARENT: JOAN PEGGY GIMBLE

METHOD OF DISPOSITION: CREMATION  
PLACE OF DISPOSITION: NW PREFERRED CREMATORY

CITY, STATE: MOUNTLAKE TERRACE, WASHINGTON  
DISPOSITION DATE: MARCH 23, 2017

FUNERAL FACILITY: BECK'S TRIBUTE CENTER

ADDRESS: 405 5TH AVENUE S.  
CITY, STATE, ZIP: EDMONDS, WASHINGTON 98020  
FUNERAL DIRECTOR: CRAIG A. NELSON

MANNER OF DEATH: ACCIDENT

AUTOPSY: YES

WERE AUTOPSY FINDINGS AVAILABLE TO COMPLETE

CAUSE OF DEATH: YES

DID TOBACCO USE CONTRIBUTE TO DEATH: NO

PREGNANCY STATUS IF FEMALE: NOT PREGNANT WITHIN THE PAST YEAR

CERTIFIER NAME: DANIEL M. SELOVE, MD  
TITLE: CORONER/ME

CERTIFIER ADDRESS: 9509 29TH AVENUE WEST  
CITY, STATE, ZIP: EVERETT, WA 98204  
DATE SIGNED: MARCH 21, 2017

CASE REFERRED TO ME/CORONER: YES  
FILE NUMBER: SCME 17SN0469  
ATTENDING PHYSICIAN: NOT APPLICABLE

LOCAL DEPUTY REGISTRAR: MARTHA RUIZ  
DATE RECEIVED: MARCH 22, 2017



# Affidavit for Correction

Mail to: Center for Health Statistics  
P.O. Box 47814  
Olympia, WA 98504-7814  
360-236-4300

This is a legal document. Complete in ink and do not alter.

## STATE OFFICE USE ONLY

State File Number	Fee Number	Initials	Date	Affidavit Number
-------------------	------------	----------	------	------------------

### Required information must match current information on record

<b>Required</b>	Record Type: <input type="checkbox"/> Birth <input type="checkbox"/> Death <input type="checkbox"/> Marriage <input type="checkbox"/> Dissolution (Divorce)				
	1. Name on Record: First Middle Last			2. Date of Event: MM/DD/YYYY	3. Place of Event: City or County
	4. Father/Parent Full Legal Name (Spouse A for Marriage or Dissolution) First Middle Last/Maiden			5. Mother/Parent Full Birth Name (Spouse B for Marriage or Dissolution) First Middle Last/Maiden	
	6. Name of Person Requesting Correction: Relationship to Person on Record: <input type="checkbox"/> Self <input type="checkbox"/> Guardian <input type="checkbox"/> Informant <input type="checkbox"/> Hospital <input type="checkbox"/> Parent(s) <input type="checkbox"/> Funeral Director <input type="checkbox"/> Other (specify)				

7. Return Mailing Address:  
P.O. Box or Street Address City State Zip

Telephone Number: ( ) Email Address:

### Use the section below for requesting any changes on the record. The record is incorrect or incomplete as follows:

The record now shows:	The true fact is:
8.	9.
10.	11.
12.	13.
14.	15.

### I declare under penalty of perjury under the laws of the State of Washington that the forgoing is true and correct

16a. Signature: 16b. Signature of 2<sup>nd</sup> parent (if required):

Printed name: Date: Printed name: Date:

### INSTRUCTIONS – go to [www.doh.wa.gov](http://www.doh.wa.gov) for more information

#### Driver's license, Social Security card or hospital decorative birth certificate cannot be used as proof

Required documentary proof must be submitted with the affidavit and include full name and birth date. Examples of documentary proof include:

- Birth/Marriage/Divorce record
- Military record (DD-214)
- School transcripts
- Social Security Numident Report
- Certificate of Naturalization
- Hospital/medical record
- Passport
- Green/Permanent Resident card (I-551)

#### Birth Certificates

1. Only a parent(s), legal guardian (if the child is under 18), or the named individual (if 18 or older) may change the birth certificate.
2. The proof(s) must match the asserted fact(s). For example, if the affidavit says the name should be Mary Ann Doe, the proof must show the name to be Mary Ann Doe.
3. Documentary proof must be five or more years old or established within five years of birth.

#### Child under 18

- If legal guardian(s), include certified court order proving guardianship
- Up to age one, last name can be changed once to either parents' name on certificate (can be any combination of the first, middle or last names)\*
- After age one, a court order is required to change the last name
- No proof is required to change the first or middle name\*
- To correct parent's information, one documentary proof is required.
- To correct the sex of the child, one documentary proof from a medical provider is required

#### Adult (18 years or older)

- Only the adult can change his or her birth certificate
- If the first or middle name is missing, three pieces of documentary proof are required
- If the first, middle and/or last name is misspelled, or date of birth is incorrect, two pieces of documentary proof are required
- To correct parent's birth date, place of birth, or name, one documentary proof is required

\*To change any part of the name of a child, signatures from both parents listed on the certificate are required. If one parent is deceased, submit a death certificate with request.

### This affidavit cannot be used to add a father to a birth certificate (use paternity acknowledgment form DOH 422-032)

#### Death Certificates

1. Only the informant, the funeral director, or executors/administrators (if evidence confirming such position is presented) may change the non-medical information. Proof is required to make changes if requested by a family member not listed as the informant on the certificate (family members are spouse or registered domestic partner, parent, sibling or adult child or stepchild). The informant may change marital status with proof. Marital status requires a certified copy of a court order if someone other than the informant is requesting the change.
2. The medical information (cause of death) may be changed only by the certifying physician or the coroner/medical examiner.

#### Marriage/Dissolution (Divorce) Certificates

1. Personal facts (minor spelling changes in name, date or place of birth or residence) may be changed by the person with one piece of documentary proof.
2. To change the date or place of marriage or dissolution, the officiant (marriage) or clerk of court (dissolution) must complete and submit the affidavit.

DOH 422-034 October 2015



Certificate not valid unless the Seal of the State of Washington changes color when heat applied.



0 1 3 6 8 5 4 3