

# Rail Accident Inspection Form

*Ok to close  
 K Johnson  
 10-12-17*

Docket No: TR-170141

Current Date: 10/10/2017

Railroad Owing Track: UPRR

Railroad Operating on Track: UPRR

FRA Investigation: Yes  No

Inspector: Mark Johnson

## I. Type of Accident

Public Crossing  Private Crossing  Trestle  Pedestrian at Crossing   
 Pedestrian Not at Crossing  Other (explain)

## II. Time and Location of Accident

Date 3/2/2017 Time 1508  
 USDOT Crossing No. 396578L WUTC Crossing No. 6R167.25  
 Railroad Milepost 167.25 GPS Identifier: Lat: 47.386794 Long: -122.241687  
 Number of Tracks: 1 City: Kent  
 Road name, yard name, bridge identifier: West Jame St. County: King  
 Company responsible for track maintenance: UPRR  
 Other railroad involved in train accident/incident: No

## III. Conditions Surrounding the Accident

Weather: Clear to cloudy  Fog  Rain  Snow   
 Road Condition: Dry  Wet  Snow  Ice   
 Visibility Due to Weather: Daylight  Darkness  Unknown   
 Adequate Sight Distance: Yes  No  N/A  Train Speed: 40mph  
 Describe: Tangent track with 1500' sight distance to the north  
 Train Type: Freight  Passenger  Locomotive only  Cars only  Tilt train   
 Remote Control: Yes  No  N/A  Haz-Mat on Train: Yes  No  N/A   
 Type of Haz-Mat: N/A

## IV. Pedestrian, Driver, or Passenger Fatalities Does this section apply? Yes No

Number of people killed 1 If a vehicle accident, number of passengers N/A  
 Name: Ryan Carl Patterson  
 Driver:  Passenger  Pedestrian  Age 37 Gender: Male  Female   
 Pedestrian trying to get on/off train? Yes  No  Suicide: Yes  No  Undetermined   
 Alcohol: Yes  No  Undetermined  Information supplied by: Death Certificate  
 Drugs: Yes  No  Undetermined  Information supplied by: Death Certificate  
 Names of additional fatalities: \_\_\_\_\_

Docket No: TR-170141

**V. Pedestrian, Driver, or Passenger Injuries**

Does this section apply? Yes  No

Number of people injured \_\_\_\_\_

If a vehicle accident, number of passengers \_\_\_\_\_

Name: \_\_\_\_\_

Driver:  Passenger  Pedestrian

Age \_\_\_\_\_ Gender: Male  Female

Pedestrian trying to get on/off train? Yes  No

Drugs: Yes  No  Undetermined

Alcohol: Yes  No  Undetermined

Names of additional injured persons:  
\_\_\_\_\_

**VI. Pedestrian Access**

Does this section apply? Yes  No

Obvious signs of consistent pedestrian trespass? Yes  No

If yes, describe: \_\_\_\_\_

Pedestrian (not at a crossing) information: Accessing public area? Yes  No

If yes, describe: \_\_\_\_\_

Deterrents at site, e.g. fence, signs, etc? Yes  No

If yes, describe: Shoulder mounted flashing light mast on each sidewalk warning pedestrians of trains.

Previous collisions at or near site? Yes  No

If yes, describe: Train striking vehicles and vehicles striking trains at crossing.

**VII. Crossing History**

Does this section apply? Yes  No

Prior accidents at this crossing? Yes  No

How many? 7

Dates of prior accidents: 4/12/81; 4/9/81; 4/26/79; 9/21/78; 10/19/77; 9/12/77; 3/5/77

Description of prior accidents (e.g., fatalities, injuries, property damage) 2 fatalities and 5 injuries

Last inspection date? 8/27/2015

Defects? Yes  No

If yes, describe: All previous defects are crossing surface defects.

Required to attach most current inventory? Yes  No

**VIII. Attachments**

Railroad incident report? Yes  No

Local law enforcement report? Yes  No

Coroner/medical examiner report? Yes  No

Pictures? Yes  No

Other (describe):  
\_\_\_\_\_

**IX. Comments**

On March 2<sup>nd</sup>, 2017 at 15:08 a UPRR train was southbound across the West Jame Street crossing in Kent, WA, when it struck pedestrian Ryan Patterson.

Witnesses stated they observed a southbound train and could see the crossing gates, bells and lights were activated. Witnesses also noted that the locomotive horn was sounding as it approached the crossing. Witness statements and train video both indicate the pedestrian was standing near the tracks and appeared to intentionally step in front of the train.

Mr. Patterson was pronounced dead at the scene. The Certificate of Death lists the manner of death as suicide.

UTC Rail Safety Program - Assignment Details - For Assignment 2017.0281

15272

|  |          |                            |               |                 |          |     |
|--|----------|----------------------------|---------------|-----------------|----------|-----|
| USDOT #  | 396578L  | Last Inspection Date       | 8/27/2015     |                 |          |     |
| UTC #  | 6R167.25 | Road Name                  | West James St |                 |          |     |
| Type of Crossing   | Public   | Section.Township.Range     | 13.22.04E     |                 |          |     |
| County   | King     | Latitude                   | 47.3867       |                 |          |     |
| City/Nearest City  | Kent     | Longitude                  | -122.24162    |                 |          |     |
| In City Limits   | Yes      | Type of Development        | Institutional |                 |          |     |
| <b>ROADWAY</b>   |          | Road Surface Grades        | 1             | Grade Direction | East     |     |
| State Highway  | No       | Road Surface Grades        | 2             | Grade Direction | West     |     |
| Down a Street  | No       | AADT                       | 21920         | AADT Year       | 2010     |     |
| Highway Milepost   |          | % of Trucks Using Crossing | 5             |                 |          |     |
| Vehicle Speed  | 35       | Number of School Bus Trips |               |                 |          |     |
| Road Surface   | PAV      | WSDOT Region               | 1             |                 |          |     |
| Road Type  | 2W       | Truck Pullout Lanes        | No            |                 |          |     |
| Number of Road Lanes   | 4        | Intersecting Highway       | 0-75'         | 75-200'         | 200-500' | N/A |
| Road Width   | 45       | Crossing Angle (degree)    | 0-29          | 30-59           | 60-90    |     |
| Sight Distance - Take measurement 6' back from stop line. If no stop line, measure at 25'. |          |                            | NW            | NE              | SW       | SE  |
|  |          |                            | 600           | 600             | 1000     | 250 |

| <b>PASSIVE PROTECTION</b>                |          | N            | S | E         | W  |
|--|----------|--------------|---|-----------|----|
| Advance Warning Signs                    | Count    |              |   | 1         | 1  |
| Road Markings                            | Count    |              |   | 2         | 2  |
| Reflective Crossbucks                    | Count    |              |   | 1         | 1  |
| Reflective Posts (req. 1/2020)           | Count    |              |   |           |    |
| Median Barriers                          | Count    |              |   | 1         |    |
| Stop Lines                               | Count    |              |   | 2         | 2  |
| Stop Lines                               | Distance |              |   | 35        | 30 |
| ENS Signs                                | Count    |              |   |           |    |
| Illuminaries (within 50 ft. of crossing) | 2        |              |   |           |    |
| <b>Miscellaneous</b>                     |          | Device Count |   | Direction |    |
| Do Not Stop on Tracks R8-8               |          | 1            |   | East      |    |

| <b>ACTIVE PROTECTION</b>    |     | Direction                                | Device Count | Cantilever Length | Gate Length |
|-----------------------------|-----|--|--------------|-------------------|-------------|
| Protective Device           |     | Both                                     | 2            | 20                | 30          |
| Four Quadrant Gates         | No  | # of Flashing Light Pairs                |              | 16                |             |
| Power Off Indicator Light   | Yes | Cantilever Lights Over All Traffic Lanes |              | Yes               |             |
| # of Bells                  | 4   | Traffic Light interconnection/Preemption |              |                   |             |
| <b>TRAIN SPEEDS</b> Freight | 40  | Passenger                                |              |                   |             |

| <b>CHARACTERISTICS</b>    |          | Wayside Horn                | No    |
|---------------------------|----------|-----------------------------|-------|
| Crossing Structure        |          | Quiet Zone                  | No    |
| Crossing Surface          | Concrete | Bike Lane                   | No    |
| Other Crossing Surface:   |          | USDOT # Posted              | Yes   |
| # Main Tracks             | 1        | Railroad Emergency # Posted | Yes # |
| # Sidings / # Yard Tracks |          | Crossing Width              | 70    |
| # Spurs                   | 0        | Sidewalk stops at crossing  |       |
| Sidewalk                  | None     | Sidewalk                    |       |

**COMMENTS**





Impact site.

Tangent track with at least 1500' of sight distance to the North.



## Halstead, Lori (UTC)

---

**From:** State Emergency Operations Officer (MIL)  
**Sent:** Thursday, March 02, 2017 4:16 PM  
**To:** 'jschneider@kentfirefa.org'; Banks, Daniel C (MIL); Elizabeth Klute; Kenneth W. Holgard; Mark Daniels (FRA); Stacey Thompson (Fed Railroad Association Reg 8); Steven Travers; UTC DL WUTC Rail Reporting  
**Subject:** Train vs Pedestrian

FYI... At 1600 hrs today, Nate Hynek from Union Pacific RR, ph # 888-877-7267, reported that at 1509 hrs today, Union Pacific Train # LIS41-02 struck a pedestrian at West James St and Lincoln Ave, in Kent. First responders arrived to provide CPR on the pedestrian. Current condition was not known.

Please confirm receipt.

Thank you,

Jim Kadrmas  
State Emergency Operations Officer  
Washington State Emergency Management Division  
Building 20, MS: TA-20  
Camp Murray, WA 98430-5122  
1-800-258-5990  
dutyofficer@mil.wa.gov

**UNION PACIFIC RAILROAD COMPANY**  
**EMAIL / FAX NOTIFICATION TO STATE REGULATORY AGENCY**

**CHECK AGENCY TO BE NOTIFIED:**

- California Public Utilities Commission      Email: [RRincident@cpuc.ca.gov](mailto:RRincident@cpuc.ca.gov)
- Kansas Department of Transportation      Email: [JohnM@ksdot.org](mailto:JohnM@ksdot.org)
- Oklahoma Corporate Commission      405-521-2916
- Washington PU&T Commission      360-586-1172

**RESPONSE MANAGEMENT COMMUNICATION CENTER**

1400 Douglas St. - Mail Stop 0850 - Omaha, NE 68179  
 Phone Number - 888-877-7267 - FAX Number - 402-501-0634

THIS MESSAGE IS INTENDED ONLY FOR THE USE OF THE INDIVIDUAL OR ENTITY TO WHICH IT IS ADDRESSED AND MAY CONTAIN INFORMATION THAT IS PRIVILEGED, CONFIDENTIAL AND EXEMPT FROM DISCLOSURE UNDER APPLICABLE LAWS.

If YOU, the reader of this message, are not the intended recipient, or the employee or person responsible for delivering this message to the intended recipient, you are hereby notified that any dissemination, distribution or copying of this communication is strictly prohibited. If you have received this communication in error, please notify the sender by telephone and return the original message to the address above, or destroy.

|   |   |  |                                   |
|---|---|--|-----------------------------------|
| Time of Incident                                  | (Central - unless otherwise noted)<br>06:37 Pm  |  |                                   |
| Date of Incident                                  | Month:<br>03  | Day:<br>02                                     | Year:<br>2017                     |
| RIMS Report Number                                | Rims Report Number:<br>2017-03-02-244nrh  |  |                                   |
| RMCC Critical Call Dispatcher:                    | Name:<br>Danny Anzures  |  |                                   |
| Type of Incident                                  | Crossing Accident, Train/Vehicle Collision, Fatality, Derailment, Hazardous Materials Release, Environmental Incident:<br>Fatality - Trespasser |  |                                   |
| Location Detail                                   | DOT:<br>396578L   | Mile Post:<br>167.25                           | Subdivision:<br>Seattle           |
| Location of Incident                              | City:<br>Kent   | State:<br>WA                                   |                                   |
| Train Detail                                      | Train Symbol:<br>LIS41 02   | Lead Locomotive ID:<br>UP 1109                 | Railcar ID:<br>N/A                |
| Emergency Response Agency                         | (Local - Police, Sheriff, Fire, etc.)<br>Valley Communications Center - King County   |  |                                   |
| Hazardous Material Release / Environmental Impact | <input checked="" type="checkbox"/> No <input type="checkbox"/> Yes   | If "Yes", indicate product:<br>N/A             | If "Yes", indicate amount:<br>N/A |
| Injuries / Fatalities                             | <input type="checkbox"/> No <input checked="" type="checkbox"/> Yes   | If "Yes", indicate how many:<br>One adult male |                                   |
| Incident Circumstances                            | *Update* Train collided with a pedestrian and one adult male sustained fatal injuries.  |  |                                   |



17-3412

Supplement No  
ORIG

# KENT POLICE DEPARTMENT



220 4th Avenue South  
Kent, WA 98032-5895  
Phone: (253) 856-5800  
Fax: (253) 856-6800

Reported Date  
03/02/2017  
Crime/Incident  
COLLISION (N)  
Member#/Dept ID#  
MILLER, RB

Phone

Fax

| Administrative Information            |                                    |                       |                              |   |      |                             |              |                             |  |                        |              |                            |          |
|---------------------------------------|------------------------------------|-----------------------|------------------------------|---|------|-----------------------------|--------------|-----------------------------|--|------------------------|--------------|----------------------------|----------|
| Agency<br>KENT POLICE DEPARTMENT      |                                    |                       |                              | Case No<br>17-3412                        |      | Supplement No<br>ORIG       |              | Reported Date<br>03/02/2017 |  | Reported Time<br>15:08 |              | CAD Call No<br>KP170014851 |          |
| Status<br>CLOSED / LEADS EXHAUSTED    |                                    |                       |                              | Crime/Incident<br>MOTOR VEHICLE COLLISION |      |                             |              |                             |  |                        |              |                            |          |
| Location<br>902 W JAMES ST            |                                    |                       |                              |   |      |                             |              |                             |  |                        | City<br>KENT |                            |          |
| Rep Dist<br>219                       |                                    | NTZ<br>KP             | Beat<br>5                    | From Date<br>03/02/2017                   |      | From Time<br>15:08          |              | To Date<br>03/02/2017       |  | To Time<br>15:08       |              |                            |          |
| Member#/Dept ID#<br>151595/MILLER, RB |                                    |                       |                              |   |      | Assignment<br>TRAFFIC       |              | Entered By<br>151595        |  | Assignment<br>TRAFFIC  |              | RMS Transfer<br>Successful |          |
| Prop Trans Stat<br>Successful         |                                    | Property?<br>Property |                              | Approving Officer<br>45182                |      | Approval Date<br>03/09/2017 |              | Approval Time<br>14:47:52   |  |                        |              |                            |          |
| # Offenses<br>1                       | Offense<br>COLLISION-INJURY (N)    |                       |                              | Description<br>COLLISION - INJURY         |      |                             |              | Complaint Type              |  | AC                     | Use          | Bias                       | Loc      |
| #Pr                                   | MOE                                | Act                   | Weapon/Force                 |   | IBRS | No                          | Cargo Theft? | Dom Viol?                   |  |                        |              |                            |          |
| Link<br>VIC                           | Involvement<br>PED                 | Invl No<br>1          | Name<br>PATTERSON, RYAN CARL |   |      |                             |              |                             |  |                        | Race<br>W    | Sex<br>M                   |          |
| DOB<br>(4b)                           |                                    |                       |                              |   |      |                             |              |                             |  |                        |              | Race<br>W                  | Sex<br>M |
| Link<br>WIT                           | Involvement<br>WIT                 | Invl No<br>1          | Name<br>POTOSNIK, DAN        |   |      |                             |              |                             |  |                        | Race<br>W    | Sex<br>M                   |          |
| DOB                                   |                                    |                       |                              |   |      |                             |              |                             |  |                        |              | Race<br>W                  | Sex<br>M |
| Link<br>WIT                           | Involvement<br>WIT                 | Invl No<br>2          | Name<br>RAGGHIANI, THOMAS B  |   |      |                             |              |                             |  |                        | Race<br>W    | Sex<br>M                   |          |
| DOB<br>(4b)                           |                                    |                       |                              |   |      |                             |              |                             |  |                        |              | Race<br>W                  | Sex<br>M |
| Link<br>WIT                           | Involvement<br>WIT                 | Invl No<br>3          | Name<br>WOLF, KRISTOPHER L   |   |      |                             |              |                             |  |                        | Race<br>W    | Sex<br>M                   |          |
| DOB<br>(4b)                           |                                    |                       |                              |   |      |                             |              |                             |  |                        |              | Race<br>W                  | Sex<br>M |
| # Offenses<br>2                       | Offense<br>DEATH INVESTIGATION (N) |                       |                              | Description<br>DEATH INVESTIGATION        |      |                             |              | Complaint Type              |  | AC                     | Use          | Bias                       | Loc      |
| #Pr                                   | MOE                                | Act                   | Weapon/Force                 |   | IBRS | No                          | Cargo Theft? | Dom Viol?                   |  |                        |              |                            |          |
| Link<br>VIC                           | Involvement<br>PED                 | Invl No<br>1          | Name<br>PATTERSON, RYAN CARL |   |      |                             |              |                             |  |                        | Race<br>W    | Sex<br>M                   |          |
| DOB<br>(4b)                           |                                    |                       |                              |   |      |                             |              |                             |  |                        |              | Race<br>W                  | Sex<br>M |
| Link<br>WIT                           | Involvement<br>WIT                 | Invl No<br>1          | Name<br>POTOSNIK, DAN        |   |      |                             |              |                             |  |                        | Race<br>W    | Sex<br>M                   |          |
| DOB                                   |                                    |                       |                              |   |      |                             |              |                             |  |                        |              | Race<br>W                  | Sex<br>M |
| Link<br>WIT                           | Involvement<br>WIT                 | Invl No<br>2          | Name<br>RAGGHIANI, THOMAS B  |   |      |                             |              |                             |  |                        | Race<br>W    | Sex<br>M                   |          |
| DOB<br>(4b)                           |                                    |                       |                              |   |      |                             |              |                             |  |                        |              | Race<br>W                  | Sex<br>M |
| Link<br>WIT                           | Involvement<br>WIT                 | Invl No<br>3          | Name<br>WOLF, KRISTOPHER L   |   |      |                             |              |                             |  |                        | Race<br>W    | Sex<br>M                   |          |
| DOB<br>(4b)                           |                                    |                       |                              |   |      |                             |              |                             |  |                        |              | Race<br>W                  | Sex<br>M |
| # Offenses<br>3                       | Offense<br>GG03 (N)                |                       |                              | Description<br>None/Unknown               |      |                             |              | Complaint Type              |  | AC                     | Use          | Bias                       | Loc      |
| #Pr                                   | MOE                                | Act                   | Weapon/Force                 |   | IBRS | No                          | Cargo Theft? | Dom Viol?                   |  |                        |              |                            |          |

# KENT POLICE DEPARTMENT

|             |             |         |                      |      |     |
|-------------|-------------|---------|----------------------|------|-----|
| Link        | Involvement | Invl No | Name                 | Race | Sex |
| VIC         | PED         | 1       | PATTERSON, RYAN CARL | W    | M   |
| DOB<br>(4b) |             |         |                      |      |     |
| Link        | Involvement | Invl No | Name                 | Race | Sex |
| WIT         | WIT         | 1       | POTOSNIK, DAN        | W    | M   |
| DOB         |             |         |                      |      |     |
| Link        | Involvement | Invl No | Name                 | Race | Sex |
| WIT         | WIT         | 2       | RAGGHIANI, THOMAS B  | W    | M   |
| DOB<br>(4b) |             |         |                      |      |     |
| Link        | Involvement | Invl No | Name                 | Race | Sex |
| WIT         | WIT         | 3       | WOLF, KRISTOPHER L   |      | M   |
| DOB<br>(4b) |             |         |                      |      |     |

## Person Summary

|      |         |      |                      |        |
|------|---------|------|----------------------|--------|
| Invl | Invl No | Type | Name                 | MNI    |
| PED  | 1       | I    | PATTERSON, RYAN CARL | 538820 |
| Race | Sex     | DOB  |                      |        |
| W    | M       | (4b) |                      |        |
| Invl | Invl No | Type | Name                 | MNI    |
| WIT  | 1       | I    | POTOSNIK, DAN        | 912612 |
| Race | Sex     | DOB  |                      |        |
| W    | M       |      |                      |        |
| Invl | Invl No | Type | Name                 | MNI    |
| WIT  | 2       | I    | RAGGHIANI, THOMAS B  | 912614 |
| Race | Sex     | DOB  |                      |        |
| W    | M       | (4b) |                      |        |
| Invl | Invl No | Type | Name                 | MNI    |
| WIT  | 3       | I    | WOLF, KRISTOPHER L   | 558436 |
| Race | Sex     | DOB  |                      |        |
| W    | M       | (4b) |                      |        |
| Invl | Invl No | Type | Name                 | MNI    |
| WIT  | 4       | I    | BENSON, JAMES E      | 700423 |
| Race | Sex     | DOB  |                      |        |
| W    | M       | (4b) |                      |        |

## Property Summary

|             |  |
|-------------|--|
| Involvement | FOU  |
| Description | Article: Clothing/Bags/Personal Items BAG FOU/backpack-searched, belonging to DEC.       |
| Involvement | DES  |
| Description | Article: Other (none of the above, includes Money) WEAPON DES/BB handgun-destroyed       |
| Involvement | VER  |
| Description | Article: Other (none of the above, includes Money) PHOTO VER/pictures of collision scene |

**KENT POLICE DEPARTMENT**

**PEDESTRIAN 1: PATTERSON,RYAN CARL**

|                      |         |                   |        |        |            |           |         |
|----------------------|---------|-------------------|--------|--------|------------|-----------|---------|
| Involvement          | Invl No | Type              |        |        |            |           |         |
| PEDESTRIAN           | 1       | Individual/Person |        |        |            |           |         |
| Name                 |         |                   | MNI    | Race   | Sex        |           |         |
| PATTERSON, RYAN CARL |         |                   | 538820 | WHITE  | Male       |           |         |
| DOB                  | Age     | Juvenile?         | Height | Weight | Hair Color | Eye Color | PRN     |
| (4b)                 | 37      | No                | 5'08"  | 185#   | BROWN      | HAZEL     | 1513151 |

|            |            |
|------------|------------|
| Type       | Address    |
| Home       | (4b)       |
| State      | Date       |
| WASHINGTON | 03/02/2017 |

**WITNESS 1: POTOSNIK,DAN**

|               |         |                   |        |       |      |
|---------------|---------|-------------------|--------|-------|------|
| Involvement   | Invl No | Type              |        |       |      |
| WITNESS       | 1       | Individual/Person |        |       |      |
| Name          |         |                   | MNI    | Race  | Sex  |
| POTOSNIK, DAN |         |                   | 912612 | WHITE | Male |
| PRN           |         |                   |        |       |      |
| 1513152       |         |                   |        |       |      |

|               |                 |          |            |
|---------------|-----------------|----------|------------|
| Type          | Address         |          |            |
| Work/Business | 402 S DAWSON ST |          |            |
| City          | State           | ZIP Code | Date       |
| SEATTLE       | WASHINGTON      | 98108    | 03/02/2017 |

|            |                |            |
|------------|----------------|------------|
| Phone Type | Phone No       | Date       |
| BUSINESS   | (206) 229-8235 | 03/02/2017 |

**WITNESS 2: RAGGHIANI,THOMAS B**

|                     |         |                   |         |       |      |
|---------------------|---------|-------------------|---------|-------|------|
| Involvement         | Invl No | Type              |         |       |      |
| WITNESS             | 2       | Individual/Person |         |       |      |
| Name                |         |                   | MNI     | Race  | Sex  |
| RAGGHIANI, THOMAS B |         |                   | 912614  | WHITE | Male |
| DOB                 | Age     | Juvenile?         | PRN     |       |      |
| (4b)                | 45      | No                | 1513153 |       |      |

|               |                 |          |            |
|---------------|-----------------|----------|------------|
| Type          | Address         |          |            |
| Work/Business | 402 S DAWSON ST |          |            |
| City          | State           | ZIP Code | Date       |
| SEATTLE       | WASHINGTON      | 98108    | 03/02/2017 |

|            |          |            |
|------------|----------|------------|
| Phone Type | Phone No | Date       |
| CELL       | (4b)     | 03/02/2017 |

**WITNESS 3: WOLF,KRISTOPHER L**

|                    |         |                   |         |      |
|--------------------|---------|-------------------|---------|------|
| Involvement        | Invl No | Type              |         |      |
| WITNESS            | 3       | Individual/Person |         |      |
| Name               |         |                   | MNI     | Sex  |
| WOLF, KRISTOPHER L |         |                   | 558436  | Male |
| DOB                | Age     | Juvenile?         | PRN     |      |
| (4b)               | 33      | No                | 1513154 |      |

|      |            |          |            |
|------|------------|----------|------------|
| Type | Address    |          |            |
| Home | (4b)       |          |            |
| City | State      | ZIP Code | Date       |
| (4b) | WASHINGTON | (4b)     | 03/02/2017 |

|            |          |            |
|------------|----------|------------|
| Phone Type | Phone No | Date       |
| CELL       | (4b)     | 03/02/2017 |

**WITNESS 4: BENSON,JAMES E**

|                 |         |                   |         |       |      |
|-----------------|---------|-------------------|---------|-------|------|
| Involvement     | Invl No | Type              |         |       |      |
| WITNESS         | 4       | Individual/Person |         |       |      |
| Name            |         |                   | MNI     | Race  | Sex  |
| BENSON, JAMES E |         |                   | 700423  | WHITE | Male |
| DOB             | Age     | Juvenile?         | PRN     |       |      |
| (4b)            | 53      | No                | 1513155 |       |      |

|      |            |          |            |
|------|------------|----------|------------|
| Type | Address    |          |            |
| Home | (4b)       |          |            |
| City | State      | ZIP Code | Date       |
| (4b) | WASHINGTON | (4b)     | 03/02/2017 |

|            |          |            |
|------------|----------|------------|
| Phone Type | Phone No | Date       |
| CELL       | (4b)     | 03/02/2017 |

17-3412

Supplement No  
ORIG

# KENT POLICE DEPARTMENT

## Property

|  |                            |                  |                                   |                 |                   |              |     |
|--|----------------------------|------------------|-----------------------------------|-----------------|-------------------|--------------|-----|
| Prop #                                       | Involvement                | Invl Date        | In Custody?                       | Security        | Tag No            | Item No      |     |
| 1  | FOUND - PLACED IN EVIDENCE | 03/02/2017       | Yes                               | No              | 170000912         | 1            |     |
| Description                                  |                            |                  |                                   |                 |                   | Typ          |     |
| FOU/backpack-searched, belonging to DEC.     |                            |                  |                                   |                 |                   | A            |     |
| Cat  |                            |                  | Article                           |                 |                   |              |     |
| Clothing/Bags/Personal Items                 |                            |                  | Duffle/Backpack/Briefcase/Luggage |                 |                   |              |     |
| IBRS Type                                    |                            | Entered Date     | Entered Time                      | RMS Transfer    | Control           |              |     |
| Purses, handbags, wallets                    |                            | 03/03/2017       | 10:04                             | Successful      | 151595 0303171015 |              |     |
| Link   | Involvement                | Invl No          | Name                              |                 |                   | Race         | Sex |
| OWN  | PED                        | 1                | PATTERSON, RYAN CARL              |                 |                   | W            | M   |
| DOB<br>(4b)                                  |                            |                  |                                   |                 |                   |              |     |
| Link   | Involvement                | Invl No          | Name                              |                 |                   | Race         | Sex |
| WIT  | WIT                        | 1                | POTOSNIK, DAN                     |                 |                   | W            | M   |
| DOB  |                            |                  |                                   |                 |                   |              |     |
| Link   | Involvement                | Invl No          | Name                              |                 |                   | Race         | Sex |
| WIT  | WIT                        | 2                | RAGGHIANI, THOMAS B               |                 |                   | W            | M   |
| DOB<br>(4b)                                  |                            |                  |                                   |                 |                   |              |     |
| Link   | Involvement                | Invl No          | Name                              |                 |                   | Race         | Sex |
| WIT  | WIT                        | 3                | WOLF, KRISTOPHER L                |                 |                   |              | M   |
| DOB<br>(4b)                                  |                            |                  |                                   |                 |                   |              |     |
| Prop #                                       | Involvement                | Invl Date        | In Custody?                       | Security        |                   |              |     |
| 2  | DESTROYED BY OFFICER       | 03/02/2017       | No                                | No              |                   |              |     |
| Description                                  |                            |                  |                                   |                 |                   | Typ          |     |
| DES/BB handgun-destroyed                     |                            |                  |                                   |                 |                   | A            |     |
| Cat  |                            |                  |                                   |                 |                   |              |     |
| Other (none of the above, includes Money)    |                            |                  |                                   |                 |                   |              |     |
| Article                                      |                            |                  |                                   | IBRS Type       | Entered Date      |              |     |
| Other Weapons - Knives, Nunchakus, Bows, etc |                            |                  |                                   | Weapons - other | 03/03/2017        |              |     |
| Entered Time                                 | RMS Transfer               | Control          |                                   |                 |                   |              |     |
| 10:13  | Successful                 | 97312 0310170037 |                                   |                 |                   |              |     |
| Link   | Involvement                | Invl No          | Name                              |                 |                   | Race         | Sex |
| OWN  | PED                        | 1                | PATTERSON, RYAN CARL              |                 |                   | W            | M   |
| DOB<br>(4b)                                  |                            |                  |                                   |                 |                   |              |     |
| Link   | Involvement                | Invl No          | Name                              |                 |                   | Race         | Sex |
| WIT  | WIT                        | 1                | POTOSNIK, DAN                     |                 |                   | W            | M   |
| DOB  |                            |                  |                                   |                 |                   |              |     |
| Link   | Involvement                | Invl No          | Name                              |                 |                   | Race         | Sex |
| WIT  | WIT                        | 2                | RAGGHIANI, THOMAS B               |                 |                   | W            | M   |
| DOB<br>(4b)                                  |                            |                  |                                   |                 |                   |              |     |
| Link   | Involvement                | Invl No          | Name                              |                 |                   | Race         | Sex |
| WIT  | WIT                        | 3                | WOLF, KRISTOPHER L                |                 |                   |              | M   |
| DOB<br>(4b)                                  |                            |                  |                                   |                 |                   |              |     |
| Prop #                                       | Involvement                | Invl Date        | In Custody?                       | Security        |                   |              |     |
| 3  | VERIPIC                    | 03/02/2017       | No                                | No              |                   |              |     |
| Description                                  |                            |                  |                                   |                 |                   | Typ          |     |
| VER/pictures of collision scene              |                            |                  |                                   |                 |                   | A            |     |
| Cat  |                            |                  |                                   | Article         | IBRS Type         | Entered Date |     |
| Other (none of the above, includes Money)    |                            |                  |                                   | Photographs     | Other             | 03/03/2017   |     |
| Entered Time                                 | RMS Transfer               | Control          |                                   |                 |                   |              |     |
| 10:14  | Successful                 | 97312 0310170037 |                                   |                 |                   |              |     |
| Link   | Involvement                | Invl No          | Name                              |                 |                   | Race         | Sex |
| WIT  | WIT                        | 1                | POTOSNIK, DAN                     |                 |                   | W            | M   |
| DOB  |                            |                  |                                   |                 |                   |              |     |
| Link   | Involvement                | Invl No          | Name                              |                 |                   | Race         | Sex |
| WIT  | WIT                        | 2                | RAGGHIANI, THOMAS B               |                 |                   | W            | M   |
| DOB<br>(4b)                                  |                            |                  |                                   |                 |                   |              |     |

**KENT POLICE DEPARTMENT**

|             |                    |              |                            |      |          |
|-------------|--------------------|--------------|----------------------------|------|----------|
| Link<br>WIT | Involvement<br>WIT | Invl No<br>3 | Name<br>WOLF, KRISTOPHER L | Race | Sex<br>M |
|-------------|--------------------|--------------|----------------------------|------|----------|

DOB

(4b)

**Narrative**

On 03/02/17 at around 1508 hours, I heard Kent Dispatch air a report of a train vs pedestrian collision in the 900 block of W James ST located in Kent, WA.

I responded to the location and saw Medics performing CPR on a male laying on the south side of W James ST. There was a Union Pacific (UP) engine (locomotive) stopped south of the location on the UP railroad tracks. The single engine was pulling 3 cars. I was later told the cars were empty.

While the pedestrian was getting medical attention, I started speaking with witnesses. (WIT) Thomas B Raghianti works for Union Pacific and was on the train when the collision occurred. Raghianti told me the were going southbound and sounding the horn as they neared the crossing of James ST. They saw a male standing near the tracks, beyond the crossing arms (which were down). The male looked back at the train is the horn was sounding and then stepped closer to the tracks. His foot was inches away from the westernmost rail just prior to impact.

After the male was struck, Raghianti watched the male as he "flew" across the roadway and came to rest on the south side. The male, when he was hit, was on the north side of James ST and on the western side of the tracks.

Raghianti told me the engineer was applying brakes while sounding the horn but due to the train's weight, they were unable to stop until well past the intersection. Where the train was currently located was the location where the train finally came to a stop and it had not moved since.

I later learned (WIT) Dan Potosnik was the engineer at the controls of the engine when this incident occurred. Due to the fact the engine/locomotive is not a driveable vehicle, he is being listed as a witness in this report and not a driver. Potosnik told me the same version of events that Raghianti stated.

(WITs) Kristopher L Wolf and James E Benson related the same story to other officers. They both indicated the crossing arms were down, and the pedestrian was close to the tracks, past the crossing arms. After the pedestrian was struck, they assisted in life saving efforts until relieved by Medics.

I returned to my patrol car and started working on the exchange of information. While there, I learned the pedestrian's name was (DEC) Ryan C Patterson. Patterson is a local transient known by the officers in the bike unit (SOU). They thought he had a daughter that lived somewhere on James ST but were not certain.

As I was finishing up the exchange of information, a Medic informed me they were pronouncing Patterson as deceased and had stopped live saving efforts. Patterson was then transported to the fire station located on W Crow ST. Patterson's body was kept there until the Medical Examiner could arrive and take possession of him.

I collected the backpack Patterson had been wearing at the time he was struck. I later searched the pack and entered into evidence as found property. If Patterson does have any relatives, the property can be released to them. Prior to placing the pack into evidence I searched it. During the search I found a BB handgun that I initially thought was a real firearm. I had the BB gun destroyed. Nothing else of note was found in the pack.

Prior to leaving the scene, Officer Bateman and I took pictures of the scene. Using my LIDAR, Officer Bateman told me Patterson was thrown 65 feet from the initial point of impact to where his body was found. Based on some calculations he made, Officer Bateman estimated the train was going just over 30 miles per hour when the collision occurred.

It should be noted Patterson did not appear to be wearing any headphones or earbuds prior to the collision. According to officers in SOU, Patterson was not deaf and therefore would have heard the train coming. He was seen by all witnesses, prior to the collision, looking back at the train. Based on this, it appears Patterson was trying to get hit by the train and made no effort to avoid being struck.

Case closed.

Case Status Update: N/A.

|                                     |                                |             |
|-------------------------------------|--------------------------------|-------------|
| Report Officer<br>151595/MILLER, RB | Printed At<br>03/29/2017 09:35 | Page 5 of 6 |
|-------------------------------------|--------------------------------|-------------|

# KENT POLICE DEPARTMENT

## Narrative

By affixing my electronic signature below in the form of my type written name, I certify under penalty of perjury under the laws of the State of Washington that this report is true and correct.

RB Miller

Dated this 3rd day of March, 2017, in the City of Kent, Washington.

17-3412

Supplement No  
0001

# KENT POLICE DEPARTMENT



220 4th Avenue South  
Kent, WA 98032-5895  
Phone: (253) 856-5800  
Fax: (253) 856-6800

Reported Date  
03/02/2017  
Crime/Incident  
**COLLISION (N)**  
Member#/Dept ID#  
**BATEMAN, KP**

Phone

Fax

| Administrative Information |                   |               |                 |                   |               |  |
|----------------------------|-------------------|---------------|-----------------|-------------------|---------------|--|
| Agency                     | Case No           | Supplement No | Reported Date   | Reported Time     |               |  |
| KENT POLICE DEPARTMENT     | 17-3412           | 0001          | 03/02/2017      | 16:44             |               |  |
| Crime/Incident             | Member#/Dept ID#  |               |                 | Assignment        |               |  |
| MOTOR VEHICLE COLLISION    | 46295/BATEMAN, KP |               |                 | TRAFFIC           |               |  |
| Entered By                 | Assignment        | RMS Transfer  | Prop Trans Stat | Approving Officer | Approval Date |  |
| 46295                      | TRAFFIC           | Successful    | Successful      | 45182             | 03/09/2017    |  |
| Approval Time              |                   |               |                 |                   |               |  |
| 14:48:35                   |                   |               |                 |                   |               |  |
| Narrative                  |                   |               |                 |                   |               |  |

On 03/02/2017 at approximately 1510 hrs I was dispatched to a train vs. pedestrian collision on W. James St at the Union Pacific Railroad (UPRR) crossing. Upon arrival I learned from Officer R. Miller and the listed witnesses that a pedestrian had been standing on the northwest side of the UPRR crossing when he was struck by the train. The arms were down, the warning lights were flashing, the warning bells were ringing, and the train was repeatedly blowing its extremely loud warning horn. The pedestrian had reportedly been standing very close to the tracks, and appeared to have stepped in front of the train. Witnesses said the train was going "slow" and estimated the speed between 20-30 mph. Trains in this area can run up to about 80 mph.

Based on where it was described that the pedestrian had been standing, I examined the roadway and found what appeared to be fresh scuff marks on the concrete, next to the tracks, on the north side of the intersection. I used Officer Miller's Kustom Signals Pro-Laser 4 to measure the distance that the pedestrian traveled to his point of rest (65 feet). I then used Officer Miller's camera to take several photos of the crossing and scuff marks. I gave him back the camera so that he could photograph the train & cars.

Next, I learned that the Medics had ceased life saving efforts and pronounced the pedestrian deceased. To help confirm his identity, I used my portable fingerprint scanner to run his prints through the AFIS database. Within a few minutes I identified the pedestrian as Ryan C. Patterson (4b) [REDACTED]. This information was provided to the Officer Miller and the Medics. A copy of the AFIS report has been attached for reference.

Since Patterson was already in the Medic vehicle when he was pronounced, and this was a very busy section of roadway, the Medics transported his body to nearby Fire Station 71 (504 W. Crow St). I called the Medical Examiner's Office, advised them of what had happened, and where Patterson was being taken. Officer Miller remained at the scene, and drove to the Station 71. Once the ME's Forensic Medicolegal Death Investigator (Alison Myrabo) arrived, Patterson's body was released to her custody reference ME report #17-433.

Once I returned to the station, I utilized a Microsoft Excel spread sheet calculate an estimated speed for the train. This spreadsheet runs the available data through 39 of the most common pedestrian equations after it determines which of them are applicable. In this case 12 of the 39 equations applied, and the average speed of the train calculated for those 12 equations was 32.3 mph, with a high value of 38.1 mph, and a low of 24.3 mph. It should be noted that for these calculations I assumed that the train fully impacted Patterson; not just a glancing. A list of the applicable equations, the corresponding calculations, and a summary of the results has been attached for reference.

Because of the variables used in the calculations (throw distance, pedestrian foot speed, coefficient of friction, etc), the probability that the minimum or maximum speeds calculated above actually occurred are low. So I used a "Monte Carlo" analysis method to address the uncertainty by randomly choosing a value between the low and high range for each variable. Random values within the ranges of each variable are then used in the in the Pedestrian Throw Distance spreadsheet authored by Roger W. Barrette, MSE for 20,000 separate calculations. The spreadsheet was given to me for use in collision investigations by Mr. Barrette when I attended his training class on 10/17/2012 in Bellevue, WA (Washington Association of Technical Accident Investigators - Fall

**KENT POLICE DEPARTMENT****Narrative**

Conference).

The spreadsheet uses the Random Number Generator in the Microsoft Excel® program to generate 105,000 variables to be used in the calculations 20,000 times. The randomness of the numbers are checked by charting the numbers in a histogram to check for uniformity. Once the 20,000 paired calculations are performed, a statistical analysis of the results is performed to determine the mean, medium values, and the standard deviation. A histogram is also constructed.

The range, or confidence interval, is then determined based on a multiplier of the standard deviation. This is referred to as the Barrette Modifier based on the Empirical Rule. Such that one standard deviation is equal to a 68% confidence interval, and two standard deviations is equal to a 95% confidence level. Any multiplier can be used to determine any other confidence level (such as 90%) if the results are normally distributed, which the histogram confirms. Therefore, using any multiplier will produce a confidence level about the mean, which is the reported speed range with a certain confidence level. The Law of Large Numbers would allow any expert to perform the same calculations 20,000 times, and upon performing a statistical analysis on the results, that expert would produce the same end results.

The use of the Monte Carlo Analysis Technique is not a novel or new approach and has general acceptance in the crash reconstruction community. It uses those equations that already have general acceptance in the community. This method has been used in other applications ranging from nuclear physics to economic risk. Several peer reviewed papers have been published in regard to this method dating back to its initial use in 1994. I [Roger Barrette] have personally taught and presented this method at several crash reconstruction conferences including San Diego and Houston, where this technique was presented to hundreds of my peers without any negative feedback. I [Roger Barrette] have personally researched this topic and have not discovered any negative responses to this method. The five hour presentation I have given has been adopted and is being used by the Northwestern University Center for Public Safety (formally the Traffic Institute) in their advanced Traffic Reconstruction III course, and two days are spent during that week teaching this method. The Spring 2012 edition of "Collision" magazine featured an article on the Monte Carlo Analysis Method that I [Roger Barrette] am the publisher of.

This this case the Monte Carlo analysis resulted in an estimated mean speed for the train of 30.6 mph, and a range of 29.2 to 32.1 mph with a confidence level of 95%. A copy of the Monte Carlo calculation summary has been attached for reference. The complete calculations are available upon request. They were not printed since the calculations are over 1,800 pages. This is consistent with the initial calculations, as well as the witnesses visual observations. I provided Officer Miller with the above speed estimations. This concluded my assistance with this case.

By affixing my electronic signature below in the form of my type written name, I certify under penalty of perjury under the laws of the State of Washington that this report is true and correct.

Officer K. Bateman / 46295

Dated March 6, 2017, in the City of Kent, Washington.



17-3412

Supplement No  
0002

# KENT POLICE DEPARTMENT



220 4th Avenue South  
Kent, WA 98032-5895  
Phone: (253) 856-5800  
Fax: (253) 856-6800

Reported Date  
**03/17/2017**  
Crime/Incident  
**COLLISION (N)**  
Member#/Dept ID#  
**MILLER, RB**

Phone

Fax

| Administrative Information                       |                              |  |                                      |                                   |                                    |  |
|--|------------------------------|--|--------------------------------------|-----------------------------------|------------------------------------|--|
| Agency<br><b>KENT POLICE DEPARTMENT</b>          | Case No<br><b>17-3412</b>    | Supplement No<br><b>0002</b>                 | Reported Date<br><b>03/17/2017</b>   | Reported Time<br><b>14:34</b>     |                                    |  |
| Crime/Incident<br><b>MOTOR VEHICLE COLLISION</b> |                              | Member#/Dept ID#<br><b>151595/MILLER, RB</b> |                                      |                                   | Assignment<br><b>TRAFFIC</b>       |  |
| Entered By<br><b>151595</b>                      | Assignment<br><b>TRAFFIC</b> | RMS Transfer<br><b>Successful</b>            | Prop Trans Stat<br><b>Successful</b> | Approving Officer<br><b>45182</b> | Approval Date<br><b>03/21/2017</b> |  |
| Approval Time<br><b>17:58:33</b>                 |                              |  |                                      |                                   |                                    |  |
| Narrative  |                              |  |                                      |                                   |                                    |  |

Case Status Update: On 3/17/17 a Union Pacific Railroad Officer showed me the video that was filmed by a camera mounted to the engine during the time of this incident.

In the video you can hear the engine sound its horn several hundred feet prior to reaching the intersection of W James ST. By the time the pedestrian is in view of the camera, the horn from the engine/train is going continuously. It appears the male looks back at the train over his shoulder but makes no move to step away from the tracks. The male is inches away from the western rail and then disappears out of view just before impact. This occurs due to the front portion of the train blocking the view; much like the hood of a car obstructs the view of objects that are lower and near the front end.

The video reinforces what the witnesses stated and it appears the collision was a successful suicide attempt by the pedestrian. The case will remain closed.

End of supplemental.

By affixing my electronic signature below in the form of my type written name, I certify under penalty of perjury under the laws of the State of Washington that this report is true and correct.

RB Miller

Dated this 17th day of March, 2017, in the City of Kent, Washington.



STATE OF WASHINGTON  
POLICE TRAFFIC  
COLLISION REPORT



1591971

REPORT NO. **E647738**

1

|                                      |   |   |
|--------------------------------------|---|---|
| INTERSTATE <input type="checkbox"/>  | CITY STREET <input checked="" type="checkbox"/> | FIRE RESULTED <input type="checkbox"/>      |
| STATE ROUTE <input type="checkbox"/> | OTHER <input type="checkbox"/>                  | STOLEN VEHICLE <input type="checkbox"/>     |
| COUNTY RD <input type="checkbox"/>   | PRIVATE WAY <input type="checkbox"/>            | HIT & RUN INVOLVED <input type="checkbox"/> |

2

TRIBAL RESERVATION

3

DATE OF COLLISION: M 03 D 02 Y 2017 TIME (2400) 1508 COUNTY # 17 MILES      CITY # 0615

4

ON (PRIMARY TRAFFIC WAY) INTERSECTION  NON-INTERSECTION   
**W JAMES ST** BLOCK NO.  900 MILE POST

4a

DISTANCE      MILES  N  E  OF (REFERENCE OR CROSS STREET) UPRR CROSSING  
 FEET  S  W

5

**UNIT 01** MOTOR VEHICLE  PEDAL-CYCLE  DAMAGE THRESHOLD MET YES  NO  PHONE     

6

LAST NAME OTHER FIRST NAME      MIDDLE INITIAL     

7

STREET NEW ADDRESS     

8

CITY      ST      ZIP     

9

CDL      RESTRICTIONS      ENDORSEMENTS     

9 6

DRIVER'S LICENSE #      STATE      SEX U D.O.B. MMDDYYYY

10 6

ON DUTY  STATUS      AIRBAG 1 RESTR. 1 EJECT 1 HELMET USE      INJURY CLASS 1 NATURE OF INJURIES     

11

LICENSE PLATE #      STATE      VIN#     

12

TRAILER PLATE #      STATE      TRAILER PLATE #      STATE     

13 A

VEH. YEAR 1988 MAKE OTH MODEL LOCAM STYLE TF VEHICLE TOWED YES  NO  TOWED BY      GOVT. VEHICLE YES  NO

14 A

REGISTERED OWNER INFO. UNION PACIFIC RAIL ROAD 1400 DOUGLAS STREET OMAHA NE 68179 D: 4025445000

15 1

LIABILITY INSURANCE IN EFFECT  INSURANCE CO & POLICY # SELF INSURED SELF INSURED  
 VEHICLE LEGALLY STANDING YES  NO  CITATION #      CHARGE     

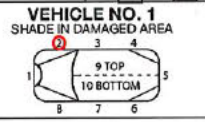

16 1

**UNIT 02** MOTOR VEHICLE  PEDAL-CYCLE  PEDESTRIAN  PROPERTY OWNER  DAMAGE THRESHOLD MET YES  NO  PHONE     

17

LAST NAME PATTERSON FIRST NAME RYAN MIDDLE INITIAL C

18

STREET NEW ADDRESS TRANSIENT

19

CITY      ST      ZIP     

20 6

CDL      RESTRICTIONS      ENDORSEMENTS     

21

DRIVER'S LICENSE #      STATE      SEX M D.O.B. MMDDYYYY **(4b)**

22 3

ON DUTY  STATUS 3 AIRBAG      RESTR.      EJECT      HELMET USE      INJURY CLASS 2 NATURE OF INJURIES DEAD

23

LICENSE PLATE #      STATE      VIN#     

24 1 7

TRAILER PLATE #      STATE      TRAILER PLATE #      STATE     

25

VEH. YEAR      MAKE      MODEL      STYLE      VEHICLE TOWED YES  NO  TOWED BY      GOVT. VEHICLE YES  NO

26

REGISTERED OWNER INFO.       
 LIABILITY INSURANCE IN EFFECT  INSURANCE CO & POLICY #       
 VEHICLE LEGALLY STANDING YES  NO  CITATION #      CHARGE       
 OFFICER'S NAME (PRINT) R MILLER BADGE OR ID # 151595 AGENCY WA0170700



1 1 8 27  
 2  
 3  
 1 1 7 28  
 2  
 3  
 0 1 29  
 30  
 1 1 2 31  
 2  
 3  
 1 32  
 2  
 3  
 FROM TO 1 5 33  
 FROM TO 1 5 34  
 4 35  
 9 36  
 37  
 38  
 39  
 40  
 1 41  
 42



STATE OF WASHINGTON  
POLICE TRAFFIC  
COLLISION REPORT



1591972

CORRECTION

REPORT NO. **E647738**

CASE # 17-3412

ADDITIONAL PERSONS INVOLVED (PASSENGERS AND/OR WITNESSES ONLY)

NAME (LAST, FIRST, MIDDLE INITIAL) **WOLF KRISTOPHER L**

ADDRESS & PHONE # **(4b)** SEX **M** D.O.B. **(4b)**

PASSENGER  WITNESS  UNIT # SEAT POS. AIRBAG RESTR. EJECT HELMET USE INJURY CLASS NATURE OF INJURIES

NAME (LAST, FIRST, MIDDLE INITIAL) **RAGGHIANI THOMAS B**

ADDRESS & PHONE # **(4b)** SEX **M** D.O.B. **(4b)**

PASSENGER  WITNESS  UNIT # SEAT POS. AIRBAG RESTR. EJECT HELMET USE INJURY CLASS NATURE OF INJURIES

NAME (LAST, FIRST, MIDDLE INITIAL) **BENSON JAMES E**

ADDRESS & PHONE # **(4b)** SEX **M** D.O.B. **(4b)**

PASSENGER  WITNESS  UNIT # SEAT POS. AIRBAG RESTR. EJECT HELMET USE INJURY CLASS NATURE OF INJURIES

NARRATIVE

Please see subsequent narrative pages

I CERTIFY (DECLARE) UNDER PENALTY OF PERJURY UNDER THE LAWS OF THE STATE OF WASHINGTON THAT THE FOREGOING IS TRUE AND CORRECT. (RCW 9A.72.085)

|  |                           |   |                                       |                  |
|--|---------------------------|---|---------------------------------------|------------------|
| <b>R MILLER</b><br>INVESTIGATING OFFICER'S SIGNATURE |                           | <b>03-03-17 12:30 PM</b><br>UNIT OR DIST. DET | <b>03-03-17 12:30 PM</b><br>DATED     | <br>PLACE SIGNED |
| <b>R MILLER 151595</b><br>APPROVED BY                |                           |   | <b>3/3/2017 12:32:50 PM</b><br>DATE   |                  |
| <b>151595</b><br>BADGE OR ID #                       | <b>WA0170700</b><br>ORI # | <b>3:10 PM</b><br>TIME POLICE DISPATCHED      | <b>3:13 PM</b><br>TIME POLICE ARRIVED | <b>5</b><br>PAGE |



STATE OF WASHINGTON  
POLICE TRAFFIC  
COLLISION REPORT



1591972

CORRECTION

REPORT NO. **E647738**

CASE # 17-3412

ADDITIONAL PERSONS INVOLVED (PASSENGERS AND/OR WITNESSES ONLY)

NAME (LAST, FIRST, MIDDLE INITIAL) **POTOSNIK DAN**

ADDRESS & PHONE # **(4b)** SEX **M** D.O.B. **(4b)**

|                                    |   |        |           |        |        |       |            |              |                    |
|------------------------------------|---|--------|-----------|--------|--------|-------|------------|--------------|--------------------|
| PASSENGER <input type="checkbox"/> | WITNESS <input checked="" type="checkbox"/> | UNIT # | SEAT POS. | AIRBAG | RESTR. | EJECT | HELMET USE | INJURY CLASS | NATURE OF INJURIES |
|------------------------------------|---|--------|-----------|--------|--------|-------|------------|--------------|--------------------|

NAME (LAST, FIRST, MIDDLE INITIAL)

ADDRESS & PHONE # SEX D.O.B.

|                                    |                                  |        |           |        |        |       |            |              |                    |
|------------------------------------|----------------------------------|--------|-----------|--------|--------|-------|------------|--------------|--------------------|
| PASSENGER <input type="checkbox"/> | WITNESS <input type="checkbox"/> | UNIT # | SEAT POS. | AIRBAG | RESTR. | EJECT | HELMET USE | INJURY CLASS | NATURE OF INJURIES |
|------------------------------------|----------------------------------|--------|-----------|--------|--------|-------|------------|--------------|--------------------|

NAME (LAST, FIRST, MIDDLE INITIAL)

ADDRESS & PHONE # SEX D.O.B.

|                                    |                                  |        |           |        |        |       |            |              |                    |
|------------------------------------|----------------------------------|--------|-----------|--------|--------|-------|------------|--------------|--------------------|
| PASSENGER <input type="checkbox"/> | WITNESS <input type="checkbox"/> | UNIT # | SEAT POS. | AIRBAG | RESTR. | EJECT | HELMET USE | INJURY CLASS | NATURE OF INJURIES |
|------------------------------------|----------------------------------|--------|-----------|--------|--------|-------|------------|--------------|--------------------|

NARRATIVE

Please see subsequent narrative pages

I CERTIFY (DECLARE) UNDER PENALTY OF PERJURY UNDER THE LAWS OF THE STATE OF WASHINGTON THAT THE FOREGOING IS TRUE AND CORRECT. (RCW 9A.72.085)

**R MILLER** INVESTIGATING OFFICER'S SIGNATURE      **03-03-17 12:30 PM** DATED      PLACE SIGNED

APPROVED BY **R MILLER 151595**      DATE **3/3/2017 12:32:50 PM**

|                             |                        |                                       |                                    |
|-----------------------------|------------------------|---------------------------------------|------------------------------------|
| BADGE OR ID # <b>151595</b> | ORI # <b>WA0170700</b> | TIME POLICE DISPATCHED <b>3:10 PM</b> | TIME POLICE ARRIVED <b>3:13 PM</b> |
|-----------------------------|------------------------|---------------------------------------|------------------------------------|

## NARRATIVE

This incident occurred in the City of Kent, Washington: V1, a Union Pacific locomotive, was crossing W James ST on the railroad tracks. Pedestrian Ryan C Patterson was walking next to the tracks, walking southbound. As the train was crossing W James ST, the pedestrian stepped towards the train and was struck.

According to all witnesses, the locomotive was going between 35 and 40 mph. The crossing arms were down and the horn was being used by the engineer (WIT Dan Potosnik). All witnesses saw the arms down and could hear the locomotive's horn. Witnesses indicated the pedestrian looked back at the train, turned his back to it and then ducked his head prior to being struck. Pedestrian made no effort to move away from the train.

After being struck by the train, the pedestrian was thrown 65 feet to the south side of W James ST. There life saving efforts were made by both citizens and Medics but they were unable to revive him. The pedestrian was pronounced deceased at the scene.

See KPD case 17-3412 for further details.

By affixing my electronic signature below in the form of my type written name, I certify under penalty of perjury under the laws of the State of Washington that this report is true and correct.

RB Miller #151595

Dated March 3, 2017, in the City of Kent, Washington.

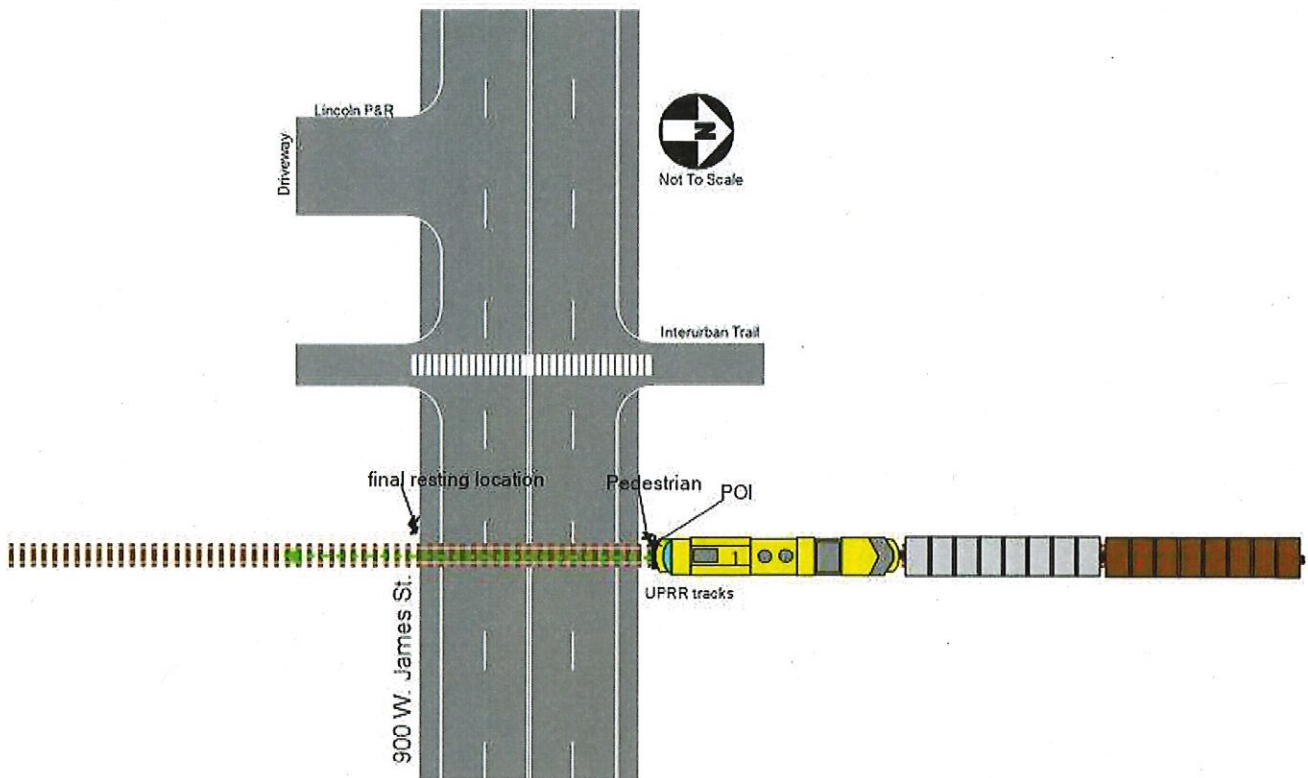

**Halstead, Lori (UTC)**

---

**From:** State Emergency Operations Officer (MIL)  
**Sent:** Thursday, March 02, 2017 5:11 PM  
**To:** 'bfcz@kentwa.gov'; Banks, Daniel C (MIL); Elizabeth Klute; Kenneth W. Holgard; Mark Daniels (FRA); Stacey Thompson (Fed Railroad Association Reg 8); Steven Travers; UTC DL WUTC Rail Reporting  
**Subject:** NRC#1172350 Train vs Pedestrian, Kent

This is the NRC for the previously reported Train vs Pedestrian incident.

Christopher Jager  
 State Emergency Operations Officer  
 Washington State Emergency Management Division Building 20, MS: TA-20 Camp Murray, WA 98430-5122  
 1-800-258-5990  
 dutyofficer@mil.wa.gov

-----Original Message-----

From: HQS-PF-flidr-NRC@uscg.mil [mailto:HQS-PF-flidr-NRC@uscg.mil]  
 Sent: Thursday, March 2, 2017 4:59 PM  
 To: State Emergency Operations Officer (MIL); State Emergency Operations Officer (MIL); State Emergency Operations Officer (MIL)  
 Subject: NRC#1172350

NATIONAL RESPONSE CENTER 1-800-424-8802

\*\*\*GOVERNMENT USE ONLY\*\*\*GOVERNMENT USE ONLY\*\*\*

Information released to a third party shall comply with any applicable federal and/or state Freedom of Information and Privacy Laws

Incident Report # 1172350

INCIDENT DESCRIPTION

\*Report taken by: MST3 STEPHEN COOKE at 19:54 on 02-MAR-17  
 Incident Type: RAILROAD NON-RELEASE  
 Incident Cause: TRESPASSER  
 Affected Area:  
 Incident was discovered on 02-MAR-17 at 17:11 local incident time.  
 Affected Medium: RAIL REPORT (N/A) TRESPASSER FATALITY

---

REPORTING PARTY

Name: DANNY ANZURES  
 Organization: UNION PACIFIC RAILROAD  
 Address: 1400 DOUGLAS ST.  
 OMAHA, NE 68179

PRIMARY Phone: (888)8777267  
 Type of Organization: PRIVATE ENTERPRISE

---

SUSPECTED RESPONSIBLE PARTY

Name: UNKNOWN

Type of Organization: UNKNOWN

---

INCIDENT LOCATION

MP: 167.25 County: KING

SD: SEATTLE

City: KENT State: WA

---

RELEASED MATERIAL(S)

---

DESCRIPTION OF INCIDENT

CALLER IS REPORTING THAT A TRESPASSER WAS STRUCK BY A FREIGHT TRAIN AND RECEIVED FATAL INJURIES IN KENT, WA.

---

SENSITIVE INFORMATION

---

INCIDENT DETAILS

Grade Crossing: NO

Location Subdivision: SEATTLE

Railroad Milepost: 167.25

Type of Vehicle Involved:

Crossing Device Type:

Device Operational: YES

DOT Crossing Number:

Date and Time Service was/will be Restored:

Brake Failure: NO

Federal Post-Accident 219.201 Sub Part C Testing Required: NO

Passenger Train Route: YES

Passenger Train Delay Expected: UNK

Passenger Train Delay Handling:

---RAILROAD INFORMATION---

Railroad Involved: UNION PACIFIC RAILROAD

Train Number: LIS41 OF THE SECOND

Train Type: FREIGHT Train Direction:

Train Speed: Track Speed:

Locomotives: Cars: Derailed:

Suspected DOT Regulation Non Compliance: UNKNOWN

DERAILED CARS:

| Pos. | Carnumber | Type | Cargo |
|------|-----------|------|-------|
|------|-----------|------|-------|

---

IMPACT

Fire Involved: NO Fire Extinguished: UNKNOWN



INJURIES: NO Hospitalized: Empl/Crew: Passenger:  
FATALITIES: YES 1 Empl/Crew: 0 Passenger: 0 Occupant: 0  
EVACUATIONS:NO Who Evacuated: Radius/Area:

Damages: NO

|                                     | Hours  | Direction of |
|-------------------------------------|--------|--------------|
| Closure Type Description of Closure | Closed | Closure      |

Air: N  
Road: N Major Artery:N

Waterway: Y SINGLE MAIN LINE S

Track:

Environmental Impact: UNKNOWN

Media Interest: UNKNOWN Community Impact due to Material:

---

#### REMEDIAL ACTIONS

Release Secured: UNKNOWN

Release Rate:

Estimated Release Duration:

---

#### WEATHER

Weather: OVERCAST, 47°F

---

#### ADDITIONAL AGENCIES NOTIFIED

Federal:

State/Local:

State/Local On Scene:

State Agency Number:

---

#### NOTIFICATIONS BY NRC

CENTERS FOR DISEASE CONTROL (GRASP)

02-MAR-17 19:58 (770)4887100

CGIS D13 FIELD OFFICE (CGIS D13 COMMAND CENTER)

02-MAR-17 19:58 (206)2207141

CUSTOMS AND BORDER PROTECTION (INTEL BRANCH/BLAINE SECTOR)

02-MAR-17 19:58 (360)4107222

DHS DEFENSE THREAT REDUCTION AGENCY (CHEMICAL AND BIOLOGICAL TECHNOLOGI

02-MAR-17 19:58 (703)7673477

NATIONAL COORDINATING CTR FOR COMMS (NCC COMM-ISAC)

02-MAR-17 19:58 (703)2355626

DOT CRISIS MANAGEMENT CENTER (MAIN OFFICE)

02-MAR-17 19:58 (202)3661863

FEDERAL RAILROAD ADMIN. (MAIN OFFICE)

02-MAR-17 19:58 (202)4936242

FEMA REGION 10 (MAIN OFFICE)

02-MAR-17 19:58 (425)4874704

NATIONAL INFRASTRUCTURE COORD CTR (MAIN OFFICE)  
02-MAR-17 19:58 (202)2829201  
NOAA RPTS FOR WA (MAIN OFFICE)  
02-MAR-17 19:58 (206)5264911  
NATIONAL RESPONSE CENTER HQ (AUTOMATIC REPORTS)  
02-MAR-17 19:58 (202)2671136  
NTSB RAIL (MAIN OFFICE)  
02-MAR-17 19:58 (202)3146293  
HOMELAND SEC COORDINATION CENTER (MAIN OFFICE)  
02-MAR-17 19:58 (202)2828300  
OREGON TITAN FUSION CENTER (FUSION COMMAND CENTER)  
02-MAR-17 19:58 (877)6204702  
PORT OF SEATTLE (COMMAND CENTER)  
02-MAR-17 19:58 (206)7873117  
SEATTLE POLICE DEPARTMENT (CRIMINAL INTELLIGENCE SECTION)  
02-MAR-17 19:58 (206)6848770  
CITY OF SEATTLE, PUBLIC UTILITIES (SPILL RESPONSE TEAM)  
02-MAR-17 19:58 (206)6847988  
WA STATE EMERGENCY MANAGEMENT (MAIN OFFICE)  
02-MAR-17 19:58 (800)2585990  
WASHINGTON STATE FUSION CENTER (FUSION COMMAND CENTER)  
02-MAR-17 19:58 (877)8439522  
WASHINGTON STATE NATIONAL GUARD (COMMAND CENTER)  
02-MAR-17 19:58 (253)5128159

---

ADDITIONAL INFORMATION

---

\*\*\* END INCIDENT REPORT #1172350 \*\*\*

Report any problems by calling 1-800-424-8802  
PLEASE VISIT OUR WEB SITE AT <http://www.nrc.uscg.mil>

STATE OF WASHINGTON  
DEPARTMENT OF HEALTH

CERTIFICATE OF DEATH



DATE ISSUED: 03/31/2017  
FEE NUMBER: 66178578

CERTIFICATE NUMBER: 2017-011325

FIRST AND MIDDLE NAME(S): RYAN CARL  
LAST NAME(S): PATTERSON

COUNTY OF DEATH: KING  
DATE OF DEATH: MARCH 02, 2017  
HOUR OF DEATH: 03:08 PM  
SEX: MALE AGE: 37 YEARS  
SOCIAL SECURITY NUMBER: (4b)

HISPANIC ORIGIN: NO, NOT SPANISH/HISPANIC/LATINO  
RACE: WHITE

BIRTH DATE: (4b)  
BIRTHPLACE: PORTLAND, MULTNOMAH COUNTY, OREGON

MARITAL STATUS: SINGLE, NEVER MARRIED  
SPOUSE: NOT APPLICABLE

OCCUPATION: FLOORING INSTALLATION  
INDUSTRY: TILE AND STONE  
EDUCATION: HIGH SCHOOL GRADUATE OR GED COMPLETED  
US ARMED FORCES: NO

INFORMANT: SHAWNA L PATTERSON  
RELATIONSHIP: MOTHER  
ADDRESS: (4b)

CAUSE OF DEATH:  
A: MULTIPLE BLUNT FORCE INJURIES  
INTERVAL: SECONDS  
B:  
INTERVAL:  
C:  
INTERVAL:  
D:  
INTERVAL:

OTHER CONDITIONS CONTRIBUTING TO DEATH:

DATE OF INJURY: MARCH 02, 2017  
HOUR OF INJURY: 03:08 PM  
INJURY AT WORK: NO  
PLACE OF INJURY: RAILROAD

LOCATION OF INJURY: UNION PACIFIC RAIL & W. JAMES ST.

CITY, STATE, ZIP: KENT, WASHINGTON 98032  
COUNTY: KING

DESCRIBE HOW INJURY OCCURRED:  
STRUCK BY FREIGHT TRAIN AFTER INTENTIONALLY STEPPING INTO  
PATH OF ONCOMING TRAIN.

IF TRANSPORTATION INJURY, SPECIFY: NOT APPLICABLE

PLACE OF DEATH: OTHER PLACE  
FACILITY OR ADDRESS: UNION PACIFIC RAIL & W. JAMES ST.  
CITY, STATE, ZIP: KENT, WASHINGTON 98032

RESIDENCE STREET: (4b)  
CITY, STATE, ZIP: (4b)  
INSIDE CITY LIMITS: YES COUNTY: (4b)  
TRIBAL RESERVATION: NOT APPLICABLE  
LENGTH OF TIME AT RESIDENCE: 1 YEAR

FATHER/PARENT: RAYMOND CARL PATTERSON  
MOTHER/PARENT: SHAWNA LUCIA MOYA

METHOD OF DISPOSITION: CREMATION  
PLACE OF DISPOSITION: FIRST CREMATION SERVICES

CITY, STATE: KENT, WASHINGTON  
DISPOSITION DATE: MARCH 08, 2017

FUNERAL FACILITY: PERSONAL ALTERNATIVE FUNERAL SERVICES

ADDRESS: 749 N CENTRAL AVE  
CITY, STATE, ZIP: KENT, WASHINGTON 98032  
FUNERAL DIRECTOR: CALVIN L. TOLBERT

MANNER OF DEATH: SUICIDE  
AUTOPSY: YES  
WERE AUTOPSY FINDINGS AVAILABLE TO COMPLETE  
CAUSE OF DEATH: YES  
DID TOBACCO USE CONTRIBUTE TO DEATH: NO  
PREGNANCY STATUS IF FEMALE: NO RESPONSE

CERTIFIER NAME: MICHELINE LUBIN, MD  
TITLE:  
CERTIFIER ADDRESS: 325 9TH AVENUE #359792 MEDICAL EXAMINER  
CITY, STATE, ZIP: SEATTLE, WASHINGTON 98104  
DATE SIGNED: MARCH 03, 2017

CASE REFERRED TO ME/CORONER: YES  
FILE NUMBER: 17-0433  
ATTENDING PHYSICIAN: NOT APPLICABLE

LOCAL DEPUTY REGISTRAR: RUTH ROBERSON  
DATE RECEIVED: MARCH 08, 2017



# Affidavit for Correction

Mail to: Center for Health Statistics  
P.O. Box 47814  
Olympia, WA 98504-7814  
360-236-4300

This is a legal document. Complete in ink and do not alter.

### STATE OFFICE USE ONLY

|                   |            |          |      |                  |
|-------------------|------------|----------|------|------------------|
| State File Number | Fee Number | Initials | Date | Affidavit Number |
|-------------------|------------|----------|------|------------------|

|                 |  |  |  |                                      |
|-----------------|--|--|--|--------------------------------------|
| <b>Required</b> | <b>Record Type:</b> <input type="checkbox"/> Birth <input type="checkbox"/> Death <input type="checkbox"/> Marriage <input type="checkbox"/> Dissolution (Divorce) |  |  |                                      |
|                 | 1. Name on Record:<br>First Middle Last  |  | 2. Date of Event:<br>MM/DD/YYYY  | 3. Place of Event:<br>City or County |
|                 | 4. Father/Parent Full Legal Name (Spouse A for Marriage or Dissolution)<br>First Middle Last/Maiden  |  | 5. Mother/Parent Full Birth Name (Spouse B for Marriage or Dissolution)<br>First Middle Last/Maiden  |                                      |
|                 | 6. Name of Person Requesting Correction:   |  | Relationship to Person on Record: <input type="checkbox"/> Self <input type="checkbox"/> Guardian <input type="checkbox"/> Informant <input type="checkbox"/> Hospital <input type="checkbox"/> Parent(s) <input type="checkbox"/> Funeral Director <input type="checkbox"/> Other (specify) |                                      |
|                 | 7. Return Mailing Address:<br>P.O. Box or Street Address City State Zip  |  |  |                                      |
|                 | Telephone Number:<br>( )   |  | Email Address:   |                                      |

**Use the section below for requesting any changes on the record. The record is incorrect or incomplete as follows:**

| The record now shows: | The true fact is: |
|-----------------------|-------------------|
| 8.                    | 9.                |
| 10.                   | 11.               |
| 12.                   | 13.               |
| 14.                   | 15.               |

**I declare under penalty of perjury under the laws of the State of Washington that the forgoing is true and correct**

|                 |   |
|-----------------|---|
| 16a. Signature: | 16b. Signature of 2 <sup>nd</sup> parent (if required): |
| Printed name:   | Printed name:   |
| Date:           | Date:   |

**INSTRUCTIONS – go to [www.doh.wa.gov](http://www.doh.wa.gov) for more information**

**Driver's license, Social Security card or hospital decorative birth certificate cannot be used as proof**

Required documentary proof must be submitted with the affidavit and include full name and birth date. Examples of documentary proof include:

- Birth/Marriage/Divorce record
- Military record (DD-214)
- School transcripts
- Social Security Numident Report
- Certificate of Naturalization
- Hospital/medical record
- Passport
- Green/Permanent Resident card (I-551)

**Birth Certificates**

- Only a parent(s), legal guardian (if the child is under 18), or the named individual (if 18 or older) may change the birth certificate.
- The proof(s) must match the asserted fact(s). For example, if the affidavit says the name should be Mary Ann Doe, the proof must show the name to be Mary Ann Doe.
- Documentary proof must be five or more years old or established within five years of birth.

|  |  |
|--|--|
| <p><b>Child under 18</b></p> <ul style="list-style-type: none"> <li>• If legal guardian(s), include certified court order proving guardianship</li> <li>• Up to age one, last name can be changed once to either parents' name on certificate (can be any combination of the first, middle or last names)*</li> <li>• After age one, a court order is required to change the last name</li> <li>• No proof is required to change the first or middle name*</li> <li>• To correct parent's information, one documentary proof is required.</li> <li>• To correct the sex of the child, one documentary proof from a medical provider is required</li> </ul> | <p><b>Adult (18 years or older)</b></p> <ul style="list-style-type: none"> <li>• Only the adult can change his or her birth certificate</li> <li>• If the first or middle name is missing, three pieces of documentary proof are required</li> <li>• If the first, middle and/or last name is misspelled, or date of birth is incorrect, two pieces of documentary proof are required</li> <li>• To correct parent's birth date, place of birth, or name, one documentary proof is required</li> </ul> |
|--|--|

\*To change any part of the name of a child, signatures from both parents listed on the certificate are required. If one parent is deceased, submit a death certificate with request.

**This affidavit cannot be used to add a father to a birth certificate (use paternity acknowledgment form DOH 422-032)**

**Death Certificates**

- Only the informant, the funeral director, or executors/administrators (if evidence confirming such position is presented) may change the non-medical information. Proof is required to make changes if requested by a family member not listed as the informant on the certificate (family members are spouse or registered domestic partner, parent, sibling or adult child or stepchild). The informant may change marital status with proof. Marital status requires a certified copy of a court order if someone other than the informant is requesting the change.
- The medical information (cause of death) may be changed only by the certifying physician or the coroner/medical examiner.

**Marriage/Dissolution (Divorce) Certificates**

- Personal facts (minor spelling changes in name, date or place of birth or residence) may be changed by the person with one piece of documentary proof.
- To change the date or place of marriage or dissolution, the officiant (marriage) or clerk of court (dissolution) must complete and submit the affidavit.

DOH 422-034 October 2015



Certificate not valid unless the Seal of the State of Washington changes color when heat applied.



0 1 3 0 7 1 6 1