

TG-143880

CITY OF RICHLAND
PUBLIC WORKS DEPARTMENT
840 Northgate Drive, Richland WA 99352
Telephone (509) 942-7500



PO BOX 190 • RICHLAND, WA 99352 • CI.RICHLAND.WA.US

CERTIFIED MAIL
RETURN RECEIPT REQUESTED

November 4, 2014

Penny Ingram
Washington Utilities and Transportation Commission
PO Box 47250
Olympia, WA 98504-7250

RE: City of Richland Annexation
Ordinance No. 26-14

Dear Ms. Ingram:

The City of Richland annexed the LaPierre Annexation area by Ordinance No.26-14, approved on October 7, 2014. A copy of the ordinance is attached. The City understands that there are overlapping WUTC certificates for solid waste collection within that area: G-110, 118 and 237.

Consistent with RCW 35.13.280, the City gives notice to the WUTC of its decision that the City hereafter shall contract for solid waste collection or provide solid waste collection itself pursuant to RCW 81.77.020. Solid waste collection services will continue to be provided in the annexation area by contract with authorized rates corresponding to WUTC-approved tariff rates for services subject to the G-certificate.

If you have any questions about the City's handling of this issue, please contact me at 509-942-7558 or progalsky@ci.richland.wa.us.

Sincerely,

A handwritten signature in blue ink, appearing to read 'Pete Rogalsky', is written over the word 'Sincerely,'.

Pete Rogalsky, P.E.
Public Works Director
Administration & Engineering

Cc: Ed's Disposal, Inc.
Basin Disposal, Inc.
Waste Management of Washington, Inc.

Enclosure: Ordinance 26-14

RECEIVED
RECORDS MANAGEMENT
2014 NOV 10 AM 8:14
STATE OF WASH
UTIL. AND TRANSP
COMMISSION

WHEN RECORDED RETURN TO:

Richland City Clerk
P.O. Box 190 MS-05
Richland, WA 99352

A CERTIFIED TRUE COPY
Marcia Stephens
CITY CLERK

PID#1-102883012999001

COPY

ORDINANCE NO. 26-14

AN ORDINANCE of the City of Richland, Benton County Washington, annexing approximately 4.8 acres of land located north of Reata Road and south of the LaPierre Baseball Field, providing for assumption of existing City indebtedness and amending the Official Zoning Map.

WHEREAS, the City received a notice of intent from the sole owner of the real property legally described in Exhibit A attached hereto, to commence annexation proceedings for annexation into the City of Richland; and

WHEREAS, a meeting was held on the nineteenth day of November, 2013 between the initiating parties of this annexation and the Council of the City of Richland, at which time the Council passed Resolution No. 82-13, accepting the notice of intention to commence annexation proceedings for the real property legally described in Exhibit A attached hereto, subject to simultaneous adoption of the Comprehensive Plan for the proposed annexation area, and the assumption of the appropriate share of all existing City indebtedness; and

WHEREAS, Resolution 82-13 further authorized and directed the Richland Planning Commission to propose and forward a recommendation to the City Council as to the most appropriate zoning designation for the area proposed to be annexed; and

WHEREAS, a notice of intention to annex was duly filed with the Benton County Boundary Review Board. Jurisdiction of the boundary Review Board was not invoked within 45 days of filing, and thus the proposed annexation was deemed approved by the Boundary Review Board on April 16, 2014 and

WHEREAS, the Richland Planning Commission held a public hearing on December 18, 2013 to consider an appropriate zoning designation for the proposed annexation area;

WHEREAS, on May 6, 2014, Council passed Resolution No. 64-14, authorizing the circulation of an annexation petition for annexation of the real property legally described in Exhibit A attached hereto;

WHEREAS, a petition was circulated and signed by the sole owner of the proposed annexation area, thereby exceeding the state requirement that owners representing at least 60% of the value of the proposed annexation area petition the City for annexation, according to the assessed valuation for general taxation; and

WHEREAS, City Council held a public hearing to consider the annexation on September 2, 2014, which hearing was duly noticed by the City Clerk through publication in a newspaper of general circulation and through the mailing of notice to all property owners within the annexation area, specifying the time and place of the hearing and inviting interested persons to appear and voice approval or disapproval of the annexation; and

WHEREAS, the matter was duly considered by the City Council of the City of Richland and the Council has determined that the annexation would be of general benefit to the residents of the City of Richland;

NOW, THEREFORE, BE IT ORDAINED by the City Council of the City of Richland as follows:

Section 1.01 The real property legally described in Exhibit A attached hereto is hereby annexed to the City of Richland and is hereby declared to be within the corporate limits of the City of Richland, Benton County Washington (the "Annexed Area")

Section 1.02 The Richland Comprehensive Plan, adopted October 6, 1997 by Ordinance 26-97, shall serve as the comprehensive plan for the Annexed Area. All properties within the annexation shall be designated as "low density residential" under the land use map that is part of the comprehensive plan.

Section 1.03 The property within the Annexed Area shall be assessed and taxed at the same rate and on the same basis as other property within the City, including assessments or taxes in payment for all or of any portion of the outstanding indebtedness of the City, approved by the voters, contracted, or incurred prior to, or existing at the date of annexation.

Section 1.04 Title 23 of the City of Richland Municipal Code and the Official Zoning Map of the City as adopted by Section 23.08.040 of said title, hereby amends Sectional Map No. 68 which is one of a series of maps constituting said Official Zoning Map, bearing the number and date of passage of this ordinance and by this reference made a part of this ordinance and of the Official Zoning Map of the City.

Section 1.05 It is hereby found, as an exercise of the City's police power, that the best zoning for the properties included in the Annexed Area shall be R1-10 Single Family Residential, as depicted on Exhibit B, when consideration is given to the interest of the general public.

Section 1.06 The City Clerk is directed to file a copy of this annexation with the Board of Commissioners of Benton County and the State of Washington in the manner required by law. The City Clerk is also directed to file with the Auditor of Benton County, Washington a copy of this ordinance and shall attach the amended sectional map as necessary and an amended Annexation map, duly certified by the Clerk as a true copy.

Section 1.07 As authorized and required by RCW 35.13.280, the City shall negotiate a new franchise with the solid waste collection service provider currently serving the Annexed Area on terms that are acceptable to the City and that complies with the City's Solid Waste Management Plan.

Section 1.08 This ordinance shall be effective immediately following the day after its publication in the official newspaper of the City.

PASSED by the City Council of the City of Richland on this 7th day of October, 2014.

COPY



DAVID W. ROSE
Mayor

ATTEST:



MARCIA HOPKINS
City Clerk

APPROVED AS TO FORM:



HEATHER KINTZLEY
City Attorney

Date Published: October 12, 2014

EXHIBIT A

Legal Description for LaPierre Annexation

A portion of the Southwest quarter of Section 2, Township 8 North, Range 28 East W.M., described as follows:

Lot 1 of Short Plat #2999, Recorded 5 3 07, under Auditor's File number 2007-013745 in Volume 1 of Short Plat, Page 2999, Records of Benton County.

This legal description includes the following Assessor Parcel Number:

PD# 102883012999001

COPY

Benton County Auditor's Office Staff
determined that this page does not meet
their scanning requirements.

The page contained:

EXHIBIT B

Please contact the City Clerk's Office,
at the City of Richland, to obtain a
copy of this omitted page.

COPY

EXHIBIT B

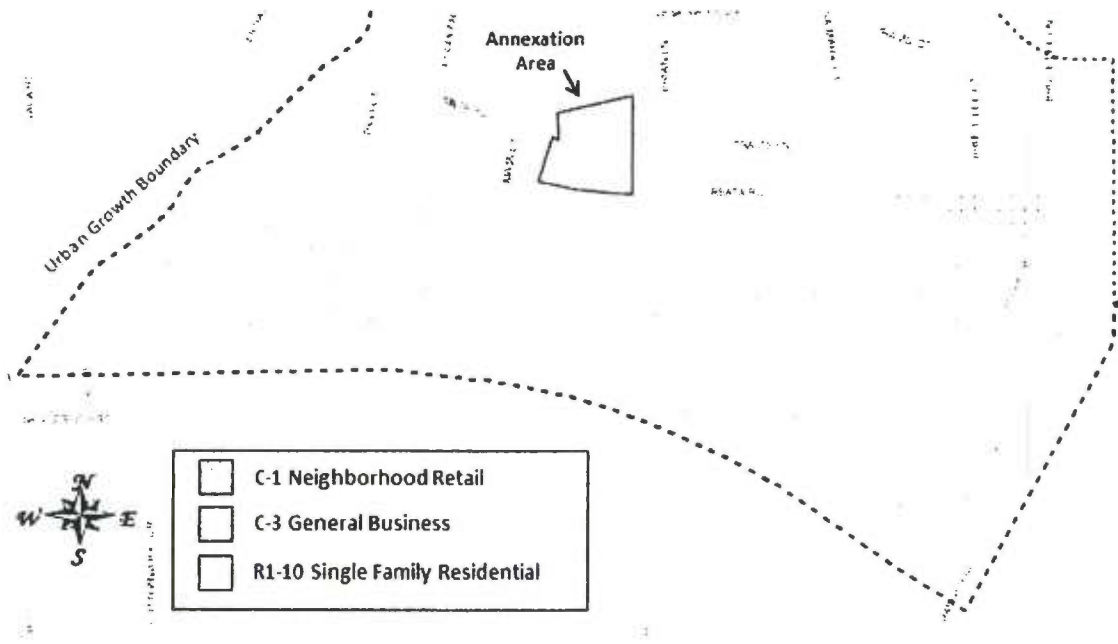

ZONING FOR LAPIERRE ANNEXATION

COPY

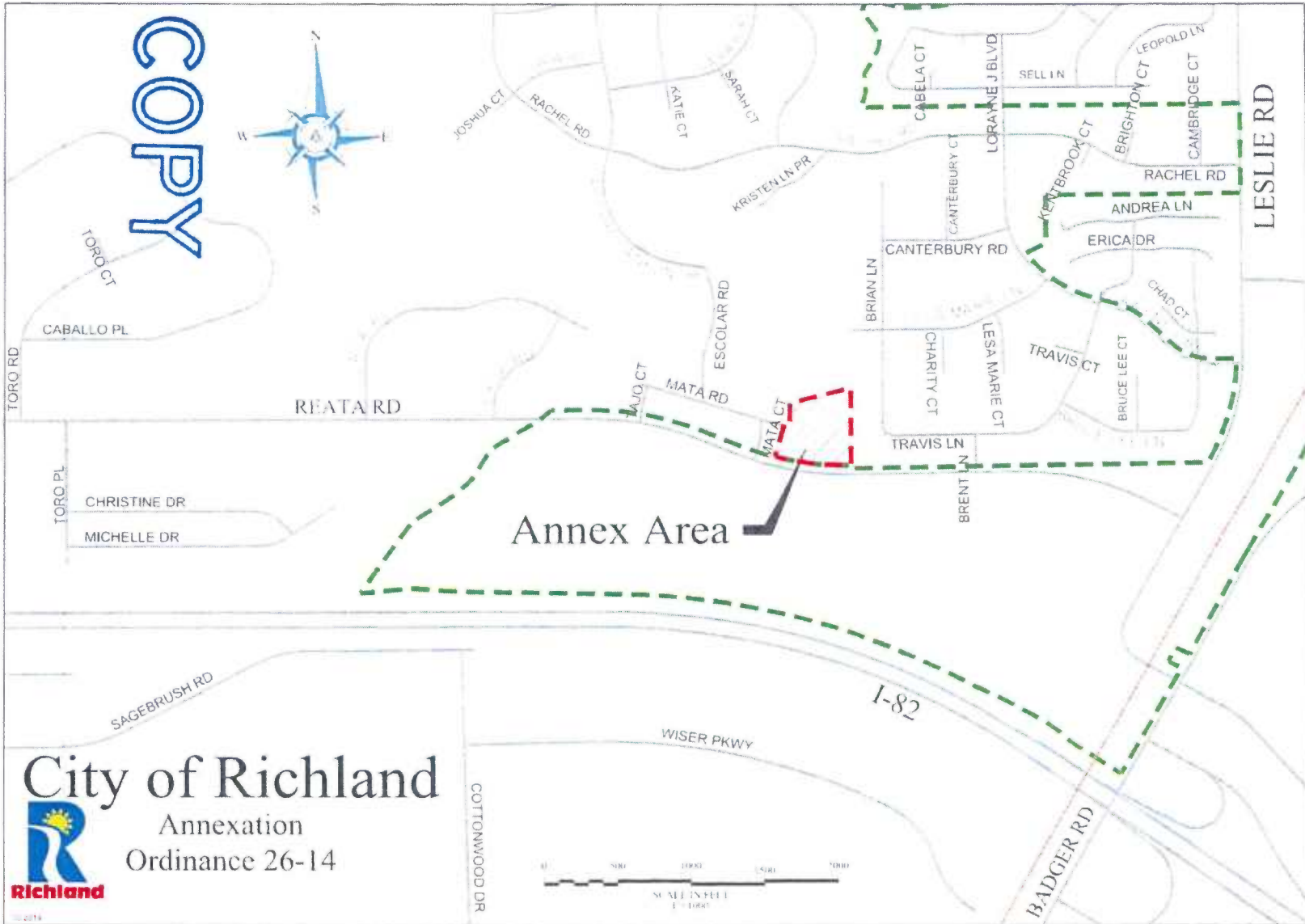

Annex Area

City of Richland



Annexation
Ordinance 26-14

