



T6-131577-CT

August 23, 2013

State of Washington
Utilities and Transportation Commission
P. O. Box 47250
Olympia, WA 98504-7250

2013 AUG 28 AM 9:09

RE: City of Moses Lake
Tax #7351 - Annexation of Territory
Regulation of Solid Waste Collection

Gentlemen:

Please be advised that the City of Moses Lake annexed certain territory, commonly known as the "Carlile Annexation," effective August 21, 2013. Enclosed is a copy of the City's annexation ordinance. Also enclosed is a copy of a letter sent to Consolidated Disposal Service, Inc. granting it a franchise for garbage service.

With this letter, the city provides notice to the WUTC of its decision to contract for solid waste collection in the "Carlile Annexation". By law, RCW 35A.14.900, with the city's decision to contract for solid waste collection in the "Carlile Annexation" area, the City grants a statutory franchise to the state's certificate holder in the "Carlile Annexation" area, Consolidated Disposal Service, Inc., to continue its solid waste collection business in the "Carlile Annexation" area for 10 years from the effective date of the annexation.

Very truly yours



Joseph K. Gavinski
City Manager

JKG:jt

Enclosure

ORDINANCE NO. 2685

AN ORDINANCE ANNEXING PROPERTY COMMONLY KNOWN AS THE CARLILE ANNEXATION TO THE CITY OF MOSES LAKE, WASHINGTON, AND INCORPORATING THE SAME WITHIN THE CORPORATE LIMITS OF THE CITY OF MOSES LAKE

THE CITY COUNCIL OF THE CITY OF MOSES LAKE, WASHINGTON DO ORDAIN AS FOLLOWS:

Section 1. The following described real estate, as shown on the attached map marked Exhibit A which by this reference is incorporated within this ordinance, situated in Grant County is hereby annexed to and incorporated in the City of Moses Lake:

Tax# 7351 - That portion of the west one half of Section 27, Township 20 North, Range 28 East W.M., Grant County, Washington, described as follows: Beginning at a point 7213.41 feet North and 1375.71 feet East of the Southeast corner of Section 33, said Township 20 North, Range 28 East W.M., (whose Washington State Grid South Zone Coordinates are Y=674,047.08 X=2,298,909.20 and referred to U.S.C. to G.S. Station "Spad" whose Washington State Grid South Zone Coordinates are Y=676,911.66 - X=2,288,625.74) said point being on the Westerly right-of-way line of a county road known as Randolph Road, this point being the True Point of Beginning; Thence North 17°17'29" East along the Westerly right-of-way line of said Randolph Road, a distance of 804.19 feet to a point hereby designated "A"; Beginning again at the True Point of Beginning; Thence North 72°41'35" West, a distance of 678.80 feet; Thence North 17°18'40" East, a distance of 130.18 feet; Thence North 72°41'20" West, a distance of 208.71 feet; Thence South 17°18'40" West, a distance of 130.20 feet; Thence North 72°41'35" West, a distance of 604.87 feet; Thence North 17°09'40" East, a distance of 401.39 feet; Thence North 72°41'35" West, a distance of 30 feet; Thence North 17°15'55" East to a point which bears North 72°41'35" West of Point "A"; Thence South 72°41'35" East, a distance of 1515 feet, more or less, to the hereinbefore designated Point "A", less road.

Parcel #171016000

Total Acreage - 26.23 acres

Section 2. All property within the territory annexed shall hereinafter be assessed and taxed at the same rate and on the same basis as other property within the city.

Section 3. The area annexed will be zoned H-I, Heavy Industrial.

Section 4. That a copy of this ordinance shall be filed with the Board of County Commissioners of Grant County, Washington.

Section 5. This ordinance shall take effect and be in force five (5) days after its passage and publication of its summary as provided by law.

Adopted by the City Council and signed by its Mayor on August 13, 2013.

ATTEST:

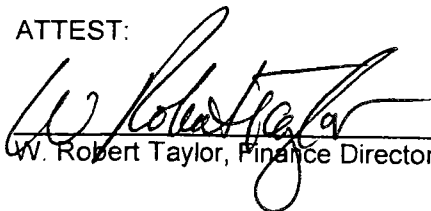
W. Robert Taylor, Finance Director

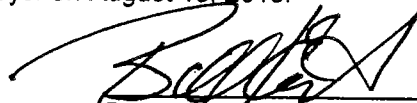
Bill J. Ecret, Mayor

APPROVED AS TO FORM:

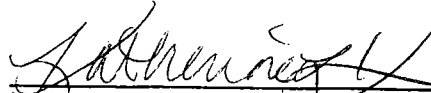
Katherine L. Kenison, City Attorney

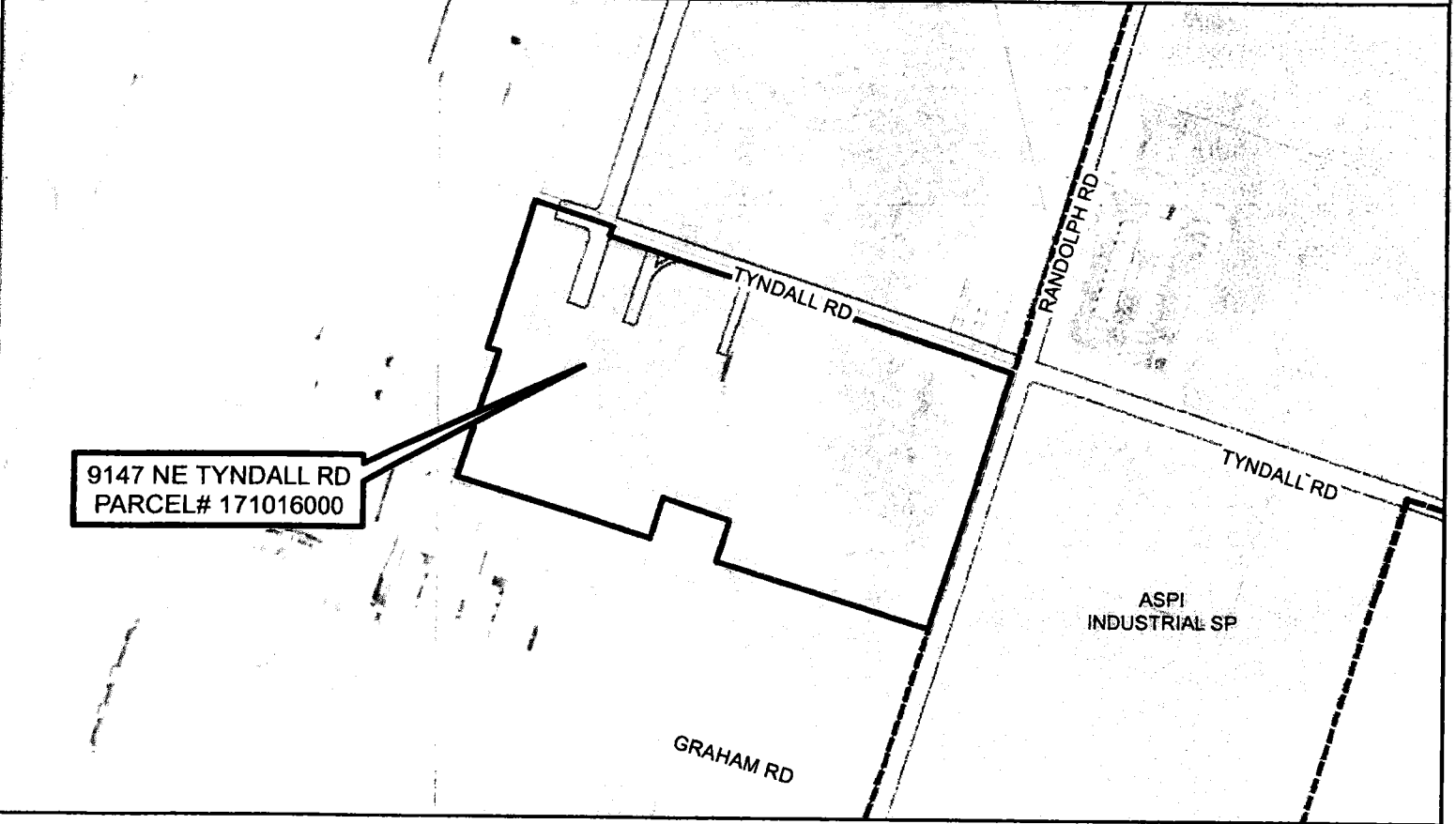
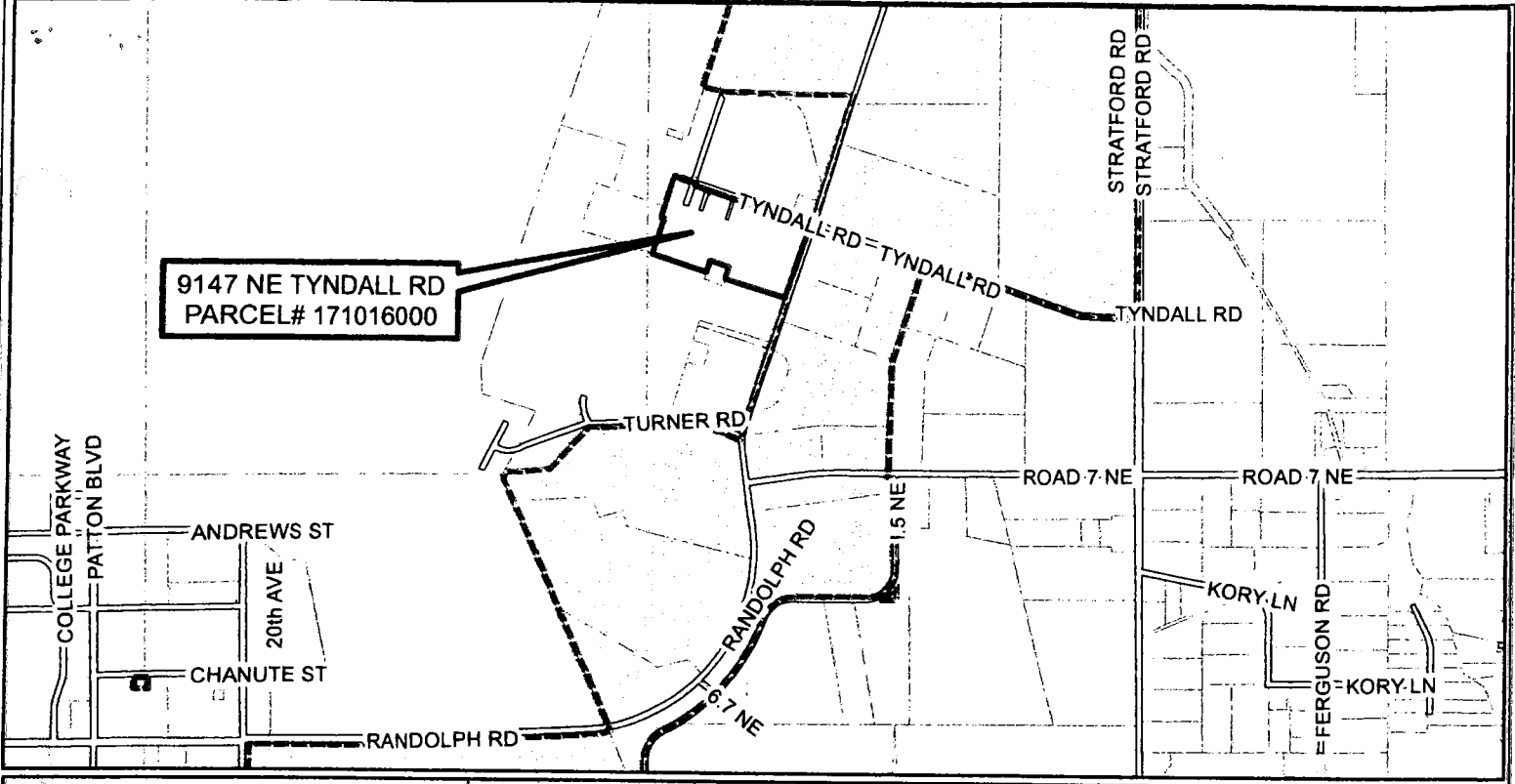

CURRENT USE: MISC COMMERCIAL
 GRANT COUNTY ZONE: URBAN HEAVY INDUSTRIAL

Exhibit A

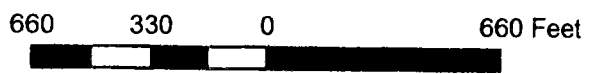
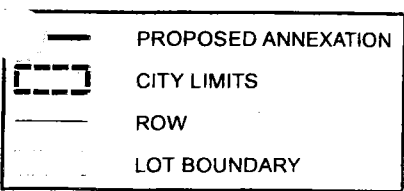

ANNEXATION
 COMMUNITY DEVELOPMENT
 PLANNING DIVISION

Date: 8/12/2013

CMS

Path: \\Gis-server\gis\Map_Requests\9147 NE TYNDALL RD.mxd



August 23, 2013

Dan Dietrich
Consolidated Disposal Service
P. O. Box 1154
Ephrata, WA 98823

RE: Carlile Annexation

Dear Mr. Dietrich

On August 13, 2013 the City of Moses Lake adopted Ordinance No. 2685 which provided for the annexation of 26.23 acres of property located at the intersection of Randolph Road and Tyndall Road. The property is contiguous to the City of Moses Lake's corporate limits. The ordinance became effective on August 21, 2013. Pursuant to RCW 35A.14.900 the City grants Consolidated Disposal a franchise to continue collecting the solid waste from that area for ten years from August 21, 2013. For your information, enclosed is the ordinance and a map showing the annexed area.

If you have any questions or comments, please contact me.

Very truly yours

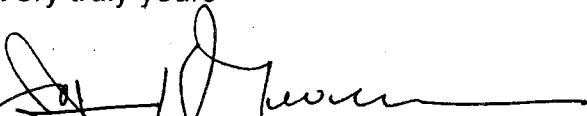

Joseph K. Gavinski
City Manager

JKG:jt

Enclosure

cc: Finance Director
Utility Account Technician
Lakeside Disposal, 2000 W. Broadway, Moses Lake, WA 98837
Utilities and Transportation Commission