



City of Olympia | Capital of Washington State

P.O. Box 1967, Olympia, WA 98507-1967

TG-131508 CT

2013 AUG 16 AM 8:04

August 12, 2013

Washington Utilities and Transportation Commission
PO Box 47250
Olympia, WA 98504-7250

Enclosed for the records of the Washington Utilities and Transportation Commission (WUTC) is annexation ordinance 6859 adopted by the City of Olympia. The ordinance incorporates the legal description of the area (collectively, "annexed territory").

This annexation cancels the franchises or permits of any person, firm or corporation authorized or permitted to operate a public service business within the limits of the annexed territory. By this correspondence, the City notifies the WUTC of its decision to contract for solid waste collection or provide solid waste collection itself (RCW 35A.14.900). The existing franchise (G-certificate) holder is no longer subject to WUTC regulation within the annexed territory.

Please do not hesitate to contact me at 360.753.8282 if you have any questions in this regard.

Sincerely,

Debbie Krumpols
City Clerk
Administrative Services Department

Enclosures

copy: LeMay Enterprises
Dan Daniels, Waste ReSources
City Attorney's Office

olympiawa.gov

CITY OF OLYMPIA
P.O. BOX 1967
OLYMPIA, WA 98507-1967

Document Title(s) (or transactions contained therein): Ordinance #6859 Annexing to the City of Olympia 8.69 acres and adjacent street rights-of-way located at 1412 Boulevard Rd SE
Reference Number(s) of Documents assigned or released: (on page ____ of document(s))
Grantor 1. City of Olympia
Grantee(s) (Last name first, then first name and initials) 1. The Public
Legal Description (abbreviated: i.e. lot, block, plat or section, township, range) McKinley School Annexation Area, East half of NE QTR of Section 24, Township 18N, Range 2W, Willamette Meridian. Additional legal is on page 4 of document.
Assessors Property Tax Parcel/Account Number 48800800100 09480059000 09480058000 Additional legal is on page ____ of document.

The Auditor/Recorder will rely on the information provided on this form. The staff will not read the document to verify the accuracy or completeness of the indexing information provided herein.

I am requesting an emergency nonstandard recording for an additional fee as provided in RCW 36.18.010. I understand that the recording processing requirements may cover up or otherwise obscure some part of the text of the original document.

Signature of Requesting Party

4349108

07/19/2013 12:32 PM
Thurston County Washington
CITY OF OLYMPIA

Ordinance

Pages: 4



Ordinance No. 6859

AN ORDINANCE OF THE CITY OF OLYMPIA, WASHINGTON, ANNEXING TO THE CITY OF OLYMPIA 8.69 ACRES AND ADJACENT STREET RIGHTS-OF-WAY LOCATED AT 1412 BOULEVARD ROAD, SE, LYING CONTIGUOUS TO OLYMPIA CITY LIMITS AND WITHIN THE OLYMPIA URBAN GROWTH AREA.

WHEREAS, the owners of sixty percent (60%) of the assessed valuation of the real property described in Exhibit A attached hereto and incorporated herein, have previously notified the City of Olympia that they intended to commence proceedings to annex said property to the City of Olympia, and said city has previously agreed to accept said proposed annexation and likewise determined that the City of Olympia would require the assumption of said annexed areas of its fair share of any existing indebtedness of the City of Olympia; and

WHEREAS, a written petition signed by the Applicant representing over 60% in value according to the assessed valuation of said property was filed requesting annexation of said property to the City of Olympia; and

WHEREAS, a date for a public hearing on said petition was fixed by the City Council of the City of Olympia and notice of said hearing was published in a newspaper of general circulation in the City of Olympia and was likewise posted in the area proposed to be annexed in the manner required by law and affidavits of publications and posting of said notice have been filed with the City Clerk; and

WHEREAS, the notice so published and posted provided said hearing be held on March 12, 2013, at 7:00 p.m. at the Council Chambers of Olympia City Hall; and

WHEREAS, said hearing was held in accordance with the provisions of RCW 35A.14.130; the City Council found that said petition was signed by the party representing more than 60% in value according to the assessed valuation of the property described therein; said area proposed to be annexed is contiguous to the City of Olympia; and the petition and hearing thereon were in all things regular and notice thereof was given as provided by law.

NOW, THEREFORE, THE OLYMPIA CITY COUNCIL ORDAINS AS FOLLOWS:

Section 1. That the property described in Exhibit A contiguous to the City of Olympia be, and the same is hereby annexed to and made a part of the City of Olympia and is subject to the laws and ordinances now and hereafter in effect; provided, however, that the property within the limits of said annexed area shall be taxed or assessed to pay its share of any bonded indebtedness of the City of Olympia contracted prior to or released from any taxes or assessments levied against it or from any liability for the payment of any outstanding bonds or warrants issued prior to such annexation; provided further, that said property hereby annexed shall be subject to readdressing of existing street names and/or numbers if they are not consistent with either the established City of Olympia "100 Block" Grid Designation or the street naming conventions in Olympia Municipal Code Title 12, Section 48; and provided further, that said property hereby annexed shall be and hereby is given the zoning designations of Single-Family Residential (R4-8).

Section 2. Pursuant to RCW 35.A.14.900, the City of Olympia plans to assume solid waste collection in the area here annexed in seven (7) years. The transition period therefore begins to run on the effective of this Ordinance.

Section 3. Effective Date. This Ordinance shall be in effect five days after its passage and publication. Thereafter, the area described herein shall become a part of the City of Olympia.

Section 4. Severability. The provisions of this Ordinance are declared separate and severable. If any provision of this ordinance or its application to any person or circumstances is held invalid, the remainder of this ordinance or application of the provision to other persons or circumstances, shall be unaffected.

Section 5. Ratification. Any act consistent with the authority and prior to the effective date of this Ordinance is hereby ratified and affirmed.



MAYOR

ATTEST:

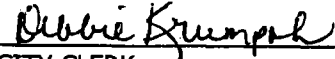

CITY CLERK

APPROVED AS TO FORM:

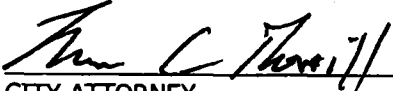

CITY ATTORNEY

PASSED: 7/16/2013

APPROVED: 7/16/2013

PUBLISHED: 7/19/2013

EXHIBIT A

Date: February 20, 2013
Project: McKinley School Annexation

CITY OF OLYMPIA MCKINLEY SCHOOL ANNEXATION AREA

McKinley School Annexation Area, situated in the East Half of the Northeast Quarter of Section 24, Township 18 North, Range 2 West, Willamette Meridian, Thurston County, Washington, said Annexation Area is contained and bounded within the following described area:

BEGINNING at the intersection of the North right-of-way of 12th Ave. SE extended west and the West right-of-way of Boulevard Road SE;

Thence Southerly along the West right-of-way of said Boulevard Road SE extended to the intersection with the South right-of-way of 15th Ave. SE (Dayton Street);

Thence Easterly along the South right-of-way of said 15th Ave SE to the intersection with the extended East line of the West Half of the Southeast Quarter of the Northeast Quarter of the Northeast Quarter of said Section 24;

Thence Northerly along said extended East line to the North line of the Southeast Quarter of the Northeast Quarter of the Northeast Quarter of said Section 24;

Thence Westerly along said North line to the intersection with the West line of the West Half of the Southeast Quarter of the Northeast Quarter of the Northeast Quarter of said Section 24;

Thence Northerly along said West line to the intersection with the North right-of-way of 12th Ave. SE;

Thence Westerly along said North right-of-way to the **POINT OF BEGINNING**.

Said annexation area contains 11.7 acres more or less.

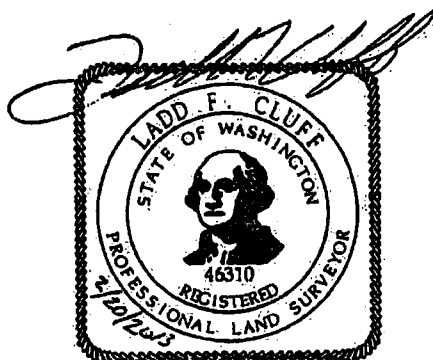

-This page for reference
-Not recorded at Thurston County

Olympia School District 111 Annexation
Olympia Regional Learning Academy
Annexation Parcel Valuations
February 22, 2013

	Property Owner	Assessor Parcel No.	Acres	Assessor's Valuation	Signed Petition	% Total
1	OSD 111	48800800100	3.82 Acres	\$ 244,300	Yes	40.6 %
2	OSD 111	09480059000	4.77 Acres	\$ 304,750	Yes	50.7%
3	Thurston County	09480058000	0.10 Acre	\$ 52,100	No	--
		TOTALS	8.69 Acres	\$ 601,150	2	91.3%

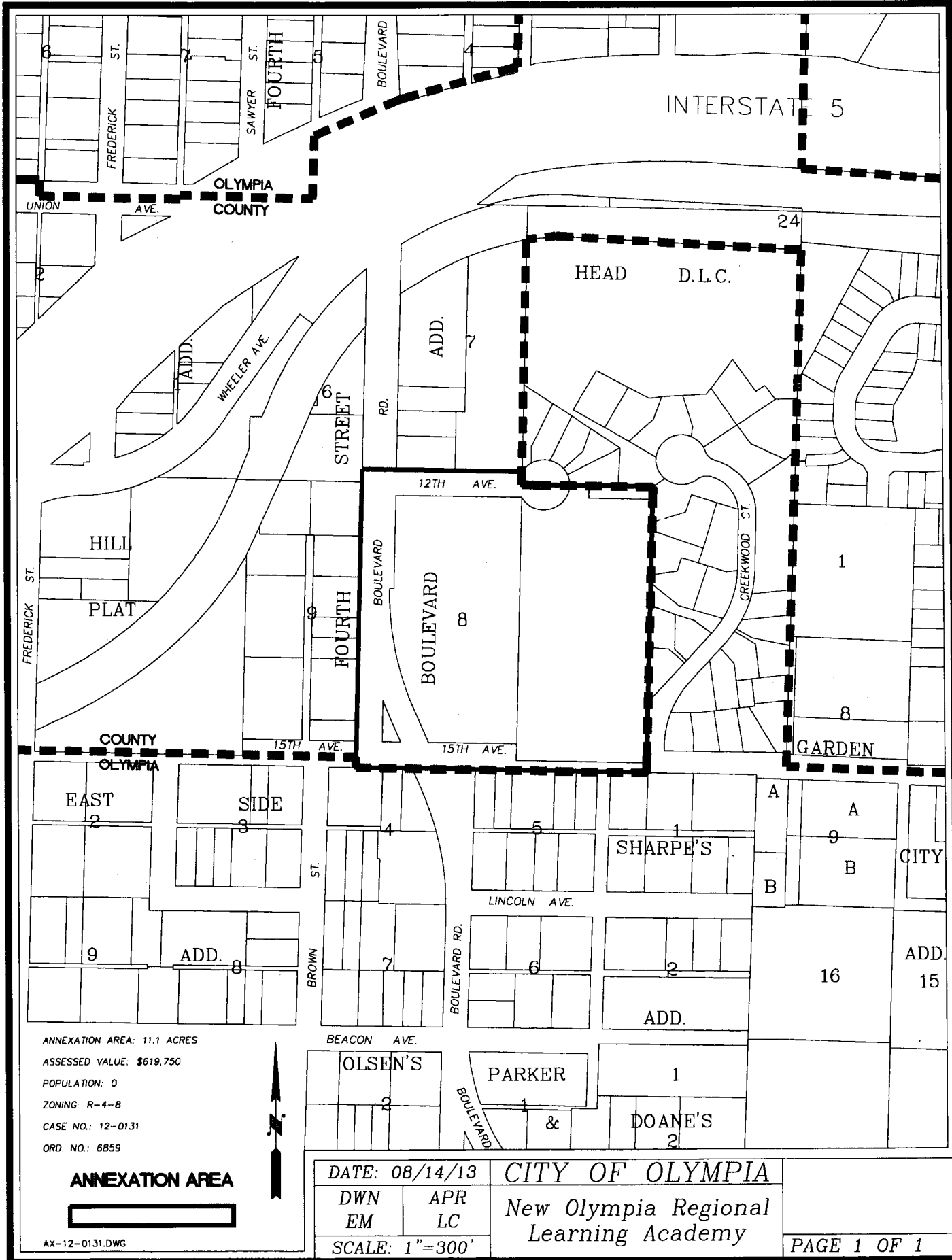

ANNEXATION AREA: 11.1 ACRES
 ASSESSED VALUE: \$619,750
 POPULATION: 0
 ZONING: R-4-B
 CASE NO.: 12-0131
 ORD. NO.: 6859

ANNEXATION AREA



AX-12-0131.DWG

BEACON AVE.

OLSEN'S

PARKER

DOANE'S

DATE: 08/14/13

CITY OF OLYMPIA

DWN EM APR LC

New Olympia Regional Learning Academy

SCALE: 1"=300'

PAGE 1 OF 1