

WASHINGTON UTILITIES AND TRANSPORTATION COMMISSION

RECEIVED
 PROJECTS MANAGEMENT
 2012 JAN 20 PM 1:45
 STATE OF WASHINGTON
 UTILITIES AND TRANSPORTATION
 COMMISSION

)	DOCKET NO. TR-
)	
Port of Chelan County)	PETITION FOR INSTALLATION OF
_____)	SIDEWALKS AT A HIGHWAY-RAIL
Petitioner,)	GRADE CROSSING
)	
vs.)	
BNSF)	
_____)	
Respondent)	USDOT CROSSING NO.: 065843K
)	
)	
.....)	

The Petitioner asks the Washington Utilities and Transportation Commission to approve installation of sidewalks at a highway-rail grade crossing.

Section 1 – Petitioner’s Information

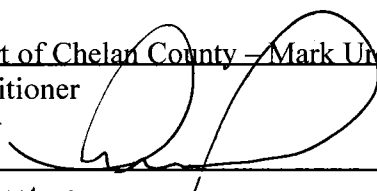
Port of Chelan County – Mark Urdahl
Petitioner

Signature
238 Olds Station Road, Suite A
Street Address
Wenatchee, WA 98801
City, State and Zip Code

Mailing Address, if different than the street address
Laura Jaecks
Contact Person Name
509-661-3118 laura@ccpd.com
Contact Phone Number and E-mail Address

Section 2 – Respondent's Information

BNSF Railway Company
Respondent
2454 Occidental Ave. S., Suite 2D
Street Address
Seattle, WA 98134-1451
City, State and Zip Code
Mailing Address, if different than the street address
Megan McIntyre
Contact Person Name
206-625-6413 megan.mcintyre@bnsf.com
Contact Phone Number and E-mail Address

Section 3 – Crossing Location

1. Name of highway/roadway	Olds Station Road		
2. Name of railroad	BNSF		
3. USDOT Crossing No.	065843K		
4. Located in the	NE 1/4 of the NE 1/4 of Sec. 28, Twp. 23N, Range 20E W.M.		
5. GPS location, if known	Lat. 47.4623611, Long. -120.3302435		
6. Railroad mile post (nearest tenth)	3.13		
7. City	Wenatchee	County	Chelan

Section 4 – Current Crossing Traffic

1. Type of public road at the crossing State County City
 Port State Park Other _____
2. Average daily vehicle traffic over the tracks 600 Vehicle speed limit 25 mph
3. Trucks (commercial vehicles) are what percent of average daily traffic 16%
4. Number of school buses over the crossing each day 0
5. Name of railroad(s) operating at crossing BNSF, Cascade & Columbia River Railroad (CSCD)

6. Type of railroad at crossing Common Carrier Logging Industrial
 Passenger Excursion
7. Type of tracks at crossing Main Line Siding or Spur
8. Number of tracks at crossing Currently 3, 1 to be removed by BNSF
9. Average daily train traffic, freight 1
Authorized freight train speed 5-10 mph Operated freight train speed _____
10. Average daily train traffic, passenger 0
Authorized passenger train speed _____ Operated passenger train speed _____

Section 5 – Justification

1. Provide the following information:

- a. Provide a description of the type of sidewalks proposed.
- c. Describe who will maintain the sidewalks.
- d. Attach a proposed diagram or design of the crossing including the sidewalks.
- e. Describe changes to the active warning devices, if affected by the project.

a) The proposed sidewalk is a 5.5' wide (including the curb) concrete sidewalk
and is proposed along the North side of Olds Station Road.

c) The Port of Chelan County is the adjacent property owner and will maintain the
sidewalk.

d) See attached exhibit

e) None

Section 6 – Waiver of Hearing by Respondent

Waiver of Hearing

The undersigned represents the Respondent in the petition to install sidewalks at the following crossing.

USDOT Crossing No. 065843K

We have investigated the conditions at the crossing. We are satisfied the conditions are the same as described by the Petitioner in this docket. We agree installation of sidewalks should be made and consent to a decision by the commission without a hearing.

Dated at Seattle, Washington, on the 13th day of January, 20 12.

Megan T. McIntyre
Printed name of Respondent

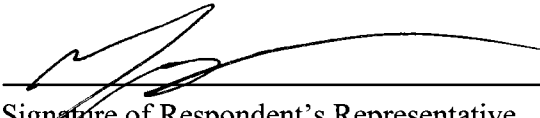
Signature of Respondent's Representative

Manager Public Projects
Title

BNSF Railway Co.
Company Name

206-625-6413 megan.mcintyre@bnsf.com
Phone number and e-mail address

2454 Occidental Ave S. # 2-D

Seattle, WA 98134
Mailing address

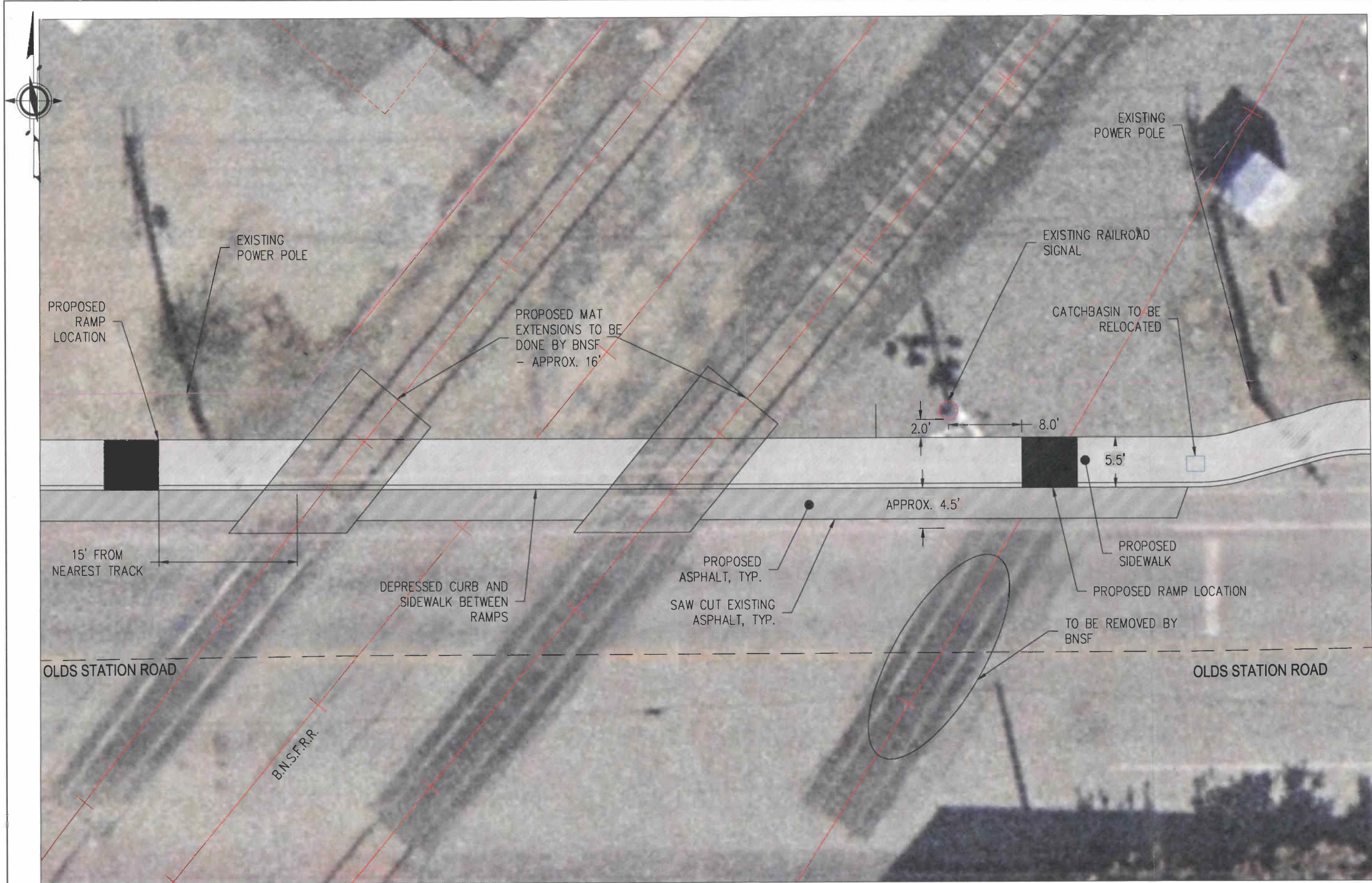

PORT OF CHELAN COUNTY
OLDS STATION SIDEWALK IMPROVEMENTS

RAILROAD CROSSING



RH2 ENGINEERING INC.
 http://www.rh2.com
 mail@rh2.com 1.800.720.8052
 BELLINGHAM 360.876.0838
 454 West Horton Road
 BOTHELL 425.815.1840
 22722 29th Drive SE, Suite 210
 EAST WENATCHEE 509.826.2800
 300 Simon Street, Suite 5
 RICHLAND 509.948.5181
 114 Columbia Point Drive, Suite C
 SILVERDALE 360.876.7940
 2021 NW Myre Rd, Suite 107
 TACOMA 253.272.3659
 621 Pacific Avenue Suite 104

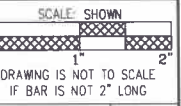

RAILROAD CROSSING PLAN USDOT
CROSSING NO: 065843K EXHIBIT
 1" = 5'

PLT: 1	DWG NO:
ENGINEER: RPC	C03
REVIEWED: SJF	
DATE: OCT 20, 2011	SHEET NO: XX
CLIENT: PCC	
JOB NO: 211-065	
FILENAME: OLDS STA-P-RR CROSSING	