

WASHINGTON UTILITIES AND TRANSPORTATION COMMISSION

)	DOCKET NO. TR-
)	
City of Battle Ground)	PETITION FOR INSTALLATION OF
_____)	SIDEWALKS AT A HIGHWAY-RAIL
Petitioner,)	GRADE CROSSING
)	
vs.)	
Clark County)	USDOT CROSSING # <i>8523502L</i>
_____)	
Respondent)	UTC CROSSING #
)	
.....)	
_____)	

The Petitioner asks the Washington Utilities and Transportation Commission to approve installation of sidewalks at a highway-rail grade crossing.

Section 1 – Petitioner’s Information

City of Battle Ground	_____
Petitioner	
109 SW 1 st St, Suite 127	_____
Street Address	
Battle Ground, WA 98604	_____
City, State and Zip Code	
109 SW 1 st St, Suite 127	_____
Mailing Address, if different than the street address	
Marit Ernst	_____
Contact Person Name	
360-666-3038 marit.ernst@ci.battle-ground.wa	_____
Contact Phone Number and E-mail Address	

Section 2 – Respondent's Information

Clark County
Respondent
1300 Franklin St, Ste #650
Street Address
Vancouver, WA 98666
City, State and Zip Code
PO Box 5000
Mailing Address, if different than the street address
Fred Abraham
Contact Person Name
360-397-2323ext4113 Fred.Abraham@clark.wa.gov
Contact Phone Number and E-mail Address

Section 3 – Crossing Location

1. Name of highway/roadway	E Main Street						
2. Name of railroad	Portland Vancouver Junction Railroad(PVJR) –owned by Columbia Basin						
3. USDOT Crossing No.	852350U	UTC Crossing No.					
4. Located in the	SW 1/4 of the SW 1/4 of Sec. 35	Twp.	4	Range	2	W.M.	E
5. GPS location, if known	45° 46' 51.7" N, 122° 31' 42.3" W						
6. Railroad mile post (nearest tenth)	14.1						
7. City	Battle Ground	County	Clark				

Section 4 – Current Crossing Traffic

1. Type of public road at the crossing State County City
 Port State Park Other _____

2. Average daily vehicle traffic over the tracks 5164 Vehicle speed limit 25 mph

3. Trucks (commercial vehicles) are what percent of average daily traffic 9%

4. Number of school buses over the crossing each day 46

5. Name of railroad(s) operating at crossing Columbia Basin

6. Type of railroad at crossing Common Carrier Logging Industrial
 Passenger Excursion

7. Type of tracks at crossing **1** Main Line **1** Siding or Spur

8. Number of tracks at crossing 2

9. Average ~~daily~~ train traffic, freight 1 per week
Authorized freight train speed 10 mph Operated freight train 10 mph or less

10. Average daily train traffic, passenger N/A
Authorized passenger train speed _____ Operated passenger train speed _____

Section 5 – Justification

1. Provide the following information:

- a. Provide a description of the type of sidewalks proposed.
- c. Describe who will maintain the sidewalks.
- d. Attach a proposed diagram or design of the crossing including the sidewalks.

As part of a Transportation Improvement Board grant, the City is proposing to improve the sidewalk on the northern side of E Main St. A portion of this pedestrian improvement project will cross the 100-foot railroad right-of-way. Currently the sidewalk area is asphalted and is used by pedestrians crossing from the downtown area to the Skate Park/Community Center. The asphalt was not properly installed and is buckling directly adjacent to the track. We propose to cut the asphalt within 3-feet of the tracks, replace the asphalt, paint two 6-inch lines and provide detectable warning strips on either side of the tracks. The City of Battle Ground will maintain this pedestrian crossing.

Section 6 – Waiver of Hearing by Respondent

Waiver of Hearing

The undersigned represents the Respondent in the petition to install sidewalks at the following crossing.

USDOT Crossing No. 852350U UTC Crossing No. _____

We have investigated the conditions at the crossing. We are satisfied the conditions are the same as described by the Petitioner in this docket. We agree installation of sidewalks should be made and consent to a decision by the commission without a hearing.

Dated at Battle Ground, Washington, on the 17th day of
May, 2010.

Fred Abraham

Printed name of Respondent



Signature of Respondent's Representative

Clark County Railroad Coordinator

Title

360-397-2323 ext 4113, Fred.Abraham@clark.wa.gov

Phone number and e-mail address

PO Box 5000,

Vancouver, WA 98666

Mailing address

*City of Battle Ground, Public Works Engineering
109 SW 1st. St. Ste 122
Battle Ground, WA 98604
Phone: (360) 342-5070 FAX: (360) 342-5051*

RECEIVED

AUG 23 2010

WASH. UT. & TP. COMM.

Letter of Transmittal

August 18, 2010

Kathy Hunter
UTC Deputy Assistant Director, Transportation Safety
13000 S Evergreen Park Drive SW
PO Box 47250
Olympia, WA 98504-7250

Kathy –

Enclosed is the UTC application for the E Main St Sidewalk Improvements project which we spoke about in May of this year. We scaled back the scope of the project due to budget constraints and are only replacing 243 square feet of asphalt, installing two detectable warning tiles and painting two 6-inch lines in the railroad right-of-way. Please refer to page 5, 8, 12 and 14 of the attached reduced size plans for details of construction in the railroad ROW. We are constructing the base bid and did not go with alternate 1.

If you have any questions, please feel free to contact me.

Sincerely,



Marit Ernst, Associate Civil Engineer

City of Battle Ground
109 SW 1st St., Ste. 122
Battle Ground, WA 98604
(360) 342-5051

EAST MAIN STREET SIDEWALK IMPROVEMENTS

OF BATTLE GROUND

PROJECT #TR0309

TIB #P-W-948(P01)-1

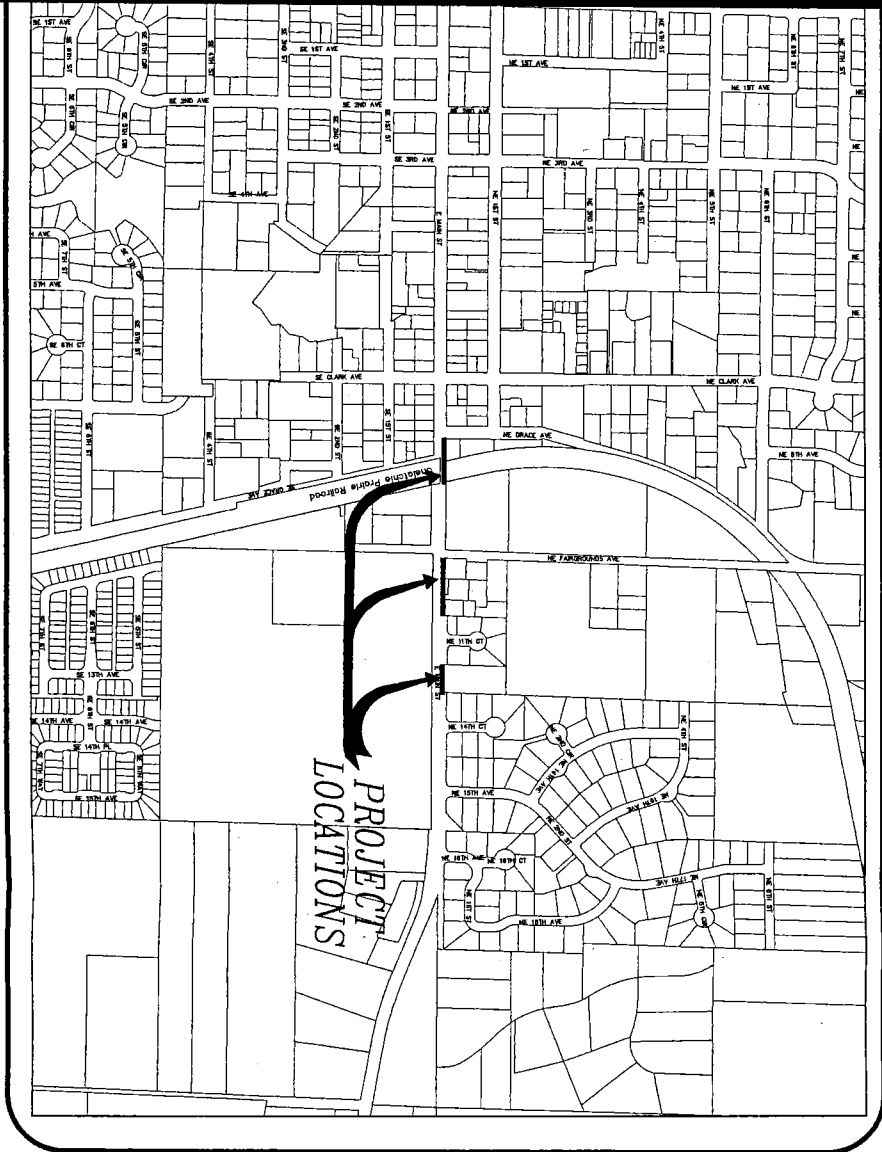

SITE MAP

SW OTR SEC 35 T4N R2E / SE OTR SEC 35 T4N R2E

MICINITY MAP



SHEET INDEX

SHEET NO.	DESCRIPTION
1	COVER SHEET
2	EXISTING & GENERAL NOTES STA 0+00 - 10+00
3	EXISTING CONDITIONS STA 10+00 - 12+00
4	BASE & ALTERNATE 1 DEMOLITION & EROSION CONTROL PLAN STA 0+00 - 5+00
5	DEMOLITION & EROSION CONTROL PLAN STA 5+00 - 10+00
6	STREET/STORM PLAN AND PROFILE STA 0+00 - 5+00
7	STREET/STORM PLAN AND PROFILE STA 5+00 - 10+00
8	ALTERNATE 1 STREET/STORM PLAN AND PROFILE STA 0+00 - 5+00
9	ALTERNATE 2 STREET/STORM PLAN AND PROFILE STA 0+00 - 5+00
10	STREET/STORM PLAN AND PROFILE STA 5+00 - 10+00
11	STREET/STORM PLAN AND PROFILE STA 10+00 - 12+70
12	CROSS SECTIONS AND CURB RETURNS
13	SIGNING & STRIPING & LANDSCAPING STA 0+00 - 5+50
14	SIGNING & STRIPING & LANDSCAPING STA 5+50 - 12+70
15	EROSION CONTROL DETAILS
16	TRANSPORTATION DETAILS
17	TRANSPORTATION DETAILS
18	TRANSPORTATION DETAILS
19	STORM DETAILS
20	STORM DETAILS
21	STORM DETAILS



CITY OF BATTLE GROUND
 109 S.W. 1ST. STREET
 SUITE 122
 BATTLE GROUND, WA 98604
 ENGINEERING 360-342-5070

No.	Revision/Issue	Date
1	REVISION 1 - TOPD	7/29



CITY OF BATTLE GROUND
 E MAIN ST SIDEWALK IMPROVEMENTS
 COVER SHEET



DESIGNED	
DRAWN	JMH
HR.	N/A
VERT.	N/A
DATE	7/22/2010
DWG.	G01
SHEET 1 OF 21	

LEGEND

EXISTING

- BUILDING OUTLINE
- ROCKWALK/CONCRETE
- SIDEWALK/CONCRETE
- ASPHALT
- CURB LINE
- PARCEL/LOT LINE
- EASEMENT
- RIGHT-OF-WAY LINE
- CHAIN LINK FENCE
- WOOD FENCE
- UNDERGROUND FIBER OPTIC LINE, # OF PARALLEL LINES
- UNDERGROUND ELECTRICAL LINE
- STORM LINE
- SANITARY SEWER LINE
- WATER LINE
- GAS LINE
- OVER HEAD UTILITY
- DITCH LINE
- GAS METER
- GAS VALVE
- TELEPHONE MANHOLE
- POWER POLE
- OVERHEAD LIGHT
- LUMINAIRE
- GUY ANCHOR
- POWER POLE/OVERHEAD LIGHT
- CABLE TV PEDESTAL
- TREE
- TRASH CAN
- WATER VALVE
- WATER METER
- FIRE HYDRANT
- SIGN
- SANITARY MANHOLE
- DRAIN BASIN
- CATCH BASIN
- CURB INLET
- DITCH INLET
- STORM MANHOLE
- SANITARY/STORM CLEAN OUT
- BOLLARD
- NO PARKING
- RAILROAD CROSSING ADVANCE WARNING
- CROSSWALK AHEAD
- STREET SIGN
- IRON ROD
- 1.0' CONTOUR
- 5.0' CONTOUR
- CONSTRUCTION EASEMENT

PROPOSED

- PLANTING STRIP
- SIDEWALK/CONCRETE
- ASPHALT
- ASPHALT DRIVEWAY - PRIVATE
- CURB LINE
- EDGE OF ASPHALT
- FILTER FABRIC FENCE
- CHAIN LINK FENCE
- WOOD FENCE
- UNDERGROUND FIBER OPTIC LINE
- UNDERGROUND CABLE TV LINE
- STORM LINE
- SANITARY SEWER LINE
- WATER LINE
- GAS LINE
- OVER HEAD UTILITY
- DITCH LINE
- FILL LINE
- GAS METER
- GAS VALVE
- TELEPHONE MANHOLE
- TELEPHONE RISER/JUNCTION BOX
- POWER POLE
- OVERHEAD LIGHT
- LUMINAIRE
- GUY ANCHOR
- POWER POLE/OVERHEAD LIGHT
- WATER METER
- FIRE HYDRANT
- SIGN
- DRAIN BASIN
- CURB INLET
- TREE TO BE REMOVED

GENERAL NOTES

1. MATERIALS AND CONSTRUCTION METHODS SHALL BE IN CONFORMANCE WITH THE CITY AND THE GROUND CONSTRUCTION REQUIREMENTS, BATTLE GROUND STANDARD DETAILS, AND THE LATEST EDITION OF THE STANDARD SPECIFICATIONS FOR ROAD, BRIDGE, AND MUNICIPAL CONSTRUCTION AS PREPARED BY WSDOT.
2. THE CONTRACTOR SHALL NOTIFY THE CITY OF BATTLE GROUND ENGINEERING DIVISION TWO WORKING DAYS PRIOR TO THE START OF CONSTRUCTION. CONSTRUCTION SHALL BEGIN UNTIL NOTICE TO PROCEED HAS BEEN ISSUED BY THE ENGINEERING DIVISION.
3. PRE-CONSTRUCTION PHOTOS ARE RECOMMENDED. THE CONTRACTOR IS RESPONSIBLE FOR ALL DAMAGE DUE TO CONSTRUCTION.
4. ALL EXISTING UTILITIES SHALL REMAIN USABLE DURING CONSTRUCTION. CONTACT THE CITY ENGINEERING DIVISION FOR UTILITY RECORD DRAWINGS. THE GROWTH COORDINATOR CAN BE REACHED AT (800) 275-8777.
5. PRIOR TO COMMENCING ANY EXCAVATION THE CONTRACTOR SHALL PROVIDE NOTICE OF THE SCHEDULED EXCAVATION TO ALL OWNERS OF UNDERGROUND UTILITIES BY CALLING CLATSOP COUNTY UTILITY COORDINATING COUNCIL'S ONE-CALL NUMBER AT (503) 862-8370. THE CONTRACTOR SHALL PROVIDE A 48 HOUR NOTICE TO ALL UTILITIES. THE CONTRACTOR SHALL MAKE THE CALL NOT LESS THAN 48 HOURS BEFORE STARTING THE WORK.
6. ALL EXISTING UTILITY LOCATIONS AND DEPTHS ARE APPROXIMATE. THE CONTRACTOR IS RESPONSIBLE FOR POT-HOLING TO CONFIRM LOCATIONS.
7. PRIVATE AND PUBLIC UTILITY COMPANIES CAN BE REACHED AT THE FOLLOWING NUMBERS:
 CLARK PUBLIC UTILITIES (ELECTRIC) (360) 969-3000
 COMCAST (CABLE) (360) 899-3285
 NW NATURAL GAS (GAS) (360) 571-5465
 WEST (PHONE) (360) 692-8370
 WASTE CONNECTIONS (GARBAGE) (360) 892-8370
 BATTLE GROUND (SEWER, STORM, WATER) (360) 542-8580
8. A PRE-CONSTRUCTION MEETING SHALL BE SCHEDULED WITH THE CITY PRIOR TO THE START OF CONSTRUCTION.
9. APPROVED TRAFFIC CONTROL PLANS REQUIRED PRIOR TO STARTING CONSTRUCTION. THE CITY RESERVES THE RIGHT TO ADD OR MODIFY TRAFFIC CONTROL. THE CONTRACTOR SHALL BE RESPONSIBLE FOR PROVIDING TRAFFIC AND ASSURE PUBLIC SAFETY.

VERTICAL CONTROL DETAILS

POINT ID:316
 CAP STAMP: 13971-1890
 BENCHMARK: PAV/RIE-64
 ADDRESS: LINE 218 ST 13971
 LOCATION: IN B.G. S SIDE MAIN, 75' E OF CL. N GRACE AVE, 42' W CL. S GRACE.
 DESCRIPTION: DSK IN CURB
 ELEV METERS: 89.908
 ELEV FEET: 294.97
 X-COORD: 1122791.51887 Y-COORD: 169863.80398



CITY OF BATTLE GROUND
 109 S.W. 1ST. STREET
 SUITE 122
 BATTLE GROUND, WA. 98604
 ENGINEERING 360-342-5070



CITY OF BATTLE GROUND
 E MAIN ST SIDEWALK IMPROVEMENTS
 LEGEND AND GENERAL NOTES

DESIGNED	JMH
DRAWN	N/A
HOR.	N/A
VERT.	N/A
DATE	7/20/2010
DWG.	G02
SHEET	2 OF 21

No.	Revision/Issue	Date

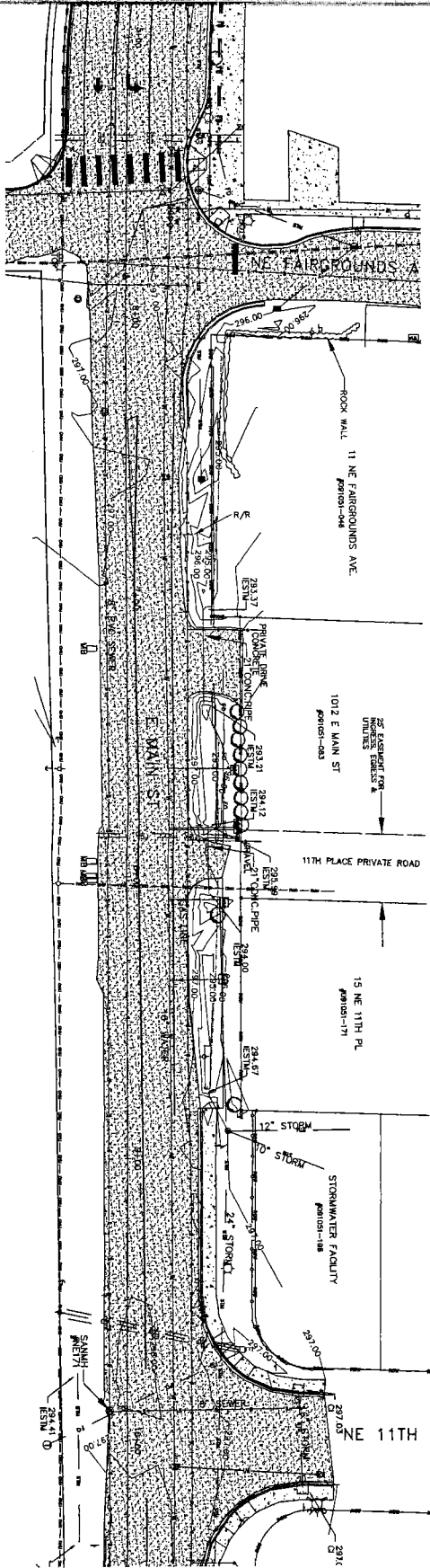

S/A 5+00 - 10+00

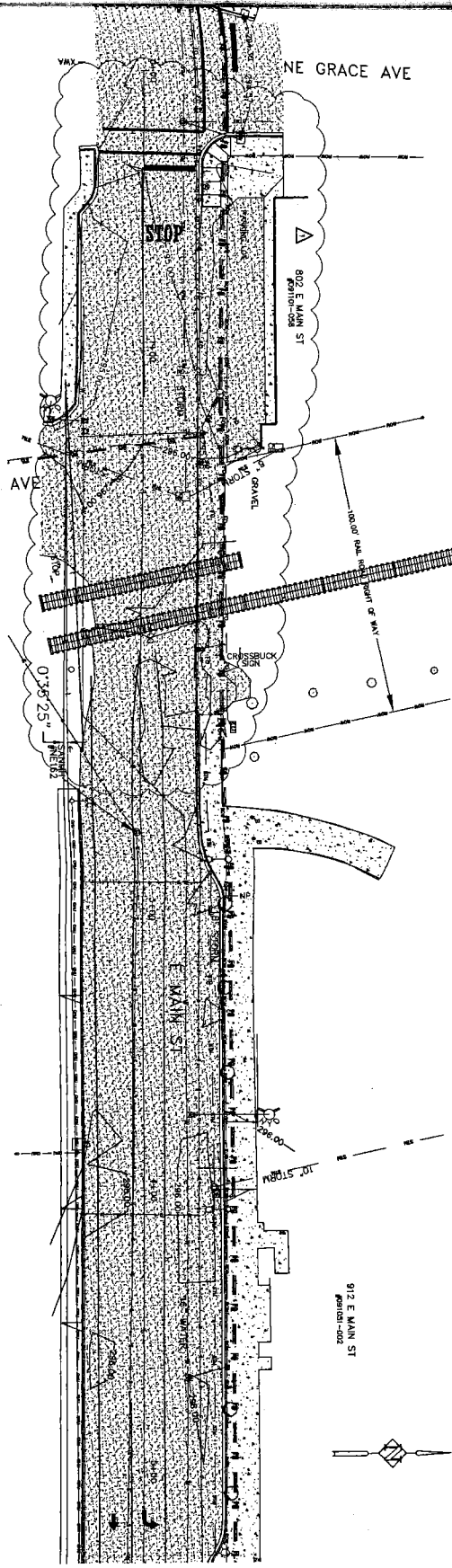

S/A 0+00 - 5+00



CITY OF BATTLE GROUND
 109 S.W. 1ST. STREET
 SUITE 122
 BATTLE GROUND, WA 98604
 ENGINEERING 360-342-5070

No.	Revision/Issue	Date
1	REVISION 1 - TOPO	7/20



CITY OF BATTLE GROUND
 E MAIN ST SIDEWALK IMPROVEMENTS

EXISTING CONDITIONS
 STA 0+00 - 10+00



DESIGNED
 DRAWN JMH
 HOR. 1" = 40'
 VERT. N/A
 DATE 7/20/2010
 DWG: VO1
 SHEET 3 OF 21

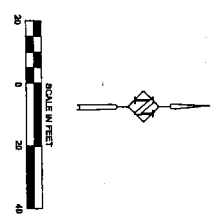
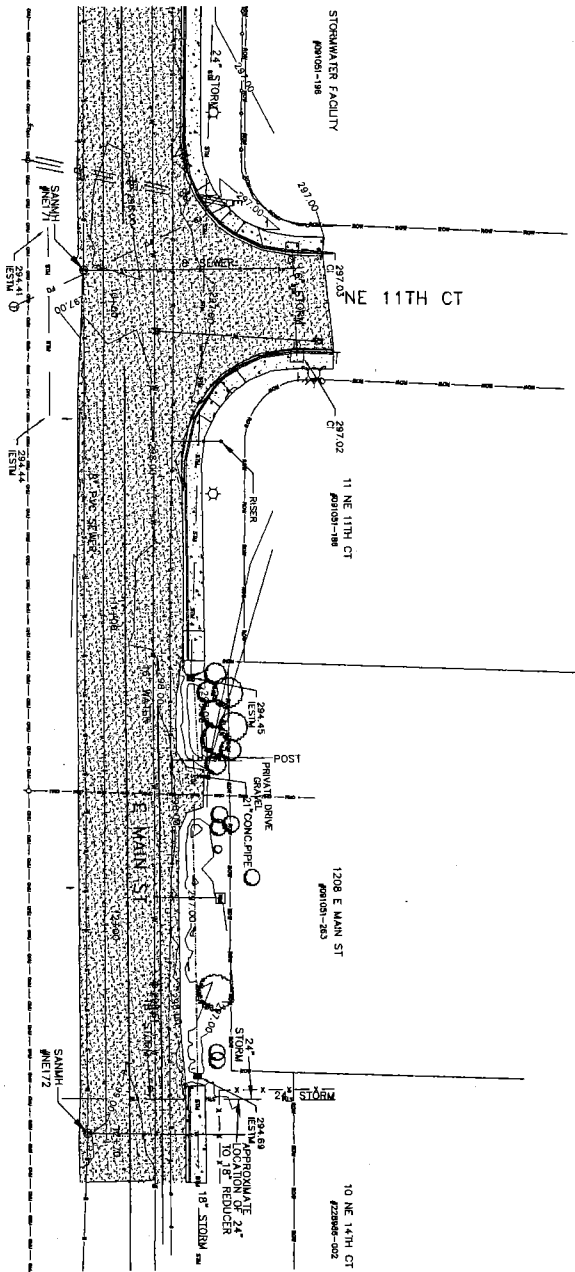

CITY OF BATTLE GROUND
 109 S.W. 1ST. STREET
 SUITE 122
 BATTLE GROUND, WA. 98604
 ENGINEERING 360-342-5070

No.	Revision/Issue	Date



CITY OF BATTLE GROUND
 E MAIN ST SIDEWALK IMPROVEMENTS
 EXISTING CONDITIONS
 STA 10+00 - 12+70



DESIGNED
 DRAWN JMH
 HOR. 4'-20'
 VERT. N/A
 DATE 7/20/2010
 DWG: V03
 SHEET 4 OF 21

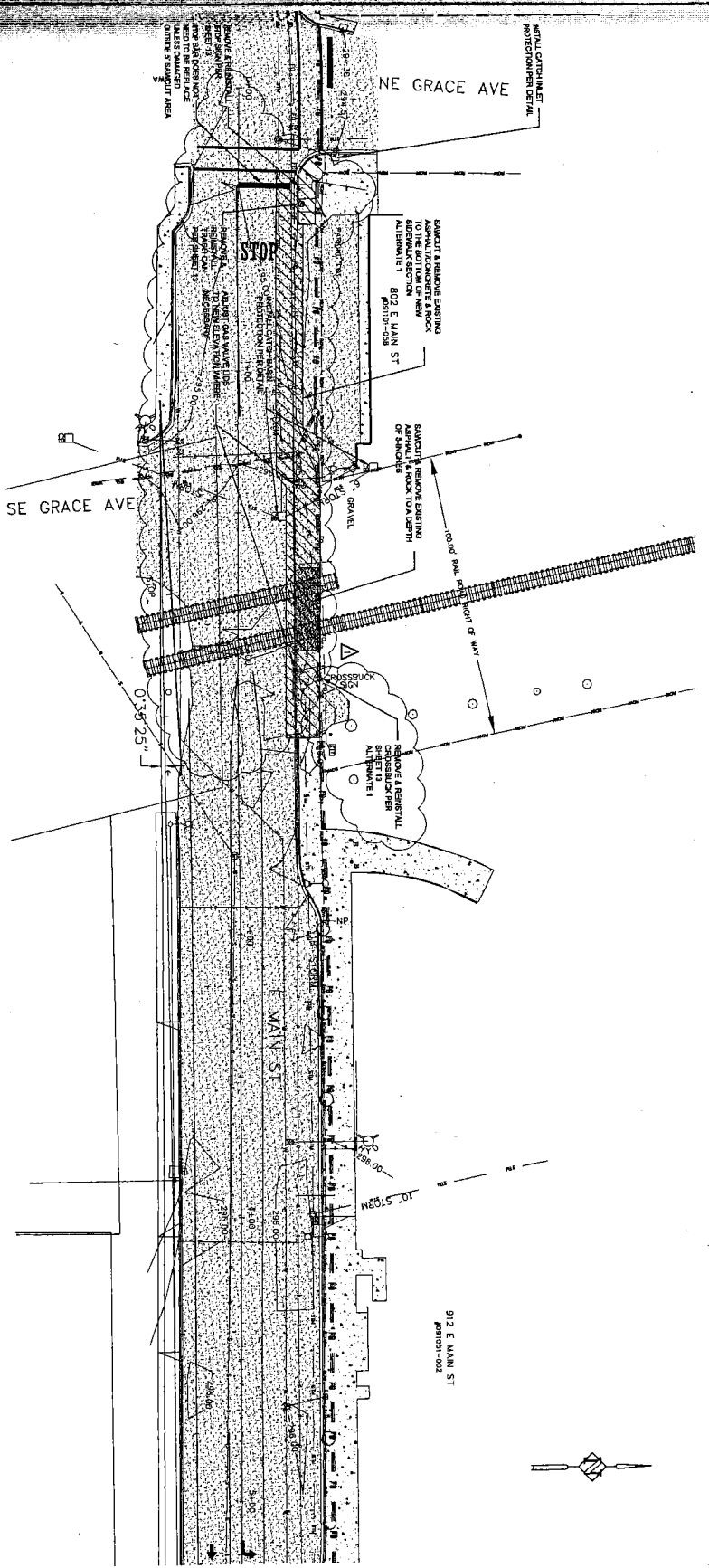

CITY OF BATTLE GROUND
 109 S.W. 1ST. STREET
 SUITE 122
 BATTLE GROUND, WA. 98604
 ENGINEERING 360-342-5070

No.	Revision/Issues	Date
1	REVISION 1 - TOPO	7/28



CITY OF BATTLE GROUND
 E MAIN ST SIDEWALK IMPROVEMENTS
 BASE AND ALTERNATE 1 DEMOLITION &
 EROSION CONTROL PLAN
 STA 00+00 - STA 5+00



DESIGNED	
DRAWN	JMH
HOR.	1" = 40'
VERT.	N/A
DATE	7/23/2010
DWG.	CD1
SHEET	5 OF 21

CALL 48 HOURS
 BEFORE YOU DIG
 1-800-353-3344
 "It's the Law"
 CLEAR EVERY
 UNDERGROUND FIRST.

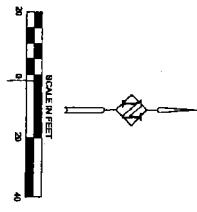
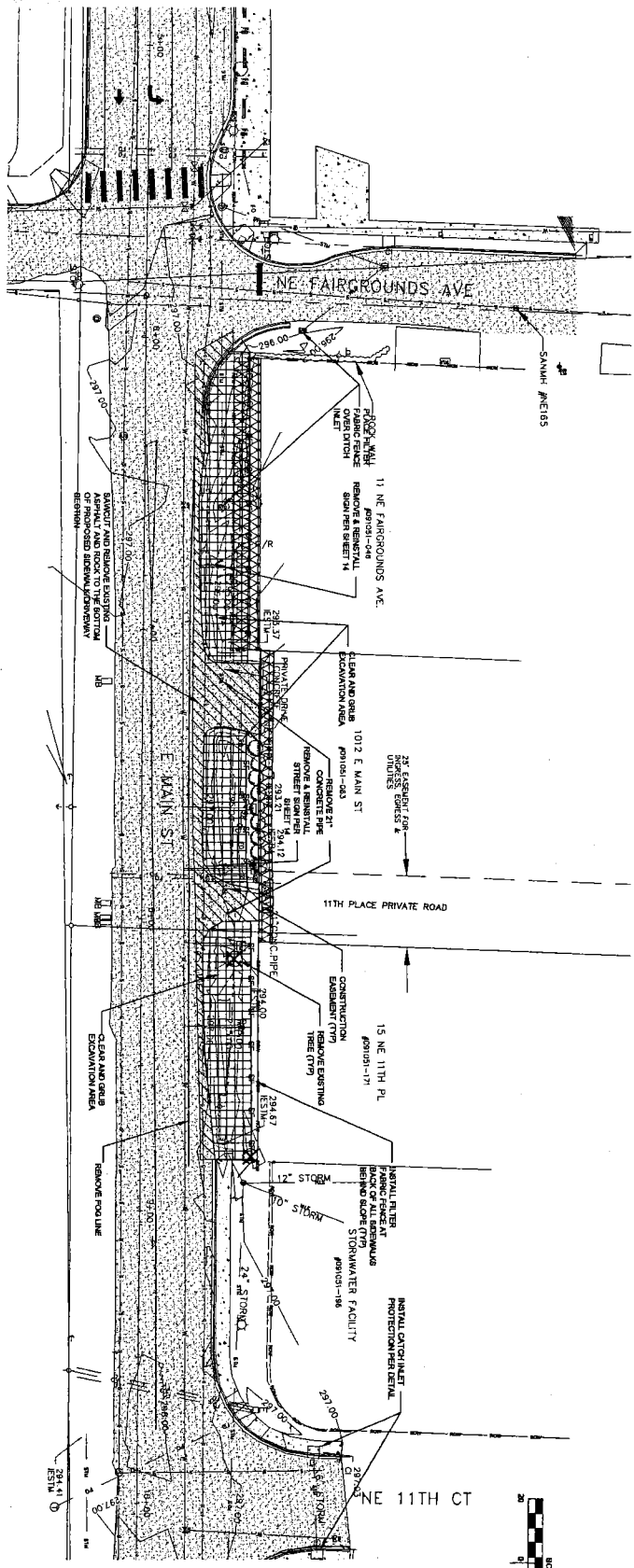

CITY OF BATTLE GROUND
 109 S.W. 15TH STREET
 SUITE 122
 BATTLE GROUND, WA. 98604
 ENGINEERING 360-342-5070

No.	Revision/Issue	Date



CITY OF BATTLE GROUND
E MAIN ST SIDEWALK IMPROVEMENTS
 DEMOLITION & EROSION CONTROL PLAN
 STA 5+00 - 10+00



DESIGNED
 DRAWN *JMH*
 HOR. *[Signature]*
 VERT. *N/A*
 DATE 7/20/2010
 DWG. C02
 SHEET 6 OF 21

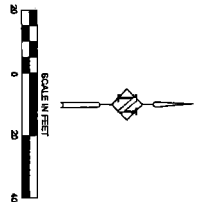
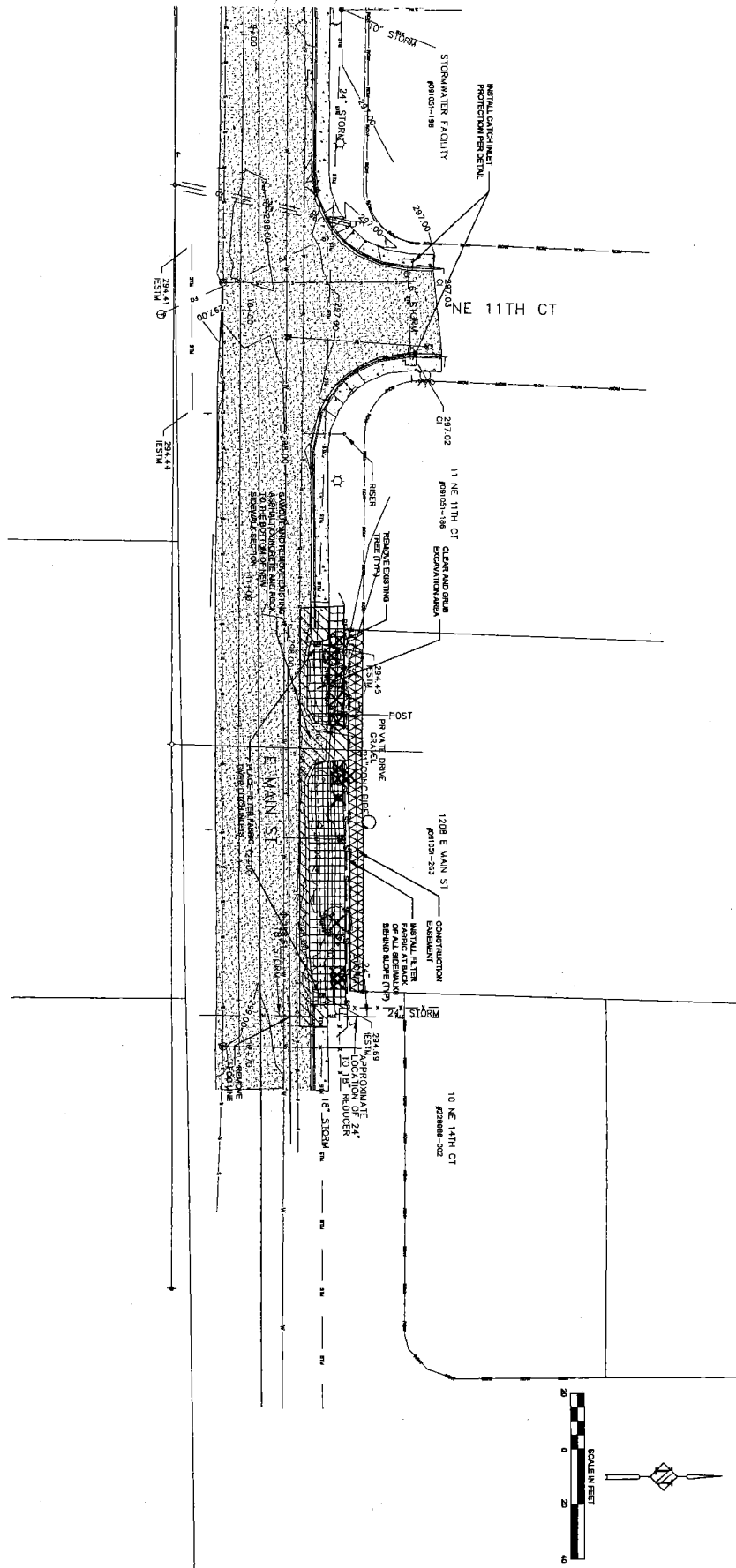

CITY OF BATTLE GROUND
 108 S.W. 1ST. STREET
 SUITE 122
 BATTLE GROUND, WA. 98604
 ENGINEERING 360-342-5070

No.	Revision/Issue	Date



CITY OF BATTLE GROUND
 E MAIN ST SIDEWALK IMPROVEMENTS
 DEMOLITION & EROSION CONTROL PLAN
 STA 10+00 - 12+70



DESIGNED	
DRAWN	JMH
HOR.	
VERT.	N/A
DATE	7/20/2010
DWG.	COJ
SHEET	7 OF 21

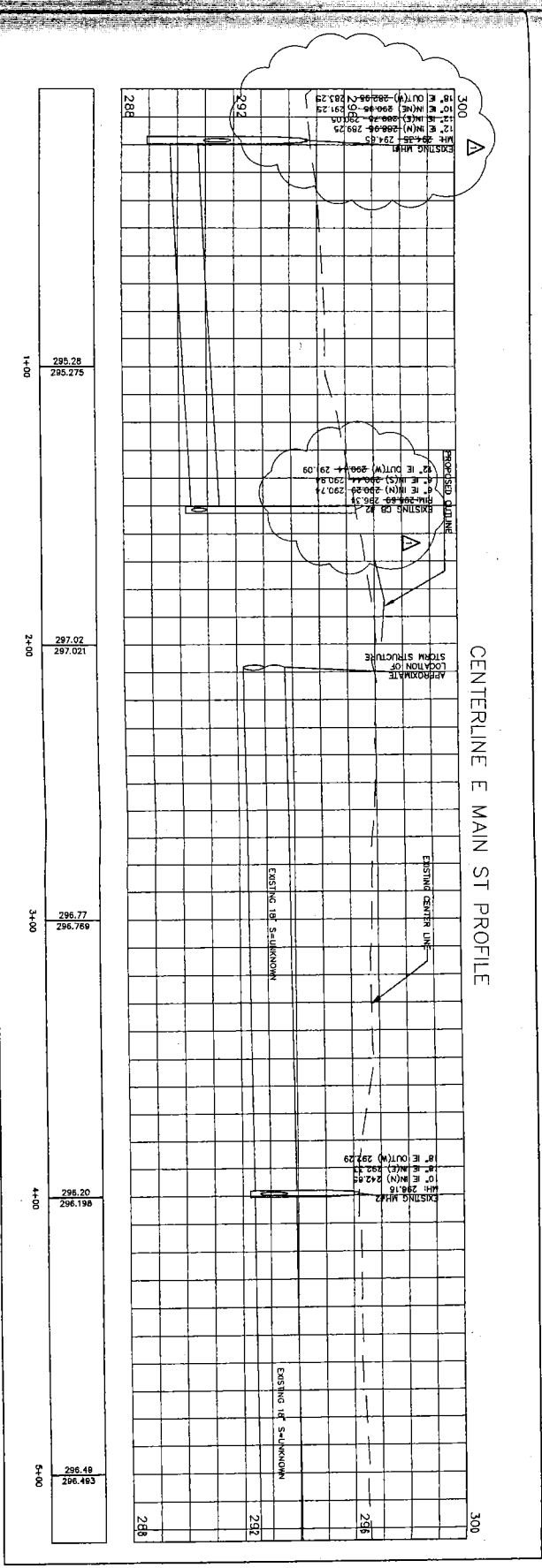
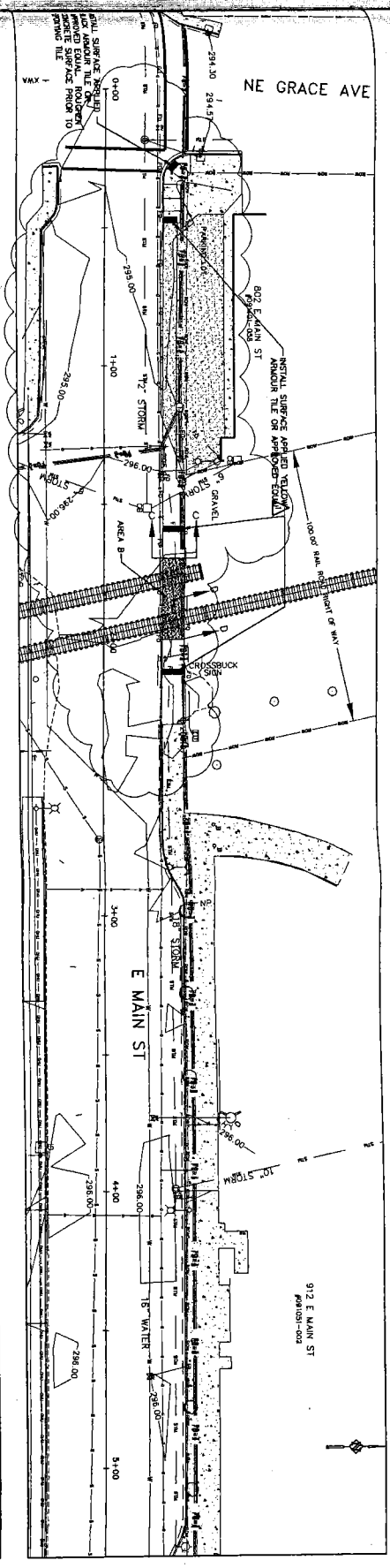

- GENERAL STREET/STORM NOTES:
- 1) ALL DRAIN BASINS ARE TO BE INSTALLED AT THE TOE OF SLOPE AND LOW POINT OF YARD
 - 2) SIDEWALK REPLACEMENT SHALL BE TO THE NEAREST JOINT

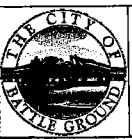

CITY OF BATTLE GROUND
 109 S.W. 1ST. STREET
 SUITE 122
 BATTLE GROUND, WA 98604
 ENGINEERING 360-342-5070

No.	Revision/Issue	Date
1	REVISION 1 - TOPO, CB/WH ELEV.	7/29



CITY OF BATTLE GROUND
 E MAIN ST SIDEWALK IMPROVEMENTS
 STREET/STORM PLAN & PROFILE
 STA 00+00 - 5+00



DESIGNED
 DRAWN JMH
 HOR. 1" = 40'
 VERT. 1" = 4'
 DATE 7/23/2010
 DWG: CC4
 SHEET 8 OF 21

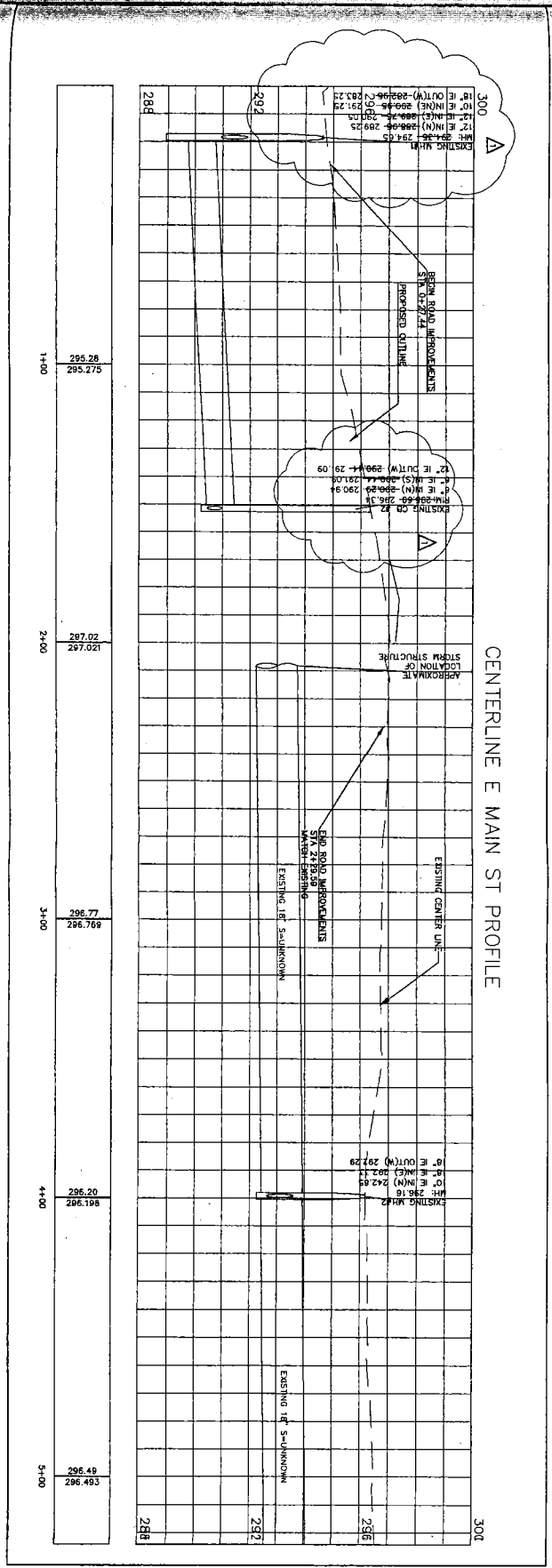
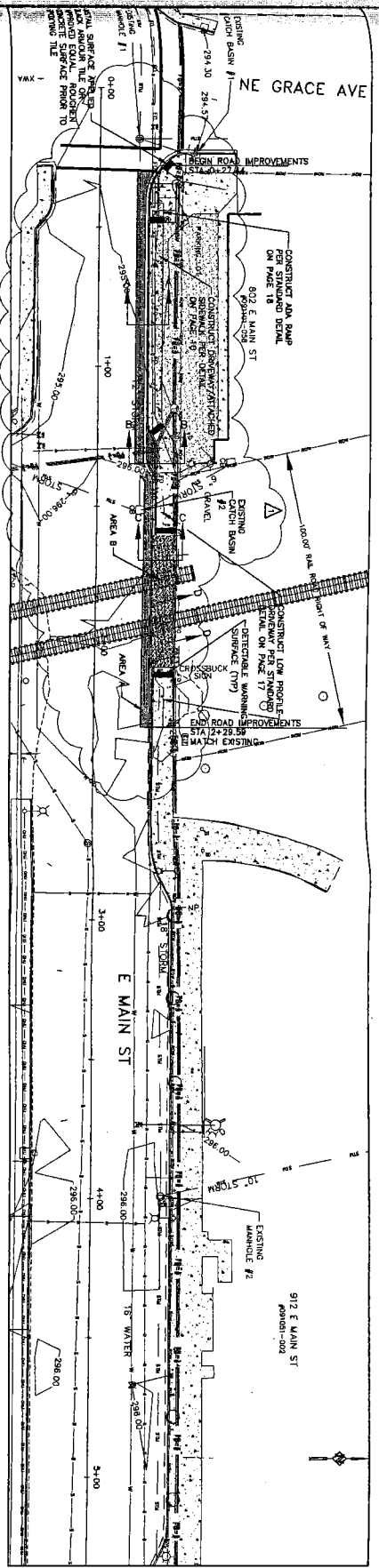

GENERAL STREET/STORM NOTES:
 1) ALL DRAIN BASINS ARE TO BE INSTALLED AT THE TOE OF SLOPE AND LOW POINT OF YARD
 2) SIDEWALK REPLACEMENT SHALL BE TO THE NEAREST JOINT



CITY OF BATTLE GROUND
 108 S.W. 1ST STREET
 SUITE 122
 BATTLE GROUND, WA 98604
 ENGINEERING 360-342-5070

REVISION 1 - TOPG, 30' AM ELEV.	7/28
No. Revision/Issue	Date



CITY OF BATTLE GROUND
 E MAIN ST SIDEWALK IMPROVEMENTS
 ALTERNATE 1
 STREET/STORM PLAN & PROFILE
 STA 00+00 - 5+00



DESIGNED	JMH
DRAWN	JMH
HOR. SCALE	1" = 40'
VERT. SCALE	1" = 4'
DATE	7/20/2010
DWG. NO.	C04
SHEET	9 OF 21

- GENERAL STREET/STORM NOTES:
- 1) ALL DRAIN BASINS ARE TO BE INSTALLED AT THE TOE OF SLOPE AND LOW POINT OF YARD
 - 2) SIDEWALK REPLACEMENT SHALL BE TO THE NEAREST JOINT

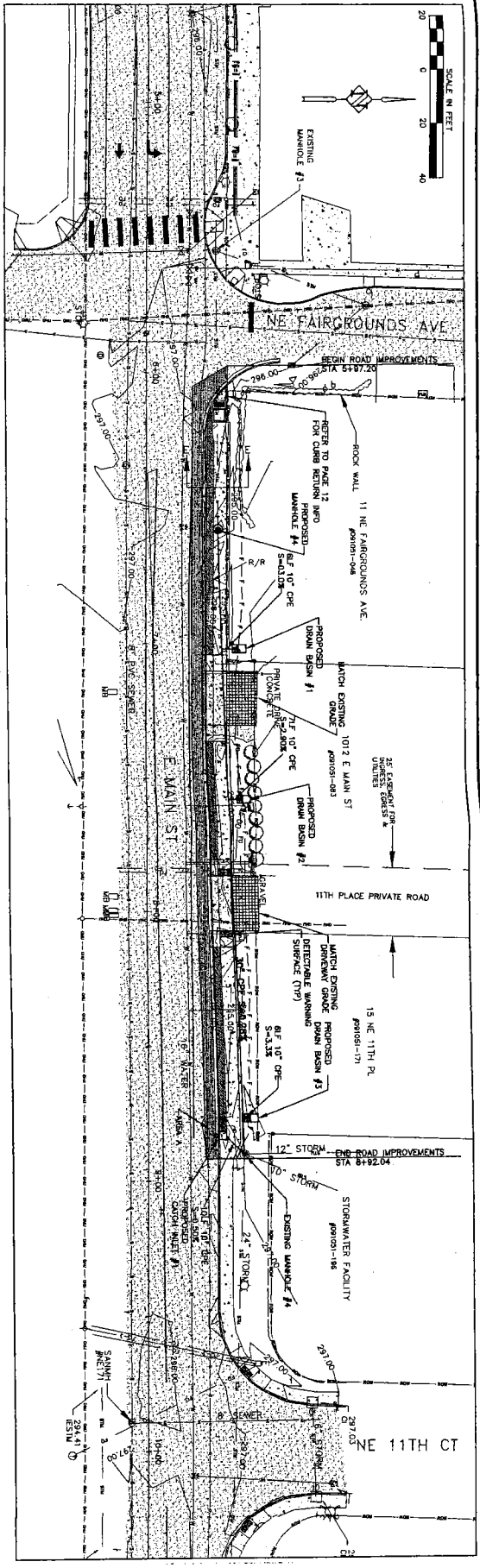
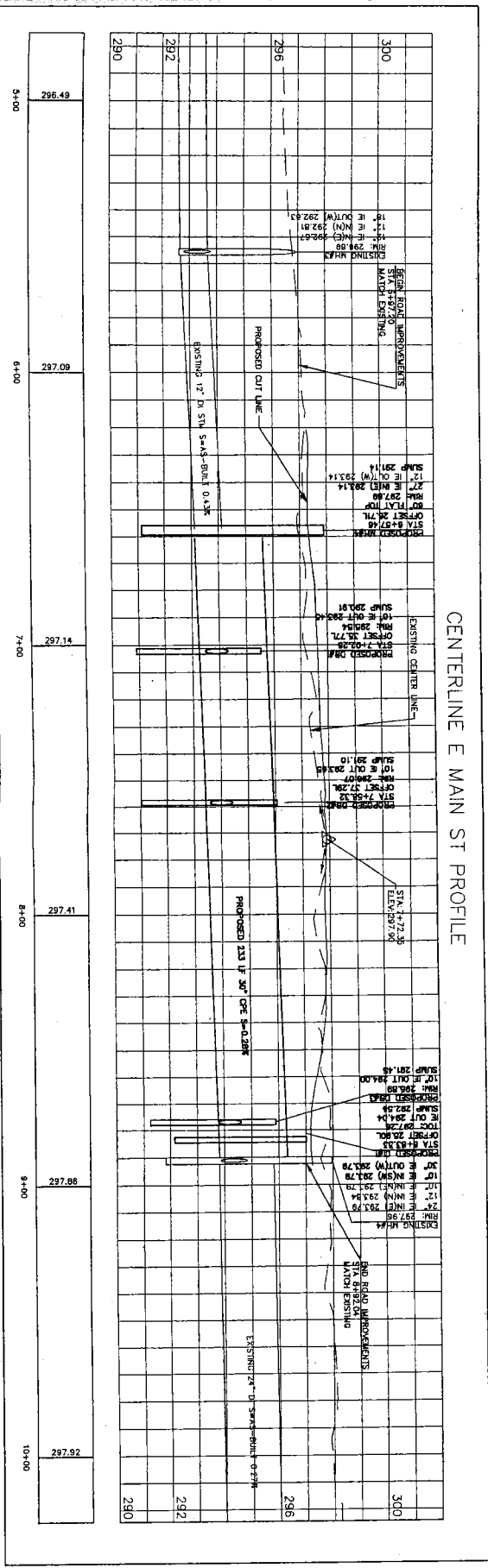

CENTERLINE E MAIN ST PROFILE



CITY OF BATTLE GROUND
 109 S.W. 1ST. STREET
 SUITE 122
 BATTLE GROUND, WA. 98604
 ENGINEERING 360-342-5070

No.	Revision/Issue	Date



CITY OF BATTLE GROUND
 E MAIN ST SIDEWALK IMPROVEMENTS
 STREET/STORM PLAN & PROFILE
 STA 5+00 - 10+00



DESIGNED	JMH
DRAWN	JMH
HOR.	1"=20'
VERT.	1"=2'
DATE	7/20/2010
DWG.	C05
SHEET	10 OF 21

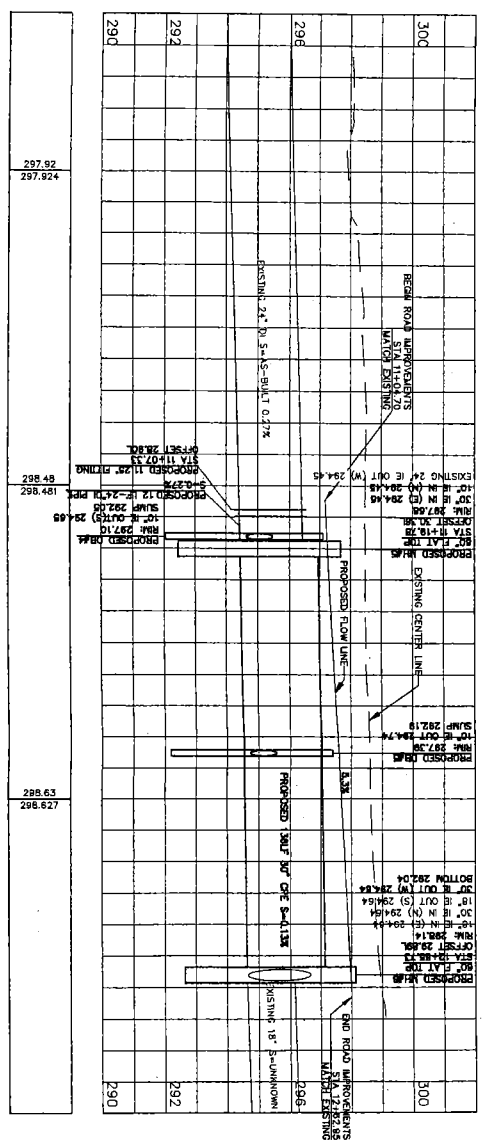
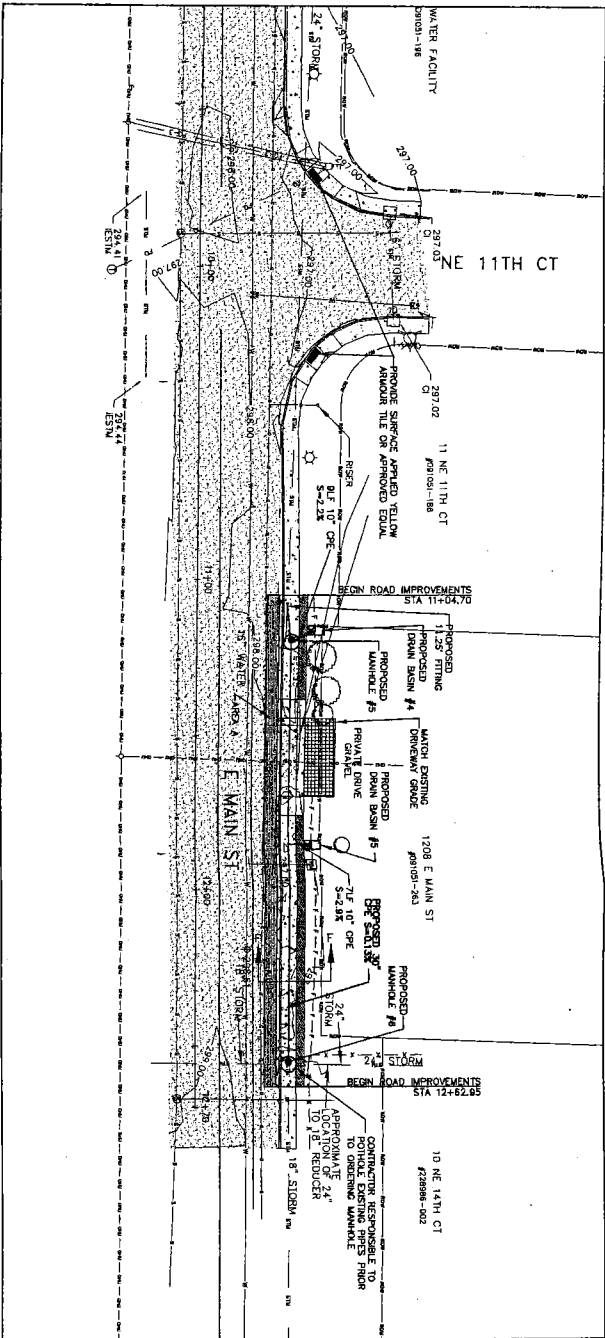

CENTERLINE E MAIN ST PROFILE

- GENERAL STREET/STORM NOTES:
- 1) ALL DRAIN BASINS ARE TO BE INSTALLED AT THE TOE OF SLOPE AND LOW POINT OF YARD
 - 2) SIDEWALK REPLACEMENT SHALL BE TO THE NEAREST JOINT



CITY OF BATTLE GROUND
 109 S.W. 1ST, STREET
 SUITE 122
 BATTLE GROUND, WA 98604
 ENGINEERING 360-342-5070

No.	Revision/Issue	Date

CITY OF BATTLE GROUND
 E MAIN ST SIDEWALK IMPROVEMENTS
 STREET/STORM PLAN & PROFILE
 STA 10+00 - 12+70



DESIGNED
 DRAWN JMH
 VOR JMH
 VERT JMH
 DATE 7/20/10
 DWS: C06
 SHEET 11 OF 21

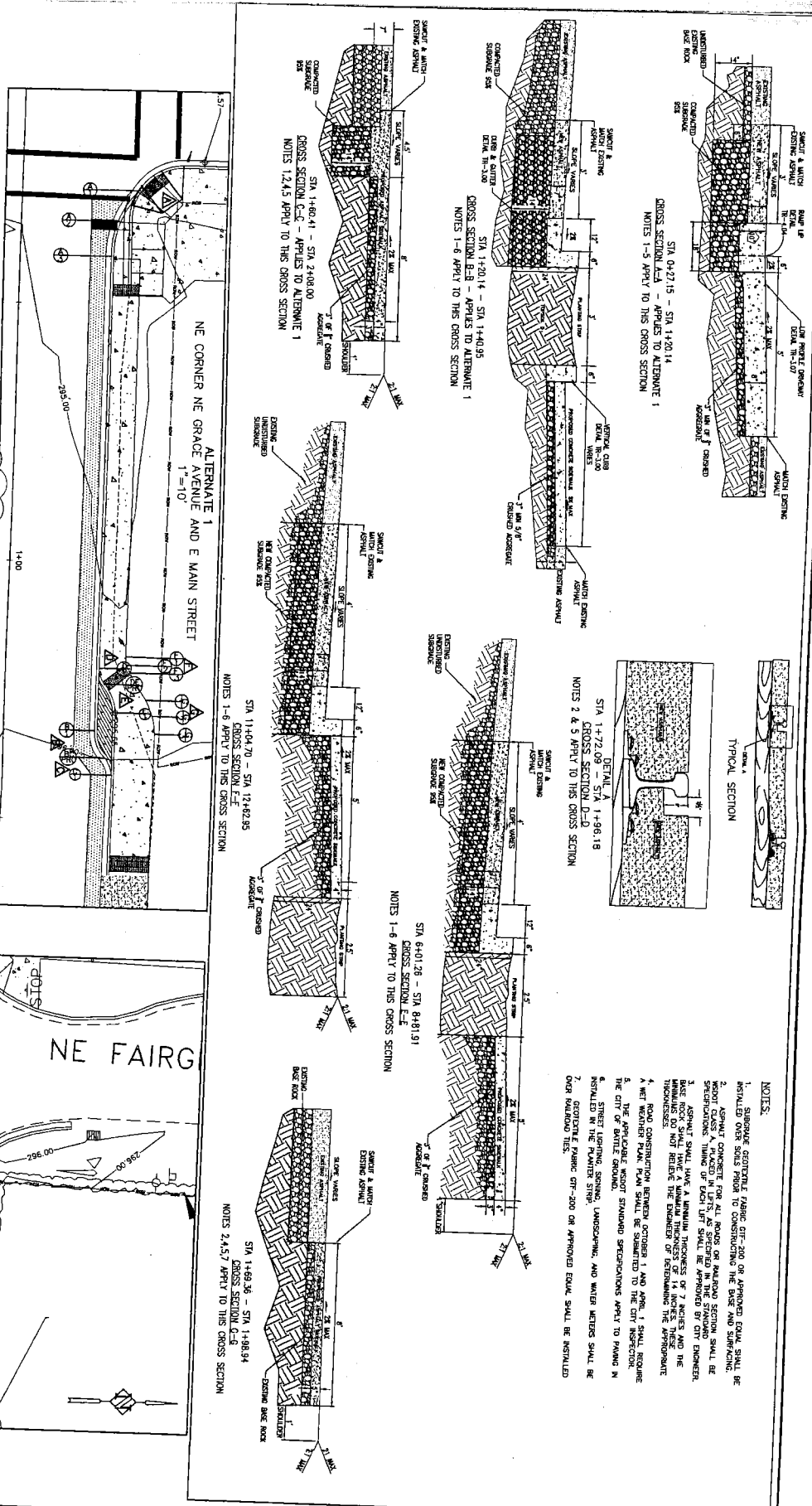

CURVE DATA TABLE			
TYPE	CURVE POINT	CENTRELINE STATIONING	OFFSET
△	7.75 R	SIA 0+28.13	22.17 L
△	14.11 R	SIA 0+33.64	17.71 L
△	23.13 R	SIA 0+40.87	17.60 L
△	7.00 R	SIA 1+32.40	17.60 L
△	5.77 L	SIA 1+37.59	19.75 L
△	5.00 R		
△	30.00 L		
△	30.75 L		
△	5.00 R	SIA 1+20.32	18.10 L
△	30.00 L	SIA 1+23.35	19.20 L

CURVE DATA TABLE			
TYPE	CURVE POINT	CENTRELINE STATIONING	OFFSET
△	6.00 R	SIA 1+28.88	21.47 L
△	6.00 R	SIA 1+18.05	23.10 L
△	12.00 R	SIA 1+19.61	23.34 L
△	12.00 R	SIA 1+21.19	23.98 L
△	12.00 R	SIA 1+22.76	24.62 L
△	12.00 R	SIA 1+24.33	25.26 L
△	12.00 R	SIA 1+25.90	25.90 L
△	12.00 R	SIA 1+27.47	26.54 L
△	12.00 R	SIA 1+29.04	27.18 L
△	12.00 R	SIA 1+30.61	27.82 L
△	12.00 R	SIA 1+32.18	28.46 L
△	12.00 R	SIA 1+33.75	29.10 L
△	12.00 R	SIA 1+35.32	29.74 L
△	12.00 R	SIA 1+36.89	30.38 L
△	12.00 R	SIA 1+38.46	31.02 L
△	12.00 R	SIA 1+40.03	31.66 L
△	12.00 R	SIA 1+41.60	32.30 L
△	12.00 R	SIA 1+43.17	32.94 L
△	12.00 R	SIA 1+44.74	33.58 L

- NOTES:**
1. SURFACE GEOTECH FIBRE GF-200 ON APPROVED EQUAL SHALL BE INSTALLED OVER SOLID FLOOR TO CONTAINMENT THE CURB AND SIDEWALK.
 2. 3000 PSI CONCRETE FOR ALL ROADS OR PAVEMENT SECTION SHALL BE 10% COMPACTED IN PLACE, AS SPECIFIED.
 3. APPROXIMATE THICKNESS OF EACH LIFT SHALL BE APPROVED BY CITY ENGINEER.
 4. CURB THICKNESS SHALL HAVE A MINIMUM THICKNESS OF 7" AND THE MINIMUM DO NOT RELIEVE THE DIMENSIONS OF APPROVED CURB MANUFACTURERS DO NOT RELIEVE THE DIMENSIONS OF APPROVED CURB MANUFACTURERS.
 5. THE APPLICABLE CURB SHALL BE SUBMITTED TO THE CITY INSPECTOR.
 6. THE CITY OF BATTLE GROUND STANDARD SPECIFICATIONS APPLY TO PAVING IN STREET LIGHTING SIGNAGE, LANDSCAPING, AND WATER METERS SHALL BE INSTALLED IN THE PLASTER STRIP.
 7. GEOTECH FIBRE GF-200 OR APPROVED EQUAL SHALL BE INSTALLED OVER PAVEMENT TIES.

CITY OF BATTLE GROUND
 108 S.W. 1ST. STREET
 SUITE 122
 BATTLE GROUND, WA 98604
 ENGINEERING 360-342-5070

REVISION 1 - ELEV. 7/28	Date
No. Revision/Issue	Date

**CITY OF BATTLE GROUND
 E MAIN ST IMPROVEMENT PROJECT**

**CROSS SECTIONS &
 CURB RETURNS**

DESIGNED: **JMH**
 DRAWN: **JMH**
 HOR.: **N/A**
 VERT.: **N/A**
 DATE: **7/20/2010**
 DWG.: **C07**
 SHEET **12** OF **21**

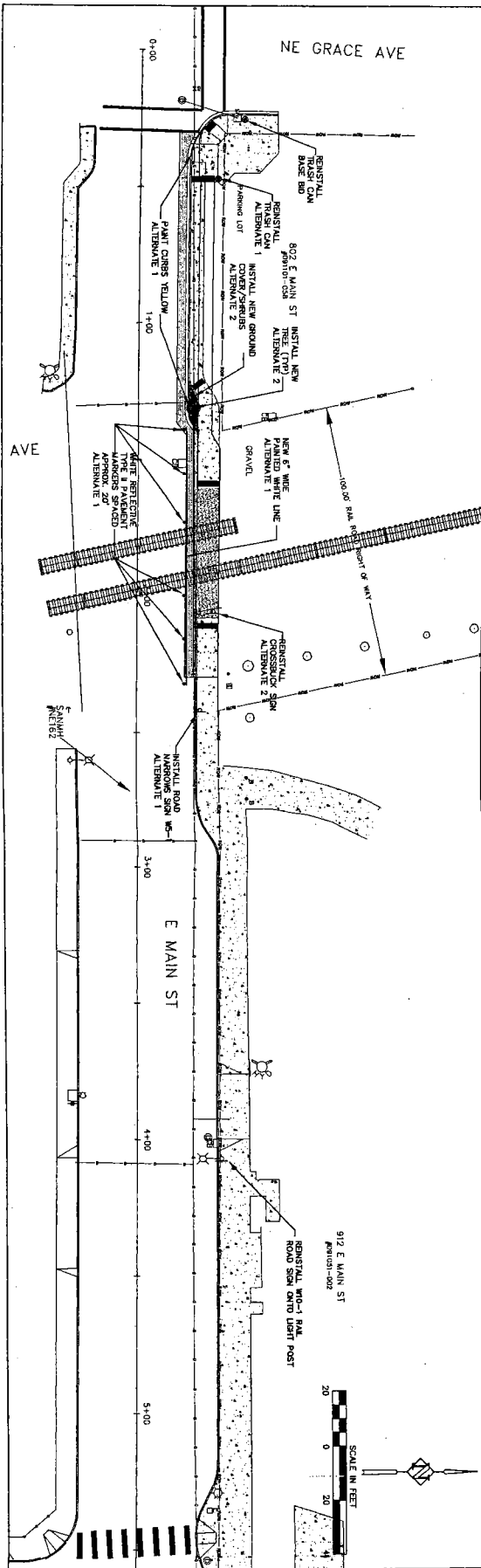

- GENERAL SIGNING, STRIPING AND LANDSCAPING NOTES:**
1. CROSS WALK & CROSS BAR STRIPING TO BE THERMOPLASTIC AND CONFORM TO CURRENT AASHTO
 2. CONTRACTOR TO RESEED LAWN ON PRIVATE PROPERTY DAMAGED BY GRADING ACTIVITIES
 3. ALL SIGNING AND STRIPING TO BE DONE IN ACCORDANCE WITH THE MANUFACTURER'S APPLICATION INSTRUCTIONS
 4. BARRICADE TO APPLIED 3-INCHES THICK IN PLANTING STRIP

STA 0+00 - STA 5+50

PLANTING LEGEND - ALTERNATE 2				
SYMBOL	BOTANICAL NAME	COMMON NAME	SIZE /CONT	COUNT
	ACER GRANDIDENTATUM "SCHMIDT"	ROCKY MOUNTAIN ACER "SCHMIDT"	2" CALIPER	13
	ARGOSTAPHYLOS UVA-URSI	KINKKINICK	1 GAL	67
	BARBERIS THUNBERGII "SCHMIDT"	CRIMSON RUBRY JAPANESE BARBERRY "CRUZIAN"	1 GAL	63

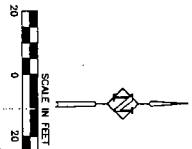

CITY OF BATTLE GROUND
 109 S.W. 1ST. STREET
 SUITE 122
 BATTLE GROUND, WA. 98604
 ENGINEERING 360-342-5070

No.	Revision/Issue	Date



CITY OF BATTLE GROUND
E MAIN ST SIDEWALK IMPROVEMENTS
 BASE & ALTERNATES 1 & 2
 SIGNING, STRIPING & LANDSCAPING
 STA 0+00 - STA 5+50



DESIGNED
 DRAWN **JMH**
 HOR. **30'**
 VERT. **N/A**
 DATE **7/20/2010**
 DWG: **COB**
 SHEET **13** OF **21**

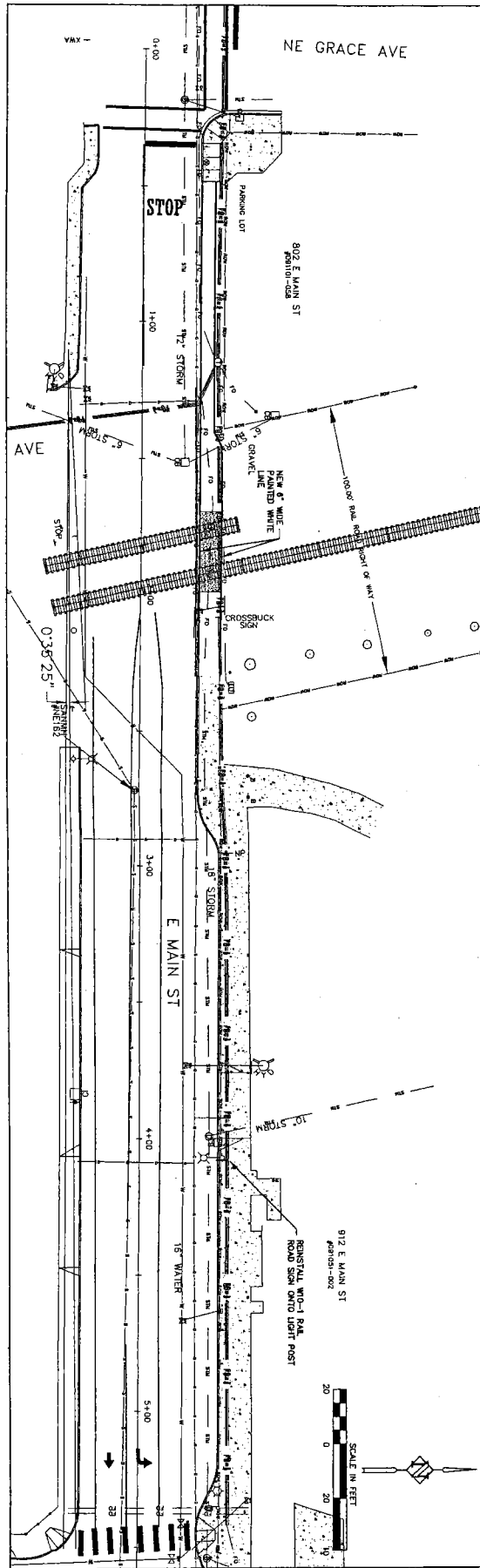

- GENERAL SIGNING, STRIPING AND LANDSCAPING NOTES:**
1. GROSS WALK & GROSS BAR STRIPING TO BE THERMOPLASTIC AND CONFORM TO CURRENT MUTCD
 2. CONTRACTOR TO RESEED LAWN ON PRIVATE PROPERTY DAMAGED BY GRADING ACTIVITIES
 3. PRE-CURBMENT TO BE APPLIED TO ALL EXISTING STRIP AREAS BY MARKING WITH BROADCAST GRANULITE
 4. BROADCAST TO APPLIED 3-INCHES THICK IN PLANTING STRIP

STA 0+00 - STA 5+50



CITY OF BATTLE GROUND
 109 S.W. 1ST STREET
 SUITE 122
 BATTLE GROUND, WA 98604
 ENGINEERING 360-342-5070

No.	Revision/Issue	Date



CITY OF BATTLE GROUND
 E MAIN ST SIDEWALK IMPROVEMENTS
 SIGNING, STRIPING & LANDSCAPING
 STA 0+00 - STA 5+50



DESIGNED
 DRAWN JMH
 HOR. 1" = 20'
 VERT. N/A
 DATE 7/20/2010
 DWG: C09
 SHEET 14 OF 21

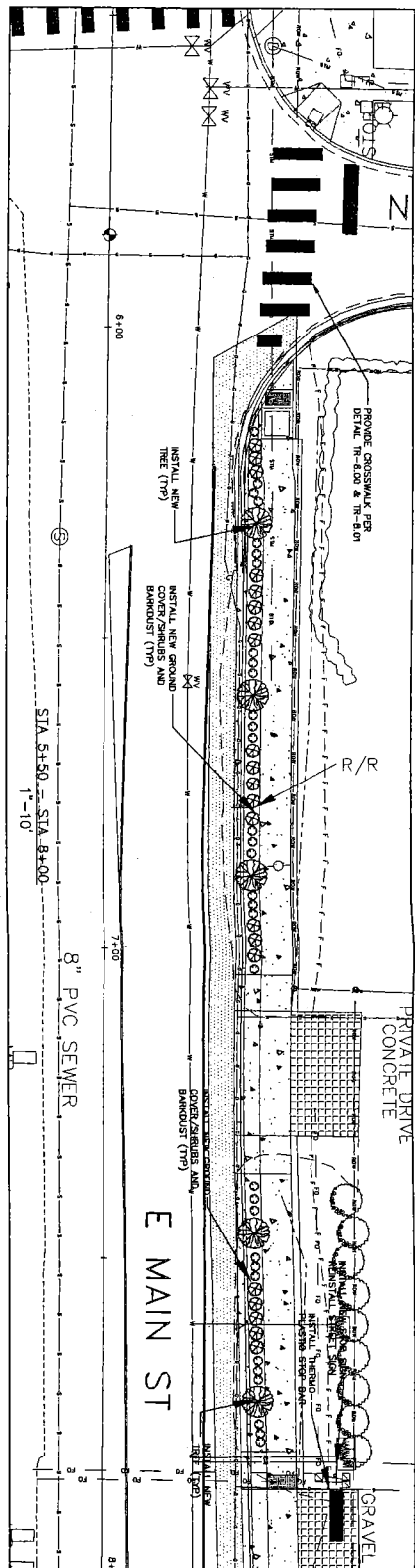
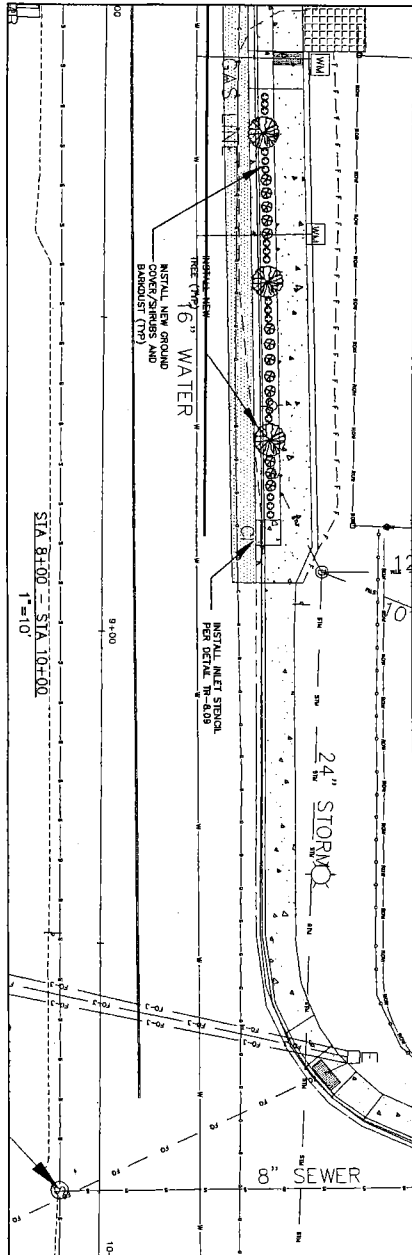
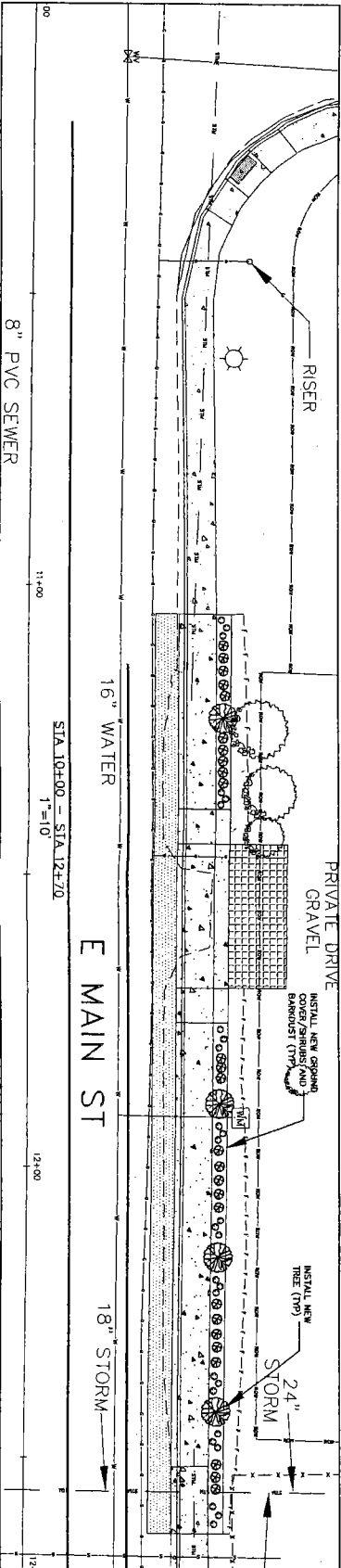

CITY OF BATTLE GROUND
 109 S.W. 1ST. STREET
 SUITE 122
 BATTLE GROUND, WA. 98604
 ENGINEERING 360-342-5070

No.	Revision/Issue	Date



CITY OF BATTLE GROUND
E MAIN ST SIDEWALK IMPROVEMENTS
 SIGNING, STRIPING & LANDSCAPING
 STA 5+50 - STA 12+70



DESIGNED
 DRAWN *JMH*
 HOR. *100%*
 VERT. *N/A*
 DATE 7/20/2010
 DWG. *CO10*
 SHEET 15 OF 21

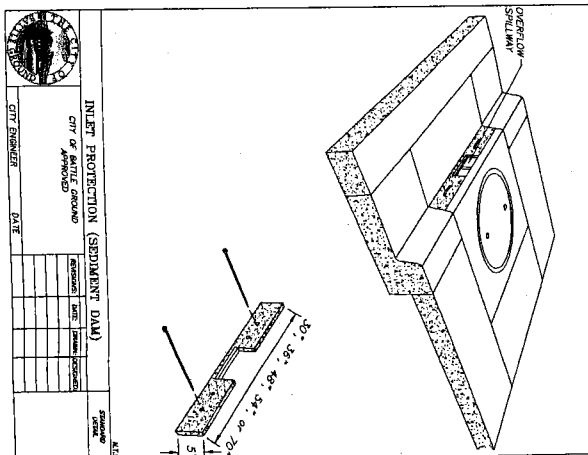
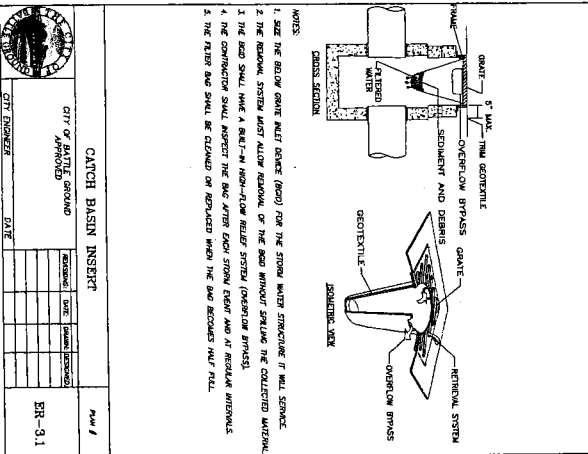
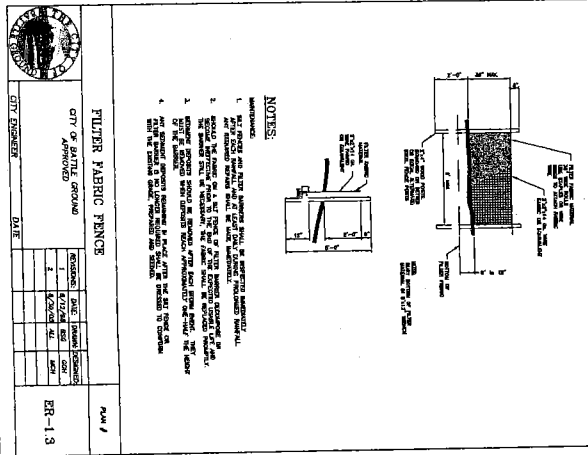
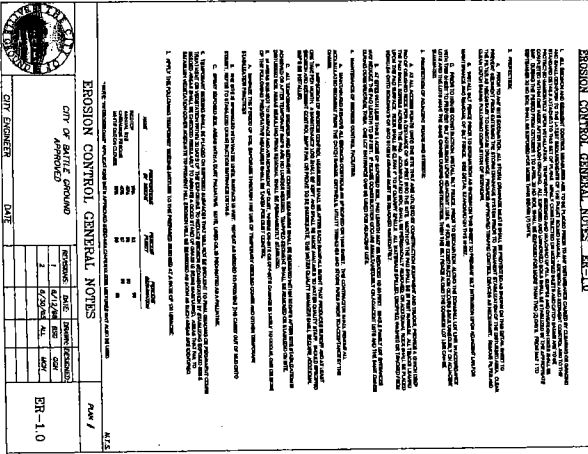

CITY OF BATTLE GROUND
109 S.W. 1ST. STREET
SUITE 122
BATTLE GROUND, WA 98604
ENGINEERING 360-342-5070

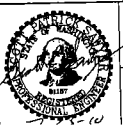

CITY OF BATTLE GROUND
E MAIN ST SIDEWALK IMPROVEMENTS
EROSION CONTROL DETAILS

DESIGNED	JMH
DRAWN	N/A
HOR.	N/A
VERT	N/A
DATE	7/20/2010
DWG.	DD1
SHEET	16 OF 21

GENERAL NOTES:

1. MATERIALS AND CONSTRUCTION METHODS SHALL BE IN ACCORDANCE WITH THE CITY OF BATTLE GROUND SPECIFICATIONS AND PERMITS AND THE LATEST EDITION OF THE STANDARD SPECIFICATIONS FOR ROAD, BRIDGE & MUNICIPAL CONSTRUCTION AS PREPARED BY MRCOIT AND THE WASHINGTON STATE CHAPTER OF THE AASHTO.
2. THE CONTRACTOR SHALL NOTIFY THE CITY INSPECTOR TWO WORKING DAYS PRIOR TO THE WORKS BEGINNING.
3. APPROVED TRAFFIC CONTROL PLAN WILL BE REQUIRED PRIOR TO THE START OF CONSTRUCTION WITHIN A CITY OR COUNTY RIGHT-OF-WAY.
4. CONSTRUCTION SHALL BE AS FOLLOWS:
-SUBGRADE SHALL BE COMPACTED TO A DEPTH OF 6" AT 95% OF THE RELATIVE DRY WEIGHT. CONCRETE SHALL BE COMPACTED TO 91% OF THE MAXIMUM RELATIVE DENSITY.
-CHISELED ROCK SHALL BE COMPACTED TO 95% STANDARD DENSITY.
5. THE DEVELOPER SHALL BE RESPONSIBLE FOR THE COST OF THE STREET LIGHT INSTALLATION.
6. MAIL BOXES SHALL HAVE 18" MINIMUM CLEARANCE FROM FACE OF THE CURB.
7. A PRE-CONSTRUCTION MEETING SHALL BE SCHEDULED WITH THE CITY PRIOR TO BEGINNING OF CONSTRUCTION.
8. PERMS TO THE CONSTRUCTION OF ANY STRUCTURES OR CURBS OR ANY REPLACEMENT THEREOF SHALL APPLY FOR A RIGHT-OF-WAY HEIGHT, AS REQUIRED PER BATTLE GROUND MUNICIPAL CODE 12.11.6.

TRANSPORTATION GENERAL NOTES

CITY OF BATTLE GROUND APPROVED

DESIGNED DATE: 5/30/08

DRAWN: JMH

CITY ENGINEER: [Signature]

DATE: 6/3/08

REVISION	DATE	BY	REASON
1	5/30/08	JMH	ISSUE FOR PERMITS
2	6/3/08	JMH	FOR REVIEW

TR-1-00

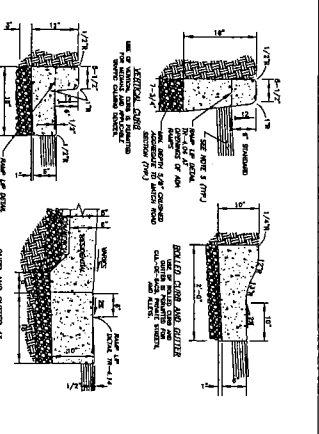

CONCRETE CURBS

CITY OF BATTLE GROUND APPROVED

DESIGNED DATE: 6/3/08

DRAWN: JMH

CITY ENGINEER: [Signature]

REVISION	DATE	BY	REASON
1	6/3/08	JMH	ISSUE FOR PERMITS
2	6/3/08	JMH	FOR REVIEW

TR-3-00

GENERAL NOTES:

- SIGNING AND STRIPING GENERAL NOTES:**
1. SIGNING SHALL BE MADE OF 16" GAUGE REFLECTIVE SHEETING.
 2. SIZING AND MATERIALS OF SIGNS SHALL BE PER THE LATEST EDITION OF THE MANUAL ON UNIFORM TRAFFIC CONTROL DEVICES (MUTCD).
- STRIPING GENERAL NOTES:**
1. ALL PERMANENT STRIPING SHALL BE THERMOPLASTIC UNLESS OTHERWISE INDICATED ON THE PLANS. PAVE STRIPING SHALL BE TYPE A OR B MATERIAL PER WISCONSIN STANDARD SPECIFICATIONS SECTION 5-14.
 2. TYPICAL SIGNING, STRIPING, AND PAVE STRIPING SHALL BE PER THE LATEST EDITION OF THE MUTCD, SECTION 5-14.
 3. TEMPORARY STRIPING SHALL BE WITHIN 24 HOURS OF ASPHALT LIFT. MEASURING STRIPING SHALL BE WITHIN 24 HOURS OF ASPHALT LIFT.
 4. ON MAJOR ROUTES, TEMPORARY STRIPING SHALL NOT BE INSTALLED WITHIN THIS OR OTHER STRIPING SHALL BE WITHIN 24 HOURS OF ASPHALT LIFT.
 5. TYPE A THERMOPLASTIC MATERIAL MAY ONLY BE USED WHEN THE TEMPERATURE IS 55°F OR GREATER.
 6. STRIPING SHALL BE WITH AN ABRASION METHOD.
- GENERAL & STRIPING GENERAL NOTES:**
1. ALL SIGNING AND STRIPING TO BE INSTALLED PER THE LATEST EDITION OF THE MUTCD.
 2. TEMPORARY SIGNING SHALL BE PER THE LATEST EDITION OF THE MUTCD, SECTION 5-14.
 3. TEMPORARY STRIPING SHALL BE PER THE LATEST EDITION OF THE MUTCD, SECTION 5-14.
 4. STRIPING SHALL BE WITHIN 24 HOURS OF ASPHALT LIFT.
 5. STRIPING SHALL BE WITHIN 24 HOURS OF ASPHALT LIFT.
 6. STRIPING SHALL BE WITHIN 24 HOURS OF ASPHALT LIFT.

STRIPING & STRIPING GENERAL NOTES

CITY OF BATTLE GROUND APPROVED

DESIGNED DATE: 5/30/08

DRAWN: JMH

CITY ENGINEER: [Signature]

REVISION	DATE	BY	REASON
1	5/30/08	JMH	ISSUE FOR PERMITS
2	6/3/08	JMH	FOR REVIEW

TR-1-01

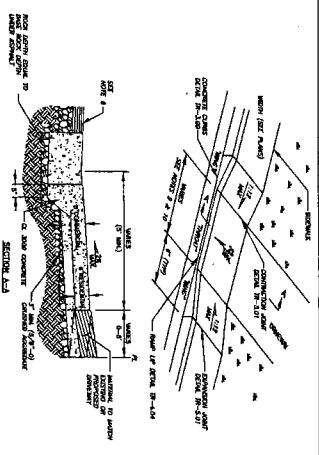

DRIVEWAY - ATTACHED SIDEWALK

CITY OF BATTLE GROUND APPROVED

DESIGNED DATE: 5/2/08

DRAWN: JMH

CITY ENGINEER: [Signature]

REVISION	DATE	BY	REASON
1	5/2/08	JMH	ISSUE FOR PERMITS
2	6/3/08	JMH	FOR REVIEW

TR-3-05

GENERAL NOTES:

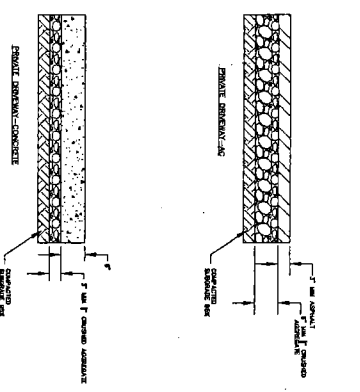

PRIVATE DRIVEWAY DETAIL

CITY OF BATTLE GROUND APPROVED

DESIGNED DATE: 5/2/08

DRAWN: JMH

CITY ENGINEER: [Signature]

REVISION	DATE	BY	REASON
1	5/2/08	JMH	ISSUE FOR PERMITS
2	6/3/08	JMH	FOR REVIEW

TR-4-04

RAMP LIP & DETECTABLE WARNING PATTERN

CITY OF BATTLE GROUND APPROVED

DESIGNED DATE: 5/6/08

DRAWN: JMH

CITY ENGINEER: [Signature]

REVISION	DATE	BY	REASON
1	5/6/08	JMH	ISSUE FOR PERMITS
2	6/3/08	JMH	FOR REVIEW

TR-4-04

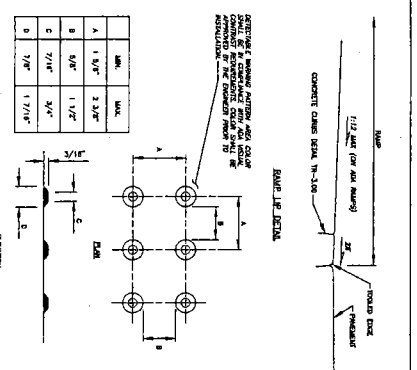

DESIGNED	JMH
DRAWN	N/A
HOR.	N/A
VERT.	N/A
DATE	7/20/2010
DWG.	D02
SHEET	17 OF 21

CITY OF BATTLE GROUND
E MAIN ST SIDEWALK IMPROVEMENTS
TRANSPORTATION DETAILS

CITY OF BATTLE GROUND
109 S.W. 1ST. STREET
SUITE 122
BATTLE GROUND, WA 98604
ENGINEERING 360-342-5070



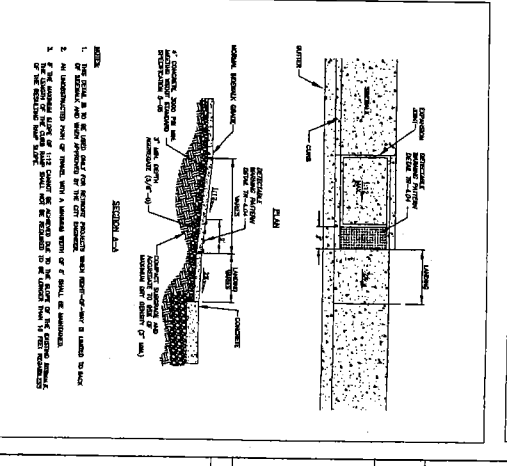
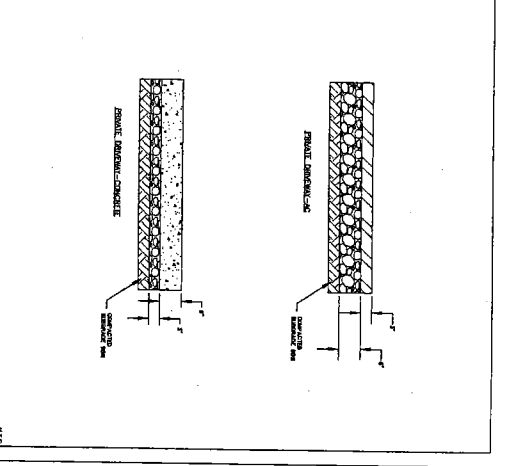
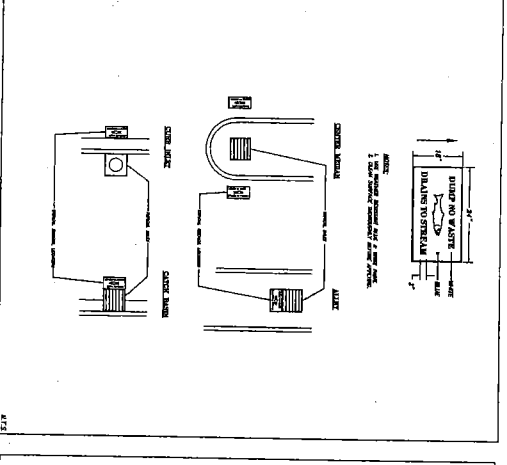
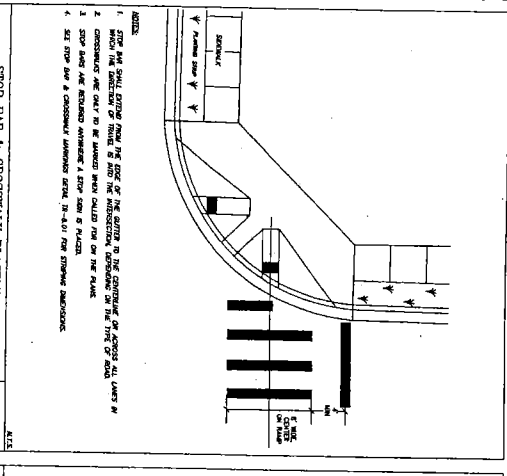
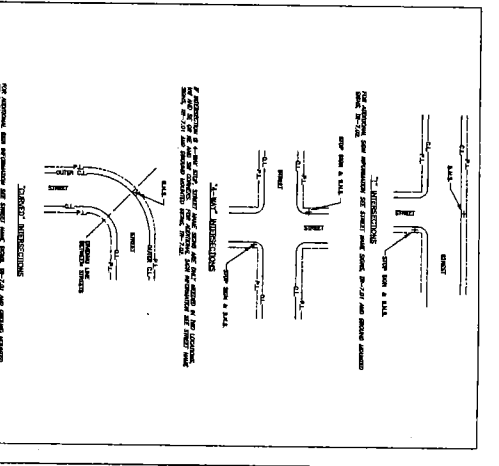
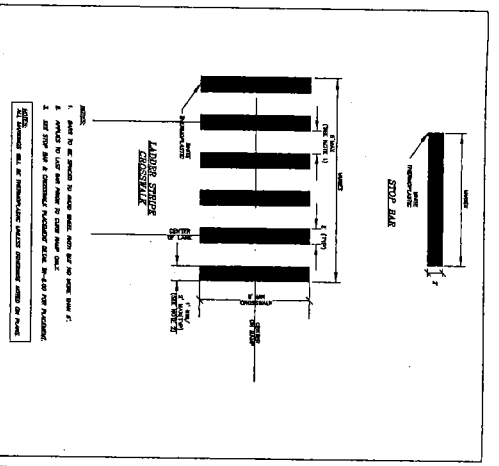
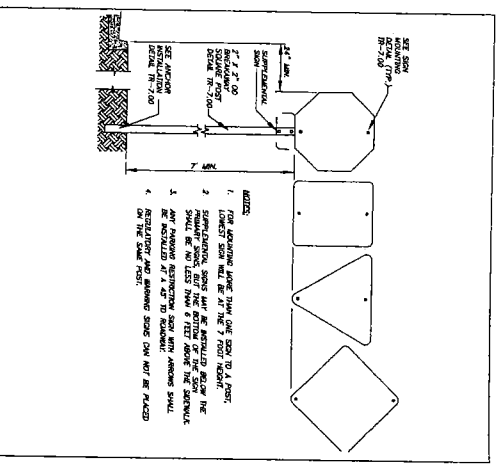
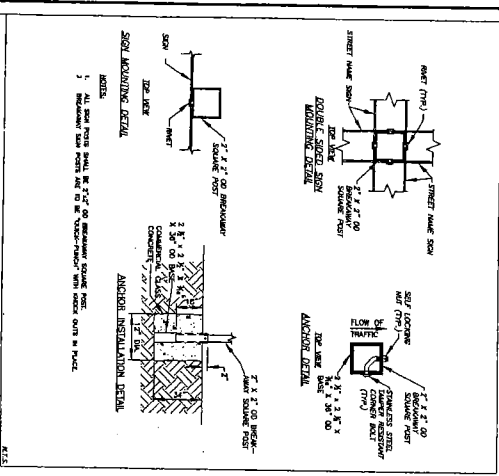

GENERAL NOTES

1. DESIGN OF THE MANHOLE/STORM STRUCTURE SHALL BE IN ACCORDANCE WITH THE LATEST EDITION OF THE ROAD/STORM STRUCTURES DESIGN MANUAL, 1ST EDITION, AASHTO, 1996.
2. MATERIALS AND CONSTRUCTION FOR STORM STRUCTURES SHALL CONFORM TO THE LATEST REQUIREMENTS.
3. CITY OF BATTLE GROUND SHALL BE RESPONSIBLE FOR THE DESIGN OF THE MANHOLE/STORM STRUCTURE AND THE DESIGN OF THE EXISTING STORM STRUCTURE.
4. THE CONTRACTOR SHALL BE RESPONSIBLE FOR THE DESIGN OF THE EXISTING STORM STRUCTURE AND THE DESIGN OF THE EXISTING STORM STRUCTURE.
5. THE CONTRACTOR SHALL BE RESPONSIBLE FOR THE DESIGN OF THE EXISTING STORM STRUCTURE AND THE DESIGN OF THE EXISTING STORM STRUCTURE.
6. THE CONTRACTOR SHALL BE RESPONSIBLE FOR THE DESIGN OF THE EXISTING STORM STRUCTURE AND THE DESIGN OF THE EXISTING STORM STRUCTURE.
7. ALL CITY BARS AND CORN REINFORCING SHALL BE PROVIDED BY THE CONTRACTOR.
8. STORM STRUCTURES SHALL BE DESIGNED TO RESIST A MINIMUM OF 15 PSI OF SURFACE LOAD.
9. STORM STRUCTURES SHALL BE DESIGNED TO RESIST A MINIMUM OF 15 PSI OF SURFACE LOAD.
10. STORM STRUCTURES SHALL BE DESIGNED TO RESIST A MINIMUM OF 15 PSI OF SURFACE LOAD.
11. STORM STRUCTURES SHALL BE DESIGNED TO RESIST A MINIMUM OF 15 PSI OF SURFACE LOAD.
12. ALL REINFORCING SHALL BE PROVIDED BY THE CONTRACTOR.

STORMWATER GENERAL NOTES & TESTING

CITY OF BATTLE GROUND APPROVED

REVISION	DATE	DESCRIPTION
1	6/20/09	ISSUED FOR PERMITS
2	6/20/09	ISSUED FOR PERMITS
3	6/20/09	ISSUED FOR PERMITS

DATE: 6/20/09

MANHOLE

CITY OF BATTLE GROUND APPROVED

REVISION	DATE	DESCRIPTION
1	6/20/09	ISSUED FOR PERMITS
2	6/20/09	ISSUED FOR PERMITS
3	6/20/09	ISSUED FOR PERMITS

DATE: 6/20/09

TOP SLAB FOR MANHOLE

CITY OF BATTLE GROUND APPROVED

REVISION	DATE	DESCRIPTION
1	6/20/09	ISSUED FOR PERMITS
2	6/20/09	ISSUED FOR PERMITS
3	6/20/09	ISSUED FOR PERMITS

DATE: 6/20/09

MANHOLE FRAMES & COVERS

CITY OF BATTLE GROUND APPROVED

REVISION	DATE	DESCRIPTION
1	6/20/09	ISSUED FOR PERMITS
2	6/20/09	ISSUED FOR PERMITS
3	6/20/09	ISSUED FOR PERMITS

DATE: 6/20/09

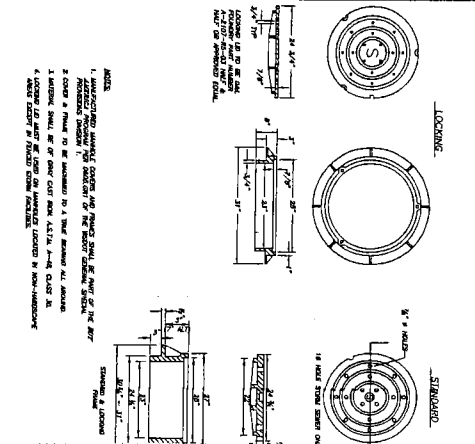
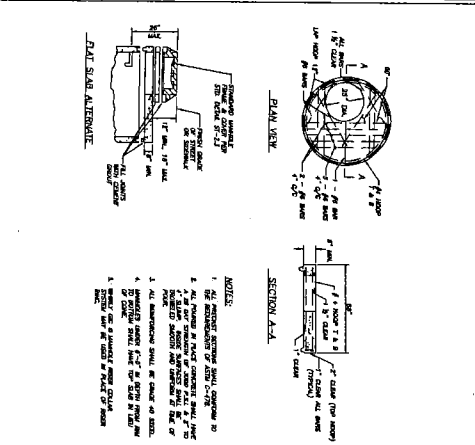
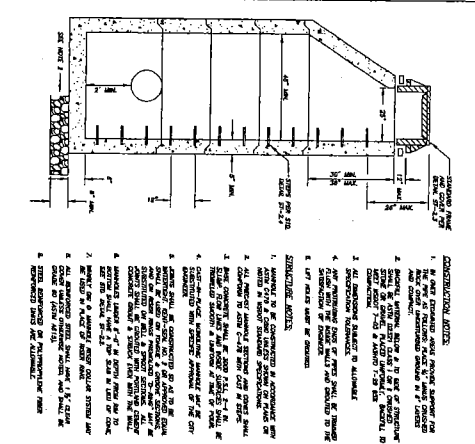

MANHOLE STUB

CITY OF BATTLE GROUND APPROVED

REVISION	DATE	DESCRIPTION
1	6/20/09	ISSUED FOR PERMITS
2	6/20/09	ISSUED FOR PERMITS
3	6/20/09	ISSUED FOR PERMITS

DATE: 6/20/09

CATCH BASIN (TYPE 1)

CITY OF BATTLE GROUND APPROVED

REVISION	DATE	DESCRIPTION
1	6/20/09	ISSUED FOR PERMITS
2	6/20/09	ISSUED FOR PERMITS
3	6/20/09	ISSUED FOR PERMITS

DATE: 6/20/09

CATCH BASIN (TYPE 1)

CITY OF BATTLE GROUND APPROVED

REVISION	DATE	DESCRIPTION
1	6/20/09	ISSUED FOR PERMITS
2	6/20/09	ISSUED FOR PERMITS
3	6/20/09	ISSUED FOR PERMITS

DATE: 6/20/09

DRAIN BASIN (NYLOPLAST OR EQUAL)

CITY OF BATTLE GROUND APPROVED

REVISION	DATE	DESCRIPTION
1	6/20/09	ISSUED FOR PERMITS
2	6/20/09	ISSUED FOR PERMITS
3	6/20/09	ISSUED FOR PERMITS

DATE: 6/20/09

CITY OF BATTLE GROUND

108 S.W. 1ST. STREET
SUITE 122
BATTLE GROUND, WA. 98604

ENGINEERING 360-342-5070

CITY OF BATTLE GROUND

E MAIN ST SIDEWALK IMPROVEMENTS

STORM DETAILS

DESIGNED: JMH
DRAWN: JMH
HOR: N/A
VERT: N/A
DATE: 7/20/2010
DWG: D05
SHEET 20 OF 21

