



1300 S. Evergreen Park Drive SW
PO Box 47250
Olympia, WA 98504-7250
(360)664-1257 or (360)664-1100
Fax: (360)586-1150
Web: www.wutc.wa.gov
E-mail: records@utc.wa.gov

**GRADE CROSSING PROTECTIVE FUND
2009 – 2011 GRANT APPLICATION
IMPROVEMENTS AT PUBLIC PASSIVE RAILROAD CROSSINGS**

The Washington Utilities and Transportation Commission (commission), through its Grade Crossing Protective Fund (GCPF), provides grants for projects that eliminate or mitigate public safety hazards at railroad crossings and along railroad rights-of-way in Washington State. As part of its 2009-2011 GCPF program, the commission has designated certain funds specifically for the purpose of improving safety at public, passively-protected railroad crossings in Washington. GCPF funds may be used for purchasing stop signs¹, yield signs, retro-reflective tape, posts (if required), retro-reflective cross buck signs, and emergency notification signs to a maximum of \$250 for each crossing. Under this program, GCPF funds may not be used for labor costs. All installations must be MUTCD compliant.

To apply for a grant to improve safety at a passive railroad crossing, complete the following information and submit it and attachments to the commission.

Applicant Information

Applicant Name:	<u>Todd Kuhn</u>
Organization:	<u>BNSF Railway Company</u>
Address:	<u>2454 Occidental Avenue South, Suite 2D, Seattle, WA 98134</u>
Phone:	<u>206-625-6146</u>
E-mail:	<u>todd.kuhn@bnsf.com</u>
Fax:	<u>206-625-6115</u>

Project Information

Attach additional sheets as necessary to the application that provide the following:

1. A list all other companies, organizations, state agencies or local governments that may be involved in implementing this proposal and the contact name, address and phone number or e-mail address for each (if known).

¹ Replacement signs only. Proposals to install a stop sign at a crossing not currently stop-controlled requires an on-site diagnostic with commission staff and a commission order authorizing the installation.

GCPF Application Form – Stop/Yield Signs at Crossings

2. A list of each railroad crossing, by USDOT number, street name, and county, where the applicant plans to improve safety and indicate which type of warning sign or other measure will be installed.
3. A cost estimate, including:
 - a. An itemized list of the total costs of the project.
 - b. Names of parties contributing to the project, including the applicant, and the amount each is contributing.
4. An estimated timeline of the project.
5. Any other information the applicant believes would be useful to the commission in considering the project.

Railroad Commitment

If the applicant is not the railroad owning the crossing, the applicant must submit the attached Railroad Commitment form, completed by the railroad owning the crossing.

Submitting the Application

After completing the application, please send the original to:
Washington Utilities and Transportation Commission
Attention: Grade Crossing Protective Fund
1300 S. Evergreen Park Drive SW
PO Box 47250
Olympia, WA 98504-7250

A signed application may be filed electronically at records@utc.wa.gov. When filing electronically, please specify “Grade Crossing Protective Fund” in the subject line.

Assistance

For questions or assistance, please contact:

- Kathy Hunter at (360)664-1257 or by e-mail at khunter@utc.wa.gov
- David Pratt at (360)664-1100 or by e-mail at dpratt@utc.wa.gov



Todd M. Kuhn, PE
Manager Public Projects

BNSF Railway Company
2454 Occidental Ave S Suite 2D
Seattle, WA 98134

206-625-6146
206-625-6115 (fax)
Todd.Kuhn@bnsf.com

January 19, 2010

Washington Utilities and Transportation Commission
1300 S. Evergreen Park Drive SW
PO Box 47250
Olympia, WA 98504-7250

Re: Grade Crossing Protective Fund Application

BNSF Railway Company is applying to the Grade Crossing Protective Fund to improve safety at all mainline public passive crossings in Washington State that are maintained by BNSF. According to our records, BNSF maintains the following public passive crossings in Washington:

Total Public Passive Crossings:	404
Mainline Public Passive Crossings:	201 (GCPF application)
Non-Mainline Public Passive Crossings:	203
Public Passive Crossings with Passenger Service:	62

The detailed list of the 201 crossings as part of this application is attached with this package. BNSF plans to install new yield (or stop) signs, wood posts with retro-reflective tape, retro-reflective crossbuck signs, and emergency notification signs at all of the 201 crossings listed. All installations will be in accordance with the attached BNSF standard plans, which are in compliance with the 2009 MUTCD. All crossings listed with "Xbucks" currently have crossbucks, and crossings listed with "StopSigns" currently have crossbucks and stop signs. For all listed crossings, BNSF will install new crossbucks with yield signs and will install new crossbucks with stop signs only if stop signs currently exist at the crossing. All labor on the project will be performed by BNSF forces.

The estimated cost of improving these 201 crossings is detailed below. BNSF is applying for grant funding of \$250 toward the material for each crossing.

	Total Project Cost	Per Crossing Cost
Labor	\$70,800	\$352.24
Material	\$62,900	\$312.94
Contingency	\$13,370	\$66.52
Total	\$147,070	\$731.69
Proposed UTC Funding Share For Material	\$50,250	\$250.00
BNSF Funding	\$96,820	\$481.69

BNSF expects to be able to complete this project by January 17, 2011.

If you have any questions or require additional information, please contact me at todd.kuhn@bnsf.com or (206) 625-6146.

Regards,

A handwritten signature in black ink, appearing to read "Todd M. Kuhn", followed by a long horizontal flourish line extending to the right.

Todd M. Kuhn

**BNSF Mainline Public Passive Crossings
Application for GCPF**

LS	MP	DOT #	Street	City	#Mains	#Other	Warning	Passenger?	Latitude	Longitude	Roadmaster
37	1467.61	058793S	FARWELL ROAD	SPOKANE	1	0	XBucks	No	47.77269633	-117.3459904	Abeyta
37	1468.17	058795F	MARKET ST.	SPOKANE	1	1	XBucks	No	47.76552549	-117.3510346	Abeyta
37	1468.17	058799H	PARKSMITH RD	SPOKANE	1	2	XBucks	No	47.76549313	-117.3510576	Abeyta
37	1468.17	058800A	HAWTHORNE RD.	SPOKANE	1	2	XBucks	No	47.76546782	-117.3510755	Abeyta
37	1473.61	065972A	BRIDGPORT AVE.	SPOKANE	1	0	XBucks	No	47.68804136	-117.3633788	Abeyta
37	1473.82	065974N	FAIRVIEW AVE	SPOKANE	1	0	XBucks	No	47.68515956	-117.3634122	Abeyta
37	1473.89	065975V	CLEVELAND AVE	SPOKANE	1	0	XBucks	No	47.68413646	-117.3635016	Abeyta
37	1490.16	058634K	DENO ROAD	SPOKANE	1	1	StopSigns	Yes	47.6718774	-117.5852015	Christ
37	1491.3	058636Y	CRAIG RD	SPOKANE	1	0	StopSigns	Yes	47.66273326	-117.6038047	Christ
37	1493.71	058638M	DOVER RD	SPOKANE	1	0	StopSigns	Yes	47.64391082	-117.647126	Christ
37	1501.88	058649A	STANGLAND ROAD	SPOKANE	1	0	StopSigns	Yes	47.57537273	-117.7901946	Christ
37	1505.42	058650U	WAKON ROAD	DAVENPORT	1	1	StopSigns	Yes	47.5403986	-117.8436718	Christ
37	1511.21	058659F	OREGON ST.	DAVENPORT	1	2	XBucks	Yes	47.50630339	-117.951085	Christ
37	1512.27	058660A	KAISER RD	DAVENPORT	1	0	XBucks	Yes	47.49917804	-117.9723217	Christ
37	1513.26	058661G	COUNTY RD # 6171	DAVENPORT	1	0	XBucks	Yes	47.49600633	-117.9939116	Christ
37	1517.24	058664C	CRABCREEK RD.	DAVENPORT	1	0	XBucks	Yes	47.50916339	-118.0703983	Christ
37	1522.4	065712G	COUNTY RD # 3573	HARRINGTON	2	0	XBucks	Yes	47.52197245	-118.1670362	Christ
37	1530.21	065722M	COUNTY RD # 3500	HARRINGTON	2	0	XBucks	Yes	47.44948272	-118.2655909	Christ
37	1542.75	065732T	COUNTY ROAD	ODESSA	1	1	XBucks	Yes	47.36055568	-118.4785609	Christ
37	1549	065739R	COUNTY RD # 2117	ODESSA	1	0	XBucks	Yes	47.33845089	-118.6044006	Christ
37	1562.12	065748P	IRBY ROAD	ODESSA	1	2	XBucks	Yes	47.35965885	-118.8509529	Christ
37	1603.94	065783D	'F' NW ROAD	EPHRATA	1	1	XBucks	Yes	47.26505558	-119.6058007	Christ
37	1609.38	065790N	J 75 NW	EPHRATA	1	1	StopSigns	Yes	47.25006365	-119.7196055	Christ
37	1614.74	065797L	DIVISION ST	EPHRATA	1	0	XBucks	Yes	47.320259	-119.548874	Christ
37	1614.74	065798T	PUBLIC XING	EPHRATA	1	0	XBucks	Yes	47.239937	-119.830681	Christ
37	1631.11	065809D	COUNTY ROAD	WENATCHEE	1	0	XBucks	Yes	47.24315462	-120.0843618	Christ
37	1633.7	065810X	COUNTY ROAD	EAST WENATCHEE	1	0	StopSigns	Yes	47.29401088	-120.0825705	Christ
37	1634.52	065811E	COUNTY ROAD	EAST WENATCHEE	1	1	XBucks	Yes	47.30862327	-120.0834573	Christ
37	1643.3	065815G	KAWECKI CHEM RD.	WENATCHEE	1	1	XBucks	Yes	47.37239211	-120.1971144	Christ
37	1650.37	065837G	THURSTON	WENATCHEE	1	3	XBucks	Yes	47.420124	-120.305809	Christ
37	1661.99	084467G	COUNTY RD	CASHMERE	1	0	XBucks	Yes	47.52494385	-120.485201	Hughes
37	1665.89	084474S	DEPOT RD	DRYDEN	1	0	XBucks	Yes	47.54171657	-120.5594767	Hughes
37	1669.31	084479B	MILL RD	PESHASTIN	1	1	XBucks	Yes	47.573223	-120.6058783	Hughes
37	1675.85	924593X	PVT XING	LEAVENWORTH	1	0	XBucks	Yes	47.65608	-120.64494	Hughes
37	1681.25	084499M	RIVER RD.	LEAVENWORTH	1	0	XBucks	Yes	47.71721909	-120.665329	Hughes
37	1689.8	084503A	JULIUS LAKE	LEAVENWORTH	1	0	StopSigns	Yes	47.76496882	-120.7923226	Hughes
37	1731.9	084516B	OLD CASCADE HWY	SKYKOMISH	1	2	XBucks	Yes	47.495926	-121.778549	Hughes
37	1734	084519W	MILLER RIVER RD	SKYKOMISH	1	1	XBucks	Yes	47.71789455	-121.3908291	Hughes
37	1761.23	084548G	6TH ST	SULTAN	1	0	XBucks	Yes	47.86152237	-121.8134964	Hughes

**BNSF Mainline Public Passive Crossings
Application for GCPF**

LS	MP	DOT #	Street	City	#Mains	#Other	Warning	Passenger?	Latitude	Longitude	Roadmaster
37	1762.08	084552W	299 AVE SW	SULTAN	1	0	StopSigns	Yes	47.85772672	-121.8309743	Hughes
37	1765.77	084556Y	SOFIE RD (EAST)	MONROE	1	0	StopSigns	Yes	47.85446673	-121.9073414	Hughes
37	1766.69	084557F	SOFIE RD (WEST)	MONROE	1	0	StopSigns	Yes	47.85551289	-121.9272247	Hughes
45	67.07	066392M	AIRPORT ST	SPOKANE	2	1	XBucks	No	47.67194104	-117.3238833	Abeyta
45	68.09	066397W	ALKI AVE	SPOKANE	2	1	XBucks	No	47.66773569	-117.3446698	Abeyta
45	68.09	066401J	SYCAMORE ST	SPOKANE	2	1	XBucks	No	47.66759183	-117.3454403	Abeyta
45	68.09	066402R	FREYA ST.	SPOKANE	2	1	XBucks	No	47.66758748	-117.345462	Abeyta
45	68.09	066405L	RALPH ST	SPOKANE	2	2	XBucks	No	47.66757725	-117.3455128	Abeyta
45	68.1	066406T	FISKE ST	SPOKANE	2	1	XBucks	No	47.66757406	-117.3455294	Abeyta
45	68.1	066413D	ALKI AVE & REGAL	SPOKANE	2	1	XBucks	No	47.66756686	-117.3455656	Abeyta
45	69.07	066408G	FISKE STREET	SPOKANE	2	1	XBucks	No	47.66357933	-117.3654288	Abeyta
46	9.65	065968K	SCRIBNER RD	SPOKANE	1	0	XBucks	Yes	47.55467869	-117.5000629	Chicks
46	31.43	089633N	BUFFALO ROAD	SPRAGUE	1	0	XBucks	Yes	47.38380723	-117.8339106	Chicks
46	33.45	089635C	COUNTY RD	SPRAGUE	1	0	XBucks	Yes	47.36035237	-117.8588255	Chicks
46	47.81	089647W	BOB LEE ROAD	RITZVILLE	1	0	XBucks	Yes	47.25605053	-118.0840987	Chicks
46	50.89	089650E	WELLSANDT ROAD	RITZVILLE	1	0	XBucks	Yes	47.24103853	-118.1517885	Chicks
46	58.58	089653A	KLEIN RD	RITZVILLE	1	1	XBucks	Yes	47.19126904	-118.2925794	Chicks
46	59.86	089654G		RITZVILLE	1	0	XBucks	Yes	47.17503765	-118.3054809	Chicks
46	62.57	089655N	SAGE RD	RITZVILLE	1	0	XBucks	Yes	47.14725549	-118.3443188	Chicks
46	71.85	089664M	BAUER RD	RITZVILLE	1	0	XBucks	Yes	47.04451047	-118.4499009	Chicks
46	76.42	089667H	ANDERSON RD	LIND	1	0	XBucks	Yes	47.00824022	-118.530366	Chicks
46	100.7	089682K	HAMPTON ROAD	HATTON	1	0	XBucks	Yes	46.7788847	-118.8247808	Chicks
46	121.37	089696T	HALLEY ROAD	MESA	1	0	XBucks	Yes	46.55699898	-119.000638	Chicks
46	142.32	089703B	PUBLIC XING	ELTOPIA	2	1	XBucks	Yes	46.27391719	-119.105149	Gibson
46	143	089704H	OREGON ST	PASCO	2	1	XBucks	Yes	46.26921093	-119.102898	Gibson
46	145.74	089988P	S. 1ST ST.	PASCO	1	3	XBucks	No	46.229301	-119.085297	Gibson
46	145.74	090030M	S 2ND AVE	PASCO	1	1	XBucks	No	46.232006	-119.082443	Gibson
46	145.86	090010B	S 1ST ST	PASCO	1	1	XBucks	No	46.229301	-119.085297	Gibson
46	145.86	090011H	S 4TH AVE	PASCO	1	1	XBucks	No	46.228401	-119.089897	Gibson
46	145.86	090012P	S 5TH AVE.	PASCO	1	2	XBucks	No	46.228298	-119.091904	Gibson
46	145.86	090013W	S 6TH ST	PASCO	1	2	XBucks	No	46.2281	-119.093903	Gibson
46	145.86	090017Y	S 10TH AVE.	PASCO	1	1	XBucks	No	46.2276	-119.0998	Gibson
46	145.86	090018F	S 11TH AVE.	PASCO	1	3	XBucks	No	46.227501	-119.101303	Gibson
46	145.86	090020G	A" ST. "	PASCO	1	1	XBucks	No	46.244507	-119.0877	Gibson
46	145.86	090021N	AINSWORTH AVE EXT	PASCO	1	2	XBucks	No	46.226898	-119.1064	Gibson
46	145.86	090024J	S 9TH ST.	PASCO	1	2	XBucks	No	46.2211	-119.100098	Gibson
46	145.86	090025R	S 8TH AVE	PASCO	1	2	XBucks	No	46.221001	-119.098701	Gibson
46	145.86	090027E	S. 5TH AVE. EXT	PASCO	1	1	XBucks	No	46.228298	-119.091904	Gibson
47	35.54	090129X	CAPE HORN RD.	SKAMANIA	1	0	XBucks	Yes	45.57509035	-122.1902268	Frederick

**BNSF Mainline Public Passive Crossings
Application for GCPF**

LS	MP	DOT #	Street	City	#Mains	#Other	Warning	Passenger?	Latitude	Longitude	Roadmaster
47	54.75	090151K	CEMETERY XING	STEVENSON	1	1	XBucks	Yes	45.69967992	-121.8688868	Frederick
47	98.57	090183R	SPEARFISH RD.	LYLE	1	0	XBucks	Yes	45.64003004	-121.1040648	Frederick
47	169.61	090062T	WHITCOMB ISLAND	PATERSON	1	1	XBucks	Yes	45.86521065	-119.790285	Gibson
47	220.37	090051F	EVANS RD.	KENNEWICK	1	0	XBucks	Yes	46.11243239	-118.9766486	Gibson
47	237.78	089545D	MARTINDALE ROAD	PASCO	1	1	XBucks	No	46.243183	-118.960335	Gibson
47	367.5	095923K	SCRIBNER ROAD	SPOKANE	1	1	XBucks	Yes	47.55572998	-117.5010439	Chicks
48	17.26	104564Y	GOOSE GAP RD	KENNEWICK	1	0	XBucks	No	46.20240374	-119.3619737	Gibson
48	33.58	104557N	HANSEN RD	KIONA	1	1	XBucks	No	46.24203545	-119.6411138	Gibson
48	39.26	104552E	LOOP CTY	PROSSER	1	0	XBucks	No	46.21445699	-119.7476609	Gibson
48	40.3	104549W	EIGHTH ST	PROSSER	1	1	XBucks	No	46.2089199	-119.7672937	Gibson
48	42.65	104544M	RICHARDS RD	PROSSER	1	0	XBucks	No	46.19307473	-119.8096549	Gibson
48	44.21	104542Y	WARD GAP RD	MABTON	1	0	XBucks	No	46.18779433	-119.8411497	Gibson
48	45.9	104540K	BYRON HILL RD	MABTON	1	1	XBucks	No	46.18799332	-119.8761357	Gibson
48	47.81	104538J	BUS ROAD	MABTON	1	0	XBucks	No	46.19205782	-119.917106	Gibson
48	49.56	104537C	PHILLIPS RD	MABTON	1	0	XBucks	No	46.19986465	-119.9497746	Gibson
48	54.23	104531L	HOLT RD	MABTON	1	0	XBucks	No	46.22248951	-120.042009	Gibson
48	60.4	104528D	N SATUS RD	MABTON	1	0	XBucks	No	46.27055093	-120.1493856	Gibson
48	62.39	104526P	BARNHART RD	MABTON	1	0	XBucks	No	46.29032071	-120.1790926	Gibson
48	68.6	104516J	STEVENS RD	TOPPENISH	1	0	XBucks	No	46.35255451	-120.2728951	Gibson
48	75.34	099185K	OLDEN WAY	WAPATO	1	0	XBucks	No	46.4199048	-120.3748142	Gibson
48	97.44	085196G	POMONA RD	SELAH	1	1	XBucks	No	46.69379999	-120.4883915	Gibson
48	121.97	085193L	RINGER RD	ELLENSBURG	1	1	XBucks	No	46.92839068	-120.5114168	Gibson
48	122.8	085192E	W RINGER RD	ELLENSBURG	1	1	XBucks	No	46.93950569	-120.517972	Gibson
48	123.99	085191X	STONE RD	ELLENSBURG	1	0	XBucks	No	46.95469918	-120.5283494	Gibson
48	125.13	085189W	BERRY RD	ELLENSBURG	1	0	StopSigns	No	46.96971258	-120.5386329	Gibson
48	126.16	085186B	MAIN ST	ELLENSBURG	1	0	StopSigns	No	46.98414946	-120.5485145	Gibson
49	4.71	085218E	KLOCKE RD	ELLENSBURG	1	0	XBucks	No	47.04313837	-120.6240803	Hammond
49	5.74	085219L	MCMANAMY RD	ELLENSBURG	1	0	XBucks	No	47.05368951	-120.6394676	Hammond
49	7.4	085220F	2ND ST	THORP	1	0	XBucks	No	47.06738453	-120.6678135	Hammond
49	20.8	085226W		CLE ELUM	1	0	XBucks	No	47.17486836	-120.857988	Hammond
49	23.79	085229S		CLE ELUM	1	0	XBucks	No	47.19062701	-120.9154367	Hammond
49	59.42	085181S	FOREST SERVICE RD	LESTER	1	1	XBucks	No	47.20922662	-121.4904853	Hammond
50	28.73	085453C	MUKILTEO BLVD	MUKILTEO	1	1	XBucks	No	47.869999	-122.327698	Hughes
50	52.41	084683A	48TH N.W.	STANWOOD	1	0	StopSigns	Yes	48.21853008	-122.2971902	Owen
50	60.28	084727X	MILLTOWN	MOUNT VERNON	1	0	XBucks	Yes	48.30852639	-122.348649	Owen
50	63.58	084735P	JOHNSON RD	MOUNT VERNON	1	0	StopSigns	Yes	48.35589823	-122.3409721	Owen
50	64.58	084736W	STACK POLE RD	MOUNT VERNON	1	0	StopSigns	Yes	48.37032853	-122.3395642	Owen
50	97.16	084815H	C" ST	BELLINGHAM	1	1	StopSigns	Yes	48.75330205	-122.4860277	Owen
50	107.07	084838P	THORNTON DR	FERNDAL	1	1	StopSigns	Yes	48.86291269	-122.5901222	Owen

**BNSF Mainline Public Passive Crossings
Application for GCPF**

LS	MP	DOT #	Street	City	#Mains	#Other	Warning	Passenger?	Latitude	Longitude	Roadmaster
52	82.72	092481X	TAYLOR CRANE RD	CASTLE ROCK	2	0	StopSigns	Yes	46.34022148	-122.9266596	Wright
376	17.8	059083H	CRESCENT ROAD	DEER PARK	1	0	XBucks	No	47.86793605	-117.3741003	Abeyta
376	19.28	059084P	CHATTAROY RD	DEER PARK	1	0	XBucks	No	47.88674341	-117.3846228	Abeyta
376	22.75	059087K	CEDAR STREET	DEER PARK	1	0	XBucks	No	47.90985291	-117.4387882	Abeyta
376	28.81	059095C	PUB XING	DEER PARK	1	0	XBucks	No	47.97150024	-117.5126618	Abeyta
376	29.52	059096J	PUB XING	DEER PARK	1	0	XBucks	No	47.97872867	-117.5233472	Abeyta
376	30.64	059097R	MONTGOMERY ROAD	DEER PARK	1	0	XBucks	No	47.99016315	-117.5402633	Abeyta
376	30.99	059099E	PUB XING	CLAYTON	1	0	XBucks	No	47.9936427	-117.5454127	Abeyta
376	31.52	059100W	JOHNSON RD	CLAYTON	1	0	XBucks	No	47.9968408	-117.5551617	Abeyta
376	32.19	059102K	WITTER ROAD	CLAYTON	1	0	XBucks	No	47.99906738	-117.5671635	Abeyta
376	34.26	059104Y	PUB XING	CLAYTON	1	0	XBucks	No	48.01945393	-117.5879544	Abeyta
376	36.21	059106M	GRANITE POINT	CLAYTON	1	0	XBucks	No	48.03816451	-117.6071527	Abeyta
376	37.15	059109H	SUNSET DRIVE RD	SPRINGDALE	1	0	StopSigns	No	48.04988355	-117.6142375	Abeyta
376	38.01	059110C	NORTH SHORE DRIVE	SPRINGDALE	1	0	XBucks	No	48.05886233	-117.6246869	Abeyta
376	38.45	059112R	CEDAR ST.	SPRINGDALE	1	1	XBucks	No	48.0614581	-117.6334454	Abeyta
376	38.68	059113X	COLVILLE ROAD	SPRINGDALE	1	0	XBucks	No	48.06279085	-117.637941	Abeyta
376	43.48	059115L	PUB XING	SPRINGDALE	1	0	XBucks	No	48.07950598	-117.6915293	Abeyta
376	49.89	059119N	PUB XING	VALLEY	1	0	XBucks	No	48.08813831	-117.7539491	Abeyta
376	54.04	059127F	PUB XING	VALLEY	1	0	XBucks	No	48.14139852	-117.7307858	Abeyta
376	56.46	059135X	HEMLOCK ST.	VALLEY	1	0	XBucks	No	48.17516083	-117.7269581	Abeyta
376	59.4	059306W	PUB XING	VALLEY	1	0	XBucks	No	48.20846942	-117.7303767	Abeyta
387	3.6	065844S	EUCLID	WENATCHEE	1	0	StopSigns	No			Christ
399	1.81	396829D	ROEDER AVE.	BELLINGHAM	1	0	XBucks	No	48.752197	-122.482521	Owen
399	2.1	396830X	SQUALICUM WAY	BELLINGHAM	1	0	XBucks	No	48.759899	-122.503021	Owen
399	2.31	396832L	ROEDER AVE.	BELLINGHAM	1	0	XBucks	No	48.759899	-122.503021	Owen
399	21.54	396889M	VAN BUREN RD.	SUMAS	1	0	StopSigns	No	48.971676	-122.329849	Owen
399	22.24	396891N	CLEARBROOK RD.	SUMAS	1	0	XBucks	No	48.7533	-122.48452	Owen
399	24.21	396893C	BARBO RD	SUMAS	1	0	XBucks	No	48.994011	-122.283577	Owen
400	12.04	085311L	E LINCOLN RD	FORT LEWIS	1	0	XBucks	No	47.11684484	-122.5006217	Hammond
400	13.7	085312T	PUBLIC XING	FORT LEWIS	1	0	XBucks	No	47.09313369	-122.5040599	Hammond
400	13.88	085313A		FORT LEWIS	1	0	StopSigns	No	47.0906244	-122.5048998	Hammond
400	15.18	085314G		FORT LEWIS	1	0	StopSigns	No	47.07270021	-122.5136921	Hammond
400	17.57	085316V	E. GATE ROAD	FORT LEWIS	1	0	XBucks	No	47.03993631	-122.5290541	Hammond
400	19.72	085318J	WARREN ST.	ROY	1	0	XBucks	No	47.00975131	-122.5405673	Hammond
400	20.07	085319R	WATER ST	ROY	1	1	XBucks	No	47.00503302	-122.5431072	Hammond
400	20.27	085320K	4TH ST	ROY	1	1	XBucks	No	47.00213188	-122.5446504	Hammond
403	86.25	085089S	JAMESON ST	SEDRO WOOLLEY	1	3	StopSigns	No	48.534512	-122.26741	Owen
403	86.55	085093G	W STATE ST	SEDRO WOOLLEY	1	5	XBucks	No	48.503532	-122.239899	Owen
403	103.03	085118A	ROTHENBUHLER RD	SEDRO WOOLLEY	1	0	XBucks	No	48.71106882	-122.2014122	Owen

**BNSF Mainline Public Passive Crossings
Application for GCPF**

LS	MP	DOT #	Street	City	#Mains	#Other	Warning	Passenger?	Latitude	Longitude	Roadmaster
403	105.53	085125K	HOMESTEADER RD	SEDRO WOOLLEY	1	0	XBucks	No	48.74604698	-122.2009177	Owen
403	106.54	085126S	STRAND RD	SEDRO WOOLLEY	1	0	XBucks	No	48.76026899	-122.1964213	Owen
403	107.29	085127Y	NELSON RD	SEDRO WOOLLEY	1	0	XBucks	No	48.77089467	-122.1930455	Owen
403	111.37	085134J	PUBLIC XING	SEDRO WOOLLEY	1	1	XBucks	No	48.82373884	-122.2181914	Owen
403	115.25	084905G	E HOFF RD	BELLINGHAM	1	0	XBucks	No	48.8545996	-122.2885667	Owen
403	117.84	084910D	HOPEWELL RD	BELLINGHAM	1	0	XBucks	No	48.88381433	-122.3212424	Owen
403	118.6	084914F	COLE RD	BELLINGHAM	1	0	XBucks	No	48.89477151	-122.3211625	Owen
403	126.85	084934S	W 3RD ST	SUMAS	1	1	XBucks	No	48.99747664	-122.2662774	Owen
403	126.92	084935Y	2ND ST	SUMAS	1	3	XBucks	No	48.946968	-122.449356	Owen
403	127.01	084936F	W GARFIELD ST	SUMAS	1	6	XBucks	No	48.99994706	-122.2666113	Owen
405	5.38	091736N	MOUNTAIN VW AVE N	RENTON	1	0	XBucks	No	47.52062933	-122.2092766	Farley
405	5.65	091738C	LAKE BLVD	RENTON	1	0	XBucks	No	47.52464758	-122.2066794	Farley
406	0.63	092080X	128TH ST. N.E.	MARYSVILLE	1	0	XBucks	No	48.11098247	-122.1754483	Hughes
406	1.23	092081E	136TH ST. N.E.	MARYSVILLE	1	0	XBucks	No	48.11849522	-122.1690606	Hughes
406	1.8	092082L	51STAVE. N.E.	MARYSVILLE	1	0	XBucks	No	48.12547055	-122.1626049	Hughes
406	5.92	092091K	204TH ST. N.E.	ARLINGTON	1	1	XBucks	No	48.18085972	-122.1378281	Hughes
409	15.16	092252D	PULVER RD.	BURLINGTON	1	0	XBucks	No	48.46597157	-122.357074	Owen
409	16.45	092259B	WALNUT ST.	BURLINGTON	1	1	XBucks	No	48.47415177	-122.3322632	Owen
409	16.53	092260V	SPRUCE ST	BURLINGTON	1	1	XBucks	No	48.47437236	-122.3307542	Owen
409	16.67	092261C	FAIRHAVEN ST	BURLINGTON	1	0	XBucks	No	48.47551143	-122.3278011	Owen
409	16.76	092262J	N PINE ST	BURLINGTON	1	0	XBucks	No	48.4761137	-122.3262702	Owen
409	16.84	092263R	ANACORTES ST	BURLINGTON	1	0	XBucks	No	48.47661601	-122.3247637	Owen
409	16.99	092264X	N REGENT ST	BURLINGTON	1	0	XBucks	No	48.47761704	-122.3217308	Owen
409	17.13	092265E	N SKAGIT ST	BURLINGTON	1	0	XBucks	No	48.47847961	-122.3191019	Owen
409	17.41	092266L	N. SECTION ST	BURLINGTON	1	0	XBucks	No	48.48023055	-122.313791	Owen
409	18.59	092270B	LAFAYETTE RD	SEDRO WOOLLEY	1	0	XBucks	No	48.48818299	-122.2913303	Owen
409	19.16	092272P	COLLINS RD	SEDRO WOOLLEY	1	0	XBucks	No	48.49228586	-122.2803652	Owen
409	21.29	085010R	METCALF ST	SEDRO WOOLLEY	1	1	XBucks	No	48.50727288	-122.2399339	Owen
409	21.38	085011X	MURDOCK ST	SEDRO WOOLLEY	1	2	XBucks	No			Owen
409	21.45	085012E	PUGETS AVE	SEDRO WOOLLEY	1	1	XBucks	No			Owen
418	1.86	096119M	HAM RD	FERNDALE	1	0	StopSigns	No	48.92293865	-122.688013	Owen
418	4.95	096134P	BROWN RD	FERNDALE	1	0	XBucks	No	48.88477393	-122.7096247	Owen
418	5.93	096137K	LONGETH RD	FERNDALE	1	0	XBucks	No	48.87023262	-122.7094958	Owen
418	8.77	096158D	UNICK RD	FERNDALE	1	0	XBucks	No	48.83408018	-122.7040915	Owen
450	3.91	097204F	MAIN ST.	BURBANK	1	1	XBucks	No	46.199267	-119.02045	Gibson
450	6.8	097203Y	MCNARY GAME FM.RD	BURBANK	1	0	XBucks	No	46.17035	-118.978967	Gibson
614	0.57	396907H	TRAPLINE RD.	EVERSON	1	0	XBucks	No	48.945757	-122.352344	Owen
614	3.18	396909W	N.WOOD RD.	LYNDEN	1	0	XBucks	No	48.600121	-122.422707	Owen
614	4.38	396910R	GROWER ST.	LYNDEN	1	0	XBucks	No	48.620647	-122.444618	Owen

**BNSF Mainline Public Passive Crossings
Application for GCPF**

LS	MP	DOT #	Street	City	#Mains	#Other	Warning	Passenger?	Latitude	Longitude	Roadmaster
614	4.83	396914T	NOOKSACK ST	LYNDEN	1	0	XBucks	No	48.64967	-122.211906	Owen
614	4.89	396915A	HAWLEY ST.	LYNDEN	1	1	XBucks	No	48.9478	-122.443359	Owen
614	5.07	396916G	1ST ST.	LYNDEN	1	2	XBucks	No	48.946953	-122.447456	Owen
614	5.16	396918V	2ND ST	LYNDEN	1	2	XBucks	No	48.998474	-122.265266	Owen
614	5.24	396919C	3RD ST.	LYNDEN	1	1	XBucks	No	48.946983	-122.451225	Owen
651	66.33	096017U	MISSION AVE	SPOKANE	2	0	XBucks	No	47.67141532	-117.3096347	Abeyta

Total Count: 201

SIGNS:

NO. 61 - "RAILROAD CROSSING"

PLACE SIGN ON THE RIGHT HAND SIDE OF EACH ROADWAY APPROACH TO THE CROSSING. 8'-1" MINIMUM FROM THE EDGE OF ROADWAY TO THE CENTER OF POST OR 14' MINIMUM FROM THE EDGE OF THE TRAVELLED WAY TO THE CENTER OF THE POST IN RURAL AREAS.

EACH SIGN SHALL BE NO CLOSER THAN 14' FROM CENTERLINE OF TRACK EXCEPT AS GOVERNED BY INDIVIDUAL STATE REQUIREMENTS. IN SOME CASES, STATE REGULATIONS SUPERCEDE FEDERAL

NO. 59 - "2", "3", ..."8"

MULTIPLE TRACK SIGN TO BE USED ONLY WHEN MORE THAN ONE TRACK IS TO BE PROTECTED. LETTERED AND MOUNTED AS IN EXAMPLE 1. USE WITH SIGN NO. 60 AND 61.

NO. 60 - "TRACKS"

MULTIPLE TRACK SIGN TO BE USED ONLY WHEN MORE THAN ONE TRACK IS TO BE PROTECTED AND USED WITH SIGN NO. 59. LETTERED AND MOUNTED AS IN EXAMPLE 1.

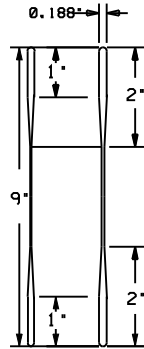
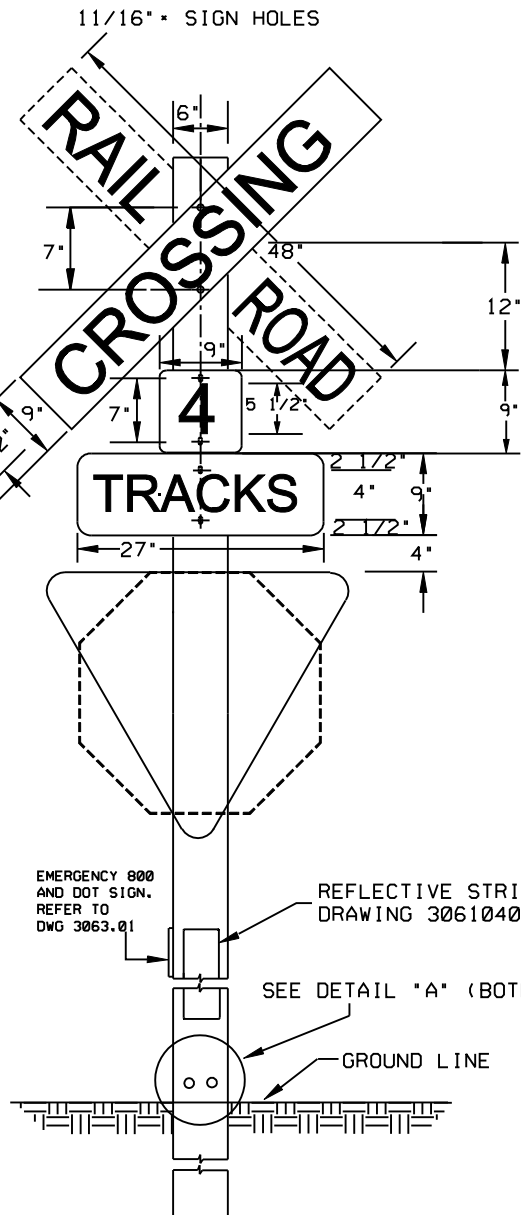

BLADE CROSS SECTION

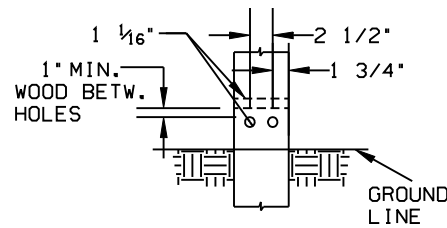

DETAIL "A"

"BREAK AWAY" SIGN POST MUST BE DRILLED PER DETAIL "A", THROUGH BOTH SIDES OF POST, 4'6" FROM ONE END.

BILL OF MATERIALS

QUANTITY	SIGN PANEL	STOCK CODES
1 SET	SIGN NO. 61-RAILROAD CROSSING	004802831
1 EA.	SIGN NO. 60-TRACKS	004804720
3 EA.	REFLECTIVE STRIP (4"X48" STRIPS)	054324553
1 EA.	REFLECTIVE STRIP (4"X24" STRIPS)	054324546
1 EA.	SIGN NO. R1-2 YIELD (36").....	004802419
1 EA.	SIGN NO. 64 STOP (36").....	004804589
1 EA.	SIGN NO. 59-MULTIPLE TRACK NUMBERS, 2 -	004804266
	3 -	004804274
	4 -	004804928
	5 -	004804282
	6 -	004804290
	7 -	004804308
	8 -	004804316

POST AND HARDWARE

- 1 EA. 4" X 6" X 18'-0" TREATED TIMBER POST (HEIGHT MAY BE INCREASED TO MATCH FIELD CONDITIONS)
- 2 EA. 5/16" X 7" GALVANIZED MACHINE BOLTS
- 2 EA. 5/16" GALVANIZED HEX NUTS, TAMPER RESISTANT AND STEEL FLAT WASHERS
- 2 EA. 5/16" NYLON FLAT WASHERS AND LOCK WASHERS (FOR PROTECTION OF FACE OF SIGN, SEE NOTE 6)
- 4 EA. 1/4" X 1 1/2" HEX HEAD LAG SCREW AND 1/4" NYLON FLAT WASHERS (FOR SIGNS NO. 59 & 60 WHEN USED, SEE NOTE 6 FOR INSTALLATION).

NOTES:

1. ALL SIGNS LISTED IN THIS PLAN ARE 9" X 9", 9" X 27", AND 9" X 48" SIZED. SIGN 59 AND 60, WITH WHITE BACKGROUND AND BLACK LETTERS. SIGN 61 WITH WHITE BACKGROUND ON BOTH SIDES WITH BLACK LETTERS EXTRUDED ALUMINUM CONSTRUCTION, DOGBONE DESIGN, DIAMOND GRADE SHEETING.
2. NO OTHER SIGNS MAY BE MOUNTED TO CROSS BUCK POST UNLESS SHOWN IN THIS STANDARD PLAN.
3. ALL SIGNS ARE TO BE PLACED NO CLOSER THAN 14' FROM CENTER LINE TRACK, WHERE PRACTICAL.
4. WHERE THE DISTANCE BETWEEN CENTER LINE TO CENTER LINE OF TRACKS, MEASURED ALONG THE HIGHWAY EXCEEDS 100 FT. (30 METERS) ADDITIONAL CROSSBUCKS (AND OTHER APPROPRIATE) SIGNS ARE TO BE INSTALLED.
5. SEE PLAN 3000.02 FOR ADDITIONAL SPECIFICATIONS AND INFORMATION CONCERNING THE REFLECTIVE AND PANEL MATERIAL.
6. SEE PLAN 3001.01 FOR POST DETAILS
7. NYLON FLAT WASHERS TO BE INSTALLED BETWEEN FACE OF SIGN AND BOLT. HEAD OF BOLT. THIS IS NECESSARY TO COMPLY WITH 3M WARRANTY.
8. USE OF STOP OR YIELD SIGN DETERMINED BY STATE REGULATIONS.

BNSF RAILWAY	
STANDARD PLAN	
HIGHWAY CROSSING SIGNS UNITED STATES BILL OF MATERIALS	
DWG NO. 3061	JAN 19, 2010
SHEET NO. 01	REV. NO. 16

REFER TO DRAWING 30610401 FOR REFLECTIVE STRIP REQUIREMENTS. HIGHWAY CROSSING - UNITED STATES.

A.A.R./D.O.T. AS WELL AS STATE CROSSING IDENTIFICATION NUMBER MARKERS SHOULD BE SHOWN ON THE HIGHWAY SIDE OF POST. PLACED 48" FROM TOP OF SIGN TO GROUND LINE. SEE DWG. 3063.01 FOR DETAILS.

HIGHWAY APPROACH
FRONTAL VIEW OF
CROSSBUCK POST
MULTIPLE TRACKS

HIGHWAY APPROACH
BACK SIDE VIEW
CROSSBUCK POST
MULTIPLE TRACKS

SEE PLAN 3061.01 FOR
CROSSBUCK AND TRACK
NUMBER SIGN DETAILS

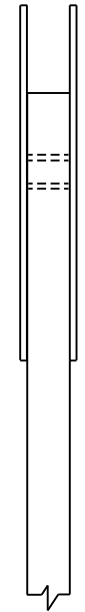
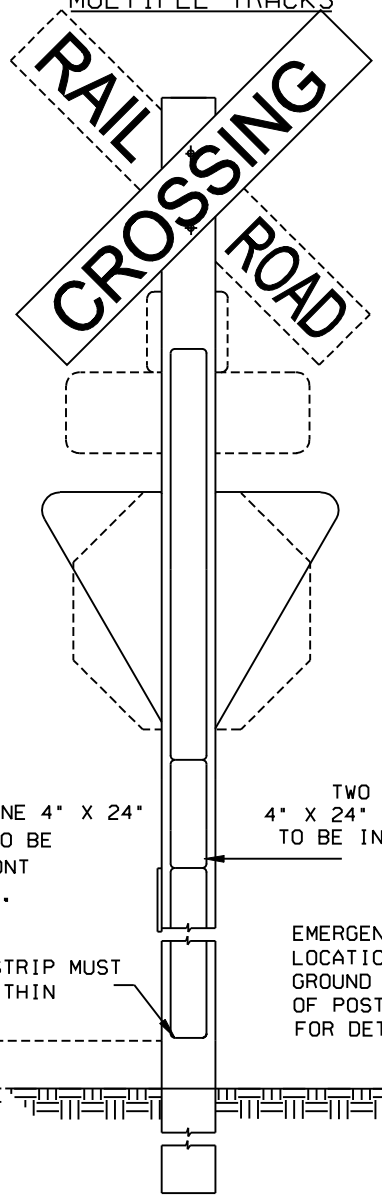
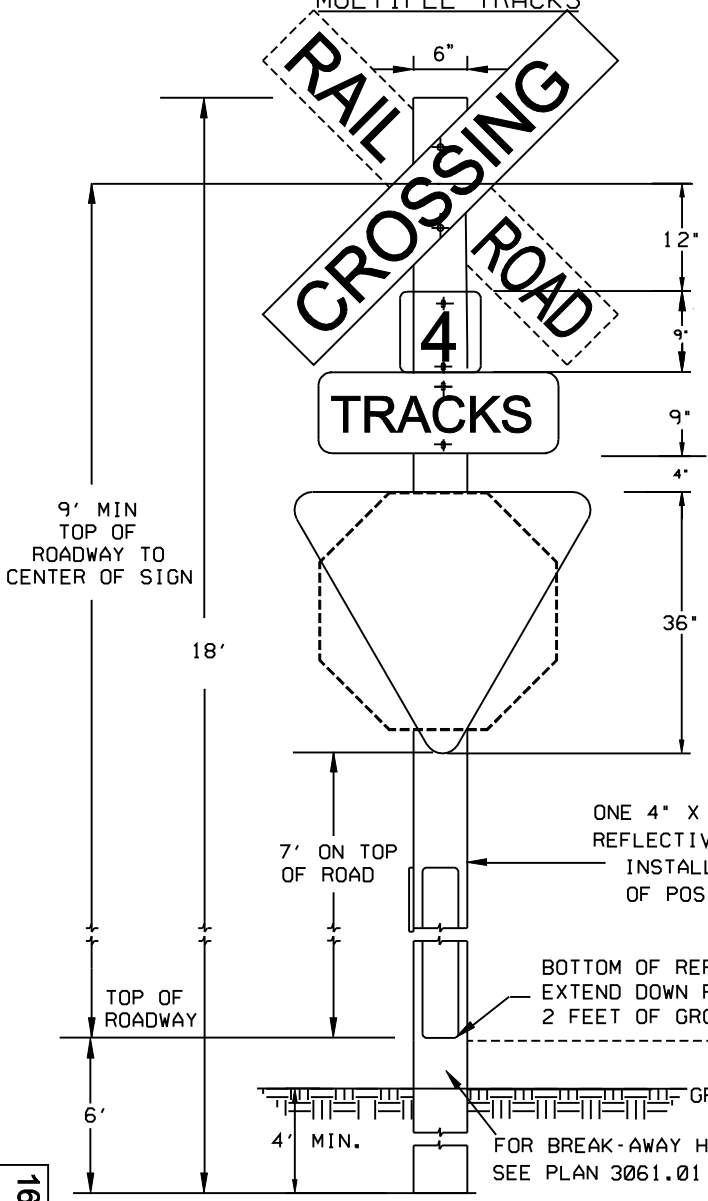

BLADE CROSS SECTION

NOTE:

1. SIGN MANUFACTURER WILL MOUNT REFLECTIVE STRIP ON POST FRONT AND BACK STARTING 6' FROM BOTTOM OF POST. POST WILL HAVE HOLES PRE-DRILLED BY SIGN MANUFACTURER.
2. MOUNT REFLECTIVE STRIPS AS FOLLOWS: PLACE ONE 4" X 48" ON BOTTOM OF POST 2 FEET ABOVE ROADWAY. PLACE 4" X 24" REFLECTIVE STRIP ABOVE THE FIRST REFLECTIVE STRIP. PLACE ANOTHER 4" X 48" REFLECTIVE STRIP ABOVE SECOND STRIP.
3. STOP OR YIELD SIGN DETERMINED BY STATE LAW.
4. PLACE BOTTOM OF REFLECTIVE STRIP WITHIN 24" OF TOP OF GROUND LINE.
5. IF YIELD OR STOP SIGN IS REQUIRED, REMOVE TOP REFLECTIVE STRIP FROM POST.

ONE 4" X 48" AND ONE 4" X 24" REFLECTIVE STRIP TO BE INSTALLED ON FRONT OF POST AS SHOWN.

TWO 4" X 48" AND ONE 4" X 24" REFLECTIVE STRIP TO BE INSTALLED AS SHOWN ON BACK OF POST

EMERGENCY 800 AND DOT LOCATION SIGN. MOUNT 48" ABOVE GROUND LINE ON ROADWAY SIDE OF POST. SEE DWG 3063.01 FOR DETAILS.

BOTTOM OF REFLECTIVE STRIP MUST EXTEND DOWN POLE TO WITHIN 2 FEET OF GROUND LINE

FOR BREAK-AWAY HOLES SEE PLAN 3061.01



STANDARD PLAN

REFLECTIVE STRIP REQUIREMENTS
HIGHWAY CROSSING SIGNS
UNITED STATES FOR
MULTIPLE TRACKS WITH
STOP OR YIELD SIGN

DWG NO. 3061

JUNE 12, 2009

SHEET NO. 04

REV NO. 0

16-16A

HIGHWAY APPROACH
FRONTAL VIEW OF
CROSSBUCK POST
SINGLE TRACK

SINGLE TRACK
BACK SIDE VIEW
OF CROSSBUCK POST

SEE PLAN 3061.01 FOR
CROSSBUCK AND TRACK
NUMBER SIGN DETAILS

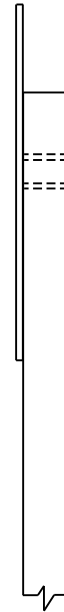
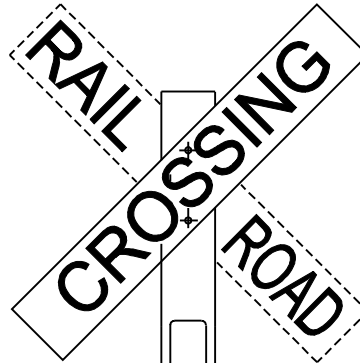
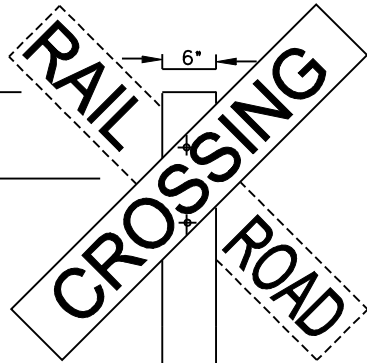

BLADE CROSS SECTION

NOTE:

1. SIGN MANUFACTURER WILL MOUNT REFLECTIVE STRIP ON POST FRONT AND BACK STARTING 6' FROM BOTTOM OF POST. POST WILL HAVE HOLES PRE-DRILLED BY SIGN MANUFACTURER.
2. MOUNT REFLECTIVE STRIPS AS FOLLOWS: PLACE ONE 4" X 48" ON BOTTOM OF POST 2 FEET ABOVE ROADWAY. PLACE 4" X 24" REFLECTIVE STRIP ABOVE THE FIRST REFLECTIVE STRIP. PLACE ANOTHER 4" X 48" REFLECTIVE STRIP ABOVE SECOND STRIP.
3. STOP OR YIELD SIGN DETERMINED BY STATE LAW.
4. PLACE BOTTOM OF REFLECTIVE STRIP WITHIN 24" OF TOP OF GROUND LINE.
5. IF YIELD OR STOP SIGN IS REQUIRED, REMOVE TOP REFLECTIVE STRIP FROM POST.

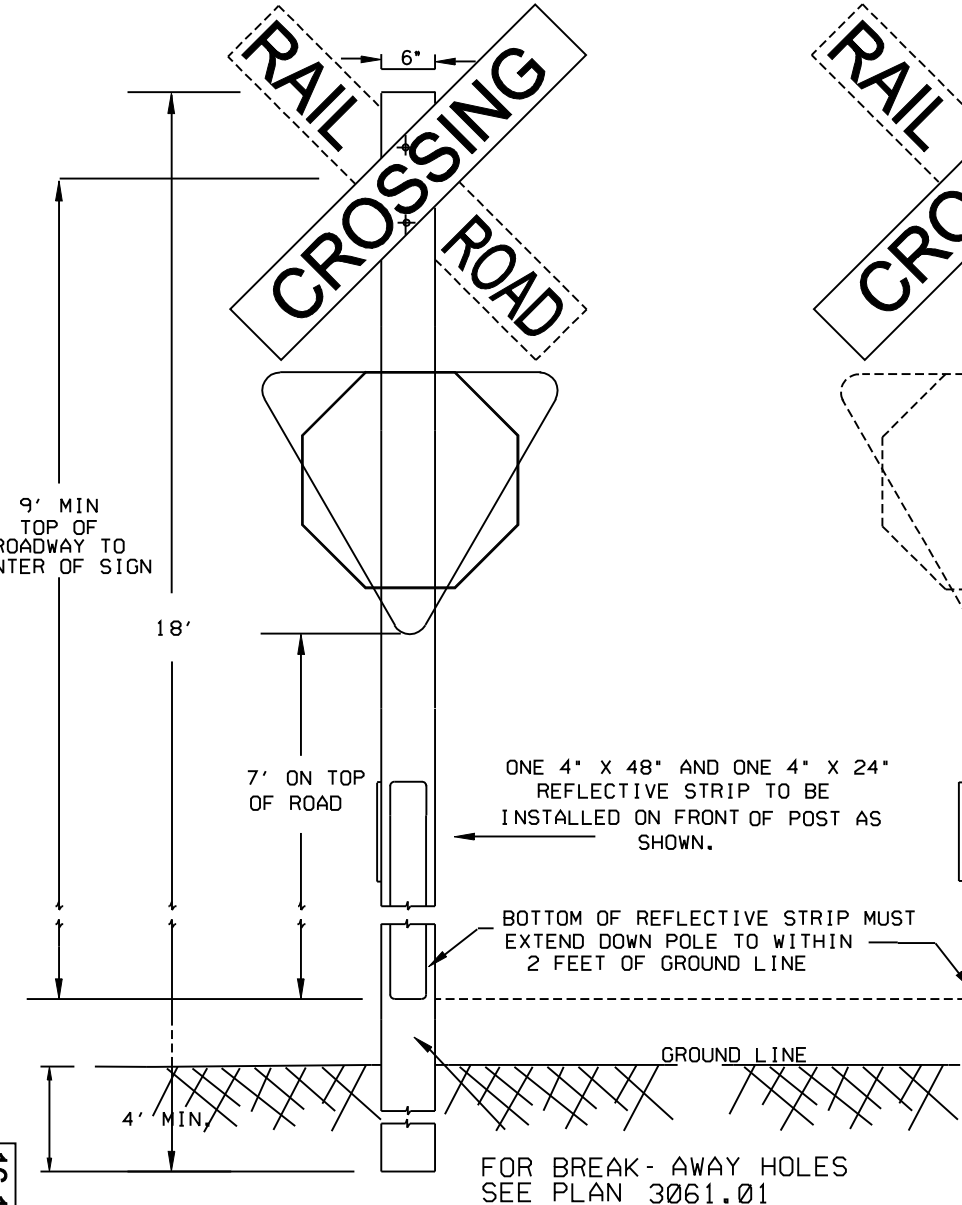

TWO 4"X48" AND ONE 4"X24" REFLECTIVE STRIP TO BE INSTALLED AS SHOWN ON BACK OF POST.

EMERGENCY 800 AND DOT LOCATION SIGN. MOUNT 48" ABOVE GROUND LINE ON ROADWAY SIDE OF POST. SEE DWG 3063.01 FOR DETAILS.



STANDARD PLAN

REFLECTIVE STRIP REQUIREMENTS FOR SINGLE TRACK HIGHWAY CROSSING SIGNS UNITED STATES WITH STOP OR YIELD SIGN

DWG NO. 3061 JUNE 12, 2009

SHEET NO. 06 REV. NO. 0