

NE 1/4 NW 1/4 & SE 1/4 NW 1/4 SEC 9, T 20 N, R 3 E, W.M. TACOMA, WA.

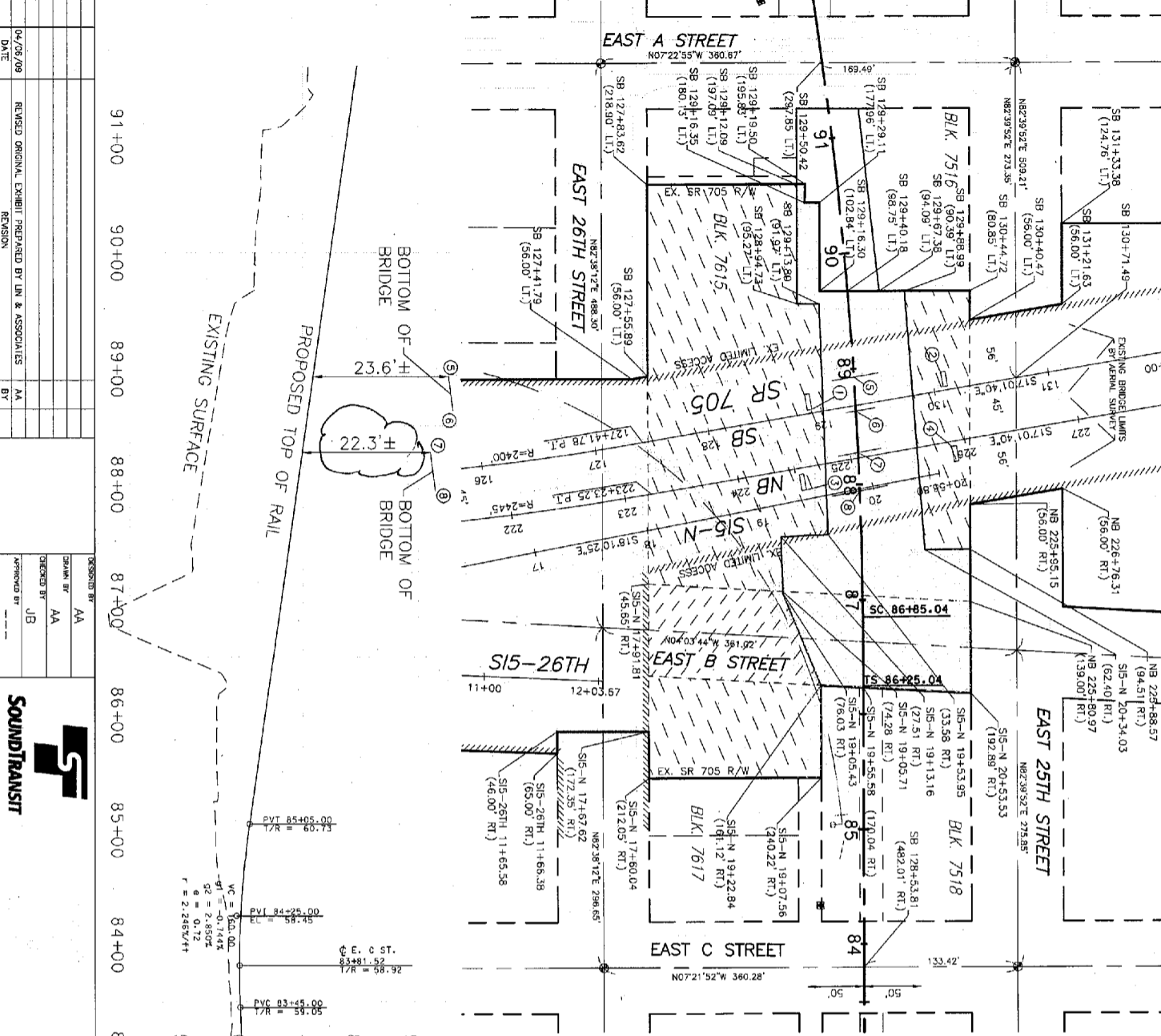

WSDOT PLAN REFERENCE NOTE:
 THIS EXHIBIT PLAN IS INTENDED TO SHOW THE LOCATION OF THE SOUND TRANSIT TACOMA-TO LAKEWOOD COMMUTER RAIL WITHIN THE RIGHT OF WAY OF SR 705. FOR SPECIFIC DETAILS OF THE RIGHT OF WAY OF SR 705 SEE PLAN PLAN ENTITLED SR 705, TACOMA SPUR, PIERCE COUNTY, RIGHT OF WAY AND LIMITED ACCESS PLAN, SHEET 2 OF 6, DATED JUNE 20, 1980, MOST RECENTLY REVISED 5-31-07.

ACCESS NOTES:
 COMMUTER RAIL VEHICLES AND TRANSIT MAINTENANCE VEHICLES WILL BE ALLOWED TO ACCESS AND TRAVEL WITHIN THE RIGHT OF WAY AND UNDER THE STRUCTURES TO THE DESIGNATED ACCESS AREAS. NO ACCESS WILL BE PERMITTED DIRECTLY TO SR705.

COMMUTER RAIL VEHICLES AND TRANSIT MAINTENANCE VEHICLES ACCESS FOR THE RAIL LINE WILL BE ALLOWED TO ENTER/LEAVE THE RIGHT OF WAY AT AND TRAVEL WITHIN THE RIGHT OF WAY BETWEEN STA. SIS-N 19+55.58 (170.04' RT) AND STA. SB 129+40.18 (88.75' LT).

- BRIDGE CLEARANCE DATA:**
- EX. BRIDGE SUPPORT COLUMN, NEAREST CORNER IS 38.3' OFFSET FROM THE COMMUTER RAIL CENTERLINE.
 - EX. BRIDGE SUPPORT COLUMN, NEAREST CORNER IS 75.5' OFFSET FROM THE COMMUTER RAIL CENTERLINE.
 - EX. BRIDGE SUPPORT COLUMN, NEAREST CORNER IS 48.3' OFFSET FROM THE COMMUTER RAIL CENTERLINE.
 - EX. BRIDGE SUPPORT COLUMN, NEAREST CORNER IS 81.5' OFFSET FROM THE COMMUTER RAIL CENTERLINE.
 - THE BOTTOM WEST EDGE OF EXISTING BRIDGE IS AT ELEV 95.4 AND SLOPES DOWN TO BOTTOM OF BRIDGE AT ELEV 71.8, PROVIDING 23.5 FEET OF CLEARANCE FROM TOP OF RAIL TO BOTTOM OF BRIDGE.
 - THE BOTTOM EAST EDGE OF EXISTING BRIDGE IS AT ELEV 96.1 AND SLOPES DOWN TO BOTTOM OF BRIDGE AT ELEV 70.9, PROVIDING 25.2 FEET OF CLEARANCE FROM TOP OF RAIL TO BOTTOM OF BRIDGE.
 - THE BOTTOM WEST EDGE OF EXISTING BRIDGE IS AT ELEV 92.2 AND SLOPES DOWN TO BOTTOM OF BRIDGE AT ELEV 89.9, PROVIDING 22.3 FEET OF CLEARANCE FROM TOP OF RAIL TO BOTTOM OF BRIDGE.
 - THE BOTTOM EAST EDGE OF EXISTING BRIDGE IS AT ELEV 93.1 AND SLOPES DOWN TO BOTTOM OF BRIDGE AT ELEV 89.0, PROVIDING 24.1 FEET OF CLEARANCE FROM TOP OF RAIL TO BOTTOM OF BRIDGE.

SOUND TRANSIT R/W NO.	OWNERS	AIR SPACE LEASE SQ. FT.	TEMPORARY CONST. ESMT. SQ. FT.	PERMANENT ESMT. SQ. FT.
1	WSDOT-SR 705	38,478	58,827 (LT.) 10,174 (RT.)	38,478
2				
3				

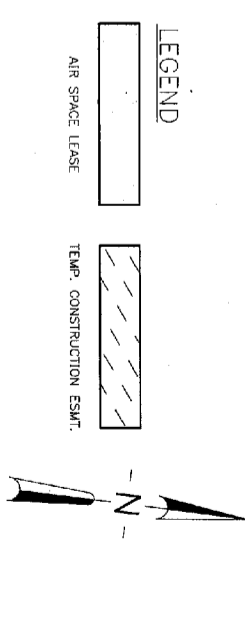

WSDOT No. AA-1
 IC 1-xxxx-
 Exhibit _____ Page _____ of _____

SCALE IN FEET

DATE	04/08/09	REVISION	REVISED ORIGINAL EXHIBIT PREPARED BY LIN & ASSOCIATES	BY	AA
DATE		REVISION		BY	

DESIGNED BY: AA
 CHECKED BY: AA
 APPROVED BY: JB

SOUNDTRANSIT

RAIL

EXHIBIT MAP
 SR705 TACOMA SPUR PIERCE COUNTY
 RIGHT OF WAY AND LIMITED ACCESS PLAN
 STA. SIS-N 0+00 TO STA. NB 232+809.93
 SOUNDER COMMUTER RAIL TACOMA TO LAKEWOOD

CONTRACT NO. _____
 DRAWING NO. _____
 SHEET NO. _____
 EXHIBIT NO. EXH01

04/13/09