

# EXHIBIT "A"

City of Yakima  
Annexation  
Highland  
ORD: 2009-04

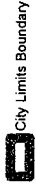

Annexation Area



City Limits Boundary

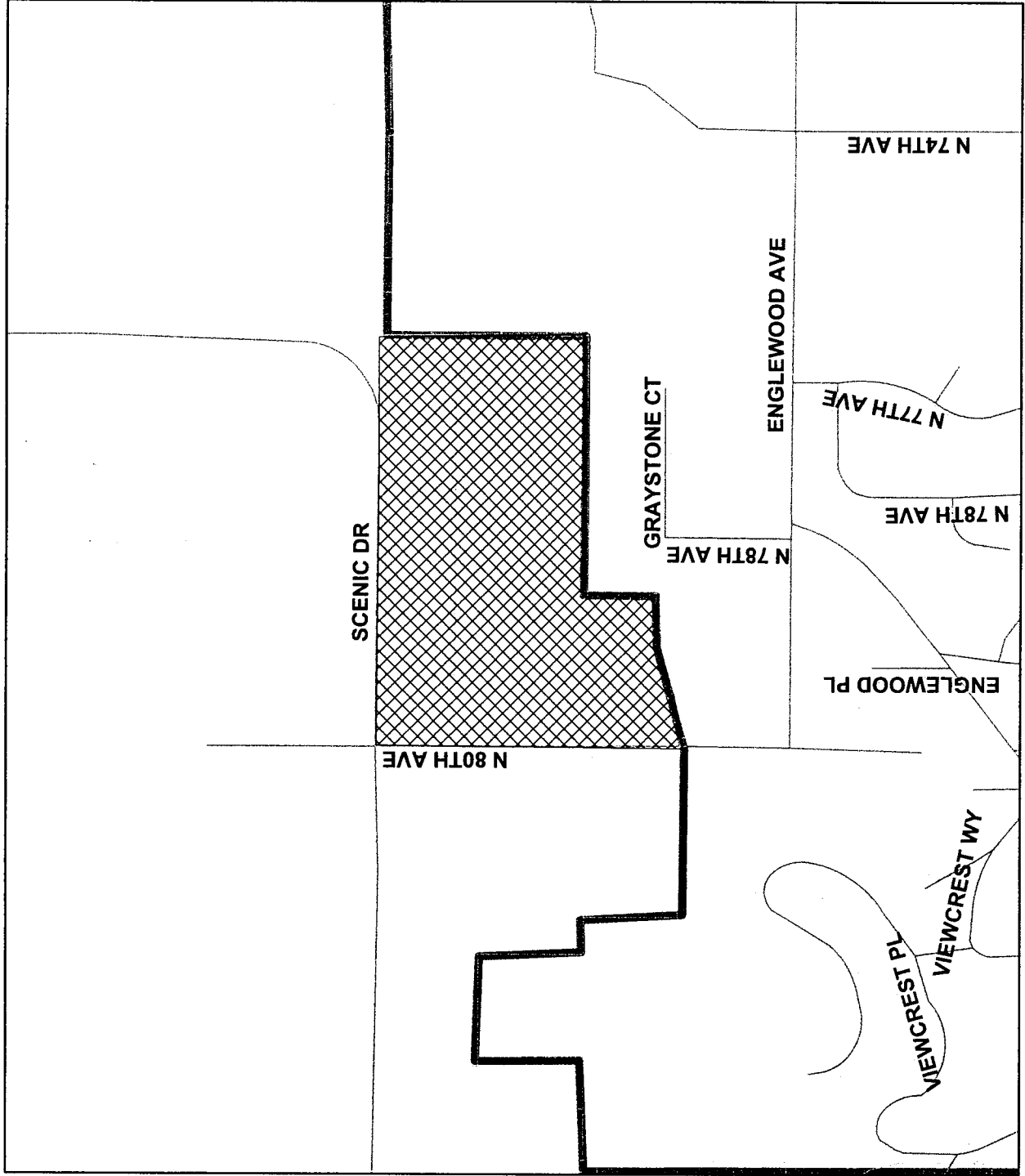

N

1 inch = 500 feet

# EXHIBIT "B"

**LEGAL DESCRIPTION FOR THE  
HIGHLAND ANNEXATION**

All those portions of Sections 17 and 18, Township 13 North, Range 18 East, W.M. described as follows: Beginning at a point along the city limits of the City of Yakima, said point being the point of intersection of the north right-of-way line of American Lane and the west right-of-way line of N 80<sup>th</sup> Avenue; thence continuing in a northerly direction along the west right-of-way line of N 80<sup>th</sup> Avenue and said line extended to the north right-of-way line of Scenic Drive; thence easterly along the north right-of-way line of Scenic Drive and said line extended to the point of intersection with the east right-of-way line of Scenic Drive going to the north; thence southerly along the aforesaid east right-of-way line to the point of intersection with the city limits of Yakima; thence in a generally southerly and westerly direction following along the city limits of Yakima to the point of beginning.

Yakima County Public Works Department  
checked for accuracy of legal description only:

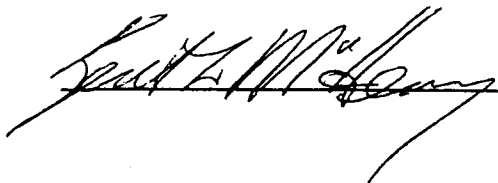

---