



**Washington State  
Department of Transportation**  
Paula J. Hammond, P.E.  
Secretary of Transportation

**Transportation Building**  
310 Maple Park Avenue S.E.  
P.O. Box 47300  
Olympia, WA 98504-7300  
360-705-7000  
TTY: 1-800-833-6388  
www.wsdot.wa.gov

2008 AUG -5 PM 4:22  
RECEIVED

August 1, 2008

Robert Boston  
Transportation Specialist/Washington State Coordinator Operation Lifesaver  
Washington Utilities and Transportation Commission  
PO Box 47250  
Olympia, WA 98504-7250

Subject: Request for horizontal clearance waiver

Dear Mr. Boston:

The Washington State Department of Transportation (WSDOT) is currently preparing to reconstruct the SR-16 Nalley Valley Interchange over Sound Transit's tracks in Tacoma, Washington. The new SR-16 structure will cross over both the Sound Transit mainline (formerly the BNSF Lakeview Subdivision) and two adjacent spur tracks in the vicinity of railroad milepost 3.35. Design of this structure includes a bridge column that will be located immediately south of the spur tracks (highlighted in orange on Exhibit A, attached).

The permanent horizontal clearance between the face of the column and the track centerline is 8.7 feet, thereby complying with the clearance requirements of WAC 480-60-050. The column, however, will be constructed using formwork that will extend closer towards the tracks than allowed under the rule. WSDOT has consulted with both Sound Transit and Tacoma Rail regarding this matter, and was advised that a close clearance will be acceptable, provided that no portion of the temporary structure is placed closer than 4 feet from the outside top of rail (see Exhibit B, Sound Transit and Tacoma Rail correspondence). WSDOT subsequently revised the plan so that the distance between the edge of formwork and track centerline is 6.7 feet. This distance meets the condition required by the railroads for their concurrence with this request.

Based on the information provided above and in the exhibits, I request that WUTC grant a clearance waiver for this temporary construction clearance pursuant to WAC 480-60. I am available to meet with you at any time to discuss this request. Please contact me at (360) 705-7271 if I can be of any assistance.

Sincerely,

Ahmer Nizam  
WSDOT Railroad Liaison

cc: Carla Maloney, WSDOT  
Eric Beckman, Sound Transit  
Kyle Kellem, Tacoma Rail

CONSTRUCTION EASEMENT		
POINT	STATION	OFFSET
1	BC 4+52.16	275.85 RT=
	BNSF 173+13.39	40' LT
2	BC 5+47.85	273.17 RT=
	BNSF 173+65.10	40' RT
3	BC 4+38.76	296.88 RT=
	BNSF 172+88.09	40' LT
4	BC 5+35.32	283.79 RT=
	BNSF 173+42.26	40' RT
5	BC 6+38.82	87.36' LT=
	BNSF 177+36.07	50' LT
6	BC 6+48.97	118.35' LT=
	BNSF 177+61.35	50' LT
7	BC 7+65.51	137.79' LT=
	BNSF 178+24.29	50' RT
8	BC 7+56.23	115.19' LT=
	BNSF 178+00.27	50' RT

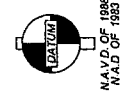
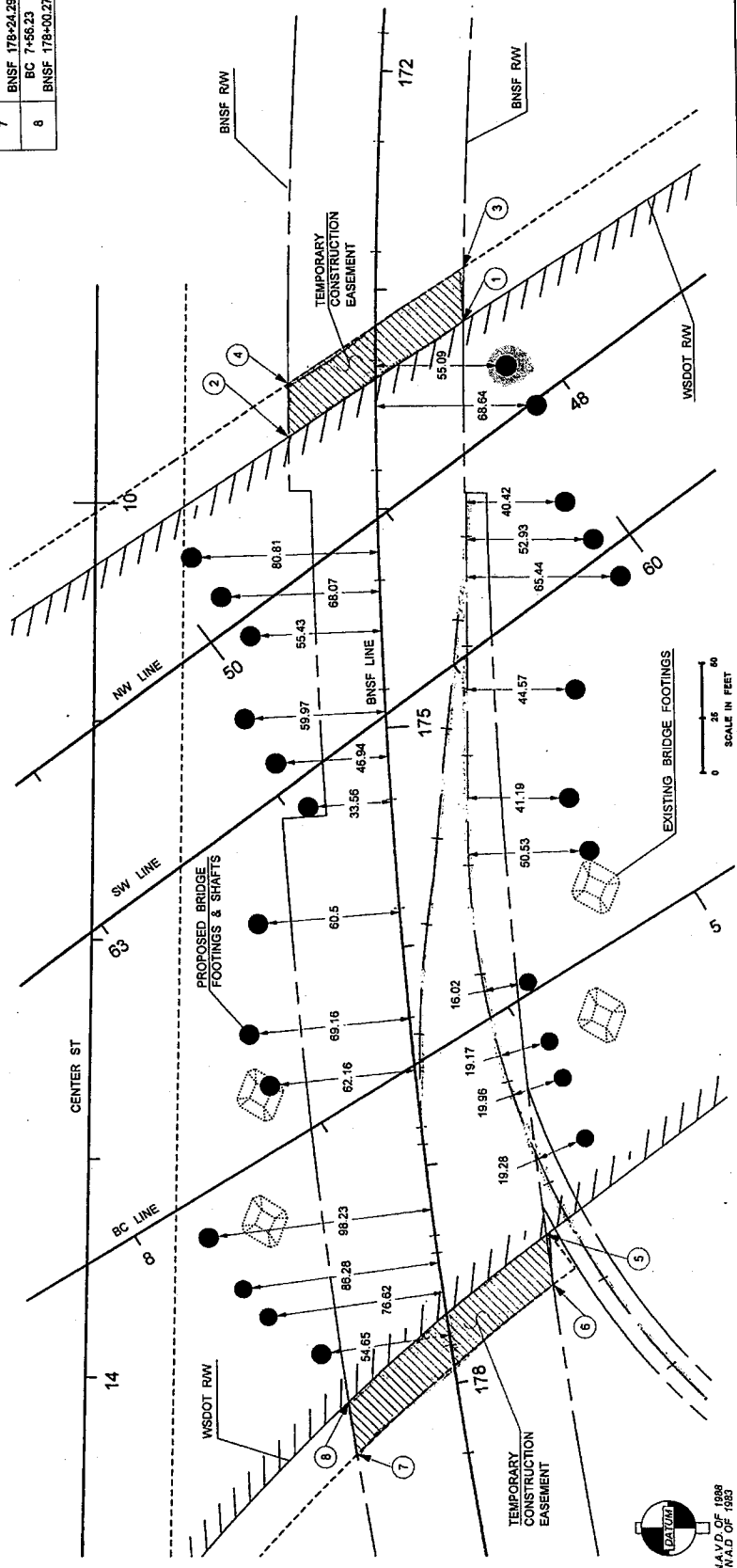
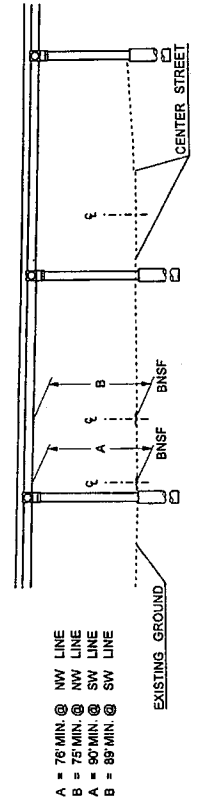

ST-1		SHEET OF SHEETS	
I-5 SR 16 I/C VALLEY VALLEY I/C RECONSTRUCTION SOUND TRANSIT EXHIBIT A			
Washington State Department of Transportation		DATE	
FED AID PROJ. NO.		DATE	
NO. 10	WASH	DATE	DATE
FOR	FOR	DATE	DATE
DESIGNED BY	C. MALONEY	DATE	DATE
ENTERED BY	T. KERR	DATE	DATE
CHECKED BY		DATE	DATE
PROJ. ENGINEER		DATE	DATE
REGIONAL ADM.		DATE	DATE
FILE NAME	C:\AA\Work\WVA\WV\Program\Office\warrdms\1868\SoundTransit.dgn		
TIME	3:41:47 PM		
DATE	11/02/07		
PLOTTED BY	Kerr		
DESIGNED BY	C. MALONEY		
ENTERED BY	T. KERR		
CHECKED BY			
PROJ. ENGINEER			
REGIONAL ADM.			

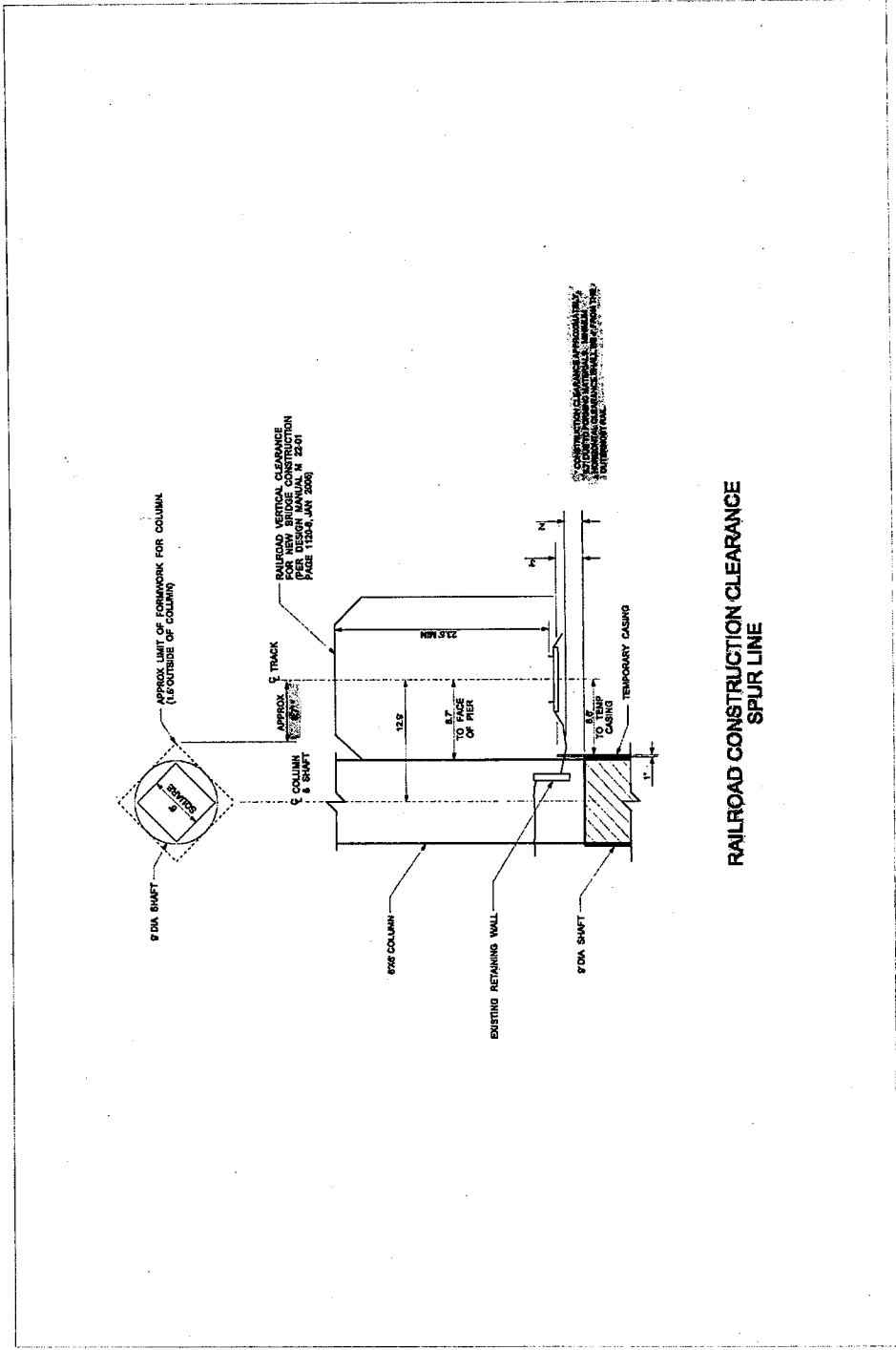

RAILROAD CONSTRUCTION CLEARANCE  
SPUR LINE

**Nizam, Ahmer**

---

**Subject:** FW: SR-16 Pier Clearance

**EXHIBIT B**  
**E-mail correspondence between WSDOT, Sound Transit, and Tacoma Rail**

---

**From:** Nizam, Ahmer  
**Sent:** Friday, August 01, 2008 10:45 AM  
**To:** 'Kellem, Kyle'  
**Cc:** Matheson, Alan; 'Beckman, Eric'  
**Subject:** RE: SR-16 Pier Clearance

Kyle,

Thanks for your review. The project office has determined that complying with your restriction can be achieved by trimming or otherwise adjusting the corner of the forms. I will proceed to petition WUTC for this waiver under the condition that you stated.

Thanks again.

Ahmer

---

**From:** Kellem, Kyle [mailto:kkellem@ci.tacoma.wa.us]  
**Sent:** Wednesday, July 30, 2008 1:47 PM  
**To:** Nizam, Ahmer  
**Cc:** Matheson, Alan  
**Subject:** RE: SR-16 Pier Clearance

Ahmer,

Tacoma Rail requires that the column and shaft forms are no closer than 4' from the field side of the nearest rail.

Standard Gauge between the rails is 4' 8 ½" and the ball of the rail is approximately 3". According to your plan the forms are approximately 3' 10" from the nearest rail.

*Kyle Kellem*  
*Track Maintenance Supervisor*  
*Tacoma Rail*  
*253-377-3554*

---

**From:** Nizam, Ahmer [mailto:nizama@WSDOT.WA.GOV]  
**Sent:** Tuesday, July 29, 2008 2:25 PM  
**To:** Beckman, Eric  
**Cc:** Kellem, Kyle  
**Subject:** RE: SR-16 Pier Clearance

Eric.

Thank you for your review. I will wait for Kyle's response.

Ahmer

---

**From:** Beckman, Eric [mailto:eric.beckman@soundtransit.org]  
**Sent:** Tuesday, July 29, 2008 2:15 PM  
**To:** Nizam, Ahmer; Kellem, Kyle  
**Cc:** Matheson, Alan; Maloney, Carla A.  
**Subject:** RE: SR-16 Pier Clearance

Ahmer-

Sound Transit has no issue with the clearance as depicted in the exhibit. I would ask that Kyle (or whomever he designates) confirm there is no issue with deliveries to potential TR customers with this clearance.

Thanks  
Eric

---

**From:** Nizam, Ahmer [mailto:nizama@wsdot.wa.gov]  
**Sent:** Friday, July 25, 2008 3:51 PM  
**To:** Beckman, Eric  
**Cc:** Matheson, Alan; Kellem, Kyle; Maloney, Carla A.  
**Subject:** SR-16 Pier Clearance

Eric,

Per our discussion, WSDOT requests that Sound Transit approve the temporary horizontal construction clearance as shown in the attached diagram. As you can see, the only element of this design that does not comply with WAC 480-60 is the temporary form work. If this temporary situation is acceptable, I will proceed to petition WUTC for a clearance waiver.

Please let me know if you have any questions or need additional information.

Thank you.

Ahmer Nizam  
HQ Railroad Liaison  
Washington State Department of Transportation  
PO Box 47329  
Olympia, WA 98504-7329  
(360) 705-7271