



222 FAIRVIEW AVENUE N., SEATTLE, WASHINGTON 98109-5312 206-624-3900
FACSIMILE 206-654-4039

July 9, 2008

Ann Soiza
Senior Pipeline Safety Engineer
Utilities and Transportation Commission
1300 S. Evergreen Park Drive SW
Olympia, WA 98504-7250

2008 JUL 10 AM 10:25

Subject: Request for written authorization under WAC 480-93-020

Dear: Dear Mrs. Soiza:

This letter is a request for written authorization under WAC 480-93-020 for a proposed service at 40 E Dream Ln in Belfair WA located in our Bremerton District. Our customer has requested service to his garage.

A plan drawing of the proposed service is attached. This service will tap Cascade's 8 inch Kitsap High Pressure (HP) Line. This line has a maximum allowable operating pressure of 499 psig. The 8 inch line was constructed in 1963. A High Pressure Service Set (HPSS) will be installed at the customer's property line.

The garage is currently 55 feet from the center line of our 8 inch high pressure line. A 3/4 inch steel service line will be extended 35 toward the building. A regulating device with an automatic shut off fracture disc (HPSS) will be installed at the above noted location, approximately 22 feet from the building, to reduce the pressure to 60 psig and protect from being over pressured. The inlet side of the service will also have a 499 psig MAOP up to the HPSS. The outlet side of the service line from the HPSS will be a PE 5/8 inch line with an MAOP of 60 psig. We will install a second regulator and a meter at the customer's building to provide residential pressures.

Please have Staff contact me at your earliest convenience so I may provide whatever additional information is needed. Our customer has requested service as soon as possible.

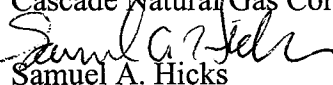
Sincerely,
Cascade Natural Gas Corporation

Samuel A. Hicks
Pipeline Safety Specialist
(206) 381-6725

Gordon M. Squire
P.O. Box 1115
Belfair, Wa. 98528

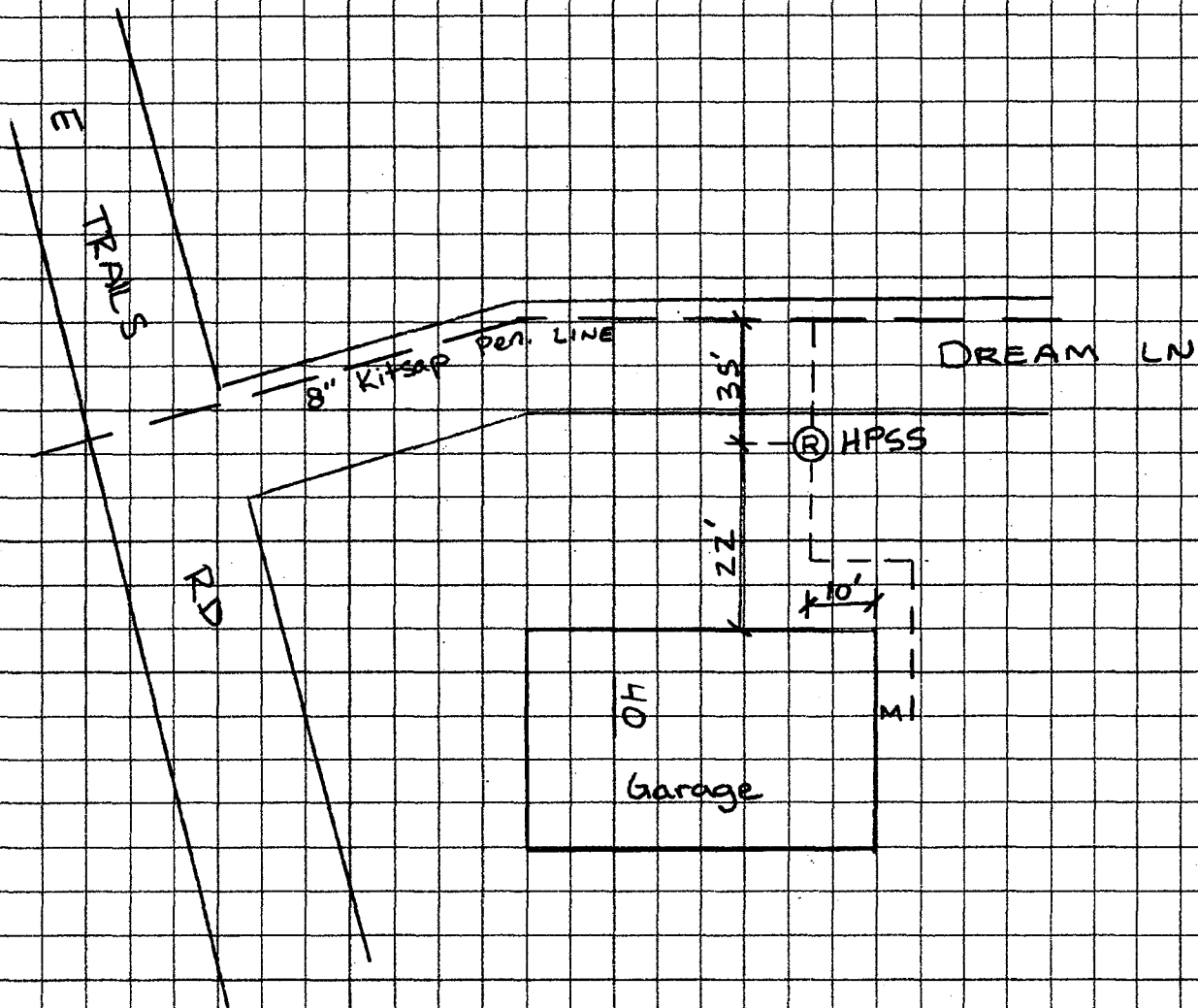
Parcel # 222237700310
Trench : Conduit provided by Requestor



Scale	NONE	Drawn	Clint Mathews
Date	6-2-08	Check	-
Eng.	-	Meas.	-
Grid No.	1-P	Dwg. No.	-



E.R. NO.

CASCADE NATURAL GAS CORPORATION
222 Fairview Ave. No. Seattle, Wash. 98109

VARIANCE REQUEST

40 E Dream LN

Belfair, Wa.