

WASHINGTON UTILITIES AND TRANSPORTATION COMMISSION

1300 South Evergreen Park Drive SW, PO Box 47250
Olympia Washington 98504-7250
Phone (360) 664-1222
Fax (360) 586-1181

RECEIVED

AUG 28 2003

WASH. UT. & TP. COMM. APPLICATION FOR BUS CERTIFICATE

Fee: \$150.00

CID metcal - 34374 Reception NO. 0000602 Application No. D79217

Date Received 8/23/03 Amount \$ 150.00 Additional Permit C-1052

Fitness _____ Rates _____ Schedule _____ Insurance OK CH-408

Application is made to the Washington Utilities and Transportation Commission for a Certificate of Public Convenience and Necessity, as provided in Chapter 81.68 RCW.

APPLICATION

Fee - \$150

(Check One Only) ORIGINAL EXTENSION

NOTE: APPLICATION MUST BE COMPLETED IN FULL. INDIVIDUAL PARTNERSHIP
 CORPORATION

1. NAME OF APPLICANT Seattle Express Inc.
(Must correspond with name on insurance policy)

2. D/B/A: SEATTLE EXPRESS

3. MAILING ADDRESS PO Box 66752 PHYSICAL ADDRESS 15201 28th Avenue SW
Seattle WA 98166 Seattle WA 98166

BUSINESS TELEPHONE NUMBER (206) 793-0770 FAX NUMBER (206) 246-2178

UBI # 601-619-460 E-MAIL PO@SEATTLEEXPRESS.COM

4. IF APPLICANT IS A CORPORATION, LIST NAME, TITLES, AND PERCENTAGE OF STOCK OF PRINCIPAL SHAREHOLDERS. IF APPLICANT IS A PARTNERSHIP, LIST NAMES, ADDRESSES, AND PERCENTAGE OF INTEREST OF ALL PERSONS HAVING AN EQUITY IN THE BUSINESSES:

PO Goloshkevich - 100% President

5. Will an attorney be representing you at the hearing? Yes No

If yes, list specific attorney's name: _____

Phone No. _____ Address: _____

6. If the Commission assigns this application for formal hearing, applicant will present approximately 7 witnesses at the hearing. Estimate how much time your presentation will take. 15 MINUTES
7. Describe your proposed route using state or county highway numbers, AND attach a detailed map or sketch showing the proposed route or area.

(NOTE: This statement may be a separate attachment labeled "7").

8. Is this an application for extension of your present route? Yes NO
If yes, attach a copy of your current certificate.
9. Attach two copies of your proposed tariff, which shows both the rates or fees to be charged for service and rules and regulations which govern how they will be assessed.
10. Attach two copies of your proposed time schedule and route, naming all service points.
11. State fully the conditions that justify the Commission granting you a certificate.

(NOTE: This statement may be a separate attachment labeled "11")

12. List the terminal facilities you propose to use at each of the named points on your proposed route.
WE DO NOT HAVE PERMANENT FACILITIES AT ANY OF OUR STOPS

(NOTE: This statement may be a separate attachment labeled "12")

13. You must submit, prior to issuance of a certificate to operate as an Auto Transportation Company, a Form "E" Certificate of Insurance issued by an insurance company authorized to write insurance in the state of Washington.
14. List the names and addresses of all other transportation providers currently furnishing similar service by means of motor coach, railroad or boat lines, between any of the points or along any portion of the route you propose to serve.

SEATTLE EXPRESS IS THE ONLY SCHEDULED SERVICE
TALI'S & LIMOS PROVIDE SIMILAR SERVICE ON A DEMAND BASIS

(NOTE: This statement may be a separate attachment labeled "14")

Attachment #7

Sea-Tac Hotels, Tukwila Hotels, & SouthCenter Mall
International Boulevard going South from 170th street to 210th street-then turn and go back south on International Boulevard to South 170th street, where we turn on to freeway entrance to interstate #518 which we follow to West Valley Hwy South. West Valley Hwy North from 160th to 156th turn around and go south on West Valley Hwy to South Center Parkway turn West to Strander Blvd turn right to entrance to Hwy 518 which turns into #509. Follow #509 to Hwy 99, then follow the viaduct to Seneca Street Exit. Pike Place market arrival & departure at 1st & University in front of the Seattle Art Museum-at the charter stop

Alternate routh from Strander Blvd: Enter I-5 proceed North to Senaca St exit to market arrival & departure at 1st & University in front of the Seattle Art Museum-at the charter stop

ISSUE DATE _____ EFFECTIVE DATE _____

ISSUED BY Ron Goldsberry, President

FOR OFFICIAL USE ONLY

EFFECTIVE _____ TC _____ LSN _____

1AA _____ BY _____

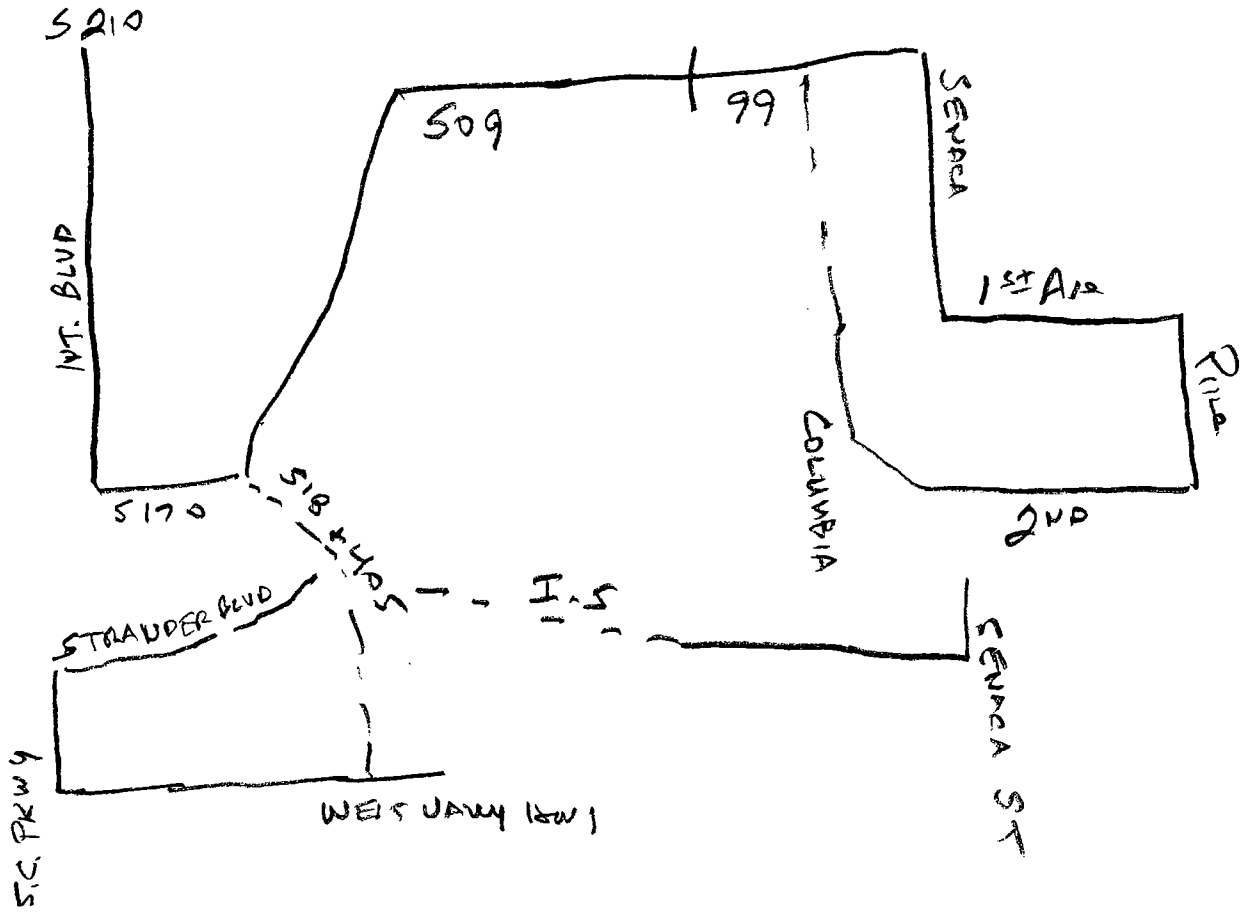

WASHINGTON UTILITIES AND TRANSPORTATION COMMISSION

For the Operation of Motor Propelled Vehicles

pursuant to the provisions of Chapter 81 RCW

THIS IS TO CERTIFY that authority is granted to operate as a MOTOR CARRIER in the transportation of the commodities and in the territory described herein to

SEATTLE EXPRESS, INC.
P.O. BOX 66752
SEATTLE, WA 98166

CERT NO.
C-01052

PASSENGER SERVICE

BETWEEN: Hotels in the Cities of Tukwila and Renton and the Pike Place Market in downtown Seattle.

BETWEEN: Hotels in the City of Sea-Tac and the Pike Place Market in downtown Seattle

T. C. NO. 011691

05-07-02

WASHINGTON UTILITIES AND TRANSPORTATION
COMMISSION

By _____

Paul Cune



PROPOSED TARRIFF

SEATTLE EXPRESS INC

C001052

ALL FARES IN DOLLARS AND CENTS PER PERSON

FARES FROM SEA- TAC HOTELS, TUKWILA HOTELS. or SOUTH CENTER MALL TO PIKE PLACE MARKET or
PIKE PLACE MARKET TO SOUTHCENTER , SEA TAC HOTELS, OR TUKWILA HOTELS:

ROUNDRIP FARES \$12

ONE WAY FARES \$7

No charge for riders going from Sea-Tac or Tukwila hotels to South Center Mall. South Side visitors bureau will pay us directly for this service.

ISSUE DATE _____ EFFECTIVE DATE _____

ISSUED BY Ron Goldsberry, President

FOR OFFICIAL USE ONLY

EFFECTIVE _____ TC _____ LSN _____

1AA _____ BY _____

ATTACHMENT # 11

Seattle Express is the only scheduled service in this area. We now service all of the hotels near South Center Mall, and have had a stop at the Red Lion Hotel on South Center property. The Red Lion has closed, and the mall is demolishing the building. We have had a request from Seattle Southside Visitor bureau to add a stop at the mall.

Prior to this riders could use the Red Lion stop for Mall access.

This is an extension of our current schedule.

PROPOSED TARRIFF

SEATTLE EXPRESS INC

C001052

ALL FARES IN DOLLARS AND CENTS PER PERSON

FARES FROM SEA- TAC HOTELS, TUKWILA HOTELS. or SOUTH CENTER MALL TO PIKE PLACE MARKET or
PIKE PLACE MARKET TO SOUTHCENTER , SEA TAC HOTELS, OR TUKWILA HOTELS:

ROUNDRIP FARES \$12

ONE WAY FARES \$7

No charge for riders going from Sea-Tac or Tukwila hotels to South Center Mall. South Side visitor's bureau will pay us directly for this service.

ISSUE DATE _____ EFFECTIVE DATE _____

ISSUED BY Ron Goldsberry, President

FOR OFFICIAL USE ONLY

EFFECTIVE _____ TC _____ LSN _____

1AA _____ BY _____

	A	B	C	D	E	F	G	H	I	J
1	SEA-TAC HOTELS SERVICED 10/16 THROUGH 4/30 RESERVATION REQUIRED CALL 206-241-5800									
2										
3	Best Western Executel	9:32am	11:32am	1:32pm	3:22pm					
4	Clarton Airport	9:38am	11:38am	1:38pm	3:28pm					
5	Comfort Inn	9:32am	11:32am	1:32pm	3:22pm					
6	Days Inn Airport	9:32am	11:32am	1:32pm	3:22pm					
7	Double Tree @ airport	9:35am	11:35am	1:35pm	3:35pm					
8	Fairfield By Marriott	9:32am	11:32am	1:32pm	3:22pm					
9	Hampton Inn Airport	9:32am	11:32am	1:32pm	3:22pm					
10	Hilton Airport	9:38am	11:38am	1:38pm	3:28pm					
11	Holiday Inn Express	9:32am	11:32am	1:32pm	3:22pm					
12	Holiday Inn Airport	9:40am	11:40am	1:40pm	3:30pm					
13	LaQuinta Airport	9:30am	11:30am	1:30pm	3:30pm					
14	Marriott Airport	9:38am	11:38am	1:38pm	3:28pm					
15	Radisson Airport	9:30am	11:30am	1:30pm	3:30pm					
16	Ramada Inn	9:40am	11:40am	1:40pm	3:40pm					
17	Red Roof Inn	9:40am	11:40am	1:40pm	3:40pm					
18	Sleep Inn	9:32am	11:32am	1:32pm	3:22pm					
19	Super 8 Airport	9:35am	11:35am	1:35pm	3:35pm					
20	Sutton Suites	9:40am	11:40am	1:40pm	3:40pm					
21	Travelodge South	9:32am	11:32am	1:32pm	3:22pm					
22	Coast Gateway	9:30am	11:30am	1:30pm	3:30pm					
23	Red Lion Airport	9:35am	11:35am	1:35pm	3:35pm					
24	Wyndam Gardens	9:35am	11:35am	1:35pm	3:35pm					
25	SouthCenter Mall Drop from hotels & returns to Seattle	9:50am	11:50am	1:50pm	3:50pm	6:40pm				
26	South Center Mall Return to Sea-Tac or Tukwila Hotel	10:40am	12:40pm	2:40pm	4:40pm	6:40pm				
27	Public Market Arrival & Hotel or South Center Return	10:20AM	12:20pm	2:20pm	**4:20pm	6:20pm	7:30pm			
28										
29	Please arrive at the departure point 5 minutes before the scheduled departure, as we can not return for late arriving guests									
30	The 4:20PM** market stop MTWTF-F-NE corner of University & Alaskan Way. Go down the Harbor steps directly across from									
31	the hammering man-then one block toward the water. Wait by the Seattle Waterfront sign arching over the sidewalk just before the viaduct									
32	ALL OTHER PUBLIC MARKET STOPS ARE AT 1ST & UNIVERSITY IN FRONT OF THE HAMMERING MAN STATUE									
33										
34	DAILY SERVICE EXCEPT NOVEMBER 24 THROUGH FEBRUARY 28 WHEN WE OPERATE ONLY ON FRIDAY, SATURDAY, & SUNDAY									
35	FRIDAY AN ADDITIONAL RETURN TO HOTELS & DOWNTOWN FROM SOUTHCENTER AT 8PM & 9PM									
36	SATURDAY ADDITIONAL RETURN TO HOTELS & DOWNTOWN FROM SOUTHCENTER AT 8PM & 9PM & 10PM									

	A	B	C	D	E	F	G	H	I	J
1	SEA-TAC HOTELS SERVICED 10/16 THROUGH 4/30 RESERVATION REQUIRED CALL 206-241-5800									
2										
3	Best Western Executive	9:32am	11:32am	1:32pm	3:22pm					
4	Clarton Airport	9:38am	11:38am	1:38pm	3:28pm					
5	Comfort Inn	9:32am	11:32am	1:32pm	3:22pm					
6	Days Inn Airport	9:32am	11:32am	1:32pm	3:22pm					
7	Double Tree @ airport	9:35am	11:35am	1:35pm	3:35pm					
8	Fairfield By Marriott	9:32am	11:32am	1:32pm	3:22pm					
9	Hampton Inn Airport	9:32am	11:32am	1:32pm	3:22pm					
10	Hilton Airport	9:38am	11:38am	1:38pm	3:28pm					
11	Holiday Inn Express	9:32am	11:32am	1:32pm	3:22pm					
12	Holiday Inn Airport	9:40am	11:40am	1:40pm	3:30pm					
13	LaQuinta Airport	9:30am	11:30am	1:30pm	3:30pm					
14	Marriott Airport	9:38am	11:38am	1:38pm	3:28pm					
15	Radisson Airport	9:30am	11:30am	1:30pm	3:30pm					
16	Ramada Inn	9:40am	11:40am	1:40pm	3:40pm					
17	Red Roof Inn	9:40am	11:40am	1:40pm	3:40pm					
18	Sleep Inn	9:32am	11:32am	1:32pm	3:22pm					
19	Super 8 Airport	9:35am	11:35am	1:35pm	3:35pm					
20	Sutton Suites	9:40am	11:40am	1:40pm	3:40pm					
21	Travelodge South	9:32am	11:32am	1:32pm	3:22pm					
22	Coast Gateway	9:30am	11:30am	1:30pm	3:30pm					
23	Red Lion Airport	9:35am	11:35am	1:35pm	3:35pm					
24	Wyndam Gardens	9:35am	11:35am	1:35pm	3:35pm					
25	SouthCenter Mall Drop from hotels & returns to Seattle	9:50am	11:50am	1:50pm	3:50pm	6:40pm				
26	South Center Mall Return to Sea-Tac or Tukwila Hotel	10:40am	12:40pm	2:40pm	4:40pm	6:40pm				
27	Public Market Arrival & Hotel or South Center Return	10:20AM	12:20pm	2:20pm	**4:20pm	6:20pm	7:30pm			
28										
29	Please arrive at the departure point 5 minutes before the scheduled departure, as we can not return for late arriving guests									
30	The 4:20PM** market stop MTWT&F-N-E corner of University & Alaskan Way. Go down the Harbor steps directly across from									
31	the hammering man-then one block toward the water. Wait by the Seattle Waterfront sign arching over the sidewalk just before the viaduct									
32	ALL OTHER PUBLIC MARKET STOPS ARE AT 1ST & UNIVERSITY IN FRONT OF THE HAMMERING MAN STATUE									
33										
34	DAILY SERVICE EXCEPT NOVEMBER 24 THROUGH FEBRUARY 28 WHEN WE OPERATE ONLY ON FRIDAY, SATURDAY, & SUNDAY									
35	FRIDAY AN ADDITIONAL RETURN TO HOTELS & DOWNTOWN FROM SOUTHCENTER AT 8PM & 9PM									
36	SATURDAY ADDITIONAL RETURN TO HOTELS & DOWNTOWN FROM SOUTHCENTER AT 8PM & 9PM & 10PM									

	A	B	C	D	E	F	G	H
1			TUKWILA HOTELS					
2		OCTOBER 15 THROUGH APRIL 30 RESERVATION REQUIRED- CALL 206-241-5800						
3								
4								
5								
6	Courtyard Marriott Sea-Tac	9:45AM	11:45AM	1:45PM	3:45PM			
7	Embassy Suites	9:45AM	11:45AM	1:45PM	3:45PM			
8	Hampton Inn	9:47AM	11:47AM	1:47PM	3:47PM			
9	Homestead Village	9:47AM	11:47AM	1:47PM	3:47PM			
10	Residence Inn	9:47AM	11:47AM	1:47PM	3:47PM			
11	Courtyard Marriott South Center	9:49AM	11:49AM	1:49PM	3:49PM			
12	Double Tree Suites	9:49AM	11:49AM	1:49PM	3:49PM			
13								
14	SouthCenter Mall Drop from hotels & returns to Seattle	9:50am	11:50am	1:50pm	3:50pm	6:40pm		
15	South Center Mall Return to Sea-Tac or Tukwila Hotel	10:40am	12:40pm	2:40pm	4:40pm	6:40pm		
16	Public Market Arrival & Hotel or South Center Return	10:20AM	12:20pm	2:20pm	**4:20pm	6:20pm	7:30pm	
17								
18		Please arrive at the departure point 5 minutes before the scheduled departure, as we can not return for late arriving guests						
19		The 4:20PM** market stop MTWT&F-NE corner of University & Alaskan Way. Go down the Harbor steps directly across from						
20		the hammering man-then one block toward the water. Wait by the Seattle Waterfront sign arching over the sidewalk just before the viaduct						
21		ALL OTHER PUBLIC MARKET STOPS ARE AT 1ST & UNIVERSITY IN FRONT OF THE HAMMERING MAN STATUE						
22								
23		DAILY SERVICE EXCEPT NOVEMBER 24 THROUGH FEBRUARY 28 WHEN WE OPERATE ONLY ON FRIDAY, SATURDAY, & SUNDAY						
24		FRIDAY AN ADDITIONAL RETURN TO HOTELS & DOWNTOWN FROM SOUTHCENTER AT 8PM & 9PM						
25		SATURDAY ADDITIONAL RETURN TO HOTELS & DOWNTOWN FROM SOUTHCENTER AT 8PM & 9PM & 10PM						

	A	B	C	D	E	F	G	H
1			TUKWILA HOTELS					
2		OCTOBER 15 THROUGH APRIL 30 RESERVATION REQUIRED- CALL 206-241-5800						
3								
4								
5								
6	Courtyard Marriott Sea-Tac	9:45AM	11:45AM	1:45PM	3:45PM			
7	Embassy Suites	9:45AM	11:45AM	1:45PM	3:45PM			
8	Hampton Inn	9:47AM	11:47AM	1:47PM	3:47PM			
9	Homestead Village	9:47AM	11:47AM	1:47PM	3:47PM			
10	Residence Inn	9:47AM	11:47AM	1:47PM	3:47PM			
11	Courtyard Marriott South Center	9:49AM	11:49AM	1:49PM	3:49PM			
12	Double Tree Suites	9:49AM	11:49AM	1:49PM	3:49PM			
13								
14	SouthCenter Mall Drop from hotels & returns to Seattle	9:50am	11:50am	1:50pm	3:50pm	6:40pm		
15	South Center Mall Return to Sea-Tac or Tukwila Hotel	10:40am	12:40pm	2:40pm	4:40pm	6:40pm		
16	Public Market Arrival & Hotel or South Center Return	10:20AM	12:20pm	2:20pm	**4:20pm	6:20pm	7:30pm	
17								
18	Please arrive at the departure point 5 minutes before the scheduled departure, as we can not return for late arriving guests							
19	The 4:20PM** market stop MTWT&F-NIE corner of University & Alaskan Way. Go down the Harbor steps directly across from							
20	the hammering man-then one block toward the water. Wait by the Seattle Waterfront sign arching over the sidewalk just before the viaduct							
21	ALL OTHER PUBLIC MARKET STOPS ARE AT 1ST & UNIVERSITY IN FRONT OF THE HAMMERING MAN STATUE							
22								
23	DAILY SERVICE EXCEPT NOVEMBER 24 THROUGH FEBRUARY 28 WHEN WE OPERATE ONLY ON FRIDAY, SATURDAY, & SUNDAY							
24	FRIDAY AN ADDITIONAL RETURN TO HOTELS & DOWNTOWN FROM SOUTHCENTER AT 8PM & 9PM							
25	SATURDAY ADDITIONAL RETURN TO HOTELS & DOWNTOWN FROM SOUTHCENTER AT 8PM & 9PM & 10PM							

ATTACHMENT # 11

Seattle Express is the only scheduled service in this area. We now service all of the hotels near South Center Mall, and have had a stop at the Red Lion Hotel on South Center property. The Red Lion has closed, and the mall is demolishing the building. We have had a request from Seattle Southside Visitor bureau to add a stop at the mall.

Prior to this riders could use the Red Lion stop for Mall access.

This is an extension of our current schedule.

15. Complete the following financial data*: 81.103

ASSETS		LIABILITIES	
Cash in Bank and on hand	\$ 5600	Salaries/Wages Payable	\$ 3200
Notes Receivable	\$ 62000	Accounts Payable	\$
Accounts Receivable	\$ 47000	Notes Payable	\$ 54375
Investments	\$	Mortgages Payable	\$ 32000
Other Current Assets	\$	Contracts and Bonds Payable	\$
Prepaid Expenses	\$	Other	\$
Land and Buildings		TOTAL LIABILITIES	\$ 89529
Equipment (buses)	\$ 24500	NET WORTH	
Office Furniture	\$	Preferred Stock	\$
Other Equipment	\$ 2500	Common Stock	\$ 10,000
Other Assets	\$	Retained Earnings	\$ 42021
	\$	Capital	\$
TOTAL ASSETS	\$ 141,600	TOTAL LIABILITIES AND NET WORTH	\$ 141,600

*Enclose Balance Sheet and Profit and Loss Statement, if available, and label it "15"

16. Complete the following statement of equipment to be used in connection with proposed service or attach equipment list with the appropriate information.

LICENSE NUMBER	YEAR AND MAKE OF VEHICLE	SERIAL NUMBER (VEHICLE IDENTIFICATION NUMBER)	SEATING CAPACITY
662 HSF	2001 Dodge Van	2BSWB35251K545407	14
551 JOB	1992 Dodge Van	2BSWB3524W1C153493	14
914 K2A	1994 Ford Maxitruck	1FDRE3053RH A44058	24

(NOTE: This information may be an attachment labeled "16").

17. SAFETY COMPLIANCE REVIEW AND QUESTIONNAIRE:

GENERAL

Do you have a copy of the laws and rules relating to auto transportation companies?..... X
Have you been cited within the last three years by the Commission for violations of its rules or laws? X

If Yes, explain: _____

Are you familiar with the state passenger carrier safety rules?..... X
Will management review the carrier's compliance status on a periodic basis?..... X

NOTIFICATION AND REPORTING OF ACCIDENTS

Are you familiar with the Commission accident reporting rule? X
Will you take any action against drivers involved in preventable accidents?..... X

PART 391 - QUALIFICATION OF DRIVERS

Do you have written hiring policies/procedures that are being followed when hiring new drivers? X
Are oral interviews conducted with new drivers to verify information submitted on their applications? X
Will you have a system established to ensure drivers' medical certificates remain current?..... X
Will you verify that physicians completing medical certifications are knowledgeable about the instructions for performing and recording driver physical examinations?..... X
Will you review the results of the health history and physical examination?..... X
Will you have a system established that will ensure drivers' operating licenses remain current?... X
Will you have a system established that will ensure drivers' annual reviews and annual record of violations remain current?..... X
Will you comply with the road test provisions of Section 391.31?..... X
Can you maintain and produce complete driver qualification files on drivers?..... X

PART 392 - DRIVING OF MOTOR VEHICLES

Do you have established procedures concerning the use of alcohol and drugs?..... X
Do you have a policy for monitoring speed?..... X

PART 395 - HOURS OF SERVICE OF DRIVERS

Can you explain the hours of service limitations, i.e., 10, 15, 60 in 7, 70 in 8?..... X
Will you file records of duty status in systematic manner?..... X
Will drivers be required to complete recaps of their records of duty status?..... X

- Will dispatchers be aware of drivers= hours of service prior to trip?..... ___ ___
- Will other independent records be compared to drivers records of duty status for accuracy?... ___ ___
- Will you have a system for recording hours of duty status on 100 mile radius drivers?..... ___ ___
- Will you have a disciplinary policy for noncompliance with Part 395?..... ___ ___

PART 396 - INSPECTION, REPAIR AND MAINTENANCE

- | | YES | NO | N/A |
|--|-------------------------------------|-----|-----|
| Will you have written procedures explaining a systematic, periodic maintenance program?... | <input checked="" type="checkbox"/> | ___ | ___ |
| Will you periodically review maintenance records for all equipment?..... | <input checked="" type="checkbox"/> | ___ | ___ |
| Will you comply with the vehicle inspection procedure?..... | <input checked="" type="checkbox"/> | ___ | ___ |

PART 396 - INSPECTION, REPAIR AND MAINTENANCE

- | | YES | NO | N/A |
|--|-------------------------------------|-----|-----|
| Will you train drivers to perform pre-trip inspections?..... | <input checked="" type="checkbox"/> | ___ | ___ |
| Will you maintain the prior three months vehicle inspection reports on a vehicle?..... | <input checked="" type="checkbox"/> | ___ | ___ |
| Will you maintain a complete maintenance file on all vehicles?..... | <input checked="" type="checkbox"/> | ___ | ___ |

The applicant understands that the filing of this application does not in itself constitute authority to operate; that he/she is familiar with the law and the rules of the Washington Utilities and Transportation Commission governing Auto Transportation Companies and promises strict compliance therewith.

Dated at: Seattle, Washington, August 27, 2003
(City or Town) (Month/Day/Year)

Row Golosbenny Pres
(Name of applicant)

By: Row Golosbenny Pres
(Signature)

I certify (or declare) under penalty of perjury under the laws of the state of Washington that the foregoing is true and correct.

8/27/2003 Seattle WA.
(Date and Place)

Row P. Golosbenny
(Signature)