

TOPOGRAPHIC SURVEY

DOANE CREEK - NW DRAINAGE POND

SURVEYED: MAY 3, 2016

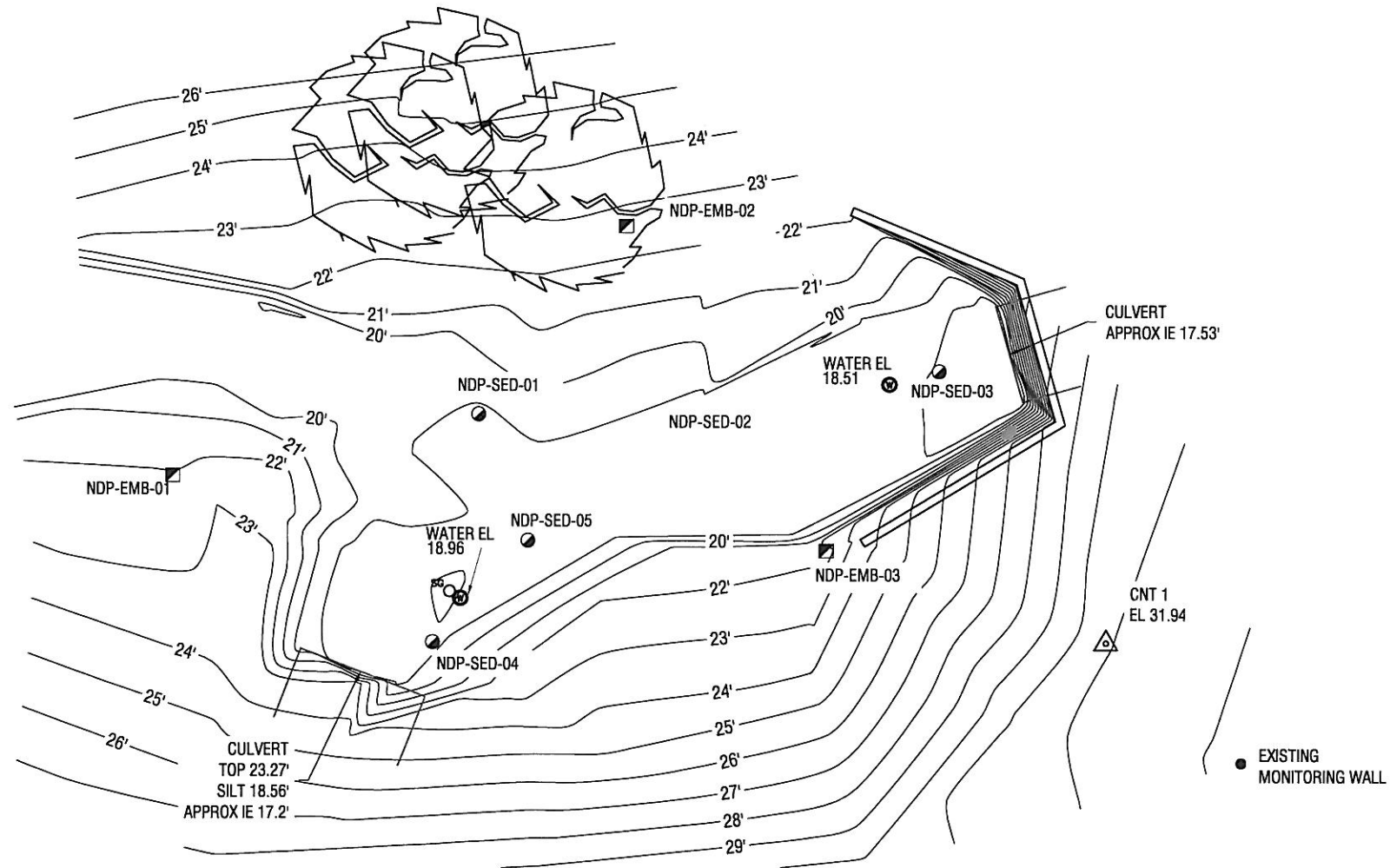
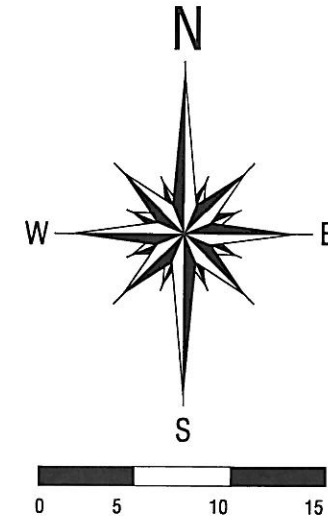

- LEGEND**
- SET SITE CONTROL
 - MONITORING WELL
 - SOIL SAMPLE
 - SEDIMENT SAMPLE
 - STREAM GAUGE
 - DECIDUOUS TREE
 - WATER ELEVATION

REGISTERED
PROFESSIONAL
LAND SURVEYOR

Deron M. Crawford

OREGON
JAN. 9, 2007
DERON M. CRAWFORD
#76980 LS

EXPIRES: 12-31-2017

**CRAWFORD,
DRUMMOND &
ASSOCIATES, INC.**

1055 AIRWAY ROAD, BLDG B
PO BOX 2385, LEBANON, OREGON 97355
PH: (541) 258-8833 FAX: (541) 258-8834

JOB: 16-02-018