



STATE OF WASHINGTON

WASHINGTON UTILITIES AND TRANSPORTATION COMMISSION

1300 S. Evergreen Park Dr. S.W., P.O. Box 47250 • Olympia, Washington 98504-7250
(206) 753-6423 • (SCAN) 234-6423 • TTY (206) 586-8203

October 13, 1995

Ref. No.: 6-0594

Mr. Larry E. Anderson, P.E.
Director of Engineering
Cascade Natural Gas Corporation
222 Fairview Avenue North
Seattle, Washington 98109

Dear Mr. Anderson:

Subject: Certificate of Public Convenience and Necessity
UG-950770 and UG-950832

Cascade Natural Gas Corporation submitted applications to amend its Certificate of Public Convenience and Necessity. The areas requested are immediately adjacent to its existing certificated area in Franklin and Kitsap County as noted in the legal description.

Please find enclosed the Certificates of Public Convenience and Necessity to Operate a Gas Plant for Hire in accordance with RCW 80.28.190 as approved in Orders No. UG-950770 and UG-950832 on October 11, 1995.

If you have any questions please feel free to contact Dennis E. Lloyd, (360) 586-0594 or Steve Rieger (360) 586-0592.

Thank you for your time and cooperation.

Sincerely,

Steve McLellan
Secretary

Enclosures

Copies to: L. Beaudry
R. Boyd
D. Camp
B. Matsuyama
D. Meredith
W. Odell
J. Stoltz
J. West

A-4-amended



WASHINGTON UTILITIES AND TRANSPORTATION COMMISSION

CERTIFICATE OF PUBLIC CONVENIENCE AND NECESSITY

TO OPERATE A GAS PLANT FOR HIRE

The Cascade Natural Gas Company of 222 Fairview Avenue North, Seattle, Washington 98109, is hereby authorized to operate a gas plant for hire in the general area or areas of:

Appendix A-1	U-80-22	Amended	February 8, 1980
Appendix A-2	U-900727	Amended	January 16, 1991
Appendix A-3	U-9873	Amended	November 20, 1968
Appendix A-4	U-950770	Amended	October 11, 1995
Appendix A-5	U-9708	Amended	September 12, 1966
Appendix A-8	U-85-04	Amended	January 23, 1985
Appendix A-9	U-9708	Amended	September 12, 1966
Appendix A-10	U-9822	Amended	July 22, 1968
Appendix A-11	U-84-55	Amended	July 18, 1984
Appendix A-12	U-9759	Amended	March 15, 1967
Appendix A-13	U-74-19	Amended	May 14, 1974
Appendix A-14	U-9360	Amended	September 19, 1962
Appendix A-15	U-9600	Amended	April 30, 1965
Appendix A-16	U-74-19	Amended	May 14, 1974
Appendix A-17	U-9600	Amended	April 30, 1965
Appendix A-18	U-9819	Amended	March 28, 1968
Appendix A-21	U-9790	Amended	July 17, 1968
Appendix A-22	U-85-76	Amended	November 13, 1985
Appendix A-23	U-900782	Amended	January 24, 1991
Appendix A-24	UG-940100	Amended	May 25, 1994
Appendix A-25	UG-940101	Amended	May 25, 1994

CONDITIONS:

1. Any gas plant operated by virtue of this certificate must be operated in accordance with the laws of the State of Washington and the Rules and Regulations of this Commission.
2. This certificate must be kept on file at the main office of the gas company except when directed to be transmitted to the Commission, and shall be subject at all times to inspection by the authorized representatives of the Commission.
3. This certificate shall be subject to revocation and cancellation by the Commission upon a showing of procurement by false affidavit or representation.
4. This certificate is subject to the terms, conditions and provisions of the Orders in Cause Nos. U-8841, U-8843, U-8937, U-9047, U-9052, U-9194, U-9238, U-9239, U-9253, U-9263, U-9264, U-9360, U-9388, U-9394, U-9407, U-9450, U-9467, U-9496, U-9600, U-9708, U-9759, U-9807, U-9808, U-9819, U-9790, U-9822, U-9860, U-9872, U-9873, U-10001, U-74-19, U-78-50, U-80-06, U-80-22,

A-4 Amended

U-80-100, U-81-43, U-83-40, U-83-41, U-84-55, U-85-04, U-85-76, UG-900727, UG-900782, UG-911010, UG-940100 UG-940101, and UG-950770.

This certificate is issued upon finding by the Washington Utilities and Transportation Commission that public convenience and necessity requires or will require such operation in accordance with RCW 80.28.190.

Order No. UG-950770 - Dated October 11, 1995
Dated at Olympia, Washington October 6, 1995
WASHINGTON UTILITIES AND TRANSPORTATION COMMISSION

BY SMcLellan

Steve McLellan
Secretary



BEFORE THE UTILITIES AND TRANSPORTATION COMMISSION

In the Matter of the Application)
of CASCADE NATURAL GAS CORPORATION)
to Amend its Certificate of Public)
Convenience and Necessity to)
Operate a Gas Plant for Hire in)
the General Area of Kitsap County)
.)
.)
.)

DOCKET NO. UG-950770

ORDER GRANTING
APPLICATION

On July 5, 1995, Cascade Natural Gas Corporation (Cascade), a Washington corporation, filed an application to amend its present Certificate of Public Convenience and Necessity to Operate a Gas Plant for Hire, to include the additional area in Kitsap County. (Appendix A-4)

Cascade is presently certificated for and is now providing gas service in Kitsap County. Cascade is requesting a certificate to expand the service area within an area northwest of Poulsbo, Washington. The additional area requested is contiguous to the existing certificated area.

This filing request makes no determination at this time as to the reasonableness of the gas pipeline facility to serve this addition to Cascade's service area, but recognizes the right of the Commission to determine such reasonable services and expenditures, together with the treatment of same, in any formal proceeding before the Commission dealing with Cascade's results of operation for ratemaking purposes.

It appears the application herein should be granted to satisfy the public convenience and necessity.

FINDING OF FACT

1. Cascade Natural Gas Corporation, a Washington corporation, operates a gas plant for hire in this state and is subject to the jurisdiction of this Commission.
2. Cascade has heretofore been issued a Certificate of Public Convenience and Necessity to Operate a Gas Plant for Hire as amended.
3. Cascade has filed an application to amend its Certificate of Public Convenience and Necessity, to include the additional area contiguous to its presently certificated area in Kitsap County.
4. The operation of a gas plant for hire in the additional area requested is or will be required by the public convenience and necessity.

5. The Certificate of Public Convenience and Necessity to Operate a gas Plant for Hire presently held by Cascade Natural Gas Corporation, should be further amended to include the additional area applied for herein.

O R D E R

1. IT IS HEREBY ORDERED that the application of Cascade Natural Gas Corporation to amend its Certificate of Public Convenience and Necessity to Operate a Gas Plant for Hire within the certificated area in Kitsap County, is hereby approved and said Certificate shall be in accordance with attached Appendix A-4, which by this reference, is made a part hereof as though fully set forth herein.

2. IT IS FURTHER ORDERED That the Certificate issued pursuant to Order Paragraph No. 1, above, is subject to the terms, conditions, and provisions of the Orders in Cause Nos. U-8841, U-8843, U-8937, U-9047, U-9052, U-9194, U-9238, U-9239, U-9253, U-9263, U-9264, U-9360, U-9388, U-9394, U-9407, U-9450, U-9467, U-9496, U-9600, U-9708, U-9759, U-9807, U-9808, U-9819, U-9790, U-9822, U-9860, U-9872, U-9873, U-10001, U-74-19, U-78-50, U-80-06, U-80-22, U-80-100, U-81-43, U-83-40, U-83-41, U-84-55, U-85-04, U-85-76, UG-900727, UG-900782, UG-911010, UG-940100, and UG-940101.

3. IT IS FURTHER ORDERED that Cascade Natural Gas Corporation provide to the Commission no later than January 1, 1996, documentation that the Company has in fact, completed the installation of 6.9 miles of twelve inch looped pipeline in Mason County and a comprehensive plan of development that will address the inadequate capacity of the existing eight inch Kitsap high-pressure pipeline and provide sufficient capacity to at least meet the anticipated demand along the Kitsap Peninsula.

4. This Order makes no determination at this time as to the reasonableness of the gas pipeline facility to serve this addition to Cascade's service area, but reserves the right of the Commission to determine such reasonable services and expenditures, together with the treatment of same, in a formal proceeding before the Commission dealing with Cascade's results of operation for ratemaking purposes.

5. IT IS FURTHER ORDERED That jurisdiction over this order is retained to effectuate the provisions of this order.

CASCADE NATURAL GAS CORPORATION
LEGAL DESCRIPTION
APPENDIX A-4
DOCKET UG-950770

A portion of Kitsap County to be added to Appendix A-4 adjacent thereto lying within the area described as follows:

Sections 2, 3, 4, and 5 of Township 26 North, Range 1 East, W.M.
Sections 22, 23, 26, 27, 28, 33, 34, and 35 of Township 27 North, Range 1 East, W.M.

APPENDIX A-4 AMENDED:

All of the incorporated area comprising the cities of Bremerton, Port Orchard and Poulsbo and additional portions of Kitsap county lying within the area described as follows:

Beginning at a point where the north line of Sec.23, T. 27 N., R. 1 E., W.M., intersects the easterly meander line of Hood Canal; thence southwesterly to a point where said meander line intersects the west line of Sec. 4, T. 26 N., R. 1 E.; thence southerly to a point where said meander line intersects the west line of Sec. 12, T. 25 N., R. 1 W.; thence south along the west lines of Secs. 12, 13, 24, 25 and 36, T. 25 N., R. 1 W., and along the west lines of Secs. 1, 12, 13, 24 and 25, T. 24 N., R. 1 W., to the southwest corner of said Sec. 25; thence west along the north lines of Secs. 35 and 34, T. 24 N., R. 1 W., to the northwest corner of said Sec. 34; thence south along the west line of said Sec. 34, and along the west lines of Secs. 3, 10, 15, 22, 27 and 34, T. 23 N., R. 1 W., to the southwest corner of said Sec. 34; thence east along the south lines of Secs. 34, 35 and 36, T. 23 N., R. 1 W., and along the south lines of Secs. 31, 32, 33, 34, 35 and 36, T. 23 N., R. 1 E., and along the south lines of Secs. 31, 32, 33 and 34, T. 23 N., R. 2 E., to the intersection of the south line of said Sec. 34 with the meander line of Puget Sound; thence north along said meander line, and along the meander line of Sinclair Inlet, Port Orchard and Liberty Bay to a point where said meander line intersects the east line of Sec. 26, T. 26 N., R. 1 E.; thence north along the east lines of Secs. 26 to the south line of Sec. 24, T. 26 N., R. 1 E.; thence east along the south line of said Sec. 24 to its southeast corner of Sec. 24, T. 26 N., R. 1 E.; thence north along the east line of Secs. 24 and 13, T. 26 N., R. 1 E. to the northeast corner of said Sec 13; thence west along the north line of Sec. 13, T. 26 N., R.1 E. to the northwest corner of said Sec. 13; thence north along the east line of Secs. 11, and 2, T. 26 N., R.1 E. and the east line of Secs. 35, 26, and 23, T. 27 N., R. 1 E., to the northeast corner of said Sec. 23; thence west along the north lines of Sec. 23, T. 27 N., R. 1 E., to a point where the north line of said Sec. 23 intersects the easterly meander line of Hood Canal, the point of beginning.

DATED at Olympia, Washington and effective this 11th day of October, 1995.

WASHINGTON UTILITIES AND TRANSPORTATION COMMISSION



SHARON L. NELSON, CHAIRMAN



RICHARD HEMSTAD, COMMISSIONER



WILLIAM R. GILLIS, COMMISSIONER

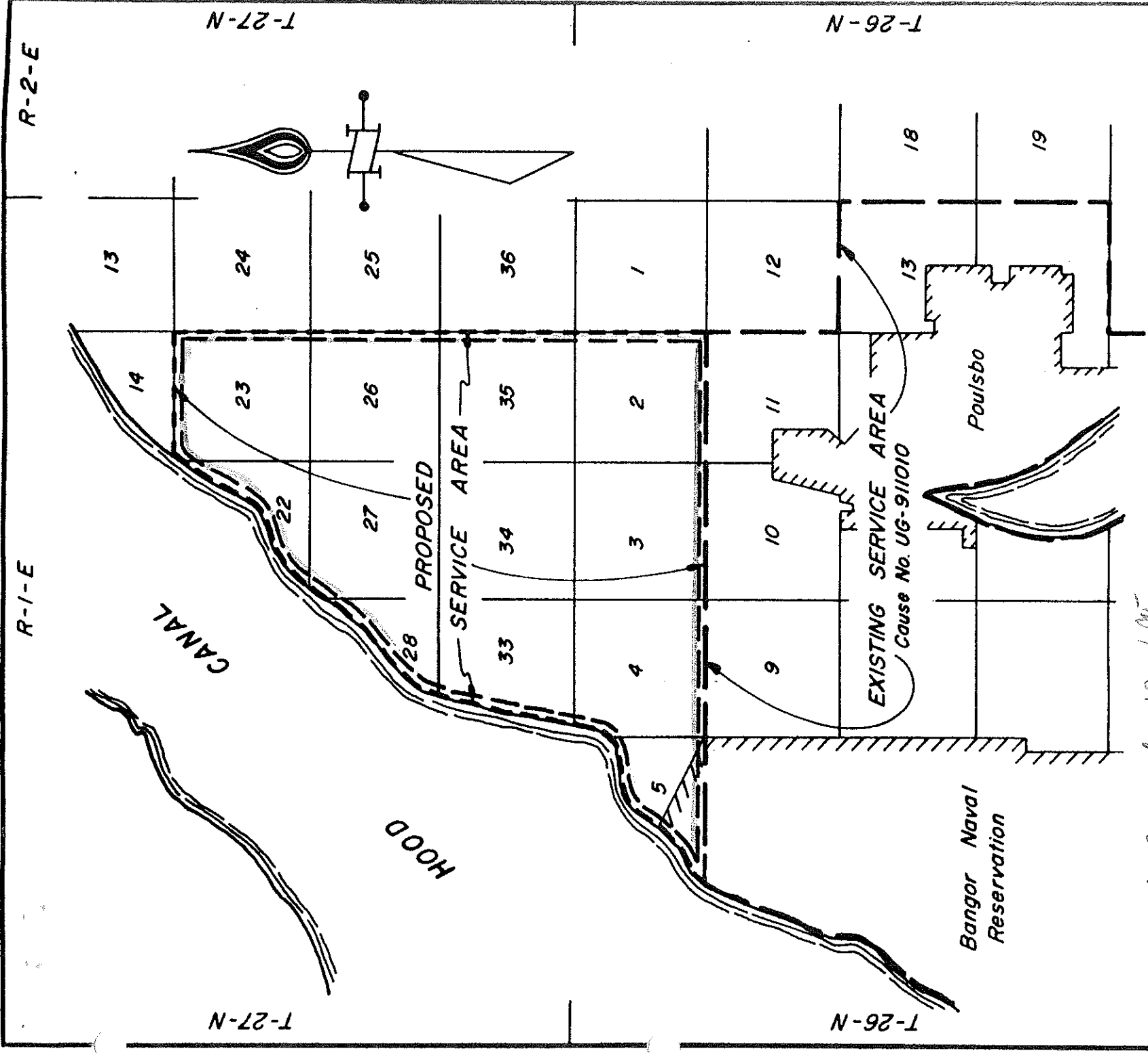

Approved 10-11-95



EXHIBIT B-1

E. R. NO.

CASCADE NATURAL GAS CORPORATION
 Seattle, Wash. 98109
 222 Fairview Ave. No.

PROPOSED SERVICE AREA
 KITSAP COUNTY WA

Scale 1" = 1 Mile	Drawn C.B.
Date 5-24-95	Checked
Eng.	Meas. N/A
Drawing Number	None