

WASHINGTON PUBLIC SERVICE COMMISSION
CERTIFICATE OF PUBLIC CONVENIENCE AND NECESSITY
TO OPERATE A GAS PLANT FOR HIRE

EASTERN WASHINGTON NATURAL GAS COMPANY, Inc.

(Name)

of Ritzville, Washington is hereby authorized
(Address)

to operate a gas plant for hire in the general area or areas of:

Ritzville, Adams County; Endicott, Whitman County and areas adjacent to the foregoing as ordered in Cause Nos. U-8891 and U-9012 and Stevenson, Skamania County and area adjacent as ordered in Cause No. U-9121, and designated in Appendices A-1, A-2 and A-3, attached hereto and made a part hereof, each such appendix consisting of a map and attached legal description.

~~as more particularly designated on "Exhibit A" of certificate holder's application, as "Exhibit A" has been or may be amended. Said "Exhibit A" is on file with the Commission and is open to public inspection.~~

CONDITIONS:

1. Any gas plant operated by virtue of this certificate must be operated in accordance with the Laws of the State of Washington and the Rules and Regulations of this Commission.
2. This certificate must be kept on file at the main office of the gas company except when directed to be transmitted to the Commission, and shall be subject at all times to inspection by the authorized representatives of the Commission.
3. This certificate shall be subject to revocation and cancellation by the Commission upon a showing of procurement by false affidavit or representation.
4. This certificate is subject to the terms, conditions and provisions of the order in Cause No. U-8891, effective April 3, 1957, Cause No. U-9012, effective February 20, 1958, and Cause No. U-9121, effective May 15, 1959, pursuant to which this certificate is issued.

This certificate is issued upon finding by the Washington Public Service Commission that public convenience and necessity requires or will require such operation in accordance with section 4, chapter 316, Laws of 1955, and

Order No. U-9121 Dated May 15, 1959

Dated at Olympia, Washington, May 15, 1959

WASHINGTON PUBLIC SERVICE COMMISSION

By Walter S. Barclay
Executive Secretary

BEFORE THE WASHINGTON PUBLIC SERVICE COMMISSION

In the Matter of the Application of)	
EASTERN WASHINGTON NATURAL)	CAUSE NO. U-9121
GAS COMPANY, INC., for a Certificate)	
of Public Convenience and Necessity)	ORDER GRANTING APPLICATION
to Operate a Gas Plant for Hire to)	AND
Encompass the Incorporated Area of)	AMENDING PRESENT CERTIFICATE
the Town of Stevenson and Adjacent)	
Area in Skamania County, Washington)	
.)	

The Eastern Washington Natural Gas Company, Inc., a Washington corporation, on April 22, 1959, filed with the Commission an application for a Certificate of Public Convenience and Necessity to Operate a Gas Plant for Hire in the Town of Stevenson and vicinity, in Skamania County, Washington. The company at present operates gas plants for hire in Ritzville and Endicott, Washington, and holds Certificate of Public Convenience and Necessity to Operate a Gas Plant for Hire No. 10, as amended in Cause No. U-9012, dated February 20, 1958.

Eastern Washington also owns a half interest in the Goldendale Natural Gas Company, which company has a certificate and is installing the necessary facilities to provide natural gas service in Goldendale, Washington, and vicinity. It is expected that Eastern Washington Natural Gas Company's management will operate the Goldendale plant when it is placed in operation.

As was indicated above, Eastern Washington's present application encompasses the Town of Stevenson and vicinity. Stevenson, with a population of about 900, is the county seat of Skamania County and is located on the Columbia River about six miles upstream from the Bonneville Dam. Logging and lumbering are the main industries of the community.

The Eastern Washington Natural Gas Company, Inc., is the only company which has requested a certificate to supply natural gas service to the Stevenson area. The company has obtained a franchise from the Town of Stevenson to operate a gas plant for hire.

The feasibility study supporting the company's application is primarily based on serving a substantial industrial load as well as serving residential and commercial customers. The company expects to have gas service available for one of the local lumber mills some time in August or as soon thereafter as the necessary pipeline facilities can be constructed. It also expects to provide gas service to a new veneer plant scheduled for completion in late 1961 or early 1962. Gas service to residential and commercial customers will be made available as soon as necessary plant facilities can be constructed.

As previously noted, Eastern Washington operates gas plants for hire in Ritzville and Endicott and expects to operate a plant in Goldendale. In view of the above experiences, Eastern Washington should be familiar with the problem of

efficiently operating a natural gas system in a community the size of Stevenson. Furthermore, certain functions, such as billing, bookkeeping and general supervision, can probably be handled from the company's main office in Ritzville with no additional personnel.

The company has been assured an adequate supply of gas for its present, as well as its anticipated future, needs by the Pacific Northwest Pipeline Corporation. The pipeline company's main line passes near Stevenson's city limits.

Montana Gas Corporation, a company with extensive operations in the gas and oil industry of Montana, controls the Eastern Washington company with the result that Eastern Washington should experience no problems in financing the Stevenson operation.

FINDINGS OF FACT

1. Eastern Washington Natural Gas Company, Inc., a Washington corporation, operates a gas plant for hire in this state and is subject to the jurisdiction of this Commission.
2. Eastern Washington Natural Gas Company, Inc., has heretofore been issued, in Cause Nos. U-8891 and U-9012, Certificate of Public Convenience and Necessity No. 10, as amended, to operate gas plants for hire in Ritzville and Endicott, Washington, and vicinity. Their present certificated areas are fully delineated in the above causes.
3. Eastern Washington Natural Gas Company, Inc., requests a Certificate of Public Convenience and Necessity to Operate a Gas Plant for Hire in the Town of Stevenson and vicinity in Skamania County, Washington.
4. At present there is no gas company operating or holding a certificate to operate a gas plant for hire in the area in question.
5. The Commission has no other application requesting certification for the area sought by Eastern Washington Natural Gas Company, Inc.
6. Eastern Washington Natural Gas Company, Inc., has obtained a franchise from the Town of Stevenson to operate a gas plant for hire.
7. Eastern Washington Natural Gas Company's plans for supplying gas service in the area encompassed in its application are, based on the representation made to this Commission, economically feasible.
8. Eastern Washington Natural Gas Company, Inc., will have available an adequate supply of gas to serve the present and anticipated future demands for the requested area.
9. The operation of a gas plant for hire by Eastern Washington Natural Gas Company, Inc., in the Stevenson area is or will be required by the public convenience and necessity.
10. The Certificate of Public Convenience and Necessity presently held by Eastern Washington Natural Gas Company, Inc., should be amended to include the Town of Stevenson and vicinity as requested.

ORDER

1. IT IS HEREBY ORDERED That the application of Eastern Washington Natural Gas Company, Inc., for a Certificate of Public Convenience and Necessity to Operate a Gas Plant for Hire in the Town of Stevenson and vicinity in Skamania County, Washington, is approved and the company's present Certificate of Public Convenience and Necessity to Operate a Gas Plant for Hire be amended to encompass the additional area as follows:

a. All the incorporated area comprising the Town of Stevenson and additional portion of Skamania County, Washington, adjacent thereto lying within the area described as follows:

Secs. 35 and 36, T 3 N, R 7 E, W. M.; Secs. 1 and 2, and all Secs. 11 and 12 lying within the County of Skamania, in T 2 N, R 7 E, W. M.; and that portion of Sec. 36, T 3 N, R 7-1/2 E, W. M.; lying within Skamania County and south of the north line of Sec. 36, T 3 N, R 7 E, W. M. ; extended eastward, all beginning in Skamania County, Washington.

As further shown on Appendix A-3 attached hereto and by this reference made a part hereof.

2. IT IS FURTHER ORDERED That the Certificate of Public Convenience and Necessity issued pursuant to the Order paragraph No. 1 above, supersedes and cancels Certificate of Public Convenience and Necessity No. 10, amended, issued to Eastern Washington Natural Gas Company, Inc., February 20, 1958, in Cause No. U-9012. Said Certificate of February 20, 1958, should be forthwith returned to this Commission.

3. IT IS FURTHER ORDERED That jurisdiction over this cause is retained to effectuate the provisions of this order.

DATED at Olympia, Washington, and effective this 15th day of May, 1959.

WASHINGTON PUBLIC SERVICE COMMISSION

FRANCIS PEARSON, Chairman

PATRICK D. SUTHERLAND, Commissioner

DAYTON A. WITTEN, Commissioner

Certificate

STATE OF WASHINGTON, }
COUNTY OF THURSTON. } ss.

I hereby certify that the foregoing and attached document..... is afull, true and correct
copy of original Order Granting Application and Amending Present Certificate,.....
dated May 15, 1959, in Cause No. U-9121, In the Matter of the Application of
EASTERN WASHINGTON NATURAL GAS COMPANY, INC., for a Certificate of
Public Convenience and Necessity to Operate a Gas Plant for Hire to Encompass
the Incorporated Area of The Town of Stevenson and Adjacent Area in Skamania
County, Washington,.....

.....
.....
now on file in the office of the Washington Public Service Commission at Olympia.

IN WITNESS WHEREOF, I have hereunto set my hand and affixed the seal of the Washington
Public Service Commission, this 15th day of May, 1959.

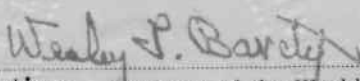
Executive Secretary of the Washington Public
Service Commission.

APPENDIX A-1. LEGAL DESCRIPTION--RITZVILLE AND VICINITY-
ADAMS COUNTY

(a) Main service area:

Beginning at the southwest corner of Sec. 23, T 19 N, R 35 E, W.M.; thence northerly along the west boundary of Sec. 23 to the mid-point of the north half of said boundary; thence westerly along the east-west center line of the north half of Sec. 22 to the north-south center line of the east half of the northeast quarter of Sec. 22; thence northerly along said north-south center line to the north boundary of Sec. 22; thence easterly to the northeast corner of Sec. 22; thence northerly along the west boundary of Sec. 14 to the mid-point of the west boundary of the south half of Sec. 14; thence easterly along the east-west center line of said south half to the north-south center line of the southeast quarter of Sec. 14; thence southerly to the mid-point of the south boundary of said southeast quarter; thence easterly to the southeast corner of Sec. 14; thence southerly along the east boundary of Sec. 23 to the southeast corner of said Sec. 23; thence westerly along the south boundary of Sec. 23 to the southwest corner of Sec. 23, which is the point of beginning, all in Adams County, Washington.

(b) Transmission line area. City gate to main service area.

A strip of land in Adams County, Washington, being the Adams County right-of-way of a road known as Wellsandt Road, and a strip of land 100 feet in width on each side of said right-of-way, commencing at the east corporate limits of the City of Ritzville and proceeding easterly across Sec. 24, T 19 N, R 35 E, W.M, and across Secs. 19, 20, 21 and 22, T 19 N, R 36 E, W.M, to a point in said Sec. 22 at which the natural gas transmission pipeline of the Pacific Northwest Pipeline Corporation crosses said Wellsandt Road.

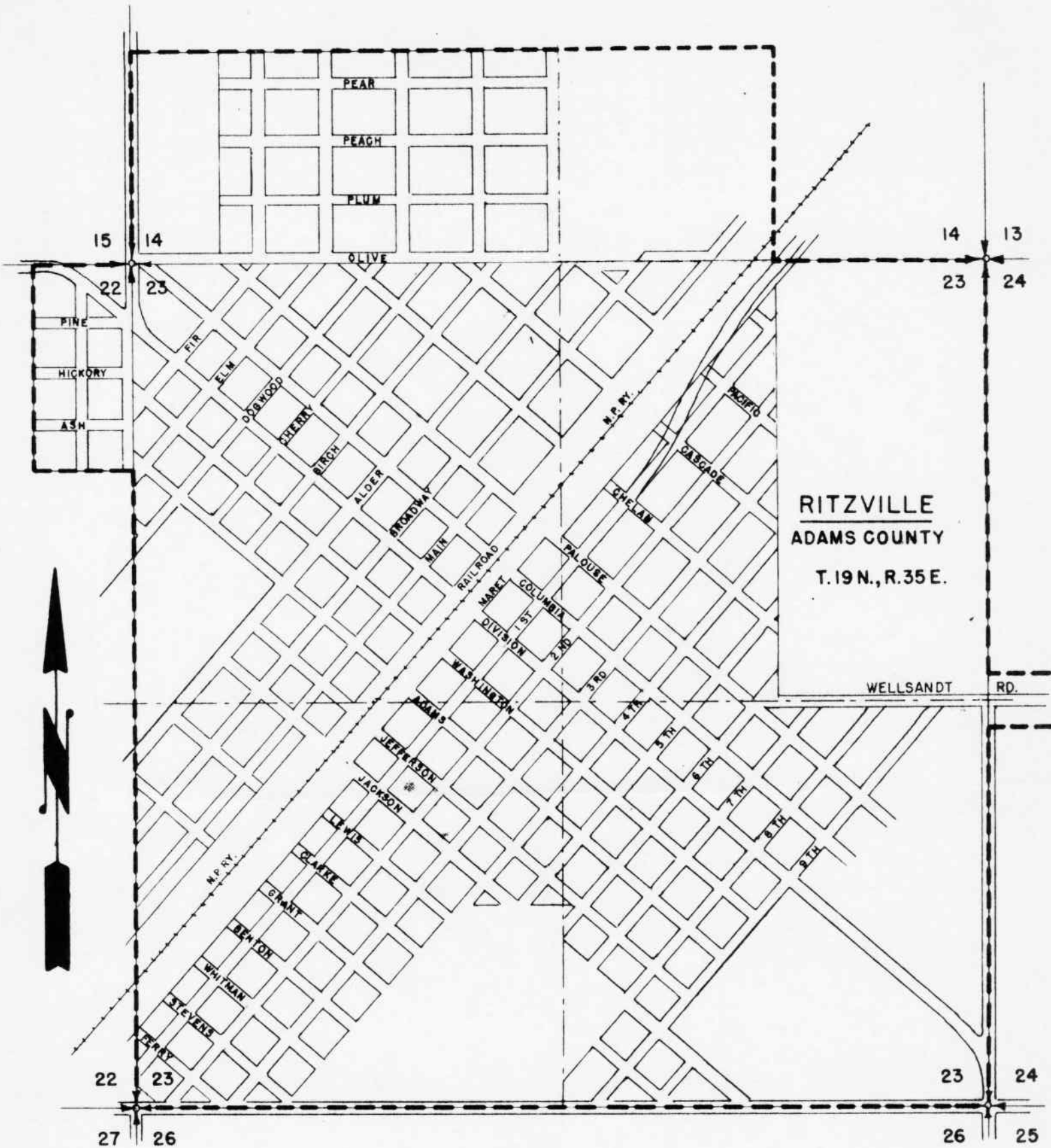

SCALE 1" = 800'

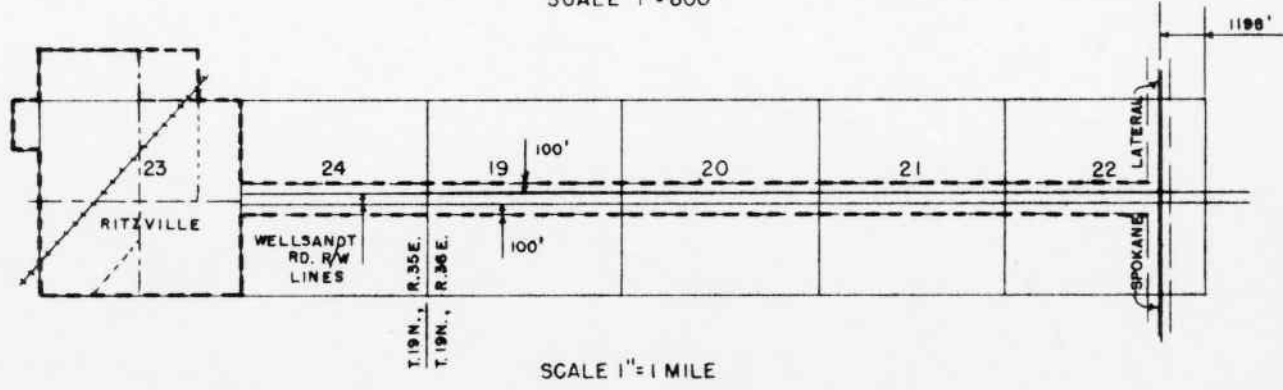

SCALE 1" = 1 MILE

APPENDIX A-1
 CAUSE NO. U-8891
 EASTERN WASHINGTON NATURAL GAS COMPANY
 BOUNDARY OF SERVICE AREA - - - - -
 (RITZVILLE & VICINITY - ADAMS COUNTY)

WASHINGTON PUBLIC SERVICE COMMISSION
 FIELD ENGINEERING
 DATE: 3-27-57
 CHECKED: A.F.G.
 BY: D.H.

Beginning at the northeast corner of Sec. 31, T 17 N, R 41 E, W.M., in the County of Whitman, State of Washington, running thence east on the north line of Sec. 32, T 17 N, R 41 E, W.M. a distance of 700 feet; thence south on a line parallel with the west line of said Sec. 32 a distance of 3,000 feet; thence west on a line parallel with the north line of said Sec. 31 a distance of 3,200 feet; thence north on a line parallel with the east line of said Sec. 31 a distance of 4,000 feet; thence east on a line parallel with the south line of Sec. 30, T 17 N, R 41 E, W.M. a distance of 1,425 feet; thence northeasterly to the right-of-way of the Pacific Northwest Pipeline Corporation's Lewiston lateral, such point is 825 feet west of the east line of Sec. 30, T 17 N, R 41 E, W.M.; thence east on a line parallel with the south line of said Sec. 30 a distance of 300 feet; thence southwesterly to a point 1,475 feet west of the east line and 1,000 feet north of the south line of said Sec. 30; thence east on a line parallel with the south line of said Sec. 30 to a point of intersection with the east line of Sec. 30; thence south on the east line of said Sec. 30 to point of beginning.

APPENDIX A-2

CAUSE NO. U-9012

**EASTERN WASHINGTON NATURAL GAS
COMPANY, INC.**

BOUNDARY OF SERVICE AREA - - - - -
(ENDICOTT & VICINITY - WHITMAN COUNTY)

WASHINGTON PUBLIC SERVICE COMMISSION

DATE: 2-11-58

BY D.H.

CHECKED: T.H.

T. 17N., R. 41E.W.M.

SEE DETAIL B FOR
EXTENSION OF AREA

PACIFIC NORTHWEST
PIPELINE

150'

150'

925'

1000'

CORPORATE
LIMITS

U.P. RR

E N D I C O T T

LIMITS

CORPORATE

U.P. RR.

3200'

DETAIL A

MAIN SERVICE AREA - ENDICOTT
SCALE 1" = 600'

675'

2600'

30 29
31 32

DETAIL B

TRANSMISSION LINE AREA
SCALE 1" = 2000'

30

29

700'

31

32

4000'

5000'



APPENDIX A-3 - LEGAL DESCRIPTION - STEVENSON
AND VICINITY, IN SKAMANIA COUNTY

Secs. 35 and 36, T 3 N, R 7 E, W. M.; Secs. 1 and 2, and all Secs. 11 and 12 lying within the County of Skamania, in T 2 N, R 7 E, W. M.; and that portion of Sec. 36, T 3 N, R 7-1/2 E, W. M.; lying within Skamania County and south of the north line of Sec. 36, T 3 N, R 7 E, W. M.; extended eastward, all beginning in Skamania County, Washington

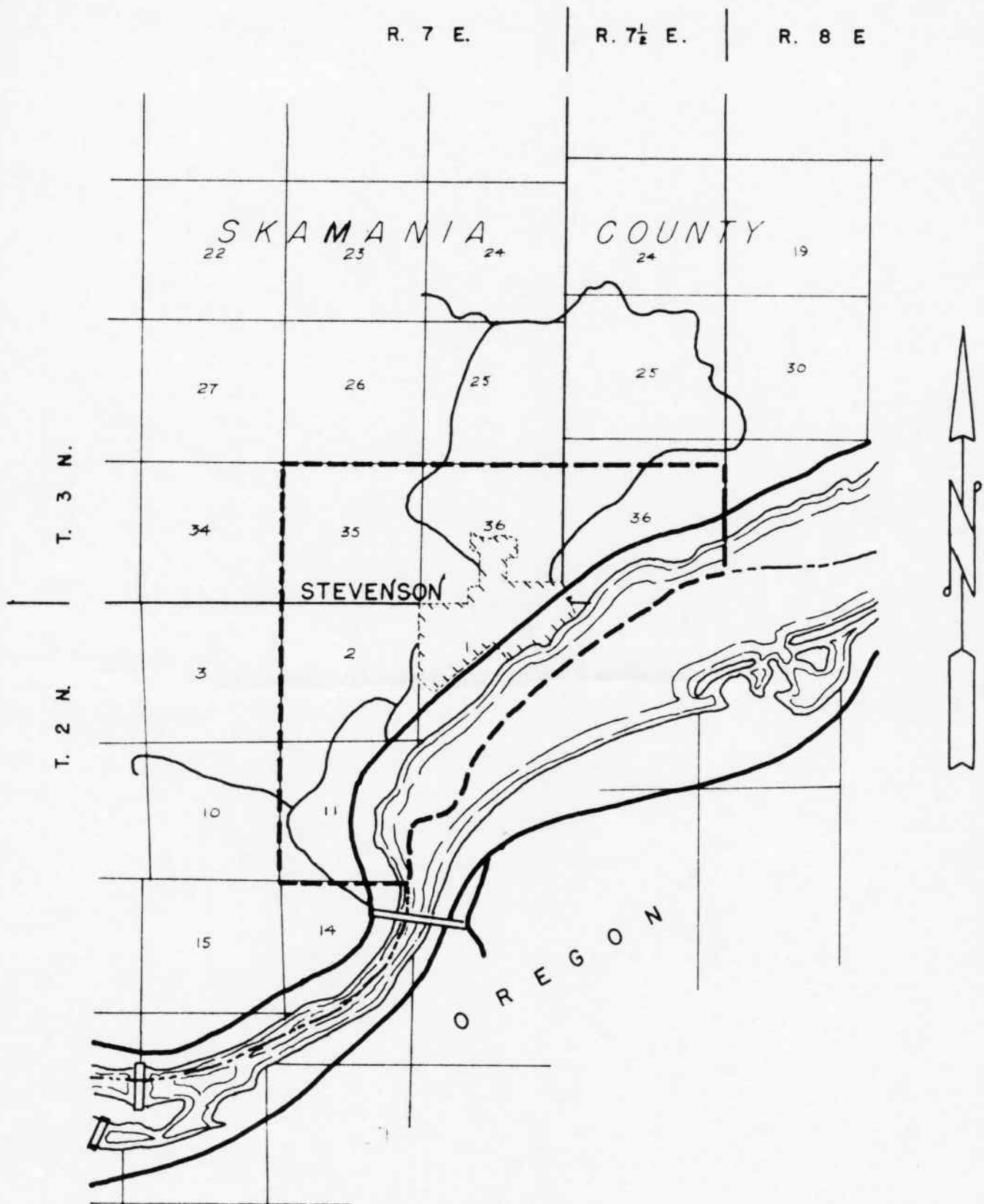

APPENDIX A-3
 CAUSE NO. U-9121

**EASTERN WASHINGTON NATURAL GAS
 COMPANY, INC.**

BOUNDARY OF SERVICE AREA 
 STEVENSON AND VICINITY SKAMANIA COUNTY

WASHINGTON PUBLIC SERVICE COMMISSION

DATE: 4-30-59

BY: TRW

CHECKED: TNH