

SUMMIT LAW GROUP®

a professional limited liability company

CAROL A. CANNON
DID: (206) 676-7088
E-MAIL: carolc@summitlaw.com

March 30, 2004

Via U.S. Mail

Tami Schultz
Washington Utilities and
Transportation Commission
1300 S. Evergreen Park Drive S.W.
PO Box 47250
Olympia, WA 98504-7250

Re: Application No. GA079221; Docket No. TG-131616

Dear Tami:

Enclosed please find a Shipper Support Statement for the Dishman-Mica Road area of the Eastern Washington authority.

Sincerely,

SUMMIT LAW GROUP PLLC



Carol A. Cannon
Legal Assistant to Polly L. McNeill

Enclosure

RECEIVED
RECORDS MANAGEMENT
04 MAR 31 AM 8:24
STATE OF WASH.
UTIL. AND TRANSP.
COMMISSION

CUSTOMER SWORN STATEMENT OF NEED FOR SERVICE

Applicant Name: Waste Management of Washington, Inc.

Application No.: GA079221 (Docket TG 031616)

Customer Name: Dorothee Allen

Address: 8707 S. Dishman-Mica Rd - Valleyford, WA. 99036

Phone Number: (509) 926-6177 Fax Number: () none E-mail: none

Describe the need for the requested service:

I have a need for solid waste collection services to my location on Dishman-Mica Road, in Spokane County. Waste Management has provided the service to me in the past, and I submit this statement in support of Waste Management's request for approval to include Dishman-Mica Road in its certificate of convenience and necessity in an effort to comport its certificate rights to its actual service operations.

What date(s) do you need the service? Tuesdays

I need solid waste collection service on a regular basis. yes

Number of days, trips, loads:

1 time/week - Tuesdays

If there is an existing company providing this service in the territory, please indicate the existing Company's name (if applicable):

There is no other company providing this service on Dishman-Mica Road.

I certify or declare under penalty of perjury under the laws of the state of Washington that the information contained in this statement is true and correct.

Dorothee Allen

Print Name

Dorothee Allen

Signature

3-27-04
Valleyford, WA. 99036

Date, County, State

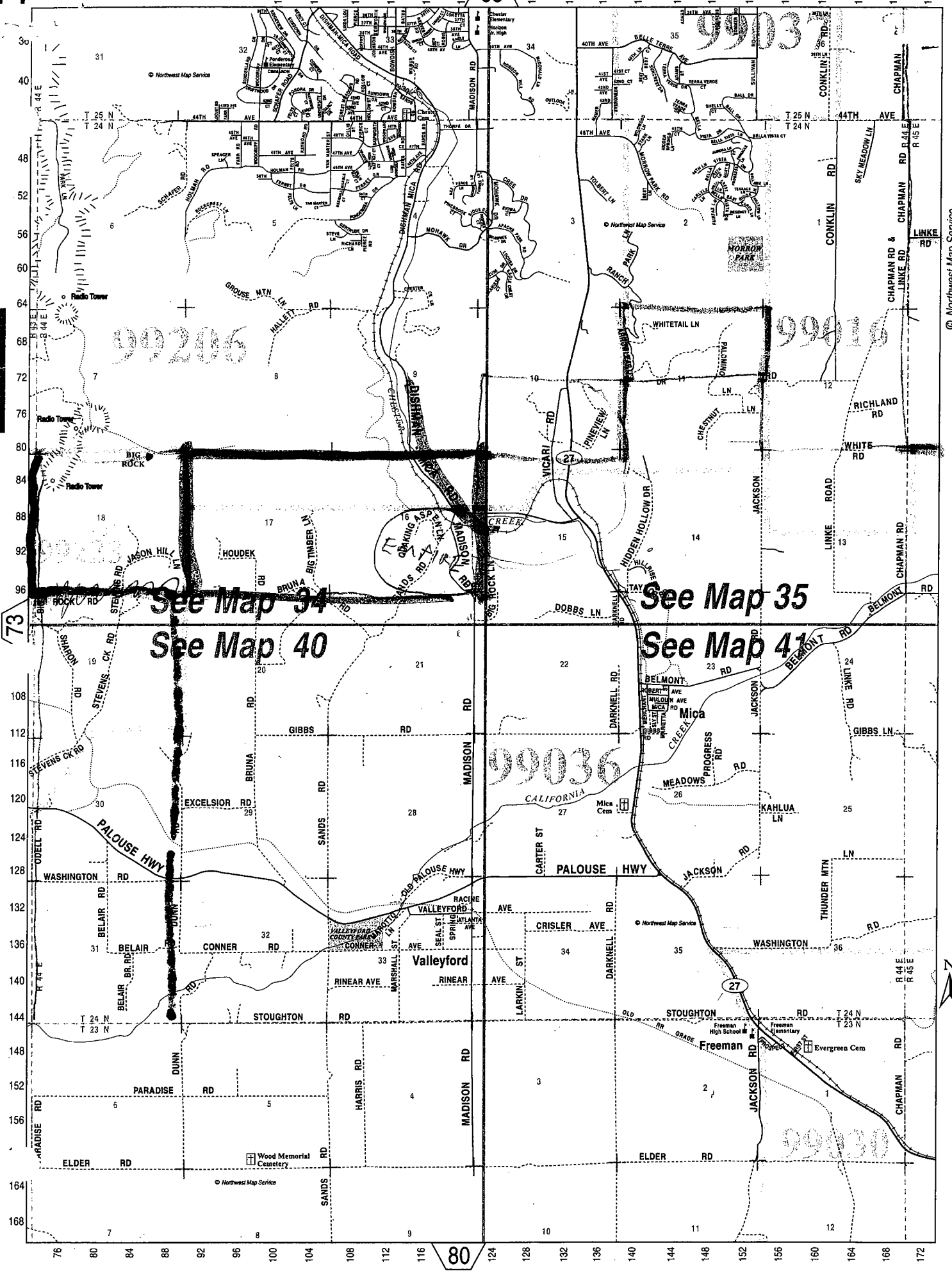

See Map 34

See Map 40

See Map 35

See Map 41

© Northwest Map Service

© Northwest Map Service

73

80