

Fatality Collision-Train vs Truck

92nd Ave NW

2016152909



## SO2016-152909 RAW DATA

| Pt#  | North   | East     | Elev   | Desc        |
|------|---------|----------|--------|-------------|
| 1    | 0       | 0        | 0      | 0 SET1      |
| 1000 | 77.386  | 0        | 17.991 | BBG1        |
| 1001 | 39.83   | -25.946  | 1.957  | REAR TRAIN  |
| 1002 | 29.987  | -29.656  | 1.968  | REAR TRAIN  |
| 1003 | -28.763 | 157.148  | 1.584  | FRONT TRAIN |
| 1004 | -38.535 | 153.509  | 1.563  | FRONT TRAIN |
| 1005 | -34.235 | 149.701  | 1.907  | TRACK       |
| 1006 | -29.337 | 151.543  | 1.907  | TRACK       |
| 1007 | 36.661  | -26.201  | 2.211  | TRACK       |
| 1008 | 31.08   | -27.033  | 2.181  | TRACK       |
| 1009 | 26.755  | 6.61     | 2.353  | DW          |
| 1010 | 38.309  | 10.171   | 0.328  | DW          |
| 1011 | 33.132  | 24.67    | 0.59   | DW          |
| 1012 | 21.079  | 20.795   | 2.318  | DW          |
| 1013 | 12.58   | 17.659   | 1.939  | DW          |
| 1014 | -28.109 | 6.276    | -3.132 | DW          |
| 1015 | -26.403 | -5.585   | -3.312 | DW          |
| 1016 | 17.954  | 3.239    | 2.091  | DW          |
| 1017 | 0.769   | -21.306  | -4.765 | CP1         |
| 1018 | -0.649  | -24.189  | -4.956 | CP1         |
| 1019 | -2.285  | -23.574  | -4.925 | CP1         |
| 1020 | -1.215  | -20.759  | -4.816 | CP1         |
| 1021 | 8.522   | -60.335  | -5.236 | CAB         |
| 1022 | 14.327  | -61.74   | -5.134 | CAB         |
| 1023 | 12.574  | -69.975  | -5.363 | CAB         |
| 1024 | 8.028   | -67.732  | -5.325 | CAB         |
| 1025 | 25.488  | -75.062  | -5.249 | WHEELS      |
| 1026 | 28.866  | -76.425  | -5.037 | WHEELS      |
| 1027 | 33.99   | -74.163  | -3.143 | FRAME       |
| 1028 | 34.713  | -70.668  | -2.153 | FRAME       |
| 1029 | 29.743  | -67.657  | -2.925 | WHEELS      |
| 1030 | 24.36   | -65.581  | -4.551 | WHEELS      |
| 1031 | 21.438  | -61.72   | -4.766 | FRONT AXLE  |
| 1032 | 20.971  | -67.691  | -4.34  | FRONT AXLE  |
| 1033 | 24.334  | -96.478  | -5.328 | PASSENGER   |
| 1034 | 39.994  | -118.874 | -5.142 | BOX         |
| 1035 | 38.98   | -126.913 | -5.255 | BOX         |
| 1036 | 57.976  | -130.418 | 0.96   | BOX         |
| 1037 | 62.309  | -124.656 | 1.846  | BOX         |
| 1038 | 76.663  | -153.852 | 2.535  | ROAD        |
| 1039 | 78.309  | -165.529 | 1.825  | ROAD        |
| 1040 | 80.034  | -188.321 | -0.193 | ROAD        |
| 1041 | 83.885  | -209.611 | -2.039 | ROAD        |
| 1042 | 88.403  | -228.75  | -3.184 | ROAD        |
| 1043 | 90.976  | -244.746 | -3.44  | ROAD        |
| 1044 | 79.656  | -233.924 | -2.867 | ROAD        |

# SO2016-152909 ACCIDENT A B



STATE OF WASHINGTON  
POLICE TRAFFIC  
COLLISION REPORT



1591971

REPORT NO. **E589327**

1 1 7 27

1 1

|                                      |   |   |
|--------------------------------------|---|---|
| INTERSTATE <input type="checkbox"/>  | CITY STREET <input type="checkbox"/>            | FIRE RESULTED <input type="checkbox"/>      |
| STATE ROUTE <input type="checkbox"/> | OTHER <input type="checkbox"/>                  | STOLEN VEHICLE <input type="checkbox"/>     |
| COUNTY RD <input type="checkbox"/>   | PRIVATE WAY <input checked="" type="checkbox"/> | HIT & RUN INVOLVED <input type="checkbox"/> |

CASE # 2016-152909

2 1

LOCAL AGENCY CODING WA0310000

3 3

TRIBAL RESERVATION

TOTAL # OF UNITS 02 OBJECT STRUCK

4

M M D D Y Y Y Y TIME (2400) COUNTY # MILES CITY #

DATE OF COLLISION 09 - 27 - 2016 1813 31 05 00 N  E  IN  OF  1235

4b

ON (PRIMARY TRAFFIC WAY) INTERSECTION  NON-INTERSECTION

92 AV NW BLOCK NO.  32000 MILE POST

5 0

DISTANCE 100 00 MILES  N  E  OF (REFERENCE OR CROSS STREET) PIONEER HWY  S  W

6 2

UNIT 01 MOTOR VEHICLE  PEDAL-CYCLE  DAMAGE THRESHOLD MET YES  NO  PHONE

7

LAST NAME TORRES-ARANDA FIRST NAME JESUS MIDDLE INITIAL

8

STREET NEW ADDRESS (4b)

9 8

CITY (4b) ST WA ZIP (4b)

10

CDL RESTRICTIONS ENDORSEMENTS

11 0 0

DRIVER'S LICENSE # (4b) STATE WA SEX M D.O.B. (4b)

12

ON DUTY  STATUS AIRBAG 1 RESTR. 1 EJECT 1 HELMET USE INJURY CLASS 2 NATURE OF INJURIES HEAD INJURIES

13 A

LICENSE PLATE # 94404Z STATE WA VIN# 1HTLKDBR6JH514337

14

TRAILER PLATE # STATE TRAILER PLATE # STATE

15 4

VEH. YEAR 1988 MAKE INTL MODEL S1900 STYLE BA VEHICLE TOWED YES  NO  TOWED BY GOVT. VEHICLE YES  NO

16

REGISTERED OWNER INFO. LIABILITY INSURANCE IN EFFECT  INSURANCE CO & POLICY # COUNTRY FINANCIAL 9921555

17

VEHICLE LEGALLY REGISTERED YES  NO  CITATION # CHARGE

18

UNIT 02 MOTOR VEHICLE  PEDAL-CYCLE  PEDESTRIAN  PROPERTY OWNER  DAMAGE THRESHOLD MET YES  NO  PHONE

19

LAST NAME BNSF RAILWAY CO FIRST NAME MIDDLE INITIAL

20

STREET NEW ADDRESS 2454 OCCIDENTAL AV BLDG 1-A

21

CITY SEATTLE ST WA ZIP 98134

22

CDL RESTRICTIONS ENDORSEMENTS

23

DRIVER'S LICENSE # STATE SEX U D.O.B. MMDYYYY

24

ON DUTY  STATUS AIRBAG RESTR. EJECT HELMET USE INJURY CLASS NATURE OF INJURIES

25

LICENSE PLATE # STATE VIN#

26

TRAILER PLATE # STATE TRAILER PLATE # STATE

VEH. YEAR MAKE MODEL STYLE VEHICLE TOWED YES  NO  TOWED BY GOVT. VEHICLE YES  NO

REGISTERED OWNER INFO. LIABILITY INSURANCE IN EFFECT  INSURANCE CO & POLICY #

VEHICLE LEGALLY REGISTERED YES  NO  CITATION # CHARGE

OFFICER'S NAME (PRINT) G. METCALF BADGE OR ID # 1319 AGENCY WA0310000

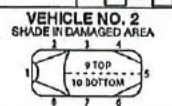

|      |        |          |                     |
|------|--------|----------|---------------------|
| 1045 | 75.986 | -220.967 | -2.484 ROAD         |
| 1046 | 72.773 | -208.08  | -1.66 ROAD          |
| 1047 | 67.659 | -178.05  | 0.662 ROAD          |
| 1048 | 64.838 | -158.015 | 1.959 ROAD          |
| 1049 | 65.623 | -143.824 | 2.292 ROAD          |
| 1050 | 60.984 | -171.767 | -1.128 STOP SIGN    |
| 1051 | 60.53  | -165.52  | -1.333 RR XING SIGN |



1591972

**CORRECTION REPORT NO. E589327**  
**CASE # 2016-152909**

| ADDITIONAL PERSONS INVOLVED (PASSENGERS AND/OR WITNESSES ONLY) |                                     |                    |                                     |        |   |           |   |                   |   |        |   |       |   |            |  |              |   |                    |                     |
|--|-------------------------------------|--------------------|-------------------------------------|--------|---|-----------|---|-------------------|---|--------|---|-------|---|------------|--|--------------|---|--------------------|---------------------|
| NAME (LAST, FIRST, MIDDLE INITIAL)                             |                                     | TAYLOR AARON W     |                                     |        |   |           |   |                   |   |        |   |       |   |            |  |              |   |                    |                     |
| ADDRESS & PHONE #  |                                     | (4b)               |                                     |        |   | SEX       | M | D.O.B. (MMDDYYYY) |   | (4b)   |   |       |   |            |  |              |   |                    |                     |
| PASSENGER  | <input checked="" type="checkbox"/> | WITNESS            | <input type="checkbox"/>            | UNIT # | 1 | SEAT POS. | 3 | AIRBAG            | 1 | RESTR. | 1 | EJECT | 2 | HELMET USE |  | INJURY CLASS | 5 | NATURE OF INJURIES | OPEN FEMUR FRACTURE |
| NAME (LAST, FIRST, MIDDLE INITIAL)                             |                                     | SORENSEN CASSIDY A |                                     |        |   |           |   |                   |   |        |   |       |   |            |  |              |   |                    |                     |
| ADDRESS & PHONE #  |                                     | (4b)               |                                     |        |   | SEX       | M | D.O.B. (MMDDYYYY) |   | (4b)   |   |       |   |            |  |              |   |                    |                     |
| PASSENGER  | <input type="checkbox"/>            | WITNESS            | <input checked="" type="checkbox"/> | UNIT # |   | SEAT POS. |   | AIRBAG            |   | RESTR. |   | EJECT |   | HELMET USE |  | INJURY CLASS |   | NATURE OF INJURIES |                     |
| NAME (LAST, FIRST, MIDDLE INITIAL)                             |                                     | NASH NANCY E       |                                     |        |   |           |   |                   |   |        |   |       |   |            |  |              |   |                    |                     |
| ADDRESS & PHONE #  |                                     | (4b)               |                                     |        |   | SEX       | F | D.O.B. (MMDDYYYY) |   | (4b)   |   |       |   |            |  |              |   |                    |                     |
| PASSENGER  | <input type="checkbox"/>            | WITNESS            | <input checked="" type="checkbox"/> | UNIT # |   | SEAT POS. |   | AIRBAG            |   | RESTR. |   | EJECT |   | HELMET USE |  | INJURY CLASS |   | NATURE OF INJURIES |                     |

**NARRATIVE**

Veh 1 (1988 international farm truck-driver: Torres-Aranda) was driving southeast on a 92 Av NW (private rd) approaching BNSF railroad tracks located at DOT crossing # 84722N (MP 58.5). Torres-Aranda failed to stop at the posted stop sign and was struck by a southbound BNSF train. The truck was destroyed and pushed to the west of the railroad tracks. The box and tractor were separated. The train was able to come to safe stop. Torres-Aranda was dead at the scene and no one on the train was injured.

\*\*\*\* AUTO-POPULATED SECTION \*\*\*\*  
 THE FOLLOWING ARE DESCRIPTIONS ENTERED FOR ITEMS SELECTED AS "OTHER":  
 Motor Vehicle Unit 1  
 Traffic Control: RAILROAD CROSSING SIGN  
 \*\*\*\* END OF AUTO-POPULATED SECTION \*\*\*\*

I CERTIFY (DECLARE) UNDER PENALTY OF PERJURY UNDER THE LAWS OF THE STATE OF WASHINGTON THAT THE FOREGOING IS TRUE AND CORRECT. (RCW 9A.72.035)

|                                   |                   |                        |                     |
|-----------------------------------|-------------------|------------------------|---------------------|
| G. METCALF                        |                   | 09-28-16 02:05 PM      |                     |
| INVESTIGATING OFFICER'S SIGNATURE | UNIT OR DIST. DET | DATED                  | PLACE SIGNED        |
| APPROVED BY                       |                   | DATE                   |                     |
| A. KAHLER 1415                    |                   | 9/28/2016 2:08:17 PM   |                     |
| BADGE OR ID #                     | ORI #             | TIME POLICE DISPATCHED | TIME POLICE ARRIVED |
| 1319                              | WA0310000         | 6:15 PM                | 6:30 PM             |

**PART B** 3000-346-100 R (7/00)

PAGE 2 OF 5



STATE OF WASHINGTON  
 POLICE TRAFFIC  
 COLLISION REPORT



1591972

CORRECTION

REPORT NO. **E589327**

CASE # 2016-152909

| ADDITIONAL PERSONS INVOLVED (PASSENGERS AND/OR WITNESSES ONLY) |                          |             |                                     |        |  |           |  |        |   |                   |  |       |  |            |  |              |  |                    |
|--|--------------------------|-------------|-------------------------------------|--------|--|-----------|--|--------|---|-------------------|--|-------|--|------------|--|--------------|--|--------------------|
| NAME (LAST, FIRST, MIDDLE INITIAL)                             |                          | NASH GLEN A |                                     |        |  |           |  |        |   |                   |  |       |  |            |  |              |  |                    |
| ADDRESS & PHONE #  |                          | (4b)        |                                     |        |  |           |  | SEX    | M | D.O.B. (MMDDYYYY) |  | (4b)  |  |            |  |              |  |                    |
| PASSENGER  | <input type="checkbox"/> | WITNESS     | <input checked="" type="checkbox"/> | UNIT # |  | SEAT POS. |  | AIRBAG |   | RESTR.            |  | EJECT |  | HELMET USE |  | INJURY CLASS |  | NATURE OF INJURIES |
| NAME (LAST, FIRST, MIDDLE INITIAL)                             |                          |             |                                     |        |  |           |  |        |   |                   |  |       |  |            |  |              |  |                    |
| ADDRESS & PHONE #  |                          |             |                                     |        |  |           |  | SEX    |   | D.O.B. (MMDDYYYY) |  |       |  |            |  |              |  |                    |
| PASSENGER  | <input type="checkbox"/> | WITNESS     | <input type="checkbox"/>            | UNIT # |  | SEAT POS. |  | AIRBAG |   | RESTR.            |  | EJECT |  | HELMET USE |  | INJURY CLASS |  | NATURE OF INJURIES |
| NAME (LAST, FIRST, MIDDLE INITIAL)                             |                          |             |                                     |        |  |           |  |        |   |                   |  |       |  |            |  |              |  |                    |
| ADDRESS & PHONE #  |                          |             |                                     |        |  |           |  | SEX    |   | D.O.B. (MMDDYYYY) |  |       |  |            |  |              |  |                    |
| PASSENGER  | <input type="checkbox"/> | WITNESS     | <input type="checkbox"/>            | UNIT # |  | SEAT POS. |  | AIRBAG |   | RESTR.            |  | EJECT |  | HELMET USE |  | INJURY CLASS |  | NATURE OF INJURIES |

**NARRATIVE**

Veh 1 (1988 international farm truck-driver: Torres-Aranda) was driving southeast on a 92 Av NW (private rd) approaching BNSF railroad tracks located at DOT crossing # 84722N (MP 58.5). Torres-Aranda failed to stop at the posted stop sign and was struck by a southbound BNSF train. The truck was destroyed and pushed to the west of the railroad tracks. The box and tractor were separated. The train was able to come to safe stop. Torres-Aranda was dead at the scene and no one on the train was injured.

\*\*\*\* AUTO-POPULATED SECTION \*\*\*\*

THE FOLLOWING ARE DESCRIPTIONS ENTERED FOR ITEMS SELECTED AS "OTHER":

Motor Vehicle Unit 1

Traffic Control: RAILROAD CROSSING SIGN

\*\*\*\* END OF AUTO-POPULATED SECTION \*\*\*\*

I CERTIFY (DECLARE) UNDER PENALTY OF PERJURY UNDER THE LAWS OF THE STATE OF WASHINGTON THAT THE FOREGOING IS TRUE AND CORRECT. (RCW 9A.72.085)

|                                   |                   |                        |                     |
|-----------------------------------|-------------------|------------------------|---------------------|
| G. METCALF                        |                   | 09-28-16 02:05 PM      |                     |
| INVESTIGATING OFFICER'S SIGNATURE | UNIT OR DIST. DET | DATED                  | PLACE SIGNED        |
| APPROVED BY                       |                   | DATE                   |                     |
| A. KAHLER 1415                    |                   | 9/28/2016 2:08:17 PM   |                     |
| BADGE OR ID #                     | ORI #             | TIME POLICE DISPATCHED | TIME POLICE ARRIVED |
| 1319                              | WA0310000         | 6:15 PM                | 6:30 PM             |

PART B 3000-345-100 R (7/05)

PAGE 3 OF 5



SUPPLEMENTAL POLICE TRAFFIC COLLISION REPORT



013197

REPORT NO. E589327

CASE # 2016-152909

1 1 2 1 3 3 4 4a 5 0 6 2 7 8 9 10 11 12 13 14 15 16 17 18 19 20 21 22 23 24 25 26

|   |                         |   |   |
|---|-------------------------|---|---|
| <b>COMMERCIAL MOTOR CARRIER</b>   |                         | INTERSTATE <input checked="" type="checkbox"/>                                | INTRASTATE <input type="checkbox"/>     |
| UNIT #  | 1                       | USDOT   | 1886940                                 |
| ICC #   | 88                      | VEHICLE TYPE  | 3                                       |
| CARGO BODY TYPE   | 9                       |   |   |
| CARRIER NAME  | HUGHES FARMS INC        |   |   |
| CARRIER ADDRESS   | 13225 FARM TO MARKET RD |   |   |
| CITY  | MOUNT VERNON            | ST  | WA                                      |
| ZIP   | 98273                   |   |   |
| NAME SOURCE   | 1                       | # AXLES   | 03                                      |
| GVWR  | 48000                   | PLACARD   | <input type="checkbox"/>                |
| ADDITIONAL UNITS  |                         | NAME IF NO NUMBER   |   |
| UNIT #  |                         | MOTOR VEHICLE <input type="checkbox"/>  | PEDAL-CYCLE <input type="checkbox"/>    |
|   |                         | PEDESTRIAN <input type="checkbox"/>   | PROPERTY OWNER <input type="checkbox"/> |
|   |                         | DAMAGE THRESHOLD MET YES <input type="checkbox"/> NO <input type="checkbox"/> |   |
| LAST NAME   |                         | FIRST NAME  |   |
| STREET NEW ADDRESS  |                         | MIDDLE INITIAL  |   |
| CITY  |                         | ST  | ZIP                                     |
| CDL   | RESTRICTIONS            | ENDORSEMENTS  |   |
| DRIVER'S LICENSE #  | STATE                   | SEX   | D.O.B. MMDDYYYY                         |
| ON DUTY <input type="checkbox"/>  | STATUS                  | AIRBAG  | RESTR.                                  |
|   |                         | EJECT   | HELMET USE                              |
|   |                         | INJURY CLASS  | NATURE OF INJURIES                      |
| LICENSE PLATE #   | STATE                   | VIN#  |   |
| TRAILER PLATE #   | STATE                   | TRAILER PLATE #   | STATE                                   |
| VEH. YEAR   | MAKE                    | MODEL   | STYLE                                   |
|   |                         | VEHICLE TOWED YES <input type="checkbox"/> NO <input type="checkbox"/>        | TOWED BY                                |
| REGISTERED OWNER INFO.  |                         | GOVT. VEHICLE YES <input type="checkbox"/> NO <input type="checkbox"/>        |   |
| LIABILITY INSURANCE DEFECT <input type="checkbox"/>                               | INSURANCE CO & POLICY # | SHADE IN DAMAGED AREA   |   |
| VEHICLE LEGALLY STANDING YES <input type="checkbox"/> NO <input type="checkbox"/> | CITATION #              | CHARGE  |   |
| UNIT #  |                         | MOTOR VEHICLE <input type="checkbox"/>  | PEDAL-CYCLE <input type="checkbox"/>    |
|   |                         | PEDESTRIAN <input type="checkbox"/>   | PROPERTY OWNER <input type="checkbox"/> |
|   |                         | DAMAGE THRESHOLD MET YES <input type="checkbox"/> NO <input type="checkbox"/> |   |
| LAST NAME   |                         | FIRST NAME  |   |
| STREET NEW ADDRESS  |                         | MIDDLE INITIAL  |   |
| CITY  |                         | ST  | ZIP                                     |
| CDL   | RESTRICTIONS            | ENDORSEMENTS  |   |
| DRIVER'S LICENSE #  | STATE                   | SEX   | D.O.B. MMDDYYYY                         |
| ON DUTY <input type="checkbox"/>  | STATUS                  | AIRBAG  | RESTR.                                  |
|   |                         | EJECT   | HELMET USE                              |
|   |                         | INJURY CLASS  | NATURE OF INJURIES                      |
| LICENSE PLATE #   | STATE                   | VIN#  |   |
| TRAILER PLATE #   | STATE                   | TRAILER PLATE #   | STATE                                   |
| VEH. YEAR   | MAKE                    | MODEL   | STYLE                                   |
|   |                         | VEHICLE TOWED YES <input type="checkbox"/> NO <input type="checkbox"/>        | TOWED BY                                |
| REGISTERED OWNER INFO.  |                         | GOVT. VEHICLE YES <input type="checkbox"/> NO <input type="checkbox"/>        |   |
| LIABILITY INSURANCE DEFECT <input type="checkbox"/>                               | INSURANCE CO & POLICY # | SHADE IN DAMAGED AREA   |   |
| VEHICLE LEGALLY STANDING YES <input type="checkbox"/> NO <input type="checkbox"/> | CITATION #              | CHARGE  |   |

27 28 29 30 31 32 33 34 35 36 37 38 39 40 41 42

I CERTIFY (DECLARE) UNDER PENALTY OF PERJURY UNDER THE LAWS OF THE STATE OF WASHINGTON THAT THE FOREGOING IS TRUE AND CORRECT. (RCW 9A.72.085)

G. METCALF INVESTIGATING OFFICER'S SIGNATURE UNIT OR DIST DET 09-28-16 02:05 PM DATED: PLACE SIGNED

BADGE OR ID # 1319 ORI # WA0310000 APPROVED BY KAHLER DATE 9/28/2016 PAGE 4 OF 5

REPORT NO. E589327

CASE # 2016-152909

DATE AND TIME OF COLLISION 09/27/16 18:13

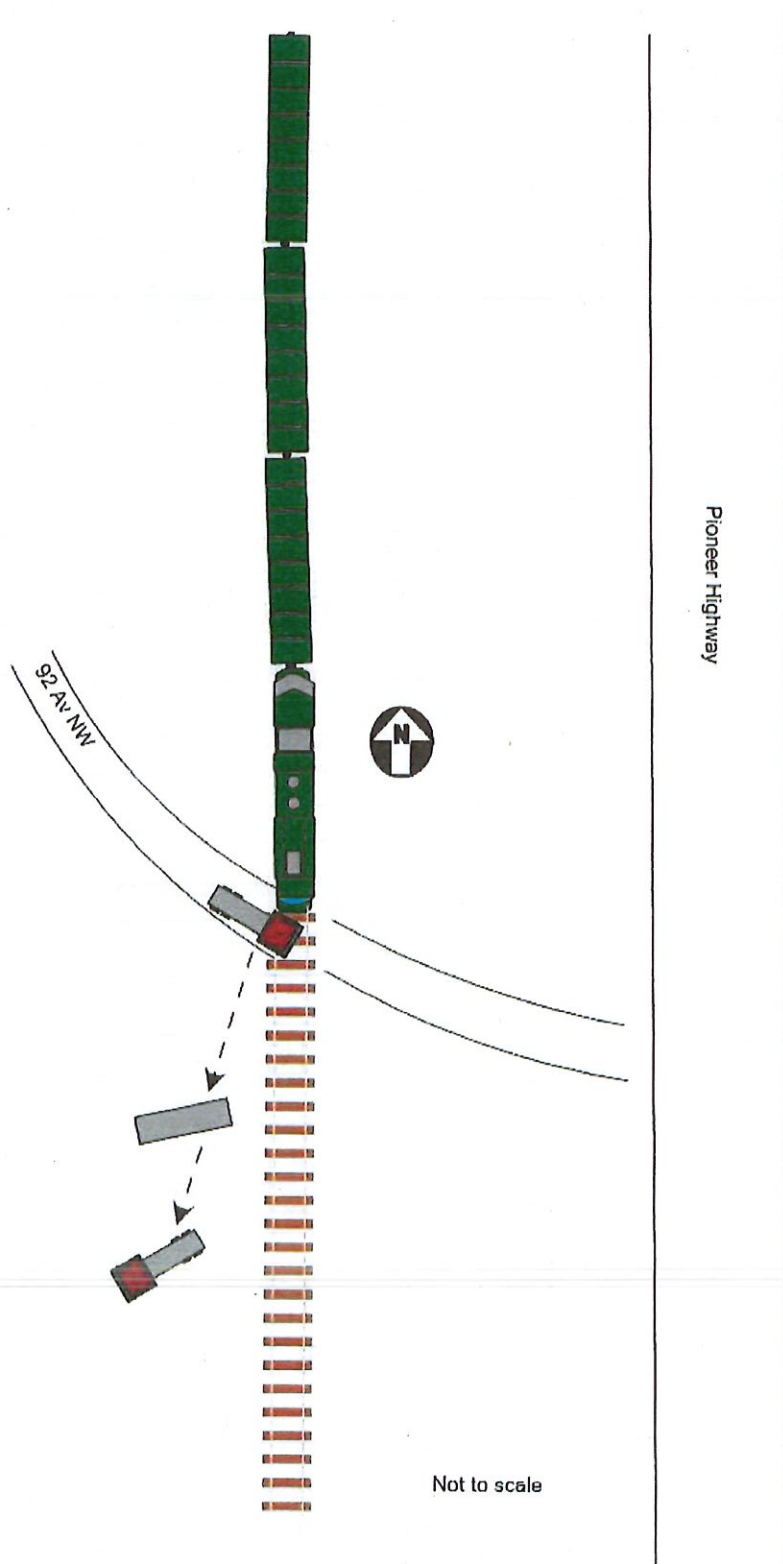



# SO2016-152909 RAW DATA MAP

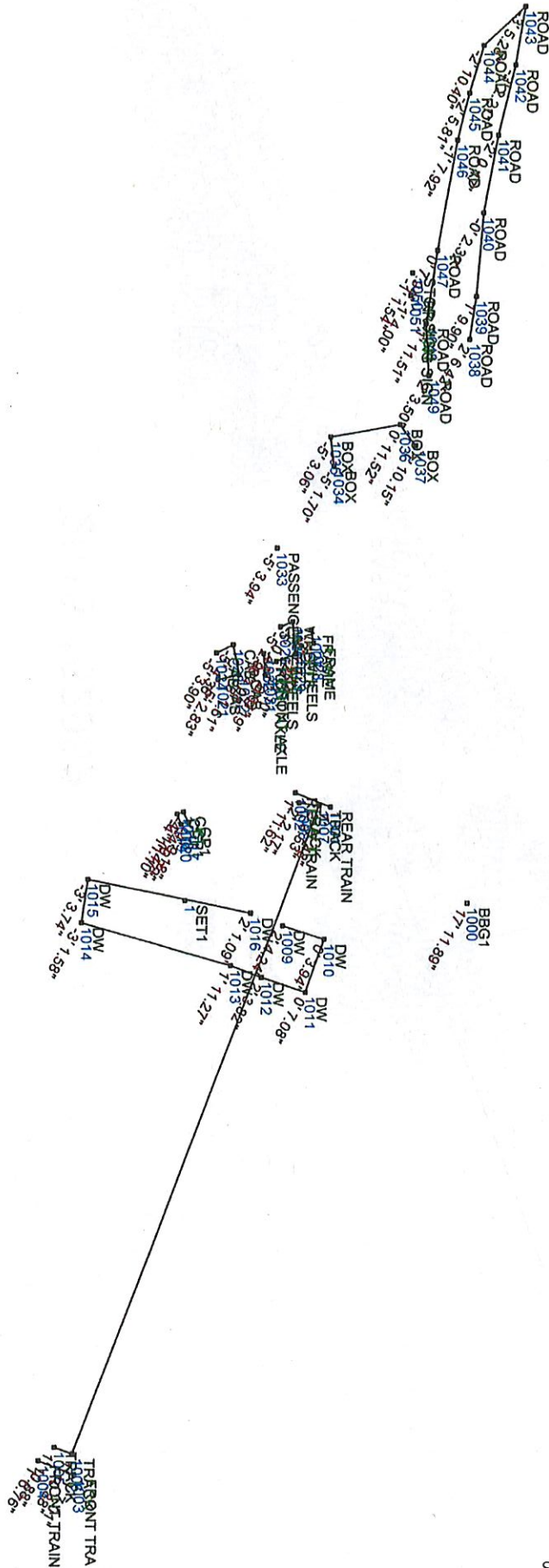

2016-152909



# SO2016-152909 STATEMENTS



## Snohomish County Sheriff's Office Statement Form

Case # 2016 - 152909

Statement of: Last Name: Olsen First: Mark Middle: Randall  
 DOB: \_\_\_\_\_ Race: \_\_\_\_\_ Hispanic: Y / N Sex: \_\_\_\_\_ Hgt: \_\_\_\_\_ Wgt: \_\_\_\_\_ Eye: \_\_\_\_\_ Hair: \_\_\_\_\_  
 Home Address: \_\_\_\_\_ City: \_\_\_\_\_ Zip: \_\_\_\_\_  
 P. O. Box Number: \_\_\_\_\_ City: \_\_\_\_\_ Zip: \_\_\_\_\_  
 Employer: BNSF City: \_\_\_\_\_  
 Home Phone: (4b) Work Phone: \_\_\_\_\_ Cell Phone: \_\_\_\_\_  
 E-mail Address: \_\_\_\_\_ Contact Phone: \_\_\_\_\_  
(Established Family Member or Friend)  
 Place statement taken (City): \_\_\_\_\_ Date: \_\_\_\_\_ Time: \_\_\_\_\_

Statement:

Heading south towards Stanwood and at  
app. MP 58.75 saw truck coming toward crossing  
kept continued to blow whistle truck didn't stop  
placed train in emergency and struck truck

I HAVE READ EACH PAGE OF THIS STATEMENT CONSISTING OF \_\_\_\_\_ PAGE(S).  
 I CERTIFY (OR DECLARE) UNDER PENALTY OF PERJURY UNDER THE LAWS OF THE STATE OF WASHINGTON  
 THAT THE ENTIRE STATEMENT IS TRUE AND CORRECT. \_\_\_\_\_ (initial)

Signature: [Signature]

Deputy: [Signature] # 1319 1 of 1



### Snohomish County Sheriff's Office Statement Form

Case # 2016 - 152909

Statement of: Last Name: Pratt First: BEN Middle: Conrad  
 DOB: (4b) Race: Caucasian Hispanic: Y  N Sex: M Hgt: 5'10" Wgt: 185 Eye: Brown Hair: Bald/brown  
 Home Address: \_\_\_\_\_ City: \_\_\_\_\_ Zip: \_\_\_\_\_  
 P. O. Box Number: \_\_\_\_\_ City: \_\_\_\_\_ Zip: \_\_\_\_\_  
 Employer: \_\_\_\_\_ City: \_\_\_\_\_  
 Home Phone: (4b) Work Phone: Same Cell Phone: \_\_\_\_\_  
 E-mail Address: \_\_\_\_\_ Contact Phone: Same  
(Established Family Member or Friend)  
 Place statement taken (City): Stanwood Date: 9-27-16 Time: 18:20

Statement:

operating a Southbound train, observed a farm truck  
approaching the crossing at approx M.P. 58.75 at a low rate of  
speed at which time the engineer was using the train whistle  
multiple times, the truck failed to stop and we hit the truck.

I HAVE READ EACH PAGE OF THIS STATEMENT CONSISTING OF \_\_\_\_\_ PAGE(S).  
 I CERTIFY (OR DECLARE) UNDER PENALTY OF PERJURY UNDER THE LAWS OF THE STATE OF WASHINGTON  
 THAT THE ENTIRE STATEMENT IS TRUE AND CORRECT. \_\_\_\_\_ (initial)

Signature: Ben Pratt Deputy: [Signature] # 1319 1 of 1



### Snohomish County Sheriff's Office Statement Form

Case # 2016 - 152909

Statement of: Last Name: Heigert First: Brett Middle: Dapheth  
 DOB: (4b) Race: White Hispanic: Y / N Sex: m Hgt: 6'0" Wgt: 185 Eye: Blue Hair: Brown  
 Home Address: \_\_\_\_\_ City: \_\_\_\_\_ Zip: \_\_\_\_\_  
 P. O. Box Number: \_\_\_\_\_ City: \_\_\_\_\_ Zip: \_\_\_\_\_  
 Employer: \_\_\_\_\_ City: \_\_\_\_\_  
 Home Phone: (4b) Work Phone: \_\_\_\_\_ Cell Phone: \_\_\_\_\_  
 E-mail Address: \_\_\_\_\_ Contact Phone: \_\_\_\_\_

Place statement taken (City): Stanwood WA (Established Family Member or Friend) Date: 09/27/16 Time: 1900

Statement:

Heading Southbound towards Stanwood. At around mp 58.75  
saw truck coming up toward crossing Engineer was blowing whistle  
saw truck still coming Engineer dumped the train, struck truck.

I HAVE READ EACH PAGE OF THIS STATEMENT CONSISTING OF \_\_\_\_\_ PAGE(S).  
 I CERTIFY (OR DECLARE) UNDER PENALTY OF PERJURY UNDER THE LAWS OF THE STATE OF WASHINGTON  
 THAT THE ENTIRE STATEMENT IS TRUE AND CORRECT. \_\_\_\_\_ (initial)

Signature: [Signature] Deputy: [Signature] # 189 1 of 1

SH-217 Rev. 2/2014

7E 706'2

0205 5x 6x 4x  
FX 2x 2x  
Brow  
Supt



# Snohomish County Sheriff's Office Statement Form

Incident # 2016-152909

First Name: AARON M: W Last: TAYLOR DOB: (4b)  
 Race: W Sex: M Hgt: (4b) Wgt: (4b) Eyes: (4b) Hair: (4b) Drivers License #: (4b) State WA  
 Home Address: (4b) City: (4b) State: WA Zip: (4b)  
 Place Statement Taken: HARBORVIEW MEDICAL CTR City: SEATTLE State: WA Zip: (4b)  
 Employer: HUGHES FARMS City: MT VERNON Best Number to Call:  Home  Cell   
 Work (4b)  
 Home Phone: (4b) Cell Phone: ( ) Work Phone: ( )  
 E-Mail Address: \_\_\_\_\_

STATEMENT: WE WERE DRIVING (JESUS WAS DRIVING) FROM THE FIELDS TO PICK UP MY PICKUP TRUCK. WE HAD MADE PROBABLY 15 LOADS FROM THAT FIELD THAT DAY. WE WERE APPROXIMATING THE TRUCKS AT 5-10 MPH, JESUS DID NOT STOP. JESUS NEVER LOOKED FOR TRAIL. I LOOKED AND SAW TRAIL IN THE MIRROR (DRIVERS OUTSIDE MIRROR) AND SAW THE LIGHTS OF THE TRAIL. I OPENED MY DOOR AND JUMPED FROM THE TRUCK. I REMEMBER WAKING UP AND PEOPLE HOLDING ME. I DID NOT HEAR ANY TRAIL WHISTLES.

THIS STATEMENT WAS WRITTEN FOR ME BY DET. MERRIS

END of statement  
AT

I have read each page of this statement consisting of \_\_\_\_\_ page(s). I certify (or declare) under penalty of perjury, under the laws of the State of Washington, that the entire statement is true and correct. (Initial) AT

Deputy Signature: G. Mestry Victim/Witness Signature: AT

Date: 10/07/16 Time: 0928 Place Signed: HARBORVIEW MEDICAL CTR Page 1 of \_\_\_\_\_



### Snohomish County Sheriff's Office Statement Form

Case # 2016-152909

Statement of: Last Name: Sorenson First: Cassidy Middle: Andrew  
 DOB: (4b) Race: Hispanic: Y / M Sex: M Hgt: 5-10 Wgt: 145 Eye: Blue Hair: Red  
 Home Address: (4b) City: (4b) Zip: (4b)  
 P. O. Box Number: \_\_\_\_\_ City: \_\_\_\_\_ Zip: \_\_\_\_\_  
 Employer: \_\_\_\_\_ City: \_\_\_\_\_  
 Home Phone: (4b) Work Phone: same Cell Phone: same  
 E-mail Address: (4b) Contact Phone: (4b)  
 Place statement taken (City): Stanwood (Established Family Member or Friend)  
 Date: 9-27-16 Time: 18:40

Statement:

Traveling south on Pioneer Valley Hwy, ~~over~~ slowly over  
taking the train. As I was 10ft ahead of the train  
they began blowing their horn, one long, two shorts, a long  
and then a constant horn. At the second long I noticed  
a Red truck approaching a private crossing. He didn't  
slow and the train impacted the truck just behind  
the cab. The truck was crossing from the farm towards  
Pioneer Valley Hwy at a 45° angle.

I stopped, called 911 and offered assistance.

I HAVE READ EACH PAGE OF THIS STATEMENT CONSISTING OF 1 PAGE(S).  
 I CERTIFY (OR DECLARE) UNDER PENALTY OF PERJURY UNDER THE LAWS OF THE STATE OF WASHINGTON  
 THAT THE ENTIRE STATEMENT IS TRUE AND CORRECT. C.S. (initial)

Signature: \_\_\_\_\_  
SH-217 Rev. 2/2014

Deputy: \_\_\_\_\_

# 1319 1 of 1



**Snohomish County Sheriff's Office  
Statement Form**

Case # 2016-152909

Statement of: Last Name: Nash First: Nancy Middle: E  
 DOB: (4b) Race: Hispanic: Y Sex: F Hgt: 5'3" Wgt: 123 Eye: green Hair: Brown  
 Home Address: (4b) City: (4b) Zip: (4b)  
 P. O. Box Number: \_\_\_\_\_ City: \_\_\_\_\_ Zip: \_\_\_\_\_  
 Employer: \_\_\_\_\_ City: \_\_\_\_\_  
 Home Phone: (4b) Work Phone: \_\_\_\_\_ Cell Phone: (4b)  
 E-mail Address: (4b) Contact Phone: (4b)  
(Established Family Member or Friend)  
 Place statement taken (City): \_\_\_\_\_ Date: \_\_\_\_\_ Time: \_\_\_\_\_

Statement:

We had just crossed the railroad tracks coming from old Hwy 99 and turned left on to Pioneer Hwy. A large works truck / vehicle ~~started~~ across the tracks on the west side. It crossed right in front of a oncoming train heading South. The vehicle was thrown into the air. My husband Glen Nash and I stopped and called 911. We then turned around to see if we could assist if there were any survivors. We assessed the best we could the one survivor. (Aaron?) Staying with him until emergency help showed up.

I HAVE READ EACH PAGE OF THIS STATEMENT CONSISTING OF 1 PAGE(S).  
 I CERTIFY (OR DECLARE) UNDER PENALTY OF PERJURY UNDER THE LAWS OF THE STATE OF WASHINGTON THAT THE ENTIRE STATEMENT IS TRUE AND CORRECT. N.N (initial)

Signature: Nancy Nash Deputy: [Signature] # 1319 1 of 1  
 SH-217 Rev. 2/2014





Snohomish County Sheriff's Office  
Statement Form

Case # 2016 - 152909

Statement of: Last Name: NASH First: GEN Middle: A.  
DOB: (4b) Race: CAJ Hispanic: Y / N Sex: M Hgt: 5'9" Wgt: 185 Eye: BLU Hair: BROWN  
Home Address: (4b) City: (4b) Zip: (4b)  
P. O. Box Number: (4b) City: \_\_\_\_\_ Zip: \_\_\_\_\_  
Employer: (4b) City: STANWOOD, WA  
Home Phone: (4b) Work Phone: \_\_\_\_\_ Cell Phone: \_\_\_\_\_  
E-mail Address: (4b) Contact Phone: SAME  
(Established Family Member or Friend)  
Place statement taken (City): STANWOOD Date: SEPT. 27, 16 Time: 6:50 PM

Statement:

I WAS DRIVING NORTH BOUND ON PIONEER HWY. AND LOOKED WEST AS THE POTATOE TRUCK WAS COMING UP ON THE TRACKS. IT CAME DIRECTLY INTO CENTER OF TRACKS AS TRAIN W/PACKED IT. THE CAB FLEW INTO THE AIR AND WAS LOST TO SIGHT AS TRAIN WENT PAST CROSSING.

I WENT 1/4 MILE DOWN ROAD AND PARKED TO CALL 911. MADE BRIEF REPORT AND CAME BACK TO SCENE.

MY WIFE NANCY AND I PARKED AND WENT TO AID WHERE NEEDED. AARON WAS ON THE GROUND WITH 2 MEN OVER HIM. THERE WAS ONE PERSON IN THE CAB THAT DID NOT NEED OUR HELP.

AARON RESPONDED TO OUR QUESTIONS. HE WAS OR HAD A PULSE OF 60 PER. MIN. HIS EYES WERE 'NORMAL'. WE COVERED HIM AND WAITED FOR EMT'S.

Gen Nash

I HAVE READ EACH PAGE OF THIS STATEMENT CONSISTING OF \_\_\_\_\_ PAGE(S).  
I CERTIFY (OR DECLARE) UNDER PENALTY OF PERJURY UNDER THE LAWS OF THE STATE OF WASHINGTON THAT THE ENTIRE STATEMENT IS TRUE AND CORRECT. GN (initial)

Signature: Gen Nash

Deputy: [Signature]

# 1319 1 of 1

# SO2016-152909 DRAWINGS

Train stopped approx 1102 feet from impact

Drawn by Det G. Metcalf #1319  
Collision Investigation Unit  
Snohomish County Sheriff's Office  
Collision Date: 09-27-16



## 2016-152909

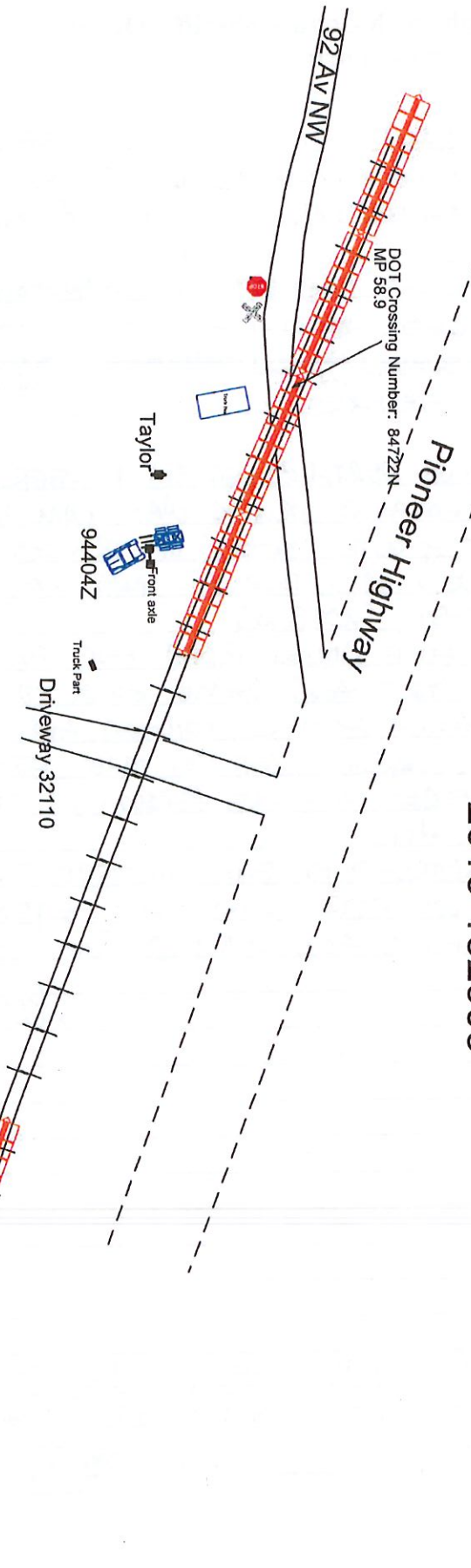

Train Information:

- Speed: 42 mph from EDR
- # of Cars: 70 (3 locomotives)
- Length: 4639 feet
- Weight: 5131 tons
- Conductor: Ben Pratt
- Engineer: Mark Olson
- Brakeman: Brett Heigart

Engine # BNSF2620  
1195.5 feet to front of train  
Measured with engineer roller wheel

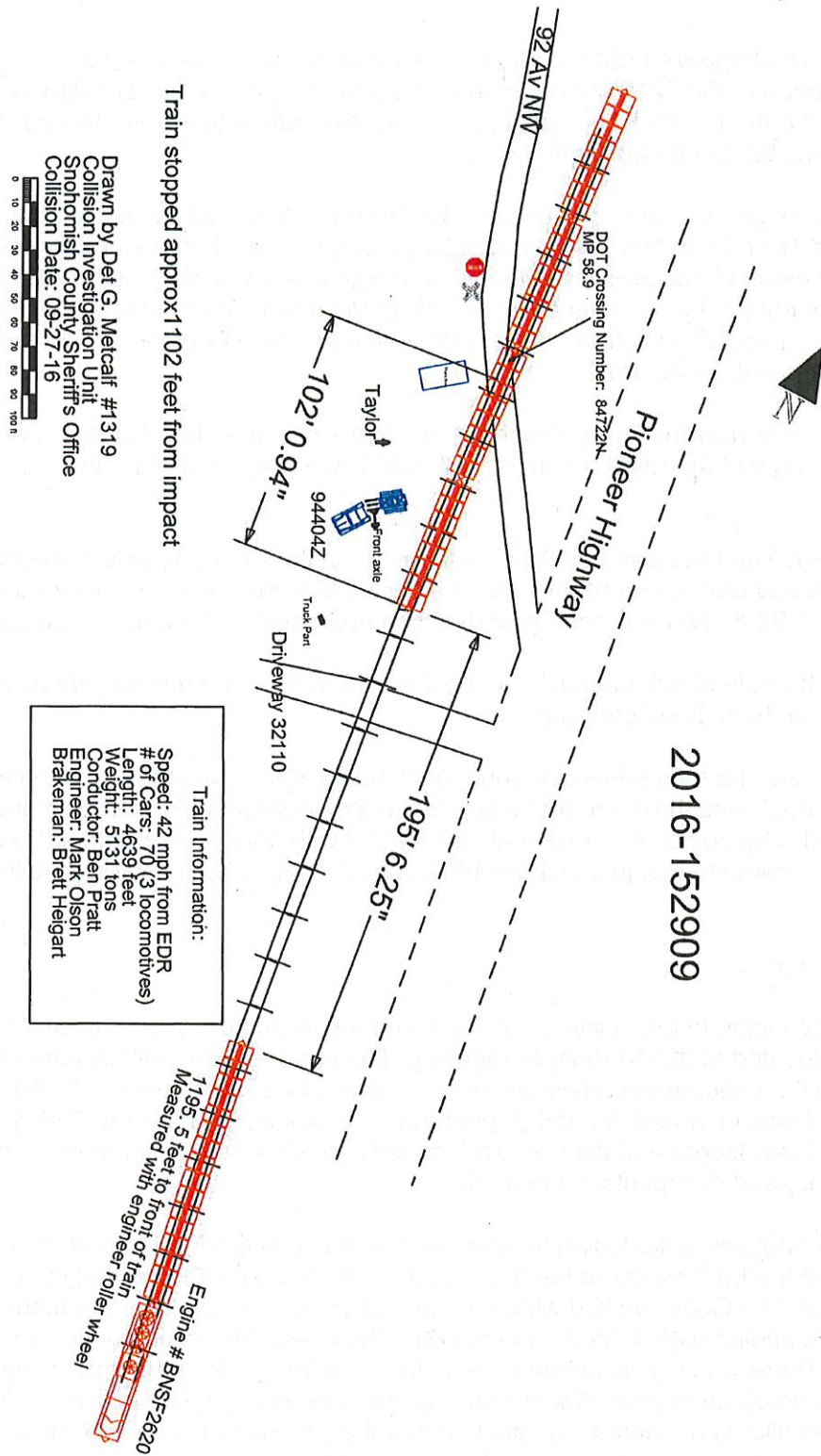

**OfficerID: so1319, Narrative**

On 09-27-16 at approx 1830 hrs, Sgt Kahler contacted me via telephone and asked for me to respond to the 32100 Blk of Pioneer Hwy for a reported fatality collision involving a truck and a train. Sgt Kahler assigned me as the lead detective for this case. On arrival, I was briefed by Sgt Kahler.

I walked through the scene and observed a farm type truck with extensive damage on the west side of the tracks. There was a large farm box that had separated from the truck as a result of the collision. There was a large amount of potatoes on the ground located all around the box over to 92 Av NW to the north. The train was stopped and had been separated by railroad personnel to allow medical personnel to attend to the injured occupants of the truck.

**Collision Description:** This collision occurred at a private railroad crossing on 92 Av NW at MP 58.9 of the BNSF main line. The DOT crossing number for the crossing is 84722N.

**Pre-Impact:** The train was traveling southbound on the BNSF main line approaching a private railroad crossing at 92 Av NW. The truck (driven by Jesus Torres-Aranda) was traveling on 92 Av NW in a southeast direction approaching the railroad crossing.

**Impact:** The train struck the truck just behind the cab on the drivers side as it crossed the tracks at the railroad crossing.

**Post-Impact:** The train continued south until the conductor was able to bring it to a stop. The truck was thrown to a grassy area to the southwest of the impact area facing westbound. The box on the truck that was loaded with potatoes separated from the vehicle and came to rest just to the southwest of the impact area spilling the load of potatoes.

**Investigation:**

I asked Det Goffin to take pictures of the scene. I saw that the train was separated at a driveway located at 32110 Pioneer Highway. The engines with multiple cars was located to the south of the driveway and the rest was located to the north of the driveway. I was informed that BNSF personnel ( Division Train Master: Elgin S. Hawkins 425-212-8744 ) separated the train and moved it to allow medical personnel to provide aid to the injured occupants of the truck.

I used my engineer roller wheel to measure the length of the front part of the train from the back of the last box car to the front engine. The length of that part of the train was 1195.5 feet. Det Goffin walked with me and took pictures of the damage to the lead locomotive engine (BNSF#2620) of the train. There were three locomotive engines for the train. There was significant damage to the right front side of the engine and down the right side of the engine as well. Damage included multiple broken air line fittings, a broken fuel filler cap, dented fuel tanks and broken and bent railings down the right side of the engine. Det Goffin documented the damage with pictures. He also returned to the

scene on 09-28-16 and took daytime photos.

I contacted the conductor Ben Pratt and obtained information on the train. He told me the engineer was Mark Olson and the brakeman was Brett Heigert. He said he thought the train was traveling at 40-45 mph at the time of the collision. The Event Data Recorder (EDR) for the train showed the speed of the train at 42 mph. He said he they were able to stop the train in approx. 600-700 feet. There were 70 cars on the train including three locomotive/engines. The length of the train was 4639 feet with a tonnage of 5131 tons of weight. Pratt said he saw the truck approaching the track at a slow speed. He said the engineer was using the train's whistle at the time but the truck failed to stop and the train struck the truck.

The train's engineer was identified as Mark Olson. Olson said as the train was traveling southbound and he saw the truck approaching the railroad crossing in front of them. He said he continued to blow the train's whistle but the truck did not stop so he placed the train into emergency status to stop the train but the train hit the truck.

The truck was down into a grass field at 32110 Pioneer Highway. The driver, later identified as Jesus Torres-Aranda, was still inside of the passenger compartment of the truck. There was extensive damage to the truck. The front axle was broken and separated from the truck. There was a large dent behind the cab of the truck indicative of impact from the train. The driver's seat was shoved forward towards the front of the vehicle from the train impact. Torres-Aranda's head and upper torso was located through the front windshield of the truck. The truck's frame was twisted and separated from the cab. The box that the truck had been carrying loaded with potatoes disengaged from the truck and was located to the north of the truck. Most of the potato load was dumped on the ground between the box and the point of impact. There was debris from the truck located on the ground around the vehicle as well as further south of the truck's final resting point.

A passenger of the truck, later identified as Aaron Taylor, was transported to Providence Colby Campus prior to my arrival. His approximate location was marked in the grassy area between the truck and the box.

Det Monson and I set up the VX Spatial station and mapped the scene. I manned the prism pole while Det Monson entered the information into the data collector. We mapped the scene including the vehicle locations, roadway, truck parts and the location of Taylor on the ground. I later downloaded the information from the data collector at my office and created a scale drawing of the scene. I was able to determine that the two parts of the train were approx 195 1/2 feet apart on the tracks after being separated. The distance from the point of impact to the front portion of the separated back part of the train was approx 102 feet. If I take into account the separated portion of the train, the distance from point of impact and the length of the front portion of the train (1195.5 feet), I can conclude that the train was able to stop in approx 1102 feet from the point of impact.

The truck came to rest approx 89 feet to the southwest from the point of impact. The box of the truck came to rest approx 16 feet southwest of the point of impact. Taylor was located between the box and cab of the truck approx 52 feet from the point of impact.

Witness Glen Nash said he and his wife Nancy were driving northbound on Pioneer Highway and looked to the west and he saw Torres-Aranda approaching the railroad crossing in the potato truck. He said the truck drove right onto the center of the tracks and was hit by the train. He said the truck flew into the air and then he lost sight of the truck as the train passed by. He said he stopped approx 1/4 mile down the road and called 9-1-1 and then went back to the scene. He said he provided aid to Taylor. He said he saw Torres-Aranda still in the cab of the truck.

Witness Cassidy Sorenson said he driving southbound on Pioneer Highway and was slowly overtaking the BNSF train. He said just as he was passing the train, he heard the trains horn blowing (one long, two short, one long and then a constant horn). He said he saw a red truck (Torres-Aranda) approaching the private railroad crossing at a 45 degree angle . He said Torres-Aranda did not stop and the train hit the truck just behind the cab.

Investigators (Chelsea Warneke and Lauren Alvarez) from the Snohomish County Medical Examiner's Office responded to the scene to conduct their preliminary investigation. They took pictures and obtained information from me in reference to the train. Torres-Aranda's son, Jesus Torres-Velazquez (4b) (4b), was on scene. The ME investigators contacted Torres-Velazquez and turned over his fathers personal property to him. They took custody of Torres-Aranda's body and transported him to the medical examiner's office. The ME case number is 16SN1732.

09-28-16- I contacted Providence Hospital to check on the status of Taylor and was informed that he had been transferred to Harborview Medical Center for treatment of his injuries. I contacted Harborview Medical Center, Taylor was in surgery and would not be available for an interview for several days.

10-06-16- I was contacted Andrew Day (BNSF), Senior Claims Representative. He was requesting information on Taylor. He also stated that there was video from the train and he would make that available next week if I wanted to view it. (scheduled for 10-11-16 at 1230 hrs).

10-07-16- I responded to Harborview Medical Center and contacted Taylor on the trauma ward and obtained a statement from him. Taylor said Jesus Torres-Aranda was driving the truck from the fields (he said they had made approx 15 loads from that field that day) located to the west of the tracks. He said they were approaching the tracks at 5-10 mph. He said Torres-Aranda never stopped and never looked back to see if a train was coming. Taylor said he looked across into the drivers side outside mirror and saw the lights of the train approaching their location. He said he opened the door of the truck

and jumped. He said he remembered waking up and people were around him helping him. He said he did not remember hearing any whistles from the train. Based on the location of Taylor post collision (52 feet from impact), I think he decided he wanted to jump from the truck and started to open the door but the train struck the truck first and he was then ejected from the truck.

10-11-16- Day came to my office to let me view the video from engine BNSF2620. I watched the video which showed Torres-Aranda approaching the train crossing from the northwest at a slow speed (consistent with 5-10 mph reported by Taylor). The video confirms that Torres-Aranda never stopped at the posted stop sign/railroad crossing signs before starting over the tracks. I could hear the train whistle which was required by signal boards located on the side of the tracks prior to railroad crossings. I could hear the escape of air from the engine just prior to the collision which is consistent with the train being placed in emergency status. I then heard the brakes on the train engage just after the collision. Day told me the maximum speed for the train on the tracks in that area is 60 mph. He told me the train was already slowing down prior to the collision because it was due to go on a side track prior to Stan wood to allow another train to pass. Per BNSF policy, they do not make copies of the video, however, the copy of the video is secured by BNSF if further litigation is necessary.

11-14-16- I received a copy of the autopsy results on Torres-Aranda. The autopsy revealed multiple blunt force injuries to the torso, head and extremities for Torres-Aranda. His toxicology results were all negative for drugs and alcohol.

**Weather:** The weather at the time of the collision was clear with a temperature around 60 degrees.

**Roadway Description:** The BNSF tracks run generally from north to south in the area of the collision. The tracks are marked with the standard railroad signage.

92 Av NW is a private gravel road which runs from northwest to southeast in the area of the collision as it approaches the private railroad crossing just to the west of Pioneer Highway. The road runs at an approx 45 degree angle as it approaches the railroad crossing. The railroad crossing has a posted stop sign (approx 44 feet from the tracks) and a railroad crossing sign (approx 34 feet from the tracks).

**Causation/Conclusion:** The cause of this collision is Torres-Aranda failed to stop at the posted stop sign and railroad crossing sign at 92 Av NW and DOT crossing 84722N. He failed to yield to the train and was struck by the southbound BNSF train.

EOR

George Metcalf #1319





**SO Case, Officer: so1319, Supervisor: so1415, Merged By: so4341**

|   |                                    |
|---|------------------------------------|
|  <p><b>SNOHOMISH COUNTY SHERIFF'S OFFICE</b><br/>3000 Rockefeller Ave<br/>Everett, WA 98021<br/>(425) 388-3523</p> | <b>Initial Case Report</b>         |
|   | Case Report # <b>2016-00152909</b> |

|              |   |  |                  |
|--------------|---|--|------------------|
| <b>EVENT</b> | OCCURRED INCIDENT TYPE<br><b>Collision</b>                                | DATE/TIME REPORTED<br><b>9/27/2016 18:13</b> | ASSOCIATED CASES |
|              | LOCATION OF OCCURRENCE<br><b>32100 PIONEER HWY<br/>STANWOOD, WA 98292</b> | OCCURRED DATE/TIME<br><b>9/27/2016 18:13</b> |                  |
|              |   | OCCURRED THROUGH<br><b>9/27/2016 20:30</b>   |                  |

|                 |                       |        |                |
|-----------------|-----------------------|--------|----------------|
| <b>OFFENSES</b> | STATUTE / DESCRIPTION | Counts | Attempt/Commit |
|                 |                       |        |                |
|                 |                       |        |                |

|                |   |   |                       |                      |                                |                   |
|----------------|---|---|-----------------------|----------------------|--------------------------------|-------------------|
| <b>SUBJECT</b> | <input type="checkbox"/> NON-DISCLOSURE |   |                       |                      |                                |                   |
|                | SUBJECT TYPE<br><b>Deceased</b>         | NAME<br><b>Adult / TORRES-ARANDA, JESUS</b> |                       |                      | DOB / AGE RANGE<br><b>(4b)</b> |                   |
|                | ADDRESS<br><b>(4b)</b>                  |   |                       |                      | PRIMARY PHONE<br><b>(4b)</b>   |                   |
|                | SECONDARY PHONE                         |   |                       |                      |                                |                   |
|                | RACE<br><b>White</b>                    | SEX<br><b>Male</b>                          | HEIGHT<br><b>5' 8</b> | WEIGHT<br><b>210</b> | HAIR<br><b>BLK</b>             | EYE<br><b>BRO</b> |
|                | DL NUMBER<br><b>(4b)</b>                | DL STATE<br><b>WA</b>                       | EMPLOYER              |                      |                                |                   |

43G Driver's license or permit number

|                |   |  |                        |                      |                                |                   |
|----------------|---|--|------------------------|----------------------|--------------------------------|-------------------|
| <b>SUBJECT</b> | <input type="checkbox"/> NON-DISCLOSURE |  |                        |                      |                                |                   |
|                | SUBJECT TYPE<br><b>Passenger</b>        | NAME<br><b>Adult / TAYLOR, AARON WILLIAM</b> |                        |                      | DOB / AGE RANGE<br><b>(4b)</b> |                   |
|                | ADDRESS<br><b>(4b)</b>                  |  |                        |                      | PRIMARY PHONE<br><b>(4b)</b>   |                   |
|                | SECONDARY PHONE                         |  |                        |                      |                                |                   |
|                | RACE<br><b>White</b>                    | SEX<br><b>Male</b>                           | HEIGHT<br><b>5' 10</b> | WEIGHT<br><b>185</b> | HAIR<br><b>BRO</b>             | EYE<br><b>BLU</b> |
|                | DL NUMBER<br><b>(4b)</b>                | DL STATE                                     | EMPLOYER               |                      |                                |                   |

43G Driver's license or permit number

|                |   |                     |                                 |
|----------------|---|---------------------|---------------------------------|
| <b>VEHICLE</b> | PROPERTY CODE<br><b>Destroy Damage Vand</b> | YEAR<br><b>1988</b> | COLOR<br><b>Brown</b>           |
|                | TYPE / <b>Automobile</b>                    |                     |                                 |
|                | MAKE / <b>International Inds., Inc.</b>     | MODEL /             |                                 |
|                | PLATE<br><b>94404Z</b>                      | STATE<br><b>WA</b>  | VIN<br><b>1HTLKDBR6JH514337</b> |

|                 |               |                     |         |       |
|-----------------|---------------|---------------------|---------|-------|
| <b>PROPERTY</b> | PROPERTY CODE |                     |         |       |
|                 | SERIAL NUMBER | QTY/UNIT OF MEASURE | VALUE   | COLOR |
|                 | TYPE /        |                     |         |       |
|                 | MAKE /        |                     | MODEL / |       |

|   |   |
|---|---|
| REPORTING OFFICER / ID #<br><b>Metcalf, George M 1319</b> | APPROVING SUPERVISOR<br><b>Kahler, Andrew J</b> |
|---|---|

Complete report details do not print in this format.

|   |                                    |
|---|------------------------------------|
|  <b>SNOHOMISH COUNTY SHERIFF'S OFFICE</b><br>3000 Rockefeller Ave<br>Everett, WA 98021<br>(425) 388-3523 | <b>Initial Case Report</b>         |
|   | Case Report # <b>2016-00152909</b> |

**ADDITIONAL SUBJECTS**

|  |   |                                 |             |            |            |                 |  |
|--|---|---------------------------------|-------------|------------|------------|-----------------|--|
| <b>SUBJECT</b>                                       | <input type="checkbox"/> NON-DISCLOSURE |                                 |             |            |            |                 |  |
|  | SUBJECT TYPE                            | NAME                            |             |            |            | DOB / AGE RANGE |  |
|  | <b>Witness</b>                          | <b>Adult / NASH, GLEN ALLAN</b> |             |            |            | <b>(4b)</b>     |  |
|  | ADDRESS                                 |                                 |             |            |            | PRIMARY PHONE   |  |
|  | <b>(4b)</b>                             |                                 |             |            |            | <b>(4b)</b>     |  |
|  |   |                                 |             |            |            | SECONDARY PHONE |  |
| RACE   |   | SEX                             | HEIGHT      | WEIGHT     | HAIR       | EYE             |  |
| <b>White</b>   |   | <b>Male</b>                     | <b>5' 9</b> | <b>180</b> | <b>BRO</b> | <b>BLU</b>      |  |
| DL NUMBER  |   | DL STATE                        |             | EMPLOYER   |            |                 |  |
| <small>43G Driver's license or permit number</small> |   | <b>WA</b>                       |             |            |            |                 |  |

|  |   |                                  |             |            |            |                 |  |
|--|---|----------------------------------|-------------|------------|------------|-----------------|--|
| <b>SUBJECT</b>                                       | <input type="checkbox"/> NON-DISCLOSURE |                                  |             |            |            |                 |  |
|  | SUBJECT TYPE                            | NAME                             |             |            |            | DOB / AGE RANGE |  |
|  | <b>Witness</b>                          | <b>Adult / NASH, NANCY ELLEN</b> |             |            |            | <b>(4b)</b>     |  |
|  | ADDRESS                                 |                                  |             |            |            | PRIMARY PHONE   |  |
|  | <b>(4b)</b>                             |                                  |             |            |            | <b>(4b)</b>     |  |
|  |   |                                  |             |            |            | SECONDARY PHONE |  |
| RACE   |   | SEX                              | HEIGHT      | WEIGHT     | HAIR       | EYE             |  |
| <b>White</b>   |   | <b>Female</b>                    | <b>5' 3</b> | <b>120</b> | <b>BRO</b> | <b>GRN</b>      |  |
| DL NUMBER  |   | DL STATE                         |             | EMPLOYER   |            |                 |  |
| <small>43G Driver's license or permit number</small> |   | <b>WA</b>                        |             |            |            |                 |  |

|  |   |                              |        |          |      |                 |  |
|--|---|------------------------------|--------|----------|------|-----------------|--|
| <b>SUBJECT</b>                                       | <input type="checkbox"/> NON-DISCLOSURE |                              |        |          |      |                 |  |
|  | SUBJECT TYPE                            | NAME                         |        |          |      | DOB / AGE RANGE |  |
|  | <b>Other Involved</b>                   | <b>Adult / OLSON, MARK R</b> |        |          |      | <b>(4b)</b>     |  |
|  | ADDRESS                                 |                              |        |          |      | PRIMARY PHONE   |  |
|  | <b>(4b)</b>                             |                              |        |          |      | <b>(4b)</b>     |  |
|  |   |                              |        |          |      | SECONDARY PHONE |  |
| RACE   |   | SEX                          | HEIGHT | WEIGHT   | HAIR | EYE             |  |
| <b>White</b>   |   | <b>Male</b>                  |        |          |      |                 |  |
| DL NUMBER  |   | DL STATE                     |        | EMPLOYER |      |                 |  |
| <small>43G Driver's license or permit number</small> |   | <b>WA</b>                    |        |          |      |                 |  |

|  |   |   |              |            |            |                 |  |
|--|---|---|--------------|------------|------------|-----------------|--|
| <b>SUBJECT</b>                                       | <input type="checkbox"/> NON-DISCLOSURE |   |              |            |            |                 |  |
|  | SUBJECT TYPE                            | NAME                                    |              |            |            | DOB / AGE RANGE |  |
|  | <b>Witness</b>                          | <b>Adult / SORENSEN, CASSIDY ANDREW</b> |              |            |            | <b>(4b)</b>     |  |
|  | ADDRESS                                 |   |              |            |            | PRIMARY PHONE   |  |
|  | <b>(4b)</b>                             |   |              |            |            | <b>(4b)</b>     |  |
|  |   |   |              |            |            | SECONDARY PHONE |  |
| RACE   |   | SEX                                     | HEIGHT       | WEIGHT     | HAIR       | EYE             |  |
| <b>White</b>   |   | <b>Male</b>                             | <b>5' 10</b> | <b>170</b> | <b>BRO</b> | <b>BLU</b>      |  |
| DL NUMBER  |   | DL STATE                                |              | EMPLOYER   |            |                 |  |
| <small>43G Driver's license or permit number</small> |   | <b>WA</b>                               |              |            |            |                 |  |

|  |   |                                       |              |            |            |                 |  |
|--|---|---------------------------------------|--------------|------------|------------|-----------------|--|
| <b>SUBJECT</b>                                       | <input type="checkbox"/> NON-DISCLOSURE |                                       |              |            |            |                 |  |
|  | SUBJECT TYPE                            | NAME                                  |              |            |            | DOB / AGE RANGE |  |
|  | <b>Other Involved</b>                   | <b>Adult / PRATT, BENJAMIN CONRAD</b> |              |            |            | <b>(4b)</b>     |  |
|  | ADDRESS                                 |                                       |              |            |            | PRIMARY PHONE   |  |
|  | <b>(4b)</b>                             |                                       |              |            |            | <b>(4b)</b>     |  |
|  |   |                                       |              |            |            | SECONDARY PHONE |  |
| RACE   |   | SEX                                   | HEIGHT       | WEIGHT     | HAIR       | EYE             |  |
| <b>White</b>   |   | <b>Male</b>                           | <b>5' 10</b> | <b>175</b> | <b>BRO</b> | <b>BRO</b>      |  |
| DL NUMBER  |   | DL STATE                              |              | EMPLOYER   |            |                 |  |
| <small>43G Driver's license or permit number</small> |   | <b>WA</b>                             |              |            |            |                 |  |

|                          |             |                         |
|--------------------------|-------------|-------------------------|
| REPORTING OFFICER / ID # | <b>1319</b> | APPROVING SUPERVISOR    |
| <b>Metcalf, George M</b> |             | <b>Kahler, Andrew J</b> |

Complete report details do not print in this format.

|   |                                    |
|---|------------------------------------|
|  <b>SNOHOMISH COUNTY SHERIFF'S OFFICE</b><br>3000 Rockefeller Ave<br>Everett, WA 98021<br>(425) 388-3523 | <b>Initial Case Report</b>         |
|   | Case Report # <b>2016-00152909</b> |

**NARRATIVE**

On 09-27-16 at approx 1830 hrs, Sgt Kahler contacted me via telephone and asked for me to respond to the 32100 Blk of Pioneer Hwy for a reported fatality collision involving a truck and a train. Sgt Kahler assigned me as the lead detective for this case. On arrival, I was briefed by Sgt Kahler.

I walked through the scene and observed a farm type truck with extensive damage on the west side of the tracks. There was a large farm box that had separated from the truck as a result of the collision. There was a large amount of potatoes on the ground located all around the box over to 92 Av NW to the north. The train was stopped and had been separated by railroad personnel to allow medical personnel to attend to the injured occupants of the truck.

**Collision Description:** This collision occurred at a private railroad crossing on 92 Av NW at MP 58.9 of the BNSF main line. The DOT crossing number for the crossing is 84722N.

**Pre-Impact:** The train was traveling southbound on the BNSF main line approaching a private railroad crossing at 92 Av NW. The truck (driven by Jesus Torres-Aranda) was traveling on 92 Av NW in a southeast direction approaching the railroad crossing.

**Impact:** The train struck the truck just behind the cab on the drivers side as it crossed the tracks at the railroad crossing.

**Post-Impact:** The train continued south until the conductor was able to bring it to a stop. The truck was thrown to a grassy area to the southwest of the impact area facing westbound. The box on the truck that was loaded with potatoes separated from the vehicle and came to rest just to the southwest of the impact area spilling the load of potatoes.

**Investigation:**

I asked Det Goffin to take pictures of the scene. I saw that the train was separated at a driveway located at 32110 Pioneer Highway. The engines with multiple cars was located to the south of the driveway and the rest was located to the north of the driveway. I was informed that BNSF personnel ( Division Train Master: Elgin S. Hawkins 425-212-8744 ) separated the train and moved it to allow medical personnel to provide aid to the injured occupants of the truck.

I used my engineer roller wheel to measure the length of the front part of the train from the back of the last box car to the front engine. The length of that part of the train was 1195.5 feet. Det Goffin walked with me and took pictures of the damage to the lead locomotive engine (BNSF#2620) of the train. There were three locomotive engines for the train. There was significant damage to the right front side of the engine and down the right side of the engine as well. Damage included multiple broken air line fittings, a broken fuel filler cap, dented fuel tanks and broken and bent railings down the right side of the engine. Det Goffin documented the damage with pictures. He also returned to the scene on 09-28-16 and took daytime photos.

This report was submitted from an electronic device owned, issued, or maintained by a law enforcement agency using my user ID and password. I certify or declare under penalty of perjury under the laws of the State of Washington that the foregoing is true and correct.

|   |   |
|---|---|
| REPORTING OFFICER / ID #<br><b>Metcalf, George M</b> 1319 | APPROVING SUPERVISOR<br><b>Kahler, Andrew J</b> |
| LOCATION SIGNED <b>Snohomish County, WA</b>               | DATE SIGNED <b>9/28/2016</b>                    |

This officer's narrative is complete when an approving supervisor's name is attached. Complete report details do not print in this format.





**SNOHOMISH COUNTY SHERIFF'S OFFICE**  
3000 Rockefeller Ave  
Everett, WA 98021  
(425) 388-3523

**Initial Case Report**

Case Report # **2016-00152909**

**NARRATIVE (continuation)**

came to rest approx 16 feet southwest of the point of impact. Taylor was located between the box and cab of the truck approx 52 feet from the point of impact.

Witness Glen Nash said he and his wife Nancy were driving northbound on Pioneer Highway and looked to the west and he saw Torres-Aranda approaching the railroad crossing in the potato truck. He said the truck drove right onto the center of the tracks and was hit by the train. He said the truck flew into the air and then he lost sight of the truck as the train passed by. He said he stopped approx 1/4 mile down the road and called 9-1-1 and then went back to the scene. He said he provided aid to Taylor. He said he saw Torres-Aranda still in the cab of the truck.

Witness Cassidy Sorenson said he driving southbound on Pioneer Highway and was slowly overtaking the BNSF train. He said just as he was passing the train, he heard the trains horn blowing (one long, two short, one long and then a constant horn). He said he saw a red truck (Torres-Aranda) approaching the private railroad crossing at a 45 degree angle . He said Torres-Aranda did not stop and the train hit the truck just behind the cab.

Investigators (Chelsea Warneke and Lauren Alvarez) from the Snohomish County Medical Examiner's Office responded to the scene to conduct their preliminary investigation. They took pictures and obtained information from me in reference to the train. Torres-Aranda's son, Jesus Torres-Velazquez (4b) was on scene. The ME investigators contacted Torres-Velazquez and turned over his fathers personal property to him. They took custody of Torres-Aranda's body and transported him to the medical examiner's office. The ME case number is 16SN1732.

09-28-16- I contacted Providence Hospital to check on the status of Taylor and was informed that he had been transferred to Harborview Medical Center for treatment of his injuries. I contacted Harborview Medical Center, Taylor was in surgery and would not be available for an interview for several days.

10-06-16- I was contacted Andrew Day (BNSF), Senior Claims Representative. He was requesting information on Taylor. He also stated that there was video from the train and he would make that available next week if I wanted to view it. (scheduled for 10-11-16 at 1230 hrs).

10-07-16- I responded to Harborview Medical Center and contacted Taylor on the trauma ward and obtained a statement from him. Taylor said Jesus Torres-Aranda was driving the truck from the fields (he said they had made approx 15 loads from that field that day) located to the west of the tracks. He said they were approaching the tracks at 5-10 mph. He said Torres-Aranda never stopped and never looked back to see if a train was coming. Taylor said he looked across into the drivers side outside mirror and saw the lights of the train approaching their location. He said he opened the door of the truck and jumped. He said he remembered waking up and people were around him helping him. He said he did not remember hearing any whistles from the train. Based on the location of Taylor post collision (52 feet from impact), I think he decided he wanted to jump from the truck and started to open the door but the train struck the truck first and he was then ejected from the truck.

This report was submitted from an electronic device owned, issued, or maintained by a law enforcement agency using my user ID and password. I certify or declare under penalty of perjury under the laws of the State of Washington that the foregoing is true and correct.

|   |   |
|---|---|
| REPORTING OFFICER / ID #<br><b>Metcalf, George M</b> 1319 | APPROVING SUPERVISOR<br><b>Kahler, Andrew J</b> |
| LOCATION SIGNED <b>Snohomish County, WA</b>               | DATE SIGNED <b>9/28/2016</b>                    |

This officer's narrative is complete when an approving supervisor's name is attached. Complete report details do not print in this format.

|  |                                    |
|--|------------------------------------|
|  <b>SNOHOMISH COUNTY SHERIFF'S OFFICE</b><br>3000 Rockefeller Ave<br>Everett, WA 98021<br>(425) 388-3523 | <b>Initial Case Report</b>         |
|  | Case Report # <b>2016-00152909</b> |

**NARRATIVE (continuation)**

10-11-16- Day came to my office to let me view the video from engine BNSF2620. I watched the video which showed Torres-Aranda approaching the train crossing from the northwest at a slow speed (consistent with 5-10 mph reported by Taylor). The video confirms that Torres-Aranda never stopped at the posted stop sign/railroad crossing signs before starting over the tracks. I could hear the train whistle which was required by signal boards located on the side of the tracks prior to railroad crossings. I could hear the escape of air from the engine just prior to the collision which is consistent with the train being placed in emergency status. I then heard the brakes on the train engage just after the collision. Day told me the maximum speed for the train on the tracks in that area is 60 mph. He told me the train was already slowing down prior to the collision because it was due to go on a side track prior to Stan wood to allow another train to pass. Per BNSF policy, they do not make copies of the video, however, the copy of the video is secured by BNSF if further litigation is necessary.

11-14-16- I received a copy of the autopsy results on Torres-Aranda. The autopsy revealed multiple blunt force injuries to the torso, head and extremities for Torres-Aranda. His toxicology results were all negative for drugs and alcohol.

Weather: The weather at the time of the collision was clear with a temperature around 60 degrees.

Roadway Description: The BNSF tracks run generally from north to south in the area of the collision. The tracks are marked with the standard railroad signage.

92 Av NW is a private gravel road which runs from northwest to southeast in the area of the collision as it approaches the private railroad crossing just to the west of Pioneer Highway. The road runs at an approx 45 degree angle as it approaches the railroad crossing. The railroad crossing has a posted stop sign (approx 44 feet from the tracks) and a railroad crossing sign (approx 34 feet from the tracks).

Causation/Conclusion: The cause of this collision is Torres-Aranda failed to stop at the posted stop sign and railroad crossing sign at 92 Av NW and DOT crossing 84722N. He failed to yield to the train and was struck by the southbound BNSF train.

EOR

George Metcalf #1319

This report was submitted from an electronic device owned, issued, or maintained by a law enforcement agency using my user ID and password. I certify or declare under penalty of perjury under the laws of the State of Washington that the foregoing is true and correct.

|  |   |
|--|---|
| REPORTING OFFICER / ID #<br><b>Metcalf, George M</b> <b>1319</b> | APPROVING SUPERVISOR<br><b>Kahler, Andrew J</b> |
| LOCATION SIGNED <b>Snohomish County, WA</b>                      | DATE SIGNED <b>9/28/2016</b>                    |

This officer's narrative is complete when an approving supervisor's name is attached. Complete report details do not print in this format.  
SO Case 2016-00152909 Page 6 OF 6



**SNOHOMISH COUNTY SHERIFF'S OFFICE**  
INTEGRITY · DIGNITY · COMMITMENT · PRIDE

Ty Trenary, Sheriff

Date: January 28, 2017

To: Lori Halstead

Dear Requestor,

Enclosed please find records responsive to PRR #K12811-120616.

Please note that there are black boxes (redactions) on various pages of the responsive documents. The black box may be small or large depending on the amount of information that is redacted. There may also be multiple redactions on one page. Within the redaction is a code – for example, 1A, 1B, etc. That code designates the statutory exemption applicable to the redacted information. If there is only one code on the page, but there are numerous redactions, that one statutory exemption applies to all of the redactions on that page. Otherwise, the code printed within the redaction designates the exemption for that redaction.

Also provided with these records is a key to the codes. This key identifies the statutory basis for the exemption as well as a brief explanation for why the exemption applies to the redacted information. As you review these responsive documents, you can refer to the key to identify the exemption and its applicability.

We have attempted to apply consistent redactions on document that contain the same information. In the event you locate documents that contain redactions that are not applied consistently, please let me know.

Finally, the disclosure of information in the records being produced does not in any way constitute a waiver of attorney-client and/or work product privileges.

If you have any questions, please contact our office at 425-388-3769.

Snohomish County Sheriff's Office  
Public Records Unit



**SNOHOMISH COUNTY SHERIFF'S OFFICE**  
 INTEGRITY • DIGNITY • COMMITMENT • PRIDE

**Ty Trenary, Sheriff**

Personally identifiable information redacted per RCW 42.56.230.  
 Some redaction marks were applied by the originating agency and will not appear in the withholding log.

| Code | Applicable Exemption   | The cited exemption applies because the redacted/withheld information includes the following:  |
|------|--|--|
| 1A   | RCW 42.56.240(1), RCW 42.56.050. Specific intelligence information and records compiled by investigative, law enforcement, penology agencies, and state agencies vested with the responsibility to discipline members of any profession, the nondisclosure of which is essential to effective law enforcement or the protection of any person's right to privacy | Identifying information of a confidential informant where nondisclosure is essential to effective law enforcement because to release the identity or information about the confidential informant would compromise this and/or future and past investigations where this confidential informant may have been involved |
| 1B   | RCW 42.56.240(1), RCW 42.56.050. Specific intelligence information and records compiled by investigative, law enforcement, penology agencies, and state agencies vested with the responsibility to discipline members of any profession, the nondisclosure of which is essential to effective law enforcement or the protection of any person's right to privacy | Identifying information of a confidential informant where nondisclosure is for the protection of the confidential informant's right to privacy   |
| 1C   | RCW 42.56.240(1), RCW 42.56.050. Specific intelligence information and records compiled by investigative, law enforcement, penology agencies, and state agencies vested with the responsibility to discipline members of any profession, the nondisclosure of which is essential to effective law enforcement or the protection of any person's right to privacy | Records contained in an active, on-going criminal investigation – this is a “categorical” exemption, meaning the records are exempt as a whole in their entirety   |
| 1D   | RCW 42.56.240(1), RCW 42.56.050. Specific intelligence information and records compiled by investigative, law enforcement, penology agencies, and state agencies vested with the responsibility to discipline members of any profession, the nondisclosure of which is essential to effective law enforcement or the protection of any person's right to privacy | Specific intelligence information compiled by law enforcement, in an investigation that has already been referred to the Prosecuting Attorney, the nondisclosure of which is essential to effective law enforcement because to release the information would compromise the investigative process.                     |
| 1E   | RCW 42.56.240(1), RCW 42.56.050. Specific intelligence information and records compiled by investigative, law enforcement, penology agencies, and state agencies vested with the responsibility to discipline members of any profession, the nondisclosure of which is essential to effective law enforcement or the protection of any person's right to privacy | Specific intelligence information compiled by law enforcement, in an investigation that has already been referred to the Prosecuting Attorney, the nondisclosure of which is for the protection of a person's right to privacy   |
| 1F   | RCW 42.56.240(1), RCW 42.56.050. Specific intelligence information and records compiled by investigative, law enforcement, penology agencies, and state agencies vested with the responsibility to discipline members of any profession, the nondisclosure of which is essential to effective law enforcement or the protection of any person's right to privacy | Specific intelligence information compiled by an investigative agency the nondisclosure of which is essential to effective law enforcement because to release the information would compromise the investigative process   |



**SNOHOMISH COUNTY SHERIFF'S OFFICE**  
 INTEGRITY · DIGNITY · COMMITMENT · PRIDE



**Ty Trenary, Sheriff**

Some redaction marks were applied by the originating agency and will not appear in the withholding log.

| Code | Applicable Exemption   | The cited exemption applies because the redacted/withheld information includes the following:  |
|------|--|--|
| 1G   | RCW 42.56.240(1), RCW 42.56.050. Specific intelligence information and records compiled by investigative, law enforcement, penology agencies, and state agencies vested with the responsibility to discipline members of any profession, the nondisclosure of which is essential to effective law enforcement or the protection of any person's right to privacy | Specific intelligence information compiled by an investigative agency the nondisclosure of which is for the protection of a person's right to privacy            |
| 1H   | RCW 42.56.240(1). General results of polygraph administered as part of criminal investigation may be withheld as specific intelligence information, the nondisclosure of which is essential to effective law enforcement   | Questions, answers, and charts of a polygraph conducted in a law enforcement investigation   |
| 1I   | RCW 42.56.240(1), RCW 42.56.050. Specific intelligence information and records compiled by investigative, law enforcement, penology agencies, and state agencies vested with the responsibility to discipline members of any profession, the nondisclosure of which is essential to effective law enforcement or the protection of any person's right to privacy | Photograph of victim or witness that shows injury, is embarrassing, the person is deceased, or would otherwise violate the individual's right to privacy         |
| 2A   | RCW 42.56.240(2). Information revealing the identity of persons who are witnesses to or victims of crime or who file complaints with any investigative, law enforcement, or penology agencies, if disclosure would endanger any person's life, physical safety, or property, or they indicate a desire for anonymity at the time of initial contact              | Identity of a victim of a crime where disclosure would endanger any person's life  |
| 2B   | RCW 42.56.240(2). Information revealing the identity of persons who are witnesses to or victims of crime or who file complaints with any investigative, law enforcement, or penology agencies, if disclosure would endanger any person's life, physical safety, or property, or they indicate a desire for anonymity at the time of initial contact              | Identity of a victim of a crime where disclosure would endanger any person's physical safety   |
| 2C   | RCW 42.56.240(2). Information revealing the identity of persons who are witnesses to or victims of crime or who file complaints with any investigative, law enforcement, or penology agencies, if disclosure would endanger any person's life, physical safety, or property, or they indicate a desire for anonymity at the time of initial contact              | Identity of a victim of a crime where disclosure would endanger any person's property  |
| 2D   | RCW 42.56.240(2). Information revealing the identity of persons who are witnesses to or victims of crime or who file complaints with any investigative, law enforcement, or penology agencies, if disclosure would endanger any person's life, physical safety, or property, or they indicate a desire for anonymity at the time of initial contact              | Identity of a victim of a crime where victim requested anonymity at time of initial contact with law enforcement   |
| 2E   | RCW 42.56.240(2). Information revealing the identity of persons who are witnesses to or victims of crime or who file complaints with any investigative, law enforcement, or penology agencies, if disclosure would endanger any person's life, physical safety, or property, or they indicate a desire for anonymity at the time of initial contact              | Identity of victim who filed a complaint with an investigative, law enforcement, or penology agency where disclosure would endanger any person's life            |
| 2F   | RCW 42.56.240(2). Information revealing the identity of persons who are witnesses to or victims of crime or who file complaints with any investigative, law enforcement, or penology agencies, if disclosure would endanger any person's life, physical safety, or property, or they indicate a desire for anonymity at the time of initial contact              | Identity of victim who filed a complaint with an investigative, law enforcement, or penology agency where disclosure would endanger any person's physical safety |
| 2G   | RCW 42.56.240(2). Information revealing the identity of persons who are witnesses to or victims of crime or who file complaints with any investigative, law enforcement, or penology agencies, if disclosure would endanger any person's life, physical safety, or property, or they indicate a desire for anonymity at the time of initial contact              | Identity of victim who filed a complaint with an investigative, law enforcement, or penology agency where disclosure would endanger any person's property        |

**SNOHOMISH COUNTY SHERIFF'S OFFICE**  
INTEGRITY · DIGNITY · COMMITMENT · PRIDE



Ty Trenary, Sheriff

Some redaction marks were applied by the originating agency and will not appear in the withholding log.

| Code | Applicable Exemption  | The cited exemption applies because the redacted/withheld information includes the following:  |
|------|---|--|
| 2H   | RCW 42.56.240(2). Information revealing the identity of persons who are witnesses to or victims of crime or who file complaints with any investigative, law enforcement, or penology agencies, if disclosure would endanger any person's life, physical safety, or property, or they indicate a desire for anonymity at the time of initial contact | Identity of a victim who filed a complaint with an investigative, law enforcement, or penology agency crime where victim requested anonymity at time of initial contact with law enforcement   |
| 2I   | RCW 42.56.240(2). Information revealing the identity of persons who are witnesses to or victims of crime or who file complaints with any investigative, law enforcement, or penology agencies, if disclosure would endanger any person's life, physical safety, or property, or they indicate a desire for anonymity at the time of initial contact | Identity of a witness to a crime where disclosure would endanger any person's life   |
| 2J   | RCW 42.56.240(2). Information revealing the identity of persons who are witnesses to or victims of crime or who file complaints with any investigative, law enforcement, or penology agencies, if disclosure would endanger any person's life, physical safety, or property, or they indicate a desire for anonymity at the time of initial contact | Identity of a witness to a crime where disclosure would endanger any person's physical safety  |
| 2K   | RCW 42.56.240(2). Information revealing the identity of persons who are witnesses to or victims of crime or who file complaints with any investigative, law enforcement, or penology agencies, if disclosure would endanger any person's life, physical safety, or property, or they indicate a desire for anonymity at the time of initial contact | Identity of a witness to a crime where disclosure would endanger any person's property   |
| 2L   | RCW 42.56.240(2). Information revealing the identity of persons who are witnesses to or victims of crime or who file complaints with any investigative, law enforcement, or penology agencies, if disclosure would endanger any person's life, physical safety, or property, or they indicate a desire for anonymity at the time of initial contact | Identity of a witness to a crime where witness requested anonymity at time of initial contact with law enforcement   |
| 2M   | RCW 42.56.240(2). Information revealing the identity of persons who are witnesses to or victims of crime or who file complaints with any investigative, law enforcement, or penology agencies, if disclosure would endanger any person's life, physical safety, or property, or they indicate a desire for anonymity at the time of initial contact | Identity of a witness who filed a complaint with an investigative, law enforcement, or penology agency where disclosure would endanger any person's life                                       |
| 2N   | RCW 42.56.240(2). Information revealing the identity of persons who are witnesses to or victims of crime or who file complaints with any investigative, law enforcement, or penology agencies, if disclosure would endanger any person's life, physical safety, or property, or they indicate a desire for anonymity at the time of initial contact | Identity of a witness who filed a complaint with an investigative, law enforcement, or penology agency where disclosure would endanger any person's physical safety                            |
| 2O   | RCW 42.56.240(2). Information revealing the identity of persons who are witnesses to or victims of crime or who file complaints with any investigative, law enforcement, or penology agencies, if disclosure would endanger any person's life, physical safety, or property, or they indicate a desire for anonymity at the time of initial contact | Identity of a witness who filed a complaint with an investigative, law enforcement, or penology agency where disclosure would endanger any person's property                                   |
| 2P   | RCW 42.56.240(2). Information revealing the identity of persons who are witnesses to or victims of crime or who file complaints with any investigative, law enforcement, or penology agencies, if disclosure would endanger any person's life, physical safety, or property, or they indicate a desire for anonymity at the time of initial contact | Identity of a witness who filed a complaint with an investigative, law enforcement, or penology agency crime where witness requested anonymity at time of initial contact with law enforcement |
| 3A   | RCW 42.56.070(1); RCW 7.69A.030(4). Name/address/photos of living child victim/witness shall not be disclosed by law enforcement, prosecutors, state agency without permission of victim/witness/parents/guardians except to entity providing services to child   | Identifying information of living child victim of a crime  |

**SNOHOMISH COUNTY SHERIFF'S OFFICE**  
 INTEGRITY · DIGNITY · COMMITMENT · PRIDE



**Ty Trenary, Sheriff**

Personally identifiable information redacted per RCW 42.56.230.  
 Some redaction marks were applied by the originating agency and will not appear in the withholding log.

| Code | Applicable Exemption  | The cited exemption applies because the redacted/withheld information includes the following:  |
|------|---|--|
| 3B   | RCW 42.56.070(1); RCW 7.69A.030(4). Name/address/photos of living child victim/witness shall not be disclosed by law enforcement, prosecutors, state agency without permission of victim/witness/parents/guardians except to entity providing services to child   | Identifying information of a living child witness to a crime   |
| 3C   | RCW 42.56.070(1); RCW 42.56.240(5), RCW 10.97.130. Information revealing the identity of child victims of sexual assault who are under age 18 are exempt – including name, address, location, photograph, and in cases in which the child victim is a relative or stepchild of the alleged perpetrator, identification of the relationship between the child and the alleged perpetrator  | Identifying information of a child victim of sexual assault  |
| 4A   | RCW 42.56.070(1); RCW 13.50.100. Records covered by RCW 13.50.100 shall be confidential and shall be released only pursuant to that section and RCW 13.50.010   | Records related to a juvenile which do not relate to the commission of a criminal offense  |
| 4B   | RCW 42.56.070(1); RCW 13.50.050. All records other than the official juvenile court file are confidential and may be released only as provided in RCW 13.50.050, RCW 13.50.010, RCW 13.40.215, RCW 4.24.550   | Records related to a juvenile related to the commission of a criminal offense  |
| 4C   | RCW 42.56.070(1); RCW 13.50.100. Records covered by this section shall be confidential and shall be released only in accordance with RCW 13.50.100 and 13.50.010.   | Records retained or produced by a juvenile justice or care agency as defined by RCW 13.50.010(1)(a)  |
| 5A   | RCW 42.56.070(1); RCW 70.48.100. Jail records are generally exempt from disclosure and may be released only in accordance with RCW 70.48.100.   | Jail records – all records including booking photos, medical information, and custodial care information   |
| 5B   | RCW 42.56.070(1); RCW 70.48.100(3)(a). Photos are exempt from disclosure except to law enforcement to assist in crime investigation   | Jail booking photographs   |
| 5C   | RCW 42.56.420(2) – specific and unique vulnerability assessments, the public disclosure of which would have a substantial likelihood of threatening security of a correctional facility.  | Jail surveillance recordings   |
| 6A   | RCW 42.56.420(1). Those portions of records assembled, prepared, or maintained to prevent, mitigate, or respond to criminal terrorist acts, which are acts that significantly disrupt the conduct of government or of the general civilian population; the public disclosure of which would have a substantial likelihood of threatening public safety, consisting of:<br>(a) Specific and unique vulnerability assessments or specific and unique response or deployment plans, including compiled underlying data collected in preparation of or essential to the assessments, or to the response or deployment plans; and<br>(b) Records not subject to public disclosure under federal law that are shared by federal or international agencies, and information prepared from national security briefings provided to state or local government officials related to domestic preparedness for acts of terrorism | Specific and unique vulnerability assessments or specific and unique response or deployment plans related to the prevention, mitigation, or response to criminal terrorist acts where disclosure would have a substantial likelihood of threatening public safety  |
| 6B   | RCW 42.56.420(1). Those portions of records assembled, prepared, or maintained to prevent, mitigate, or respond to criminal terrorist acts, which are acts that significantly disrupt the conduct of government or of the general civilian population; the public disclosure of which would have a substantial likelihood of threatening public safety, consisting of:<br>(a) Specific and unique vulnerability assessments or specific and unique response or deployment plans, including compiled underlying data collected in preparation of or essential to the assessments, or to the response or deployment plans; and<br>(b) Records not subject to public disclosure under federal law that are shared by federal or international agencies, and information prepared from national security briefings provided to state or local government officials related to domestic preparedness for acts of terrorism | Records not subject to public disclosure under federal law that are shared by the federal or international agencies, and information prepared from national security briefings provided to state or local government officials related to domestic preparedness for acts of terrorism, the public disclosure of which would have a substantial likelihood of threatening public safety |



**SNOHOMISH COUNTY SHERIFF'S OFFICE**  
 INTEGRITY · DIGNITY · COMMITMENT · PRIDE

Ty Trenary, Sheriff

Some redaction marks were applied by the originating agency and will not appear in the withholding log.

| Code | Applicable Exemption  | The cited exemption applies because the redacted/withheld information includes the following:   |
|------|---|---|
| 7A   | RCW 42.56.420(2). Vulnerability assessments or emergency and escape response plans at an adult or juvenile correctional facility or a secure facility for persons civilly confined under RCW 71.09, the public disclosure of which would have a substantial likelihood of threatening the security of the facility or any individual's safety | Vulnerability assessment of an adult or juvenile correctional facility where disclosure would have a substantial likelihood of threatening the security of the facility                     |
| 7B   | RCW 42.56.420(2). Vulnerability assessments or emergency and escape response plans at an adult or juvenile correctional facility or a secure facility for persons civilly confined under RCW 71.09, the public disclosure of which would have a substantial likelihood of threatening the security of the facility or any individual's safety | Vulnerability assessment of an adult or juvenile correctional facility where disclosure would have a substantial likelihood of threatening any individual's safety                          |
| 7C   | RCW 42.56.420(2). Vulnerability assessments or emergency and escape response plans at an adult or juvenile correctional facility or a secure facility for persons civilly confined under RCW 71.09, the public disclosure of which would have a substantial likelihood of threatening the security of the facility or any individual's safety | Vulnerability assessment of a secure facility for persons civilly confined under RCW 71.09 where disclosure would have a substantial likelihood of threatening the security of the facility |
| 7D   | RCW 42.56.420(2). Vulnerability assessments or emergency and escape response plans at an adult or juvenile correctional facility or a secure facility for persons civilly confined under RCW 71.09, the public disclosure of which would have a substantial likelihood of threatening the security of the facility or any individual's safety | Vulnerability assessment of a secure facility for persons civilly confined under RCW 71.09 where disclosure would have a substantial likelihood of threatening any individual's safety      |
| 7E   | RCW 42.56.420(2). Vulnerability assessments or emergency and escape response plans at an adult or juvenile correctional facility or a secure facility for persons civilly confined under RCW 71.09, the public disclosure of which would have a substantial likelihood of threatening the security of the facility or any individual's safety | Emergency response plans for an adult or juvenile correctional facility where disclosure would have a substantial likelihood of threatening the security of the facility                    |
| 7F   | RCW 42.56.420(2). Vulnerability assessments or emergency and escape response plans at an adult or juvenile correctional facility or a secure facility for persons civilly confined under RCW 71.09, the public disclosure of which would have a substantial likelihood of threatening the security of the facility or any individual's safety | Emergency response plans of an adult or juvenile correctional facility where disclosure would have a substantial likelihood of threatening any individual's safety                          |
| 7G   | RCW 42.56.420(2). Vulnerability assessments or emergency and escape response plans at an adult or juvenile correctional facility or a secure facility for persons civilly confined under RCW 71.09, the public disclosure of which would have a substantial likelihood of threatening the security of the facility or any individual's safety | Emergency response plans of a secure facility for persons civilly confined under RCW 71.09 where disclosure would have a substantial likelihood of threatening the security of the facility |
| 7H   | RCW 42.56.420(2). Vulnerability assessments or emergency and escape response plans at an adult or juvenile correctional facility or a secure facility for persons civilly confined under RCW 71.09, the public disclosure of which would have a substantial likelihood of threatening the security of the facility or any individual's safety | Emergency response plans of a secure facility for persons civilly confined under RCW 71.09 where disclosure would have a substantial likelihood of threatening any individual's safety      |

**SNOHOMISH COUNTY SHERIFF'S OFFICE**  
 INTEGRITY · DIGNITY · COMMITMENT · PRIDE



Ty Trenary, Sheriff

| Code | Applicable Exemption  | The cited exemption applies because the redacted/withheld information includes the following:  |
|------|---|--|
| 7I   | RCW 42.56.420(2). Vulnerability assessments or emergency and escape response plans at an adult or juvenile correctional facility or a secure facility for persons civilly confined under RCW 71.09, the public disclosure of which would have a substantial likelihood of threatening the security of the facility or any individual's safety   | Escape response plans for an adult or juvenile correctional facility where disclosure would have a substantial likelihood of threatening the security of the facility                    |
| 7J   | RCW 42.56.420(2). Vulnerability assessments or emergency and escape response plans at an adult or juvenile correctional facility or a secure facility for persons civilly confined under RCW 71.09, the public disclosure of which would have a substantial likelihood of threatening the security of the facility or any individual's safety   | Escape response plans for an adult or juvenile correctional facility where disclosure would have a substantial likelihood of threatening any individual's safety                         |
| 7K   | RCW 42.56.420(2). Vulnerability assessments or emergency and escape response plans at an adult or juvenile correctional facility or a secure facility for persons civilly confined under RCW 71.09, the public disclosure of which would have a substantial likelihood of threatening the security of the facility or any individual's safety   | Escape response plans of a secure facility for persons civilly confined under RCW 71.09 where disclosure would have a substantial likelihood of threatening the security of the facility |
| 7L   | RCW 42.56.420(2). Vulnerability assessments or emergency and escape response plans at an adult or juvenile correctional facility or a secure facility for persons civilly confined under RCW 71.09, the public disclosure of which would have a substantial likelihood of threatening the security of the facility or any individual's safety   | Escape response plans of a secure facility for persons civilly confined under RCW 71.09 where disclosure would have a substantial likelihood of threatening any individual's safety      |
| 8    | RCW 42.56.070(1); RCW 68.50.105; RCW 11.02.005. Reports and records of autopsies or post-mortems shall be confidential  | Autopsy records related to a post mortem investigation   |
| 9    | RCW 42.56.240(1). Specific intelligence information and specific investigative records compiled by investigative, law enforcement, and penalty agencies, and state agencies vested with the responsibility to discipline members of any profession, the non-disclosure of which is essential for the protection of any person's right to privacy (privacy extends to the family of the deceased). Also see <i>Comarato v. Pierce County Medical Examiner's Office</i> , 111 Wn.App. 69, 43 P.3d 539 (2002). | Suicide Note   |
| 10A  | RCW 42.56.070(1); 28 USC § 534(b); RCW 10.97.050, RCW 10.97.030; RCW 43.43.834(5); RCW 43.43.710. Any law enforcement agency that receives information under 28 USC § 534 may not disseminate such information outside of such agency. Additionally, non-conviction information may not be produced to the public. For conviction information, please contact <a href="http://www.wsp.wa.gov/crime/chrequests.htm">http://www.wsp.wa.gov/crime/chrequests.htm</a>   | FBI Rap Sheet – the County received this information/record pursuant to 28 USC § 534   |
| 10B  | RCW 42.56.070(1); RCW 10.97.050, RCW 10.97.030. Non-conviction information may not be disclosed to the public   | Non-conviction data  |
| 10C  | RCW 42.56.070(1); RCW 43.43.834(5). Criminal history background records obtained by a business or organization cannot be disclosed to the public  | Criminal history background check obtained by a business or organization   |
| 11   | RCW 42.56.250(2). Applications for public employment, including name, resume, other related materials submitted by or with respect to applicant   | Public employee application materials, including the name of the applicant and materials submitted to the County by or with respect to the applicant                                     |
| 12A  | RCW 42.56.250(1). Test questions, scoring keys, and other examination data used to administer an employment examination are exempt  | Test questions used for an employment examination  |



**SNOHOMISH COUNTY SHERIFF'S OFFICE**  
INTEGRITY · DIGNITY · COMMITMENT · PRIDE

**Ty Trenary, Sheriff**

Personally identifiable information redacted per RCW 42.56.230.  
Some redaction marks were applied by the originating agency and will not appear in the withholding log.

| Code | Applicable Exemption  | The cited exemption applies because the redacted/withheld information includes the following:   |
|------|---|---|
| 12B  | RCW 42.56.250(1). Test questions, scoring keys, and other examination data used to administer an employment examination are exempt  | Test scoring keys used for an employment examination  |
| 12C  | RCW 42.56.250(1). Test questions, scoring keys, and other examination data used to administer an employment examination are exempt  | Examination data (other than questions or scoring keys) used for an employment examination  |
| 13   | RCW 42.56.360(1)(j). All documents, including completed forms, received pursuant to a wellness program under RCW 41.04.362 are exempt   | Records the County received for participation in an employee wellness program   |
| 14A  | RCW 42.56.250(8). Photographs and month and year of birth in the personnel files of employees and workers of criminal justice agencies are exempt, unless the requestor is a member of the news media.  | Photograph of a criminal justice agency employee (includes Sheriff's Office, Prosecuting Attorney's Office, Court staff)  |
| 14B  | RCW 42.56.250(8). Photographs and month and year of birth in the personnel files of employees and workers of criminal justice agencies are exempt, unless the requestor is a member of the news media.  | Birthdate (month and year) of a criminal justice agency employee (includes Sheriff's Office, Prosecuting Attorney's Office, Court staff)  |
| 14C  | RCW 42.56.240(13). The global positioning system data that would indicate the location of the residence of an employee or worker of a criminal justice agency.  | GPS data that shows the location of the residence of an employee or worker of a criminal justice agency   |
| 15   | RCW 42.56.250(3). The following information held by any public agency in personnel records, public employment related records, volunteer rosters, or included in any mailing list of employees or volunteers of any public agency: Residential addresses, residential telephone numbers, personal wireless telephone numbers, personal electronic mail addresses, social security numbers, driver's license numbers, identifiacard numbers, and emergency contact information of employees or volunteers of a public agency, and the names, dates of birth, residential addresses, residential telephone numbers, personal wireless telephone numbers, personal electronic mail addresses, social security numbers, and emergency contact information of dependents of employees or volunteers of a public agency | Specific personal information of a public employee or volunteer contained in personnel records, public employment related records, volunteer rosters, or mailing list of employees or volunteers                |
| 16   | RCW 42.56.250(3). The following information held by any public agency in personnel records, public employment related records, volunteer rosters, or included in any mailing list of employees or volunteers of any public agency: Residential addresses, residential telephone numbers, personal wireless telephone numbers, personal electronic mail addresses, social security numbers, driver's license numbers, identifiacard numbers, and emergency contact information of employees or volunteers of a public agency, and the names, dates of birth, residential addresses, residential telephone numbers, personal wireless telephone numbers, personal electronic mail addresses, social security numbers, and emergency contact information of dependents of employees or volunteers of a public agency | Specific personal information of a dependent of a public employee or volunteer contained in personnel records, public employment related records, volunteer rosters, or mailing list of employees or volunteers |
| 17   | RCW 42.56.230(3); RCW 42.56.050. personal information maintained for employee, appointee, elected official to the extent disclosure violates right to privacy. Also see <u>Dawson v. Daly</u> , 120 Wn.2d 782, 845 P.2d 995 (1993).   | Public employee performance evaluations – not containing specific instances of misconduct   |
| 18   | RCW 42.56.230(3); RCW 42.56.050. The employee identity and identifiers in unsubstantiated allegations of sexual misconduct are exempt from production to protect the employee's right to privacy  | Employee identifying information in an administrative investigation resulting in a non-adverse finding when the allegation was one of sexual misconduct   |



**SNOHOMISH COUNTY SHERIFF'S OFFICE**  
 INTEGRITY · DIGNITY · COMMITMENT · PRIDE

Ty Trenary, Sheriff

Some redaction marks were applied by the originating agency and will not appear in the withholding log.

| Code | Applicable Exemption   | The cited exemption applies because the redacted/withheld information includes the following:   |
|------|--|---|
| 19   | RCW 42.56.250(5). Investigative records compiled by an employing agency conducting an active and ongoing investigation of a possible unfair practice under chapter 49.60 RCW or a possible violation of other federal, state, or local laws prohibiting discrimination in employment are exempt  | Investigative records related to an active, on-going investigation of a violation of a law against discrimination in employment. This investigation is active and on-going and involves an allegation of employment discrimination. |
| 20   | RCW 42.56.070(1); RCW 42.41.030(7). The identity of a reporting employee shall be kept confidential to the extent possible under law, unless the employee authorizes the disclosure of his or her identity in writing.   | Identifying information of a whistleblower  |
| 21   | RCW 42.56.070(1); 18 USC §§2721, 2725(3). Personal information including photograph, social security number, driver identification number, name, address (not zip code), telephone number, and medical or disability information may not be disclosed by a government agency who received such information from the state department of licensing, except in particular instances defined in 18 USC § 2721(b).   | Personal information provided to the County by the state department of licensing for the purpose of carrying out the County's governmental functions  |
| 22   | RCW 42.56.070(1); RCW 46.52.130(3). The County may not release an abstract driving record to a third party; contact the Department of Licensing at <a href="http://www.dol.wa.gov/driverslicense/requestyourrecord.html">http://www.dol.wa.gov/driverslicense/requestyourrecord.html</a>   | Abstract Driving Record   |
| 23   | RCW 42.56.070(1); RCW 46.12.635. Name/address of individual vehicle owner shall not be released; contact the Department of Licensing at <a href="http://www.dol.wa.gov/forms/224003.pdf">http://www.dol.wa.gov/forms/224003.pdf</a>  | Vehicle Registration - name/address of owner  |
| 24   | RCW 42.56.070(1); 5 USC §552(a); RCW 42.56.050; RCW 42.56.230(5). The Privacy Act of 1974 evinces Congress' intent that social security numbers are a private concern. RCW 42.56.230(5). Credit card numbers, debit card numbers, electronic check numbers, credit expiration dates, bank/other financial information as defined in RCW 9.35.005 including social security numbers are exempt except when disclosure is expressly required by or governed by other law | Social Security Number  |
| 25   | RCW 42.56.070(1); 5 USC §552(a); RCW 42.56.050. The Privacy Act of 1974 evinces Congress' intent that passport numbers are a private concern   | Passport number   |
| 26   | RCW 42.56.230(3); RCW 42.56.230(4); RCW 42.56.070(1); RCW 82.32.330; 26 USC 6103(a). Taxpayer information shall be kept confidential and may not be disclosed – includes a taxpayer's identity, the nature, source, or amount of the taxpayer's income, payments, receipts, deductions, exemptions, credits, assets, liabilities, net worth, tax liability deficiencies, over-assessments, or tax payments   | Taxpayer information  |
| 27   | RCW 42.56.230(4); RCW 42.56.070(1); RCW 84.08.210. Property taxpayer information is confidential and may not be disclosed  | Taxpayer information provided to determine property tax   |
| 28A  | RCW 42.56.070(1); RCW 5.60.060(2)(a), RCW 42.56.290. Communication from client to attorney for the purpose of obtaining legal advice is exempt   | Communication from client to attorney to obtain legal advice  |
| 28B  | RCW 42.56.070(1); RCW 5.60.060(2)(a), RCW 42.56.290. Communication from attorney to client for the purpose of providing legal advice is exempt   | Communication from attorney to client to provide legal advice   |
| 28C  | RCW 42.56.070(1); RCW 5.60.060(2)(a), RCW 42.56.290. Communication between client and attorney regarding litigation is exempt  | Communication between attorney and client regarding litigation  |



**SNOHOMISH COUNTY SHERIFF'S OFFICE**  
INTEGRITY · DIGNITY · COMMITMENT · PRIDE

**Ty Trenary, Sheriff**

Some redaction marks were applied by the originating agency and will not appear in the withholding log.

| Code | Applicable Exemption   | The cited exemption applies because the redacted/withheld information includes the following:             |
|------|--|---|
| 28D  | RCW 42.56.070(1); RCW 5.60.060(2)(a), RCW 42.56.290. Communication between attorneys that reflect attorney/client communications regarding advice is exempt  | Communication between attorney and client regarding client advice   |
| 28E  | RCW 42.56.070(1); RCW 5.60.060(2)(a), RCW 42.56.290. Communication between attorneys regarding litigation is exempt  | Communication between attorneys regarding litigation  |
| 28F  | RCW 42.56.070(1); RCW 5.60.060(2)(a), RCW 42.56.290. Communication between attorneys regarding client advice is exempt   | Communication between attorneys regarding client advice   |
| 28G  | RCW 42.56.070(1); RCW 5.60.060(2)(a). Communication between members of client agency for purpose of gathering information to obtain legal advice or convey attorney/client communications is exempt  | Communications between clients to gather information for attorney   |
| 28H  | RCW 42.56.290. Communications between attorney and client that reveals opinions/impressions of attorney or information prepared/collected/assembled in litigation or anticipation of litigation or related to client advice is exempt                                    | Attorney work product – communications between attorney and client  |
| 28I  | RCW 42.56.290. Communications between attorneys that reveals opinions/mental impression of attorney, or information prepared/collected/assembled in litigation or anticipation of litigation or related to client advice is exempt                                       | Attorney work product - communication between attorneys   |
| 28J  | RCW 42.56.070(1); RCW 5.60.060(2)(a), RCW 42.56.290. Notes/memoranda/statements/records that reveal factual or investigative information prepared/collected/assembled in litigation or in anticipation of litigation or related to client advice is exempt               | Attorney work product -- records that reveal attorney's thought process                                   |
| 28K  | RCW 42.56.070(1); RCW 5.60.060(2)(a), RCW 42.56.290. Drafts/notes/memoranda, research regarding opinions/impressions of attorney or attorney's agent prepared, collected, assembled in litigation or in anticipation of litigation or related to client advice is exempt | Attorney work product related to anticipated litigation, litigation, or client advice                     |
| 28L  | RCW 42.56.290. Communications between attorney and client that reveals opinions/impressions of attorney or information prepared/collected/assembled in litigation or anticipation of litigation or related to client advice is exempt                                    | Prosecuting Attorney's Office Decline Notice  |
| 29A  | RCW 42.56.370. Client records maintained by an agency that is a domestic violence program as defined in RCW 70.123.020 or .075, or a rape crisis center as defined in RCW 70.125.030 are exempt from disclosure  | Domestic Violence Program Records   |
| 29B  | RCW 42.56.370. Client records maintained by an agency that is a domestic violence program as defined in RCW 70.123.020 or .075, or a rape crisis center as defined in RCW 70.125.030 are exempt from disclosure  | Rape Crisis Center Program Records  |
| 30   | 42 USC § 12112(d)(3); RCW 42.56.070(1). Information obtained regarding the medical condition or history of an employee is treated as a confidential medical record.  | Records related to employee ADA accommodations  |
| 31A  | 42 CFR 2; RCW 42.56.070(1); RCW 70.96A.150. The registration and other records of treatment programs for chemical dependency shall remain confidential and cannot be disclosed   | Records related to the registration for chemical dependency programs                                      |
| 31B  | 42 CFR 2; RCW 42.56.070(1); RCW 70.96A.150. The registration and other records of treatment programs for chemical dependency shall remain confidential and cannot be disclosed   | Records of chemical dependency treatment programs   |
| 32A  | RCW 42.56.070(1), RCW 70.24.105. No person shall disclose the identity of a person who has requested to be tested for a sexually transmitted disease, or has had such test or HIV antibody test performed, or the results of such tests                                  | Identity of person who has requested to be tested for a sexually transmitted disease (including HIV/AIDS) |
| 32B  | RCW 42.56.070(1), RCW 70.24.105. No person shall disclose the identity of a person who has requested to be tested for a sexually transmitted disease, or has had such test or HIV antibody test performed, or the results of such tests                                  | Identity of person has had a test for a sexually transmitted disease (including HIV/AIDS)                 |





**SNOHOMISH COUNTY SHERIFF'S OFFICE**  
 INTEGRITY · DIGNITY · COMMITMENT · PRIDE

Ty Trenary, Sheriff

Personally identifiable information redacted per RCW 42.56.230.  
 Some redaction marks were applied by the originating agency and will not appear in the withholding log.

| Code | Applicable Exemption  | The cited exemption applies because the redacted/withheld information includes the following:                     |
|------|---|---|
| 32C  | RCW 42.56.070(1); RCW 70.24.105. No person shall disclose the identity of a person who has requested to be tested for a sexually transmitted disease, or has had such test or HIV antibody test performed, or the results of such tests   | Results of a test for a sexually transmitted disease (including HIV/AIDS)   |
| 33   | RCW 42.56.070(1); HIPAA, 45 CFR Part 160, 164; RCW 70.02.020; RCW 70.02.005(4). Disclosure of health care information without the patient's consent is prohibited in the PRA. Disclosure must conform to the patient's written authorization.   | Medical records and records containing specific medical information   |
| 34   | RCW 42.56.070(1); RCW 42.56.360(2); RCW 70.02.020; RCW 70.02.230; HIPAA, 45 CFR Part 160, 164; RCW 70.02.005(4). The fact of admission and all information and records compiled, obtained, or maintained in the course of providing services to either voluntary or involuntary recipients of services for mental illness at public or private agencies are confidential. Disclosure of health care information without the patient's consent is prohibited in the PRA. Disclosure must conform to the patient's written authorization. | Medical records related to receipt of services for mental illness   |
| 35   | RCW 42.56.070(1); RCW 70.02.240. The fact of admission and all information obtained through mental health treatment for minors under RCW 71.34 is confidential, except under certain circumstances  | Juvenile mental health treatment records  |
| 36   | RCW 42.56.070(1); 42 USCA §290dd-2. Records of any patient in connection with any program relating to substance abuse education, prevention, training, treatment, rehabilitation, or research, which is conducted, regulated, or directly or indirectly assisted by any department or agency of the USA shall be confidential   | Substance abuse treatment records   |
| 37   | RCW 42.56.070(1); RCW 50.13.020; RCW 42.56.410. Information/records concerning a person or employer obtained by the ESD pursuant to the administration of this title or other programs for which the ESD has responsibility shall be private and confidential, except as otherwise provided in this chapter   | Records concerning a person or employer obtained by the Employment Security Department                            |
| 38   | RCW 42.56.070(1); RCW 13.50.100(11); RCW 26.44.020(19); RCW 26.44.031(1)(4). An unfounded, screened-out, or inconclusive report of child abuse or neglect may not be produced   | Records related to an unfounded, screened out, or inconclusive report of child abuse or neglect                   |
| 39A  | RCW 42.56.070(1); RCW 18.51.190. The name of any individual complainant or other person mentioned in a nursing home complaint shall not be disclosed to the licensee  | Identity of a complainant in a nursing home complaint   |
| 39B  | RCW 42.56.070(1); RCW 18.51.190. The name of any individual complainant or other person mentioned in a nursing home complaint shall not be disclosed to the licensee  | Identity of a person mentioned in a nursing home complaint  |
| 40   | RCW 42.56.070(1); RCW 74.34.095. Reports of abandonment, abuse, financial exploitation, or neglect of vulnerable adults, the identity of the person making the report, and all records used or developed in the investigation or provision of protective services are confidential  | Reports made to protective services regarding a vulnerable adult  |
| 41A  | RCW 42.56.230(1). Personal information in any files maintained for students in public schools, patients, or clients of public institutions, or public health agencies, or welfare recipients  | Personal information in files maintained for students in public schools   |
| 41B  | RCW 42.56.230(1). Personal information in any files maintained for students in public schools, patients, or clients of public institutions, or public health agencies, or welfare recipients  | Personal information in files maintained for patients or clients of public institutions or public health agencies |
| 41C  | RCW 42.56.230(1). Personal information in any files maintained for students in public schools, patients, or clients of public institutions, or public health agencies, or welfare recipients  | Personal information in files maintained for welfare recipients   |
| 42   | RCW 42.56.070(1); RCW 74.04.060. Public assistance records for programs administered under Title 74 are confidential, except under certain circumstances  | Public assistance records   |



**SNOHOMISH COUNTY SHERIFF'S OFFICE**  
 INTEGRITY · DIGNITY · COMMITMENT · PRIDE

Ty Trenary, Sheriff

Some redaction marks were applied by the originating agency and will not appear in the withholding log.

| Code | Applicable Exemption   | The cited exemption applies because the redacted/withheld information includes the following: |
|------|--|---|
| 43A  | RCW 42.56.230(5). Credit card numbers, debit card numbers, electronic check numbers, credit expiration dates, bank/other financial information as defined in RCW 9.35.005 including social security numbers are exempt except when disclosure is expressly required by or governed by other law  | Credit or debit card number   |
| 43B  | RCW 42.56.230(5). Credit card numbers, debit card numbers, electronic check numbers, credit expiration dates, bank/other financial information as defined in RCW 9.35.005 including social security numbers are exempt except when disclosure is expressly required by or governed by other law  | Electronic check number   |
| 43C  | RCW 42.56.230(5). Credit card numbers, debit card numbers, electronic check numbers, credit expiration dates, bank/other financial information as defined in RCW 9.35.005 including social security numbers are exempt except when disclosure is expressly required by or governed by other law  | Credit expiration dates   |
| 43D  | RCW 42.56.230(5). Credit card numbers, debit card numbers, electronic check numbers, credit expiration dates, bank/other financial information as defined in RCW 9.35.005 including social security numbers are exempt except when disclosure is expressly required by or governed by other law  | Bank/other financial account numbers and balances   |
| 43E  | RCW 42.56.230(5). Credit card numbers, debit card numbers, electronic check numbers, credit expiration dates, bank/other financial information as defined in RCW 9.35.005 including social security numbers are exempt except when disclosure is expressly required by or governed by other law  | Bank or financial account codes and passwords   |
| 43F  | RCW 42.56.230(5). Credit card numbers, debit card numbers, electronic check numbers, credit expiration dates, bank/other financial information as defined in RCW 9.35.005 including social security numbers are exempt except when disclosure is expressly required by or governed by other law  | Tax identification number   |
| 43G  | RCW 42.56.230(5). Credit card numbers, debit card numbers, electronic check numbers, credit expiration dates, bank/other financial information as defined in RCW 9.35.005 including social security numbers are exempt except when disclosure is expressly required by or governed by other law  | Driver's license or permit numbers  |
| 43H  | RCW 42.56.230(5). Credit card numbers, debit card numbers, electronic check numbers, credit expiration dates, bank/other financial information as defined in RCW 9.35.005 including social security numbers are exempt except when disclosure is expressly required by or governed by other law  | State identcard numbers issued by the department of licensing                                 |
| 44A  | RCW 42.56.420(4). Information regarding the infrastructure and security of computer and telecommunications networks, consisting of security passwords, security access codes and programs, access codes for secure software applications, security and service recovery plans, security risk assessments, and security test results to the extent that they identify specific system vulnerabilities | Computer networks – security passwords  |
| 44B  | RCW 42.56.420(4). Information regarding the infrastructure and security of computer and telecommunications networks, consisting of security passwords, security access codes and programs, access codes for secure software applications, security and service recovery plans, security risk assessments, and security test results to the extent that they identify specific system vulnerabilities | Computer networks – security access codes   |
| 44C  | RCW 42.56.420(4). Information regarding the infrastructure and security of computer and telecommunications networks, consisting of security passwords, security access codes and programs, access codes for secure software applications, security and service recovery plans, security risk assessments, and security test results to the extent that they identify specific system vulnerabilities | Computer networks – security access programs  |

**SNOHOMISH COUNTY SHERIFF'S OFFICE**  
 INTEGRITY · DIGNITY · COMMITMENT · PRIDE



**Ty Trenary, Sheriff**

Some redaction marks were applied by the originating agency and will not appear in the withholding log.

| Code | Applicable Exemption   | The cited exemption applies because the redacted/withheld information includes the following:              |
|------|--|--|
| 44D  | RCW 42.56.420(4). Information regarding the infrastructure and security of computer and telecommunications networks, consisting of security passwords, security access codes and programs, access codes for secure software applications, security and service recovery plans, security risk assessments, and security test results to the extent that they identify specific system vulnerabilities | Computer networks – access codes for secure software applications  |
| 44E  | RCW 42.56.420(4). Information regarding the infrastructure and security of computer and telecommunications networks, consisting of security passwords, security access codes and programs, access codes for secure software applications, security and service recovery plans, security risk assessments, and security test results to the extent that they identify specific system vulnerabilities | Computer networks – security and service recovery plans  |
| 44F  | RCW 42.56.420(4). Information regarding the infrastructure and security of computer and telecommunications networks, consisting of security passwords, security access codes and programs, access codes for secure software applications, security and service recovery plans, security risk assessments, and security test results to the extent that they identify specific system vulnerabilities | Computer networks – security risk assessments  |
| 44G  | RCW 42.56.420(4). Information regarding the infrastructure and security of computer and telecommunications networks, consisting of security passwords, security access codes and programs, access codes for secure software applications, security and service recovery plans, security risk assessments, and security test results to the extent that they identify specific system vulnerabilities | Computer networks – security test results to the extent that they identify specific system vulnerabilities |
| 45A  | RCW 42.56.420(4). Information regarding the infrastructure and security of computer and telecommunications networks, consisting of security passwords, security access codes and programs, access codes for secure software applications, security and service recovery plans, security risk assessments, and security test results to the extent that they identify specific system vulnerabilities | Telecommunications networks – security passwords   |
| 45B  | RCW 42.56.420(4). Information regarding the infrastructure and security of computer and telecommunications networks, consisting of security passwords, security access codes and programs, access codes for secure software applications, security and service recovery plans, security risk assessments, and security test results to the extent that they identify specific system vulnerabilities | Telecommunications networks – security access codes  |
| 45C  | RCW 42.56.420(4). Information regarding the infrastructure and security of computer and telecommunications networks, consisting of security passwords, security access codes and programs, access codes for secure software applications, security and service recovery plans, security risk assessments, and security test results to the extent that they identify specific system vulnerabilities | Telecommunications networks – security access programs   |
| 45D  | RCW 42.56.420(4). Information regarding the infrastructure and security of computer and telecommunications networks, consisting of security passwords, security access codes and programs, access codes for secure software applications, security and service recovery plans, security risk assessments, and security test results to the extent that they identify specific system vulnerabilities | Telecommunications networks – access codes for secure software applications                                |
| 45E  | RCW 42.56.420(4). Information regarding the infrastructure and security of computer and telecommunications networks, consisting of security passwords, security access codes and programs, access codes for secure software applications, security and service recovery plans, security risk assessments, and security test results to the extent that they identify specific system vulnerabilities | Telecommunications networks – security and service recovery plans  |
| 45F  | RCW 42.56.420(4). Information regarding the infrastructure and security of computer and telecommunications networks, consisting of security passwords, security access codes and programs, access codes for secure software applications, security and service recovery plans, security risk assessments, and security test results to the extent that they identify specific system vulnerabilities | Telecommunications networks – security risk assessments  |
| 45G  | RCW 42.56.420(4). Information regarding the infrastructure and security of computer and telecommunications networks, consisting of security passwords, security access codes and programs, access codes for secure software applications, security and service recovery plans, security risk assessments, and security test results to the extent that they identify specific system vulnerabilities | Telecommunications networks – security test results because they identify specific system vulnerabilities  |
| 46   | RCW 42.56.070(1); Federal Copyright Act, 17 USC § 102, 301 and 106(1). Reproduction of records prohibited under copyright law  | Copyrighted material   |



**SNOHOMISH COUNTY SHERIFF'S OFFICE**  
 INTEGRITY · DIGNITY · COMMITMENT · PRIDE

**Ty Trenary, Sheriff**

Some redaction marks were applied by the originating agency and will not appear in the withholding log.

| Code | Applicable Exemption  | The cited exemption applies because the redacted/withheld information includes the following:   |
|------|---|---|
| 47   | RCW 42.56.070(1); RCW 19.108 et seq. Information that derives independent economic value from not being generally known and is the subject of efforts that are reasonable under the circumstances to maintain its secrecy   | Trade secret information  |
| 48   | RCW 42.56.280. Preliminary drafts, notes, recommendations, intra-agency memos in which opinions are expressed, policies formulated or recommended are exempt, except that a specific record is not exempt when publicly cited by agency in connection with agency action  | Records that relate to a deliberative process that is still on-going; disclosure would injure the deliberative or consultative function of the process; disclosure would inhibit the flow of recommendations, observations, and opinions; AND the records reflect policy recommendations and opinions |
| 49   | RCW 42.56.070(1); RCW 46.52.080-085. Traffic collision reports may only be released to specific individuals in specific circumstances. To obtain this report, please contact the below website, complete the form, and submit with payment to the address provided: <a href="http://www.wsp.wa.gov/publications/collision.htm">http://www.wsp.wa.gov/publications/collision.htm</a>   | Traffic collision reports   |
| 50   | RCW 42.56.070(1); RCW 9.73.090(1)(c). No sound or video recording made under this subsection may be duplicated and made available to the public by a law enforcement agency subject to this section until final disposition of any criminal or civil litigation which arises from the event(s) which were recorded  | Dash camera video of an event that is still the subject of active, pending criminal or civil litigation   |
| 51A  | RCW 42.56.230(3); RCW 42.56.050. personal information maintained for employee, appointee, elected official to the extent disclosure violates right to privacy   | Birth certificate – employee or dependent   |
| 51B  | RCW 42.56.230(3); RCW 42.56.050. personal information maintained for employee, appointee, elected official to the extent disclosure violates right to privacy   | Death certificate – employee or dependent   |
| 51C  | RCW 42.56.230(3); RCW 42.56.050. personal information maintained for employee, appointee, elected official to the extent disclosure violates right to privacy   | Marriage certificate/license – employee or dependent  |
| 51D  | RCW 42.56.230(3); RCW 42.56.050 Personal information maintained for employee, appointee, elected official to the extent disclosure violates right to privacy  | Information regarding an employee's benefits selections   |
| 52   | RCW 42.56.070(1); RCW 7.68.140. Information contained in the claim files and records of victims, under the provisions of this chapter, shall be deemed confidential and shall not be open to public inspection  | Records regarding a victims claim under the Crime Victim's Compensation Act   |
| 53A  | RCW 42.56.260(1)(a) The contents of real estate appraisals, made for or by any agency relative to the acquisition or sale of property. RCW 42.56.260(2) The exemption does not apply when disclosure is mandated by another statute or after the project or prospective project is abandoned or all properties that are part of the project have been purchased, sold, or leased. No appraisal may be withheld for more than three years. | Real estate appraisal related to the acquisition or sale of property by the County. The project has not been abandoned, all properties related to the project have not been purchased, sold, or leased, and the appraisal is less than three years old.   |



**SNOHOMISH COUNTY SHERIFF'S OFFICE**  
 INTEGRITY · DIGNITY · COMMITMENT · PRIDE

Ty Trenary, Sheriff

Some redaction marks were applied by the originating agency and will not appear in the withholding log.

| Code | Applicable Exemption  | The cited exemption applies because the redacted/withheld information includes the following:   |
|------|---|---|
| 53B  | RCW 42.56.260(1)(b) Documents prepared for the purpose of considering the selection of a site or the acquisition of real estate by lease or purchase when public knowledge regarding such consideration would cause a likelihood of increased price, including records prepared for executive session pursuant to RCW 42.13.110(1)(b). RCW 42.56.260(2) The exemption does not apply when disclosure is mandated by another statute or after the project or prospective project is abandoned or all properties that are part of the project have been purchased, sold, or leased. No appraisal may be withheld for more than three years. | Documents prepared for the purpose of considering selection of a site or acquisition of real estate. Public knowledge would cause a likelihood of increased price. The project has not been abandoned, all properties related to the project have not been purchases, sold, or leased, and the appraisal is less than three years old.  |
| 53C  | RCW 42.56.260(1)(c) Documents prepared for the purpose of considering the minimum price of real estate that will be offered for sale or lease when public knowledge regarding such consideration would cause a likelihood of decreased price, including records prepared for executive session pursuant to RCW 42.30.110(1)(c). RCW 42.56.260(2) The exemption does not apply when disclosure is mandated by another statute or after the project or prospective project is abandoned or all properties that are part of the project have been purchased, sold, or leased. No appraisal may be withheld for more than three years.        | Documents prepared for the purpose of considering the minimum price of real estate that will be offered by the County for sale or lease. Public knowledge regarding such consideration would cause a likelihood of decreased price. The project has not been abandoned, all properties related to the project have not been purchases, sold, or leased, and the appraisal is less than three years old. |
| 54   | RCW 42.56.300(1) Records, maps, or other information identifying the location of archaeological sites in order to avoid the looting or depredation of such sites are exempt from disclosure under this chapter.   | Information that identifies the location of archaeological sites  |
| 55a  | RCW 26.23.120(1) Any information or records concerning individuals who owe a support obligation or for whom support enforcement services are being provided which are obtained or maintained by the Washington state support registry, the division of child support, or under chapter 74.20 RCW shall be private and confidential.   | Information concerning individuals who owe a child support obligation   |
| 55b  | RCW 26.23.120(1) Any information or records concerning individuals who owe a support obligation or for whom support enforcement services are being provided which are obtained or maintained by the Washington state support registry, the division of child support, or under chapter 74.20 RCW shall be private and confidential.   | Information concerning individuals for whom child support enforcement services are being provided   |
| 56   | RCW 42.56.070(1); RCW 9.68A.050 Duplication or dissemination of a minor engaged in sexually explicit conduct is a crime.  | Depiction of a minor engaged in sexually explicit conduct   |
| 57   | RCW 71.05.620 Files and records of court proceedings under Chapter 71.05 are closed and accessible only to the subject of the petition, that person's attorney, guardian ad litem, resource management services, or service providers authorized to receive such information by resource management services.   | Files and records of a court proceeding under Chapter 71.05 and the requestor is not authorized to receive the information.   |
| 58   | RCW 42.56.600 Records of mediation communications that are privileged under chapter 7.07 RCW are exempt from disclosure under this chapter.   | Mediation communications that are privileged under chapter 7.07 RCW.  |



# SNOHOMISH COUNTY SHERIFF'S OFFICE

INTEGRITY · DIGNITY · COMMITMENT · PRIDE

Ty Trenary, Sheriff

Some redaction marks were applied by the originating agency and will not appear in the withholding log.

| Code | Applicable Exemption   | The cited exemption applies because the redacted/withheld information includes the following: |
|------|--|---|
| 59   | RCW 42.56.240(4); RCW 42.56.070(1); RCW 9.41.129. The department of licensing may keep copies or records of applications for concealed pistol licenses provided for in RCW 9.41.070, copies or records of applications for alien firearm licenses, copies or records of applications to purchase pistols provided for in RCW 9.41.090, and copies or records of pistol transfers provided for in RCW 9.41.110. The copies and records shall not be disclosed except as provided in RCW 42.56.240(4).<br>42.56.240(4) License applications under RCW 9.41.070; copies of license applications or information on the applications may be released to law enforcement or corrections agencies | Concealed pistol license application  |