

BEFORE THE WASHINGTON PUBLIC SERVICE COMMISSION

In the Matter of the Application of)	
GOLDENDALE NATURAL GAS CO.,)	
INC. for a Certificate of Public)	CAUSE NO. U-9038
Convenience and Necessity to Operate)	
a Gas Plant for Hire in the General)	ORDER GRANTING
Area or Areas of Goldendale,)	APPLICATION
Washington)	
.)	

The Goldendale Natural Gas Co., Inc, a Washington corporation, on April 25, 1958, filed with the Commission an application for a Certificate of Public Convenience and Necessity to Operate a Gas Plant for Hire in Goldendale, Washington, and vicinity. At present the company is not certified or operating a gas plant for hire in any other area in this State.

The company's application encompasses the City of Goldendale and immediate environs plus a narrow strip of land from its main service area to the Pacific Northwest Pipeline Corporation's main pipeline, a distance of about 2.8 miles. Goldendale Natural Gas Co., Inc. will install and own the gas transmission line from Pacific's pipeline to its distribution system.

Goldendale is a city with a population of about 2,500 and is the county seat of Klickitat County. It is in the center of an agriculture and forest area and with the exception of two sawmills there is practically no industry in the city. The company bases its feasibility study primarily on prospective residential and commercial gas sales.

Goldendale Natural Gas Co., Inc. is the only company that has requested a certificate to supply natural gas service to the Goldendale area where there presently is no gas distribution system. The company has secured a franchise from the City of Goldendale to install and operate plant facilities for the distribution of natural gas within the incorporated limits of the city.

A feasibility study supporting the company's application appears to show rather meager earnings for the first five years under the proposed gas rates. While the Commission would prefer to see a more prosperous immediate future for the company, it is reluctant to question the judgment of the company's officers to supply gas service in Goldendale. Especially since the Commission is aware the company officers are experienced in the natural gas field with a record of successfully operating gas distribution systems comparable to the proposed Goldendale operation.

Half of the outstanding stock in the Goldendale company is owned by the Hardrock Oil Company, a financially successful Montana corporation, with its headquarters in Great Falls, Montana. This same company has a controlling interest in the Eastern Washington Natural Gas Company, Inc., who are certificated and operate gas systems in Ritzville and Endicott, Washington. It is expected that a first mortgage will provide about 65% of the cost of installing the proposed plant facilities and no difficulty is expected in obtaining all necessary financing.

While no contract has been consummated for a supply of natural gas there appears to be no problem on that matter as the company has received verbal assurance the gas is available.

FINDINGS OF FACT

1. Goldendale Natural Gas Co., Inc., a Washington corporation, at present is not an operating or regulated utility.
2. Goldendale Natural Gas Co., Inc. has applied for a Certificate of Public Convenience and Necessity to Operate a Gas Plant for Hire in Goldendale, Washington, and certain areas adjacent thereto.
3. At present there is no company operating a gas plant or certificated to operate a gas plant for hire in the area under question.
4. There are no other applications for a certificate covering the area sought by Goldendale Natural Gas Co., Inc.
5. Goldendale Natural Gas Co., Inc. appears to be fully qualified to provide natural gas service in the area it seeks certification.
6. Goldendale Natural Gas Co., Inc. will be able to obtain an adequate supply of natural gas to serve the present and future anticipated demands of the requested area.
7. The operation of a gas plant for hire by Goldendale Natural Gas Co., Inc. in the area it proposes to serve is or will be in the interest of public convenience and necessity.
8. Goldendale Natural Gas Co., Inc. should be granted a Certificate of Public Convenience and Necessity to Operate a Gas Plant for Hire in the Goldendale, Washington, area as delineated in its application of April 25, 1958.

ORDER

IT IS HEREBY ORDERED That the application of Goldendale Natural Gas Co., Inc. for a Certificate of Public Convenience and Necessity to Operate a Gas Plant for Hire be approved and a certificate granted to encompass an area as follows:

- (a) Main service area -- All of Secs. 16, 17, 20 and 21 in T 4 N, R 16 E, W.M., including the City of Goldendale, Klickitat County, Washington.
- (b) Transmission line area. City gate to south boundary of main service area -- A strip of land 300 feet in width, being 150 feet on each side of a line described as follows: Commencing at the southeast corner of the west half of Sec. 21, T 4 N, R 16 E, W.M.; thence directly south to the Pacific Northwest Pipeline Corporation's 26-inch main pipeline, which is approximately 3,400 feet south of the north line of Sec. 4, T 3 N, R 16 E, W.M., all in the County of Klickitat, State of Washington

As further shown on Appendix A-1 attached hereto and by this reference made a part hereof.

IT IS FURTHER ORDERED That jurisdiction over this cause is retained to effectuate the provisions of this order.

DATED at Olympia, Washington, and effective this 7th day of May, 1958.

WASHINGTON PUBLIC SERVICE COMMISSION

FRANCIS PEARSON, Chairman

JOSEPH STARIN, Commissioner

GEORGE F. PARKS, Commissioner

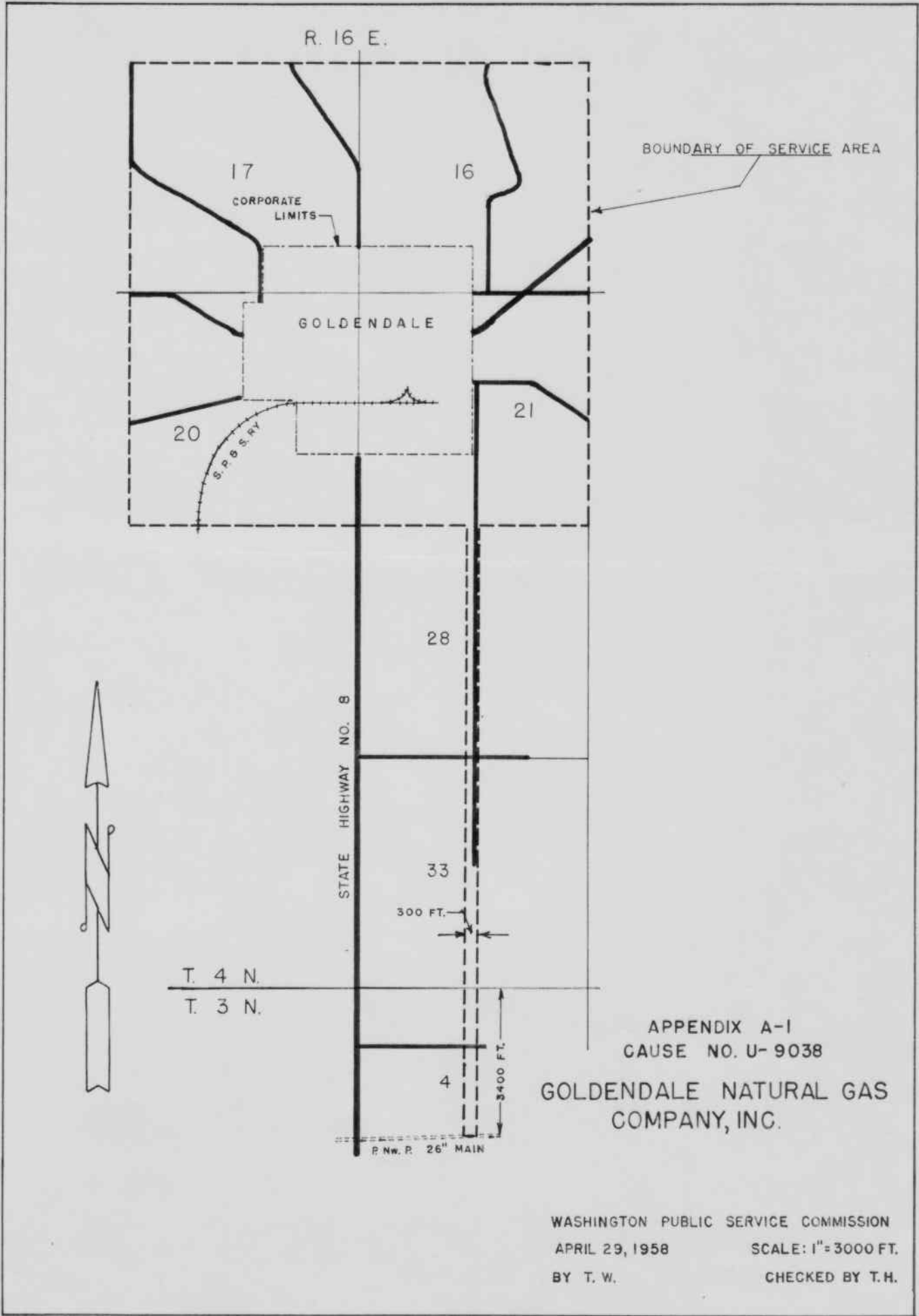

R. 16 E.

17
CORPORATE
LIMITS

16

BOUNDARY OF SERVICE AREA

GOLDENDALE

20

S.P. & S. RY

21

28

STATE HIGHWAY NO. 8

33

300 FT.

T. 4 N.

T. 3 N.

4

3400 FT.

P.N.W.P. 26" MAIN

APPENDIX A-1
CAUSE NO. U-9038

GOLDENDALE NATURAL GAS
COMPANY, INC.

WASHINGTON PUBLIC SERVICE COMMISSION
APRIL 29, 1958
BY T. W.
SCALE: 1" = 3000 FT.
CHECKED BY T. H.