

BEFORE THE WASHINGTON UTILITIES AND TRANSPORTATION COMMISSION

In the Matter of the Application of )	
WASHINGTON NATURAL GAS COMPANY for a )	CAUSE NO. U-71-28 gc
Certificate of Public Convenience )	
and Necessity to Operate a Gas Plant )	ORDER GRANTING
for Hire in the general area or areas )	APPLICATION
of Snohomish, King, Pierce, Thurston )	
and Lewis Counties. )	
. . . . . )	

May 3, 1971, Washington Natural Gas Company, a Delaware corporation, filed in Cause No. U-71-28 gc, an application to amend its Certificate of Public Convenience and Necessity to Operate a Gas Plant for Hire No. 2, amended, to include additional area in Pierce County.

Washington Natural is presently certificated for and is now providing gas service in the above-noted county. The additional area applied for is contiguous to the company's present service area.

FINDINGS AND CONCLUSIONS

1. Washington Natural Gas Company, a Delaware corporation, operates a gas plant for hire in this state and is subject to the jurisdiction of this Commission.
2. Washington Natural Gas Company has heretofore been issued Certificate of Public Convenience and Necessity to Operate a Gas Plant for Hire, No. 2 amended.
3. Washington Natural Gas Company filed an application that its Certificate of Public Convenience and Necessity to Operate a Gas Plant for Hire be amended to encompass additional area contiguous to its presently certificated areas in Pierce County.
4. Based on Washington Natural Gas Company's feasibility study, it appears the company's plan to provide gas service in the additional area applied for is economically justified.
5. The operation of a gas plant for hire in the additional area requested by the Washington Natural Gas Company is or will be required by public convenience and necessity.
6. Washington Natural Gas Company has adequate gas supply available to serve this additional area.
7. The Certificate of Public Convenience and Necessity to Operate a Gas Plant for Hire presently held by the Washington Natural Gas Company should be amended to encompass the additional area applied for in this Cause.

O R D E R

1. IT IS HEREBY ORDERED That the application of the Washington Natural Gas Company to amend its Certificate of Public Convenience and Necessity to Operate a Gas Plant for Hire to encompass additional area contiguous to its presently certificated areas in Pierce County, is approved, and the company's present Certificate of Public Convenience and Necessity to Operate a Gas Plant for Hire be amended to encompass the area delineated as follows:

All of the incorporated cities of Tacoma, Ruston, Fircrest, Steilacoom, the communities of Lakeview, Brookdale, Parkland, and additional portions of King County and Pierce County adjacent thereto lying with the area described as follows:

Beginning at the point where the easterly line of Puget Sound intersects the east line of Sec. 1, T 21 N, R 3 E.W.M.; thence following the easterly line of Puget Sound and its bays and estuaries through Tps. 21 and 20, and into T 19 to the intersection of the west line of Sec. 14, T 19 N, R 1 E; thence south along the west lines of Secs. 14, 23, 26, and 35, T 19 N, R 1 E.W.M., to the southwest corner of said Sec. 35; thence east to the southeast corner of Sec. 34, T 19 N, R 4 E; thence south to the southwest corner of Sec. 14, east to the southeast corner of Sec. 13; thence north to the northeast corner of Sec. 1, all in T 18 N, R 3 E; thence east to the southeast corner of Sec. 35; thence north to the northeast corner of Sec. 11; thence west to the northwest corner of Sec. 7, all in T 19 N, R 4 E; thence north to the intersection of the east line of Sec. 1, T 21 N, R 3 E, with the easterly line of Puget Sound, the point of beginning,

and as further shown on Appendix A-4, amended, attached hereto and by this reference made a part hereof.

2. IT IS FURTHER ORDERED That the Certificate of Public Convenience and Necessity to Operate a Gas Plant for Hire issued pursuant to Order Paragraph No. 1 above, supersedes and cancels Certificate of Public Convenience and Necessity to Operate a Gas Plant for Hire No. 2, as amended and issued to Washington Natural Gas Company on November 19, 1968, in Cause No. U-9872. Said Certificate of November 19, 1968 should be forthwith returned to this Commission.

3. IT IS FURTHER ORDERED That jurisdiction over this Cause is retained to effectuate the provisions of this order and future consideration to determine alterations, if any, to be made to the Certificate issued pursuant to Order Paragraph No. 1 above, to conform to the requirements of public convenience and necessity as the same may then be made to appear.

U-71-28 gc

3.

DATED at Olympia, Washington and effective this 28th day of May, 1971.

WASHINGTON UTILITIES AND TRANSPORTATION COMMISSION

*Donald H. Brazier*  
DONALD H. BRAZIER, JR., Chairman

*Francis Pearson*  
FRANCIS PEARSON, Commissioner

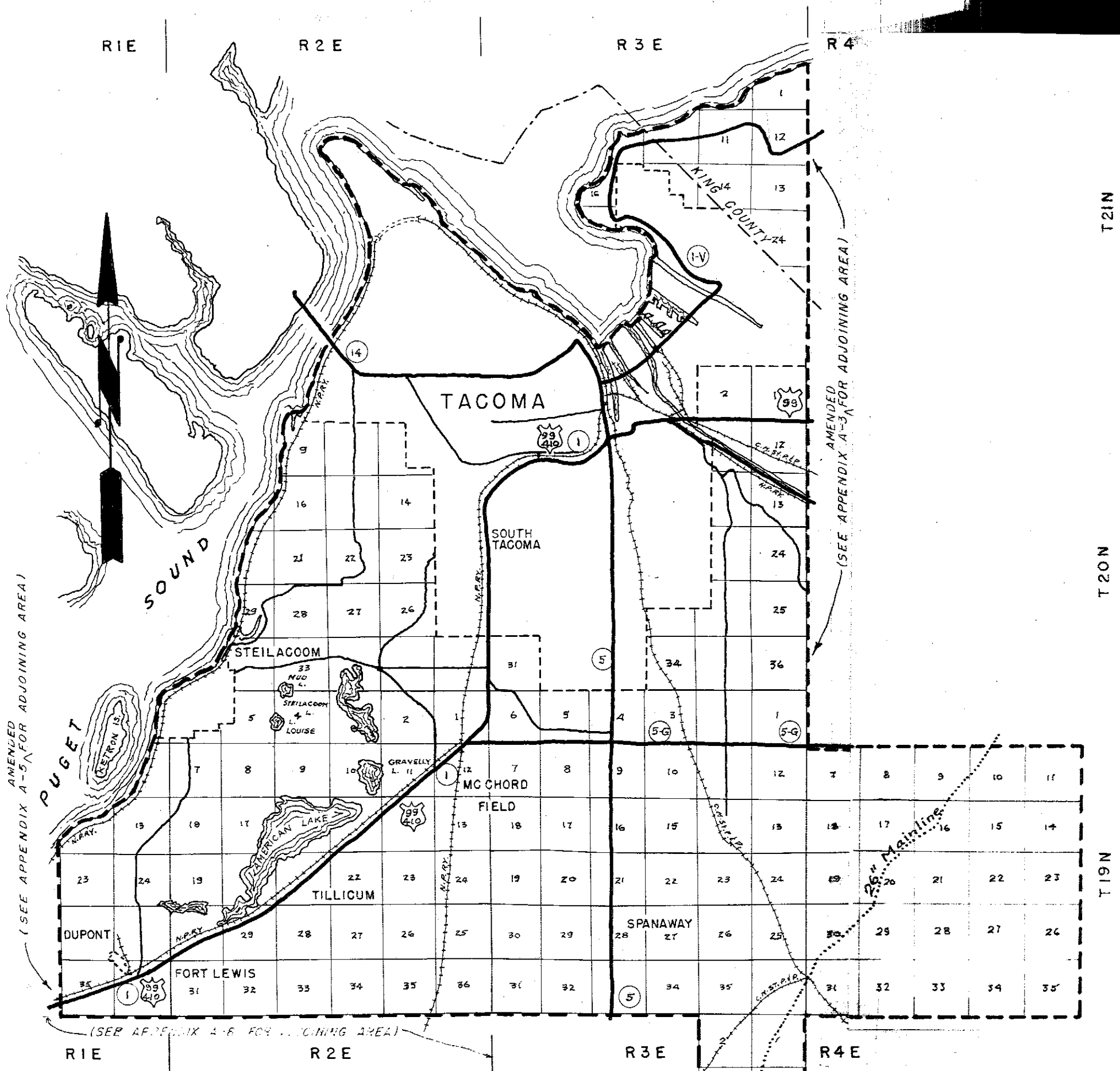

AMENDED (SEE APPENDIX A-5 FOR ADJOINING AREA)

AMENDED (SEE APPENDIX A-3 FOR ADJOINING AREA)

T21N

T20N

T19N

(SEE APPENDIX A-11 FOR ADJOINING AREA)

APPENDIX A-4 (AMENDED)  
 CAUSE NO. U-71-28 GC  
 WASHINGTON NATURAL GAS COMPANY  
 BOUNDARY OF SERVICE AREA ————  
 (TACOMA & VICINITY - KING & PIERCE COUNTIES)

WASHINGTON  
 UTILITIES AND TRANSPORTATION  
 COMMISSION

JUNE 29, 1962  
 REVISED 5/27/74

BY: D.H.  
 BY: T.W.