



RECEIVED
STATE OF WASHINGTON
JUL 30 2004 15
UTILITY DIVISION
COMMERCIAL

July 30, 2004

BY OVERNIGHT MAIL

Ms. Carole J. Washburn, Executive Secretary
Washington Utilities and Transportation Commission
P.O. Box 47250
Olympia, WA 98504-7250

**Re: PSE Service Quality Program - Gas Emergency Response Plans Report
Docket Nos. UE-011570 and UG-011571**

Dear Ms. Washburn:

Pursuant to Exhibit J of the Settlement Stipulation Re Service Quality Index (SQI) in Docket Nos. UE-011570 and UG-011571, Puget Sound Energy ("PSE" or "the Company") provides herewith an original and 12 copies of PSE's Service Quality Program – Gas Emergency Response Plans Report for the six-month period ending June 2004.

The enclosed report includes detailed response plans for each of the following areas:

- ✓ Winlock,
- ✓ Vashon Island,
- ✓ Toledo,
- ✓ Kittitas County, and
- ✓ Centralia / Chehalis

The response plans filed herewith have been redacted for security purposes and are available for viewing without redaction at the Company's offices in Bellevue, Washington.

The Company hopes the information contained in this report is helpful. PSE would be happy to meet with interested parties to discuss more fully the data elements included in the enclosed report and to discuss how the report might be modified if necessary, in order to meet any additional data needs.

Ms. Carole J. Washburn

July 30, 2004

Page 2

If you have any questions regarding this report, please contact Colleen Paulson at 425-462-3205.

Sincerely,

A handwritten signature in black ink, appearing to read 'K. Karzmar', with a long horizontal stroke extending to the right.

Karl R. Karzmar

Director, Regulatory Relations

Enclosures

cc: Joelle Steward – Washington Utilities & Transportation Commission
Mary Kimball – Public Counsel
Chuck Eberdt – Opportunity Council

Centralia/Chehalis

EMERGENCY RESPONSE PLAN

TABLE OF CONTENTS

Centralia/Chehalis

| | |
|------------------------------|---|
| Users Guide..... | 2 |
| How it will be served | 3 |
| Regular business hours | 3 |
| After hours | 3 |
| Floods..... | 3 |

PSE Staff

| | |
|---------------------------------------|---|
| Who reside in Centralia/Chehalis..... | 4 |
| Who work in Centralia/Chehalis | 4 |
| Live near Centralia/Chehalis..... | 5 |

Maps

| | |
|---------------------------------------|----|
| Directions to Centralia Base | 6 |
| City Map Centralia..... | 7 |
| Gas Operations Map Key Centralia..... | 8 |
| Plat Map Key Centralia | 9 |
| Directions to Chehalis | 10 |
| City Map Chehalis | 11 |
| Gas Operations Map Key Chehalis | 12 |
| Plat Map Key Chehalis..... | 13 |

Service Provider

| | |
|----------------------------------|----|
| Roles and Responsibilities | 14 |
|----------------------------------|----|

Pagination on redacted version may differ due to redaction and font change.

USERS GUIDE

Dispatch

| | |
|---|-----|
| PSE Staff | 4,5 |
| City Map Centralia..... | 7 |
| Gas Operations Map Key Centralia..... | 8 |
| Plat Map Key Centralia | 9 |
| City Map Chehalis | 11 |
| Gas Operations Map Key Chehalis | 12 |
| Plat Map Key Chehalis | 13 |
| Roles and responsibility of Service Providers | 14 |

First Responders

| | |
|---|-----|
| PSE Staff | 4,5 |
| City Map Centralia..... | 7 |
| Gas Operations Map Key Centralia..... | 8 |
| Plat Map Key Centralia | 9 |
| City Map Chehalis | 11 |
| Gas Operations Map Key Chehalis | 12 |
| Plat Map Key Chehalis | 13 |
| Roles and responsibility of Service Providers | 14 |

CFS

| | |
|---|-----|
| PSE Staff | 4,5 |
| City Map Centralia..... | 7 |
| Gas Operations Map Key Centralia..... | 8 |
| Plat Map Key Centralia | 9 |
| City Map Chehalis | 11 |
| Gas Operations Map Key Chehalis | 12 |
| Plat Map Key Chehalis | 13 |
| Roles and responsibility of Service Providers | 14 |

Gas Control

PSE Staff4,5
City Map Centralia.....7
Gas Operations Map Key Centralia.....8
Plat Map Key Centralia9
City Map Chehalis11
Gas Operations Map Key Chehalis12
Plat Map Key Chehalis13
Roles and responsibility of Service Providers14

EMERGENCY RESPONSE PLAN

Centralia/Chehalis

How Centralia/Chehalis will be served

Regular business hours:

During regular business hours we will utilize employees who are working in Centralia/Chehalis. This could include Gas First Response, SC&P, or Pilchuck personnel.

After Hours:

We have identified those gas employees that live in and in close proximity to Centralia/Chehalis. Outside of normal business hours we will contact the Gas First Response employees who live in Centralia/Chehalis. (If these employees know they will be unavailable they will notify Dispatch). If the resident employees are not available, we will notify the staff identified that lives near Centralia/Chehalis, if that fails, we will move First Responders per the standard callout process, which dispatch the closest GFR personnel to the problem.

Floods:

Lewis County has had numerous 100-year floods in the past several years; this area is prone to flooding. This area may be closed to any traffic except for emergency vehicles and local traffic. In the past I-5 has been shut down. During flooding, the best way to get there may be through Littlerock or Bucoda. The Cities of Centralia, Chehalis and Lewis Co. generally inform PSE of any wash outs or any other road problems. Portions of the distribution system may need to be shut down in case of flooding.

Alternative Access:

If access by conventional means is unavailable, you may be able to deliver personnel and materials to the Centralia/Chehalis area by helicopter. The System Manager *TELEPHONE NUMBER REDACTED* on duty should be called to arrange helicopter support.

PSE STAFF WHO RESIDE IN CENTRALIA/CHEHALIS

NAME REDACTED (Gas)
ADDRESS REDACTED
Centralia, WA 98531
Home phone: *NUMBER REDACTED*
Cell phone: *NUMBER REDACTED*
Pager: *NUMBER REDACTED*

NAME REDACTED (Gas)
ADDRESS REDACTED
Centralia, WA 98531
Home phone: *NUMBER REDACTED*
Cell phone: *NUMBER REDACTED*
Pager: *NUMBER REDACTED*

NAME REDACTED (Gas)
ADDRESS REDACTED
Chehalis, WA 98532
Home phone: *NUMBER REDACTED*
Cell phone: *NUMBER REDACTED*
Pager: *NUMBER REDACTED*

PSE STAFF WHO WORK IN CENTRALIA/CHEHALIS

NAME REDACTED (Gas)
ADDRESS REDACTED
Toledo, WA 98591
Home phone: *NUMBER REDACTED*
Cell phone: *NUMBER REDACTED*
Pager: *NUMBER REDACTED*

NAME REDACTED (Gas)
ADDRESS REDACTED
Chehalis, WA 98532
Home phone: NUMBER REDACTED
Cell phone: NUMBER REDACTED
Pager: NUMBER REDACTED

NAME REDACTED (Gas)
ADDRESS REDACTED
Rochester, WA 98579
Home phone: NUMBER REDACTED
Cell phone: NUMBER REDACTED
Pager: NUMBER REDACTED

PSE STAFF WHO LIVE NEAR CENTRALIA/CHEHALIS

NAME REDACTED (Gas)
ADDRESS REDACTED
Rochester, WA 98579
Home phone: NUMBER REDACTED
Cell phone: NUMBER REDACTED
Pager: NUMBER REDACTED

DIRECTIONS/CENTRALIA OPERATING BASE (From Olympia)

DIRECTIONS REDACTED

Total Estimated Driving Time from Olympia: 31 minutes

Total Distance: Approximately 28 miles

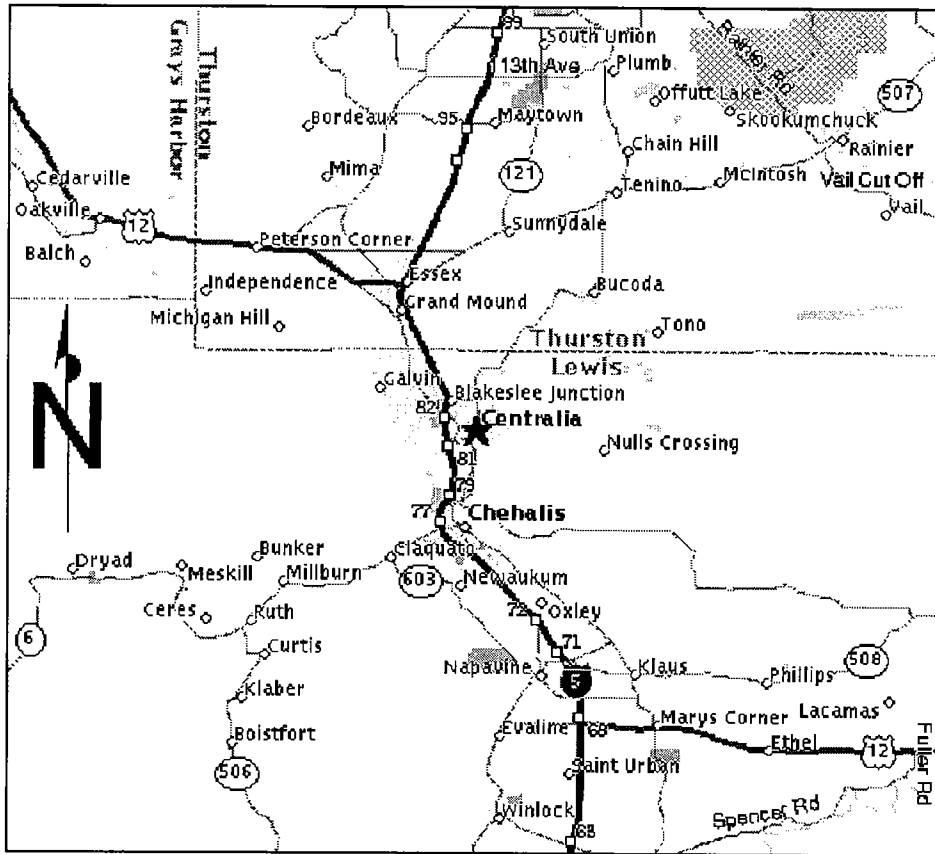

CITY MAP

Centralia

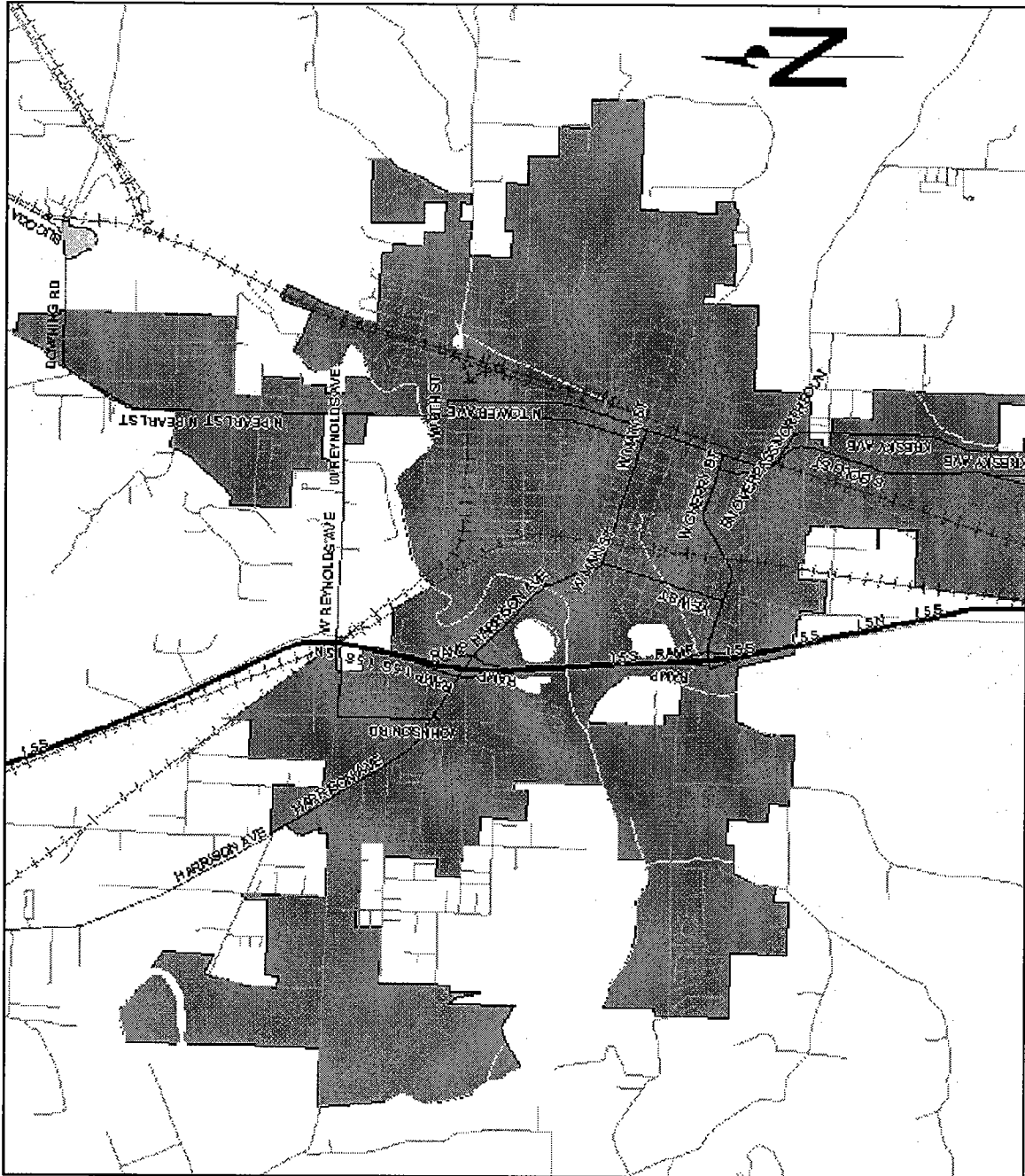

OPERATIONS MAP KEY

Centralia

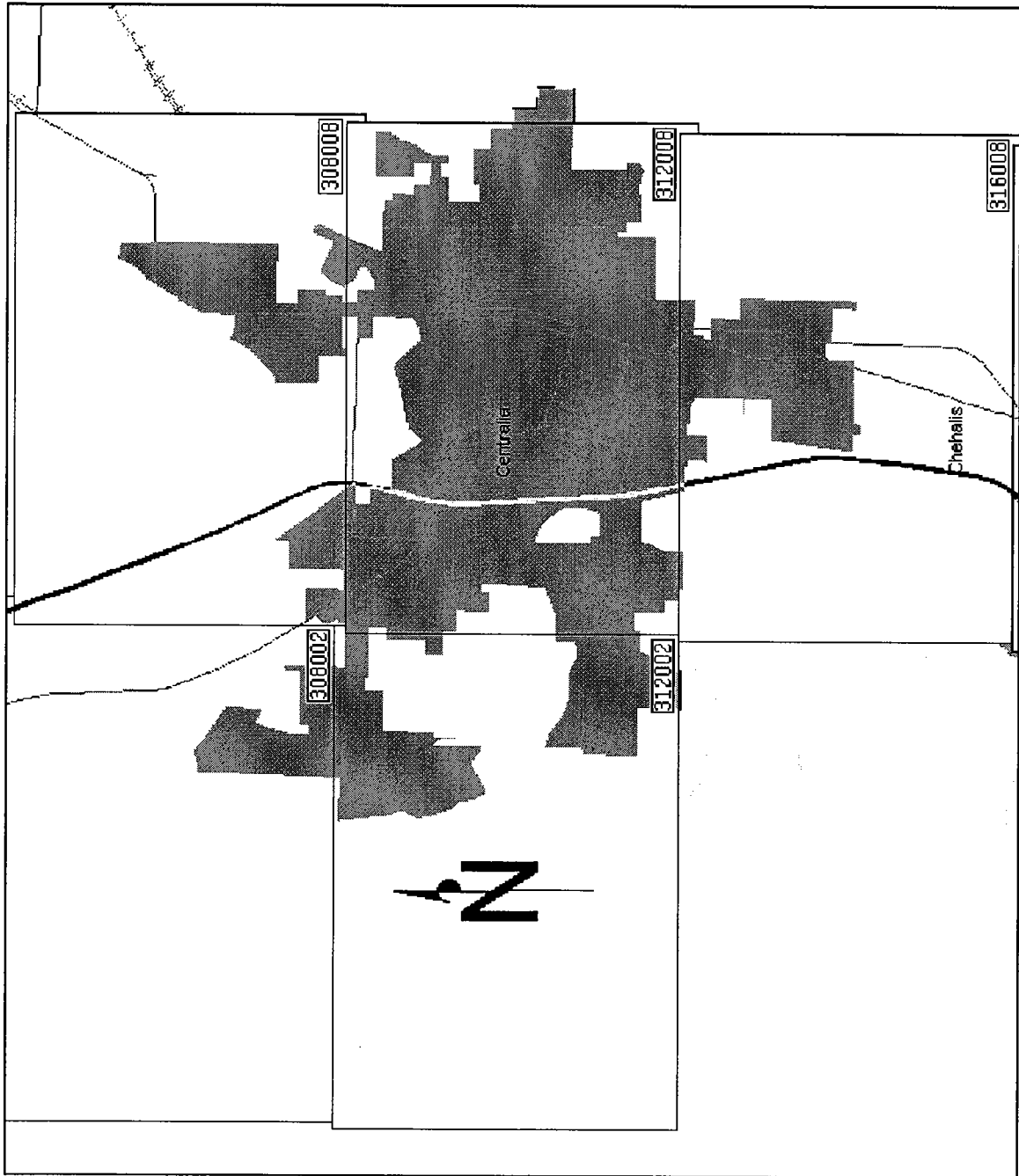

DIRECTIONS/CHEHALIS (From Olympia)

DIRECTIONS REDACTED

Total Estimated Driving Time from Olympia: 32 minutes
Total Distance: 30.71 miles

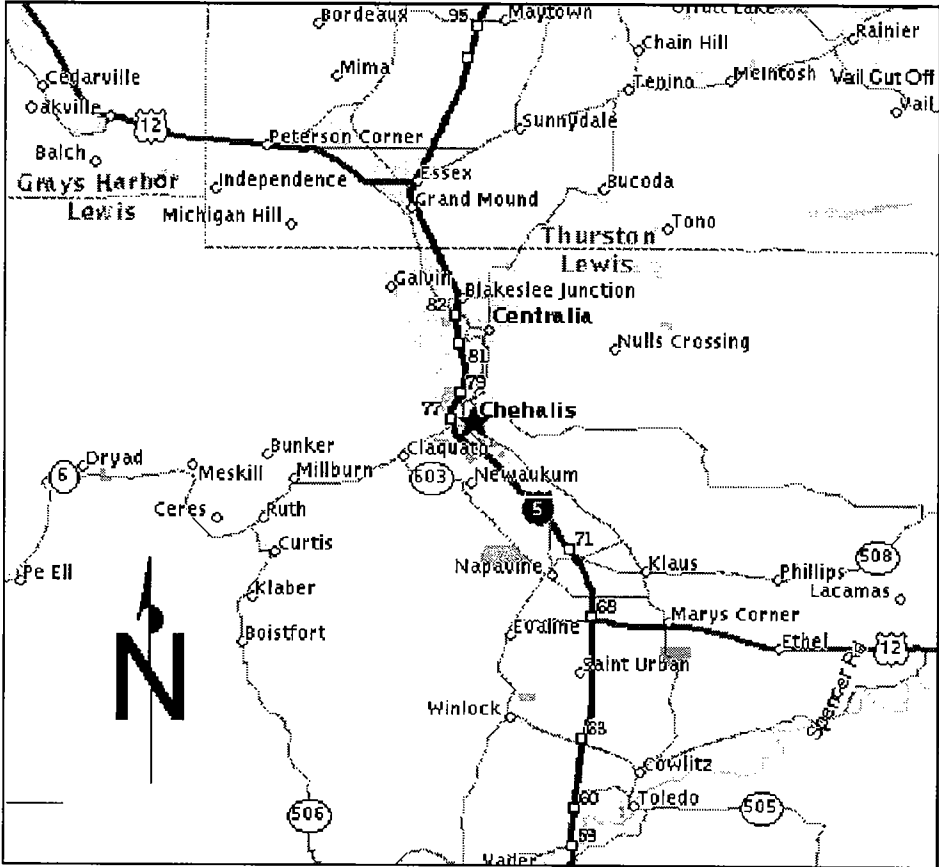

CITY MAP Chehalis

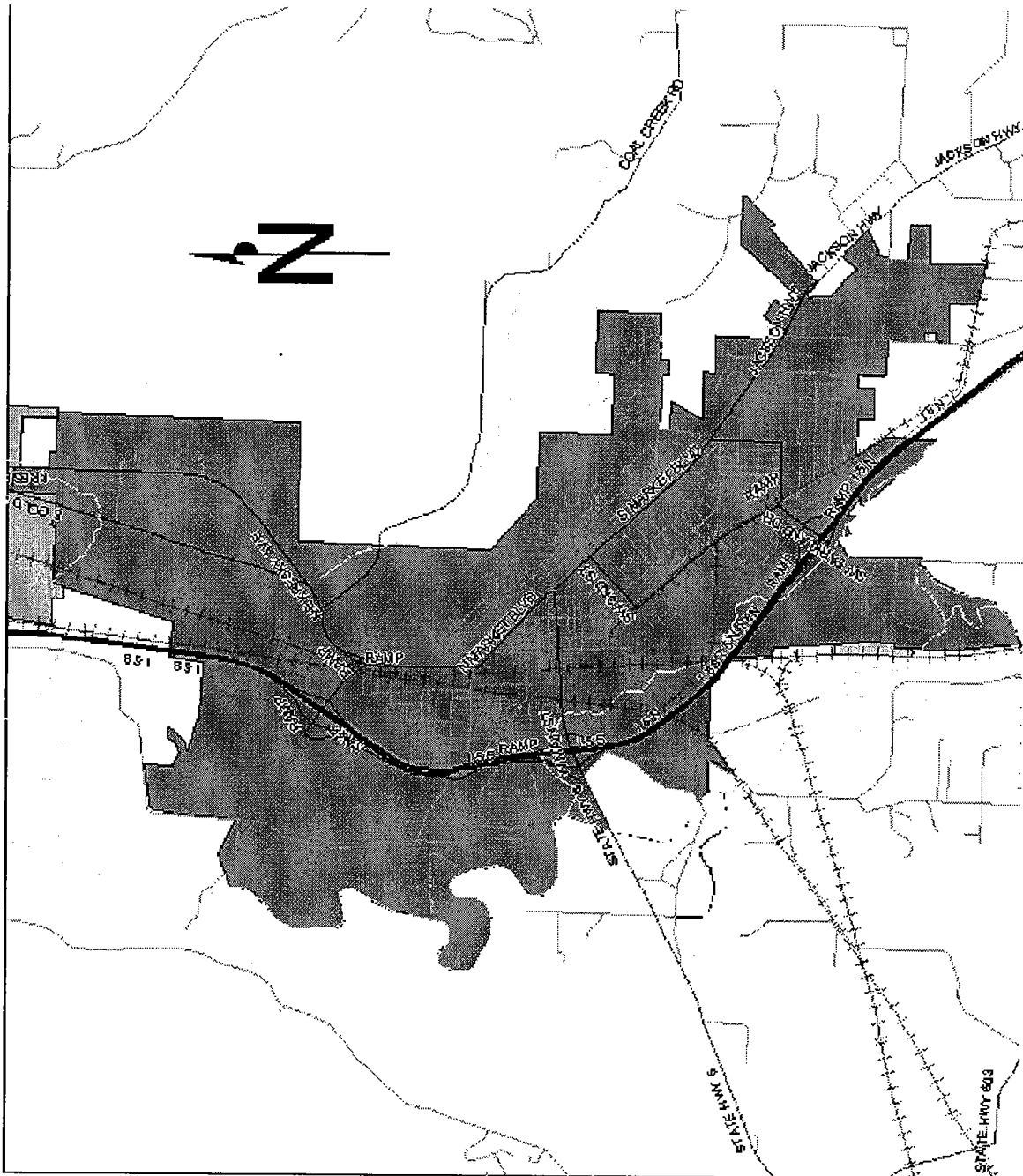

OPERATIONS MAP KEY

Chehalis

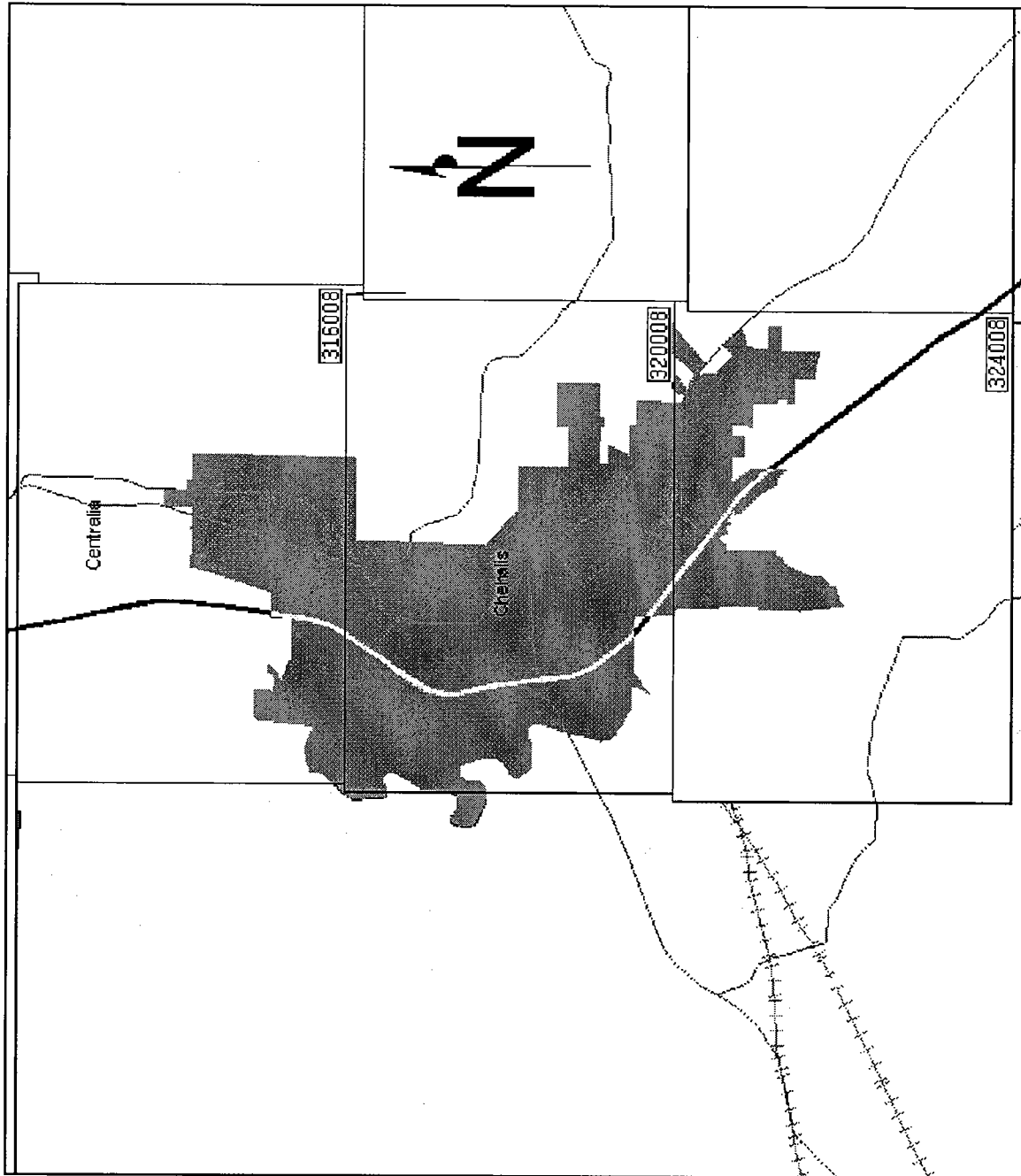

ROLES AND RESPONSIBILITIES OF THE SERVICE PROVIDERS

Pilchuck Contractors performs the installation of new customer construction on both residential and commercial gas services. They perform gas system upgrades and replacements, as well as, gas system operation and maintenance. In addition, Pilchuck responds to breaks at the request of PSE Gas Dispatch.

Kittitas County

EMERGENCY RESPONSE PLAN

TABLE OF CONTENTS

Kittitas

| | |
|------------------------------|---|
| Users guide | 2 |
| How it will be served | 3 |
| Regular business hours | 3 |
| After hours | 3 |

PSE Staff

| | |
|---|-----|
| Who reside in and around Kittitas | 3,4 |
|---|-----|

Facilities

| | |
|--|-------|
| Driving directions | 4 |
| Kittitas base | 5,6,7 |
| Maps of Distribution and supply system | 7 |

Roles and Responsibilities

| | |
|----------------------------|-----|
| Service providers..... | 7 |
| Mutual aid agreement | 7,8 |
| Williams Pipeline | 8 |

Material / tool List

| | |
|------------------------|---|
| Weld Equipment | 8 |
| Emergency Trailer..... | 8 |
| Tool Room..... | 9 |
| Backhoe..... | 9 |

Pagination on redacted version may differ due to redaction and font change.

Users Guide

Dispatch

| | |
|---|-------|
| PSE Staff | 3,4 |
| Facilities | 4,5,6 |
| Material / tool List..... | 8,9 |
| Maps of Distribution and supply system | 7 |
| Roles and responsibility of Service Providers | 7 |
| Agreement between PSE/City of Ellensburg | 7,8 |

First Responders

| | |
|---|-------|
| PSE Staff | 3,4 |
| Facilities | 4,5,6 |
| Material / tool List..... | 8,9 |
| Maps of Distribution and supply system | 7 |
| Roles and responsibility of Service Providers | 7 |
| Agreement between PSE/City of Ellensburg | 7,8 |

CFS

| | |
|---|-------|
| PSE Staff | 3,4 |
| Facilities | 4,5,6 |
| Maps of Distribution and supply system | 7 |
| Material / tool List..... | 8,9 |
| Roles and responsibility of Service Providers | 7 |

Gas Control

| | |
|--|-------|
| PSE Staff | 3,4 |
| Facilities | 4,5,6 |
| Material / tool List..... | 8,9 |
| Maps of Distribution and supply system | 7 |

Emergency Response Plan Kittitas - GAS

How Kittitas is served

Regular business hours:

During regular business hours we will utilize employees who are working in Kittitas. This could include Gas First Response personnel or SC&P.

After Hours:

Outside of normal business hours we will first contact the Gas First Response employees who live in Kittitas. Two of these employees are expected to provide 24 hour 7 days per week coverage on an alternating week basis. If one of the three resident employees is not going to be available, we will move a First Responder from the west side of the mountains. If none of these people are available, use the normal callout procedure, calling the closest person(s) to the emergency.

What to do if the pass is closed and support is needed:

The primary link between the Kittitas service territory and the rest of the company is I-90. If inclement weather has the pass closed and support personnel or material are required from the West side, call the System Manager at *TELEPHONE NUMBER REDACTED* to make arrangements for aerial transport to Ellensburg.

PSE gas staff who reside in/near Kittitas

| Name | Home | Cell | Pager | Nextel | Addr | Job |
|------|------|----------|-------|--------|----------------------|-----------------|
| | | | | | REDACTED, Ellensburg | CFS Tech |
| | | REDACTED | | | REDACTED, Ellensburg | Fitter |
| | | | | | REDACTED, Cle Elum | PI Inspector |
| | | | | | REDACTED, Selah | Supervisor |

- These personnel have received basic training on regulator station operations and using the main line valves to control the 16" high pressure main.

PSE support Staff in Kittitas –
 Knowledge of area and keys to facilities

| Name | Home | Cell | Pager | Nextel | Addr | Job |
|------|----------|------|-------|--------|------------|--------------|
| | | | | | Ellensburg | Op Clerk |
| | REDACTED | | | | Ellensburg | CCR |
| | REDACTED | | | | Ellensburg | Meter Reader |
| | REDACTED | | | | Cle Elum | Meter Reader |
| | | | | | Ellensburg | Cashier |

NAMES REDACTED all carry current flagging cards.

PSE Electric servicemen in Kittitas

| Dispatch | After hours | Sys Mgr | Addr | Job |
|----------|-------------|---------|-------------------------|------------|
| | | | Cle Elum | Serviceman |
| | REDACTED | | Ellensburg | Serviceman |
| | REDACTED | | Cle Elum (part time) | Serviceman |

Facilities

Puget Sound Energy's Kittitas Base is located *DIRECTIONS REDACTED*.

Address

ADDRESS REDACTED

Map and Driving Directions to Facility

DIRECTIONS REDACTED.

MAPS REDACTED.

Key Number

Key NUMBER REDACTED fits the door and electronic gate

Key NUMBER REDACTED opens the door to the tool room

You will need a PSE NUMBER REDACTED key to enter the facility

DIRECTIONS REDACTED.

Material

PSE maintains a trailer at our Kittitas facility, which will be used to carry Tools and materials needed in case of a gas emergency (see Material and Tool List Available at the Facility, page 8,9).

Map of Distribution and Supply System

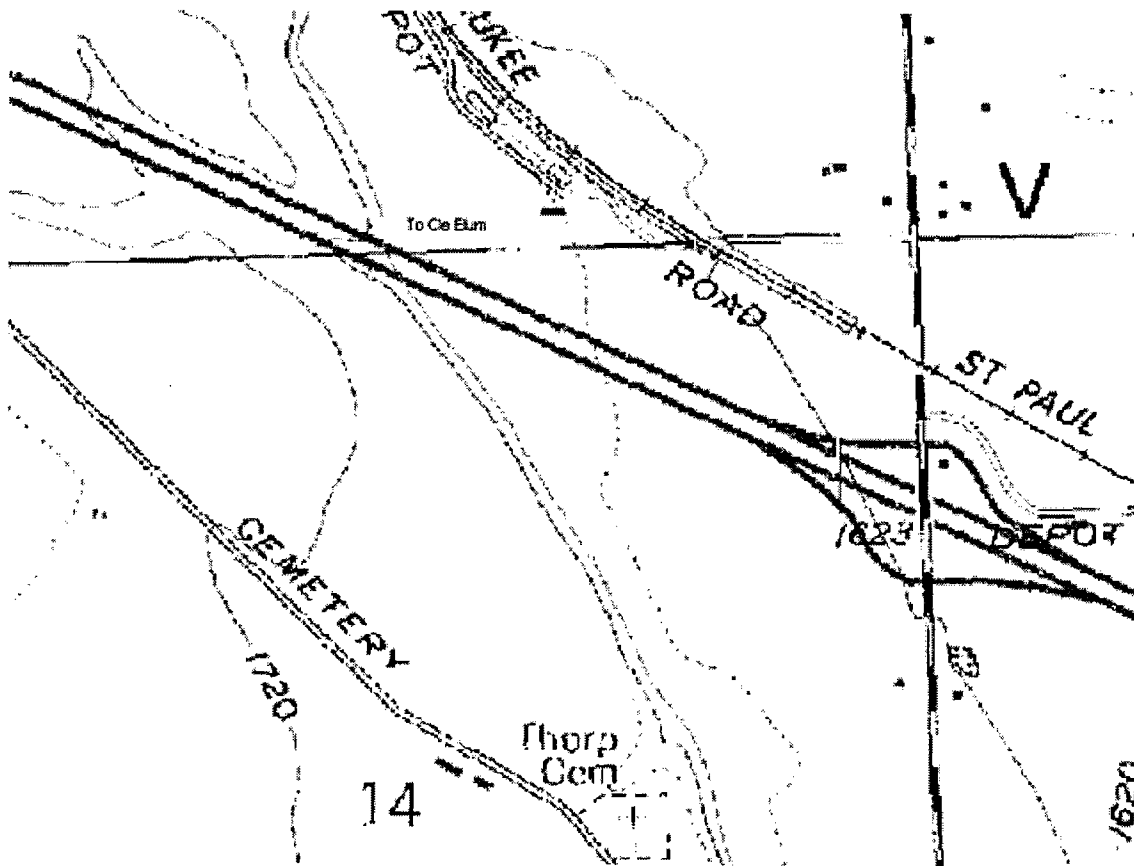

See the following OP (Operations) maps:

MAP NUMBERS REDACTED

Roles and Responsibilities of the Service Providers and others

PSE performs the installation of new customer construction on both residential and commercial gas services, as well as, gas system operation and maintenance. Pilchuck responds to breaks at the request of PSE Gas Dispatch.

Mutual Assistance Agreement City of Ellensburg:

PSE has entered into a mutual aid agreement with the municipal natural gas utility at the City of Ellensburg. In the case of emergency they can be reached through the following numbers.

City of Ellensburg natural gas (daytime) *NUMBER REDACTED*

Kittitas County 911 (dispatch after hours) *NUMBER REDACTED*

NAME REDACTED, City of Ellensburg Gas engineer *NUMBER REDACTED*

Williams Pipeline:

NAME REDACTED – Operations Technician

Cell *NUMBER REDACTED*

Office *NUMBER REDACTED*

Sat *NUMBER REDACTED*

Material and Tool List Available at the Facility

Kittitas Emergency Supply Equipment

Weld Equipment

Oxy/acetylene - One bottles each of oxygen and acetylene will be stored at the facility in the warehouse.

Equipment store on the trailer at PSE's facility

Squeeze Tools:

4" and 6" PE Squeeze Machines and Hydraulic pump

Breathing Air:

4 – 1 hour bottles

4 – 5 min bottles

4 – large face masks

Electrofusion:

2", 4" and 6" clamps

1 – 2500 watt generator

Electrofusion machine

Leak Clamps:

Full circle clamps - 2" by 12" long - two

Full circle clamps - 4" by 12" long - two

Full circle clamps – 6" by 12" long - one

Incidental equipment:

Wood plugs – variety of sizes

Fire Extinguisher

Tool Room Inventory:

Shoring: - in tool room

Two 24" spreaders and two - 4 X 4' sheets of board

Fusion:

2" and 4" plates facer etc.

Flagging:

Signs and standards – access thorough tool room back into battery room

Covered Storage next to covered parking:

Pre tested pipe 1¼", 2", 4" and 6" pipe.

Valve Keys

Backhoe

PSE does not maintain a backhoe at the Kittitas facility. When a backhoe has been required one has been either rented from Potelco (who co-occupies the base) or United Rentals located in Ellensburg.

In the case of an emergency where a backhoe is required on site the following options are presented:

1. The PSE electric shift operators at *NUMBER REDACTED* or *NUMBER REDACTED* who regularly dispatch electric outage work to Potelco in Kittitas. As such, they would notify Potelco of an immediate need for a backhoe and the location for it to be delivered. If so specified, they could provide an IBEW operator as well.
2. The City of Kittitas has an operator and hoe that can be used for emergencies within the city limits of Kittitas if they can be reached and the equipment is available. They can be reached at *NUMBER REDACTED* during normal working hours. The operator's name is *NAME REDACTED*.

Toledo

EMERGENCY RESPONSE PLAN

TABLE OF CONTENTS

Toledo

| | |
|------------------------------|---|
| Users Guide..... | 2 |
| How it will be served | 3 |
| Regular business hours | 3 |
| After hours | 3 |
| Floods..... | 3 |

PSE Staff

| | |
|----------------------------|---|
| Who reside in Toledo | 4 |
| Who work in Toledo..... | 4 |
| Live near Toledo..... | 4 |

Maps

| | |
|------------------------------|---|
| Directions | 5 |
| City Map..... | 6 |
| Gas Operations Map Key | 7 |
| Plat Map Key | 8 |

Service Provider

| | |
|----------------------------------|---|
| Roles and Responsibilities | 9 |
|----------------------------------|---|

Pagination on redacted version may differ due to redaction and font change.

USERS GUIDE

Dispatch

| | |
|---|---|
| PSE Staff..... | 4 |
| Directions..... | 5 |
| City Map | 6 |
| Gas Operations Map Key | 7 |
| Plat Map Key..... | 8 |
| Roles and responsibility of Service Providers | 9 |

First Responders

| | |
|---|---|
| PSE Staff..... | 4 |
| Directions..... | 5 |
| City Map | 6 |
| Gas Operations Map Key | 7 |
| Plat Map Key..... | 8 |
| Roles and responsibility of Service Providers | 9 |

CFS

| | |
|---|---|
| PSE Staff..... | 4 |
| Directions..... | 5 |
| City Map | 6 |
| Gas Operations Map Key | 7 |
| Plat Map Key..... | 8 |
| Roles and responsibility of Service Providers | 9 |

Gas Control

| | |
|---|---|
| PSE Staff..... | 4 |
| Directions..... | 5 |
| City Map | 6 |
| Gas Operations Map Key | 7 |
| Plat Map Key..... | 8 |
| Roles and responsibility of Service Providers | 9 |

EMERGENCY RESPONSE PLAN

Toledo

How Toledo will be served

Regular business hours:

During regular business hours we will utilize employees who are working in Toledo. This could include Gas First Response, SC&P, or Pilchuck personnel.

After Hours:

We have one (1) gas employee who lives in Toledo. We have identified those gas employees that live in close proximity to Toledo. Outside of normal business hours we will contact the Gas First Response employee who lives in Toledo. If this employee is not going to be available he will notify Dispatch. Dispatch will first contact the GFR staff that live near Toledo. If that fails, Dispatch will move the closest GFR personnel to the problem per the Standard Call-Out process. In the case were GFR personnel is unavailable, Dispatch will contact SC&P staff trained for First Response.

Floods:

Lewis County has had numerous 100-year floods in past years; this area is prone to flooding. This area may be closed to any traffic except for emergency vehicles and local traffic. In the past I-5 has been shut down. During flooding, the best way to get there may be through Littlerock or Bucoda. The City of Centralia and Chehalis as well as Lewis Co. has historically informed PSE of any wash outs or any other problems we may need to be aware of. PSE may need to isolate areas of the gas system during flooding.

Alternative Access:

If access by conventional means is unavailable, you may be able to deliver personnel and materials to the Winlock area by helicopter. The System Manager *TELEPHONE NUMBER REDACTED* on duty should be called to arrange helicopter support.

PSE STAFF WHO RESIDE IN TOLEDO

NAME REDACTED (Gas)
ADDRESS REDACTED
Toledo, WA 98591
Home phone: NUMBER REDACTED
Cell phone: NUMBER REDACTED
Pager: NUMBER REDACTED

PSE STAFF WHO WORK IN TOLEDO

NAME REDACTED (Gas)
ADDRESS REDACTED
Toledo, WA 98591
Home phone: NUMBER REDACTED
Cell phone: NUMBER REDACTED
Pager: NUMBER REDACTED

NAME REDACTED (Gas)
ADDRESS REDACTED
Chehalis, WA 98532
Home phone: NUMBER REDACTED
Cell phone: NUMBER REDACTED
Pager: NUMBER REDACTED

PSE STAFF WHO LIVE NEAR TOLEDO

NAME REDACTED (Gas)
ADDRESS REDACTED
Centralia, WA 98531
Home phone: NUMBER REDACTED
Cell phone: NUMBER REDACTED
Pager: NUMBER REDACTED

NAME REDACTED (Gas)
ADDRESS REDACTED
Centralia, WA 98531
Home phone: *NUMBER REDACTED*
Cell phone: *NUMBER REDACTED*
Pager: *NUMBER REDACTED*

NAME REDACTED (Gas)
ADDRESS REDACTED
Chehalis, WA 98532
Home phone: *NUMBER REDACTED*
Cell phone: *NUMBER REDACTED*
Pager: *NUMBER REDACTED*

CITY MAP

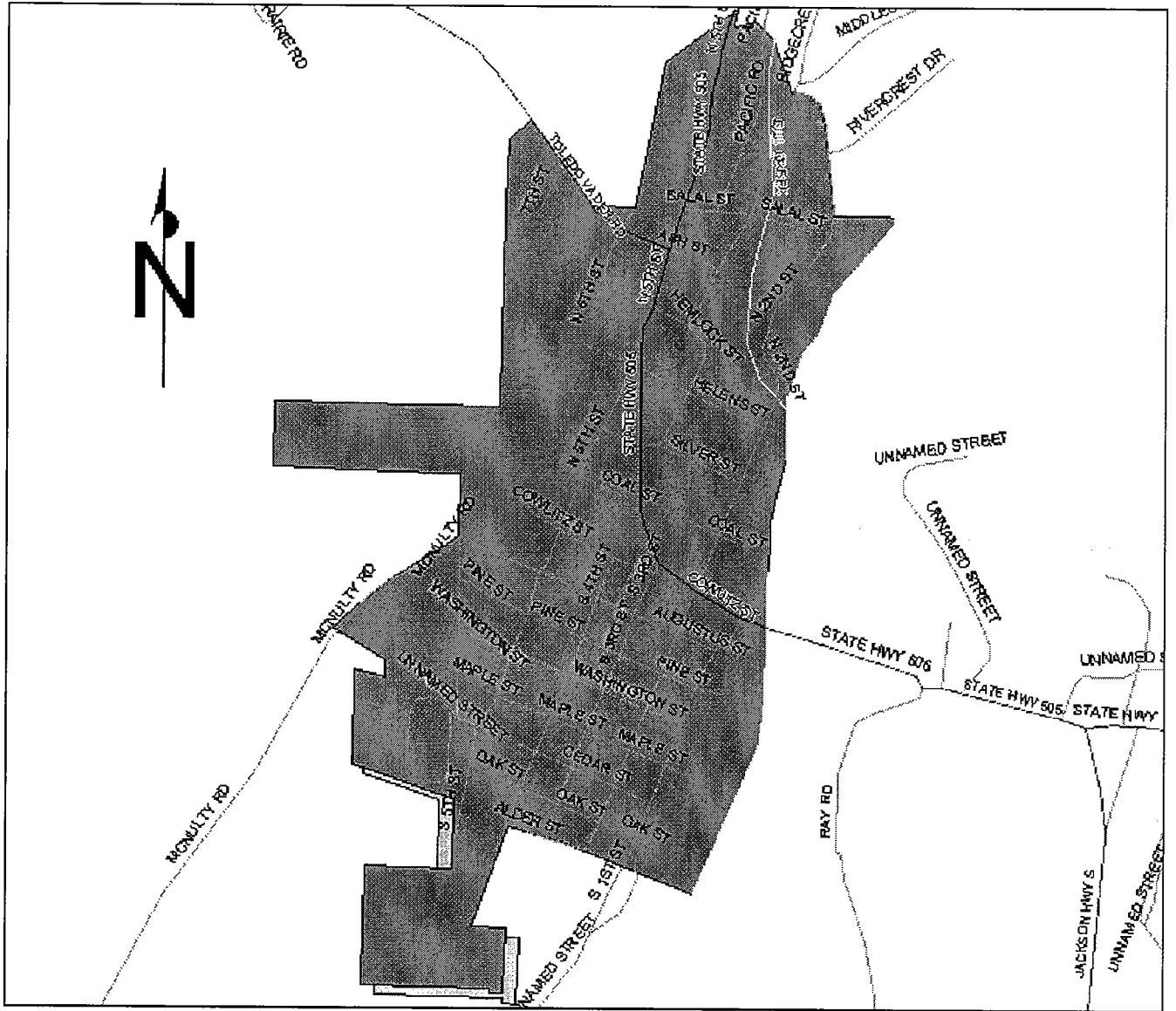

PLAT MAP KEY

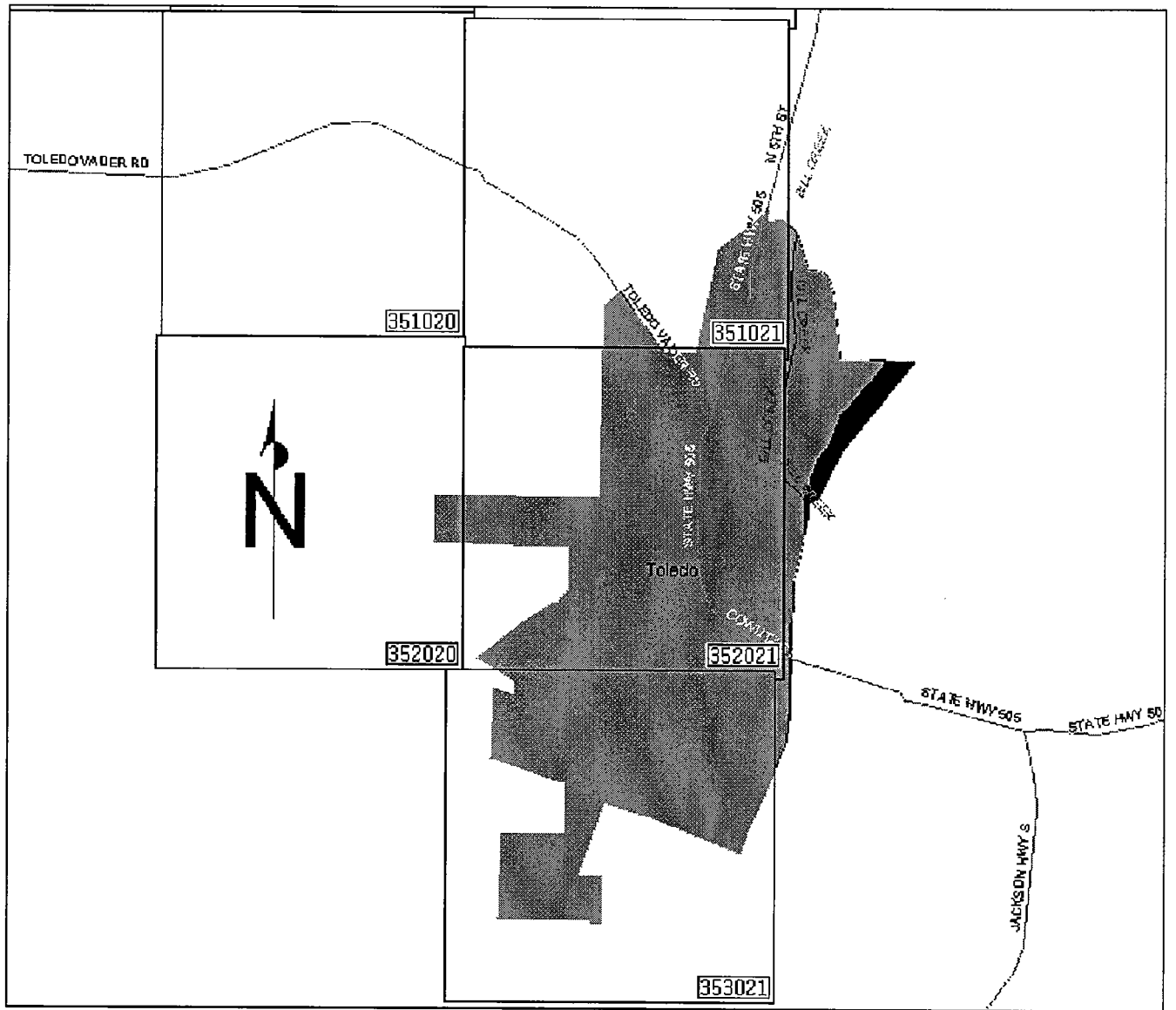

ROLES AND RESPONSIBILITIES OF THE SERVICE PROVIDERS

Pilchuck Contractors performs the installation of new customer construction on both residential and commercial gas services. They perform gas system upgrades and replacements, as well as, gas system operation and maintenance. In addition, Pilchuck responds to breaks at the request of PSE Gas Dispatch.

Vashon Island
EMERGENCY RESPONSE PLAN

TABLE OF CONTENTS

Vashon

Users Guide..... 2
How Vashon will be served..... 3
Regular business hours..... 3
After hours 3

PSE Staff

Who reside on the Island..... 4
Who work on the Island 4
Who live near a ferry terminal 5

Facilities

Address and Driving Directions 6
Vashon Base 7
Gas Operations Map Key 8

Ferry

After Hours:..... 3
Ferry Procedure 8
Ferry Terminal Directions 9-12

Service Provider

Roles and Responsibilities of the Service Providers 11

Material and Tool List..... 12

Agreement Between PSE And Vashon Fire Department 13, 14

Users Guide

Dispatch

PSE Staff 4-5
Facilities 6-8
Material / tool List.....17
Ferry 3, 9-12
Map of distribution and supply system7, 8
Roles and responsibility of Service Providers13
Agreement between PSE/Vashon Fire Department.....15, 16

First Responders

PSE Staff 4-5
Facilities 6-8
Material / tool List.....17
Ferry 3, 9-12
Map of distribution and supply system7, 8
Roles and responsibility of Service Providers13
Agreement between PSE/Vashon Fire Department.....15, 16

CFS

PSE Staff 4-5
Facilities 6-8
Material / tool List.....17
Ferry 3, 9-12
Map of distribution and supply system7, 8
Roles and responsibility of Service Providers13
Agreement between PSE/Vashon Fire Department.....15, 16

Gas Control

PSE Staff 4-5
Facilities 6-8
Material / tool List.....17
Ferry 3, 9-12
Map of distribution and supply system7, 8

Emergency Response Plan

Vashon Island

How Vashon will be served

Regular business hours:

During regular business hours we will utilize employees who are working on the Island. This could include Gas First Response personnel, System Control and Protection, or Pilchuck Contractors.

Personnel assigned to work on the island on a day to day basis will notify dispatch when they arrive on and leave the island.

After Hours:

PSE has two Employees who live on the Island, both Electric. PSE has also identified those gas employees that live near the ferry terminals at Fauntleroy, Southworth and Tacoma. Outside of normal business hours we will contact the First Responders living closest to the ferry terminals. If this fails, we will dispatch the First Responders per the standard callout process that moves the closest GFR personnel to the event.

Ferry Service after Hours:

If ferry service is needed outside the normal service hours, you can contact the System Manager at *NUMBER REDACTED* or *NUMBER REDACTED*. They have set up an arrangement with the Washington Ferry System to take PSE vehicles to the Island in case of emergencies (see After Hours Ferry Procedure page).

Alternative Access:

If access by conventional means is unavailable, you may be able to deliver personnel and materials to Vashon Island area by helicopter. The System Manager, *NUMBER REDACTED*, on duty should be called to arrange helicopter support.

PSE staff who reside on the Island

NAME REDACTED (Electric Employee)
ADDRESS REDACTED
Vashon, WA 98070
Home phone: *NUMBER REDACTED*
Nextel Phone: *NUMBER REDACTED*

NAME REDACTED (Electric Employee)
ADDRESS REDACTED
Vashon, WA 98070
Home phone: *NUMBER REDACTED*
Nextel Phone: *NUMBER REDACTED*

PSE staff who Work on the Island

NAME REDACTED (Electric Employee)
ADDRESS REDACTED
Vashon, WA 98070
Home phone: *NUMBER REDACTED*
Nextel Phone: *NUMBER REDACTED*

NAME REDACTED (Electric Employee)
ADDRESS REDACTED
Vashon, WA 98070
Home phone: *NUMBER REDACTED*
Nextel Phone: *NUMBER REDACTED*

PSE Staff who live near a ferry terminal

Fauntleroy

Georgetown personnel close to the **Fauntleroy Ferry Terminal:**

| | | |
|----------------------|---------------------------------------|-------------------------|
| <i>NAME REDACTED</i> | 1st Response Fitter | <i>ADDRESS REDACTED</i> |
| <i>NAME REDACTED</i> | 1st Response CFS | <i>ADDRESS REDACTED</i> |
| <i>NAME REDACTED</i> | 1st Response CFS | <i>ADDRESS REDACTED</i> |
| <i>NAME REDACTED</i> | CFS Appliance Fitter | <i>ADDRESS REDACTED</i> |
| <i>NAME REDACTED</i> | 1st Response Fitter | <i>ADDRESS REDACTED</i> |
| <i>NAME REDACTED</i> | 1st Response CFS | <i>ADDRESS REDACTED</i> |

Southworth

| | | |
|----------------------|---------------------------------|-------------------------|
| <i>NAME REDACTED</i> | Corrosion Control Fitter | <i>ADDRESS REDACTED</i> |
|----------------------|---------------------------------|-------------------------|

Tacoma - Tahlaquah (Pt. Defiance)

| | | |
|----------------------|---------------------------------------|-------------------------|
| <i>NAME REDACTED</i> | 1st Response Fitter | <i>ADDRESS REDACTED</i> |
|----------------------|---------------------------------------|-------------------------|

Street Truck-- 1 set of breathing air--4 extra bottles

FACILITIES

Puget Sound Energy's office is located just south of the town of Vashon on the main Highway.

Address

ADDRESS REDACTED

The building site sits back off the highway about 100 yards and is somewhat secluded.

Map and Driving Directions to Facility

The facility is located at ADDRESS REDACTED (see page 7 for layout of Vashon facility).

The building sets back off the highway about 100 yards and is hard to see from the road.

You will need a NUMBER REDACTED key to enter the facility

Key Number

NUMBER REDACTED will fit the keypad

Material

We will maintain a trailer at our Vashon facility, which will be used to carry materials needed in case of a gas emergency (see Material and Tool List Available at the Facility, page 17).

During emergencies this trailer will be picked up by the first PSE employee to respond, which may not necessarily be a gas employee.

MAP REDACTED

**SOUTH KING COUNTY
NATURAL GAS OPS
MAPS**

204-056

Seattle

208-056

Burien

212-050

212-056

216-050

216-056

King

220-050

220-056

220-062

224-056

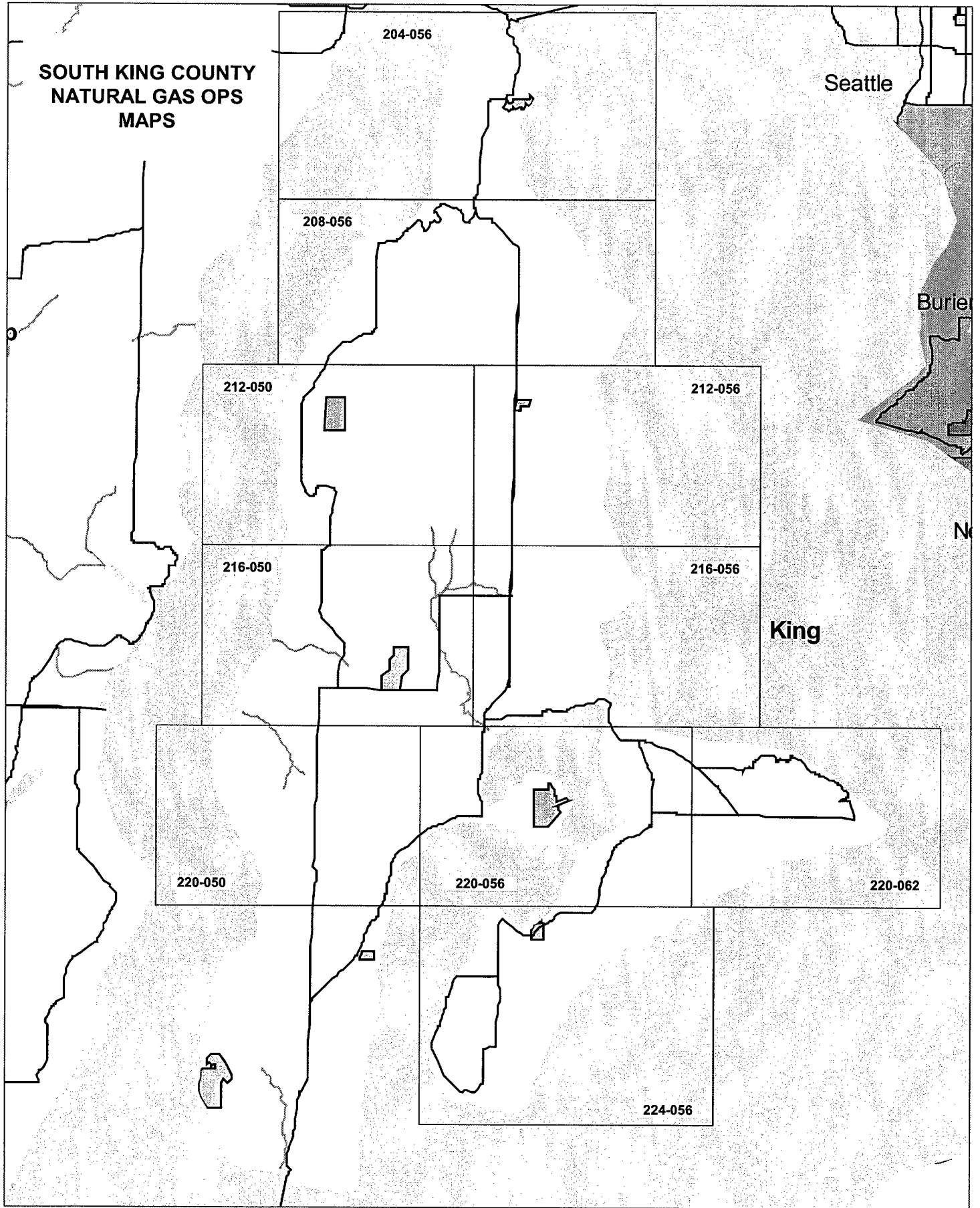

FERRY PROCEDURE

WASHINGTON STATE FERRY SYSTEM (WSF)

Adopted 12-22-98

Current information: www.wsdot.wa.gov/ferries/schedules/current

Reviewed 10-24-01

PRIORITY LOADING PROCEDURE - GAS EMERGENCY

This procedure addresses gas emergencies only.

There are no hard and fast rules relating to who qualifies for priority loading of utility vehicles on ferry routes. The WSF Operations Watch Supervisor is the key contact person to arrange priority loading and will make the ultimate decision whether or not to approve such a request.

In order to reduce the possibility for abusing the system for personal benefit, the Operations Watch Supervisor will only accept loading requests from PSE's Gas Operations Dispatchers. Employees will not be able to arrange their own priority loading with the dock attendants.

The procedures to be followed is:

- The Gas Operations Dispatcher has the responsibility to **determine if the emergency in question requires an immediate response** necessitating priority loading on a Washington State ferry.
NOTE: In general, events such as broken and blowing lines, Class A leaks, inside odors, and possible CO poisoning would meet this test. There may be other valid emergencies such as employee injuries or vehicle accidents, but these can adequately be covered by local emergency responders and probably don't require special loading of PSE personnel. The WSF Operations Watch Supervisor will rely on our Dispatchers to make proper judgments.
- If the emergency meets this test, the dispatcher shall **contact the WSF Operations Watch Supervisor.**
Call 206.515.3456
- **Provide the following information.**
 - Name and contact number of Gas Operations Dispatcher calling
 - Type of gas emergency necessitating priority boarding
 - Ferry route affected
 - Number and type of vehicles requiring priority loading
 - Estimated arrival time of vehicles at terminal
- Dispatcher shall **obtain** the following **information** from the WSF Operations Watch Supervisor. **Record the information** on the Emergency Report form. **Communicate approval information** to vehicles involved.
 - Name of Operations Watch Supervisor
 - Date and time of request for priority loading
 - Confirmation of approval of PSE's request
- The **Operations Watch Supervisor will contact the dock attendant** at the affected terminal and communicate the information.
- **If difficulties arise** at the terminal, the dock attendant should be asked to contact the Operations Watch Supervisor. PSE's Dispatcher may also call as well to confirm the previously agreed to arrangements. In no case shall PSE employees at the dock engage in arguments regarding loading. All such difficulties, especially those resulting in a delayed response, shall be recorded on the Emergency Report form.

Driving Directions to Ferry Terminals

Southworth Terminal
11564 SE State Hwy 160
Southworth, WA 98386

DIRECTIONS REDACTED

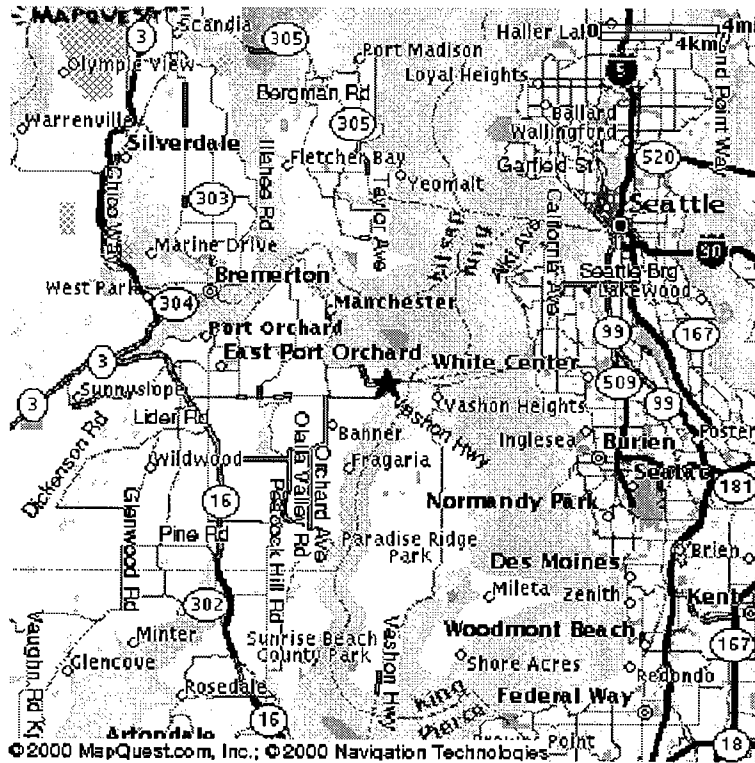

Fauntleroy Terminal
4829 SW Barton
Seattle, WA 98136

DIRECTIONS REDACTED

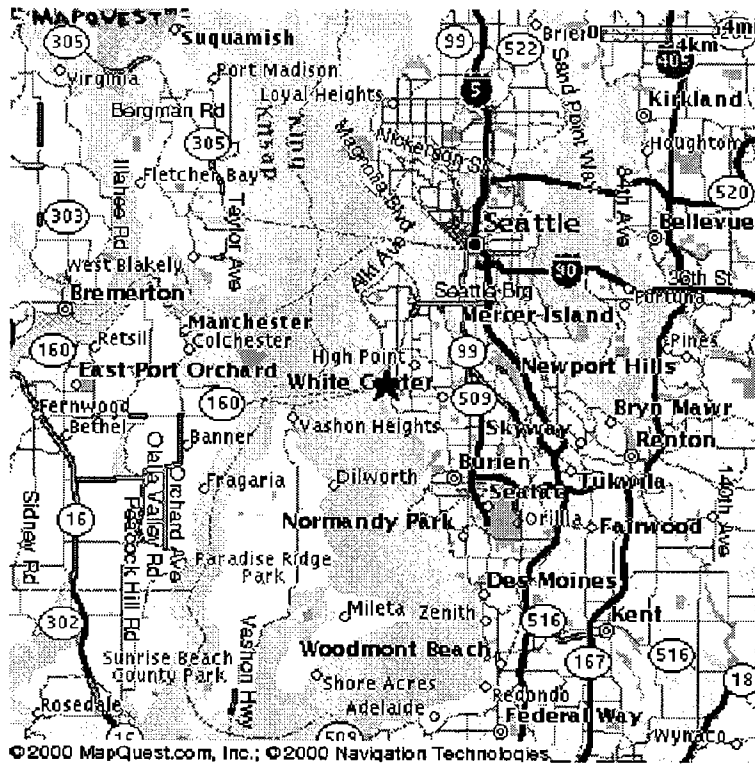

Pt. Defiance / Tahlequah Terminal
5810 N. Pearl St.
Tacoma WA 98405

DIRECTIONS REDACTED

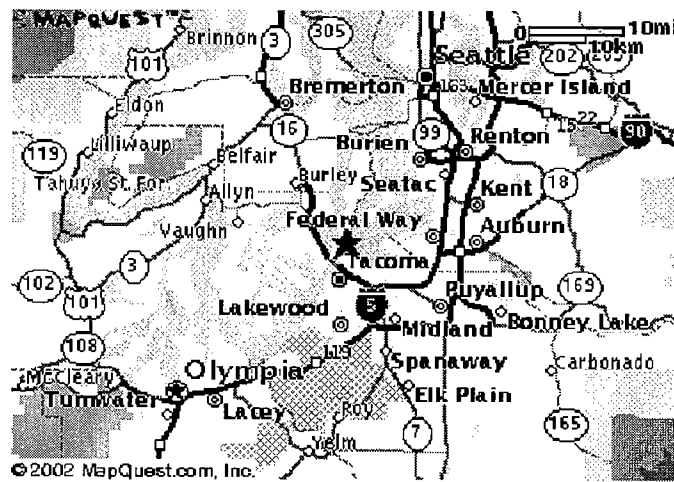

Roles and Responsibilities of the Service Providers

Pilchuck Contractors performs the installation of new customer construction on both residential and commercial gas services. They perform gas system upgrades and replacements, as well as, gas system operation and maintenance. In addition, Pilchuck responds to breaks at the request of PSE Gas Dispatch.

Pilchuck notifies Gas Dispatch when they get on the ferry going to the island and again when they are leaving the island.

Material and Tool List
Available at the Facility

Vashon Reserve Emergency Supply
Parts and Equipment

Weld Equipment

Oxy/acetylene - Two bottles each of oxygen and acetylene will be store at the facility. If additional Oxy. Act. is needed, it can be obtained from *REDACTED*.

Equipment store on the trailer at PSE's facility

Squeeze Tools:

4" and 6" PE Squeeze Machines and Hydraulic pump

Small steel squeeze machine

Large steel squeeze machine

Valve keys:

One standard

One long (8' or better)

Leak Clamps:

Full circle clamps - 2" by 12" long - two

Full circle clamps - 4" by 12" long - two

Full circle clamps - 6" by 12" long - two

Band clamps - 1/2", 3/4", 1", 1 1/4", 2", 4" and 6"

Shoring:

Two 24" spreaders and two - 4 X 4' sheets of board

12' ladder

Incidental equipment:

Wood plugs - variety of sizes

Environmental Packs (two)

Fire Extinguisher

Agreement Between PSE And Vashon Fire Department

PSE Operations personnel met with the Vashon Fire department on December 17, 2001. As a result, the following guideline was agreed to between the Vashon Fire Department and Puget Sound Energy.

- **Communication with the Beachcomber**
PSE is communicating with the Beachcomber and will continue to stay in touch with them.
- **Emergency Center**
PSE will participate with the Vashon Fire Department regarding Emergency Center Operations. PSE's contact is *REDACTED*.
- **Open House**
PSE will participate in the Fire Department Open House. Our contact for this is either *REDACTED* or *REDACTED*.
- **Natural Gas Training**
PSE provides natural gas emergency training, our contact is: *REDACTED*.
- **Road Closed Signs:**
PSE has 12 plastic barricades at our Vashon Facility, located next to the Oxygen/ Acetylene storage rack (see attached diagram).

The Fire Department can gain access by using the Knox box.

➤ **Direct Communication With Dispatch**

Our dispatch numbers are:

ELECTRIC-

NUMBER REDACTED use this number to gain record information

GAS

Fire & Police hot line for direct access to Gas Dispatch

NUMBERS REDACTED

Use this number to gain record information from Gas Dispatch

NUMBER REDACTED

➤ **Vashon Response Time**

PSE's goal is to meet or exceed the 55-minute SQI (Service Quality Index) agreed to with the WUTC.

➤ **Annual Valve Surveys**

PSE's Gas First Response PI (Public Improvement) Inspector will meet with the Vashon Fire Department annually. They will provide an updated service valve list and review the completed service valve survey results with the chief and his staff.

➤ **Tools & Material**

We will review the number of valve keys and wooden plugs they presently are equipped with, re-supply where needed.

Winlock

EMERGENCY RESPONSE PLAN

TABLE OF CONTENTS

Winlock

| | |
|------------------------------|---|
| Users Guide..... | 2 |
| How it will be served | 3 |
| Regular business hours | 3 |
| After hours | 3 |
| Floods..... | 3 |

PSE Staff

| | |
|---------------------------|---|
| Who work in Winlock | 4 |
| Live near Winlock | 4 |

Maps

| | |
|------------------------------|---|
| Directions | 5 |
| City Map..... | 6 |
| Gas Operations Map Key | 7 |
| Plat Map Key | 8 |

Service Provider

| | |
|----------------------------------|---|
| Roles and Responsibilities | 9 |
|----------------------------------|---|

Pagination on redacted version may differ due to redaction and font change.

USERS GUIDE

Dispatch

| | |
|---|---|
| PSE Staff..... | 4 |
| Directions..... | 5 |
| City Map | 6 |
| Gas Operations Map Key | 7 |
| Plat Map Key..... | 8 |
| Roles and responsibility of Service Providers | 9 |

First Responders

| | |
|---|---|
| PSE Staff..... | 4 |
| Directions..... | 5 |
| City Map | 6 |
| Gas Operations Map Key | 7 |
| Plat Map Key..... | 8 |
| Roles and responsibility of Service Providers | 9 |

CFS

| | |
|---|---|
| PSE Staff..... | 4 |
| Directions..... | 5 |
| City Map | 6 |
| Gas Operations Map Key | 7 |
| Plat Map Key..... | 8 |
| Roles and responsibility of Service Providers | 9 |

Gas Control

| | |
|---|---|
| PSE Staff..... | 4 |
| Directions..... | 5 |
| City Map | 6 |
| Gas Operations Map Key | 7 |
| Plat Map Key..... | 8 |
| Roles and responsibility of Service Providers | 9 |

EMERGENCY RESPONSE PLAN

Winlock

How Winlock will be served

Regular business hours:

During regular business hours we will utilize employees who are working in Winlock. This could include Gas First Response, SC&P, or Pilchuck personnel.

After Hours:

Puget Sound Energy has identified those gas employees that live in close proximity to Winlock. Dispatch will first contact the GFR staff that live near Winlock. If that fails, Dispatch will move the closest GFR personnel to the problem per the Standard Call-Out process. In the case were GFR personnel is unavailable, Dispatch will contact SC&P staff trained for First Response.

Floods:

Lewis County has had numerous 100-year floods in the past several years; this area is prone to flooding. This area may be closed to any traffic except for emergency vehicles and local traffic. In the past I-5 has been shut down. During flooding, the best way to get there may be through Littlerock or Bucoda. The City of Centralia and Chehalis as well as Lewis Co. has historically informed PSE of any wash outs or any other problems we may need to be aware of. PSE may need to isolate areas of the gas system during flooding.

Alternative Access:

If access by conventional means is unavailable, you may be able to deliver personnel and materials to the Winlock area by helicopter. The System Manager *TELEPHONE NUMBER REDACTED* on duty should be called to arrange helicopter support.

PSE STAFF WHO WORK IN WINLOCK.

NAME REDACTED (Gas)
ADDRESS REDACTED
Toledo, WA 98591
Home phone: NUMBER REDACTED
Cell phone: NUMBER REDACTED
Pager: NUMBER REDACTED

NAME REDACTED (Gas)
ADDRESS REDACTED
Chehalis, WA 98532
Home phone: NUMBER REDACTED
Cell phone: NUMBER REDACTED
Pager: NUMBER REDACTED

PSE STAFF WHO LIVE NEAR WINLOCK

NAME REDACTED (Gas)
ADDRESS REDACTED
Centralia, WA 98531
Home phone: NUMBER REDACTED
Cell phone: NUMBER REDACTED
Pager: NUMBER REDACTED

NAME REDACTED (Gas)
ADDRESS REDACTED
Centralia, WA 98531
Home phone: NUMBER REDACTED
Cell phone: NUMBER REDACTED
Pager: NUMBER REDACTED

NAME REDACTED (Gas)
ADDRESS REDACTED
Toledo, WA 98591
Home phone: NUMBER REDACTED
Cell phone: NUMBER REDACTED
Pager: NUMBER REDACTED

NAME REDACTED (Gas)
ADDRESS REDACTED
Chehalis, WA 98532
Home phone: *NUMBER REDACTED*
Cell phone: *NUMBER REDACTED*
Pager: *NUMBER REDACTED*

Directions (From Olympia)

DIRECTIONS REDACTED

Total Estimated Driving Time from Olympia: 32 minutes

Total Distance: 30.71 miles

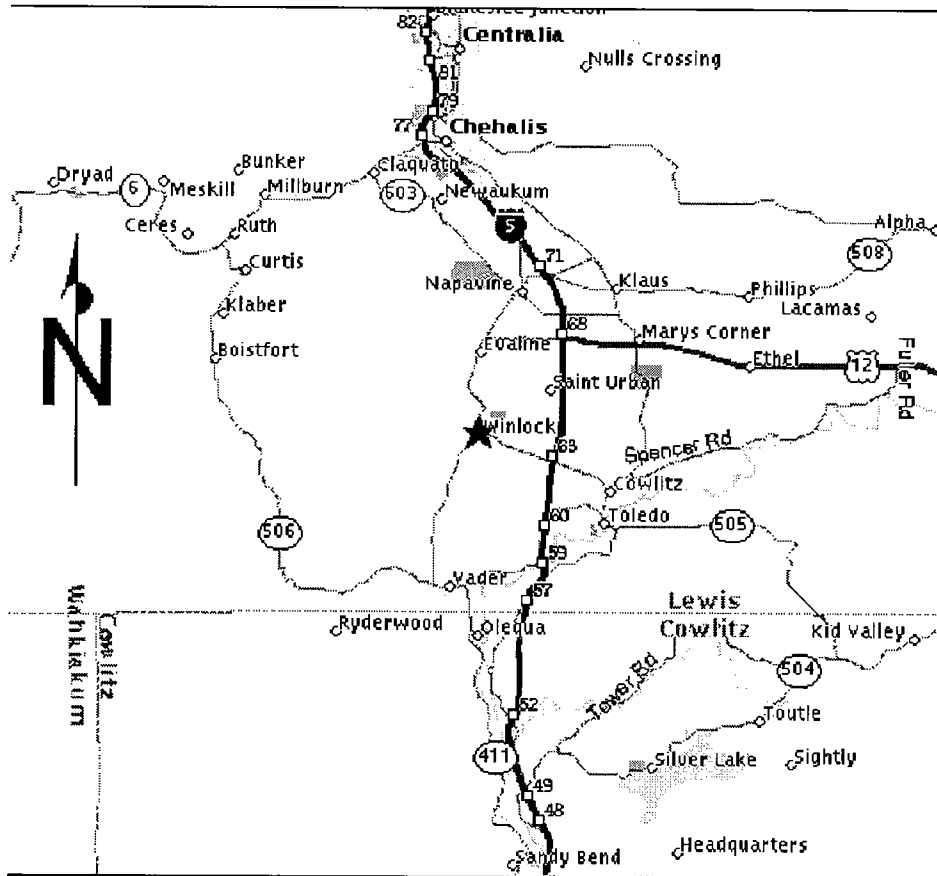

CITY MAP

Winlock

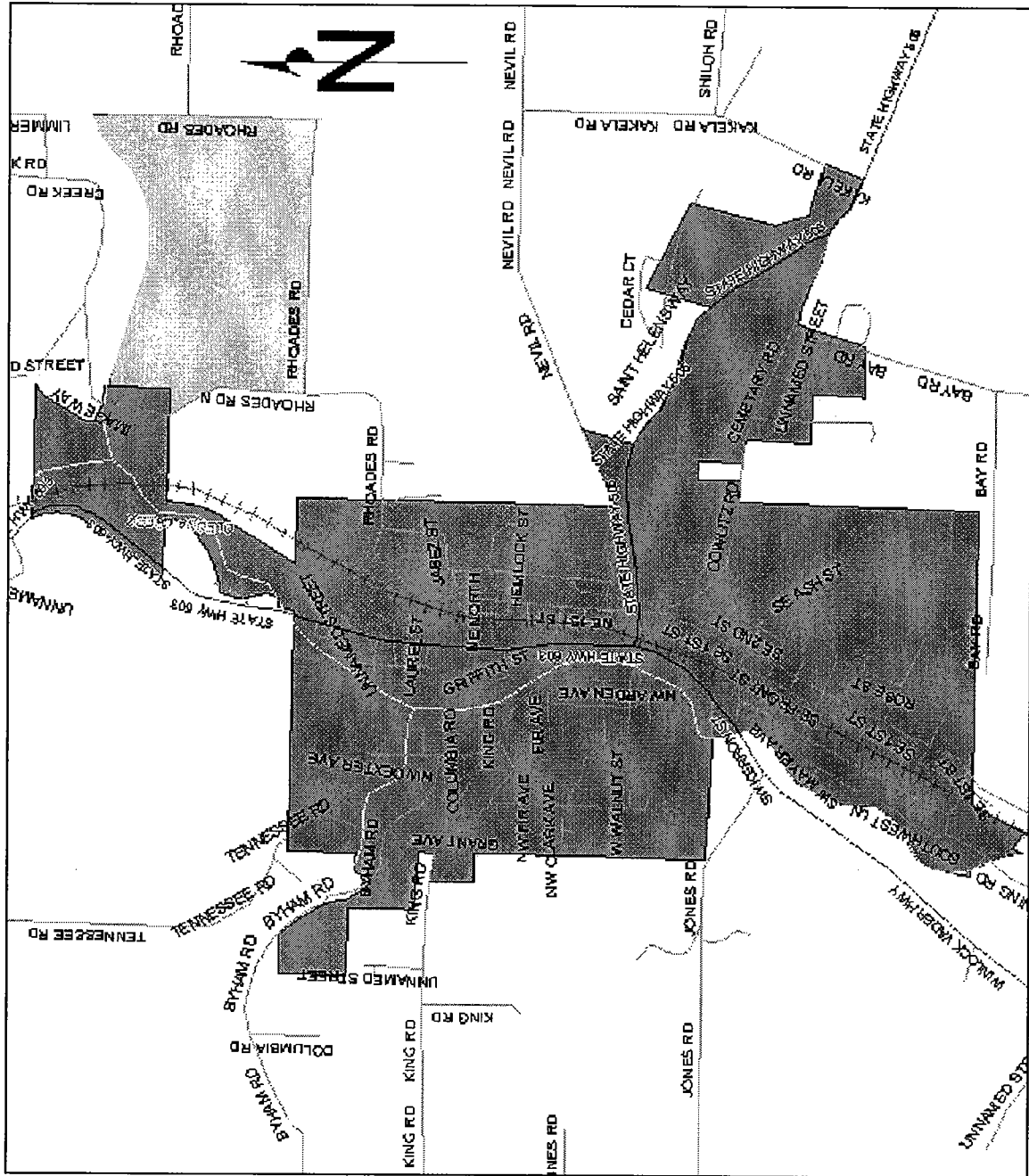

OPERATIONS MAP KEY

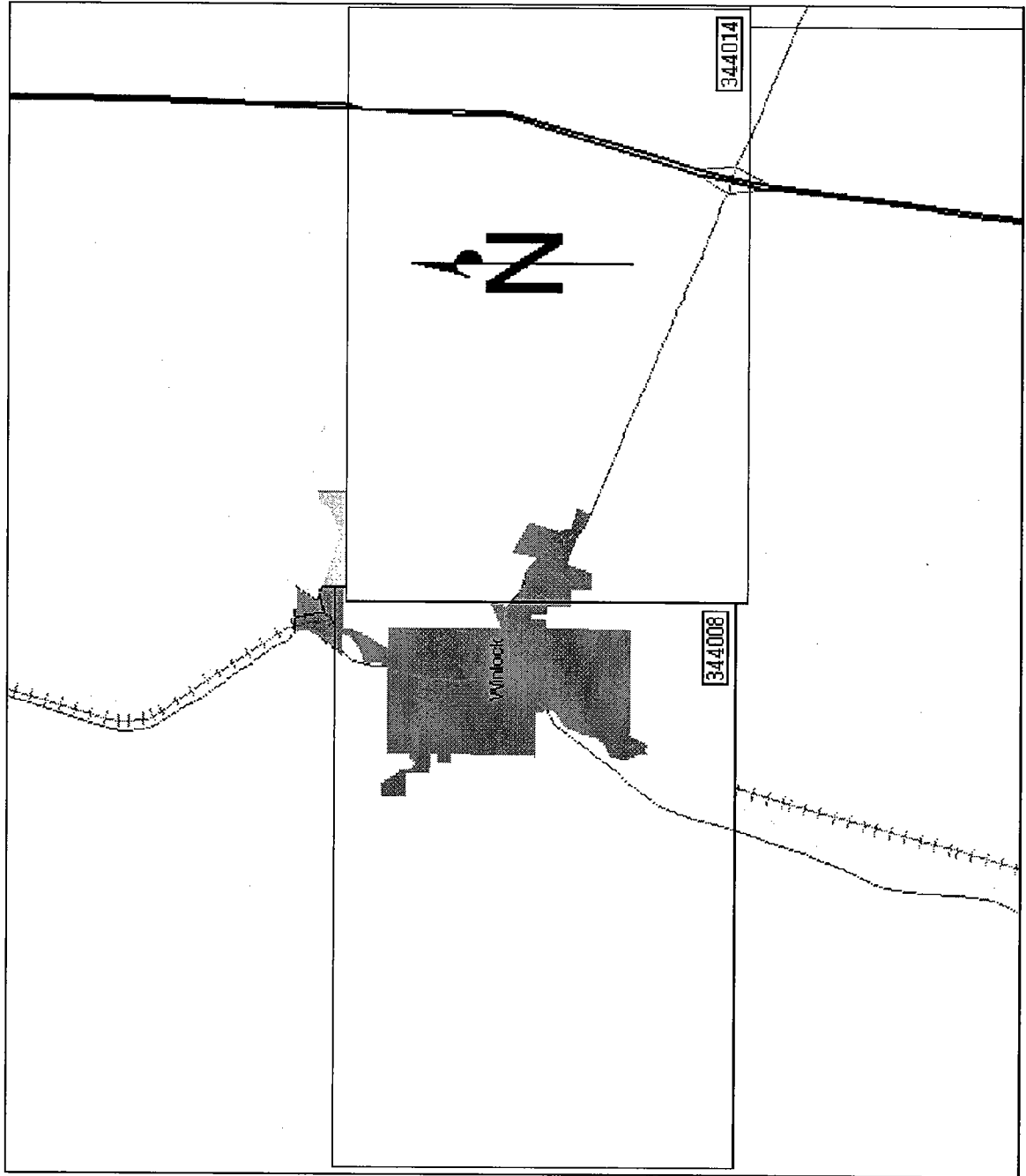

PLAT MAP KEY

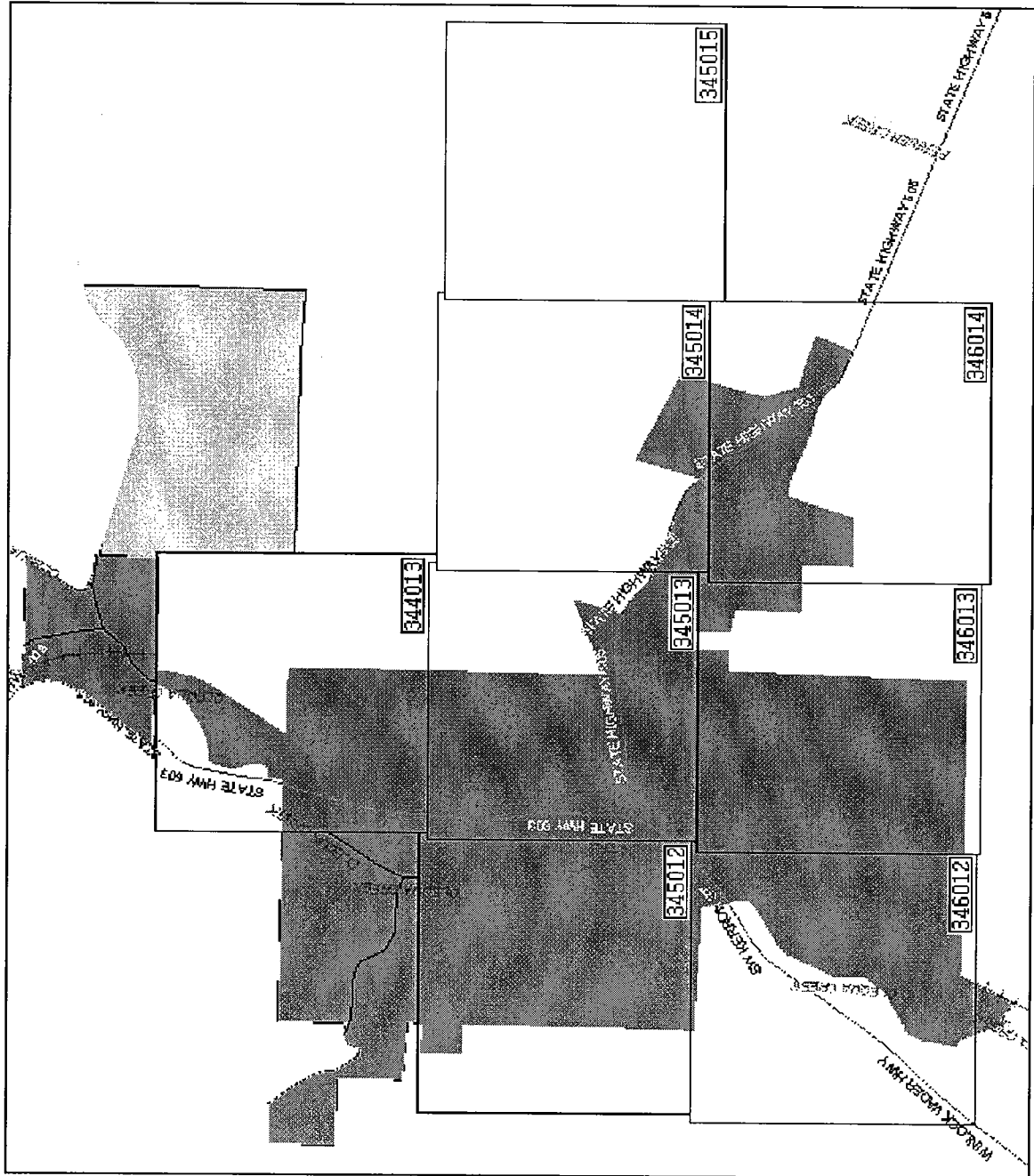

ROLES AND RESPONSIBILITIES OF THE SERVICE PROVIDERS

Pilchuck Contractors performs the installation of new customer construction on both residential and commercial gas services. They perform gas system upgrades and replacements, as well as, gas system operation and maintenance. In addition, Pilchuck responds to breaks at the request of PSE Gas Dispatch.