



COUNTY COMMISSIONERS

Cathy Wolfe
District One

Sandra Romero
District Two

Karen Valenzuela
District Three

PUBLIC WORKS

Creating Solutions for Our Future

Lester Olson
Director

RECEIVED
RECORDS MANAGEMENT
2011 JUN 15 PM 3:26
STATE OF WASH.
UTIL. AND TRANSP.
COMMISSION

June 14, 2011

Kathy Hunter
Deputy Assistant Director, Transportation Safety
Utilities and Transportation Commission
PO Box 47250
Olympia WA 98504-1257

Re: UTC Docket No. TR 091450
Project Amendment Request
Project Extension Request

Dear Kathy:

Thurston County Public Works is asking for two items for the above referenced Docket No.

The first is an amendment to the project agreement and scope of work. Thurston County Public Works is asking for authorizing to scale the proposed scope of work that originally included signing on several county and state roads to just upgrading signing on Old Hwy 99 on both approaches to the BNSF crossing. This signing (see example) would consist of installing larger warning signs, improving reflectivity and providing additional information not current present. This signing was included in the original scope of work but the other signing upgrades cannot be completed as originally intended due to unforeseen conditions and material delivery delays. The remaining signing will improve driver notification of this low clearance crossing and as such will still improve safety as intended by this project.

If the change in scope is approved the following table outlines the new project costs. In summary the over grant cost to cover material purchases would be about \$1,200 which is a reduction from the original \$14,000 submitted in the original request. See Table on the next page for breakdown between grant funded work and county funded work.

TYPE C SIGNS
LOW CLEARANCE SIGNS



W12-2
12'-6"
36 x 36



W16-9P
30 x 16"



W18-3P
30 x 24

ESTIMATED PROJECT COSTS			
PHASE	UTC GRANT	THURSTON COUNTY	TOTAL
MATERIALS	1,200	\$0	\$1,200
INSTALLATION	0	\$250	\$250
TOTAL	\$1,200	\$250	\$1,400

The second request is to ask for an extension of work from June 15, 2011 to June 30th, 2011 for project completion. This extension is needed to accommodate a later than anticipated installation due to material delivery delays and unforeseen project changes regarding the location and type of placards used on the project.

Thank you for your consideration of these requests and if you have any questions I can be reached at 360-709-3034 or by email at davissa@co.thurston.wa.us

Sincerely



Scott Davis, PE
Traffic Engineering & Operations Manager

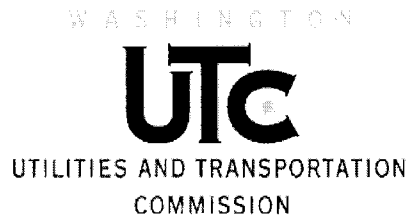

1300 S. Evergreen Park Drive SW
PO Box 47250
Olympia, WA 98504-7250
(360)664-1257 or (360)664-1100
Fax: (360)586-1150
Web: www.wute.wa.gov
E-mail: records@utc.wa.gov

**GRADE CROSSING PROTECTIVE FUND
2009 – 2011 GRANT APPLICATION
OPEN CALL FOR PROJECTS**

**UTC DOCKET NO. TR-091450
AMENDMENT 6/14/11**

The Washington Utilities and Transportation Commission (commission), through its Grade Crossing Protective Fund (GCPF), provides grants for projects that eliminate or mitigate public safety hazards at railroad crossings and along railroad rights-of-way in Washington State. Any public, private or non-profit entity may submit an application to the commission for a GCPF grant.

To apply for a grant to eliminate or mitigate a public safety hazard at a railroad crossing or along a railroad right-of-way, complete the following information and submit it and attachments to the commission.

Applicant Information

Applicant Name: Scott Davis
Organization: Thurston County Public Works
Address: 9605 Tilley Rd SW, Olympia WA 98512
Phone: (360) 709-3034
E-mail: davissa@co.thurston.wa.us
Fax: (360) 709-3096

Project Information

Attach additional sheets as necessary to the application that provide the following:

- 1. A detailed summary of the hazard being addressed. Include any information about accidents or incidents at the site and photographs, drawings or other materials that support the application.**

GCPF Application Form

The Old Hwy 99 under-crossing at the BNSF railroad near Offutt Lake is 12'6". Old Hwy 99 is a high volume two-lane rural arterial roadway with an average daily traffic volume approaching 9000. This portion of Old Hwy 99 also considered a T4 freight route. This means between 100,000-400,000 tons of freight is transported annually on this portion of Old Hwy 99.

Thurston County has signage on county and state routes indicating the height restriction. However, between 2007 and 2009 there were 8 dispatches of sheriff deputies to assist commercial vehicles that were unable to pass under the railroad. This assistance involves providing traffic control to allow these vehicles to back up ½ mile to 1 mile to the nearest turnaround. This does not include informal dispatches of the Public Works Commercial Vehicle Inspector which is estimated to be about once a month. During this same time there were two reported crashes of commercial vehicles striking the railroad bridge structure.

These ongoing incidents and crashes indicate there may be an increasing risk to the railroad overcrossing as traffic volumes and freight movements increase on Old Hwy 99.

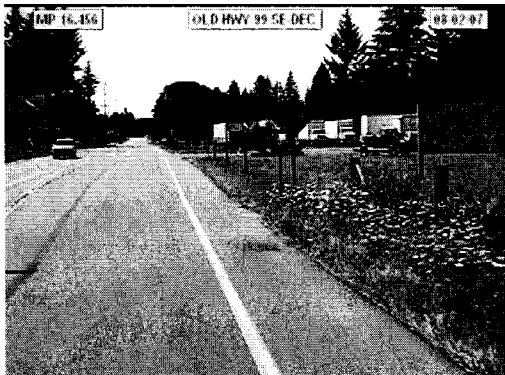
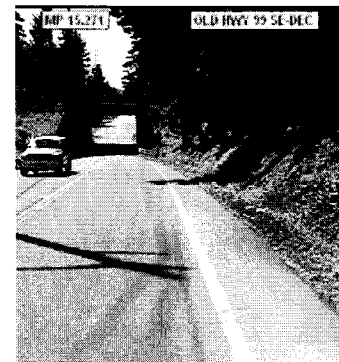
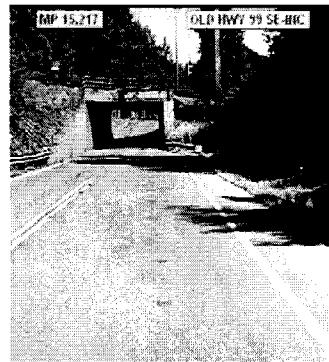
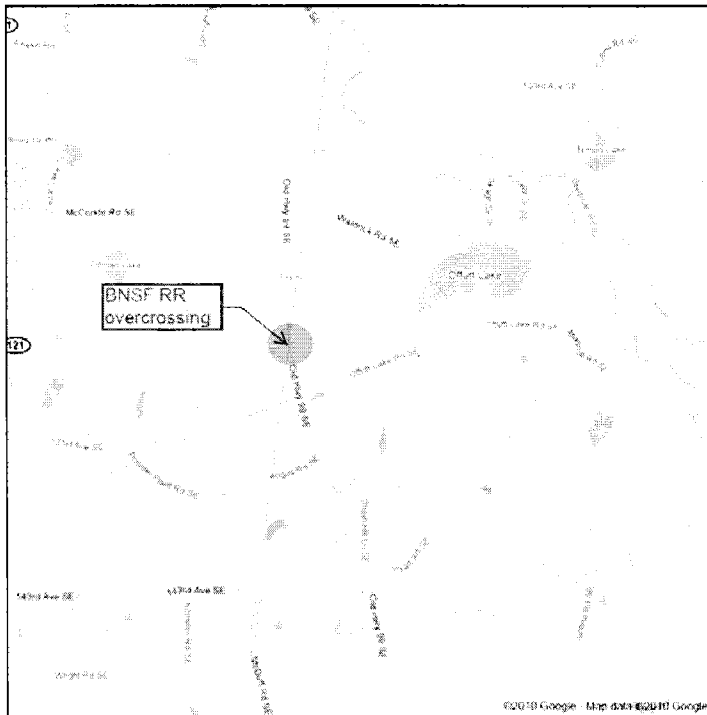

GCPF Application Form

These incidents also expend our limited law enforcement resources needlessly and may reduce the level of safety on this roadway.

- 2. **A detailed summary of the proposed project and how it will eliminate or mitigate the hazard. Include any drawings or construction plans for the proposed project.**

The continued incidents of commercial vehicles either being involved in crashes or in need of law enforcement assistance to backup indicates there may be an opportunity to enhance the information provided to commercial vehicle drivers.

Thurston County proposed replacing existing low clearance signs to improving reflectivity, increasing sign size, add placards to enhance information provided to the drivers. So this means the existing low clearance signs will increase in size from 30"x30" to 36"x36", reflectivity will increase since the older signs will be replaced and placards informing drivers of the distance to the BNSF crossing will be added (i.e., 3 miles, 1/2 mile, Ahead, etc...). See Example Below:

TYPE C SIGNS
LOW CLEARANCE SIGNS

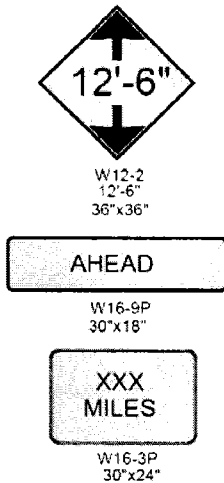

GCPF Application Form

3. **A list all other companies, organizations, state agencies or local governments that may be involved in implementing this proposal and the contact name, address and phone number for each (if known).**

None, all improvements will be on Thurston County Roads.

4. **A cost estimate, including:**
 a. **An itemized list of the total costs of the project.**
 b. **Names of parties contributing to the project, including the applicant, and the amount each is contributing.**

Thurston County is asking the UTC to fund 100% of the work. This includes purchasing materials and installation. Materials include wood sign posts, aluminum signs and hardware needed for installation. The following is a cost breakdown by phase and funding source:

ESTIMATED PROJECT COSTS			
PHASE	UTC GRANT	THURSTON COUNTY	TOTAL
MATERIALS	1,200	\$0	\$1,200
INSTALLATION	0	\$250	\$250
TOTAL	\$1,200	\$250	\$1,400

5. **The name of the party responsible for long-term maintenance, such as repair of fencing.**

The Thurston County Public Works Department would be responsible for the long term maintenance of the proposed project.

6. **An estimated timeline of the project.**

Thurston County can complete proposed work within 6 months of executing the project agreement. Assuming the agreement is signed by January 2011 the following schedule should hold depending on weather and delivery of materials.

PROPOSED SCHEDULE	
DESIGN	Complete
MATERIAL PURCHASE	Complete
INSTALLATION	June 2011

7. **A description of how the project's success would be measured.**

A measure of success will be an indication the overall risk of the structure and roadway safety is reduced. This will be measured by the number of dispatches to the county sheriff's office and to the public works commercial vehicle inspector and number of reported crashes. If commercial

GCPF Application Form

vehicle crashes are reduced and dispatches are reduced then we will know the project is likely a success.

8. **Any other information the applicant believes would be useful to the commission in considering the project.**

None at this time.

Railroad Commitment

See Original Application.