



Date _____

UPRR REMS
Folder 303486

**AGREEMENT FOR PRELIMINARY ENGINEERING SERVICES
AND SUBMITTAL OF EXHIBIT "A" FOR RAILROAD APPROVAL**

Crossing: Public
WA, Spokane Valley
MP 12.99, Spokane Sub
Barker RD / DOT #662526C
Spokane County

Peggy J. Ygbuhay
Union Pacific Railroad Company
Engineering-Public Projects
10031 Foothills Boulevard
Roseville, CA 95747

Dear Ms. Ygbuhay:

Plans are being prepared to widen Barker Road at the location referenced above. The proposed work includes reconstructs Barker Road from the Spokane River to Euclid Road to a three lane, 40ft wide road with curb and gutter. The project also constructs a 10ft asphalt shared use path on the east side of the roadway. In connection with the project, the Agency considers it necessary for the successful advancement of the project for your company to collaborate in the development of the project by performing the following:

- preliminary engineering and other related services
- development of cost estimates
- review of the project's preliminary layouts
- submit current train and switching moves

The Agency authorizes and agrees to reimburse the Railroad for its expenses and actual costs that are incurred for collaborating in the development of the project's preliminary engineering and other preliminary activities. The Railroad has estimated that these preliminary engineering and other preliminary costs will be \$25,000.00. Payment will be made within thirty (30) days from the Agency's receipt and approval of the Railroad's request for reimbursement. Railroad will refer to Agency's Project Number 0275 and forward Invoices to:

Robert Lochmiller
10210 E. Sprague Avenue
Spokane Valley, WA 99206

The project may require the Railroad to incur costs for force account activities. Please prepare the railroad force account cost estimate for work activities to be provided by your company, as identified in **Exhibit A** and submit them at your earliest convenience so that they may be attached to the railroad

generated Construction & Maintenance (C&M) agreement.

Please verify the number of current regular train (9) and switching movements (0) with a Maximum Speed of (40) at this location as currently shown in our inventory records. This information will be used by the Agency's Contractor to obtain Railroad Protective Liability Insurance.

This agreement is intended to address Preliminary Engineering. It is understood by both parties that railroad may withhold its approval for any reason directly or indirectly related to safety or its operations, property issues or effect to its facilities. If the Project is approved, Union Pacific will continue to work with the Agency to develop Final Plans, Specifications and prepare Material and Cost Estimates for Railroad Construction Work associated with the project. It is also understood that if the project is constructed, if at all, at no cost to the railroad.

The Agency and the Railroad will enter into separate License, Right of Entry, Construction and Maintenance Agreements associated with the actual construction of the project if the project is accepted and approved by the railroad. The Agreements will be drafted by Union Pacific and forwarded to the Agency after the **Exhibit A** and cost estimates have been approved.

Please feel free to contact the City's project manager Robert Lochmiller at telephone number (509)720-5010 via email at rlochmiller@spokanevalley.org if you have any questions. Your assistance in this matter is appreciated.

Sincerely,



Mark Calhoun
City Manager

UNION PACIFIC RAILROAD COMPANY

By

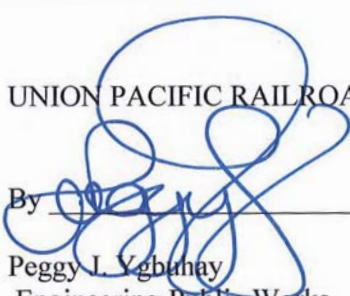

Peggy L. Ygbunay
Engineering-Public Works

Date

Aug. 29, 2019

Encl: Exhibit A

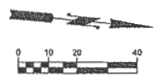
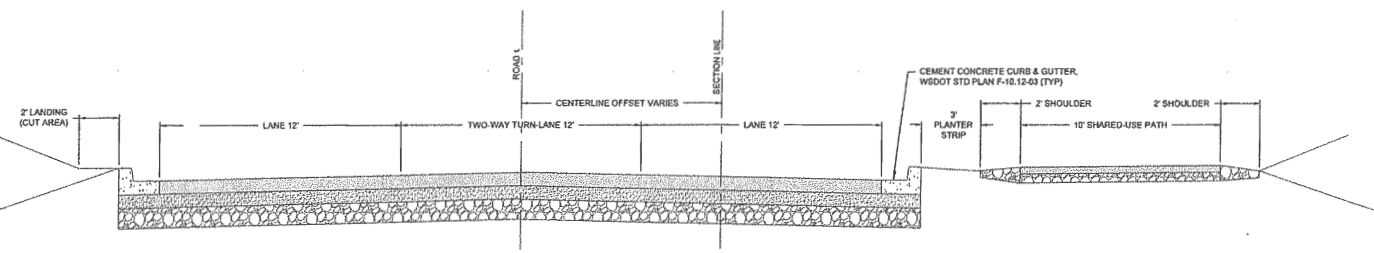
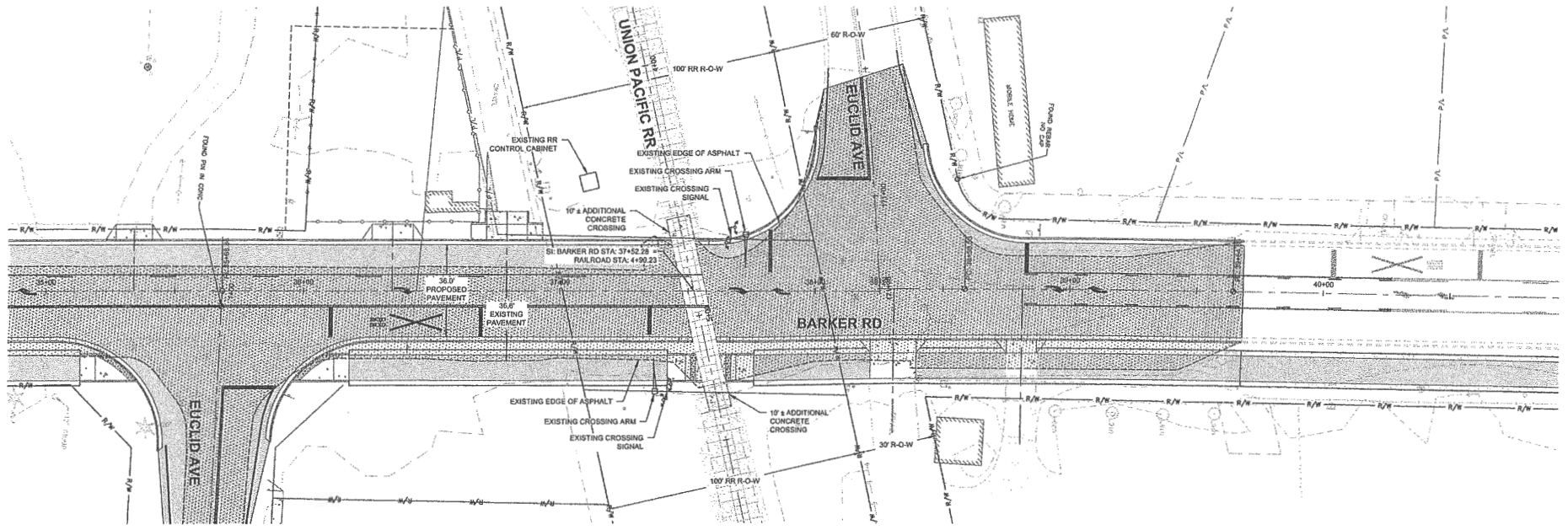

REVISIONS			
NO.	DATE	DESCRIPTION	BY

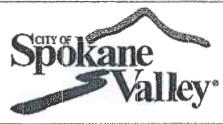

CITY OF SPOKANE VALLEY
 COMMUNITY & PUBLIC WORKS DEPARTMENT
 10210 EAST SPRAGUE AVENUE
 SPOKANE VALLEY, WA. 99206
 (509) 720-5000

DRAWN	DATE
JAM	07/18/19
DESIGNED	DATE
JAM	07/18/19
CHECKED BY	DATE
RAL	07/18/19

0275 BARKER RD WIDENING PROJECT
 UNION PACIFIC RR
 (SPOKANE INTERNATIONAL RR)
 CROSSING MODIFICATIONS

SHEET
 EX-A

U. S. DOT CROSSING INVENTORY FORM

DEPARTMENT OF TRANSPORTATION
FEDERAL RAILROAD ADMINISTRATION

OMB No. 2130-0017

Instructions for the initial reporting of the following types of new or previously unreported crossings: For public highway-rail grade crossings, complete the entire inventory Form. For private highway-rail grade crossings, complete the Header, Parts I and II, and the Submission Information section. For public pathway grade crossings (including pedestrian station grade crossings), complete the Header, Parts I and II, and the Submission Information section. For Private pathway grade crossings, complete the Header, Parts I and II, and the Submission Information section. For grade-separated highway-rail or pathway crossings (including pedestrian station crossings), complete the Header, Part I, and the Submission Information section. For changes to existing data, complete the Header, Part I Items 1-3, and the Submission Information section, in addition to the updated data fields. Note: For private crossings only, Part I Item 20 and Part III Item 2.K. are required unless otherwise noted. An asterisk * denotes an optional field.

A. Revision Date (MM/DD/YYYY) 11 / 05 / 2018	B. Reporting Agency <input checked="" type="checkbox"/> Railroad <input type="checkbox"/> Transit <input type="checkbox"/> State <input type="checkbox"/> Other	C. Reason for Update (Select only one) <input checked="" type="checkbox"/> Change in Data <input type="checkbox"/> Re-Open <input type="checkbox"/> New Crossing <input type="checkbox"/> Date Change Only <input type="checkbox"/> Closed <input type="checkbox"/> Change in Primary Operating RR <input type="checkbox"/> No Train Traffic <input type="checkbox"/> Quiet Zone Update <input type="checkbox"/> Admin. Correction	D. DOT Crossing Inventory Number 662526C
---	--	--	--

Part I: Location and Classification Information

1. Primary Operating Railroad Union Pacific Railroad Company [UP]		2. State WASHINGTON		3. County SPOKANE	
4. City / Municipality <input type="checkbox"/> In <input checked="" type="checkbox"/> Near SPOKANE		5. Street/Road Name & Block Number BARKER ROAD (Street/Road Name) * (Block Number)		6. Highway Type & No. CO97410	
7. Do Other Railroads Operate a Separate Track at Crossing? <input type="checkbox"/> Yes <input checked="" type="checkbox"/> No If Yes, Specify RR			8. Do Other Railroads Operate Over Your Track at Crossing? <input type="checkbox"/> Yes <input checked="" type="checkbox"/> No If Yes, Specify RR		
9. Railroad Division or Region <input type="checkbox"/> None Pacific Northwest		10. Railroad Subdivision or District <input type="checkbox"/> None Spokane Sub		11. Branch or Line Name <input checked="" type="checkbox"/> None	
12. RR Milepost 0012.990 (prefix) (nnnn.nnn) (suffix)		13. Line Segment *		14. Nearest RR Timetable Station *	
15. Parent RR (if applicable) <input checked="" type="checkbox"/> N/A		16. Crossing Owner (if applicable) <input type="checkbox"/> N/A UP		17. Crossing Type <input checked="" type="checkbox"/> Public <input type="checkbox"/> Private	
18. Crossing Purpose <input checked="" type="checkbox"/> Highway <input type="checkbox"/> Pathway, Ped. <input type="checkbox"/> Station, Ped.		19. Crossing Position <input checked="" type="checkbox"/> At Grade <input type="checkbox"/> RR Under <input type="checkbox"/> RR Over		20. Public Access (if Private Crossing) <input type="checkbox"/> Yes <input checked="" type="checkbox"/> No	
21. Type of Train <input checked="" type="checkbox"/> Freight <input type="checkbox"/> Intercity Passenger <input type="checkbox"/> Commuter		22. Average Passenger Train Count Per Day <input type="checkbox"/> Transit <input type="checkbox"/> Shared Use Transit <input type="checkbox"/> Tourist/Other		<input type="checkbox"/> Less Than One Per Day <input type="checkbox"/> Number Per Day 0	
23. Type of Land Use <input type="checkbox"/> Open Space <input type="checkbox"/> Farm <input checked="" type="checkbox"/> Residential <input type="checkbox"/> Commercial <input type="checkbox"/> Industrial <input type="checkbox"/> Institutional <input type="checkbox"/> Recreational <input type="checkbox"/> RR Yard					
24. Is there an Adjacent Crossing with a Separate Number? <input type="checkbox"/> Yes <input checked="" type="checkbox"/> No If Yes, Provide Crossing Number			25. Quiet Zone (FRA provided) <input checked="" type="checkbox"/> No <input type="checkbox"/> 24 Hr <input type="checkbox"/> Partial <input type="checkbox"/> Chicago Excused Date Established		
26. HSR Corridor ID <input checked="" type="checkbox"/> N/A		27. Latitude in decimal degrees (WGS84 std: nn.nnnnnnn) 47.6864630		28. Longitude in decimal degrees (WGS84 std: -nnn.nnnnnnn) -117.1544352	
29. Lat/Long Source <input checked="" type="checkbox"/> Actual <input type="checkbox"/> Estimated		30.A. Railroad Use *			
30.B. Railroad Use *		31.A. State Use *			
30.C. Railroad Use *		31.B. State Use *			
30.D. Railroad Use *		31.C. State Use *			
30.E. Railroad Use *		31.D. State Use *			
32.A. Narrative (Railroad Use) *			32.B. Narrative (State Use) *		
33. Emergency Notification Telephone No. (posted) 800-848-8715		34. Railroad Contact (Telephone No.) 402-544-3721		35. State Contact (Telephone No.) 360-664-1262	

Part II: Railroad Information

1. Estimated Number of Daily Train Movements				
1.A. Total Day Thru Trains (6 AM to 6 PM) 4	1.B. Total Night Thru Trains (6 PM to 6 AM) 3	1.C. Total Switching Trains 2	1.D. Total Transit Trains 0	1.E. Check if Less Than One Movement Per Day <input type="checkbox"/> How many trains per week? _____
2. Year of Train Count Data (YYYY) 2016		3. Speed of Train at Crossing 3.A. Maximum Timetable Speed (mph) 49 3.B. Typical Speed Range Over Crossing (mph) From 24 to 49		
4. Type and Count of Tracks Main 1 Siding 0 Yard 0 Transit 0 Industry 0				
5. Train Detection (Main Track only) <input checked="" type="checkbox"/> Constant Warning Time <input type="checkbox"/> Motion Detection <input type="checkbox"/> AFO <input type="checkbox"/> PTC <input type="checkbox"/> DC <input type="checkbox"/> Other <input type="checkbox"/> None				
6. Is Track Signaled? <input type="checkbox"/> Yes <input checked="" type="checkbox"/> No		7.A. Event Recorder <input type="checkbox"/> Yes <input checked="" type="checkbox"/> No		7.B. Remote Health Monitoring <input type="checkbox"/> Yes <input checked="" type="checkbox"/> No

U. S. DOT CROSSING INVENTORY FORM

A. Revision Date (MM/DD/YYYY) 11/05/2018		PAGE 2		D. Crossing Inventory Number (7 char.) 662526C	
Part III: Highway or Pathway Traffic Control Device Information					
1. Are there Signs or Signals? <input checked="" type="checkbox"/> Yes <input type="checkbox"/> No	2. Types of Passive Traffic Control Devices associated with the Crossing				
2.E. Low Ground Clearance Sign (W10-5) <input type="checkbox"/> Yes (count 0) <input checked="" type="checkbox"/> No	2.A. Crossbuck Assemblies (count) 0	2.B. STOP Signs (R1-1) (count) 0	2.C. YIELD Signs (R1-2) (count) 0	2.D. Advance Warning Signs (Check all that apply; include count) <input checked="" type="checkbox"/> None <input type="checkbox"/> W10-1 <input type="checkbox"/> W10-2 <input type="checkbox"/> W10-3 <input type="checkbox"/> W10-4 <input type="checkbox"/> W10-11 <input type="checkbox"/> W10-12	
2.F. Pavement Markings <input checked="" type="checkbox"/> Stop Lines <input type="checkbox"/> Dynamic Envelope <input checked="" type="checkbox"/> RR Xing Symbols <input type="checkbox"/> None	2.G. Channelization Devices/Medians <input type="checkbox"/> All Approaches <input type="checkbox"/> One Approach <input type="checkbox"/> Median <input checked="" type="checkbox"/> None		2.H. EXEMPT Sign (R15-3) <input type="checkbox"/> Yes <input checked="" type="checkbox"/> No	2.I. ENS Sign (I-13) Displayed <input checked="" type="checkbox"/> Yes <input type="checkbox"/> No	
2.J. Other MUTCD Signs Specify Type _____ Count 0 Specify Type _____ Count 0 Specify Type _____ Count _____	<input type="checkbox"/> Yes <input checked="" type="checkbox"/> No	2.K. Private Crossing Signs (if private) <input type="checkbox"/> Yes <input type="checkbox"/> No	2.L. LED Enhanced Signs (List types)		
3. Types of Train Activated Warning Devices at the Grade Crossing (specify count of each device for all that apply)					
3.A. Gate Arms (count) Roadway 2 Pedestrian _____	3.B. Gate Configuration <input checked="" type="checkbox"/> 2 Quad <input type="checkbox"/> Full (Barrier) Resistance <input type="checkbox"/> 3 Quad <input type="checkbox"/> 4 Quad <input type="checkbox"/> Median Gates	3.C. Cantilevered (or Bridged) Flashing Light Structures (count) Over Traffic Lane 2 <input type="checkbox"/> Incandescent Not Over Traffic Lane 0 <input type="checkbox"/> LED	3.D. Mast Mounted Flashing Lights (count of masts) 2 <input type="checkbox"/> Incandescent <input checked="" type="checkbox"/> LED <input checked="" type="checkbox"/> Back Lights Included <input checked="" type="checkbox"/> Side Lights Included	3.E. Total Count of Flashing Light Pairs 9	
3.F. Installation Date of Current Active Warning Devices: (MM/YYYY) _____/_____/_____ <input checked="" type="checkbox"/> Not Required		3.G. Wayside Horn <input type="checkbox"/> Yes <input checked="" type="checkbox"/> No Installed on (MM/YYYY) ____/____/____	3.H. Highway Traffic Signals Controlling Crossing <input type="checkbox"/> Yes <input checked="" type="checkbox"/> No	3.I. Bells (count) 2	
3.J. Non-Train Active Warning <input type="checkbox"/> Flagging/Flagman <input type="checkbox"/> Manually Operated Signals <input type="checkbox"/> Watchman <input type="checkbox"/> Floodlighting <input type="checkbox"/> None			3.K. Other Flashing Lights or Warning Devices Count 0 Specify type _____		
4.A. Does nearby Hwy Intersection have Traffic Signals? <input type="checkbox"/> Yes <input type="checkbox"/> No	4.B. Hwy Traffic Signal Interconnection <input type="checkbox"/> Not Interconnected <input type="checkbox"/> For Traffic Signals <input type="checkbox"/> For Warning Signs	4.C. Hwy Traffic Signal Preemption <input type="checkbox"/> Simultaneous <input type="checkbox"/> Advance	5. Highway Traffic Pre-Signals <input type="checkbox"/> Yes <input checked="" type="checkbox"/> No Storage Distance * _____ Stop Line Distance * _____	6. Highway Monitoring Devices (Check all that apply) <input type="checkbox"/> Yes - Photo/Video Recording <input type="checkbox"/> Yes - Vehicle Presence Detection <input type="checkbox"/> None	
Part IV: Physical Characteristics					
1. Traffic Lanes Crossing Railroad Number of Lanes 2 <input type="checkbox"/> One-way Traffic <input checked="" type="checkbox"/> Two-way Traffic <input type="checkbox"/> Divided Traffic	2. Is Roadway/Pathway Paved? <input checked="" type="checkbox"/> Yes <input type="checkbox"/> No	3. Does Track Run Down a Street? <input type="checkbox"/> Yes <input checked="" type="checkbox"/> No	4. Is Crossing Illuminated? (Street lights within approx. 50 feet from nearest rail) <input type="checkbox"/> Yes <input checked="" type="checkbox"/> No		
5. Crossing Surface (on Main Track, multiple types allowed) Installation Date * (MM/YYYY) ____/____/____ Width * _____ Length * _____ <input type="checkbox"/> 1 Timber <input type="checkbox"/> 2 Asphalt <input type="checkbox"/> 3 Asphalt and Timber <input checked="" type="checkbox"/> 4 Concrete <input type="checkbox"/> 5 Concrete and Rubber <input type="checkbox"/> 6 Rubber <input type="checkbox"/> 7 Metal <input type="checkbox"/> 8 Unconsolidated <input type="checkbox"/> 9 Composite <input type="checkbox"/> 10 Other (specify) _____					
6. Intersecting Roadway within 500 feet? <input checked="" type="checkbox"/> Yes <input type="checkbox"/> No If Yes, Approximate Distance (feet) 30		7. Smallest Crossing Angle <input type="checkbox"/> 0° - 29° <input type="checkbox"/> 30° - 59° <input checked="" type="checkbox"/> 60° - 90°		8. Is Commercial Power Available? * <input checked="" type="checkbox"/> Yes <input type="checkbox"/> No	
Part V: Public Highway Information					
1. Highway System <input type="checkbox"/> (01) Interstate Highway System <input type="checkbox"/> (02) Other Nat Hwy System (NHS) <input checked="" type="checkbox"/> (03) Federal AID, Not NHS <input type="checkbox"/> (08) Non-Federal Aid	2. Functional Classification of Road at Crossing <input type="checkbox"/> (0) Rural <input checked="" type="checkbox"/> (1) Urban <input type="checkbox"/> (1) Interstate <input type="checkbox"/> (5) Major Collector <input type="checkbox"/> (2) Other Freeways and Expressways <input type="checkbox"/> (6) Minor Collector <input type="checkbox"/> (3) Other Principal Arterial <input type="checkbox"/> (7) Local <input checked="" type="checkbox"/> (4) Minor Arterial		3. Is Crossing on State Highway System? <input type="checkbox"/> Yes <input checked="" type="checkbox"/> No	4. Highway Speed Limit _____ MPH <input type="checkbox"/> Posted <input type="checkbox"/> Statutory	
7. Annual Average Daily Traffic (AADT) Year 1988 AADT 2309	8. Estimated Percent Trucks 09 %	9. Regularly Used by School Buses? <input type="checkbox"/> Yes <input checked="" type="checkbox"/> No Average Number per Day 0		10. Emergency Services Route <input type="checkbox"/> Yes <input type="checkbox"/> No	
Submission Information - This information is used for administrative purposes and is not available on the public website.					
Submitted by _____	Organization _____		Phone _____	Date _____	
Public reporting burden for this information collection is estimated to average 30 minutes per response, including the time for reviewing instructions, searching existing data sources, gathering and maintaining the data needed and completing and reviewing the collection of information. According to the Paperwork Reduction Act of 1995, a federal agency may not conduct or sponsor, and a person is not required to, nor shall a person be subject to a penalty for failure to comply with, a collection of information unless it displays a currently valid OMB control number. The valid OMB control number for information collection is 2130-0017. Send comments regarding this burden estimate or any other aspect of this collection, including for reducing this burden to: Information Collection Officer, Federal Railroad Administration, 1200 New Jersey Ave. SE, MS-25 Washington, DC 20590.					