

WASHINGTON UTILITIES AND TRANSPORTATION COMMISSION

CERTIFICATE OF PUBLIC CONVENIENCE AND NECESSITY

TO OPERATE A GAS PLANT FOR HIRE

The Washington Water Power Company of East 1411 Mission Avenue, Spokane, Washington is hereby authorized to operate a gas plant for hire in the general area or areas of:

Appendix A-1 Amended 9/11/91	Appendix A-13	Original 4/7/67
Appendix A-2 Amended 5/11/86	Appendix A-14	Original 4/7/67
Appendix A-3 Amended 4/15/66	Appendix A-15	Original 4/24/68
Appendix A-4 Original 10/19/56	Appendix A-16	Original 4/24/68
Appendix A-5 Amended 5/11/86	Appendix A-17	Original 3/24/70
Appendix A-6 Amended 1/16/91	Appendix A-18	Original 3/19/74
Appendix A-7 Original 10/9/61	Appendix A-19	Original 3/19/74
Appendix A-8 Original 10/9/61	Appendix A-20	Original 3/19/74
Appendix A-9 Original 10/9/61	Appendix A-21	Amended 1/22/91
Appendix A-10 Amended 9/11/91	Appendix A-22	Original 3/19/74
Appendix A-11 Original 4/15/66	Appendix A-23	Original 3/19/74
Appendix A-12 Amended 5/10/95	Appendix A-24	Original 11/13/85

CONDITIONS:

1. Any gas plant operated by virtue of this certificate must be operated in accordance with the Laws of the State of Washington and the Rules and Regulations of this Commission.
2. This certificate must be kept on file at the main office of the gas company except when directed to be transmitted to the Commission, and shall be subject at all times to inspection by the authorized representatives of the Commission.
3. This certificate shall be subject to revocation and cancellation by the Commission upon a showing of procurement by false affidavit or representation.
4. This certificate is subject to the terms, conditions and provisions of the Orders in Cause Nos. U-8889, U-9021, U-9022, U-9023, U-9052, U-9115, U-9288, U-9591, U-9676, U-9764, U-9826, U-9954, U-73-53, U-85-67, U-86-84, U-88-1884, Docket No. UG-900873, UG-900905, UG-900937, UG-900979, UG-910528, UG-911028, and UG-941546.

This certificate is issued upon finding by the Washington Utilities and Transportation Commission that public convenience and necessity requires or will require such operation in accordance with RCW 80.28.190.

Order No. UG-941546 - Dated May 10, 1995

Dated at Olympia, Washington

WASHINGTON UTILITIES AND TRANSPORTATION COMMISSION

By





R. 38 E.

R. 39 E.

REF. NO. U-9676
EXHIBIT A

T. 36 N.

T. 35 N.

T. 34 N.

T.

T.

T.

T.

T.

T.

T.

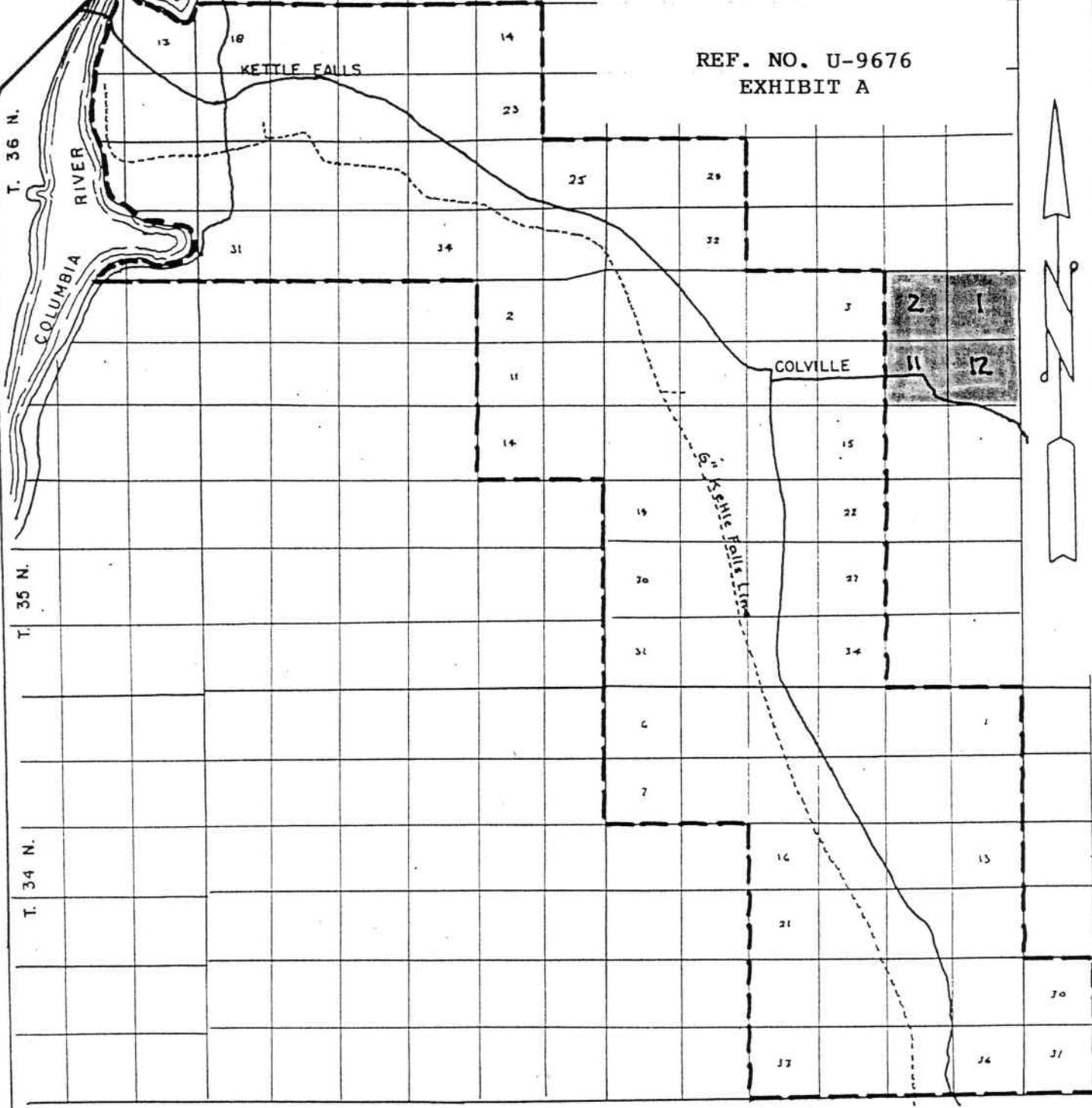

APPENDIX A-12
CAUSE NO. U-9676



- PROPOSED CERTIFICATE ADDITION

THE WASHINGTON WATER POWER CO.

WASHINGTON
UTILITIES AND TRANSPORTATION
COMMISSION

BOUNDARY OF SERVICE AREA - - - - -

(PORTIONS OF STEVENS COUNTY)

DATE: APRIL 15, 1966

BY: T.W.

APPENDIX 1
WASHINGTON WATER POWER
LEGAL DESCRIPTION
DOCKET UG-941546

A PORTION OF STEVENS COUNTY TO BE ADDED TO APPENDIX A-12 DESCRIBED AS FOLLOWS:

Beginning at the northwest corner of Sec. 2, T. 35 N., R. 39 E., thence easterly along the north line of Sects. 2 and 1, T. 35 N., R. 39 E., to the northeast corner of Sec. 1, T. 35 N., R. 39 E., thence southerly on the east line of Sect. 1 and 12, T. 35 N., R. 39 E. to the southeast corner of Sec. 12, T. 35 N., R. 39 E.; thence westerly on the south line of Sects. 12 and 11, T. 35 N., R. 39 E., to the southwest corner of Sec. 11, T. 35 N., R. 39 E.; thence northerly on the west line of Sects. 11 and 2, T. 35 N., R. 39 E., to the northwest corner of Sec. 2, T. 35 N., R. 39 E., which is the point of beginning.

APPENDIX A-12, AMENDED

Beginning at the southwest corner of Sec. 33, T. 34 N., R. 39 E.; thence northerly along the west line of Sects. 33, 23, 21 and 16, T. 34 N., R. 39 E., to the southeast corner of Sec. 8, T. 34 N., R. 39 E.; thence westerly on the south line of Sects. 8 and 7, T. 34 N., R. 39 E., to the southwest corner of Sec. 7, T. 34 N., R. 39 E.; thence northerly on the west line of Sects. 7 and 6, T. 34 N., R. 39 E., and Sects. 31, 30 and 19, T. 35 N., R. 39 E., to the southeast corner of Sec. 13, T. 35 N., R. 38 E.; thence westerly on the south line of Sects. 13 and 14, T. 35 N., R. 38 E., to the southwest corner of Sec. 14, T. 35 N., R. 38 E.; thence northerly on the west line of Sects. 14, 11 and 2, T. 35 N., R. 38 E., to a point on the south line of Sec. 34, T. 36 N., R. 38 E.; thence westerly on the south line of Sects. 34, 33, 32 and 31, T. 36 N., R. 38 E., and Sects. 36 and 35, T. 36 N., R. 37 E., to the easterly edge of the Columbia River; thence following the easterly edge of the Columbia River in an easterly, northwesterly, northerly and easterly direction to its intersection with the north line of Sec. 18, T. 36 N., R. 38 E.; thence easterly on the north line of Sects. 18, 17, 16, 15 and 14, T. 36 N., R. 38 E., to the northeast corner of Sec. 14, T. 36 N., R. 38 E.; thence southerly on the east line of Sects. 14 and 23, T. 36 N., R. 38 E., to the northwest corner of Sec. 25, T. 36 N., R. 38 E.; thence easterly on the north line of Sec. 25, T. 36 N., R. 38 E., and Sects. 30 and 29, T. 36 N., R. 39 E., to the northeast corner of Sec. 29, T. 36 N., R. 39 E.; thence southerly on the east line of Sects. 29 and 32, T. 36 N., R. 39 E., to the northwest corner of Sec. 4, T. 35 N., R. 39 E.; thence easterly on the north line of Sects. 4, 3, 2 and 1, T. 35 N., R. 39 E., to the northeast corner of Sec. 1, T. 35 N., R. 39 E.; thence southerly on the east line of Sects. 1 and 12, T. 35 N., R. 39 E., to the southeast corner of Sec. 12, T. 35 N., R. 39 E.; thence westerly on the south line of Sects. 12 and 11, T. 35 N., R. 39 E., to the northeast corner of Sec. 15, T. 35 N., R. 39 E., thence southerly on the east line of Sects. 15, 22, 27 and 34, T. 35 N., R. 39 E., to the north line of Sec. 2, T. 34 N., R. 39 E.; thence easterly on the north line of Sects. 2 and 1, T. 34 N., R. 39 E., to the northeast corner of Sec. 1, T. 34 N., R. 39 E.; thence southerly on the east line of Sects. 1, 12, 13 and 24, T. 34 N., R. 39 E., to the northwest corner of Sec. 30, T. 34 N., R. 40 E.; thence easterly on the north line of Sec. 30, T. 34 N., R. 40 E., to the northeast corner of Sec. 30, T. 34 N., R. 40 E.; thence southerly on the east line of Sects. 30 and 31, T. 34 N., R. 40 E., to the southeast corner of Sec. 31, T. 34 N., R. 40 E.; thence westerly on the south line of Sec. 31, T. 34 N., R. 40 E., and Sects. 36, 35, 34 and 33 to the southwest corner of Sec. 33, T. 34 N., R. 39 E., which is the point of beginning.