

LEGEND—PAVEMENT MARKINGS

- P1** PAINTED SKIP YELLOW PASSING LINE & RECESSED PAVEMENT MARKERS TYPE 2YY
- P2** PAINTED DOUBLE YELLOW CENTER LINE & RECESSED PAVEMENT MARKERS TYPE 2YY
- P3** PAINTED EDGE LINE
- P4** PAINTED NO-PASS LINE & RECESSED PAVEMENT MARKERS TYPE 2YY
- P5** PLASTIC 24" STOP LINE INSTALL PERPENDICULAR TO C. LOCATION TO BE VERIFIED BY TRAFFIC DEPT PRIOR TO INSTALLATION.

**ALL SIGN STATION LOCATIONS SHALL BE APPROVED BY ENGINEER PRIOR TO INSTALLATION
 *** SHEETING TYPES AS DESIGNATED IN ASTM SPECIFICATION D4956
 **** THE EXISTING FLASHING BEACONS SHALL REMAIN IN SERVICE WHILE SCHOOL IS IN SESSION.

PERMANENT SIGNING SCHEDULE

SYMBOL	SIGN CODE NO. (DESCRIPTION)	SIGN SIZE		LETTER SIZE OR CODE	***SHEETING TYPE	POST MATERIAL	POST SIZE	POST LENGTH	QUANT.	**LOCATION	BLOCK #	NOTES			
		X	Y												
(S1)	S5-1 (SCHOOL SPEED LIMIT 20)	24"	48"	STANDARD	4	STEEL	2.5" SQ.	12'	1	99+84 LT.	-	****REUSE EXISTING FLASHING BEACONS			
(S1-A)	S1-1 (SCHOOL ADVANCE WARNING)	36"	36"	STANDARD	4	STEEL	2.5" SQ.	12'	1	101+00 RT.	-	FLOURESCENT YELLOW GREEN			
	W16-9P (AHEAD)	24"	12"	STANDARD	4										
(S2)	R2-1 (SPEED LIMIT 35)	24"	30"	STANDARD	4	STEEL	2.5" SQ.	12'	1	109+60 LT.	-				
(S3)	W1-1L (LEFT TURN)	36"	36"	STANDARD	4	STEEL	2.5" SQ.	12'	1	109+63 RT.	-				
	W13-1 (20 MPH ADVISORY)	24"	24"	STANDARD											
(S4)	W1-7 (INTERSECTION WARNING)	48"	24"	STANDARD	4	STEEL	2.5" SQ.	12'	1	111+62 LT.	-				
	D-3 (FIR TREE RD SE)	N/A	12"	SERIES B	4								2	4100	-
	D-3 (RICH RD SE)	N/A	12"	SERIES B	4								2	8700	-
(S5)	R1-1 (STOP)	36"	36"	STANDARD	4				1						
(S6)	W10-1 (RAIL CROSSING)	36"	DIA.	STANDARD	4	STEEL	2.5" SQ.	12'	1	114+15 RT.	-				
(S7)	W1-8 (CHEVRON)	24"	30"	STANDARD	4	STEEL	2.5" SQ.	12'	1	114+56 RT.	-				
(S8)	W1-8 (CHEVRON)	24"	30"	STANDARD	4	STEEL	2.5" SQ.	12'	1	115+25 RT.	-				
(S8-A)	W1-8 (CHEVRON)	24"	30"	STANDARD	4										
(S8-B)	W1-6 (CURVE ARROW)	48"	24"	STANDARD	4										
(S9)	W1-6 (CURVE ARROW)	48"	24"	STANDARD	4	STEEL	2.5" SQ.	12'	1	115+55 RT.	-				
(S10)	W1-8 (CHEVRON)	24"	30"	STANDARD	4	STEEL	2.5" SQ.	12'	1	115+93 RT.	-				
(S10-A)	W1-8 (CHEVRON)	24"	30"	STANDARD	4										

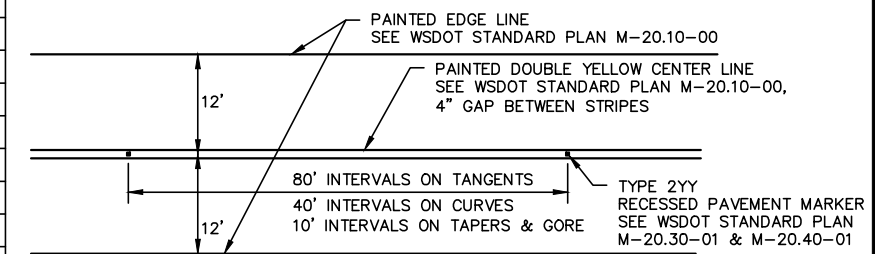
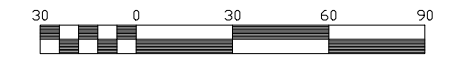

THURSTON COUNTY PUBLIC WORKS
 DESIGN SECTION
 2404-A HERITAGE CT SW OLYMPIA, WA 98502
 (360) 754-4580



Designed: VB	Revisions:	Date:
Drafted: MB		
Checked: MU		
Scale: AS NOTED		
DWG File: RICH_RD_PH2_TRAFFIC_PLAN		

RICH RD PHASE-2 87TH AVE TO NORMANDY ST
 C.R.P. No. 61460 F.A. No. TBD

SIGNING & CHANNELIZATION 1

Sheet
 29 of 31

O:\Projects\06_CapitolConst\61460 Rich Road Upgrade Phase 2 87th-Normandy\Design\CADD\Current Design\Preliminary\Design\Rich_Rd_ph2_Traffic_Plan.dwg, TRAFF PLAN 1 PH2, 01/14/2016 4:12:21 PM

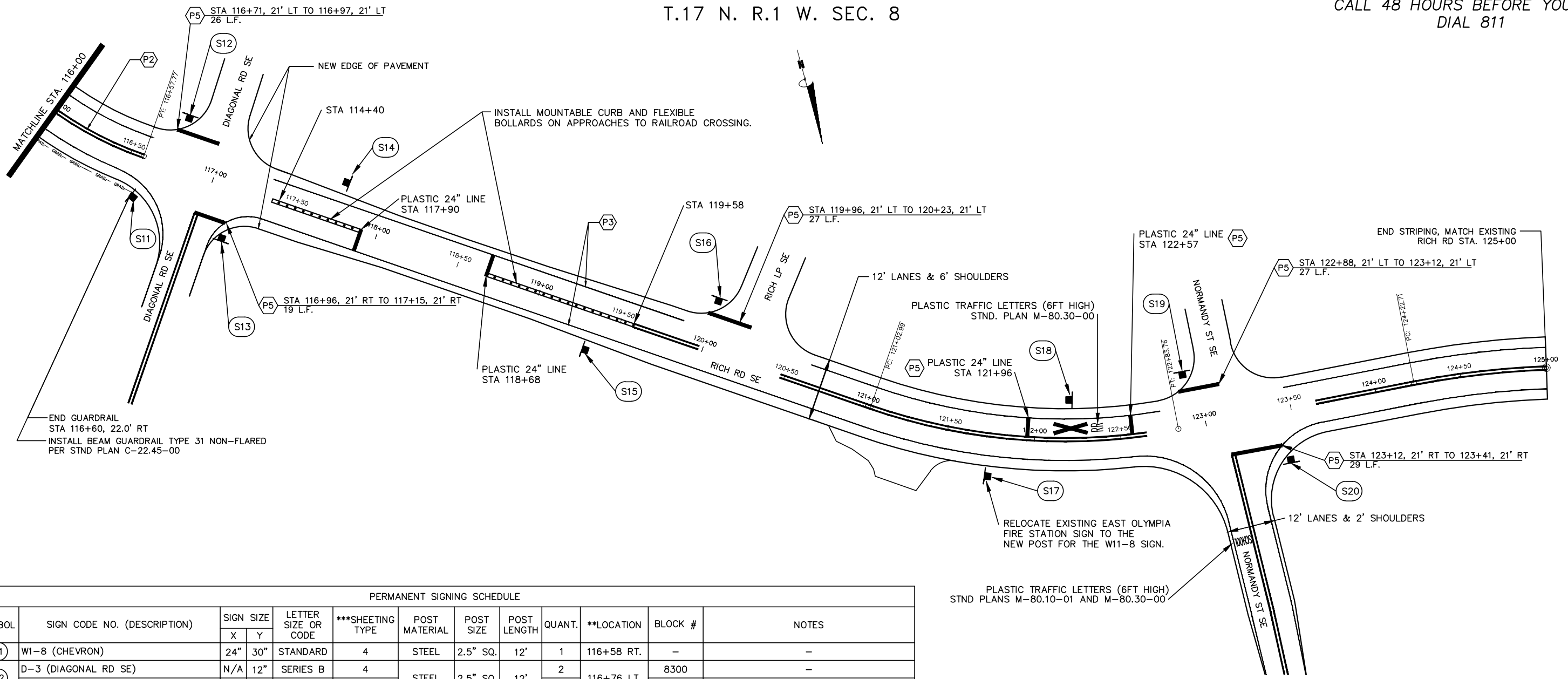

PERMANENT SIGNING SCHEDULE

SYMBOL	SIGN CODE NO. (DESCRIPTION)	SIGN SIZE		LETTER SIZE OR CODE	***SHEETING TYPE	POST MATERIAL	POST SIZE	POST LENGTH	QUANT.	**LOCATION	BLOCK #	NOTES
		X	Y									
(S11)	W1-8 (CHEVRON)	24"	30"	STANDARD	4	STEEL	2.5" SQ.	12'	1	116+58 RT.	-	-
(S12)	D-3 (DIAGONAL RD SE)	N/A	12"	SERIES B	4	STEEL	2.5" SQ.	12'	2	116+76 LT.	8300	-
	R1-1 (STOP)	36"	36"	STANDARD	4							
(S13)	D-3 (DIAGONAL RD SE)	N/A	12"	SERIES B	4	STEEL	2.5" SQ.	12'	2	117+16 RT.	8300	-
	R1-1 (STOP)	36"	36"	STANDARD	4							
(S14)	W1-1R (RIGHT TURN)	36"	36"	STANDARD	4	STEEL	2.5" SQ.	12'	1	117+75 RT.	-	-
	W13-1 (20 MPH ADVISORY)	24"	24"	STANDARD	4							
(S15)	W1-3L (CURVES AHEAD)	36"	36"	STANDARD	4	STEEL	2.5" SQ.	12'	1	119+34 RT.	-	-
	W13-1 (20 MPH ADVISORY)	24"	24"	STANDARD	4							
(S16)	D-3 (RICH LP SE)	N/A	12"	SERIES B	4	STEEL	2.5" SQ.	12'	2	120+00 LT.	8300	-
	R1-1 (STOP)	36"	36"	STANDARD	4							
(S17)	W11-8 (FIRE STATION)	36"	36"	STANDARD	4	STEEL	2.5" SQ.	12'	1	121+74 RT.	-	-
(S18)	W10-1 (RAIL CROSSING)	36"	DIA.	STANDARD	4	STEEL	2.5" SQ.	12'	1	122+22 LT.	-	-
(S19)	D-3 (NORMANDY ST SE)	N/A	12"	SERIES B	4	STEEL	2.5" SQ.	12'	2	122+92 LT.	4000	-
	R1-1 (STOP)	36"	36"	STANDARD	4							
(S20)	D-3 (NORMANDY ST SE)	N/A	12"	SERIES B	4	STEEL	2.5" SQ.	12'	2	123+45 RT.	8300	-
	D-3 (RICH RD SE)	N/A	12"	SERIES B	4							
	R1-1 (STOP)	36"	36"	STANDARD	4							

LEGEND-PAVEMENT MARKINGS

- (P1) PAINTED SKIP YELLOW PASSING LINE & RECESSED PAVEMENT MARKERS TYPE 2YY
- (P2) PAINTED DOUBLE YELLOW CENTER LINE & RECESSED PAVEMENT MARKERS TYPE 2YY
- (P3) PAINTED EDGE LINE
- (P4) PAINTED NO-PASS LINE & RECESSED PAVEMENT MARKERS TYPE 2YY
- (P5) PLASTIC 24" STOP LINE
INSTALL PERPENDICULAR TO C.
LOCATION TO BE VERIFIED BY TRAFFIC DEPT PRIOR TO INSTALLATION.

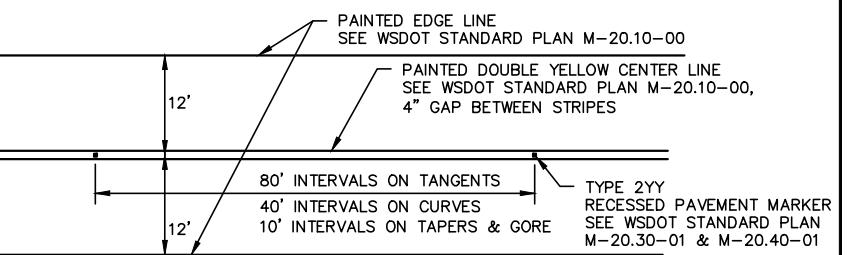

TYPICAL PAVEMENT MARKING DETAIL

**ALL SIGN STATION LOCATIONS SHALL BE APPROVED BY ENGINEER PRIOR TO INSTALLATION
*** SHEETING TYPES AS DESIGNATED IN ASTM SPECIFICATION D4956
**** THE EXISTING FLASHING BEACONS SHALL REMAIN IN SERVICE WHILE SCHOOL IS IN SESSION.

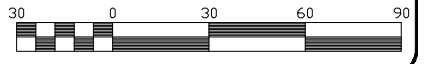

O:\Projects\06_CapitolConst\61460 Rich Road Upgrade Phase 2 87th-Normandy\Design\CADD\Current Design\Preliminary\Design\Rich_Rd_ph2_Traffic_Plan.dwg, TRAFF PLAN 2 PH2, 01/14/2016 4:12:24 PM

THURSTON COUNTY PUBLIC WORKS
DESIGN SECTION
2404-A HERITAGE CT SW OLYMPIA, WA 98502
(360) 754-4580



Designed: VB	Revisions:	Date:
Drafted: MB		
Checked: MU		
Scale: AS NOTED		
DWG File: RICH_RD_PH2_TRAFFIC_PLAN		

RICH RD PHASE-2 87TH AVE TO NORMANDY ST
C.R.P. No. 61460 F.A. No. TBD

SIGNING & CHANNELIZATION 2

Sheet
30 of 31